



F.I.A. Recognition No. 5525
Group 1 - Series Production

ROYAL AUTOMOBILE CLUB

31, Belgrave Square, London, S.W.1

Form of recognition in accordance with appendix J to the International Sporting Code of the
FEDERATION INTERNATIONALE DE L'AUTOMOBILE

Cylinder-capacity 1248 cm.³ 77.48 in.³
Manufacturer Chrysler United Kingdom Ltd Model Hillman Avenger 1250 TC
Serial No. of chassis/body 236.000001 Manufacturer Chrysler United Kingdom Ltd
Serial No. of engine 236.000001 Manufacturer Chrysler United Kingdom Ltd
Recognition is valid from 1973 List

The manufacturing of the model described in this recognition form started on 5th September 1972
and the minimum production of 5000 identical cars, in accordance with the specifications of
this form was reached on 10th January 1973 - approximately

Photograph A. $\frac{1}{4}$ view of car from front



F.I.A. Stamp

R.A.C. Stamp

B



C



D

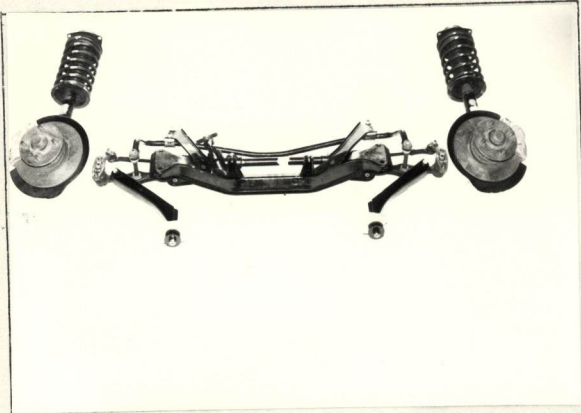

E

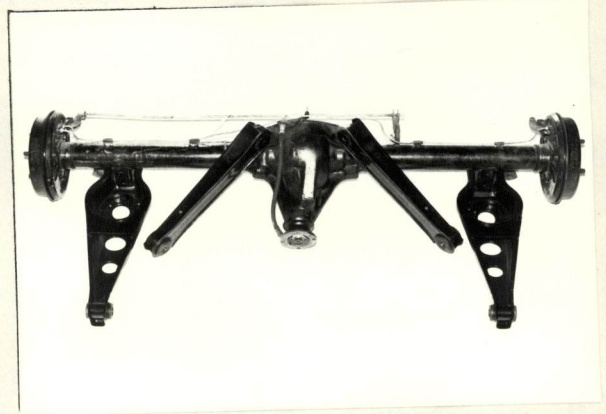

F

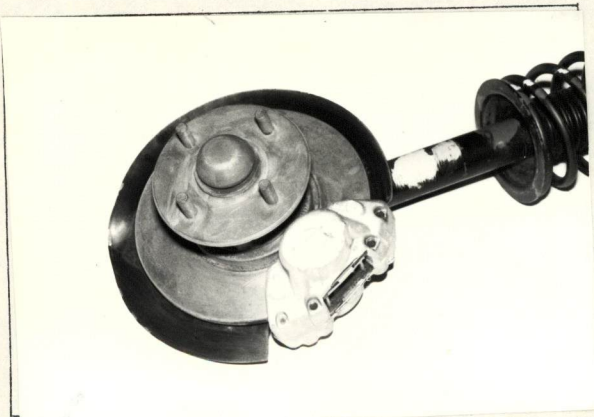

G

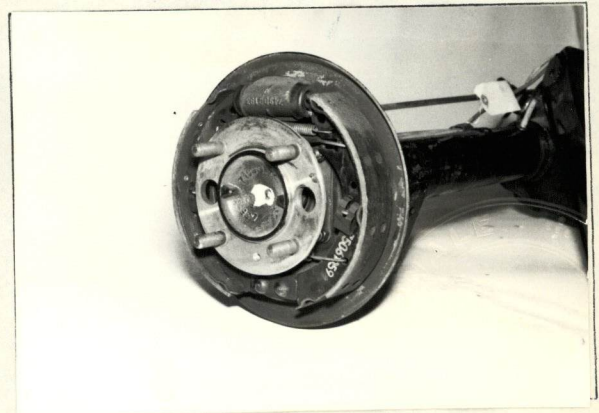

H

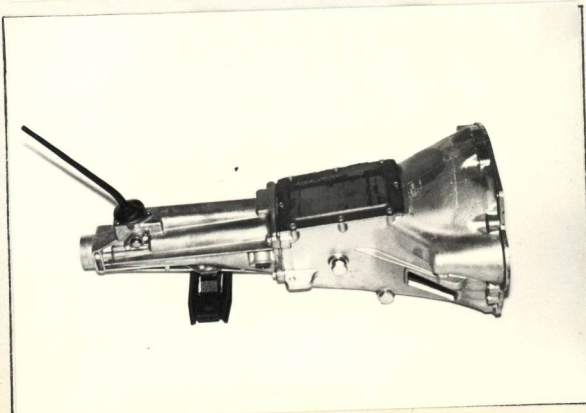

I

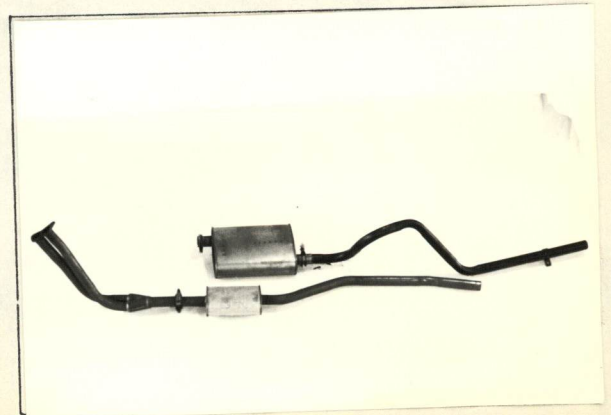

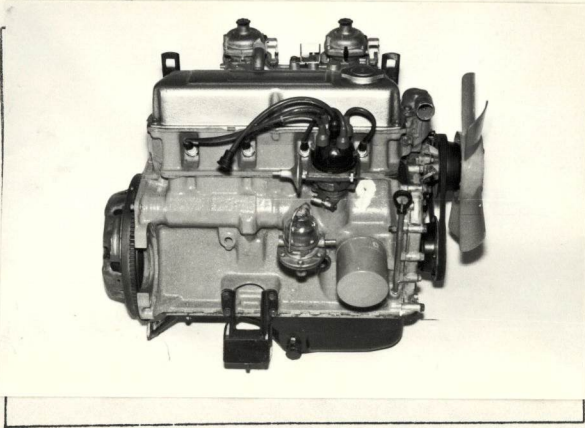

J

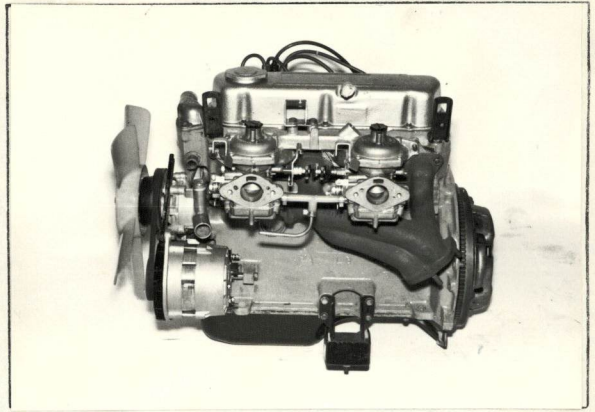

K

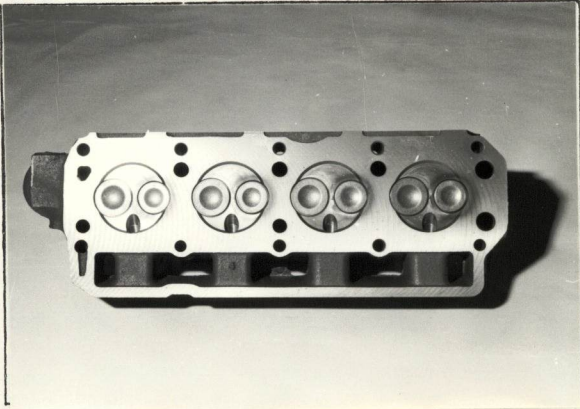

L



M

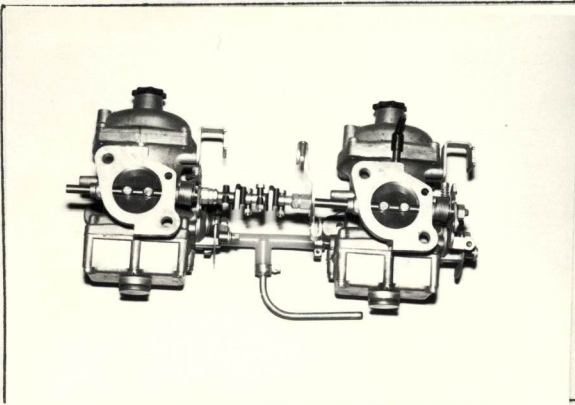

N

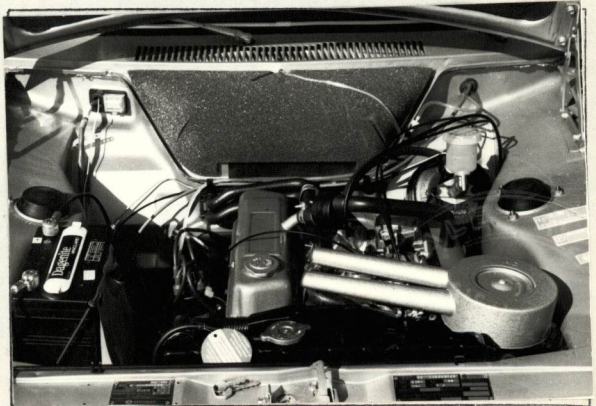

O

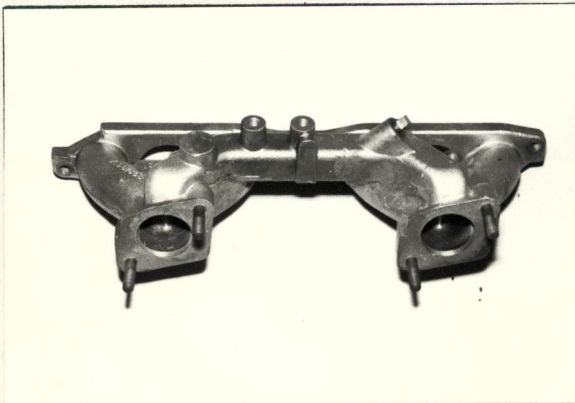

P



Q

Drawing inlet manifold ports, side of cylinderhead. Indicate scale or dimensions and manufacturing tolerance.

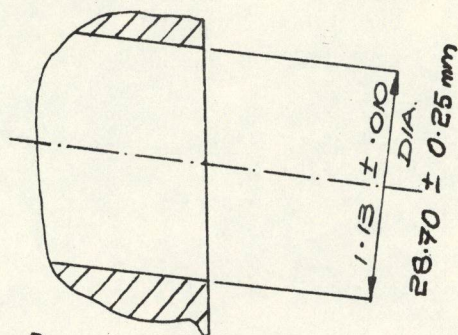

Drawing of entrance to inlet port of cylinderhead. Indicate scale or dimensions and manufacturing tolerance.

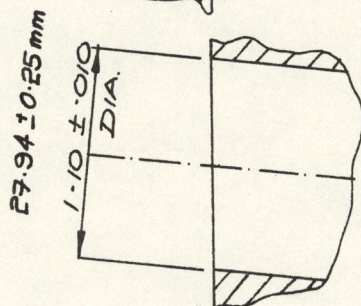

Drawing of exhaust manifold ports, side of cylinderhead. Indicate scale or dimensions and manufacturing tolerance.

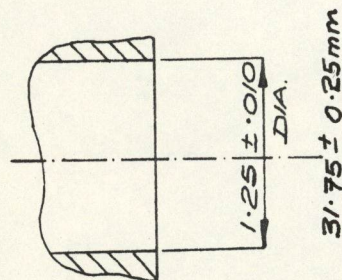

Drawing of exit to exhaust port of cylinderhead. Indicate scale or dimensions and manufacturing tolerance.

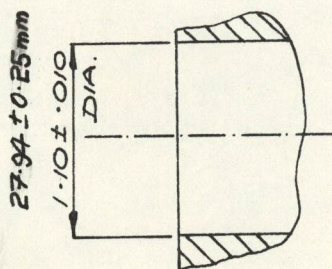

NOTE 1.

All dimensions must be given in two measuring systems, see Note 3.

CAPACITIES AND DIMENSIONS

1. Wheelbase			<i>2,490</i>	mm.	<i>98-0</i>	inches
2. Front track	<i>1,295</i>	mm.	<i>51-0</i>	inches		
			<i>1,302</i>	mm.	<i>51-3</i>	inches

Height of bottom of sill to ground

Front:- 7-25 in. 184 mm.

Rear:- 8-00 in. 206 mm.

4. Overall length of the car			<i>410</i>	cm.	<i>161-4</i>	inches
5. Overall width of the car			<i>159</i>	cm.	<i>62-5</i>	inches
5a. Width at front axle :-	<i>159 cm. 62.5 in.</i>				<i>159 cm. 62.5 in.</i>	
6. Overall height of the car			<i>135</i>	cm.	<i>53-1</i>	inches
7. Capacity of fuel tank (reserve included)						
	<i>45.5</i>	ltrs.	<i>12</i>	gall. U.S.	<i>10</i>	gall. Imp.
8. Seating Capacity.	<i>4</i>					
9. Weight. Total weight of the car with normal equipment, water, oil, and spare wheel but without fuel or repair tools :						
	<i>844</i>	kg.	<i>1860</i>	lbs.	<i>16-6</i>	cwts.

NOTE 2.

Differences in track caused by the use of other wheels with different rim widths must be stated when recognition is requested for the wheels concerned. Specify ground clearance in relation to the track and give drawing of two easily recognisable points at front and rear at which measurements are taken. These ground clearance dimensions are only for information when checking the track and can in no way affect the eligibility of the car.

NOTE 3.

CONVERSION TABLE

1 inch/pouce	—	<i>2.54</i>	cm.	1 quart US	—	<i>0.9464</i>	ltrs.
1 foot/pied	—	<i>30.4794</i>	cm.	1 pint (pt)	—	<i>0.568</i>	ltrs.
1 sq. inch/pouce carre	—	<i>6.452</i>	cm. ²	1 gallon Imp.	—	<i>4.546</i>	ltrs.
1 cubic inch/pouce cube	—	<i>16.387</i>	cm. ³	1 gallon US	—	<i>3.785</i>	ltrs.
1 pound/livre (lb)	—	<i>453.593</i>	gr.	1 hundred weight (cwt.)	—	<i>50.802</i>	kg.

CHASSIS AND COACHWORK (Photographs A, B and C)

- 20. Chassis/body construction: ~~separate~~/unitary construction
- 21. Unitary construction, material(s) *Steel*
- 22. Separate construction, Material(s) of chassis *—*
- 23. Material(s) of coachwork *Steel*
- 24. Number of doors *4* Material(s) *Steel*
- 25. Material(s) of bonnet *Steel*
- 26. Material(s) of boot lid *Steel*
- 27. Material(s) of rear-window *Safety glass*
- 28. Material(s) of windscreen *Safety glass or laminated*
- 29. Material(s) of front-door windows *Safety glass*
- 30. Material(s) of rear-door windows *Safety glass*
- 31. Sliding system of door windows *Vertical winding*
- 32. Material(s) of rear-quarter light *Safety glass*

ACCESSORIES AND UPHOLSTERY

- 38. Interior heating : yes — ~~no~~
- 39. Air conditioning : ~~yes~~ — no
- 40. Ventilation : yes — ~~no~~
- 41. Front seats, type of seat and upholstery *Ambla/nylon on rubber diaphragm -reclining*
- 42. Weight of front seat(s), complete with supports and rails, out of the car :

<i>10</i>	kg.	<i>22</i>	lbs.
-----------	-----	-----------	------
- 43. Rear seats, type of seat and upholstery *Ambla/nylon on cushion frame*
- 44. Front bumper, material(s) *Steel* Weight *3-45* kg. *7-55* lbs.
- 45. Rear bumper, material(s) *Steel* Weight *4-15* kg. *9-15* lbs.

WHEELS

- 50. Type *Pressed steel ventilated disc*
- 51. Weight (per wheel, without tyre) *5-9* kg. *13-0* lbs.
- 52. Method of attachment *4 stud*
- 53. Rim diameter *330* mm. *13* ins. 54. Rim width *114* mm. *4-5* ins.

STEERING

- 60. Type *Rack & pinion*
- 61. Servo-assistance : ~~yes~~ — no
- 62. Number of turns of steering wheel from lock to lock *3-6*
- 63. In case of servo-assistance *—*

SUSPENSION

- 70. Front suspension (photograph D), type *Independent - hydraulic strut assemblies*
- 71. Type of spring *Coil*
- 72. Stabiliser (if fitted) *Transverse anti-roll bar*
- 73. Number of shock absorbers *2*
- 74. Type *Telescopic*
- 78. Rear suspension (photograph E), type *Live axle with 4 link location.*
- 79. Type of spring *Coil*
- 80. Stabiliser (if fitted) *-*
- 81. Number of shock absorbers *2*
- 82. Type *Telescopic*

BRAKES (photographs F and G)

- 90. Method of operation *Hydraulic*
 - 91. Servo-assistance (if fitted), type *Girling - direct acting*
 - 92. Number of hydraulic master cylinders *1*
 - 93. Number of cylinders per wheel *2*
 - 94. Bore of wheel cylinder(s) *48.1*
- | | FRONT | 1 | REAR |
|--|--------------|----------|-------------|
| | mm. | mm. | mm. |
| | 1.89 | 15.9 | 0.63 |
| | inches | inches | inches |

Drum Brakes

- 95. Inside diameter *—* mm. *—* inches *203* mm. *8.0* inches
- 96. Length of brake linings *—* mm. *—* inches *197* mm. *7.75* inches
- 97. Width of brake linings *—* mm. *—* inches *38.1* mm. *1.5* inches
- 98. Number of shoes per brake *—* *2*
- 99. Total area per brake *—* mm.² *—* sq. in. *15,000* mm.² *23.0* sq. in.

Disc Brakes

- 100. Outside diameter *241* mm. *9.5* inches *—* mm. *—* inches
- 101. Thickness of disc *9.6* mm. *0.38* inches *—* mm. *—* inches
- 102. Length of brake linings *61.8* mm. *2.44* inches *—* mm. *—* inches
- 103. Width of brake linings *47.5* mm. *1.87* inches *—* mm. *—* inches
- 104. Number of pads per brake *2*
- 105. Total area per brake *5,612* mm.² *8.7* sq. in. *—* mm.² *—* sq. in.

ENGINE (photographs J and K)

- | | | | |
|--|----------------|--|---|
| 130. Cycle | 4 | 131. Number of cylinders | 4 |
| 132. Cylinder Arrangement | <i>In line</i> | | |
| 133. Bore <i>78-64</i> mm. <i>3-096</i> in. | | 134. Stroke <i>64-3</i> mm. <i>2-53</i> in. | |
| <i>133a. Rebore. 78-94</i> mm. <i>3-108</i> in. | | | |
| 135. Capacity per cylinder | | <i>312</i> cm. ³ <i>19-05</i> cu. in. | |
| <i>135a. Rebore.</i> | | <i>314.5</i> cm. ³ <i>19-2</i> cu. in. | |
| 136. Total cylinder capacity | | <i>1248</i> cm. ³ <i>76-2</i> cu. in. | |
| <i>136a. Rebore.</i> | | <i>1258</i> cm. ³ <i>76-8</i> cu. in. | |
| 137. Material(s) of cylinder block <i>Cast Iron</i> | | 138. Material(s) of sleeves (if fitted) — | |
| 139. Cylinder head, material(s) <i>Cast Iron</i> | | Number fitted <i>1</i> | |
| 140. Number of inlet ports <i>4</i> | | 141. Number of exhaust ports <i>4</i> | |
| 142. Compression ratio <i>9.2 : 1 ± .5</i> | | | |
| <i>142a. Rebore. 9.26 : 1 ± .5</i> | | | |
| 143. Volume of one combustion chamber | | <i>13.7 / 16.2</i> cm. ³ <i>0.84 / 0.99</i> cu. in. | |
| <i>Compressed thickness of gasket: - .97 / .89 mm.</i> | | <i>-.038 / .035 in.</i> | |
| 144. Piston, material <i>Aluminium</i> | | 145. Number of rings <i>3</i> | |
| 146. Distance from gudgeon pin centre line to highest point of piston crown | | <i>44.1 / 44.0</i> mm. <i>1.735 / 1.732</i> in. | |
| 147. Crankshaft: cast /stamped <i>Cast Iron.</i> | | 148. Type of crankshaft: integral/ <i>Yes</i> | |
| 149. Number of crankshaft main bearings <i>5</i> | | | |
| 150. Material of bearing cap <i>Cast Iron.</i> | | | |
| 151. System of lubrication: dry sump /oil in sump | | | |
| 152. Capacity, lubricant <i>4-0</i> ltrs. <i>7-0</i> pts. <i>4-22</i> quarts U.S. | | | |
| 153. Oil cooler: <i>yes</i> /no | | 154. Method of engine cooling <i>Water</i> | |
| 155. Capacity of cooling system <i>7-32</i> ltrs. <i>12-9</i> pts. <i>7-73</i> quarts U.S. | | | |
| 156. Cooling fan (if fitted) dia. <i>35-56</i> cm. <i>14-0</i> in. | | | |
| 157. Number of blades of cooling fan <i>5 - viscous coupling drive</i> | | | |

Bearings

- | | | | |
|---|--------------------|--------------------|-----|
| 158. Crankshaft main, type <i>Steel backed shell</i> | dia. <i>53-980</i> | <i>2-1252</i> | in. |
| | <i>53-962</i> | m.m. <i>2-1245</i> | |
| 159. Connecting rod big end, type <i>Steel backed shell</i> | dia. <i>50-800</i> | m.m. <i>2-0000</i> | in. |
| | <i>50-787</i> | <i>1-9995</i> | |

Weights

- | | |
|---|---|
| 160. Flywheel (clean) | <i>8-26</i> kg. <i>18-2</i> lbs. |
| | <i>7-48</i> kg. <i>16-5</i> lbs. |
| 161. Flywheel with clutch (all turning parts) | <i>13-20</i> kg. <i>29-1</i> lbs. |
| | <i>12-11</i> kg. <i>26-7</i> lbs. |
| 162. Crankshaft <i>12-61</i> kg. <i>27-8</i> lbs. | 163. Connecting rod <i>0-726</i> kg. <i>1-60</i> lbs. |
| | <i>11-43</i> kg. <i>25-2</i> lbs. <i>0-658</i> kg. <i>1-45</i> lbs. |
| 164. Piston with rings and pin | <i>0-608</i> kg. <i>1-34</i> lbs. |
| | <i>0-526</i> kg. <i>1-16</i> lbs. |

ENGINE ACCESSORIES

- 230. Fuel pump : mechanical ~~and/or electrical~~
- 231. No. fitted 1
- 232. Type of ignition system *Coil*
- 233. No. of distributors 1
- 234. No. of ignition coils 1
- 235. No. of spark plugs per cylinder 1
- 236. Generator, type : ~~dynamo~~/alternator—number fitted 1
- 237. Method of drive *Belt*
- 238. Voltage of generator *12* volts
- 239. Battery, number *1*
- 240. Location *Engine compartment*
- 241. Voltage of battery *12* volts

ENGINE AND CAR PERFORMANCES (as declared by manufacturer in catalogue)

- 250. Max. engine output *78* (type of horsepower: *Gross*) at *6,000* r.p.m.
- 251. Max. r.p.m. *6,700* output at that figure *Not available*
- 252. Max. torque *65 Lb.ft* at *4,500* r.p.m.
- 253. Max. speed of the car *147* km./hour *92* miles/hour

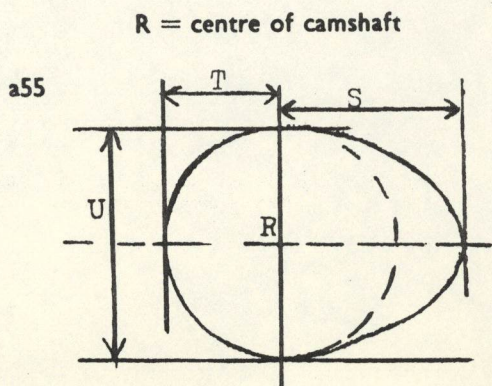

Inlet cam

S =	<i>21.9</i>	mm.	<i>0.862</i>	inches
T =	<i>14.5</i>	mm.	<i>0.572</i>	inches
U =	<i>29.1</i>	mm.	<i>1.145</i>	inches

Exhaust cam

S =	<i>21.9</i>	mm.	<i>0.862</i>	inches
T =	<i>14.5</i>	mm.	<i>0.572</i>	inches
U =	<i>29.1</i>	mm.	<i>1.145</i>	inches

DRIVE TRAIN

CLUTCH

260. Type of clutch Diaphragm 261. No. of plates 1
262. Dia. of clutch plates 19.1 cm. 7.50 ins.
263. Dia. of linings, inside 13.65 cm. 5.375 ins.
- outside 19.1 cm. 7.50 ins.
264. Method of operating clutch Cable

GEAR BOX (photograph H)

270. Manual type, make Chrysler Method of operation Manual
271. No. of gear-box ratios forward 4 272. Synchronized forward ratios 4
273. Location of gear-shift Central
274. Automatic, make Not available type —
275. No. of forward ratios — 276. Location of gear shift —

277.	Manual		Automatic		Alternative manual/automatic			
	Ratio	No. teeth	Ratio	No. teeth	Ratio	No. teeth	Ratio	No. teeth
1	3.317	$\frac{23}{16}$ $\frac{30}{13}$			3.538	$\frac{23}{15}$ $\frac{30}{13}$		
2	2.029	$\frac{23}{16}$ $\frac{24}{17}$			2.165	$\frac{23}{15}$ $\frac{24}{17}$		
3	1.366	$\frac{23}{16}$ $\frac{19}{20}$			1.387	$\frac{23}{15}$ $\frac{19}{21}$		
4	1.000	<u>Direct</u>			1.000	<u>Direct</u>		
5								
6								
reverse	3.450	$\frac{23}{16}$ $\frac{36}{15}$			3.680	$\frac{23}{15}$ $\frac{36}{15}$		

278. Overdrive, type Nil
279. Forward gears on which overdrive can be selected —
280. Overdrive ratio —

FINAL DRIVE

290. Type of final drive Hypoid 291. Type of differential 4 pinion
292. Type of limited slip differential (if fitted in series-production) 4 pinion
293. Final drive ratio 4.11 : 1 Number of teeth 37 : 9

IMPORTANT :

During the scrutineering of cars entered in group 5 (Sportscars) only the following items of the present recognition form are to be taken into consideration : 1, 2, 3, 9, 20, 21, 22, 23, 24, 25, 26, 70, 71, 78, 79, 90, 130, 131, 132, 133, 134, 135, 136, 137, 138, 139, 140, 141, 147, 148, 149, 150, 158, 159, 170, 171, 172, 173, 185, 200, 270, 271, 274, 275, 290, 291, 292 and photographs A, B, D, E, F, G, H, J, K and O.

The vehicle described in this form has been subject to the following amendments :

on.....	19.....	rec. no.....	List.....	on.....	19.....	rec. no.....	List.....
on.....	19.....	rec. no.....	List.....	on.....	19.....	rec. no.....	List.....
on.....	19.....	rec. no.....	List.....	on.....	19.....	rec. no.....	List.....
on.....	19.....	rec. no.....	List.....	on.....	19.....	rec. no.....	List.....
on.....	19.....	rec. no.....	List.....	on.....	19.....	rec. no.....	List.....

Optional equipment affecting preceding information. This to be stated together with reference number.

This vehicle is available with a Heavy Duty Specification which comprises of:-

1. Stiffer springs and dampers - no visual changes to photographs D&E.

2. Engine sump guard Part No:- 71.250.072.

Weight:- 13.8Kg 30 Lb.

Dimensions:- 70 x 54 cm.
27.5 x 21.3 in.

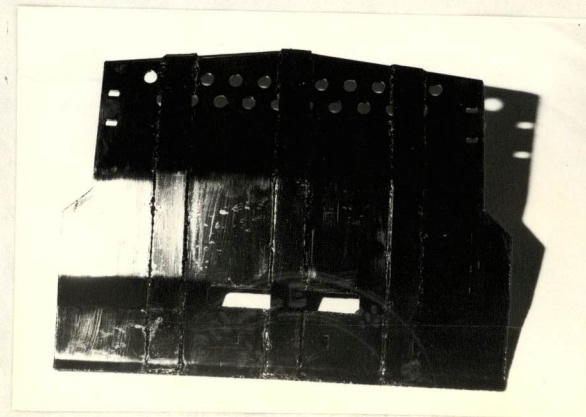



MOTOR SPORT DIVISION
The Royal Automobile Club,
31 Belgrave Square, London, S.W.1

Manufacturer *Chrysler U.K. Ltd*
Model *Hillman Avenger 1250 TC*
F.I.A. Recognition No. *5525*
Amendment No. *1/1V*

Amendment to Form of Recognition

FEDERATION INTERNATIONALE DE L'AUTOMOBILE

No.

Reference No.

3. Petrol tank guard

Part No:- 71.238.039.

Weight:- 7.6 Kg 16.7 Lb

Dimensions:- 77.5 x 54.6
x 22.9 cm.

30.5 x 21.5 x 9 in.

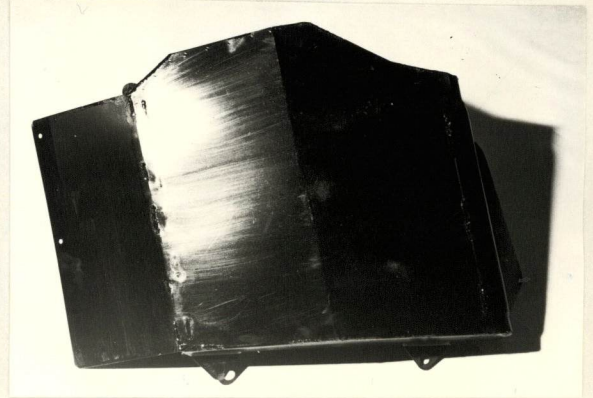

4. Turret brace - joining front suspension top mountings to bulkhead.

Part No:- 71.203.122.

Weight:- 2 Kg 4.5 Lb.

Dimensions:- 109 x 30.5 cm.
43 x 12 in.

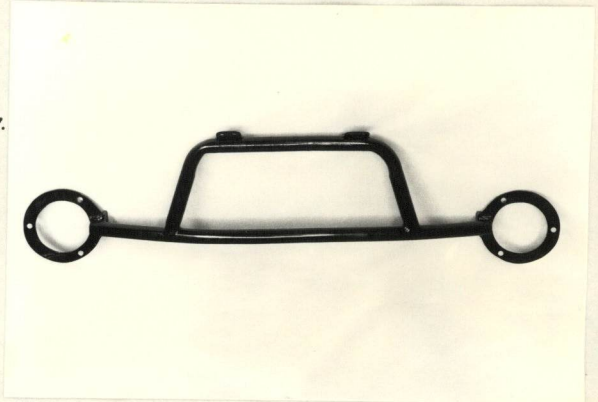

Date amendment is valid from... *19.73*



MOTOR SPORT DIVISION
The Royal Automobile Club,
31 Belgrave Square, London, S.W.1

Manufacturer *Chrysler UK Ltd.*
Model *Hillman Avenger 1250TC*
F.I.A. Recognition No. *5525*
Amendment No. *1/IV*

Amendment to Form of Recognition

FEDERATION INTERNATIONALE DE L'AUTOMOBILE

No.

Reference No.

5. Engine oil cooler (two Supply Variants)

Part No:- 71.087.504.

Weight:- 1.5 Kg 3.3 Lb.

Dimensions:- 33 x 10 x 5 cm.
13 x 4 x 2 in.



Part No:- 71.235.338.

Weight:- 2.6 Kg 5.6 Lb.

Dimensions:- 52 x 5 Dia. cm.
20.5 x 2 Dia. in.

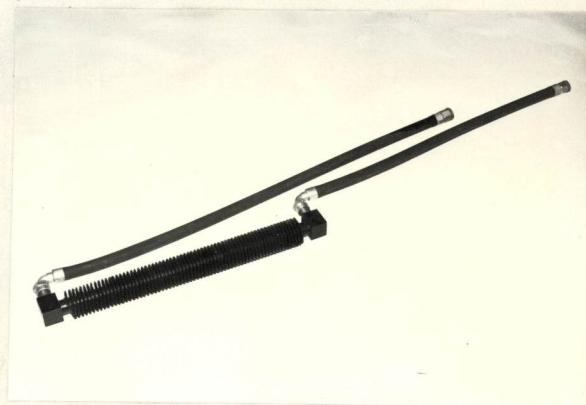

152. Capacity. lubricant. becomes:-

4.25 ltrs.

7.5 pts.

4.5 quarts U.S.

*In certain territories (where motorways are not predominant)
the following final drive ratio is fitted:-*

293 Final drive ratio:- 4.375 : 1.

35 : 8 teeth.

Date amendment is valid from *1.9.73*

Stamp of F.I.A./R.A.C.



MOTOR SPORT DIVISION
The Royal Automobile Club,
31 Belgrave Square, London, S.W.1

Manufacturer *Chrysler U.K. Ltd.*
Model *Hillman Avenger 1250cc*
F.I.A. Recognition No. *5525*
Amendment No. *3/3V*

Amendment to Form of Recognition

FEDERATION INTERNATIONALE DE L'AUTOMOBILE

No.

Reference No.

In accordance with Chrysler policy, this vehicle is marketed in certain territories under the following

names:-
Sunbeam
Plymouth
Dodge

Date amendment is valid from *1973*

Stamp of F.I.A./R.A.C.



MOTOR SPORT DIVISION
The Royal Automobile Club,
31 Belgrave Square, London, S.W.1

Manufacturer *Chrysler U.K. Ltd.*
Model *Hillman Avenger 1250 TC*
F.I.A. Recognition No. *5525*
Amendment No. *4/1E*

Amendment to Form of Recognition

FEDERATION INTERNATIONALE DE L'AUTOMOBILE

No.

Reference No. Normal Evolution

The specification of the revised Avenger 1250 TC, including all options etc is identical to the superseded Avenger 1250 TC except for the following items:-

I

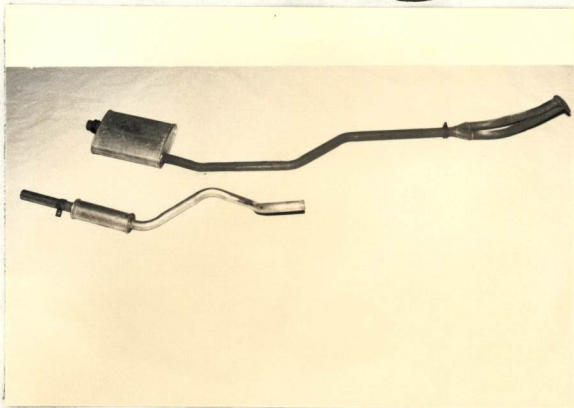

K

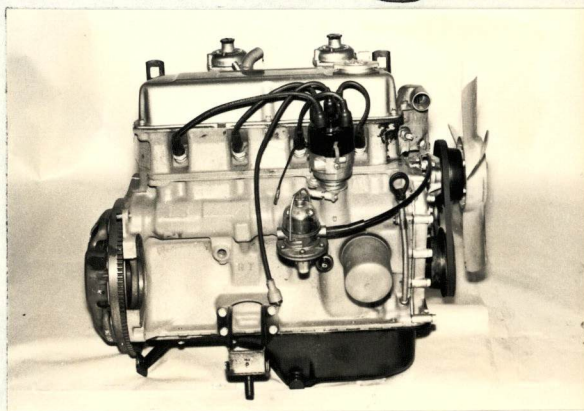
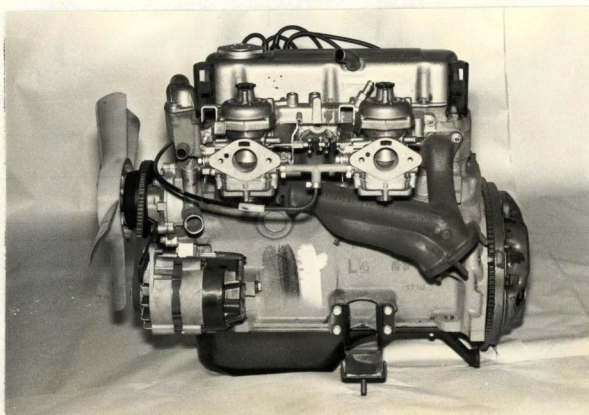

J

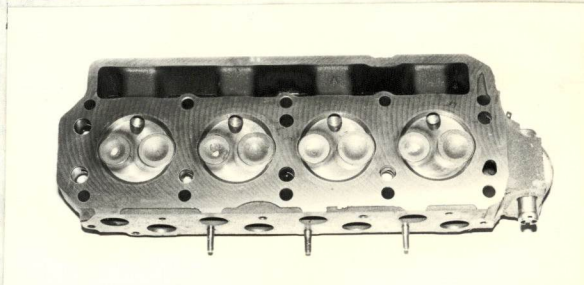

L



M

Date amendment is valid from 1.6.76

Stamp of F.I.A./R.A.C.

[Handwritten signature]



MOTOR SPORT DIVISION
The Royal Automobile Club,
31 Belgrave Square, London, S.W.1

Manufacturer *Chrysler UK Ltd*
Model *Hillman Avenger 1250 TC*
F.I.A. Recognition No. *5525*
Amendment No. *h/1E*

Amendment to Form of Recognition

FEDERATION INTERNATIONALE DE L'AUTOMOBILE

No. Reference No. *Normal Evolution cont'd*

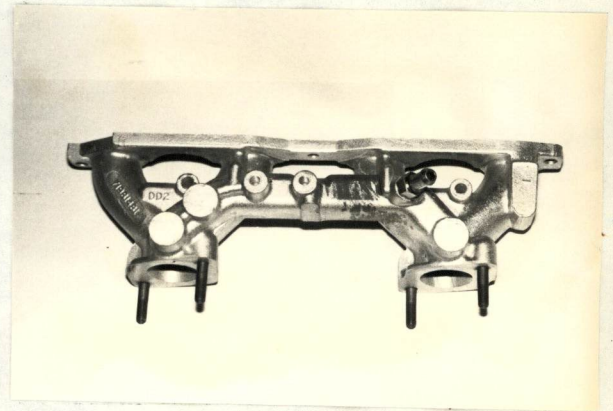
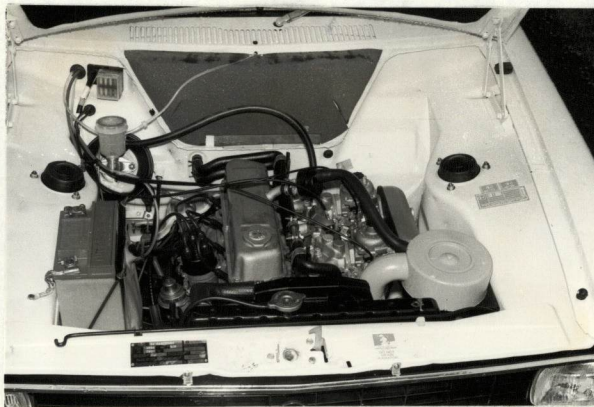

Inlet Manifold
Ports

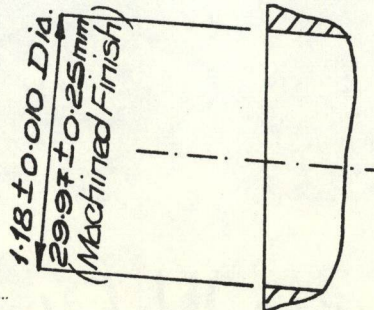
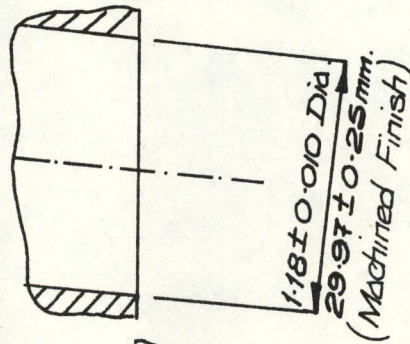

Inlet part of cylinder
head

Date amendment is valid from

Stamp of F.I.A./R.A.C.



MOTOR SPORT DIVISION
The Royal Automobile Club,
31 Belgrave Square, London, S.W.1

Manufacturer Chrysler UK Ltd
Model Hillman Avenger 1250 TC
F.I.A. Recognition No. 5525
Amendment No. h/1E

Amendment to Form of Recognition

FEDERATION INTERNATIONALE DE L'AUTOMOBILE

No.	Reference No.	<u>Normal Evolution cont'd</u>	
133.	Bore:-	3.100 in.	78.72 mm.
133a.	Overbore:-	Not possible.	
134	Stroke:-	2.625 in.	66.67 mm.
135	Capacity per cylinder:-	19.75 in ³	323.8 cc.
136	Total cylinder capacity:-	79.0 in ³	1,295 cc.
142	Compression ratio:-	8.6 : 1 ± 0.5	
143	Volume of one combustion chamber:-	16.1 17.3 cm ³	0.98 1.06 in ³
143a.	Compressed thickness of gasket:-	0.97 0.89 mm.	0.038 0.035 in.
250	Max engine output:-	79 BHP gross @	5800 RPM.
252	Max torque:-	68 lbf.ft. @	4,000. RPM.
253	Max speed of car:-	95 MPH.	151 KPH.
160.	Flywheel weight (clean):-	17.3 15.6 Lb.	7.82 7.09 Kg
161.	Flywheel with clutch weight:-	28.3 25.6 Lb.	12.81 11.62 Kg
162	Crankshaft weight:-	25.4 23.0 Lb.	11.52 10.44 Kg
163.	Connecting rod weight:-	1.70 1.54 Lb.	0.771 0.699 Kg
164.	Piston, rings & pin weight:-	1.24 1.12 Lb.	0.562 0.509 Kg

Date amendment is valid from

Stamp of F.I.A./R.A.C.



MOTOR SPORT DIVISION
The Royal Automobile Club,
31 Belgrave Square, London, S.W.1

Manufacturer *Chrysler UK Ltd*
Model *Hillman Avenger 1250 TC*
F.I.A. Recognition No. *5525*
Amendment No. *5/hV*

Amendment to Form of Recognition

FEDERATION INTERNATIONALE DE L'AUTOMOBILE

No. Reference No. *Production Variant - Avenger 1300 GT*

The specification of the Avenger 1300 GT, including all options etc., is identical to the revised Avenger 1250 TC except for the following items:-

A



Date amendment is valid from *1.6.76*

Stamp of F.I.A./R.A.C.



MOTOR SPORT DIVISION
The Royal Automobile Club,
31 Belgrave Square, London, S.W.1

Manufacturer *Chrysler U.K. Ltd*
Model *Hillman Avenger 1250 TC*
F.I.A. Recognition No. *5525*
Amendment No. *5/4V*

Amendment to Form of Recognition

FEDERATION INTERNATIONALE DE L'AUTOMOBILE

No. Reference No. *Avenger 1300 GT cont'd*



9.	Weight:-	830 kg	1830 Lb.	16.35 cwt.
2.	Front track:-	50.8 in.		1290 mm.
3.	Rear track:-	51.1 in.		1300 mm.
24.	Number of doors:-	2		
42.	Weight of front seat:-	12.3 kg	27 Lb.	
51.	Wheel weight:-	6.1 kg	13.5 Lb.	
54.	Rim width:-	127 mm.	5.0 in.	

Date amendment is valid from

Stamp of F.I.A./R.A.C.



MOTOR SPORT DIVISION
The Royal Automobile Club
 31 Belgrave Square, London SW1X 8QH

Manufacturer *Chrysler UK Ltd*
 Model *Hillman Avenger 1250cc*
 F.I.A. Recognition No. *5525*
 Amendment No. *615V*

Amendment to Form of Recognition

FEDERATION INTERNATIONALE DE L'AUTOMOBILE

Production Variant

No.

Reference No.

I

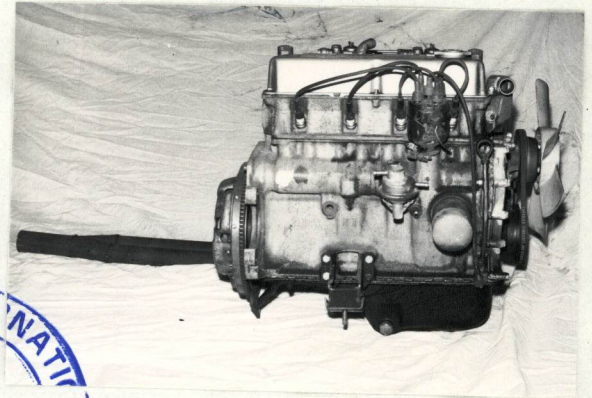
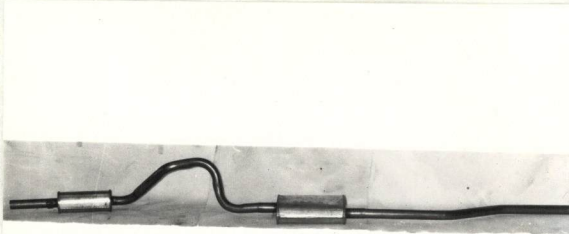

K

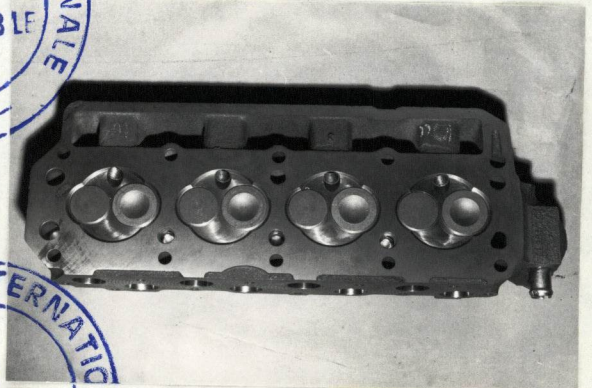
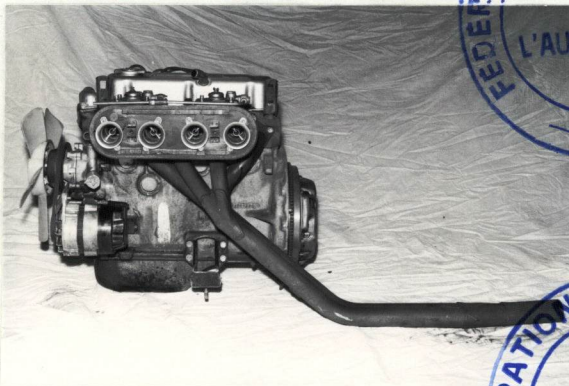

N

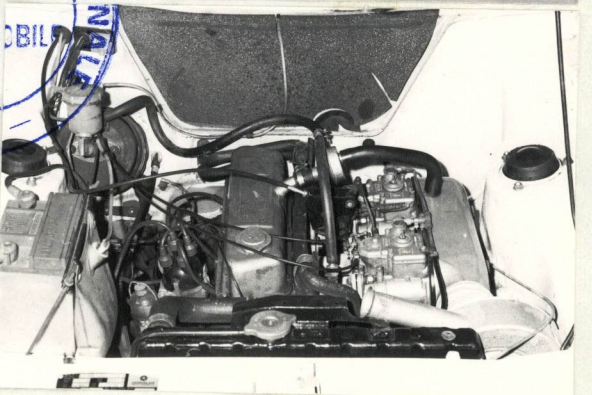
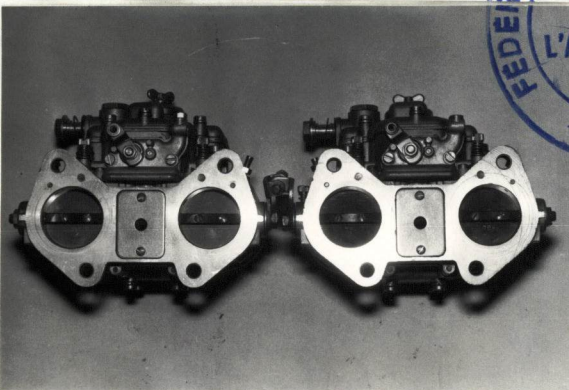

Date amendment is valid from *1.10.75*



Stamp of F.I.A./R.A.C.



MOTOR SPORT DIVISION
The Royal Automobile Club
31 Belgrave Square, London SW1X 8QH

Manufacturer Chrysler UK Ltd
 Model Hillman Avenger 1250cc
 F.I.A. Recognition No. 5525
 Amendment No. 615V

Amendment to Form of Recognition

FEDERATION INTERNATIONALE DE L'AUTOMOBILE

Production Variant - cont'd.

No.

Reference No.

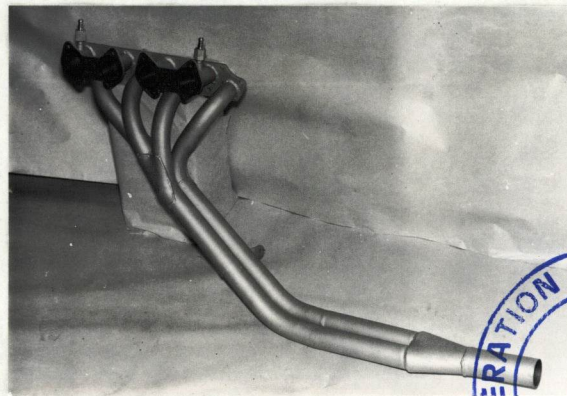

PQ

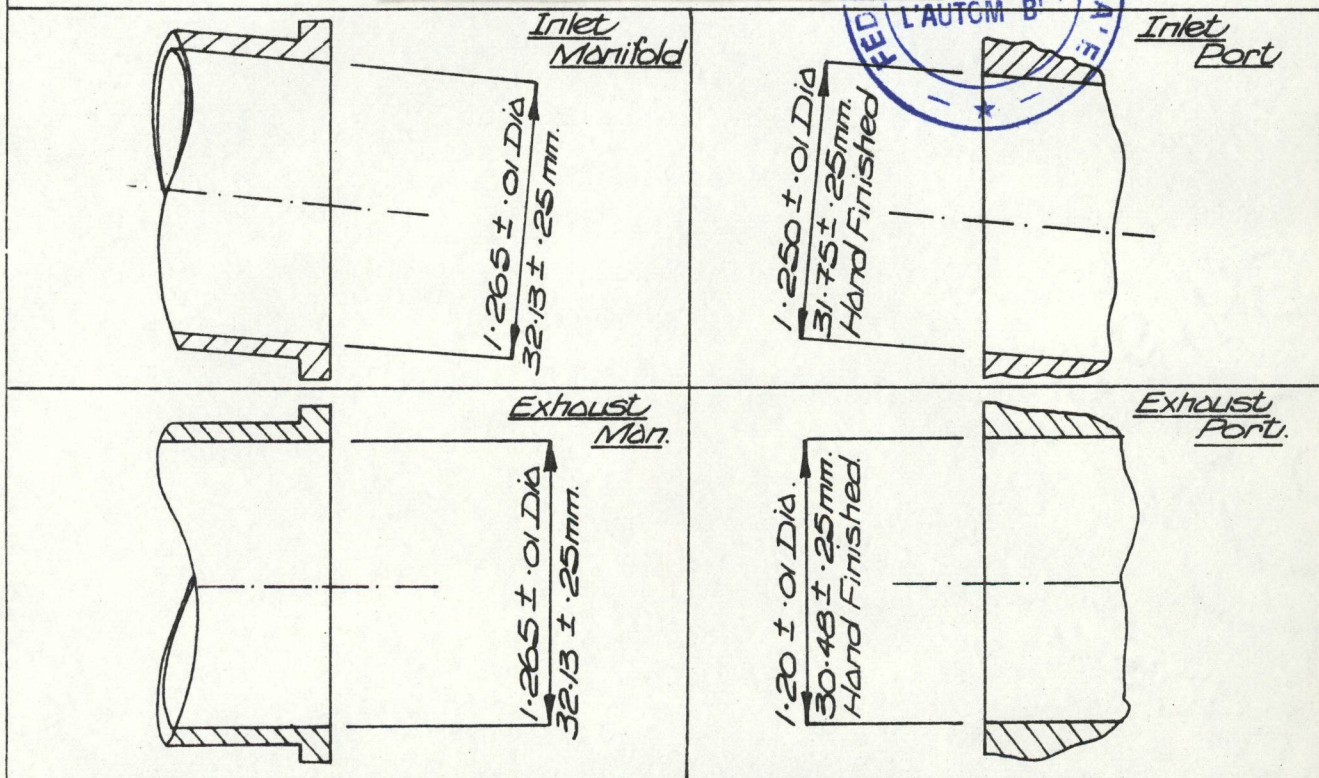

Date amendment is valid from.....



Stamp of F.I.A./R.A.C.



MOTOR SPORT DIVISION
The Royal Automobile Club
31 Belgrave Square, London SW1X 8QH

Manufacturer Chrysler UK Ltd
 Model Hillman Avenger 1250TC
 F.I.A. Recognition No. 3525
 Amendment No. 6/5V

Amendment to Form of Recognition

FEDERATION INTERNATIONALE DE L'AUTOMOBILE

Production Variant - Cont'd

No.	Reference No.		
142.	Compression ratio:-	9.4 : 1 ± .5	
143.	Combustion chamber vol:-	18.8 17.1 cc	1.15 1.04 c.in
180.	Matl. of inlet manifold:-	steel.	
181.	Dia. of inlet valves:-	38.23 37.97 mm.	1.505 in. 1.495 in.
182.	Max inlet valve lift:-	10.24 mm.	.403 in.
187.	Inlet valves open:-	64° BTDC	
188.	Inlet valves close:-	91° ABDC	
195.	Matl. of exhaust manifold:-	steel	
196.	Dia. of exhaust valves:-	unchanged	
197.	Max valve lift:-	10.08 mm.	.397 in.
202.	Exhaust valves open:-	74° BBDC.	
203.	Exhaust valves close:-	46° ATDC.	
204.	Exhaust manifold outlet:-	48.26 mm.	1.90 in.
212.	Make of carburettors:-	Weber	
213.	Model:-	40 DCOE	
214.	No. mixture passages:-	2	
215.	Flange hole dia at exit:-	40 mm.	1.575 in.
216.	Min. dia. venturi:-	30 mm.	
250.	Max engine output:-	95 BHP Gross @ 6,250 RPM.	
251.	Max R.P.M.:-	7,000, output not available.	
252.	Max torque:-	70 Lb.ft. @ 4,500 RPM.	
253.	Max speed of car:-	100 MPH. 160 KPH.	
256.	Vol. combustion chamber in head:-	12.9 12.3 cc.	.79 .75 c.in.
	Inlet and exhaust cams:-		
	S:-	21.59 mm.	.850 in.
		21.46 mm.	.845 in.
	T:-	14.61 mm.	.575 in.
		14.48 mm.	.570 in.
	L:-	29.46 mm.	1.160 in.
		29.21 mm.	1.150 in.

Date amendment is valid from.....

Stamp of F.I.A./R.A.C.





MOTOR SPORT DIVISION
The Royal Automobile Club
31 Belgrave Square, London SW1X 8QH

Manufacturer Chrysler UK Ltd
 Model Hillman Avenger 1250cc
 F.I.A. Recognition No. 5525
 Amendment No. 716V

Amendment to Form of Recognition

FEDERATION INTERNATIONALE DE L'AUTOMOBILE

Optional Equipment

- | No. | Reference No. |
|-----|--|
| | <i>Alternative roadwheel</i> |
| 2. | <i>Front track: - 1.333.5 ± 6mm.
52.5 ± .25in.</i> |
| 3. | <i>Rear track: - 1.341 ± 6mm.
52.8 ± .25in.</i> |
| 50. | <i>Wheel type: - Aluminium diecast.</i> |
| 51. | <i>Weight: - 5.2kg. 11.5lb.</i> |
| 54. | <i>Rim width: - 140mm. 5.5in.</i> |
| | <i>Part no. (kit): - 72.270.036</i> |
| | <i>Steering unit</i> |
| 62. | <i>No. turns lock to lock: - 2-3.</i> |
| | <i>Part no: - 71.203.215 RHD.
71.203.233 LHD.</i> |

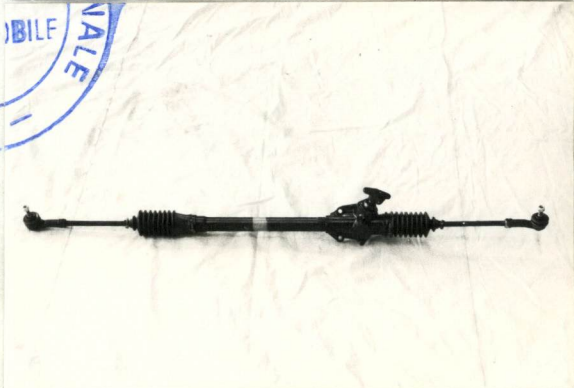

Date amendment is valid from 1.10.75

Stamp of F.I.A./R.A.C.



MOTOR SPORT DIVISION
The Royal Automobile Club
31 Belgrave Square, London SW1X 8QH

Manufacturer Chrysler UK Ltd
 Model Hillman Avenger 1250cc
 F.I.A. Recognition No. 5525
 Amendment No. 817V

Amendment to Form of Recognition

FEDERATION INTERNATIONALE DE L'AUTOMOBILE

Supply Variant - alternative supplier.

No.	Reference No.			
	<i>Rear brake assembly.</i>			
94.	<i>Bore of wheel cylinder:-</i>		<i>17.46mm.</i>	<i>0.6875 in.</i>

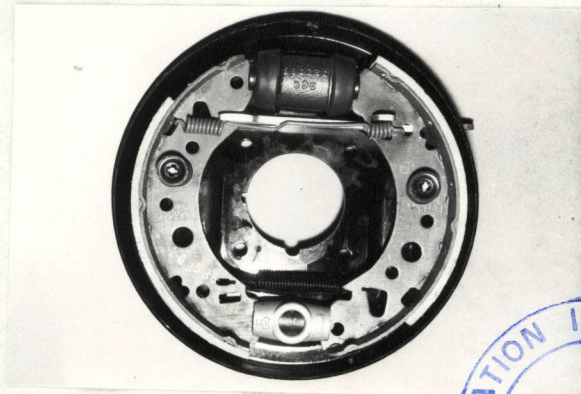

Date amendment is valid from 1.10.75

Stamp of F.I.A./R.A.C.



MOTOR SPORT DIVISION
The Royal Automobile Club
31 Belgrave Square, London SW1X 8QH

Manufacturer Chrysler U.K. Ltd
 Model Hillman Avenger 1250TC
 F.I.A. Recognition No. 5525
 Amendment No. 9/8V

Amendment to Form of Recognition

FEDERATION INTERNATIONALE DE L'AUTOMOBILE

No. Reference No. Normal evolution

*Certain export territories [to commonise with larger
 engined Avenger produced locally] - replaces ratios
 quoted as "Alternative manual" on Page 11.*

277.

	<i>Gearbox ratios</i>	<i>No. teeth.</i>
1	2.796	31 15
2	1.729	23 18
3	1.285	19 20
4	1.000	23 17
Reverse	3.247	36 15

Date amendment is valid from

1.10.75

Stamp of F.I.A. R.A.C.





MOTOR SPORT DIVISION
The Royal Automobile Club
31 Belgrave Square, London SW1X 8QH

Manufacturer Chrysler UK Ltd
 Model Averger 1250 TC
 F.I.A. Recognition No. 5525
 Amendment No. 10/2E

Amendment to Form of Recognition

FEDERATION INTERNATIONALE DE L'AUTOMOBILE

VALID IN GROUP1.....

No.

Reference No. Averger 1300 GT

Evolutionary change - revised front & rear styling, fascia, interior trim and listed mechanical features.



Date amendment is valid from 1 JAN 1977

Stamp of F.I.A./R.A.C.



MOTOR SPORT DIVISION
The Royal Automobile Club
 31 Belgrave Square, London SW1X 8QH

Manufacturer Chrysler UK Ltd
 Model Avengeur 1250 TC
 F.I.A. Recognition No. 5525
 Amendment No. 10/2E

Amendment to Form of Recognition

FEDERATION INTERNATIONALE DE L'AUTOMOBILE

VALID IN GROUP.....1.....

No.	Reference No.		
	<u>Avengeur 1300GT cont'd.</u>		
4	Overall length :-	414.4 cm.	163.1 in.
5	Overall width :-	161.5 cm.	63.6 in.
41.	Front seats :-	Brush nylon on rubber diaphragm - reclining.	
43.	Rear seats :-	Brush nylon on spring case.	
142. *	Compression ratio :-	10.0 ± .5 : 1	
156.	Cooling fan dia :-	25.4 cm.	10.0 in } except
157.	Number of blades :-	4 - electrically driven } H. Duty.	
250. *	Max. engine output :-	95 BHP Gross @ 6,000 RPM.	
252. *	Max torque :-	70 LB. FT @ 4,300 RPM.	
*	Applies to Weber carburettor engine specification only - Production Variant - ref. amendment no. 6/5v.		

Date amendment is valid from.....

20FS

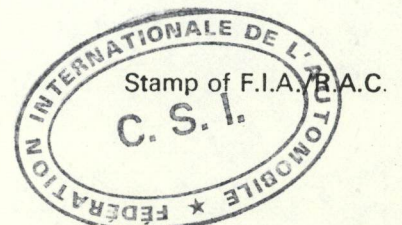



MOTOR SPORT DIVISION
The Royal Automobile Club
31 Belgrave Square, London SW1X 8QH

Manufacturer Chrysler UK Ltd
 Model Avengeur 1250 TC
 F.I.A. Recognition No. 5525
 Amendment No. M/3E

Amendment to Form of Recognition

FEDERATION INTERNATIONALE DE L'AUTOMOBILE

VALID IN GROUP 1.....

No.

Reference No. Heavy Duty Specification.

The following additional items are now included in the Heavy Duty specification:-

- Turret brace - front suspension top mountings to bulkhead.

Weight:- 6 Lb. 2.7 Kg

Part no:- 71.203.127.

Note:- replaces part no. 71.238.039 when dual braking master cylinder is fitted.

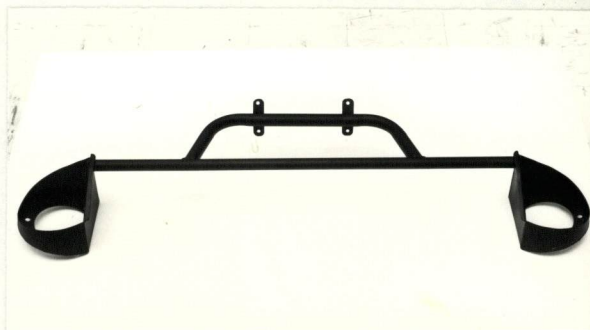

- Heavy duty axle - increased tube thickness and retaining pins.

Part no:- 71.203.135

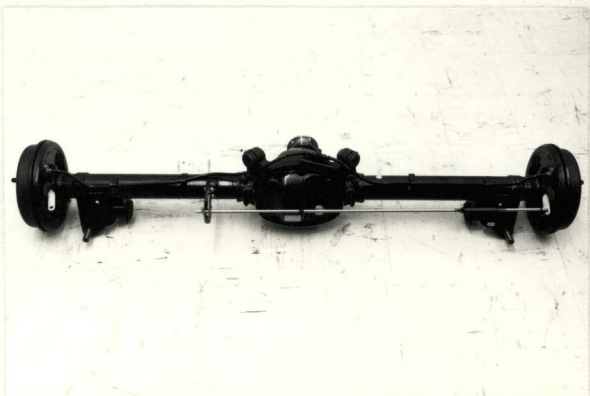

- Rear suspension bottom link.

Part no:- 71.203.214.



Date amendment is valid from -1. JAN 1977





MOTOR SPORT DIVISION
The Royal Automobile Club
31 Belgrave Square, London SW1X 8QH

Manufacturer Chrysler UK Ltd.
 Model Avenor 1250 TC
 F.I.A. Recognition No. 5525
 Amendment No. M13E

Amendment to Form of Recognition

FEDERATION INTERNATIONALE DE L'AUTOMOBILE

VALID IN GROUP1.....

No.

Reference No. Heavy Duty Specification cont'd.
4. Front suspension crossmember
 Part no:- 71.203.247.



Date amendment is valid from.....



Stamp of F.I.A./R.A.C.



MOTOR SPORT DIVISION
The Royal Automobile Club
31 Belgrave Square, London SW1X 8QH

Manufacturer Chrysler UK Ltd
 Model Aventor 1250 TC
 F.I.A. Recognition No. 5525
 Amendment No. 1219V

Amendment to Form of Recognition

FEDERATION INTERNATIONALE DE L'AUTOMOBILE

VALID IN GROUP.....1.....

No.

Reference No. Production Variant - part of the basic specification in certain territories.

1. Hot climate radiator
 Part no:- 71.203.128.



2. Larger capacity fuel tank
 Capacity of fuel tank:-
 63.6 lbs. 16.8 gall. U.S. 14 gall. Imp.
 Part no:- 71.203.109.



7.

3. Dual braking system - to comply with legislative requirements
 No. hydraulic master cylinders:- 2.
 Part no. master cyl./servo assembly:- 75061181/75061177 R.H.
 75061153 L.H.

92.

4. Axle ratio
 Final drive ratio:- 3.89 : 1.

293.

No. of teeth 35 : 9.



-1. JAN. 1977

Date amendment is valid from.....

5 OF 5.

Stamp of F.I.A./R.A.C.



MOTOR SPORT DIVISION
The Royal Automobile Club
31 Belgrave Square, London SW1X 8QH

Manufacturer *Chrysler UK Ltd*
 Model *Avenger 1250 TC*
 F.I.A. Recognition No. *5525*
 Amendment No. *13/4E*

Amendment to Form of Recognition

FEDERATION INTERNATIONALE DE L'AUTOMOBILE

VALID IN GROUP.....1.....

No. Reference No. *Avenger 1300 GT*
Normal Evolutionary Change - rationalisation and ease of production.

277.	1 ST Gear.	2.675	$\frac{30}{13} \times \frac{22}{19}$	supercedes	2.796	$\frac{31}{15} \times \frac{23}{17}$
	2 ND Gear.	1.634	$\frac{24}{17} \times \frac{22}{19}$	"	1.729	$\frac{23}{18} \times \frac{23}{17}$
	3 RD Gear.	1.280	$\frac{21}{19} \times \frac{22}{19}$	"	1.285	$\frac{19}{20} \times \frac{23}{17}$
	4 TH Gear	1.000	Direct	"	1.000	Direct
	Reverse	2.779	$\frac{36}{15} \times \frac{22}{19}$	"	3.247	$\frac{36}{15} \times \frac{23}{17}$

Date amendment is valid from *1.4.77*

Stamp of F.I.A./R.A.C.





MOTOR SPORT DIVISION
The Royal Automobile Club
31 Belgrave Square, London SW1X 8QH

Manufacturer *Chrysler UK Ltd*
 Model *Avenger 1300GT*
 F.I.A. Recognition No. *5525*
 Amendment No. *14/10V*

Amendment to Form of Recognition

FEDERATION INTERNATIONALE DE L'AUTOMOBILE

VALID IN GROUP 1

No.

Reference No.

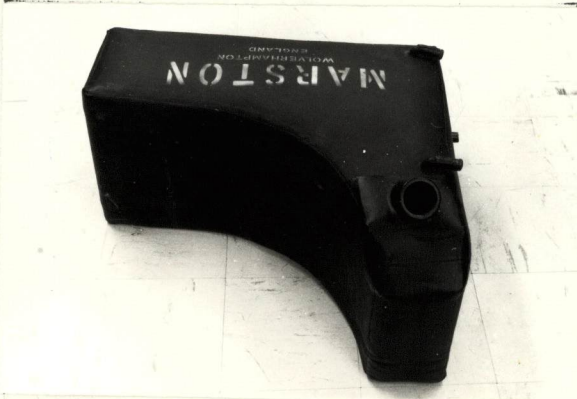

Safety fuel tank. FIA-FT3.
7. Capacity :- 63.6 litres.
16.8 galls U.S.
14 galls Imp.
Manufactured by:-
Marston Excelsior Ltd.
Part no:- CTS 3130



42.

Weight of seat, with subframes, without optional headrest shown.

Fixed back:- 23 Lbs. 10.4 kg

Recliner:- 28 Lbs. 12.7 kg

Reference:- Chrysler Sports Seat - Fixed back - part no:- CTS 3317.

" " " - recliner - " :- CTS 3318.

Note:- subframes are interchangeable, to suit particular needs of occupants.

Date amendment is valid from *1.7.77*



[Signature]
 Stamp of F.I.A./R.A.C.



MOTOR SPORT DIVISION
The Royal Automobile Club
 31 Belgrave Square, London SW1X 8QH

Manufacturer Chrysler UK Ltd
 Model Hillman Avenger 1250TC
 F.I.A. Recognition No. 5525
 Amendment No. 15 / 5 E

Amendment to Form of Recognition

FEDERATION INTERNATIONALE DE L'AUTOMOBILE

VALID IN GROUP.....1.....

- No. Reference No. Evolutionary change - Normal
1. *Revised aircleaner assembly with Weber carburettors - ref. photo 1*
 2. *Front track increased by 1.0 in. 25.4 mm.*
 3. *Front strut assy - stub reinforcements added to Heavy Duty specification - ref. photo. 2.*
 4. *Heavy Duty track rod ends added to specification. Part no:- 75.062.052. Ref. photo 3.*

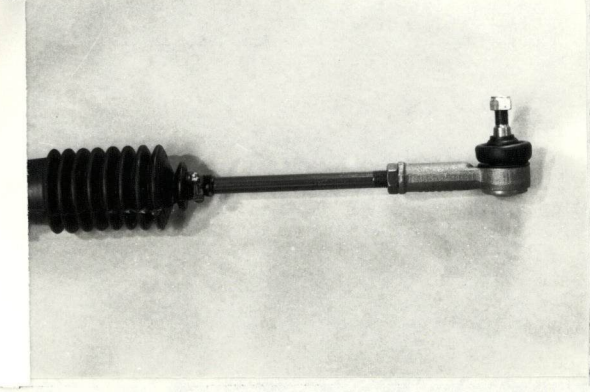
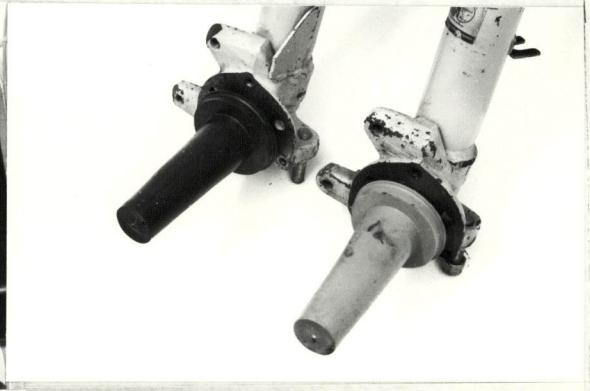
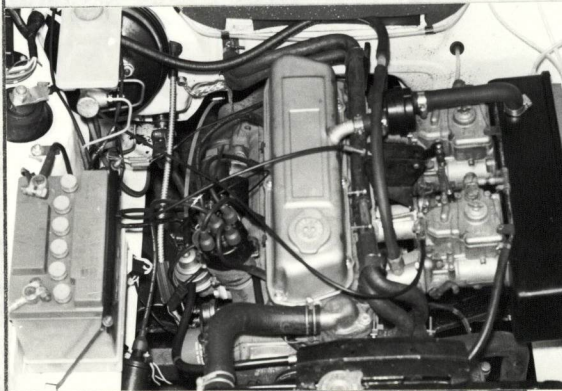

Date amendment is valid from.....-1. AVR. 1978.....

Stamp of F.I.A./R.A.C.





MOTOR SPORT DIVISION
The Royal Automobile Club
31 Belgrave Square, London SW1X 8QH

Manufacturer TALBOT
 Model AVENGER 1300GT
 F.I.A. Recognition No. 5525
 Amendment No. 16/06E

Amendment to Form of Recognition

FEDERATION INTERNATIONALE DE L'AUTOMOBILE

VALID IN GROUP.....1.....

No.

Reference No.

1.

EVOLUTIONARY CHANGE —

**MANUFACTURER'S NAME NOW 'TALBOT' WAS
 'CHRYSLER'**

