



# FEDERATION INTERNATIONALE DU SPORT AUTOMOBILE

Homologation N°

A - 5097

Groupe **A/B**  
Group

FICHE D'HOMOLOGATION CONFORME A L'ANNEXE J DU CODE SPORTIF INTERNATIONAL  
HOMOLOGATION FORM IN ACCORDANCE WITH APPENDIX J OF THE INTERNATIONAL SPORTING CODE

Homologation valable à partir du  
Homologation valid as from

- 1 JAN. 1983

en groupe  
in group A

Photo A

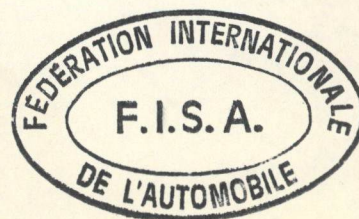

Photo B



## 1. DEFINITIONS / DEFINITIONS

101. Constructeur  
Manufacturer FORD
102. Dénomination(s) commerciale(s) — Modèle et type  
Commercial name(s) — Type and model Escort RS 1600i
103. Cylindrée totale  
Cylinder capacity 1597 cm<sup>3</sup>
104. Mode de construction  
Type of car construction  
 séparée, matériau du châssis  
separate, material of chassis Steel  
 monocoque  
unitary construction
105. Nombre de volumes  
Number of volumes 2
106. Nombre de places  
Number of places 4



Marque FORD Modèle Escort RS 1600i N° Homol. A-5097  
 Make \_\_\_\_\_ Model \_\_\_\_\_

**2. DIMENSIONS, POIDS / DIMENSIONS, WEIGHT**

**202. Longueur hors-tout** 4065 mm ± 1%  
**Overall length** \_\_\_\_\_

**203. Largeur hors-tout** 1645 mm ± 1% Endroit de la mesure At rear axle  
**Overall width** \_\_\_\_\_ Where measured \_\_\_\_\_

**204. Largeur de la carrosserie:**  
**Width of bodywork:**

a) A la hauteur de l'axe AV 1615 mm ± 1%  
 At front axle \_\_\_\_\_

b) A la hauteur de l'axe AR 1645 mm ± 1%  
 At rear axle \_\_\_\_\_

**206. Empattement:** a) Droit 2395 mm ± 1%  
**Wheelbase:** Right \_\_\_\_\_

b) Gauche: 2395 mm ± 1%  
 Left: \_\_\_\_\_

**209. Porte-à-faux:** a) AV: 755 mm ± 1%  
**Overhang:** Front: \_\_\_\_\_

b) AR: 915 mm ± 1%  
 Rear: \_\_\_\_\_

**210. Distance «G» (volant — paroi de séparation AR)** 1530 mm ± 1%  
**Distance «G» (steering wheel — rear bulkhead)** \_\_\_\_\_

**3. MOTEUR / ENGINE:** (En cas de moteur rotatif, voir Article 335 sur fiche complémentaire).  
 (In case of rotative engine, see Article 335 on complementary form)

**301. Emplacement et position du moteur:** Front, transverse, vertical  
**Location and position of the engine:** \_\_\_\_\_

**303. Cycle** 4  
**Cycle** \_\_\_\_\_

**304. Suralimentation** /non; type \_\_\_\_\_  
**Supercharging** /no; type \_\_\_\_\_  
 (En cas de suralimentation, voir également l'Article 334 sur fiche complémentaire)  
 (In case of supercharging, see also Article 334 on complementary form)

**305. Nombre et disposition des cylindres** 4 in line  
**Number and layout of the cylinders** \_\_\_\_\_

**306. Mode de refroidissement** Liquid  
**Cooling system** \_\_\_\_\_

**307. Cylindrée:** a) Unitaire 399,25 cm<sup>3</sup> b) Totale 1597 cm<sup>3</sup>  
**Cylinder capacity:** a) Unitary \_\_\_\_\_ b) Total \_\_\_\_\_

c) Totale maximum autorisée\* 1599,9 cm<sup>3</sup> \*(Cette indication n'est pas à considérer en Gr. N)  
 c) Maximum total allowed\* \_\_\_\_\_ \*(This indication is not to be considered in Gr. N)



Marque FORD Modèle Escort RS 1600i N° Homol. A-5097  
Make \_\_\_\_\_ Model \_\_\_\_\_

312. Matériau du bloc-cylindres Cast iron  
Cylinder block material \_\_\_\_\_

313. Chemises: a) /non c) Type:  
Sleeves: /no Type: \_\_\_\_\_

314. Alésage 80,0 mm  
Bore \_\_\_\_\_

315. Alésage maximum autorisé 80,03 mm (Cette indication n'est pas à considérer en Gr N)  
Maximum bore allowed \_\_\_\_\_ (This indication is not to be considered in Gr N)

316. Course 79,5 mm  
Stroke \_\_\_\_\_

318. Bielle: a) Matériau Steel b) Type de la tête de bielle Split  
Connecting rod: Material \_\_\_\_\_ Big end type \_\_\_\_\_

c) Diamètre intérieur de la tête de bielle (sans coussinets): 50,9 mm  $\pm 0,1\%$   
Interior diameter of the big end (without bearings): \_\_\_\_\_

d) Longueur entre axes: 131,9 mm ( $\pm 0,1$  mm) e) Poids minimum: 580 g  
Length between the axes: \_\_\_\_\_ Minimum weight: \_\_\_\_\_

319. Vilebrequin: a) Type de construction One piece  
Crankshaft: Type of manufacture \_\_\_\_\_

b) Matériau Cast iron  
Material \_\_\_\_\_

c)  coulé  estampé  
 moulded  stamped

d) Nombre de paliers 5  
Number of bearings \_\_\_\_\_

e) Type de paliers Smooth  
Type of bearings \_\_\_\_\_

f) Diamètre des paliers 62,3 mm  $\pm 0,2\%$   
Diameter of bearings \_\_\_\_\_

g) Matériau des chapeaux des paliers Cast iron  
Bearing caps material \_\_\_\_\_

h) Poids minimum du vilebrequin nu 12000 g  
Minimum weight of the bare crankshaft \_\_\_\_\_

320. Volant moteur: a) Matériau Cast iron  
Flywheel: Material \_\_\_\_\_

b) Poids minimum avec couronne de démarreur 6500 g  
Minimum weight of the flywheel with starter ring \_\_\_\_\_

321. Culasse: a) Nombre de culasses 1 b) Matériau Aluminium alloy  
Cylinderhead: Number of cylinderheads \_\_\_\_\_ Material \_\_\_\_\_

323. Alimentation par carburateur(s): a) Nombre de carburateurs \_\_\_\_\_  
Fuel feed by carburettor(s): Number of carburetors \_\_\_\_\_

b) Type \_\_\_\_\_ c) Marque et modèle \_\_\_\_\_  
Type \_\_\_\_\_ Make and model \_\_\_\_\_

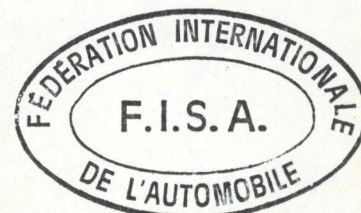

Marque FORD Modèle Escort RS 1600i N° Homol. A-5097  
 Make \_\_\_\_\_ Model \_\_\_\_\_

- d) Nombre de passages de gaz par carburateur  
 Number of mixture passages per carburettor \_\_\_\_\_
- e) Diamètre maximum de la tubulure de gaz à la sortie du carburateur  
 Maximum diameter of the flange hole of the carburettor exit port \_\_\_\_\_ mm
- f) Diamètre du diffuseur au point d'étranglement maximum  
 Diameter of the venturi at the narrowest point \_\_\_\_\_ mm

**324. Alimentation par injection:**

**Fuel feed by injection:**

a) Marque: Bosch  
 Manufacturer: \_\_\_\_\_

b) Modèle du système d'injection: K jetronic  
 Model of injection system: \_\_\_\_\_

c) Mode de dosage du carburant:  mécanique  électronique  hydraulique  
 Kind of fuel measurement:  mechanical  electronical  hydraulical

c1) Plongeur non c2) Mesure du volume d'air non  
 Piston pump no Measurement of air volume no

c3) Mesure de la masse d'air oui c4) Mesure de la vitesse de l'air non  
 Measurement of air mass yes Measurement of air speed no

c5) Mesure de la pression d'air non Quelle est la pression de réglage?  
 Measurement of air pressure no Which pressure is taken for measurement? \_\_\_\_\_ bars

d) Dimensions effectives du point de mesure au(x) papillon(s) ou au(x) tiroir(s) d'étranglement  
 Effective dimensions of measure position in the throttle area 55 mm

e) Nombre des sorties effectives de carburant 5 (including cold start)  
 Number of effective fuel outlets \_\_\_\_\_

f) Position des soupapes d'injection:  Canal d'admission  Culasse  
 Position of injection valves:  Inlet manifold  Cylinderhead

g) Parties du système d'injection servant au dosage du carburant  
 Statement of fuel measuring parts of injection system Fuel pump; metering head;  
injectors.

**325. Arbre à cames:**

a) Nombre 1 b) Emplacement In cylinder head  
 Camshaft: Number \_\_\_\_\_ Location \_\_\_\_\_

c) Système d'entraînement Notched belt d) Nombre de paliers par arbre 5  
 Driving system \_\_\_\_\_ Number of bearings for each shaft \_\_\_\_\_

f) Système de commande des soupapes Oscillating lever  
 Type of valve operation \_\_\_\_\_

**326. Distribution:**

e) Levée maximum des soupapes Admission 11,2 mm Echappement 11,3 mm  
 Timing: Maximum valve lift Inlet \_\_\_\_\_ mm Exhaust \_\_\_\_\_ mm  
 avec jeu de with clearance 0,3 mm 0,35 mm

**327. Admission:**

a) Matériau du collecteur Aluminium alloy  
 Inlet: Material of the manifold \_\_\_\_\_

b) Nombre d'éléments du collecteur 1 c) Nombre de soupapes par cylindre 1  
 Number of manifold elements \_\_\_\_\_ Number of valves per cylinder \_\_\_\_\_

d) Diamètre maximum des soupapes 42,1 mm e) Diamètre de la tige de soupape 8,0 mm  
 Maximum diameter of the valves \_\_\_\_\_ mm Diameter of the valve stem \_\_\_\_\_ mm

f) Longueur de la soupape 134,8 + 0,5 mm g) Type des ressorts de soupape Helical  
 Length of the valve \_\_\_\_\_ mm Type of valve springs \_\_\_\_\_

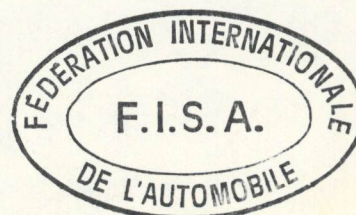

Marque FORD Modèle Escort RS 1600i N° Homol. A-5097  
Make \_\_\_\_\_ Model \_\_\_\_\_

**328. Echappement:** a) Matériau du collecteur Cast iron  
**Exhaust:** Material of the manifold \_\_\_\_\_  
b) Nombre d'éléments du collecteur 1 d) Nombre de soupapes par cylindre 1  
Number of manifold elements \_\_\_\_\_ Number of valves per cylinder \_\_\_\_\_  
e) Diamètre maximum des soupapes 37,1 mm f) Diamètre de la tige de soupape 8,0 mm  
Maximum diameter of the valves \_\_\_\_\_ mm Diameter of the valve stem \_\_\_\_\_ mm  
g) Longueur de la soupape 131,8 ± 0,5 mm h) Type des ressorts de soupape Helical  
Length of the valve \_\_\_\_\_ mm Type of valve springs \_\_\_\_\_

**330. Système d'allumage:** a) Type Battery  
**Ignition system:** Type \_\_\_\_\_  
b) Nombre de bougies par cylindre 1 c) Nombre de distributeurs 1  
Number of plugs per cylinder \_\_\_\_\_ Number of distributors \_\_\_\_\_

**333. Système de lubrification:** a) Type Compartmented wet sump b) Nombre de pompes à huile 1  
**Lubrification system:** Type \_\_\_\_\_ Number of oil pumps \_\_\_\_\_

#### 4. CIRCUIT DE CARBURANT / FUEL CIRCUIT

**401. Réservoir:** a) Nombre 1 b) Emplacement Under rear seat  
**Fuel tank:** Number \_\_\_\_\_ Location \_\_\_\_\_  
c) Matériau Steel d) Capacité maximum 40 L  
Material \_\_\_\_\_ Maximum capacity \_\_\_\_\_

#### 5. EQUIPEMENT ELECTRIQUE / ELECTRICAL EQUIPEMENT

**501. Batterie(s):** a) Nombre 1  
**Battery(ies):** Number \_\_\_\_\_

#### 6. TRANSMISSION / DRIVE

**601. Roues motrices:**  avant  arrière  
**Driving wheels:**  front  rear

**602. Embrayage:** b) Système de commande Mechanical  
**Clutch:** Drive system \_\_\_\_\_  
c) Nombre de disques One  
Number of plates \_\_\_\_\_

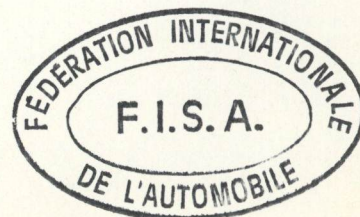

**603. Boite de vitesses:** a) Emplacement Rear of engine  
**Gear-box:** Location \_\_\_\_\_

b) Marque «manuelle» Ford c) Marque «automatique» \_\_\_\_\_  
 «Manual» make \_\_\_\_\_ «Automatic» make \_\_\_\_\_

d) Emplacement de la commande Central on floor  
 Location of the gear lever \_\_\_\_\_

e) Rapports Ratios

|           | Manuelle / Manual |                                  |          | Automatique / Automatic |                                  |          | B.V. suppl. / Additional G.B. |                                  |          |
|-----------|-------------------|----------------------------------|----------|-------------------------|----------------------------------|----------|-------------------------------|----------------------------------|----------|
|           | rappports ratio   | nombre de dents/ number of teeth | synchro. | rappports ratio         | nombre de dents/ number of teeth | synchro. | rappports ratio               | nombre de dents/ number of teeth | synchro. |
| 1         | 3,154             | 41:13                            | X        |                         |                                  |          |                               |                                  |          |
| 2         | 1,913             | 44:23                            | X        |                         |                                  |          |                               |                                  |          |
| 3         | 1,276             | 37:29                            | X        |                         |                                  |          |                               |                                  |          |
| 4         | 0,951             | 39:41                            | X        |                         |                                  |          |                               |                                  |          |
| 5         | 0,83              | 35:42                            | X        |                         |                                  |          |                               |                                  |          |
| AR/R      | 3,615             | 47:13                            |          |                         |                                  |          |                               |                                  |          |
| Constante |                   |                                  |          |                         |                                  |          |                               |                                  |          |
| Constant. |                   |                                  |          |                         |                                  |          |                               |                                  |          |

f) Grille de vitesse Gear change gate

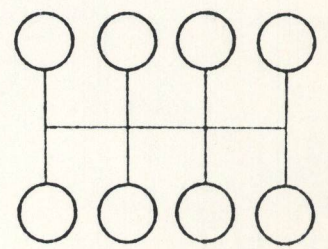
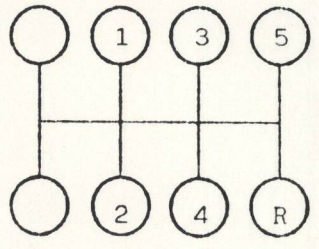

**604. Surmultiplication:** a) Type \_\_\_\_\_  
**Overdrive:** Type \_\_\_\_\_

b) Rapport Ratio \_\_\_\_\_ c) Nombre de dents Number of teeth \_\_\_\_\_

d) Utilisable avec les vitesses suivantes Usable with the following gears \_\_\_\_\_



Marque FORD Modèle Escort RS 1600i N° Homol. A-5097  
 Make \_\_\_\_\_ Model \_\_\_\_\_

**605. Couple final:**

**Final drive:**

- a) Type du couple final  
Type of final drive
- b) Rapport  
Ratio
- c) Nombre de dents  
Teeth number
- d) Type de limitation de différentiel (si prévu)  
Type of differential limitation (if provided)

| AV / Front   | AR / Rear |
|--------------|-----------|
| Helical gear |           |
| 3,84         |           |
| 73:19        |           |
|              |           |
|              |           |

- e) Rapport de la boîte de transfert  
Ratio of the transfer box \_\_\_\_\_

**606. Type de l'arbre de transmission**

Type of the transmission shaft \_\_\_\_\_

Sliding balls & constant velocity joints

**7. SUSPENSION / SUSPENSION**

701. Type de suspension:  
Type of suspension:

a) AV / Front \_\_\_\_\_ Independent wheels - MacPherson strut

b) AR / rear \_\_\_\_\_ Independent wheels - strut & radius arms

702. Ressorts hélicoïdaux:  
Helicoïdal springs:

AV: oui/  
Front: yes/

AR: oui/  
Rear: yes/

703. Ressorts à lames:  
Leaf springs:

AV: /non  
Front: /no

AR: /non  
Rear: /no

704. Barre de torsion:  
Torsion bar:

AV: /non  
Front: /no

AR: /non  
Rear: /no

705. Autre type de suspension: Voir photo/dessin en page 15

Other type of suspension: See photo or drawing on page 15

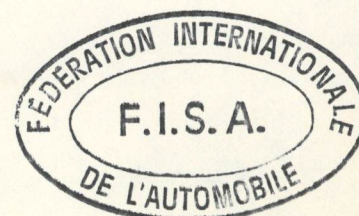

Marque FORD  
 Make \_\_\_\_\_

Modèle Escort RS 1600i  
 Model \_\_\_\_\_

N° Homol. A-5097

**707. Amortisseurs:**

**Shock Absorbers:**

- a) Nombre par roue  
Number per wheel
- b) Type  
Type
- c) Principe de fonctionnement  
Working principle

| Avant / Front | Arrière / Rear |
|---------------|----------------|
| 1             | 1              |
| Telescopic    | Telescopic     |
| Hydraulic     | Hydraulic      |

**8. TRAIN ROULANT / RUNNING GEAR:**

**801. Roues:** a) Diamètre AV 15" / 381 mm AR 15" / 381 mm  
**Wheels:** Diameter Front \_\_\_\_\_ mm Rear \_\_\_\_\_ mm

**803. Freins:** a) Système de freinage Dual hydraulic  
**Brakes:** Braking system \_\_\_\_\_  
 b) Nombre de maître-cylindres Tandem b1) Alésage 2 x 22 mm  
 Number of master cylinders \_\_\_\_\_ Bore \_\_\_\_\_ mm  
 c) Servo-frein oui/ c1) Marque et type Girling.  
 Power assisted brakes yes/ Make and type Vacuum  
 d) Régulateur de freinage oui/ d1) Emplacement In engine compartment  
 Braking adjuster yes/ Location \_\_\_\_\_

e) Nombre de cylindres par roue:  
Number of cylinders per wheel:

e1) Alésage  
Bore

f) Freins à tambours:  
Drum brakes:

f1) Diamètre intérieur  
Interior diameter

f2) Nombre de mâchoires par roue.  
Number of shoes per wheel

f3) Surface de freinage  
Braking surface

f4) Largeur des garnitures  
Width of the shoes

g) Freins à disques:  
Disc brakes:

g1) Nombres de sabots par roue  
Number of pads per wheel

g2) Nombre d'étriers par roue  
Number of calipers per wheel

| Avant / Front         | Arrière / Rear      |
|-----------------------|---------------------|
| 1                     | 1                   |
| 54 mm                 | 19,05 mm            |
| _____ mm (± 1,5 mm)   | 180 mm (± 1,5 mm)   |
| _____                 | 2                   |
| _____ cm <sup>2</sup> | 169 cm <sup>2</sup> |
| _____ mm              | 30 mm               |
| 2                     | _____               |
| 1                     | _____               |

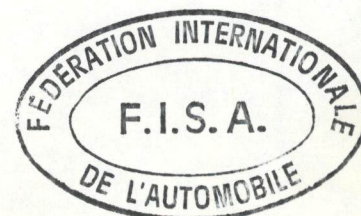

Marque FORD Modèle Escort RS 1600i N° Homol. A-5097  
 Make \_\_\_\_\_ Model \_\_\_\_\_

|  | AV / Front                 | AR / Rear             |
|--|----------------------------|-----------------------|
| g3) Matériau des étriers<br>Caliper material   | <u>Cast iron</u>           | _____                 |
| g4) Epaisseur maximale du disque<br>Maximum disc thickness   | <u>24</u> mm               | _____ mm              |
| g5) Diamètre extérieur du disque<br>Exterior diameter of the disc                                  | <u>239,5</u> mm (± 1 mm)   | _____ mm (± 1 mm)     |
| g6) Diamètre extérieur de frottement des sabots<br>Exterior diameter of the shoe's rubbing surface | <u>239</u> mm              | _____ mm              |
| g7) Diamètre intérieur de frottement des sabots<br>Interior diameter of the shoe's rubbing surface | <u>160</u> mm              | _____ mm              |
| g8) Longueur hors-tout des sabots<br>Overall length of the shoes                                   | <u>110</u> mm              | _____ mm              |
| g9) Disques ventilés<br>Ventilated disc  | <u>oui/yes/</u>            | <u>oui/non/yes/no</u> |
| g10) Surface de freinage par roue<br>Braking surface per wheel                                     | <u>495</u> cm <sup>2</sup> | _____ cm <sup>2</sup> |

h) Frein de stationnement: Parking brake: \_\_\_\_\_  
 h2) Emplacement de la commande Location of the lever Central on floor  
 h1) Système de commande Command system Mechanical  
 h3) Effet sur roues On which wheels AV Front AR Rear Rear

804. Direction: a) Type Rack and pinion  
 Steering: Type \_\_\_\_\_  
 b) Rapport Ratio 19,5:1

c) Servo-assistance /non  
 Power assisted /no

**9. CARROSSERIE / BODYWORK**

901. Intérieur: a) Ventilation oui/ Interior: Ventilation yes/  
 b) Chauffage oui/ Heating yes/  
 f) Toit ouvrant optionnel /NON Sun roof optional /NO  
 f1) Type \_\_\_\_\_  
 f2) Système de commande Command system \_\_\_\_\_

g) Système d'ouverture des vitres latérales: AV/Front: Crank  
 Opening system for the side windows: AR/Rear: -

902. Extérieur: a) Nombre de portes Two b) Hayon AR oui/ Exterior: Number of doors Rear tailgate yes/  
 c) Matériau des portières: Door material: AV/Front: Steel  
 AR/Rear: -



Marque FORD Modèle Escort RS 1600i N° Homol. A-5097  
 Make \_\_\_\_\_ Model \_\_\_\_\_

- d) Matériau du capot AV  
Front bonnet material Steel
- e) Matériau du capot/hayon AR  
Rear bonnet / tailgate material Steel
- f) Matériau de la carrosserie  
Bodywork material Steel
- g) Matériau du pare-brise  
Windscreen material Laminated for competition use
- h) Matériau de la lunette AR  
Rear window material Safety glass
- i) Matériau des glaces de custode  
Rear quarter lights material Safety glass
- k) Matériau des vitres latérales  
Side window material AV / Front Safety glass  
AR / Rear
- l) Matériau du pare-choc avant  
Material of the front bumper Steel/plastic
- m) Matériau du pare-choc arrière  
Material of the rear bumper Steel/plastic

INFORMATIONS COMPLEMENTAIRES

COMPLEMENTARY INFORMATION

605. Alternative final drive gears:

4,05 18:73 or 4,294 73:17

321e. angle between inlet/exhaust valve : 49°

803 c1. ATE / BENDIX .

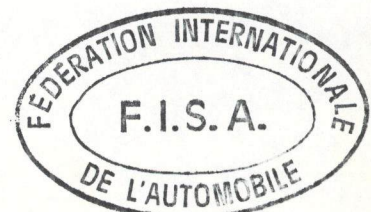

Marque  
Make

FORD

Modèle  
Model

Escort RS 1600i

N° Homol. **A-5097**

**PHOTOS / PHOTOS**

**Moteur / Engine**

C) Profil droit du moteur déposé  
Right hand view of dismounted engine

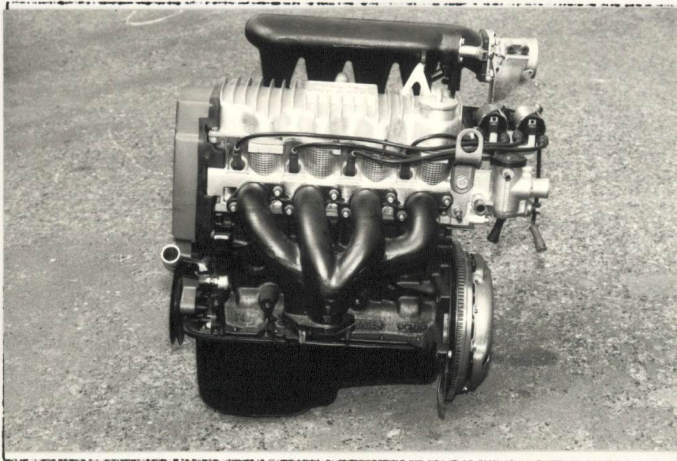

D) Profil gauche du moteur déposé  
Left hand view of dismounted engine

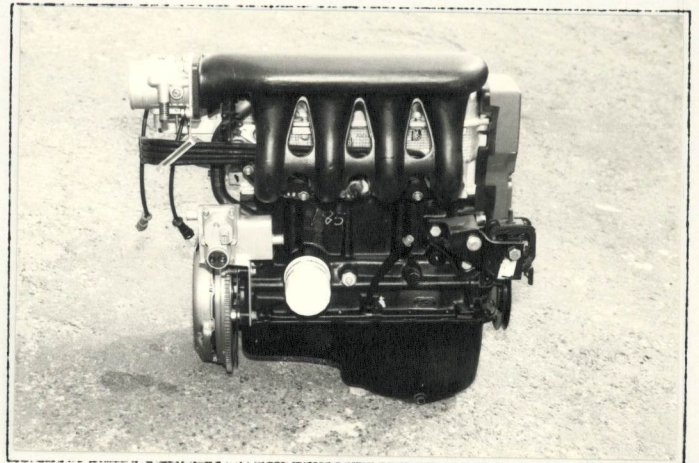

E) Moteur dans son compartiment  
Engine in its compartment

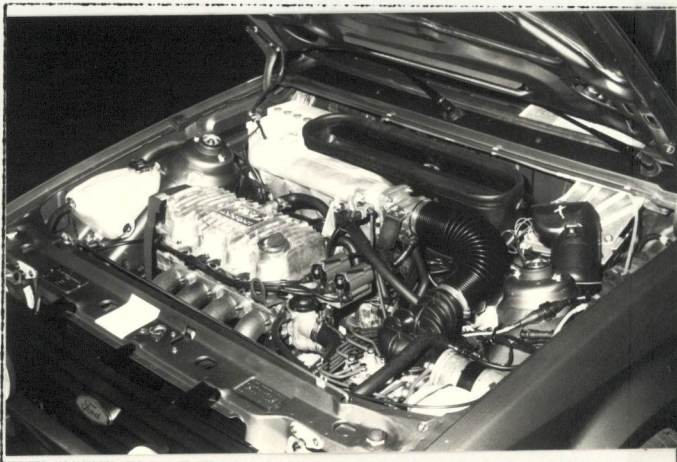

F) Culasse nue  
Bare cylinderhead

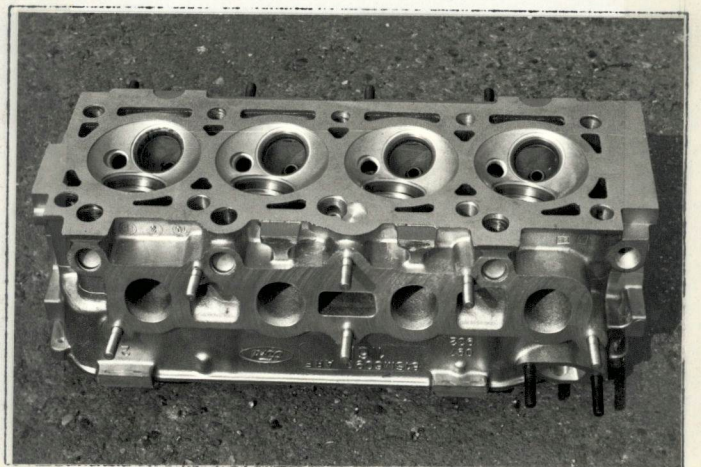

Marque  
Make

FORD

Modèle  
Model

Escort RS 1600i

N° Homol.

A-5097

G) Chambre de combustion  
Combustion chamber

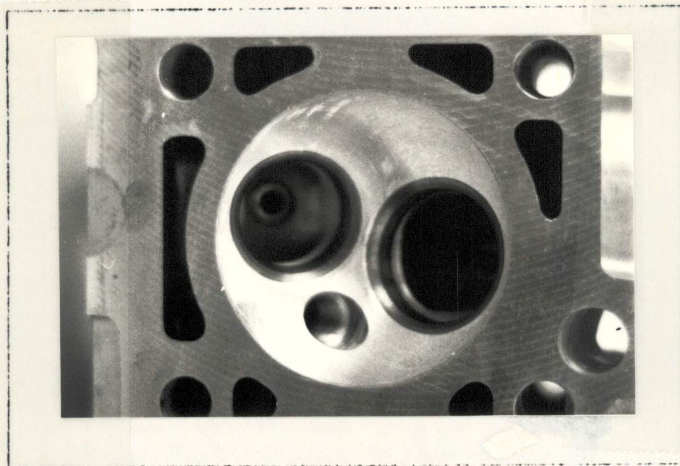

H) Carburateur(s) ou système d'injection  
Carburetor(s) or injection system

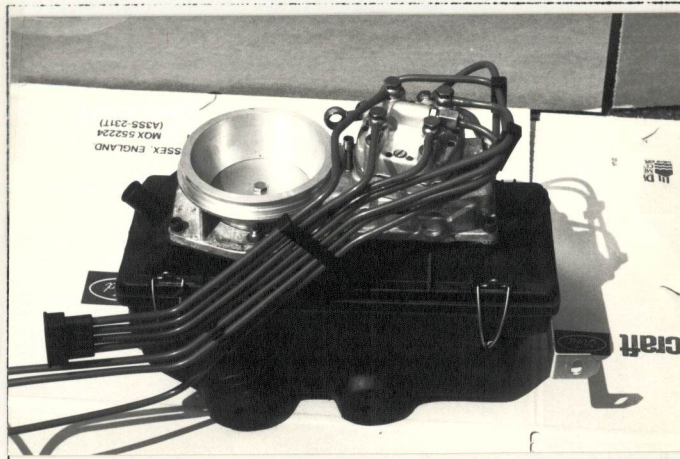

I) Collecteur d'admission  
Inlet manifold

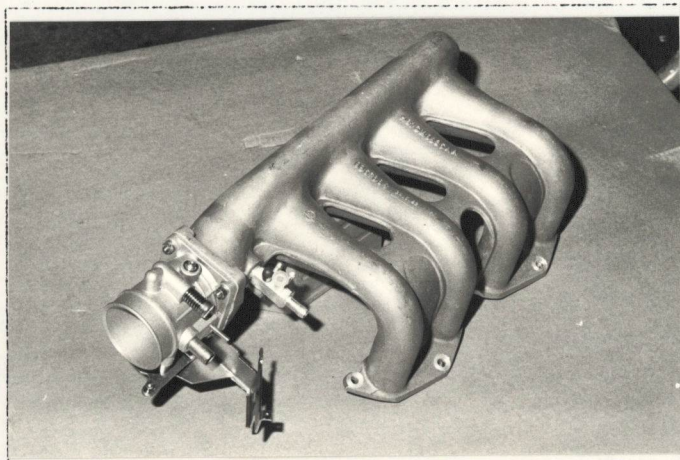

J) Collecteur d'échappement  
Exhaust manifold

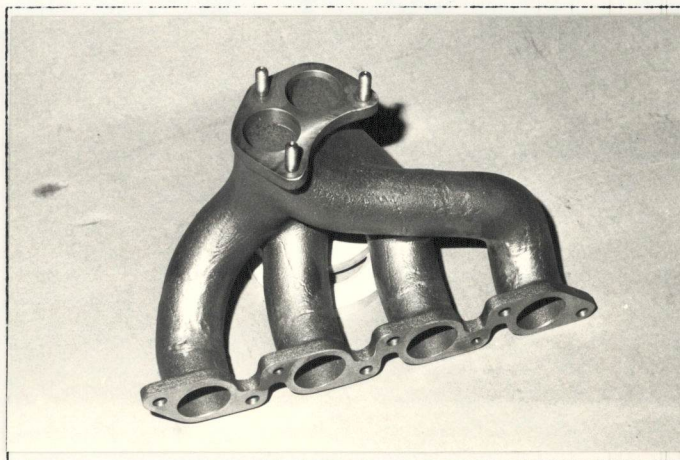

**Transmission / Transmission**

S) Carter de boîte de vitesse et cloche d'embrayage  
Gearbox casing and clutch bellhousing

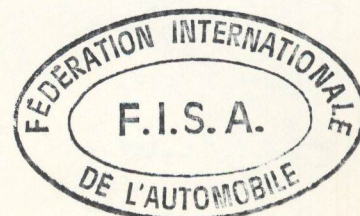
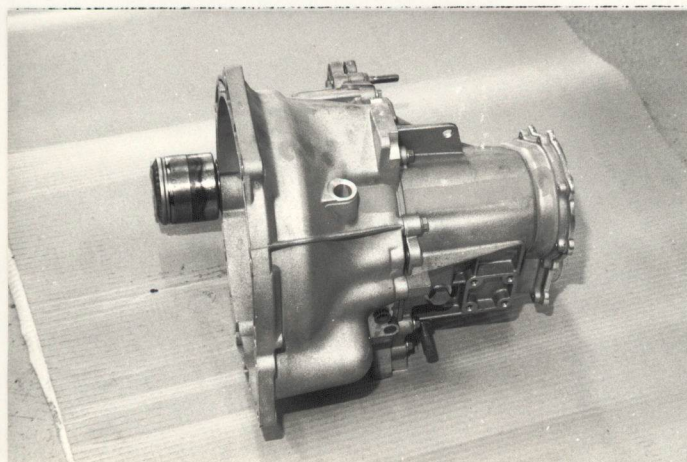

Marque FORD  
Make

Modèle Escort RS 1600i  
Model

N° Homol. A-5097

**Suspension / Suspension**

T) Train avant complet déposé  
Complete dismantled front running gear

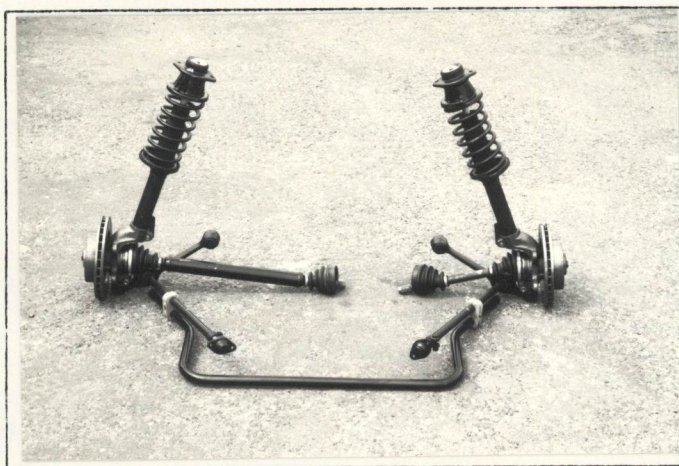

U) Train arrière complet déposé  
Complete dismantled rear running gear

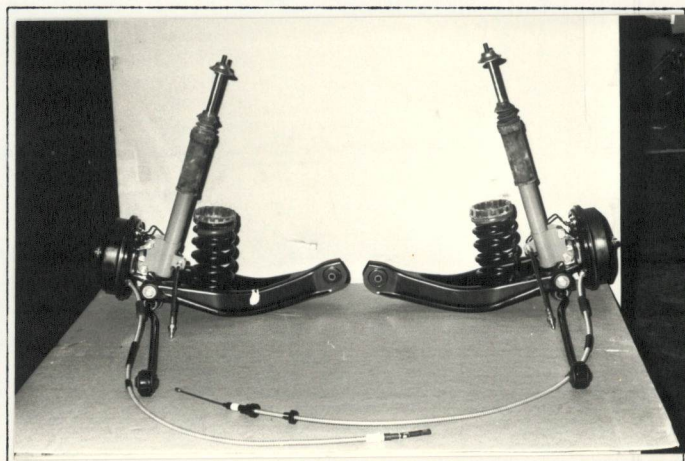

**Train roulant / Running gear**

V) Freins avant  
Front brakes

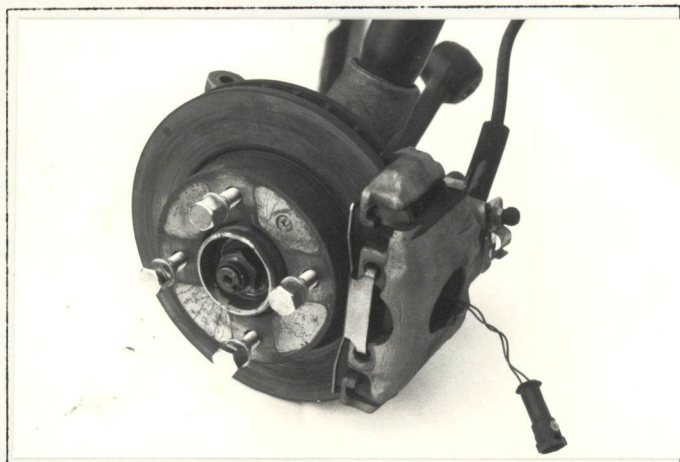

W) Freins arrière  
Rear brakes



**Carrosserie / Bodywork**

X) Tableau de bord  
Dashboard



Y) Toit ouvrant  
Sunroof

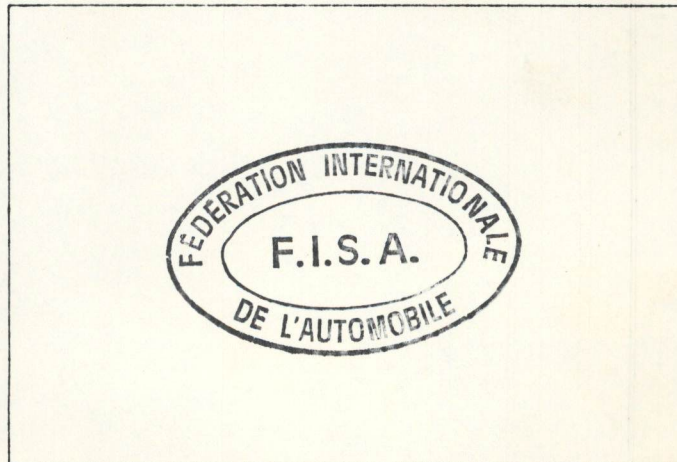

DESSINS / DRAWINGS

Moteur / Engine

- I Orifices d'admission de la culasse, face collecteur (tolérances sur dimensions: -2%, +4%)  
Cylinderhead inlet ports, manifold side (tolerances on dimensions: -2%, +4%)

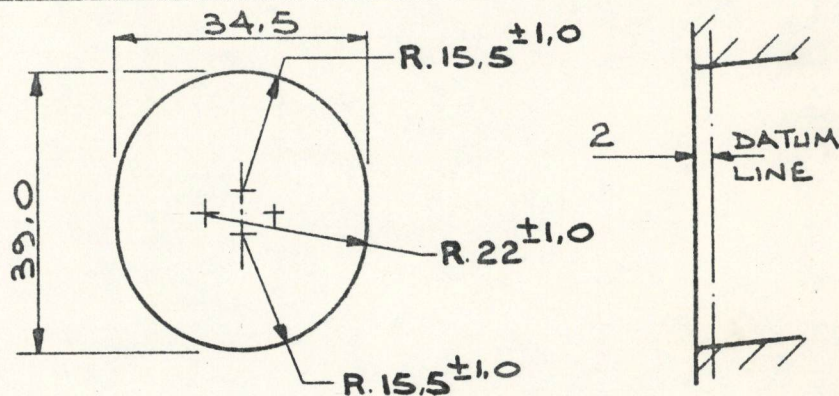

- II Orifices du collecteur d'admission, côté culasse (tolérances sur dimensions: -2%, +4%)  
Inlet manifold ports, cylinderhead side (tolerances on dimensions: -2%, +4%)

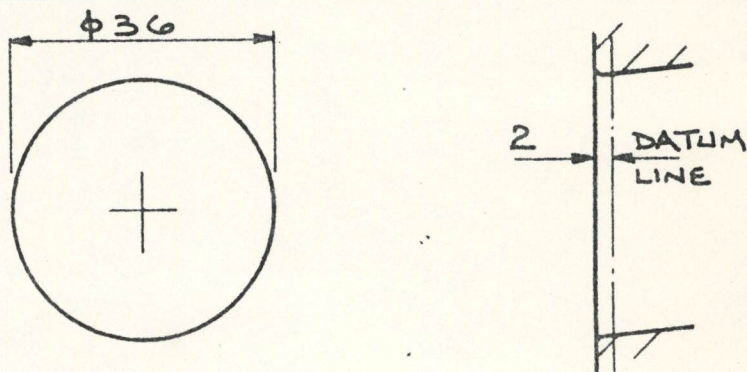

- III Orifices d'échappement de la culasse, face collecteur (tolérances sur dimensions: -2%, +4%)  
Cylinderhead exhaust ports, manifold side (tolerances on dimensions: -2%, +4%)

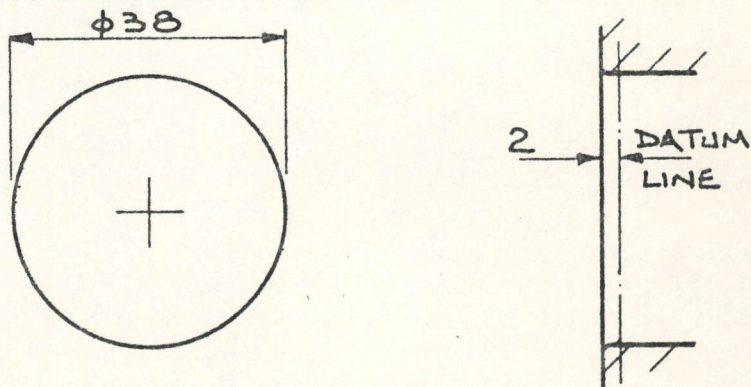

- IV Orifices du collecteur d'échappement, côté culasse (tolérances sur dimensions: -2%, +4%)  
Exhaust manifold ports, cylinderhead side (tolerances on dimensions: -2%, +4%)

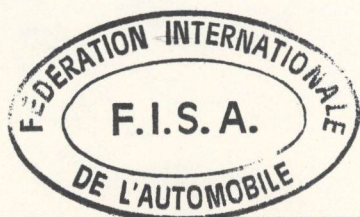
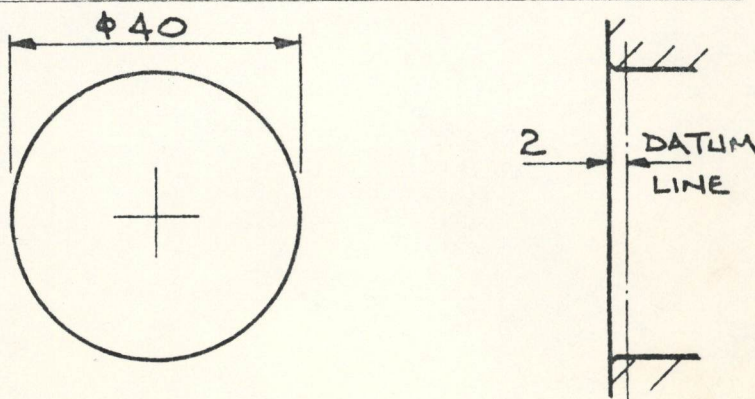

Marque  
Make

FORD

Modèle  
Model

Escort RS 1600i

N° Homol.

A-5097

**Suspension / Suspension**

XV Système de suspension, selon l'article 705 ou en remplacement des photos O et P.  
Suspension system according to article 705 or replacing photos O and P.

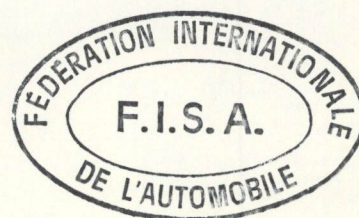





# FEDERATION INTERNATIONALE DU SPORT AUTOMOBILE

Homologation N°

**A - 5097**

Extension N°

**01 / 01 VF**

FICHE D'EXTENSION A L'HOMOLOGATION OFFICIELLE FISA  
FORM OF EXTENSION TO THE OFFICIAL FISA HOMOLOGATION

**ET** Evolution normale du type: dès le numéro de châssis  
Normal evolution of the type: as from chassis number \_\_\_\_\_

**VF** Variante de fourniture / Supply variant

**VO** Variante option / Option variant

**ER** Errata / Erratum

Homologation valable dès le **- 1 JAN. 1983** en groupe **A**  
Homologation valid as from \_\_\_\_\_ in group \_\_\_\_\_

Constructeur **FORD** Modèle et type **Escort RS 1600i**  
Manufacturer \_\_\_\_\_ Model and type \_\_\_\_\_

| Page ou ext.<br>Page or ext. | Art.<br>Art. | Description<br>Description  |
|------------------------------|--------------|---|
|                              | 313          | Sleeves: Pressed in dry liners may be fitted as a factory reclaim - the customer having no choice.                    |
|                              | 318c & 319f  | Crankshaft journals may be ground undersize by 0,010" or 0,020" as production reclaim. The customer having no choice. |
|                              | 327e & 328f  | Valve stem diameters may be either 0,003" (0,076 mm) or 0,015" (0,381 mm) oversize as production reclaim.             |
|                              | 804          | Servo assist power steering is a non option variant in certain markets - steering ratio unchanged.                    |

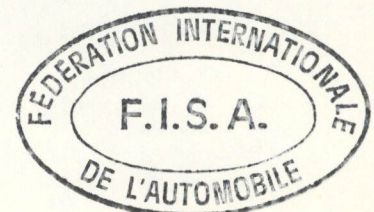



# FEDERATION INTERNATIONALE DU SPORT AUTOMOBILE

Homologation N°

A - 5097

Extension N°

02 / 01 VO

FICHE D'EXTENSION A L'HOMOLOGATION OFFICIELLE FISA  
FORM OF EXTENSION TO THE OFFICIAL FISA HOMOLOGATION

ET Evolution normale du type: dès le numéro de châssis  
Normal evolution of the type: as from chassis number \_\_\_\_\_

VF Variante de fourniture / Supply variant

VO Variante option / Option variant

ER Errata / Erratum

Homologation valable dès le \_\_\_\_\_ - 1 JAN. 1983 \_\_\_\_\_ en groupe A  
Homologation valid as from \_\_\_\_\_ in group \_\_\_\_\_

Constructeur FORD Modèle et type Escort RS 1600i  
Manufacturer \_\_\_\_\_ Model and type \_\_\_\_\_

| Page ou ext.<br>Page or ext. | Art.<br>Art. | Description<br>Description   |
|------------------------------|--------------|--|
|                              | 803          | Dual circuit braking with separate front and rear circuits - fluid reservoir not in habitable. This unit may be used with one, or two in line vacuum assist servo units. |
|                              |              | 803b 2 or 803b1 17,8 mm <i>see photo 82-0</i><br>803b1 19,1 mm or 803b1 20,6 mm<br>803c Non - no 803d Optional pressure control valve in rear brake circuit.             |
|                              | 803          | 803e 4 803e1 38,1 mm<br>803g1 2 803g2 1<br>803g3 Alum alloy 803g8 112 mm<br>See photo 82-1   |
|                              | 803          | 803e 2 803e1 38 mm<br>803g1 2 803g2 1 -<br>803g3 Cast iron 803g8 62 mm<br>See photo 82-2   |
|                              | 803          | 803g4 21 mm 803g5 264 mm<br>803g6 262 mm 803g7 158 mm<br>803g9 Ventilated 803g10 702 cm <sup>2</sup><br>See photo 82-3   |
|                              | 803          | 803g4 12,8 mm 803g5 265 mm<br>803g6 262 mm 803g7 160 mm<br>803g9 Non ventilated 803g10 676 cm <sup>2</sup><br>See photo 82-4   |



Marque  
Make FORD

Modèle  
Model Escort RS 1600i

N° Homol. **A-5097**

VO

N° Ext. **02 / 01 VO**

| Page ou ext.<br>Page or ext. | Art.<br>Art. | Description<br>Description  |
|------------------------------|--------------|---|
|                              | 803          | 803e1 22,2 mm      803f1 203 mm<br>803f2 2              803f3 236.2 cm <sup>2</sup><br>803f4 38 mm<br><p style="text-align: center;">See photo 82-5</p> |
|                              | 701          | Anti roll bar for rear suspension<br><p style="text-align: center;">See photo 82-6</p>  |

82-0

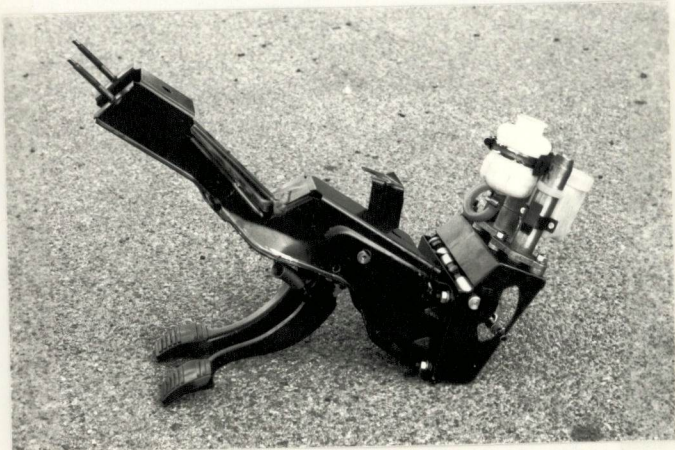



Marque FORD  
Make \_\_\_\_\_

Modèle Escort RS 1600i  
Model \_\_\_\_\_

N° Homol. A-5097

PHOTOS / PHOTOS

N° Ext. 02/01V0

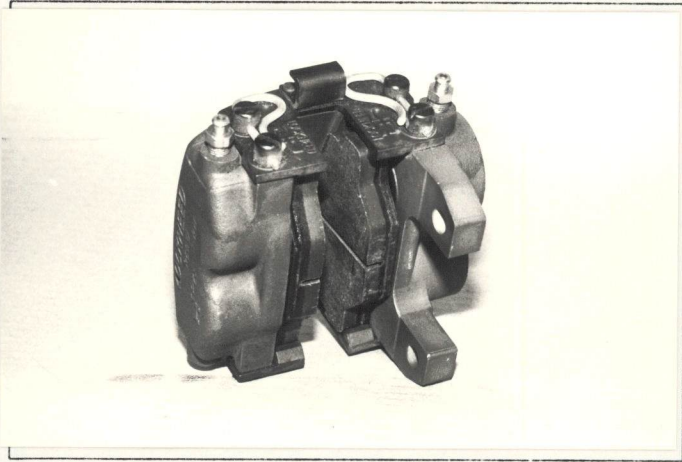

82-1

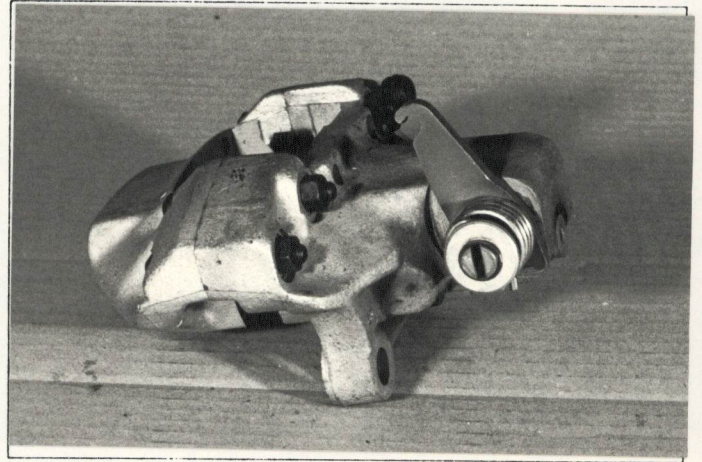

82-2

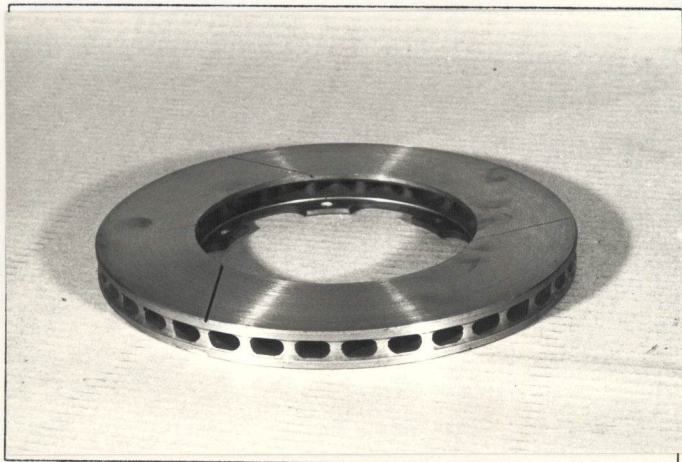

82-3

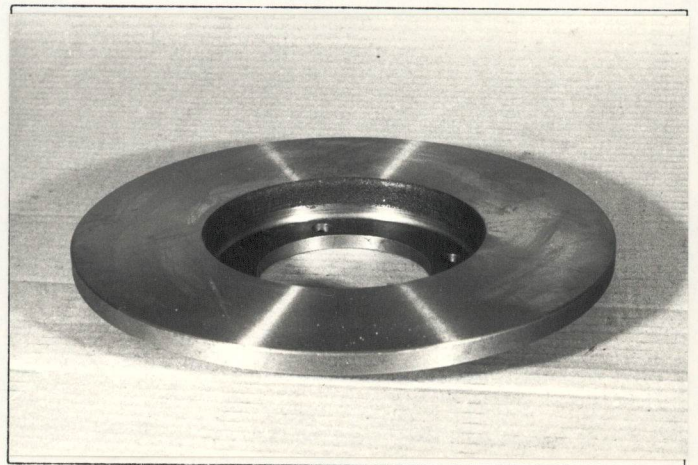

82-4

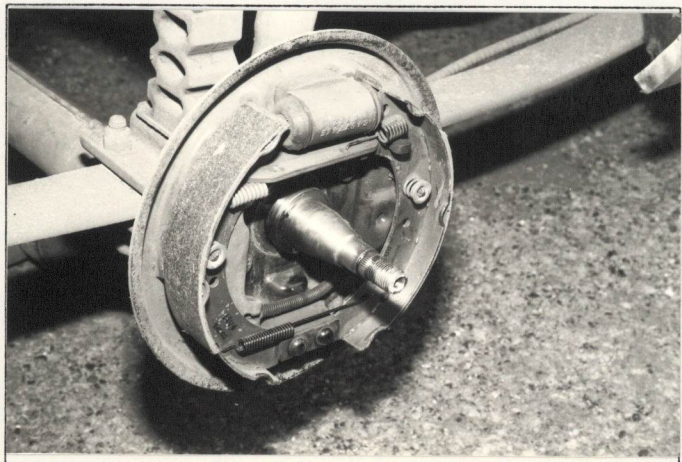

82-5

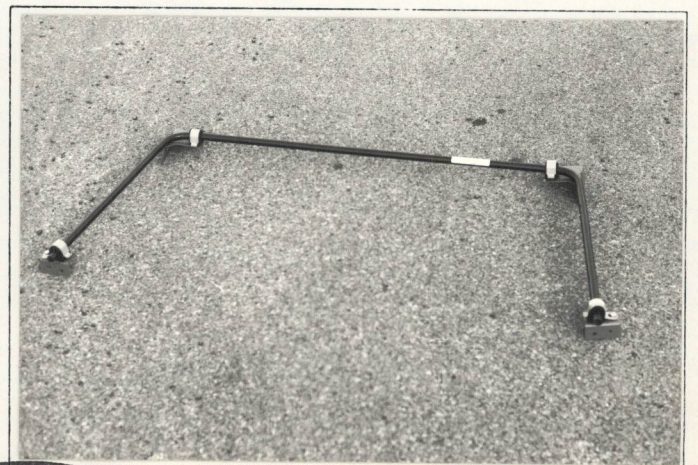

82-6





# FEDERATION INTERNATIONALE DU SPORT AUTOMOBILE

Homologation N°

A - 5097

Extension N°

03 / 02 VO

FICHE D'EXTENSION A L'HOMOLOGATION OFFICIELLE FISA  
FORM OF EXTENSION TO THE OFFICIAL FISA HOMOLOGATION

ET Evolution normale du type: dès le numéro de châssis  
Normal evolution of the type: as from chassis number \_\_\_\_\_

VF Variante de fourniture / Supply variant

VO Variante option / Option variant

ER Errata / Erratum

Homologation valable dès le \_\_\_\_\_ 1 January 1983 \_\_\_\_\_ en groupe  
Homologation valid as from \_\_\_\_\_ in group \_\_\_\_\_ A

Constructeur \_\_\_\_\_ FORD \_\_\_\_\_ Modèle et type \_\_\_\_\_ Escort RS 1600i  
Manufacturer \_\_\_\_\_ Model and type \_\_\_\_\_

| Page ou ext.<br>Page or ext. | Art.<br>Art.   | Description<br>Description  |
|------------------------------|----------------|---|
| 803                          |                | Hydraulic pressure limiting valve - adjustable.<br>See photo 83-1.  |
| 803                          | e<br>g1<br>g3  | 4 e1 38.2 mm<br>2 g2 1<br>Alum alloy g8 96 mm<br>See photo 83-2   |
| 803                          | e<br>g1<br>g3  | 2 e1 33.9 mm<br>2 g2 1<br>Cast iron g8 59 mm<br>See photo 83-3  |
| 803                          | g4<br>g6<br>g9 | 28 mm g5 304 mm<br>303 mm g7 200 mm<br>Ventilated g10 813.4 cm <sup>2</sup> See photo 83-4  |
| 803                          | g4<br>g6<br>g9 | 10 mm g5 238.5 mm<br>237.4 mm g7 150 mm<br>Non ventilated g10 532 cm <sup>2</sup><br>See photo 83-5   |
| 401                          | a)<br>c)<br>d) | 1 b) in rear compartment<br>Rubber to FT3 specification<br>Max capacity = 90 litres<br>Tank in car - photo 83-6<br>Tank out of car - photo 83-7 |

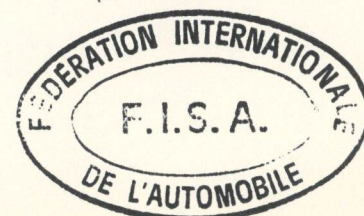

Marque FORD  
Make \_\_\_\_\_

Modèle Escort RS 1600i  
Model \_\_\_\_\_

N° Homol. A-5097

PHOTOS / PHOTOS

N° Ext. 03 / 02 V0



83-1

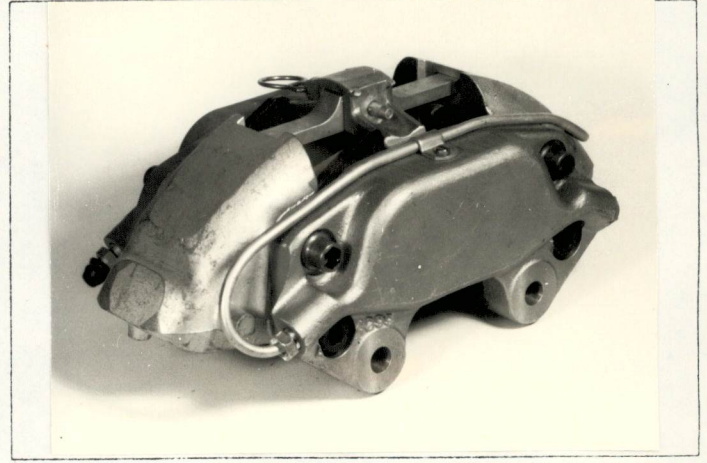

83-2

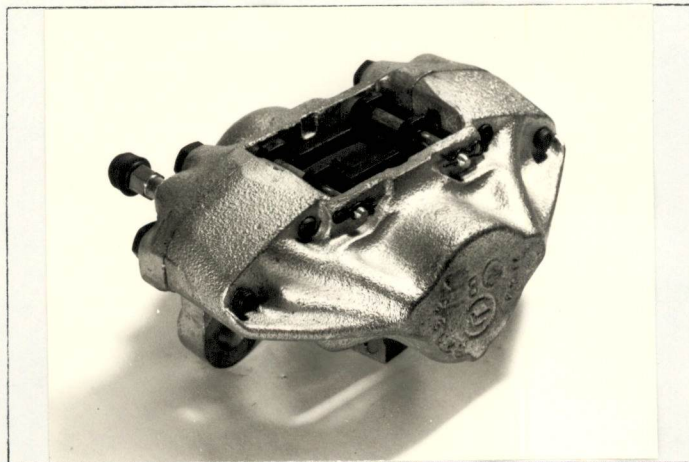

83-3

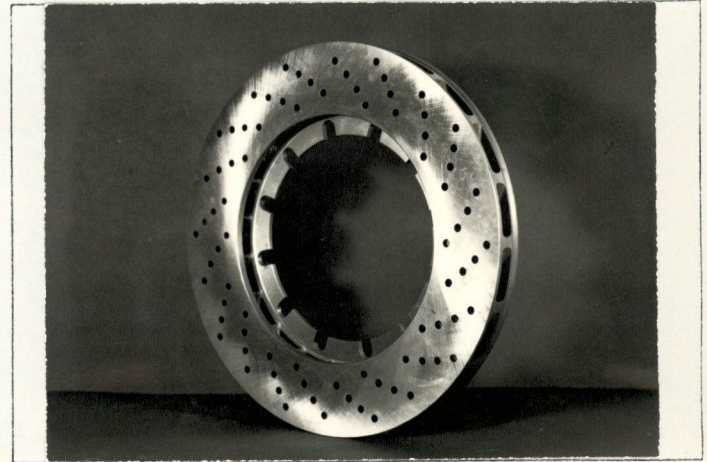

83-4

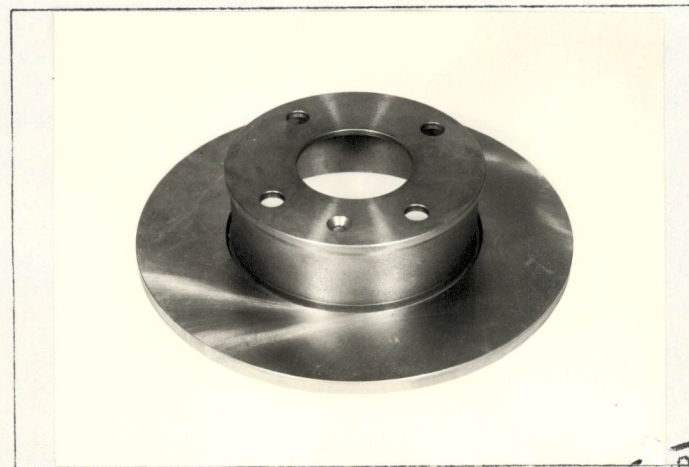

83-5

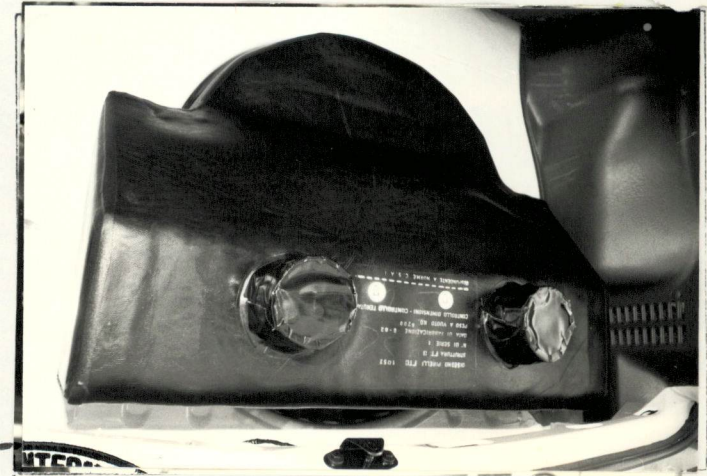

83-6

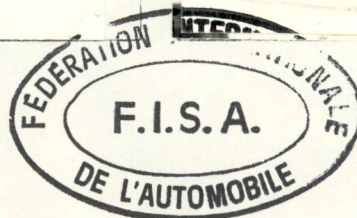

Marque FORD  
Make

Modèle Escort RS 1600i  
Model

N° Homol. A-5097

PHOTOS / PHOTOS

N° Ext. 03/02V0



83-7

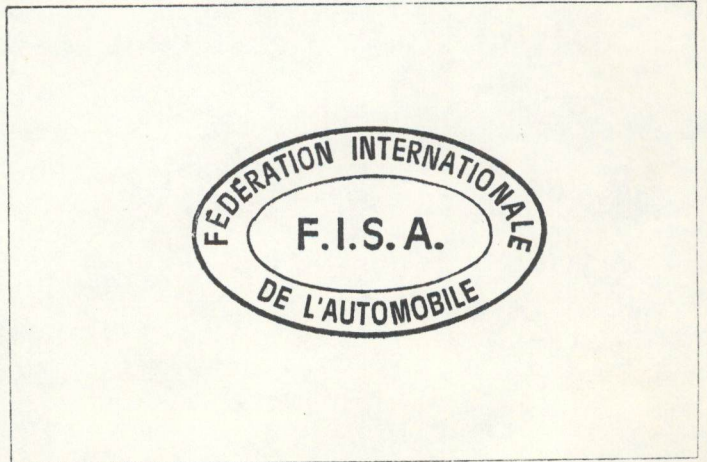
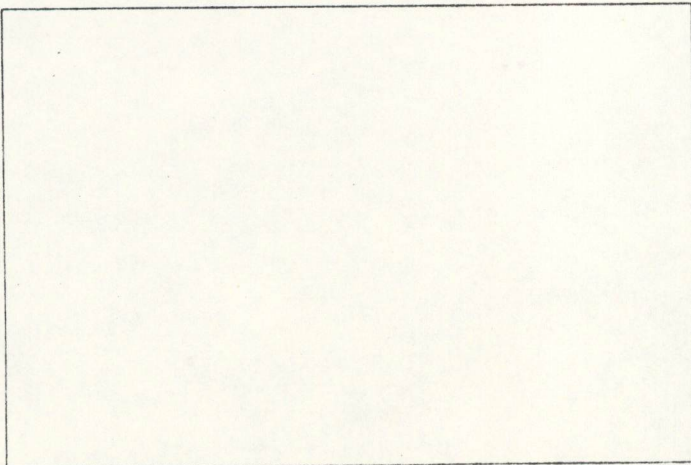
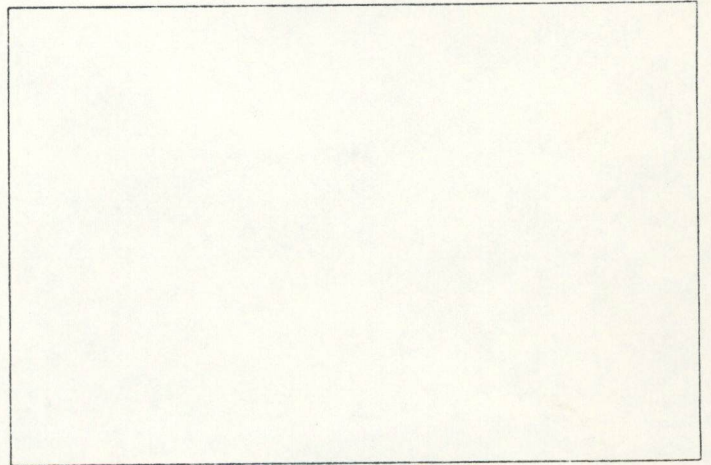
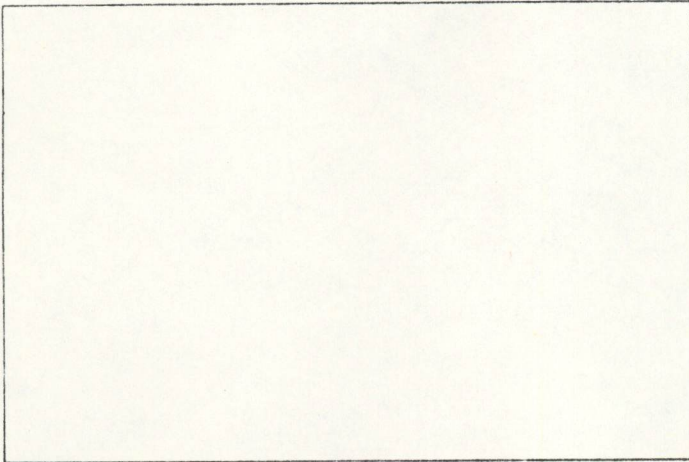
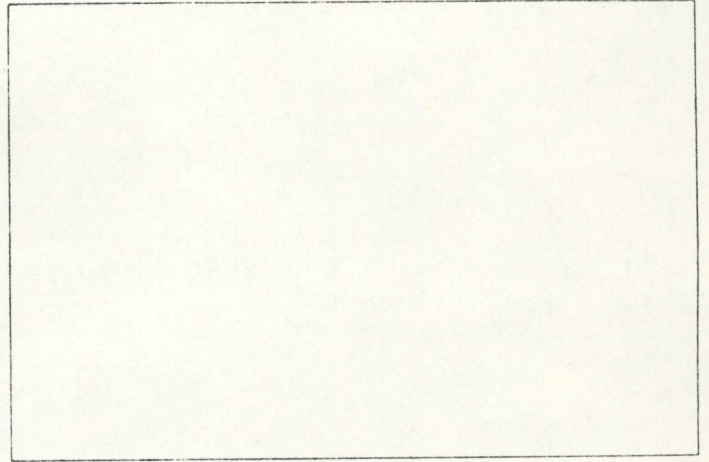



# FEDERATION INTERNATIONALE DU SPORT AUTOMOBILE

Homologation N°

A - 5097

Extension N°

04 / 03 VO

FICHE D'EXTENSION A L'HOMOLOGATION OFFICIELLE FISA  
FORM OF EXTENSION TO THE OFFICIAL FISA HOMOLOGATION

- ET Evolution normale du type: dès le numéro de châssis  
Normal evolution of the type: as from chassis number \_\_\_\_\_
- VF Variante de fourniture / Supply variant
- VO Variante option / Option variant
- ER Errata / Erratum

Homologation valable dès le - 1 JAN. 1983 en groupe A  
Homologation valid as from \_\_\_\_\_ in group \_\_\_\_\_

Constructeur FORD Modèle et type Escort RS 1600i  
Manufacturer \_\_\_\_\_ Model and type \_\_\_\_\_

| Page ou ext.<br>Page or ext. | Art.<br>Art. | Description<br>Description                                   |
|------------------------------|--------------|--|
|                              |              | <u>Boîte de vitesses supplémentaire de la fiche de base.</u> |

| 603 |      | ADDITIONAL GEARBOX / B.V. Suppl.   |                    |                |                    |                |   |     |       |   |   |      |       |   |   |      |       |   |   |      |       |   |   |      |       |   |     |      |       |  |
|-----|------|--|--------------------|----------------|--------------------|----------------|---|-----|-------|---|---|------|-------|---|---|------|-------|---|---|------|-------|---|---|------|-------|---|-----|------|-------|--|
|     |      | <table border="1"> <thead> <tr> <th></th> <th><u>Ratio</u></th> <th><u>No of teeth</u></th> <th><u>synchro</u></th> </tr> </thead> <tbody> <tr> <td>1</td> <td>2.6</td> <td>39/15</td> <td>X</td> </tr> <tr> <td>2</td> <td>1.91</td> <td>40/21</td> <td>X</td> </tr> <tr> <td>3</td> <td>1.41</td> <td>41/29</td> <td>X</td> </tr> <tr> <td>4</td> <td>1.13</td> <td>35/31</td> <td>X</td> </tr> <tr> <td>5</td> <td>1.00</td> <td>39/39</td> <td>X</td> </tr> <tr> <td>REV</td> <td>3.61</td> <td>47/13</td> <td></td> </tr> </tbody> </table> |                    | <u>Ratio</u>   | <u>No of teeth</u> | <u>synchro</u> | 1 | 2.6 | 39/15 | X | 2 | 1.91 | 40/21 | X | 3 | 1.41 | 41/29 | X | 4 | 1.13 | 35/31 | X | 5 | 1.00 | 39/39 | X | REV | 3.61 | 47/13 |  |
|     |      | <u>Ratio</u>   | <u>No of teeth</u> | <u>synchro</u> |                    |                |   |     |       |   |   |      |       |   |   |      |       |   |   |      |       |   |   |      |       |   |     |      |       |  |
|     | 1    | 2.6  | 39/15              | X              |                    |                |   |     |       |   |   |      |       |   |   |      |       |   |   |      |       |   |   |      |       |   |     |      |       |  |
|     | 2    | 1.91   | 40/21              | X              |                    |                |   |     |       |   |   |      |       |   |   |      |       |   |   |      |       |   |   |      |       |   |     |      |       |  |
|     | 3    | 1.41   | 41/29              | X              |                    |                |   |     |       |   |   |      |       |   |   |      |       |   |   |      |       |   |   |      |       |   |     |      |       |  |
|     | 4    | 1.13   | 35/31              | X              |                    |                |   |     |       |   |   |      |       |   |   |      |       |   |   |      |       |   |   |      |       |   |     |      |       |  |
| 5   | 1.00 | 39/39  | X                  |                |                    |                |   |     |       |   |   |      |       |   |   |      |       |   |   |      |       |   |   |      |       |   |     |      |       |  |
| REV | 3.61 | 47/13  |                    |                |                    |                |   |     |       |   |   |      |       |   |   |      |       |   |   |      |       |   |   |      |       |   |     |      |       |  |





# FEDERATION INTERNATIONALE DU SPORT AUTOMOBILE

Homologation N°

A - 5097

Extension N°

05 / 01 ER

## FICHE D'EXTENSION A L'HOMOLOGATION OFFICIELLE FISA FORM OF EXTENSION TO THE OFFICIAL FISA HOMOLOGATION

- ET Evolution normale du type: dès le numéro de châssis  
Normal evolution of the type: as from chassis number \_\_\_\_\_
- VF Variante de fourniture / Supply variant
- VO Variante option / Option variant
- ER Errata / Erratum

Homologation valable dès le - 1 AVR. 1983 en groupe A  
Homologation valid as from \_\_\_\_\_ in group \_\_\_\_\_

Constructeur FORD Modèle et type ESCORT RS1600i  
Manufacturer \_\_\_\_\_ Model and type \_\_\_\_\_

| Page ou ext.<br>Page or ext. | Art.<br>Art. | Description<br>Description                               |
|------------------------------|--------------|--|
| 3                            | 319h         | Crankshaft weight 11800 grammes instead of 12000         |
| 3                            | 320b         | Flywheel weight 6400 grammes instead of 6500             |
| 4                            | 326e         | Valve lift 11.4 mm instead of 11.2 and 11.3 respectively |

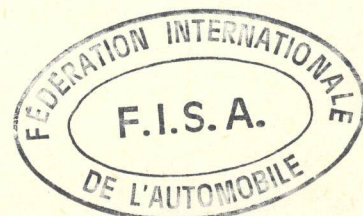



# FEDERATION INTERNATIONALE DU SPORT AUTOMOBILE

Homologation N°

**A - 5097**

Extension N°

**06 / 04 VO**

FICHE D'EXTENSION A L'HOMOLOGATION OFFICIELLE FISA  
FORM OF EXTENSION TO THE OFFICIAL FISA HOMOLOGATION

**ET** Evolution normale du type: dès le numéro de châssis  
Normal evolution of the type: as from chassis number \_\_\_\_\_

**VF** Variante de fourniture / Supply variant

**VO** Variante option / Option variant

**ER** Errata / Erratum

Homologation valable dès le \_\_\_\_\_ en groupe **A**  
Homologation valid as from **- 1 MAI 1983** in group \_\_\_\_\_

Constructeur **FORD** Modèle et type **ESCORT RS 1600i**  
Manufacturer \_\_\_\_\_ Model and type \_\_\_\_\_

| Page ou ext.<br>Page or ext. | Art.<br>Art. | Description<br>Description  |
|------------------------------|--------------|---|
|                              |              | Centre lock wheel fixing - same principle front and rear<br>Photo: 83-8<br>83-9 |
|                              |              | Reinforced rear radius arm<br>Photo: 83-10                                      |
|                              |              | Reinforced and adjustable front T.C.A.<br>Photo: 83-11                          |

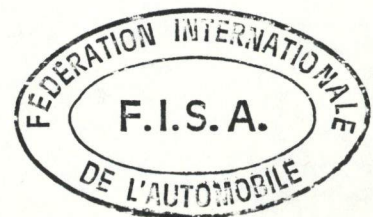

Marque  
Make FORD

Modèle  
Model ESCORT RS 1600i

N° Homol. A - 5097

PHOTOS / PHOTOS

N° Ext. 06 / 04 V0

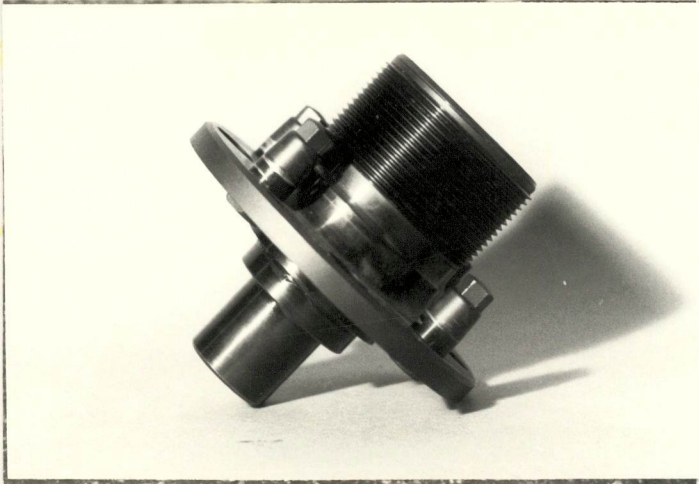

83-8



83-9



83-10



83-11



# FÉDÉRATION INTERNATIONALE DU SPORT AUTOMOBILE

ONS Oberste Nationale Sportkommission für den Automobilsport in Deutschland GmbH

Homologation Nr.

**A - 5097**

Nachtrag Nr.  
Extension Nr.

**07 / 05 VO**

## Nachtrag zum offiziellen Testblatt der FISA

Form of extension to the official FISA-Homologation

**vo** **Ausstattungsvariante**  
Option variant

Homologation gültig ab - 1 JUL. 1983 in Gruppe A  
Homologation valid as from \_\_\_\_\_ in group \_\_\_\_\_

Fahrzeughersteller Ford Modell und Typ Escort RSI 1600  
Manufacturer of the car \_\_\_\_\_ Model and type \_\_\_\_\_

### Überrollbügel/-käfig

Rollbar/rollcage

Hauptbügel  
Main rollbar

Diagonalstrebe  
Longitudinal/diagonal strut

Vorderbügel  
Front rollbar

Bügelhersteller Winfried Matter GmbH, D-7523 Graben-Neudorf 07255-5071  
Rollbar manufacturer \_\_\_\_\_

Material ALZn 4,5 MG 1 ALZn 4,5 MG 1 ALZn 4,5 MG 1  
Material \_\_\_\_\_

Außendurchmesser 40 mm 40 mm / 40 mm 40 mm  
Exterior diameter \_\_\_\_\_

Wandstärke 3,5 mm 3,5 mm / 3,5 mm 3,5 mm  
Wall thickness \_\_\_\_\_

Streckgrenze 290-345 kg/mm<sup>2</sup> 290-345 kg/mm<sup>2</sup> / 290-345 kg/mm<sup>2</sup> 290-345 kg/mm<sup>2</sup>  
Elastic limit \_\_\_\_\_

Zugfestigkeit 350-390 kg/mm<sup>2</sup> 350-390 kg/mm<sup>2</sup> / 350-390 kg/mm<sup>2</sup> 350-390 kg/mm<sup>2</sup>  
Tensile strength \_\_\_\_\_

Gesamtgewicht inkl. Befestigungsvorrichtungen 25 kg  
Total weight including fixings \_\_\_\_\_

Kompletter Überrollbügel/-käfig ausgebaut  
Complete rollbar/rollcage outside the car



*[Handwritten signature]*

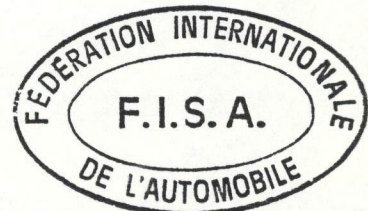

Hiermit wird bestätigt, daß der beschriebene Überrollbügel/-käfig den Anforderungen des Anhangs J der FISA entspricht, insbesondere in Bezug auf seine Befestigungen, Verbindungen und Beanspruchungswerte.

We certify that the present rollbar/rollcage complies with the conditions of the FIA Appendix J, in particular with regard to its attachments, its connections and its stress resistances.

Unterschrift des Fahrzeugherstellers  
Signature of the car manufacturer representative

**Winfried Matter GmbH**

Industriegebiet  
Tel. 07255/5071

*[Handwritten signature]*  
7523 Graben-Neudorf *[Handwritten signature]*  
RAC MOTOR SPORTS ASSOCIATION



# FEDERATION INTERNATIONALE DU SPORT AUTOMOBILE

Homologation N°

A-5097

Extension N°

08 / 06 VO

FICHE D'EXTENSION A L'HOMOLOGATION OFFICIELLE FISA  
FORM OF EXTENSION TO THE OFFICIAL FISA HOMOLOGATION

**ET** Evolution normale du type: dès le numéro de châssis  
Normal evolution of the type: as from chassis number \_\_\_\_\_

**VF** Variante de fourniture / Supply variant

**VO** Variante option / Option variant

**ER** Errata / Erratum

Homologation valable dès le **- 1 JUL. 1983** en groupe **A**  
Homologation valid as from \_\_\_\_\_ in group \_\_\_\_\_

Constructeur **FORD** Modèle et type **Escort RS 1600i**  
Manufacturer \_\_\_\_\_ Model and type \_\_\_\_\_

| Page ou ext.<br>Page or ext. | Art.<br>Art. | Description<br>Description   |
|------------------------------|--------------|--|
|                              | 701          | Upated front knuckle Photo: 83-14  |
|                              | 701          | Heavy duty strut top mount (Kinematics not changed) Photo: 83-15   |
|                              | 701          | Heavy duty rear suspension tie bar Photo: 83-16  |
|                              | 701          | Heavy duty rear suspension T.C.A. with spherical ball joints Photo: 83-17  |
|                              | 701          | Heavy duty rear suspension T.C.A. with spherical ball joints and lowered, adjustable spring seat. Photo: 83-18                       |
|                              | 707 a        | Shock absorber with reinforced location and camber correction Photo: 83-19   |
|                              | 803          | Alternative brake pedal box - adjustable from cockpit<br>bi = 15,8 mm Ø, 17,8 mm Ø, 19,05 mm Ø, 20,6 mm Ø,<br>25,4 mm Ø Photo: 83-20 |
|                              | 803h         | Hydraulic handbrake assembly<br>h1 = hydraulic h2 = central on floor<br>h3 = rear Photo: 83-21                                       |

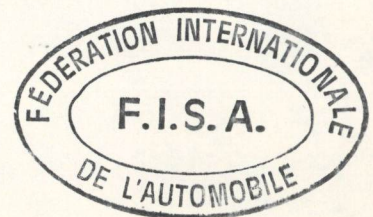

Marque  
Make

FORD

Modèle  
Model

Escort RS 1600i

N° Homol.

A-5097

08 / 06 VO

VO

N° Ext.

| Page ou ext.<br>Page or ext. | Art.<br>Art.                    | Description<br>Description  |                       |         |       |            |       |        |       |        |       |                                 |        |                       |
|------------------------------|---------------------------------|---|-----------------------|---------|-------|------------|-------|--------|-------|--------|-------|---------------------------------|--------|-----------------------|
|                              | 803                             | <table border="0"> <tr> <td>803e</td> <td>2</td> <td>803e1</td> <td>41,27 mm Ø</td> </tr> <tr> <td>803g</td> <td>2</td> <td>803g2</td> <td>1</td> </tr> <tr> <td>803g3</td> <td>Alum alloy</td> <td>803g8</td> <td>68</td> </tr> </table> <p style="text-align: right;">Photo: 83-22</p>                                  | 803e                  | 2       | 803e1 | 41,27 mm Ø | 803g  | 2      | 803g2 | 1      | 803g3 | Alum alloy                      | 803g8  | 68                    |
| 803e                         | 2                               | 803e1   | 41,27 mm Ø            |         |       |            |       |        |       |        |       |                                 |        |                       |
| 803g                         | 2                               | 803g2   | 1                     |         |       |            |       |        |       |        |       |                                 |        |                       |
| 803g3                        | Alum alloy                      | 803g8   | 68                    |         |       |            |       |        |       |        |       |                                 |        |                       |
|                              | 803                             | <table border="0"> <tr> <td>803e</td> <td>1</td> <td>803e1</td> <td>60 mm</td> </tr> <tr> <td>803g1</td> <td>2</td> <td>803g2</td> <td>1</td> </tr> <tr> <td>803g3</td> <td>Cast iron</td> <td>803g8</td> <td>110 mm</td> </tr> </table> <p style="text-align: right;">Photo: 83-23</p>                                   | 803e                  | 1       | 803e1 | 60 mm      | 803g1 | 2      | 803g2 | 1      | 803g3 | Cast iron                       | 803g8  | 110 mm                |
| 803e                         | 1                               | 803e1   | 60 mm                 |         |       |            |       |        |       |        |       |                                 |        |                       |
| 803g1                        | 2                               | 803g2   | 1                     |         |       |            |       |        |       |        |       |                                 |        |                       |
| 803g3                        | Cast iron                       | 803g8   | 110 mm                |         |       |            |       |        |       |        |       |                                 |        |                       |
|                              | 803                             | <table border="0"> <tr> <td>803e</td> <td>1</td> <td>803e1</td> <td>30 mm</td> </tr> <tr> <td>803g1</td> <td>2</td> <td>803g2</td> <td>1</td> </tr> <tr> <td>803g3</td> <td>Alum body )<br/>Cast iron yoke )</td> <td>803g8</td> <td>90 mm</td> </tr> </table> <p style="text-align: right;">Photo: 83-24</p>             | 803e                  | 1       | 803e1 | 30 mm      | 803g1 | 2      | 803g2 | 1      | 803g3 | Alum body )<br>Cast iron yoke ) | 803g8  | 90 mm                 |
| 803e                         | 1                               | 803e1   | 30 mm                 |         |       |            |       |        |       |        |       |                                 |        |                       |
| 803g1                        | 2                               | 803g2   | 1                     |         |       |            |       |        |       |        |       |                                 |        |                       |
| 803g3                        | Alum body )<br>Cast iron yoke ) | 803g8   | 90 mm                 |         |       |            |       |        |       |        |       |                                 |        |                       |
|                              | 803                             | <table border="0"> <tr> <td>803g4</td> <td>9,7 mm</td> <td>803g5</td> <td>250 mm</td> </tr> <tr> <td>803g6</td> <td>250 mm</td> <td>803g7</td> <td>150 mm</td> </tr> <tr> <td>803g9</td> <td>No</td> <td>803g10</td> <td>628,3 cm<sup>2</sup></td> </tr> </table> <p style="text-align: right;">Photo: 83-25</p>          | 803g4                 | 9,7 mm  | 803g5 | 250 mm     | 803g6 | 250 mm | 803g7 | 150 mm | 803g9 | No                              | 803g10 | 628,3 cm <sup>2</sup> |
| 803g4                        | 9,7 mm                          | 803g5   | 250 mm                |         |       |            |       |        |       |        |       |                                 |        |                       |
| 803g6                        | 250 mm                          | 803g7   | 150 mm                |         |       |            |       |        |       |        |       |                                 |        |                       |
| 803g9                        | No                              | 803g10  | 628,3 cm <sup>2</sup> |         |       |            |       |        |       |        |       |                                 |        |                       |
|                              | 803                             | <table border="0"> <tr> <td>803g4</td> <td>24,8 mm</td> <td>803g5</td> <td>260 mm</td> </tr> <tr> <td>803g6</td> <td>258 mm</td> <td>803g7</td> <td>157 mm</td> </tr> <tr> <td>803g9</td> <td>Ventilated</td> <td>803g10</td> <td>658,4 cm<sup>2</sup></td> </tr> </table> <p style="text-align: right;">Photo: 83-26</p> | 803g4                 | 24,8 mm | 803g5 | 260 mm     | 803g6 | 258 mm | 803g7 | 157 mm | 803g9 | Ventilated                      | 803g10 | 658,4 cm <sup>2</sup> |
| 803g4                        | 24,8 mm                         | 803g5   | 260 mm                |         |       |            |       |        |       |        |       |                                 |        |                       |
| 803g6                        | 258 mm                          | 803g7   | 157 mm                |         |       |            |       |        |       |        |       |                                 |        |                       |
| 803g9                        | Ventilated                      | 803g10  | 658,4 cm <sup>2</sup> |         |       |            |       |        |       |        |       |                                 |        |                       |
|                              | 804                             | Steering damper <span style="float: right;">Photo: 83-27</span>   |                       |         |       |            |       |        |       |        |       |                                 |        |                       |
|                              | 804                             | High ratio steering   |                       |         |       |            |       |        |       |        |       |                                 |        |                       |
|                              | 804a                            | Rack & Pinion   |                       |         |       |            |       |        |       |        |       |                                 |        |                       |
|                              | 804b                            | 14:7  |                       |         |       |            |       |        |       |        |       |                                 |        |                       |
|                              | 804c                            | No  |                       |         |       |            |       |        |       |        |       |                                 |        |                       |
|                              | 603D                            | Up-rated gear change linkage <span style="float: right;">Photo: 83-30</span>  |                       |         |       |            |       |        |       |        |       |                                 |        |                       |

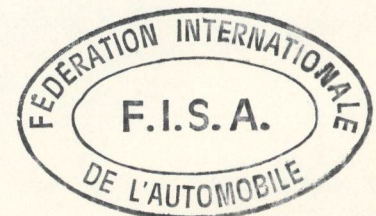

Marque  
Make

FORD

Modèle  
Model

Escort RS 1600i

N° Homol. A-5097

PHOTOS / PHOTOS

N° Ext. 08 / 06 V0



83-14

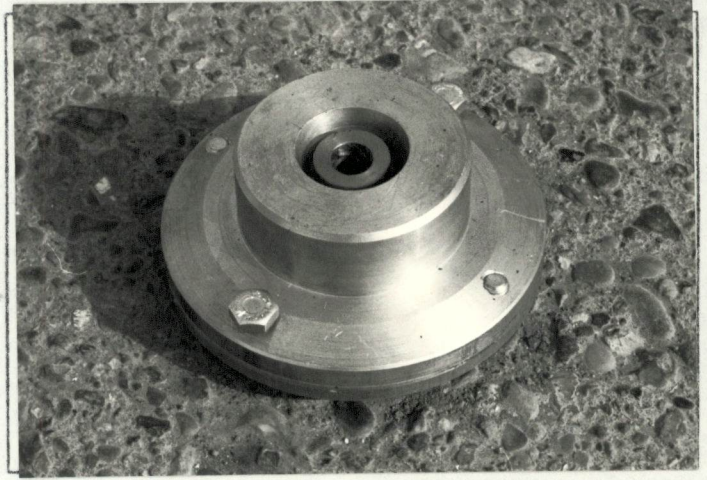

83-15



83-16

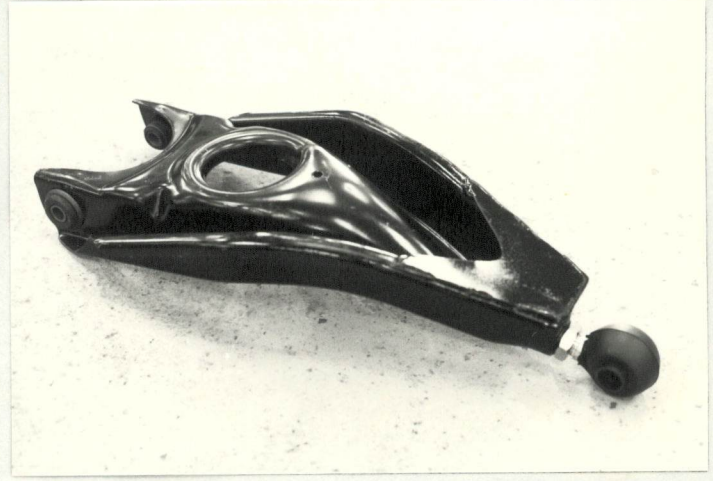

83-17



83-18

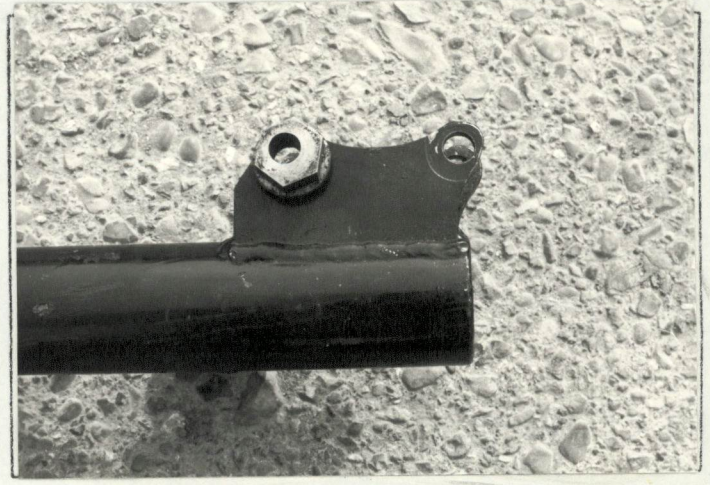

83-19



PHOTOS / PHOTOS

N° Ext. 08 / 06 V0

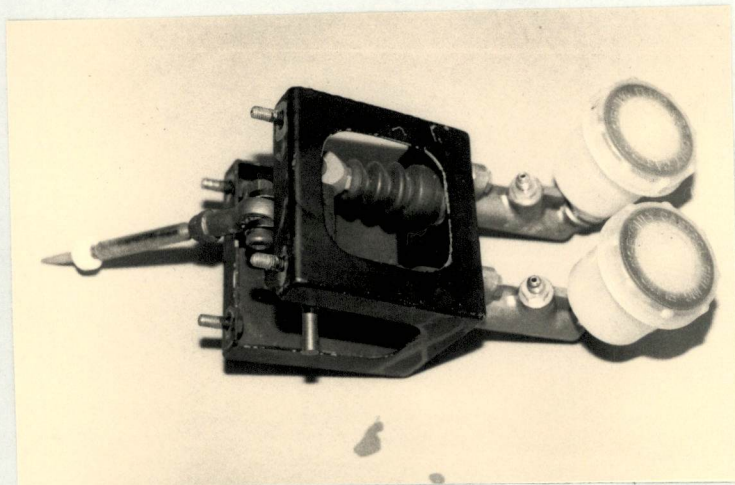

83-20

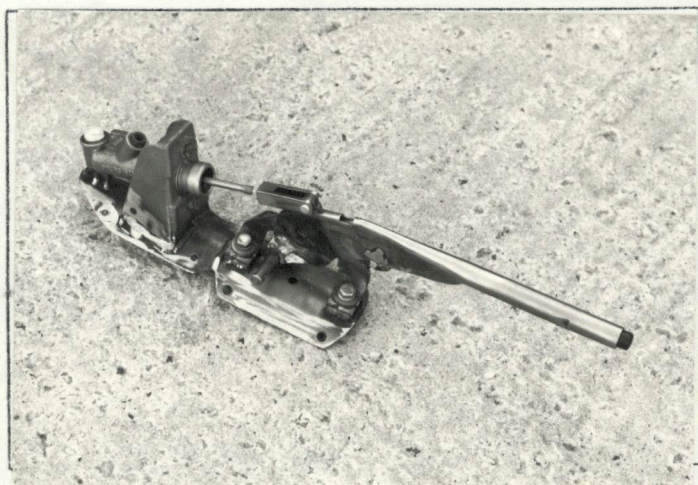

83-21



83-22



83-23



83-24



83-25

Marque FORD  
Make \_\_\_\_\_

Modèle Escort RS 1600i  
Model \_\_\_\_\_

N° Homol. A-5097

PHOTOS / PHOTOS

N° Ext. 08 / 06 V0

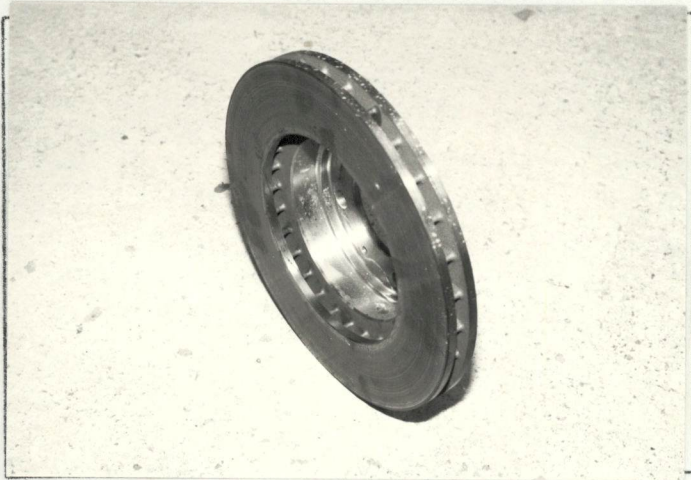

83-26

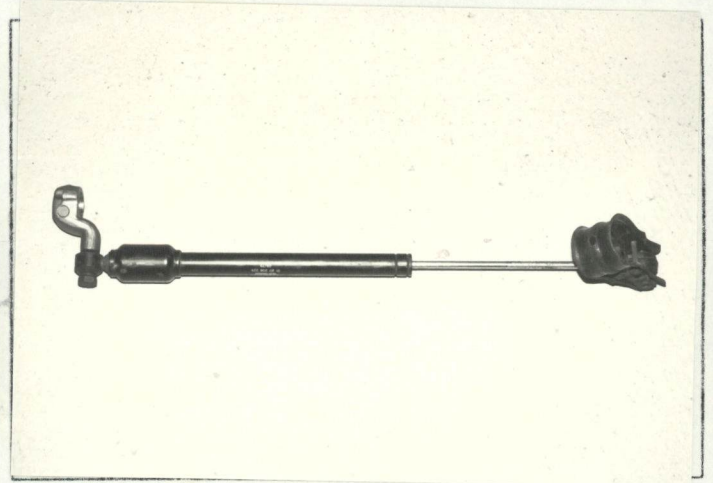

83-27

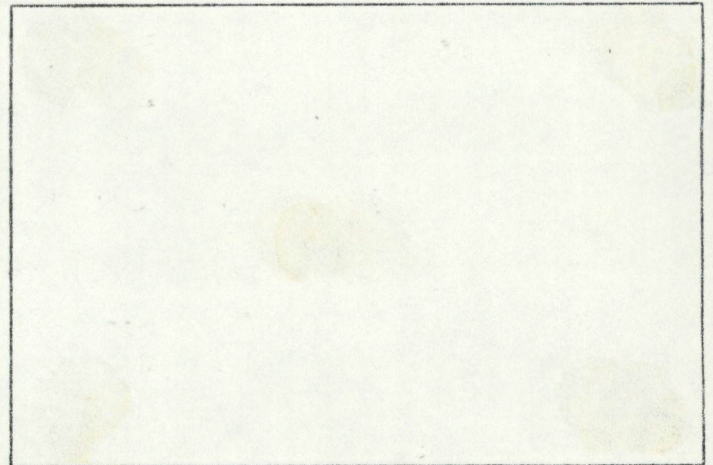
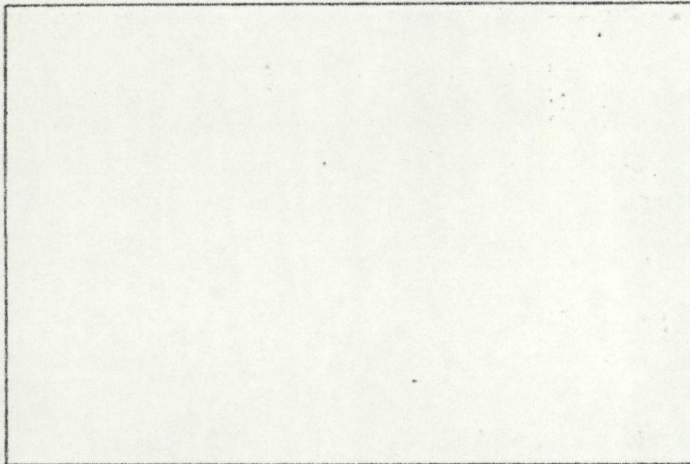

83-29



83-30

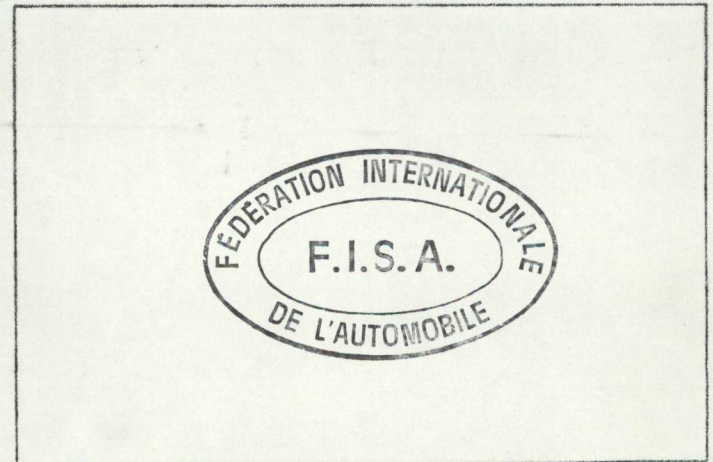



# FEDERATION INTERNATIONALE DU SPORT AUTOMOBILE

Homologation N°

A5097

Extension N°

09 / 02 ER

FICHE D'EXTENSION A L'HOMOLOGATION OFFICIELLE FISA  
FORM OF EXTENSION TO THE OFFICIAL FISA HOMOLOGATION

- ET Evolution normale du type: dès le numéro de châssis  
Normal evolution of the type: as from chassis number \_\_\_\_\_
- VF Variante de fourniture / Supply variant
- VO Variante option / Option variant
- ER Errata / Erratum

Homologation valable dès le \_\_\_\_\_ - 1 JUL. 1983 \_\_\_\_\_ en groupe A  
Homologation valid as from \_\_\_\_\_ in group \_\_\_\_\_

Constructeur FORD Modèle et type RS 1600 i  
Manufacturer \_\_\_\_\_ Model and type \_\_\_\_\_

| Page ou ext.<br>Page or ext. | Art.<br>Art. | Description<br>Description   |
|------------------------------|--------------|--|
|                              | 330c         | No. of distributors = electronic distribution, plus twin coils.  |
|                              | 324g         | Items which control fuel = mixture control unit, metering valve unit, air flow meter, warm up valve and injector, injection valve assemblies, fuel lines, fuel pump and pressure control valve, temperature/time switch : C4, measurement of air volume - Yes. |
|                              | 327b         | No. of manifd elements = 2 (originally 1)  |
|                              | 605          | Alternative final drive = 4.27 64:15<br>(originally 4.29 73:17)  |





# FEDERATION INTERNATIONALE DU SPORT AUTOMOBILE

Homologation N°

A-5097

Extension N°

10 / 01 ET

FICHE D'EXTENSION A L'HOMOLOGATION OFFICIELLE FISA  
FORM OF EXTENSION TO THE OFFICIAL FISA HOMOLOGATION

ET Evolution normale du type: dès le numéro de châssis  
Normal evolution of the type: as from chassis number \_\_\_\_\_

VF Variante de fourniture / Supply variant

VO Variante option / Option variant

ER Errata / Erratum

Homologation valable dès le \_\_\_\_\_ - 1 JUIL. 1983 \_\_\_\_\_ en groupe \_\_\_\_\_ A  
Homologation valid as from \_\_\_\_\_ in group \_\_\_\_\_

Constructeur \_\_\_\_\_ FORD \_\_\_\_\_ Modèle et type \_\_\_\_\_ Escort RS 1600i  
Manufacturer \_\_\_\_\_ Model and type \_\_\_\_\_

| Page ou ext.<br>Page or ext. | Art.<br>Art. | Description<br>Description |
|------------------------------|--------------|----------------------------|
|------------------------------|--------------|----------------------------|

Evolution of chassis mounting points for the suspension -  
as indicated below. *Displacements as regards the basic form.*

Front

Rear

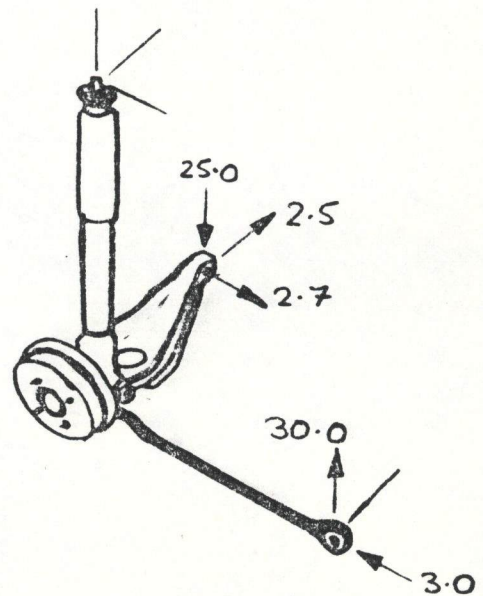
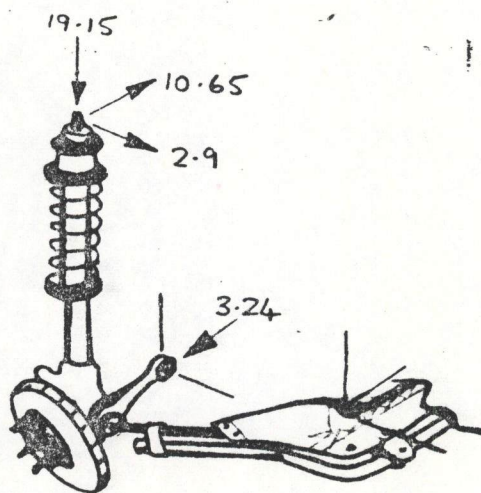

New front strut top mount - see photo: 83-29



Marque  
Make

FORD

Modèle  
Model

Escort RS 1600i

N° Homol. A- 5097

PHOTOS / PHOTOS

N° Ext. 10 / 01 ET



83-29

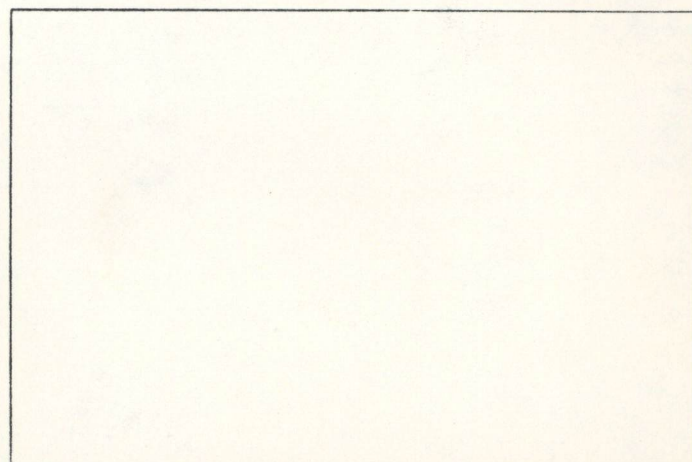
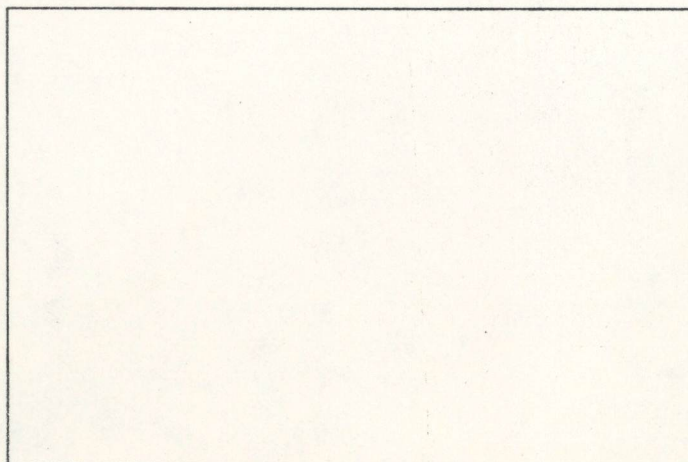
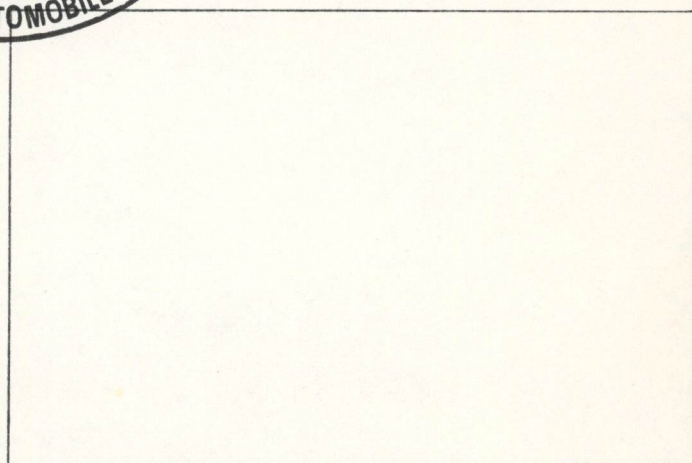
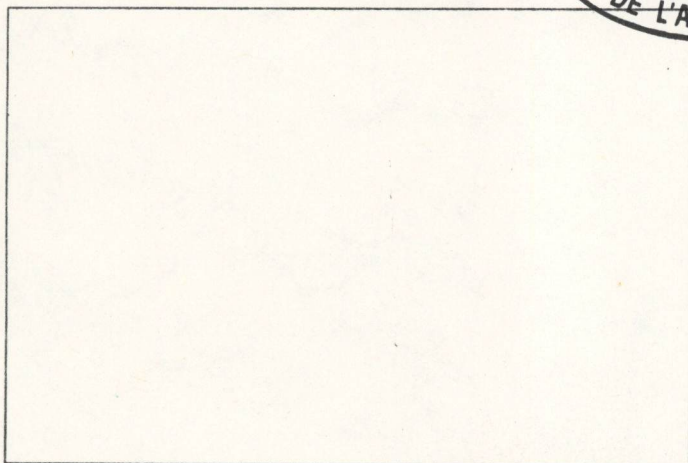
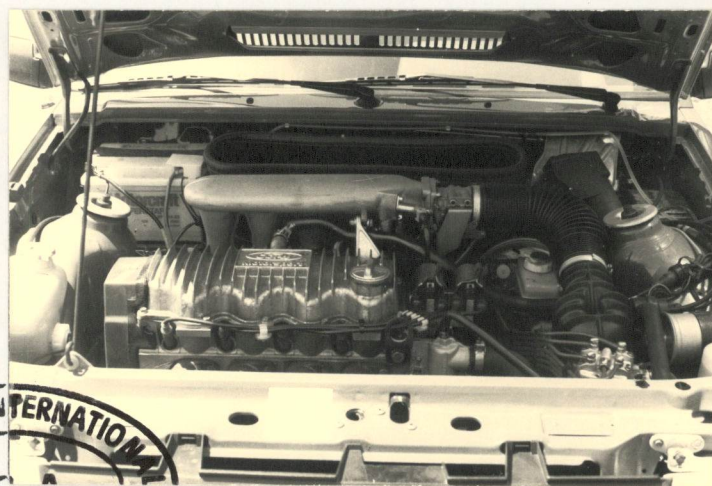



# FEDERATION INTERNATIONALE DU SPORT AUTOMOBILE

Homologation N°

A-5097

Extension N°

**11 / 03 ER**

FICHE D EXTENSION A L'HOMOLOGATION OFFICIELLE FISA  
FORM OF EXTENSION TO THE OFFICIAL FISA HOMOLOGATION

**ET** Evolution normale du type: dès le numéro de châssis  
Normal evolution of the type: as from chassis number \_\_\_\_\_

**VF** Variante de fourniture / Supply variant

**VO** Variante option / Option variant

**ER** Errata / Erratum

Homologation valable dès le 1st October 1983 en groupe A  
Homologation valid as from \_\_\_\_\_ in group \_\_\_\_\_

Constructeur FORD Modèle et type Escort RS 1600i  
Manufacturer \_\_\_\_\_ Model and type \_\_\_\_\_

| Page ou ext.<br>Page or ext. | Art.<br>Art. | Description<br>Description |
|------------------------------|--------------|----------------------------|
|------------------------------|--------------|----------------------------|

page 10

605

Alternative final drive  
= 4.727 52:11  
(originally 4.05 73:18)





# FEDERATION INTERNATIONALE DU SPORT AUTOMOBILE

Homologation N°

A-5097

Extension N°

12 / 07 VO

FICHE D'EXTENSION A L'HOMOLOGATION OFFICIELLE FISA  
FORM OF EXTENSION TO THE OFFICIAL FISA HOMOLOGATION

**ET** Evolution normale du type: dès le numéro de châssis  
Normal evolution of the type: as from chassis number \_\_\_\_\_

**VF** Variante de fourniture / Supply variant

**VO** Variante option / Option variant

**ER** Errata / Erratum

**- 1 FEV. 1984**

Homologation valable dès le \_\_\_\_\_ en groupe \_\_\_\_\_  
Homologation valid as from \_\_\_\_\_ in group A

Constructeur FORD Modèle et type Escort RS 1600i  
Manufacturer \_\_\_\_\_ Model and type \_\_\_\_\_

| Page ou ext.<br>Page or ext. | Art.<br>Art. | Description<br>Description   |
|------------------------------|--------------|--|
|                              | 606          | Alternative heavy duty drive shafts with intermediate bearing. - see photo 83-34                               |
|                              | 606          | Alternative constant velocity joint bolted - see photo 83-35   |
|                              | 701          | Heavy duty track control arm and reinforced mounting. - see photo 83-36  |
|                              | 701          | Alternative rear anti-roll bar - see photo 83-37   |
|                              | 701          | Rear spring seat adjustable - see photo 83-31  |
|                              | 804          | Power assisted steering<br>Ratios: 1) 19.5:1<br>2) 14.7:1 (same as non-assisted steering)<br>- see photo 83-32 |
| 04/03 VO                     | 603          | heavy duty gearbox case for supplementary gears<br>- see photo 83-33   |

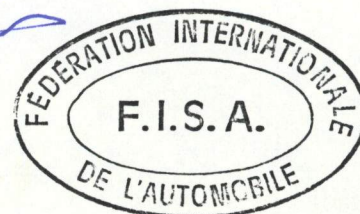

Marque FORD  
Make \_\_\_\_\_

Modèle Escort RS 1600i  
Model \_\_\_\_\_

N° Homol. A-5097

PHOTOS / PHOTOS

N° Ext. 12 / 07 V0

V0

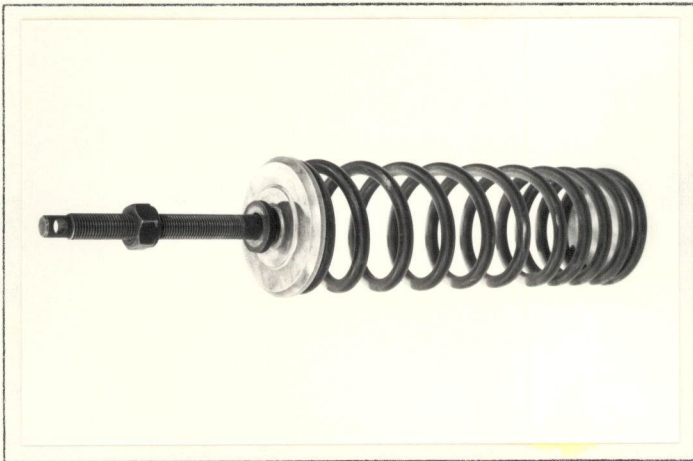

83-31

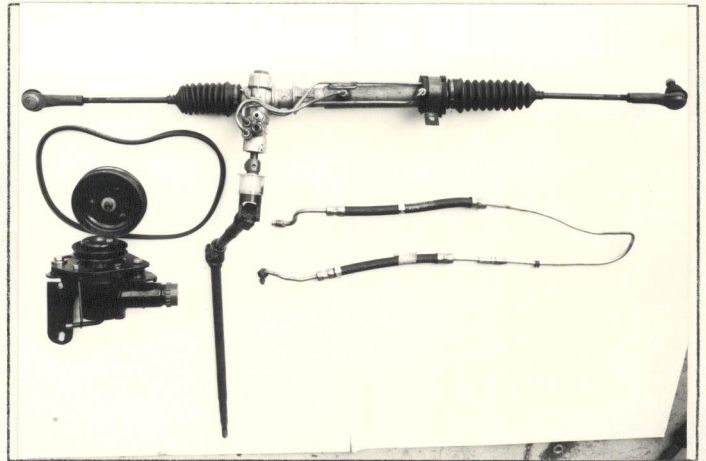

83-32

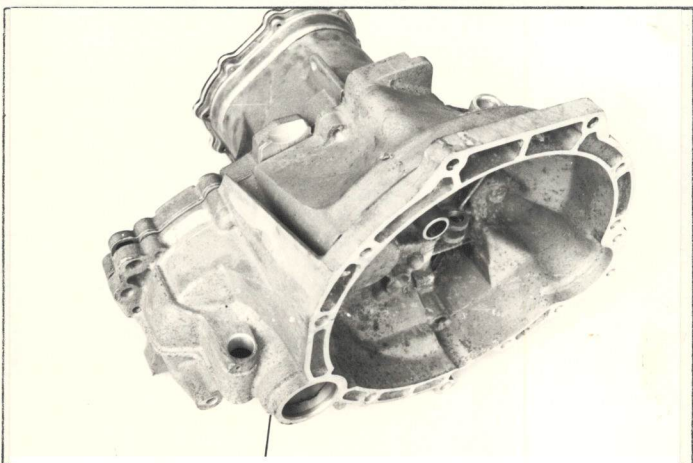

83-33

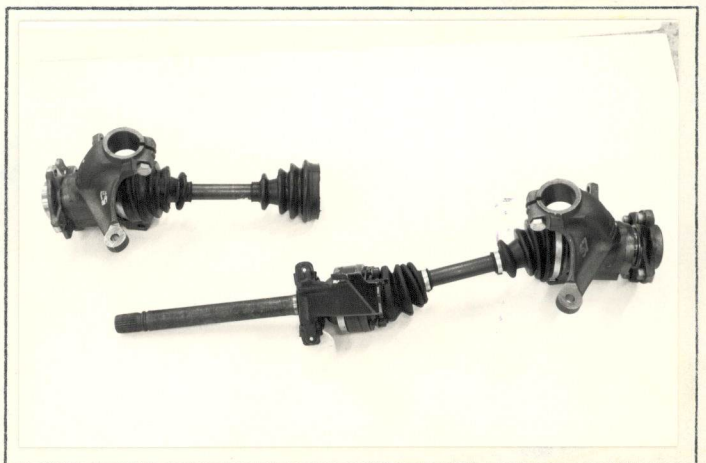

83-34

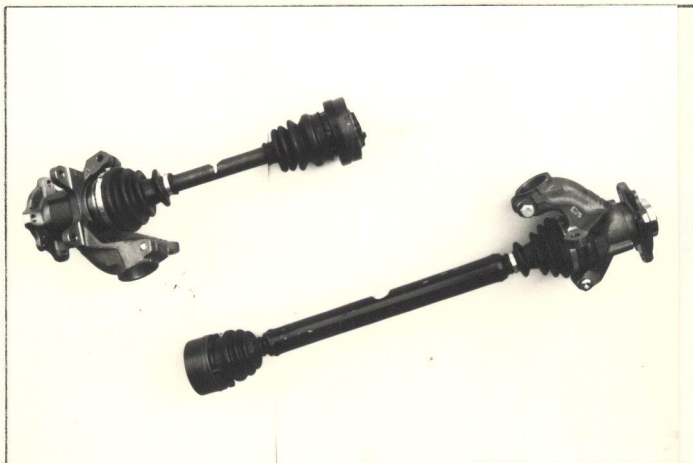

83-35

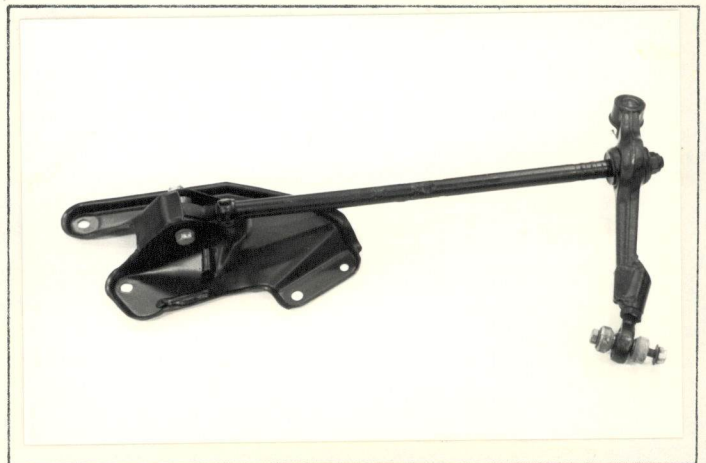

Marque FORD  
Make \_\_\_\_\_

Modèle Escort RS 1600i  
Model \_\_\_\_\_

N° Homol. A-5097

PHOTOS / PHOTOS

N° Ext. 12 / 07 VN

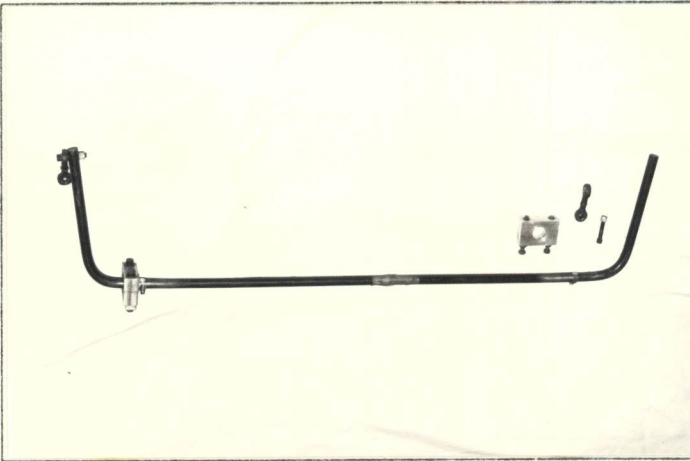

83-37

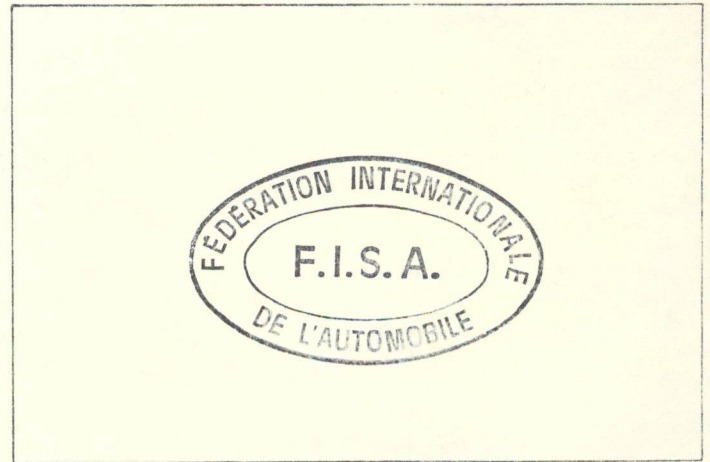
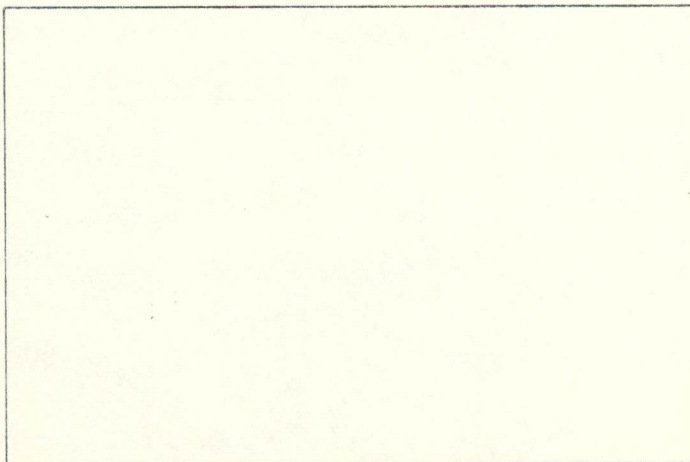
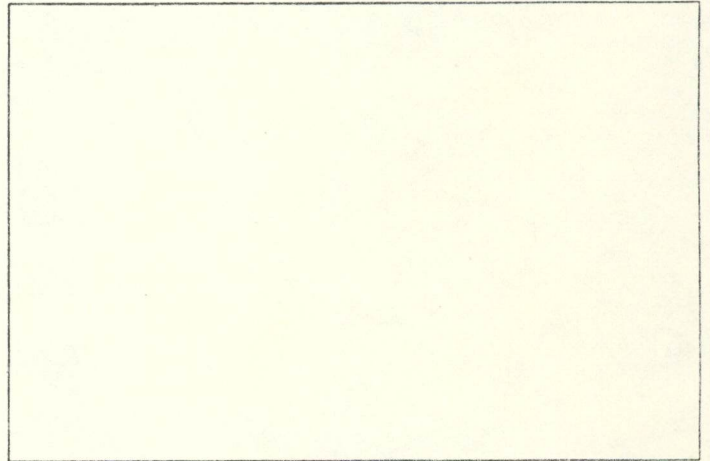
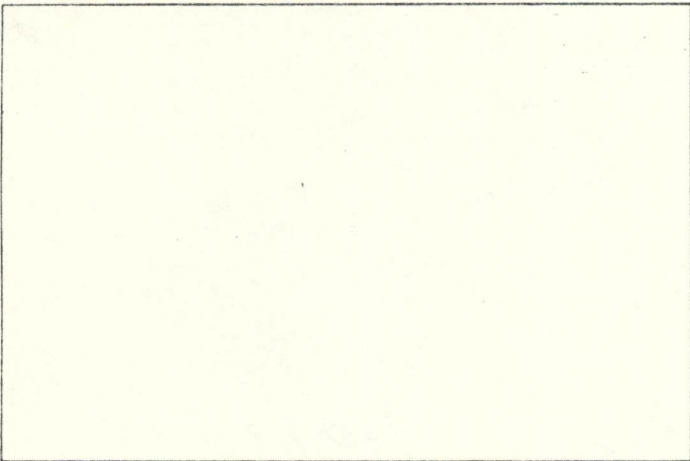
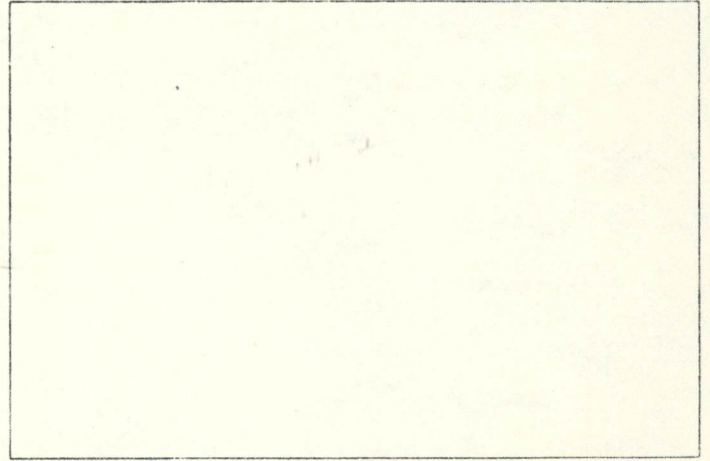



# FEDERATION INTERNATIONALE DU SPORT AUTOMOBILE

Homologation N°

**A - 5097**

Extension N°

**13 - 04 ER**

FICHE D'EXTENSION A L'HOMOLOGATION OFFICIELLE FISA  
FORM OF EXTENSION TO THE OFFICIAL FISA HOMOLOGATION

- ES** Evolution sportive du type / Sporting evolution of the type
- ET** Evolution normale du type / Normal evolution of the type
- VF** Variante de fourniture / Supply variant
- VO** Variante option / Option variant
- ER** Errata / Erratum

Homologation valable dès le 01 MARS 1985 en groupe A  
Homologation valid as from \_\_\_\_\_ in group \_\_\_\_\_

Constructeur Ford Modèle et type escort RS 1600i  
Manufacturer \_\_\_\_\_ Model and type \_\_\_\_\_

| Page ou ext.<br>Page or ext. | Art.<br>Art. | Description<br>Description                   |
|------------------------------|--------------|--|
| 12                           | photo J      | ∅ de la sortie du collecteur d'échappement : |
| 12                           | photo J      | ∅ of the exhaust manifold exit. :            |
|                              |              | <u>42 ± .2 mm</u>                            |

*Reynold. Young*

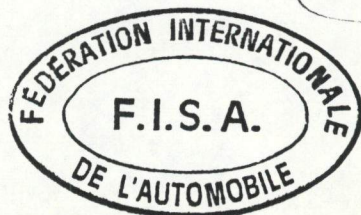

# FÉDÉRATION INTERNATIONALE DU SPORT AUTOMOBILE

ONS Oberste Nationale Sportkommission für den Automobilsport in Deutschland GmbH

Homologation Nr.

A 5097

Nachtrag Nr.  
Extension Nr.

14 - 08 VO

## Nachtrag zum offiziellen Testblatt der FISA

Form of extension to the official FISA-Homologation

VO **Ausstattungsvariante**  
Option variant

- 1 OCT. 1985

Homologation gültig ab \_\_\_\_\_ in Gruppe A/N  
Homologation valid as from \_\_\_\_\_ in group

Fahrzeughersteller FORD Modell und Typ Ford Escort RS 1600i  
Manufacturer of the car \_\_\_\_\_ Model and type \_\_\_\_\_

### Überrollbügel/-käftig

Rollbar/rollcage

Hauptbügel  
Main rollbar

Diagonalstrebe  
Longitudinal/diagonal strut

Vorderbügel  
Front rollbar

Winfried Matter GmbH, Industriegebiet, D - 7523 Graben-Neudorf  
Tel. 07255/5071 Telex: 7822215 mat d

Bügelhersteller  
Rollbar manufacturer

Material  
Material

ALZn 4,5 Mg 1

ALZn 4,5 Mg 1

ALZn 4,5 Mg 1

Außendurchmesser  
Exterior diameter

40 mm

40 mm / mm

40 mm

Wandstärke  
Wall thickness

3.5 mm

3.5 mm / mm

3.5 mm

Streckgrenze  
Elastic limit

min. 29.0 kg/mm<sup>2</sup>

min. 29.0 kg/mm<sup>2</sup> / kg/mm<sup>2</sup>

min. 29.0 kg/mm<sup>2</sup>

Zugfestigkeit  
Tensile strength

min. 35.0 kg/mm<sup>2</sup>

min. 35.0 kg/mm<sup>2</sup> / kg/mm<sup>2</sup>

min. 35.0 kg/mm<sup>2</sup>

Gesamtgewicht inkl.  
Befestigungsvorrichtungen  
Total weight including fixings

25.0 kg

Kompletter Überrollbügel/-käftig ausgebaut  
Complete rollbar/rollcage outside the car



Hiermit wird bestätigt, daß der beschriebene Überrollbügel/-käftig den Anforderungen des Anhangs J der FISA entspricht, insbesondere in Bezug auf seine Befestigungen, Verbindungen und Beanspruchungswerte.

We certify that the present rollbar/rollcage complies with the conditions of the FIA Appendix J, in particular with regard to its attachments, its connections and its stress resistances.

Unterschrift des Fahrzeugherstellers  
Signature of the car manufacturer representative

Winfried Matter GmbH  
Industriegebiet  
Tel. 07255/5071  
7523 Graben-Neudorf

Marke FORD  
Make

Modell ESCORT RS 1600i  
Model

Homologation Nr. A 5097  
Homologation Nr.

14-08V0

Fotos oder Zeichnungen der Befestigungen an der Karosserie:  
Photos or drawings of the attachments on the Body:

Nachtrag Nr. \_\_\_\_\_  
Ext. Nr.

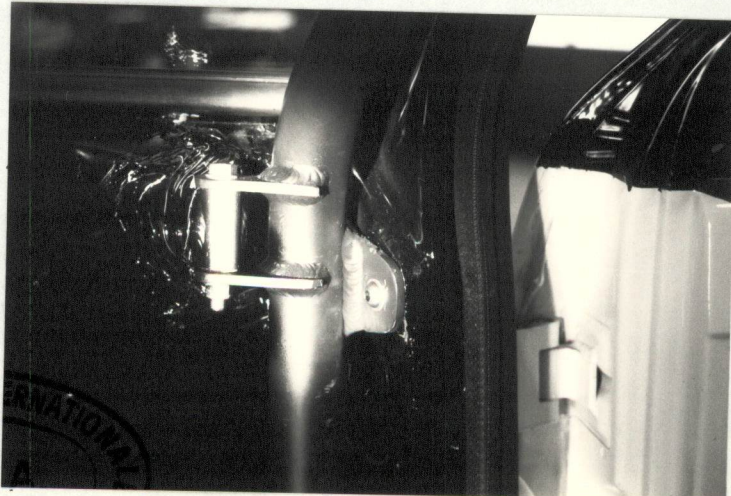
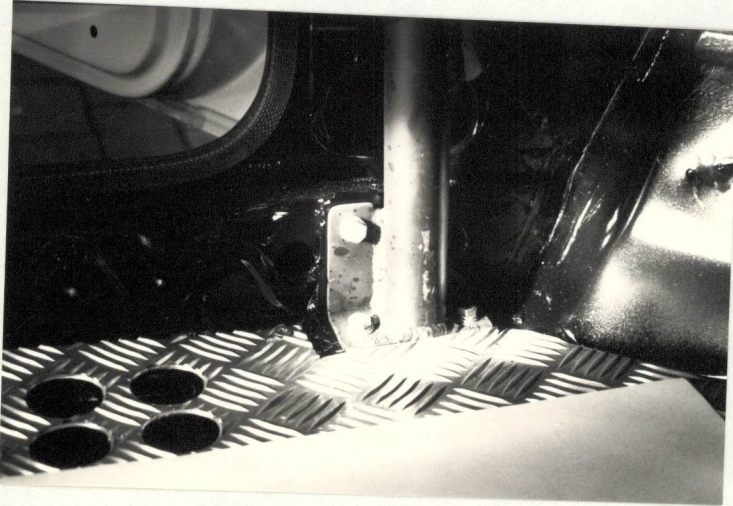
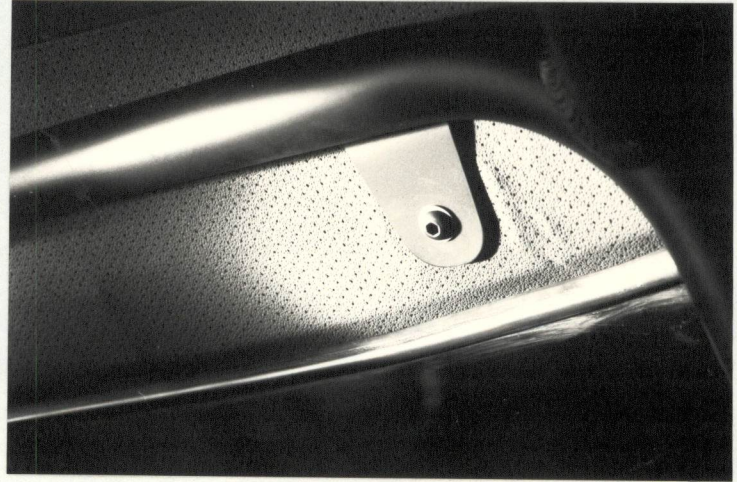
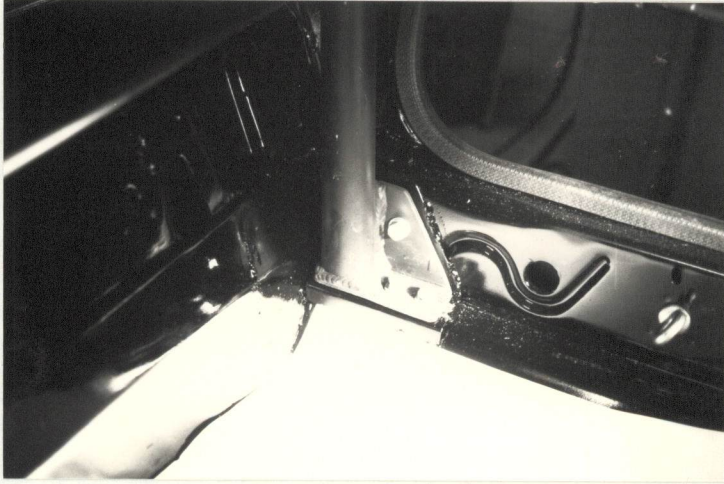

FEDERATION INTERNATIONALE  
F.I.S.A.  
DE L'AUTOMOBILE



# FEDERATION INTERNATIONALE DU SPORT AUTOMOBILE

Homologation N°

**N - 5 0 9 7 N**

FICHE COMPLEMENTAIRE D'HOMOLOGATION EN GROUPE «N»  
COMPLEMENTARY HOMOLOGATION FORM FOR GROUP «N»

Homologation valable à partir du **- 1 JAN. 1984** prononcée par **F.I.S.A.**  
Homologation valid as from \_\_\_\_\_ decided by \_\_\_\_\_

En complément de la fiche de Gr. A n° **A 5097**  
In addition to the Gr. A from n° \_\_\_\_\_

**IMPORTANT:**

La présente fiche comporte toutes informations complémentaires à la fiche d'homologation de base de Gr. A pour la participation du véhicule en groupe «N». En cas d'information contradictoire, seule l'information figurant sur la présente fiche complémentaire est à prendre en considération pour le Groupe «N».

**IMPORTANT:**

This form includes all the additional information to the basic Group A homologation form for the participation of the vehicle in Group «N». In the case of contradictory information, only the information appearing on the present additional form is to be taken into consideration for Group «N».

## 1. DEFINITIONS

101. Constructeur **Ford**  
Manufacturer \_\_\_\_\_

102. Dénomination(s) commerciale(s) — Modèle et type **Escort RS 1600i**  
Commercial name(s) — Type and model \_\_\_\_\_

103. Cylindrée totale **1597** cm<sup>3</sup>  
Cylinder capacity \_\_\_\_\_

## 2. DIMENSIONS, POIDS / DIMENSIONS, WEIGHTS

201. Poids minimum **876** kg  
Minimum weight \_\_\_\_\_

205. Hauteur minimum centre moyeu de roue /  
ouverture du passage de roue **320** mm  
Minimum height center hub /  
wheel arch opening **320** mm

AV  
Front **320** mm  
AR  
Rear **320** mm

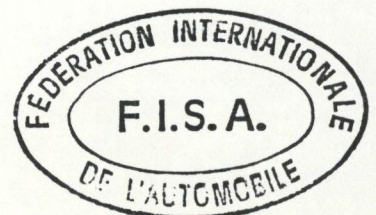
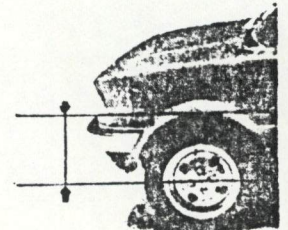

Marque Ford Modèle Escort RS 1600i N° Homol. N-5097 **N**  
 Make \_\_\_\_\_ Model \_\_\_\_\_

207. Voie maximum AV 1402 mm AR 1442 mm  
 Maximum track Front \_\_\_\_\_ mm Rear \_\_\_\_\_ mm

208. Garde au sol minimum 110 mm Endroit de la mesure Front stabiliser bar  
 Minimum ground clearance \_\_\_\_\_ mm Where measured \_\_\_\_\_

**3. MOTEUR / ENGINE**

302. Nombre de supports 3  
 Number of supports \_\_\_\_\_

308. Volume minimal total d'une chambre de combustion 41.2 cm<sup>3</sup>  
 Total minimum volume of a combustion chamber \_\_\_\_\_

309. Volume minimum d'une chambre de combustion dans la culasse 49.0 cm<sup>3</sup>  
 Minimum volume of a combustion chamber in the cylinderhead \_\_\_\_\_

310. Rapport volumétrique maximum (par rapport à l'unité) 10,7  
 Maximum compression ratio (in relation with the unit) \_\_\_\_\_

311. Hauteur minimum du bloc-cylindres 210.8 mm  
 Minimum height of the cylinder block \_\_\_\_\_

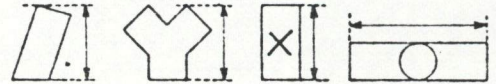

313. Chemises b) Matériau Cast Iron  
 Sleeves Material \_\_\_\_\_

317. Piston a) Matériau Aluminium Alloy  
 Piston Material \_\_\_\_\_

b) Nombre de segments 3 c) Poids minimum 520 g  
 Number of rings \_\_\_\_\_ Minimum weight \_\_\_\_\_

d) Distance de la médiane de l'axe au sommet du piston 47,8 mm  
 Distance from gudgeon pin center line to highest point of piston crown \_\_\_\_\_

e) Distance (+/-) entre le sommet du piston au PMH et le plan de joint du bloc-cylindre +12,2 mm  
 Distance (+/-) between the top of the piston at TDC and the gasket plane of the cylinderblock \_\_\_\_\_

f) Volume de l'évidement du piston - cm<sup>3</sup>  
 Piston groove volume \_\_\_\_\_

319. Vilebrequin i) Diamètre maximum des manetons 47,9 mm  
 Crankshaft Maximum diameter of big end journals \_\_\_\_\_

320. Volant moteur 11,000 g  
 Flywheel  
 c) Poids minimum avec couronne de démarreur et embrayage complet  
 Minimum weight of the flywheel with starter ring and complete clutch \_\_\_\_\_

321. Culasse: c) Hauteur minimum 128 mm  
 Cylinderhead: Minimum height \_\_\_\_\_

d) Endroit de la mesure Top/bottom face  
 Where measured \_\_\_\_\_

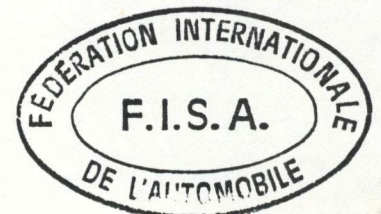

322. Epaisseur du joint de culasse serré 1,6 ± 0.3 mm  
 Thickness of the tightened cylinderhead gasket

325. Arbre à cames e) Diamètre des paliers 45,75 - 44,75 mm  
 Camshaft Diameter of bearings

g) Dimensions de la came Admission: A = 31,0 mm  
 Cam dimensions Inlet: B = 38,0 mm  
 Echappement Exhaust: A = 31,0 mm  
 Exhaust: B = 38,0 mm

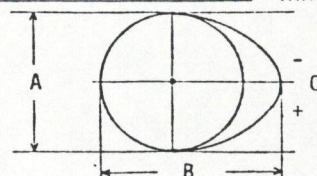

326. Distribution a) Jeu théorique pour la distribution Admission 0,2 mm Echappement 0.25 mm  
 Timing Theoretical timing clearance Inlet Exhaust

b) Avance à l'ouverture (avec jeu théorique (326 a))  
 Valves open at (with theoretical timing clearance (326 a))  
 Admission Inlet 21 ° avant/avant PMH Echappement Exhaust 58 ° avant/avant PMB  
 before/before TDC after/after BDC

c) Retard à la fermeture (avec jeu théorique (326 a))  
 Valves closes at (with theoretical timing clearance (326 a))  
 Admission Inlet 60 ° avant/avant PMB Echappement Exhaust 20 ° avant/avant PMH  
 before/before after BDC after/after TDC

d) Levée de came en mm (arbre démonté) (dessin/drawing art. 325)  
 Cam lifts in mm (dismounted camshaft)

Admission / Inlet

0 = 7,0 mm

|                        |                        |
|------------------------|------------------------|
| - 5° = <u>6,95</u> mm  | + 5° = <u>6,95</u> mm  |
| - 10° = <u>6,75</u> mm | + 10° = <u>6,75</u> mm |
| - 15° = <u>6,45</u> mm | + 15° = <u>6,45</u> mm |
| - 30° = <u>4,85</u> mm | + 30° = <u>4,85</u> mm |
| - 45° = <u>2,45</u> mm | + 45° = <u>2,45</u> mm |
| - 60° = <u>0,45</u> mm | + 60° = <u>0,45</u> mm |
| - 75° = <u>0,10</u> mm | + 75° = <u>0,10</u> mm |
| - 90° = <u>0</u> mm    | + 90° = <u>0</u> mm    |
| - 105° = _____ mm      | + 105° = _____ mm      |
| - 120° = _____ mm      | + 120° = _____ mm      |
| - 135° = _____ mm      | + 135° = _____ mm      |
| - 150° = _____ mm      | + 150° = _____ mm      |

Echappement / Exhaust

0 = 7,0 mm

|                        |                        |
|------------------------|------------------------|
| - 5° = <u>6,95</u> mm  | + 5° = <u>6,95</u> mm  |
| - 10° = <u>6,75</u> mm | + 10° = <u>6,75</u> mm |
| - 15° = <u>6,45</u> mm | + 15° = <u>6,45</u> mm |
| - 30° = <u>4,85</u> mm | + 30° = <u>4,85</u> mm |
| - 45° = <u>2,45</u> mm | + 45° = <u>2,45</u> mm |
| - 60° = <u>0,45</u> mm | + 60° = <u>0,45</u> mm |
| - 75° = <u>0,10</u> mm | + 75° = <u>0,10</u> mm |
| - 90° = <u>0</u> mm    | + 90° = <u>0</u> mm    |
| - 105° = _____ mm      | + 105° = _____ mm      |
| - 120° = _____ mm      | + 120° = _____ mm      |
| - 135° = _____ mm      | + 135° = _____ mm      |
| - 150° = _____ mm      | + 150° = _____ mm      |

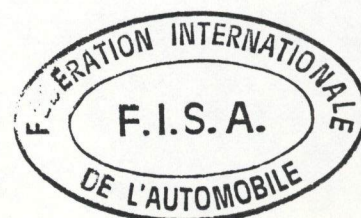

Marque  
Make

FORD

Modèle  
Model

Escort RS 1600i

N° Homol.

N - 5097

N

e) Levée de soupape en mm avec jeu théorique de distribution (art. 326 a)

Valve lift in mm with theoretical timing clearance (art. 326 a)

Admission / Inlet

Art. 326 b) = 210° avant/avant PMH  
before/before TDC = 0,0 mm

|        |   |      |    |
|--------|---|------|----|
| + 20°  | = | 0.8  | mm |
| + 40°  | = | 2.5  | mm |
| + 60°  | = | 5.7  | mm |
| + 80°  | = | 8.2  | mm |
| + 100° | = | 10.1 | mm |
| + 120° | = | 11.1 | mm |
| + 140° | = | 11.3 | mm |
| + 160° | = | 10.5 | mm |
| + 180° | = | 8.9  | mm |
| + 200° | = | 6.6  | mm |
| + 220° | = | 4.0  | mm |
| + 240° | = | 1.4  | mm |
| + 260° | = | 0.1  | mm |
| + 280° | = | 0.0  | mm |
| + 300° | = |      | mm |
| + 320° | = |      | mm |
| + 340° | = |      | mm |
| + 360° | = |      | mm |

Echappement / Exhaust

Art. 326 b) = 58° avant/avant PMH  
before/before BDC = 0,0 mm

|        |   |      |    |
|--------|---|------|----|
| + 20°  | = | 1.1  | mm |
| + 40°  | = | 3.5  | mm |
| + 60°  | = | 6.1  | mm |
| + 80°  | = | 8.3  | mm |
| + 100° | = | 9.9  | mm |
| + 120° | = | 10.8 | mm |
| + 140° | = | 11.0 | mm |
| + 160° | = | 10.1 | mm |
| + 180° | = | 8.4  | mm |
| + 200° | = | 6.1  | mm |
| + 220° | = | 3.4  | mm |
| + 240° | = | 1.0  | mm |
| + 260° | = | 0.0  | mm |
| + 280° | = |      | mm |
| + 300° | = |      | mm |
| + 320° | = |      | mm |
| + 340° | = |      | mm |
| + 360° | = |      | mm |

**327. Admission** h) Nombre de ressorts par soupape

**Inlet** Number of springs per valve 1

|  |             |  |             |    |
|--|-------------|--|-------------|----|
| i) Caractéristiques des ressorts: Sous une charge de | <u>31</u>   | kg, la longueur max. du ressort est de | <u>36</u>   | mm |
| Spring characteristics: Under a load of              |             | kg, the max. length of the spring is   |             | mm |
| Caractéristiques des ressorts: Sous une charge de    | <u>75</u>   | kg, la longueur max. du ressort est de | <u>26</u>   | mm |
| Spring characteristics: Under a load of              |             | kg, the max. length of the spring is   |             | mm |
| k) Diamètre extérieur des ressorts                   | <u>32,7</u> | mm                                     |             |    |
| Exterior diameter of the springs                     |             |  |             |    |
| m) Diamètre du fil des ressorts                      | <u>4,3</u>  | mm                                     |             |    |
| Diameter of spring wire                              |             |  |             |    |
|  |             | l) Nombre de spires des ressorts       | <u>5,75</u> | mm |
|  |             | Number of spring coils                 |             |    |
|  |             | n) Longueur libre maximum des ressorts | <u>43,5</u> | mm |
|  |             | Maximum free length of the springs     |             |    |

**328. Echappement**

**Exhaust**

|  |             |  |             |    |
|--|-------------|--|-------------|----|
| c) Diamètre de(s) sortie(s) du collecteur            | <u>42</u>   | mm                                     |             |    |
| Diameter of the manifold exit(s)                     |             |  |             |    |
| k) Caractéristiques des ressorts: Sous une charge de | <u>75</u>   | kg, la longueur max. du ressort est de | <u>26</u>   | mm |
| Spring characteristics: Under a load of              |             | kg, the max. length of the spring is   |             | mm |
| l) Diamètre extérieur des ressorts                   | <u>32,7</u> | mm                                     |             |    |
| Exterior diameter of the springs                     |             |  |             |    |
| n) Diamètre du fil des ressorts                      | <u>4,3</u>  | mm                                     |             |    |
| Diameter of spring wire                              |             |  |             |    |
|  |             | i) Nombre de ressorts par soupape      | <u>1</u>    |    |
|  |             | Number of springs per valve            |             |    |
|  |             | m) Nombre de spires des ressorts       | <u>5,75</u> |    |
|  |             | Number of spring coils                 |             |    |
|  |             | o) Longueur libre maximum des ressorts | <u>43,5</u> | mm |
|  |             | Maximum free length of the springs     |             |    |

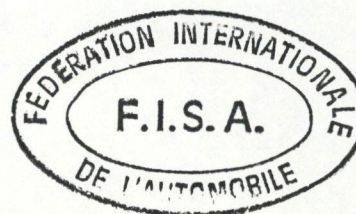

Marque Ford Modèle Escort RS 1600i N° Homol. N-5097 **N**

329. Système anti-pollution a) ~~oui~~/non  
Anti pollution system Yes/no  
b) Description  
Description \_\_\_\_\_

330. Système d'allumage d) Nombre de bobines 2  
Ignition system Number of coils \_\_\_\_\_

331. Capacité du circuit de refroidissement 7,8 L  
Cooling system capacity \_\_\_\_\_

332. Ventilateur de refroidissement a) Nombre 1 b) Diamètre de l'hélice 280 mm  
Cooling fan Number \_\_\_\_\_ Diameter of the screw \_\_\_\_\_ mm  
c) Matériau de l'hélice Polypropylene d) Nombre de pales 4  
Material of the screw \_\_\_\_\_ Number of blades \_\_\_\_\_  
e) Type de connection Electric f) Ventilateur débrayable oui/~~non~~  
Type of connection \_\_\_\_\_ Automatic cut in yes/~~no~~

333. Système de lubrification c) Capacité totale 3,75 L  
Lubrification system Total capacity \_\_\_\_\_ L  
d) Radiateur(s) d'huile oui/~~non~~ Nombre 1  
Oil radiator(s) yes/~~no~~ Number \_\_\_\_\_  
e) Emplacement du/des radiateurs near oil filter  
Position of the radiator(s) \_\_\_\_\_

4. CIRCUIT DE CARBURANT / FUEL CIRCUIT

401. Réservoir e) Emplacement des orifices Off side rear wing  
Fuel tank Filler holes location \_\_\_\_\_

402. Pompe(s) à essence a)  Electrique  Mécanique  
Fuel pump(s)  Electrical  Mechanical  
b) Nombre 1 c) Marque et type Bosch, electric  
Number \_\_\_\_\_ Make and type \_\_\_\_\_  
d) Emplacement Under floor e) Débit maximum 2,0 l/mn  
Location \_\_\_\_\_ Maximum flow \_\_\_\_\_ l/mn  
régime moteur 1000 t/mn

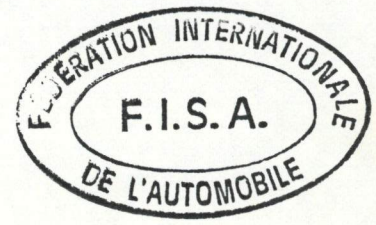



**7. SUSPENSION / SUSPENSION**

**702. Ressorts hélicoïdaux**  
**Helical springs**

|   | AV / Front                                | AR / Rear                                 |
|---|---|---|
|   | Steel                                     | Steel                                     |
| a) Matériau<br>Material                           |   |   |
| b) Type progressif<br>Progressive type            | <del>XXX</del> /non<br><del>YES</del> /no | <del>oui</del> /non<br><del>yes</del> /no |
| c) Longueur libre minimale<br>Minimal free length | 259 mm                                    | 258 mm                                    |
| d) Nombre de spires<br>Number of coils            | 7,6                                       | 8,13                                      |
| e) Diamètre du fil<br>Diameter of the wire        | 11,3 mm                                   | 10,9 mm                                   |
| f) Diamètre extérieur<br>Exterior diameter        | 108 mm                                    | 105,8 mm                                  |

g) Caractéristiques des ressorts: Sous une charge de 251 kg, la longueur min. du ressort AV est de 141 mm  
 Spring characteristics: Under a load of 251 kg, the min. length of the front spring is 141 mm  
 Sous une charge de 210 kg, la longueur min. du ressort AR est de 154 mm  
 Under a load of 210 kg, the min. length of the rear spring is 154 mm

**703. Ressorts à lames**  
**Leaf springs**

A = Lame maîtresse / X = lame auxiliaire  
 2 = 2e lame / 3 = 3e lame / 4 = 4e lame / 5 = 5e lame

A = major leaf / X = auxiliary leaf  
 2 = 2nd leaf / 3 = 3rd leaf / 4 = 4th leaf / 5 = 5th leaf

- a) Matériau  
Material
- b) Nombre d'étriers  
Number of spring hangers
- c) Longueur libre minimum  
Minimum free length
- d) Largeur maximum  
Maximum width
- e) Epaisseur  
Thickness
- f) Courbure verticale maximale  
Maximum vertical curve

| A        | 2        | 3        |
|----------|----------|----------|
| _____    | _____    | _____    |
| _____    | _____    | _____    |
| _____ mm | _____ mm | _____ mm |
| _____ mm | _____ mm | _____ mm |
| _____ mm | _____ mm | _____ mm |
| _____ mm | _____ mm | _____ mm |

- a) Matériau  
Material
- b) Nombre d'étriers  
Number of spring hangers
- c) Longueur libre minimum  
Minimum free length
- d) Largeur maximum  
Maximum width
- e) Epaisseur  
Thickness
- f) Courbure verticale maximale  
Maximum vertical curve

| 4        | 5        | X        |
|----------|----------|----------|
| _____    | _____    | _____    |
| _____    | _____    | _____    |
| _____ mm | _____ mm | _____ mm |
| _____ mm | _____ mm | _____ mm |
| _____ mm | _____ mm | _____ mm |
| _____ mm | _____ mm | _____ mm |

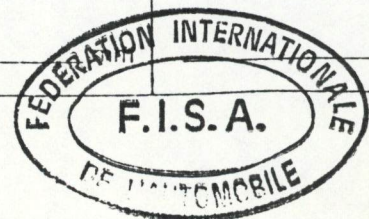

Marque Ford  
 Make \_\_\_\_\_

Modèle Escort RS 1600i  
 Model \_\_\_\_\_

N° Homol. **N-5097** **N**

**704. Barre de torsion**  
**Torsion bar**

- a) Longueur efficace  
 Effective length  
 mesurée de:  
 measured from:  
 à:  
 to:
- b) Diamètre efficace  
 Effective diameter  
 mesuré à:  
 measured at:
- c) Matériau  
 Material

| AV / Front | AR / Rear |
|------------|-----------|
| _____ mm   | _____ mm  |
| _____      | _____     |
| _____      | _____     |
| _____ mm   | _____ mm  |
| _____      | _____     |
| _____      | _____     |

**706. Stabilisateur**  
**Stabilizer**

- a) Longueur efficace  
 Effective length
- b) Diamètre efficace  
 Effective diameter
- c) Matériau  
 Material

| AV / Front               | AR / Rear                |
|--------------------------|--------------------------|
| 485 _____ mm             | _____ mm                 |
| 25,4 _____ mm            | _____ mm                 |
| Steel tube               | _____                    |
| _____ mm                 | _____ mm                 |
| <del>non</del><br>yes/no | <del>non</del><br>yes/no |
| 215 _____ mm             | _____ mm                 |
| _____ mm                 | _____ mm                 |

**707. Amortisseurs**  
**Shock absorbers**

- d) Diamètre extérieur  
 Exterior diameter
- e) Assiette du ressort réglable  
 Adjustable spring trim
- f) Distance assiette-fixation  
 Distance trim-monitoring
- g) Diamètre de la tige de piston  
 Diameter of the piston rod

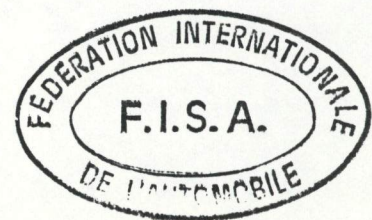

Marque / Make Ford

Modèle / Model Escord RS 1600i

N° Homol. N-5097 N

**8. TRAIN ROULANT / RUNNING GEAR**

**801. Roues / Wheels**

- a) Diamètre / Diameter
- b) Largeur / Width
- c) Marque et type / Make and type
- d) Matériau / Material
- e) Poids unitaire / Unitary weight
- f) Dépot entre plan de montage et extrémité intérieure / Offset between mounting and extreme inner face

| AV / Front | AR / Rear  | Secours / Spare |
|------------|------------|-----------------|
| 15 "       | 15 "       | 15 "            |
| 381 mm     | 381 mm     | 381 mm          |
| 6 "        | 6 "        | 6 "             |
| 152 mm     | 152 mm     | 152 mm          |
| Ford       | Ford       | Ford            |
| Alum alloy | Alum alloy | Alum alloy      |
| 8 kg       | 8 kg       | 8 kg            |
| 125 mm     | 125 mm     | 125 mm          |

802. Emplacement de la roue de secours / Location of the spare wheel

In boot

**9. CARROSSERIE / BODYWORK**

901. Intérieur / Interior

c) Climatisation / Air conditioning ~~XXX~~/non / ~~XXX~~/no

- d) Sièges / Seats
- d1) Type / Type
- d2) Appuie-tête / Headrest
- d3) Poids / Weight

| AR / Rear                              | AV / Front                       |
|--|----------------------------------|
| Bench                                  | Separate seats                   |
| <del>XXX</del> non / <del>XXX</del> no | oui/non / yes/no <u>Optional</u> |
| 16.5 kg                                | 13 kg                            |

d4) Siège AR rabattable / Car rear seat be folded oui/~~non~~ / yes/~~no~~

e) Plage arrière / Rear ledge oui/~~non~~ / yes/~~no~~

e1) Matériau / Material Resinated felt

902. Extérieur / Exterior

n) Essuie-glace AR / Rear wiper oui/~~non~~ / yes/~~no~~ Optional

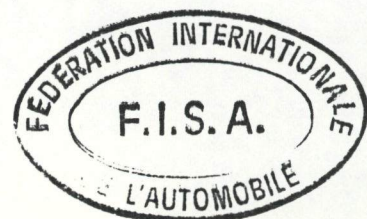

**PHOTOS / PHOTOS**

**Moteur / Engine**

AA) Piston de profil  
Piston profile



BB) Echappement complet  
Complete exhaust system

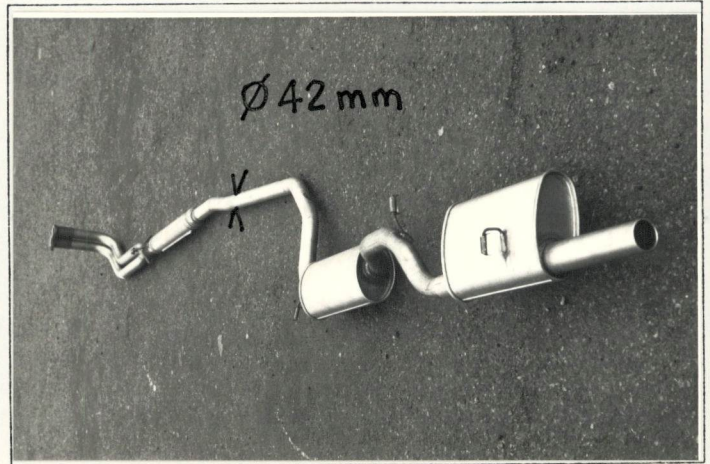

**Transmission / Transmission**

CC) Embrayage complet  
Complete clutch

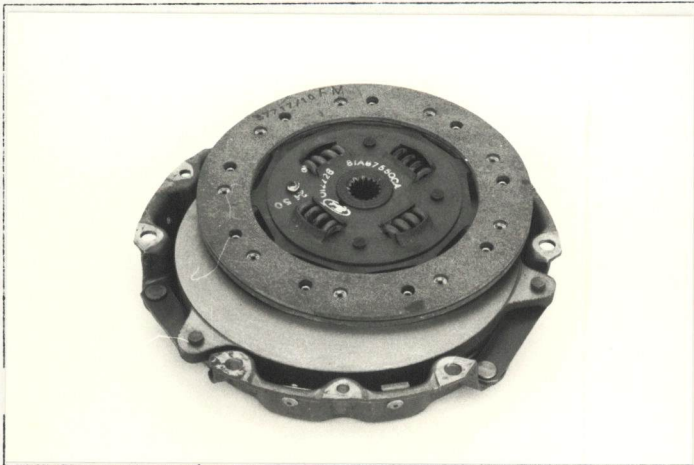

**Train roulant / Running gear**

DD) Roue nue (vue de 3/4)  
Bare wheel (3/4 view)

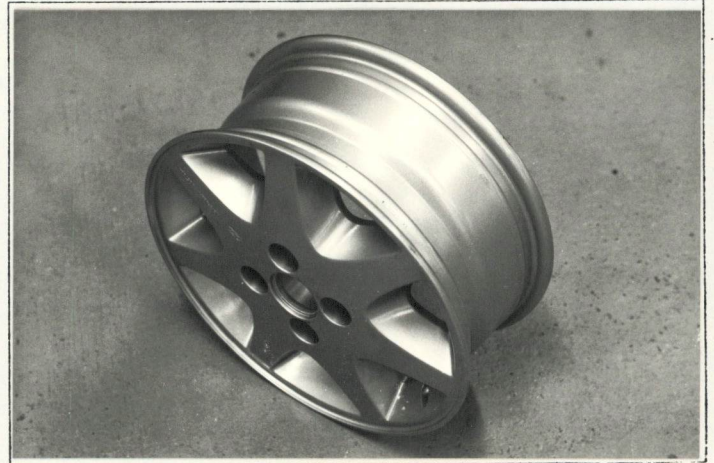

EE) Roue de secours dans son emplacement  
Spare wheel in its location



**Carrosserie / Bodywork**

FF) Siège démonté avec ses accessoires  
Dismounted seat with its accessories

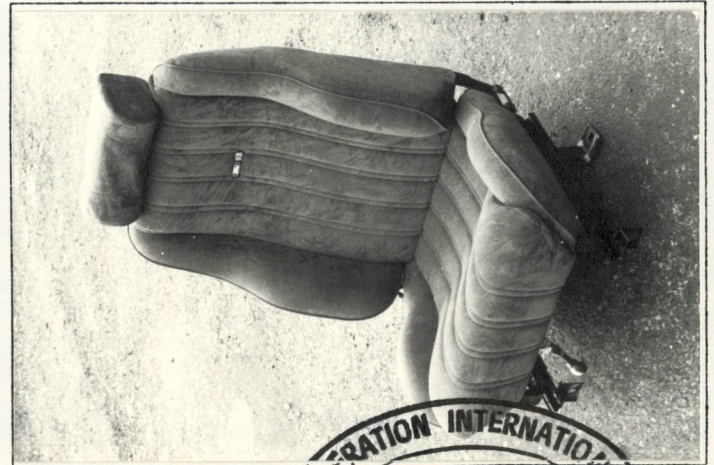



# FEDERATION INTERNATIONALE DU SPORT AUTOMOBILE

Homologation N°

N - 5097

Extension N°

01 / 01 ER

FICHE D'EXTENSION A L'HOMOLOGATION OFFICIELLE FISA  
FORM OF EXTENSION TO THE OFFICIAL FISA HOMOLOGATION

ET Evolution normale du type: dès le numéro de châssis  
Normal evolution of the type: as from chassis number \_\_\_\_\_

VF Variante de fourniture / Supply variant

VO Variante option / Option variant

ER Errata / Erratum

Homologation valable dès le 01 OCT. 1984 en groupe  
Homologation valid as from \_\_\_\_\_ in group N

Constructeur FORD Modèle et type ESCORT RS 1600i  
Manufacturer \_\_\_\_\_ Model and type \_\_\_\_\_

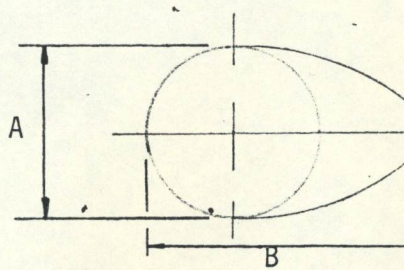
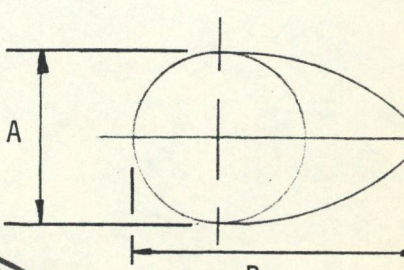
| Page ou ext.<br>Page or ext. | Art.<br>Art. | Description<br>Description  |
|------------------------------|--------------|---|
| 3                            | 325(g)       | <p>Cam Dimensions Read</p> <p>INLET A = 31.0mm<br/>B = 38.0mm</p> <p>EXHAUST<br/>A = 31.0mm<br/>B = 38.0mm</p>                       |
|                              |              | <p><i>SHOULD</i></p> <p>Cam Dimensions Read</p> <p>INLET A = 30.0mm<br/>B = 37.0mm</p> <p>EXHAUST<br/>A = 30.0mm<br/>B = 37.0mm</p>  |



*[Handwritten signature]*