



JAPAN AUTOMOBILE FEDERATION

社団法人 日本自動車連盟

有効年月日 1973年9月30日
F. I. A. Recognition No. 5568
Group |

COMMISSION SPORTIVE FEDERATION INTERNATIONALE DE L'AUTOMOBILE

01305 05.1173
INTERNATIONALE

Form of recognition in accordance with Appendix J to the International Sporting Code.

国際スポーツ法典付則J項及びJAF国内競技車両規則に従った公認書式。

Manufacturer 製造会社名	NISSAN MOTOR CO., LTD.	Cylinder-capacity 総排気量	Reciprocation 1,428 cm ³ 87.1 cu.in. Special cm ³ cu.in.
Serial No of chassis 製造開始シャーシ型式番号	PB(L)210-000001	Model 型式及び通称名	PB(L)210 DATSUN SUNNY 1400
engine 製造開始エンジン型式番号	L14-000001	Manufacturer	NISSAN
Recognition is valid from	1.6.76	Manufacturer	NISSAN
		List	

The manufacturing of the model described in this recognition form was started on MAR. 1973 and the minimum production of 5,000 identical cars, in accordance with the specifications of this form was reached on MAY. 1973

Photograph A, 3/4 view of car from front 写真A, 全体写真(斜め前方)



The vehicle described in this form has been subject to the following amendments :

Variants

on	19	rec. No.	List
on	19	rec. No.	List
on	19	rec. No.	List
on	19	rec. No.	List
on	19	rec. No.	List

Normal evolution of the type

on	19	rec. No.	List
on	19	rec. No.	List
on	19	rec. No.	List
on	19	rec. No.	List
on	19	rec. No.	List

Stamp and signature of the JAF

JAF公認印及び署名

難波靖雄

Yasuharu Nanba



Stamp and signature

[Handwritten signature]

Make NISSAN

Model PB(L)210

F.I.A. Rec. No. 5568

IMPORTANT - the underlined items must be stated in two measuring systems, one of which must be the metric system. See conversion table hereafter.

CAPACITIES AND DIMENSIONS
仕様諸元

1. <u>Wheelbase</u> ホイールベース	234.0	cm	92.1	inches
2. <u>Front track</u> フロント(前)	125.5	cm	49.4	inches *
3. <u>Rear track</u> リア(後)	124.5	cm	49.0	inches *
4. Overall length of the car 全長	404.5	cm	159.2	inches
5. Overall width of the car 全幅	154.5	cm	60.8	inches
6. Overall height of the car 全高	137.0	cm	53.9	inches
7. Capacity of fuel tank (reserve included) 燃料タンク容量	11.6	Gallon US	44	ltrs Gallon Imp.
8. Seating capacity 定員	5			
9. Weight, total weight of the car with normal equipment, water, oil and spare wheel but without fuel nor repair tools 車両重量(冷却水、オイル、スペアタイヤを含む標準状態の車両重量、但し燃料、車載工具を除く)	840	kg	1,852	lbs cwt

* Differences in track caused by the use of other wheels with different rim widths must be stated when recognition is requested for the wheels concerned.

** Specify ground clearance in relation to the track and give drawing of two fixed points of the vehicle's structure at which
車両の標準状態を示すためのサイドメンバー前端及び後端に於ける地上高
measurements are taken.

These ground clearance dimensions are only for information when checking the track and can in no way affect the eligibility of the car.

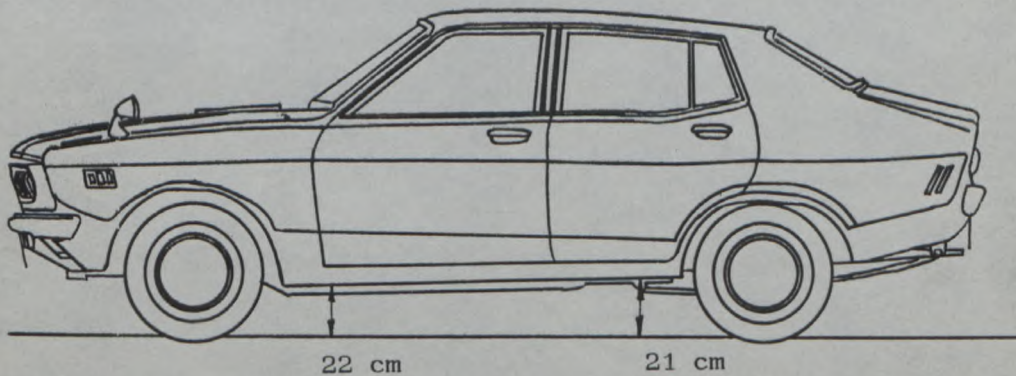

*** Width of the car measured in the vertical plane passing through the axle of the wheels.

車軸上の車体幅	Front フロント	154.2	cm	Rear リア	154.5	cm
---------	---------------	-------	----	------------	-------	----

CONVERSION TABLE

1 inch / pouce	2.54	cm	1 quart US	0.9464	ltrs
1 foot / pied	30.4794	cm	1 pint (pt)	0.568	ltrs
1 square inch / pouce carre	6.452	cm ²	1 gallon imp.	4.546	ltrs
1 cubic inch / pouce cube	16.387	cm ³	1 gallon US	3.785	ltrs
1 pound / livre (lb)	453.59	gr	1 hundred weight (cwt)	50.802	kg



Make NISSAN

Model PB(L)210
型式

CHASSIS AND COACHWORK (Photographs A, B and C)

FISA - Transfert en Gr.A

- 20 Chassis / body construction : ~~XXXXXXXXX~~ / unitary construction
~~XXXXXXXXXX~~ / 一体構造
- 21 Unitary construction, material (s) Steel
- 22 Separate constructions: material (s) of chassis
- 23 Material (s) of coachwork
- 24 Number of doors 4 Material (s) Steel
- 25 Material (s) of bonnet Steel
- 26 Material (s) of boot lid Steel
- 27 Material (s) of rear-window Glass
- 28 Material (s) of windscreen Glass (LAMINATED)
- 29 Material (s) of front-door windows Glass
- 30 Material (s) of rear-door windows Glass
- 31 Sliding system of door windows Vertical. manual
- 32 Material (s) of rear-quarter light

ACCESSORIES AND UPHOLSTERY
アクセサリ

- 38. Interior heating : yes - ~~XXX~~
- 39. Air-conditioning : ~~XXX~~ - no
- 40. Ventilation : yes - ~~XXX~~
- 41. Front seats, type of seats and upholstery Separate Vinyl
- 42. Weight of front seat (s), complete with supports and rails, out of the car :
フロントシートの重量 (ブラケット、シートレール付)
13 X 2 kg lbs
- 43. Rear seats, type of seats and upholstery Bench Vinyl
- 44. Front bumper, material (s) Steel Weight 4.5 kg lbs
- 45. Rear bumper, material (s) Steel Weight 3.4 kg lbs

WHEELS
ホイール

- 50. Type Pressed steel
- 51. Weight (per wheel, without tyre) 6.1 kg lbs
- 52. Method of attachment 4 Nuts
- 53. Rim diameter 330 mm 13 inches
- 54. Rim width 102 mm 4 inches

STEERING
ステアリング

- 60. Type Recirculating ball
- 61. Servo-assistance : ~~XXX~~ - no
- 62. Number of turns of steering wheel from lock to lock 3.2
- 63. In case of servo-assistance



Make NISSAN

Model PB(L)210
型式

J.A.F.公認番号 T-214

F.I.A. Rec. No. 5568

FISA - Transfert en Gr.A

SUSPENSION
サスペンション

- 70. Front suspension (photogr. D), type
フロントサスペンションの形式
- 71. Type of spring
スプリングの種類
- 72. Stabiliser (if fitted)
スタビライザーの形式
- 73. Number of shockabsorbers 2
ショックアブソーバーの数
- 78. Rear suspension (photogr. E), type
リヤサスペンションの形式
- 79. Type of spring
スプリングの種類
- 80. Stabiliser (if fitted)
スタビライザーの形式
- 81. Number of shockabsorbers 2
ショックアブソーバーの数

Mcpherson

Coil

Torsion bar

74. Type Hydraulic telescopic
形式

Rigid axle

Leaf

82. Type Hydraulic telescopic
形式

BRAKES (photographs F and G)
ブレーキ

- 90. System
作動方式
- 91. Servo-assistance (if fitted), type
サーボシステムの形式
- 92. Number of hydraulic master cylinders 1
マスターシリンダーの数

Hydraulic

Vacuum

1

- 93. Number of cylinders per wheel
ホイール当りのシリンダー数

- 94. Bore of wheel cylinder (s)
ホイールシリンダーの内径

Drum Brakes
ドラムブレーキ

- 95. Inside diameter
ドラムの内径

- 96. Length of brake linings
ライニングの長さ

- 97. Width of brake linings
ライニングの幅

- 98. Number of shoes per brake
ブレーキ当りのシューの数

- 99. Total area per brake
1ブレーキ当りの総摩擦面積

Disc brakes
ディスクブレーキ

- 100. Outside diameter
ディスクの外径

- 101. Thickness of disc
ディスクの厚さ

- 102. Length of brake linings
パッドの長さ

- 103. Width of brake linings
パッドの幅

- 104. Number of pads per brake
ブレーキ当りのパッドの数

- 105. Total area per brake
1ブレーキ当りの総摩擦面積

FRONT
フロント
1

REAR
リヤ
1

	FRONT フロント 1			REAR リヤ 1		
93. Number of cylinders per wheel						
94. Bore of wheel cylinder (s)	51.1	mm	in.	20.6	mm	in.
95. Inside diameter		mm	in.	203	mm	in.
96. Length of brake linings		mm	in.	195	mm	in.
97. Width of brake linings		mm	in.	35	mm	in.
98. Number of shoes per brake				2		
99. Total area per brake		mm ²	sq. in.	13,650	mm ²	sq. in.
100. Outside diameter	232	mm	in.		mm	in.
101. Thickness of disc	10	mm	in.		mm	in.
102. Length of brake linings	63	mm	in.		mm	in.
103. Width of brake linings	41	mm	in.		mm	in.
104. Number of pads per brake	2					
105. Total area per brake	5,000	mm ²	sq. in.		mm ²	sq. in.



Make NISSAN

Model PB(L)230
 型式

FISA - Transfert en Gr.A

ENGINE (photographs J and K) **

130. Cycle	4	131. Number of cylinders	4		
132. Cylinder arrangement	In-line				
133. Bore	83.0 mm	134. Stroke	66.0 mm	2.60 in.	
135. Capacity per cylinder			357.10 cm ³	21.792 cu. in.	
136. Total cylinder-capacity			1,428 cm ³	87.17 cu. in.	
137. Material (s) of cylinder block	Cast-iron				
138. Material (s) of sleeves (if fitted)				Number fitted	1
139. Cylinder-head, material (s)	Cast-iron				
140. Number of inlet ports	4	141. Number of exhaust ports	4		
142. Compression ratio	9.0				
143. Volume of one combustion chamber			44.6 cm ³		cu. in.
144. Piston, material	Aluminum alloy	145. Number of rings		3	
146. Distance from gudgeon pin centre line to highest point of piston crown	38 mm				inches
147. Crankshaft : casted / stamped		148. Type of crankshaft	integral	XXXXXX	
149. Number of crankshaft main bearings	5		一体式	XXXXXX	
150. Material of bearing cap	Cast-iron				
151. System of lubrication : dry sump oil in sump					quarts US
152. Capacity, lubricant	4.6 ltrs				pts
153. Oil cooler : yes / no		154. Method of engine cooling	Water		quarts US
155. Capacity of cooling system	6.0 ltrs				pints
156. Cooling fan (if fitted), dia.	330 mm				inches
157. Number of blades of cooling fan	4				
Bearings **					
158. Crankshaft main, type	Plain	Dia.	55 mm		in.
159. Connecting rod big end,	Plain	Dia.	50 mm		in.
Weights **					
160. Flywheel (clean)	9.5 kg				lbs
161. Flywheel with clutch (all turning parts)			12.3 kg		lbs
162. Crankshaft	13.4 kg	163. Connecting rod	0.66 kg		lbs
164. Piston with rings and pin	0.52 kg				lbs

** for additional information concerning Wankel rotary engines see page 15, 16
 ロータリーエンジンは15、16頁参照



Make NISSAN

Model PB(L) 210
型式

J.A.F.公認番号 T-214

F.I.A. Rec. No. 5568

FISA * Transfert en Gr.A

FOUR STROKE ENGINES *, **

4サイクルエンジン

- 170. Number of camshafts **1**
カムシャフトの数
- 172. Type of camshaft drive **Chain**
カムシャフトの駆動方式
- 173. Type of valve operation **SOHC : Rocker arm**
バルブの作動方式

171. Location **Cylinder head**
カムシャフトの位置

INLET (see page 8) *, **
吸気系

- 180. Material(s) of inlet manifold **Aluminum alloy**
マニホールドの材質
- 181. Diameter of valves **38** mm **1.50** inches
バルブの径
- 182. Max. valve lift **10** mm **0.39** in. 183. Number of valve springs **1**
バルブリフト
バルブスプリングの数
- 184. Type of spring **Coil** 185. Number of valves per cylinder **1**
バルブスプリングの種類
シリンダー当りのバルブの数
- 186. Tappet clearance for checking timing (cold) **0.25** mm **inches**
- 187. Valves open at (with tolerance for tappet clearance indicated) **B.T.D.C $8^{\circ} \pm 3^{\circ}$**
- 188. Valves close at (with tolerance for tappet clearance indicated) **A.B.D.C $44^{\circ} \pm 3^{\circ}$**
- 189. Air filter, type **Dry**

EXHAUST (see page 8) *, **
排気系

- 195. Material(s) of exhaust manifold **Cast-iron**
マニホールドの材質
- 196. Diameter of valves **33** mm **1.30** inches
バルブの径
- 197. Max. valve lift **10** mm **0.39** in. 198. Number of valve springs **1**
バルブリフト
バルブスプリングの数
- 199. Type of spring **Coil** 200. Number of valves per cylinder **1**
バルブ・スプリングの種類
シリンダー当りのバルブの数
- 201. Tappet clearance for checking timing (cold) **0.30** mm **inches**
- 202. Valves open at (with tolerance for tappet clearance indicated) **B.B.D.C $50^{\circ} \pm 3^{\circ}$**
- 203. Valves close at (with tolerance for tappet clearance indicated) **A.T.D.C $10^{\circ} \pm 3^{\circ}$**

CARBURETION (photograph N)
気化器

- 210. Number of carburetors fitted **1** 211. Type **Down-draft**
キャブレターの数
形式
- 212. Make **NIHONKIKAKI** 213. Model **213282**
製造会社
型式
- 214. Number of mixture passages per carburettor **2**
- 215. Flange hole diameter of exit port(s) of carburettor **28 & 32** mm **in**
キャブレター出口内径
- 216. Minimum dimensions of mixture passage(s) with piston at max. height (example: SU)
ベンチュリーの最小寸法 (SUなどはピストン最上部で測定) **21 & 28** mm **inches**

INJECTION (if fitted)
燃料噴射

- 220. Make of pump
ポンプの製造会社
- 222. Model or type of pump
- 224. Location of injectors
ノズルの位置
- 225. Minimum diameter of inlet pipe
吸気管の最小径
- 221. Number of plungers
プランジャーの数
- 223. Total number of injectors
ノズルの総数

*) for additional information concerning two-stroke engines and super-charged engines see page 14.
2サイクルエンジン、過給機付エンジンは14頁参照

* *) for additional information concerning Wankel rotary engines see page 15, 16.
ロータリーエンジンは15、16頁、参照



Make NISSAN

Model PB(L)210
型式

J·A·F 公認番号 T-214
F.I.A. Rec. No. 5568
FISA - Transfert en Gr. A

ENGINE ACCESSORIES

230. Fuel pump : ~~mechanical~~ ~~electrical~~
燃料ポンプ ~~機械式~~ ~~電気式~~
232. Type of ignition system **Make & break**
点火方式
234. No. of ignition coils **1**
コイルの数
236. Generator, type: ~~direct~~ **alternator**-number fitted **1**
発電機 ~~直流~~ **交流** 数
238. Voltage of generator **12** volts
発電機電圧
240. Location **Engine room**
バッテリー位置
241. Voltage of battery **12** volts
バッテリー電圧

231. No. fitted **1**
ポンプの数
233. No. of distributors **1**
ディストリビューターの数
235. No. of spark plugs per cylinder ~~1~~ **1**
シリンダー当りのプラグ数 ~~(XXXXXX)~~
237. Method of drive **V-Belt**
駆動方式
239. Battery, number **1**
バッテリーの数

ENGINE AND CAR PERFORMANCES (as declared by manufacturer in catalogue)

250. Max. engine output **85 PS** (type of horsepower: JIS) at **6,000** rpm
251. Maximum rpm **6,500 rpm** output at that figure **80 PS**
252. Maximum torque **11.8 kg-m** at **3,600** rpm
253. Maximum speed of the car **155** km/hour **miles / hour**

255. Cam profile
カムプロフィール

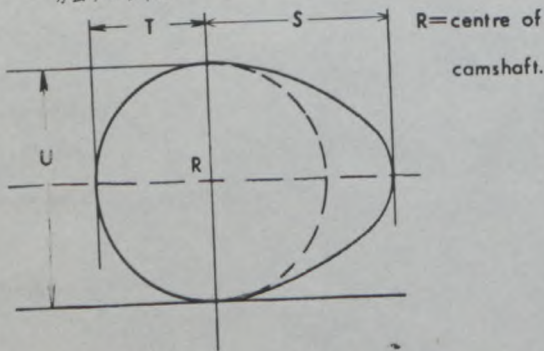

Inlet cam

吸気カム				
S =	23.5	mm	0.93	inches
T =	16.5	mm	0.65	inches
U =	33.1	mm	1.30	inches

Exhaust cam

排気カム				
S =	23.5	mm	0.93	inches
T =	16.5	mm	0.65	inches
U =	33.1	mm	1.30	inches



Make NISSAN

Model PB(L)210
型式

Drawing inlet manifold ports, side of cylinder-head / ~~housing~~ scale or dimensions and manufacturing tolerance.

吸気マニホールドのポート (シリンダーヘッド側)

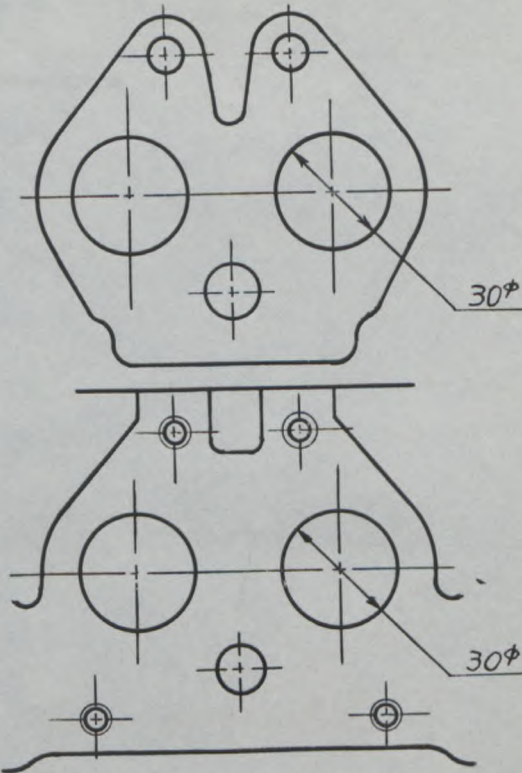

Drawing of entrance to inlet port of cylinder-head / ~~housing~~ scale or dimensions and manufacturing tolerance.

シリンダーヘッドの吸気ポート (吸気マニホールド側)

Drawing exhaust manifold ports, side of cylinder-head / ~~housing~~ scale or dimensions and manufacturing tolerance.

排気マニホールドのポート (シリンダーヘッド側)

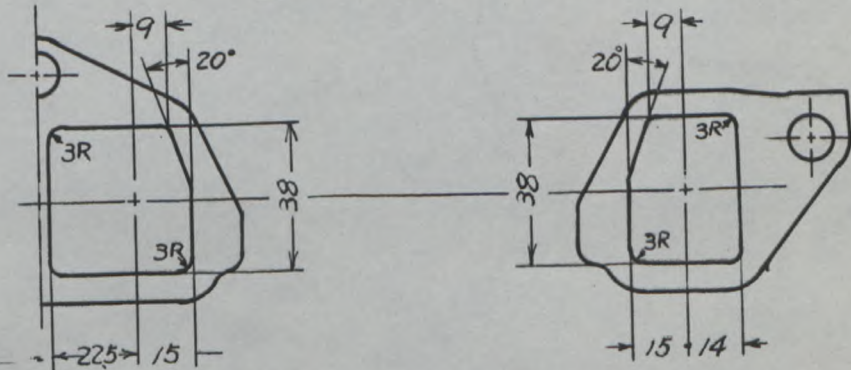

Drawing of exit to exhaust port of cylinderhead / ~~housing~~. Indicate scale or dimensions and manufacturing tolerance.

シリンダーヘッドの排気ポート (排気マニホールド側)

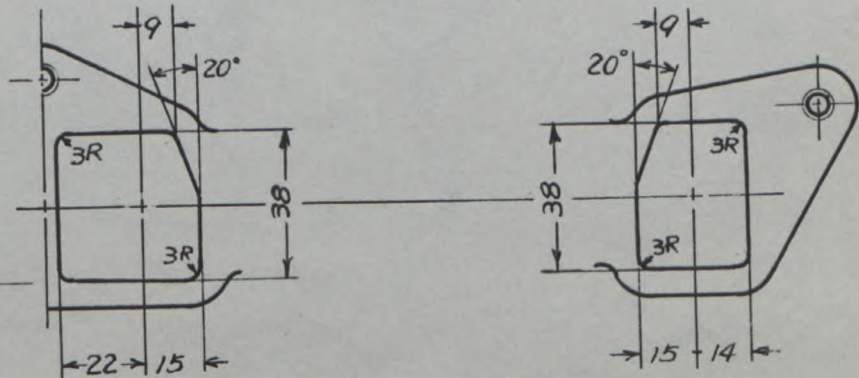

Unit: mm

~~XXXXXX~~



Make NISSAN

Model PB(L)210
型式

J.A.F 公認番号 T-214
F.I.A. Rec. No. 5568

FISA - Transfert en Gr.A

DRIVE TRAIN

駆動系

CLUTCH

クラッチ

260. Type of clutch 形式 Dry plate
261. No. of plates プレッシュャープレートの数 1
262. Dia. of clutch plates 180 mm inches
263. Dia. of linings, inside 125 mm in. outside 180 mm in.
264. Method of operating clutch 作動方式 Hydraulic

GEAR BOX (photograph H)
トランスミッション

270. Manual type, make 手動式の製造会社名 NISSAN
271. No. of gear-box ratios forward 前進段数 4
272. Synchronized forward ratios 1,2,3 & 4
273. Location of gear-shift シフトレバーの位置 Floor
274. Automatic, make 自動式の製造会社名 NISSAN
275. No. of forward ratios 前進段数 3
276. location of gear-shift シフトレバーの位置 Floor
Method of operation 作動方式 Mechanical
type 形式 3N71B

277.	Manual 手動		Automatic 自動		Alternative manual 手動		Alternative automatic 自動	
	Ratio ギヤー比	No. teeth 歯数	Ratio ギヤー比	No. teeth 歯数	Ratio ギヤー比	No. teeth 歯数	Ratio ギヤー比	No. teeth 歯数
1	3.66	$\frac{32}{21} \times \frac{36}{15}$	2.46	$2 + \frac{33}{72}$	2.00	 		
2	2.18	$\frac{32}{21} \times \frac{30}{21}$	1.46	$1 + \frac{33}{72}$	1.86	 		
3	1.42	$\frac{32}{21} \times \frac{27}{29}$	1.00		1.81	 		
4	1.00				1.00	 		
5								
6								
reverse リバース	3.64	$\frac{32}{21} \times \frac{18}{21} \times \frac{39}{14}$	2.18	$\frac{72}{33}$		31 17 39 22 22 14		



278. Overdrive, type オーバードライブ形式
279. Forward gears on which overdrive can be selected オーバードライブの作動段数
280. Overdrive ratio オーバードライブ比

FINAL DRIVE

ファイナル

290. Type of final drive 形式 Hypoid gear
291. Type of differential 差動機形式 Bevel gear
292. Type of limited slip differential (if fitted) リミテッドスリップデフの形式
293. Final drive ratio ギヤー比 3.89 4.38
Number of teeth 歯数 35/9 35/8



Make NISSAN

Model PB(L)210

T-214
5568

COMMISSION SPORTIVE
F.I.A. Rec. No.

00030 08.3.74

INTERNATIONALE

Optional equipment affecting preceding information. This to be stated together with reference to the preceding information.

The following items have been added.

FISA - Transfert en Gr.A

L14 MODEL ENGINE

* Thickness of head gasket when compressed		1.2	mm
** Reboring dimensions		0.15	mm
133. <u>Max bore</u>	83.3	mm	3.28 in.
135. <u>Max capacity per cylinder</u>	359.75	cm	21.953 cu.in.
136. <u>Max total, cylinder-capacity</u>	1,439	cm	87.81 cu.in.

Photograph

A, 3/4 view of car from front



B, 3/4 view of car from rear



C, Interior view of car through driver's door (open) with dashboard



C, Interior view of car through driver's door (open) with dashboard



C, Interior view of car through driver's door (open) with dashboard



C, Interior view of car through driver's door (open) with dashboard



Make NISSAN

Model PB(L)210
型式

F.I.A. Rec. No.

5568

Photograph

写真

B, 3/4 view of car from rear 全体写真(斜め後方)



C, Interior view of car through driver's door (open or removed) with dashboard 運転席附近



D, Front axle complete, removed from car. Without wheels. フロントサスペンション



E, Rear axle complete without wheels, removed from car. リアサスペンション

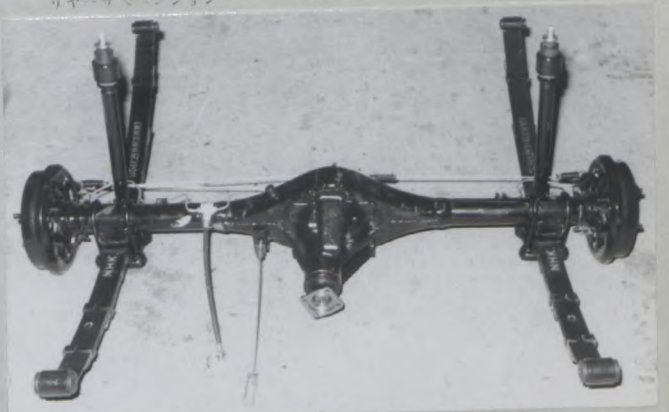

F, Front brake. ~~リヤブレーキ~~ disc with caliper(s) フロントブレーキ



G, Rear brake, drum removed ~~フロントブレーキ~~ リヤブレーキ

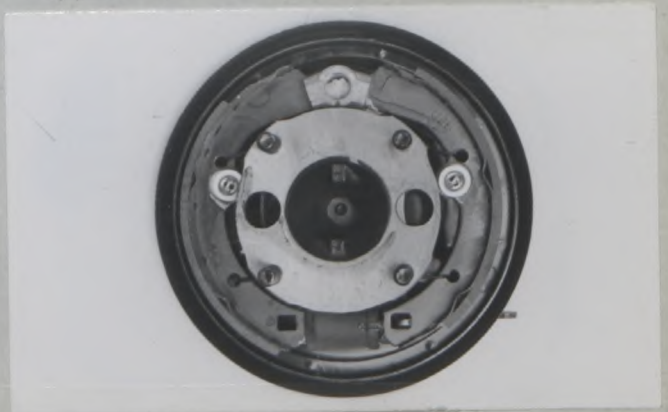

H, Gear-box, view from side トランスミッション

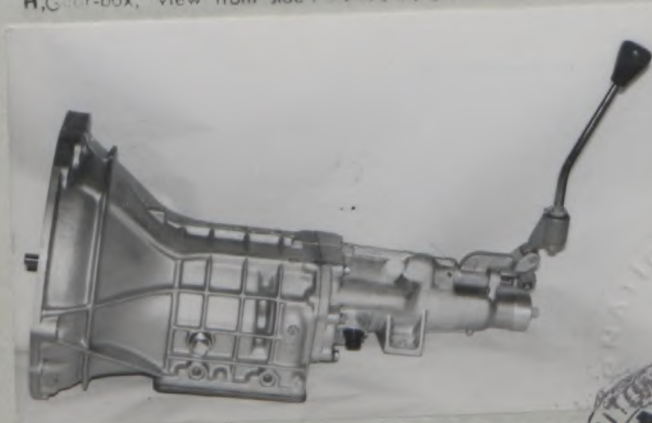

I, Silencer + exhaust pipes after exhaust manifold. 排気系

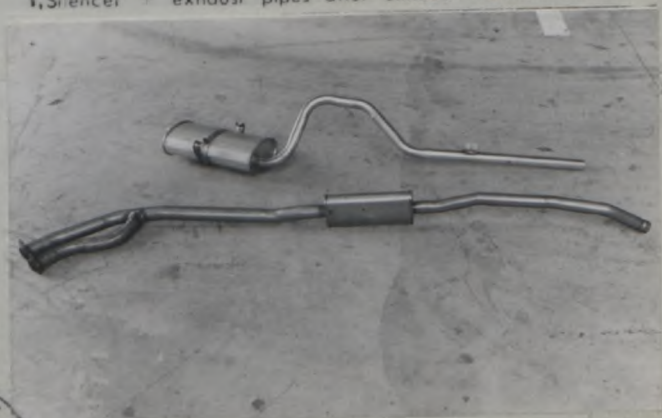

Make NISSAN

Model PB(L)210
型式

Photograph

写真

J, Engine unit out of car, from right. With clutch and accessories but without air filter nor gear-box. エンジン右側面

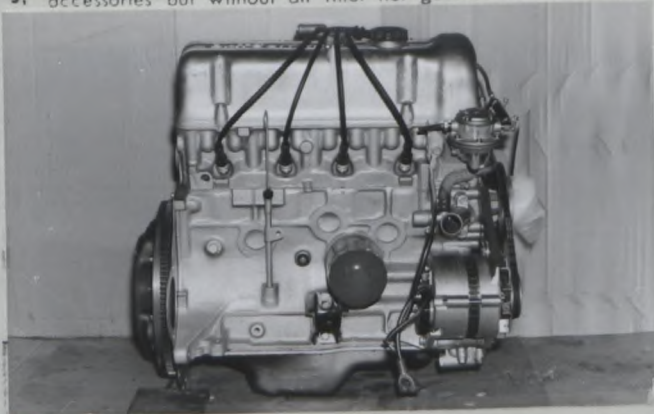

K, Engine unit out of car, from left. With clutch and accessories but without gear-box nor air filter. エンジン左側面

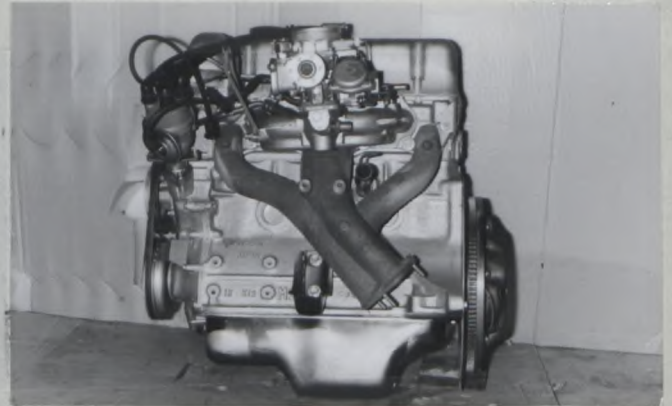

L, Combustion chamber 燃焼室 XXXXXXXXXX

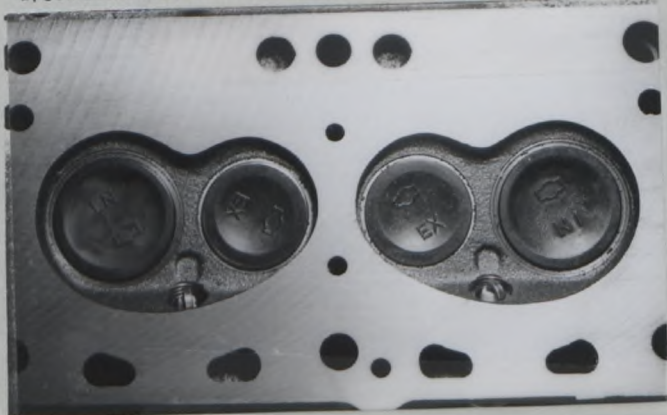

M, Piston crown ピストンクラウン XXXXXXXXXX



N, Carburettor (view from side of manifold) 気化器

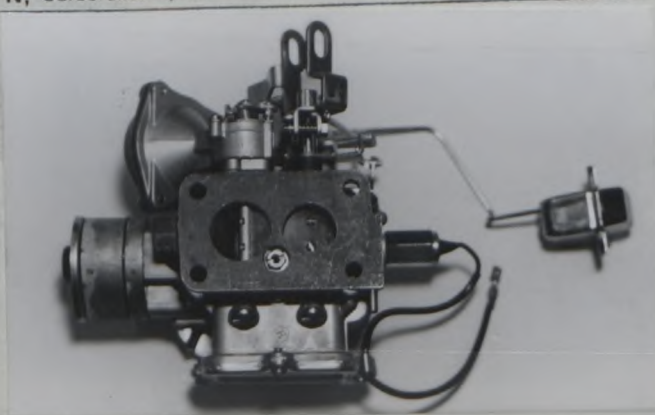

O, Engine in car with all accessories, bonnet open or removed. エンジンルーム

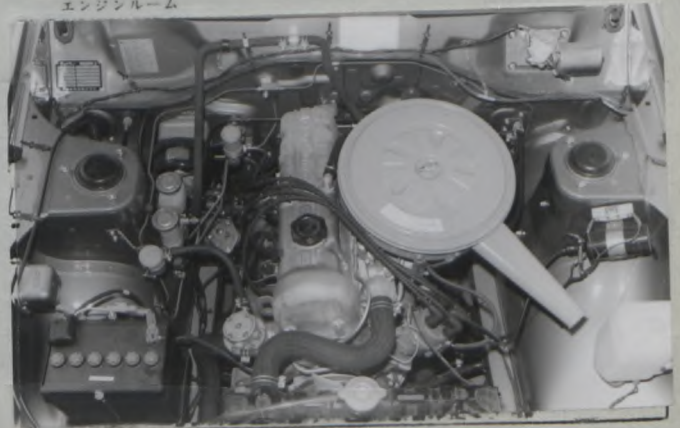

P, Inlet manifold 吸気マニホールド

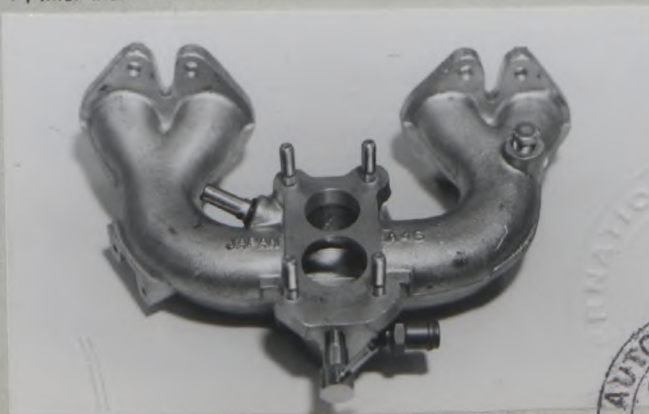

Q, Exhaust manifold 排気マニホールド



43φ × 2



5 SPEED GEAR BOX

FISA - Transfert en Gr.A

GEAR BOX

270. Manual type, make NISSAN
Method of operation Mechanical
271. No. of gear-box ratios forward 5
272. Synchronized forward ratios 1,2,3,4 & 5
273. Location of gear-shift Floor

277	Manual	
	Ratio	No. teeth
1	3.38	$\frac{31}{22} \times \frac{36}{15}$
2	2.01	$\frac{31}{22} \times \frac{30}{21}$
3	1.31	$\frac{31}{22} \times \frac{27}{29}$
4	1.00	
5	0.85	$\frac{31}{22} \times \frac{20}{33}$
reverse	3.57	$\frac{31}{22} \times \frac{17}{15} \times \frac{38}{17}$

Photograph
H, Gear box

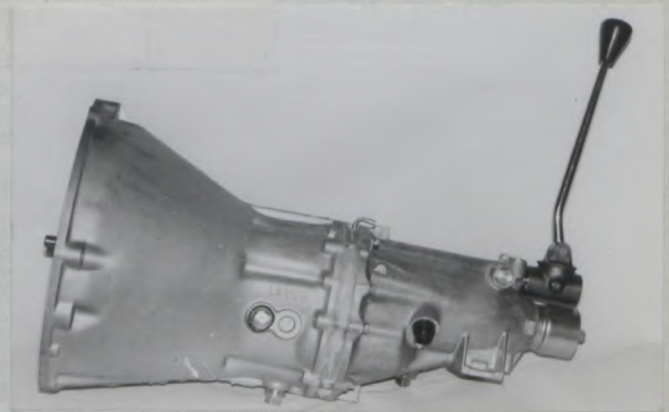

COUPE MODEL KPB(L)210

CAPACITIES AND DIMENSIONS

6. Overall height of the car 135 cm
7. Capacity of fuel tank 43 ltrs 11.4 Gallon US
9. Weight, total weight of the car with normal equipment, water, oil and spare wheel but without fuel nor repair tools :
- * SINGLE CARBURETTOR ENGINE MODEL 840 kg 1,852 lbs
 - ** TWIN CARBURETTOR ENGINE MODEL 830 kg 1,830 lbs

CHASSIS AND COACHWORK (Photograph A and B)

24. Number of doors 2
Material(s) Steel
32. Material(s) of rear-quarter light Glass



FISA - Transfert en Gr.A

Photograph

A, 3/4 view of car from front



A, 3/4 view of car from front



B, 3/4 view of car from rear



B, 3/4 view of car from rear



E, Rear axle complete

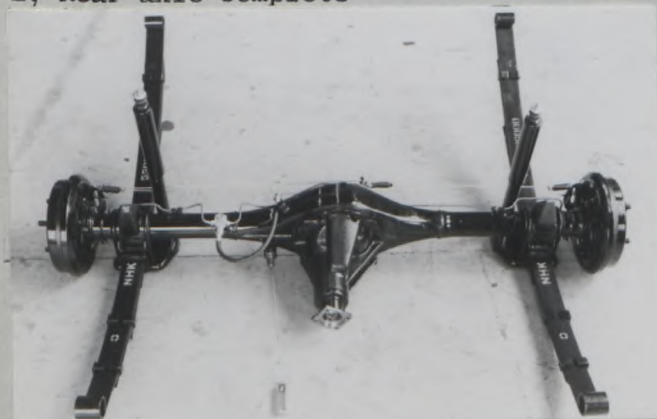

Make NISSAN

Model PB(L)210
型式

F.I.A. Rec. No. 5568

2/2V

FRONT SUSPENSION STRUT



Adjustable type & modifying spindle
Parts NO. R/H 54302-H5820
L/H 54303-H5820

FRONT TENSION ROD



Modifying tension rod with pillow ball
Parts NO. R/H 54474-H5820
L/H 54475-H5820



FRONT TRANSVERSE LINK



Modifying transverse link with pillow ball
Parts NO. R/H 54529-H5820
L/H 54530-H5820

STRUT TOWER BAR



Parts NO. 54421-H5875



FRONT UNDER COVER



Parts NO. 99090-H5775

"valable en Groupe 2 uniquement"
"valid for Group 2 only"



Make NISSAN

Model PB(L)210
型式

F.I.A. Rec. No. 5568

e/v

FRONT DISC BRAKE



Parts NO.
 Brake caliper
 R/H 41000-E4621
 L/H 41010-E4621
 Caliper adapter plate
 R/H 41155-H5820
 L/H 41156-H5820
 Brake rotor
 40206-H5820



93. Number of cylinders per wheel	4
94. Bore of wheel cylinder (s)	41.3 mm
100. Outside diameter	245 mm
101. Thickness of disc	20 mm
102. Length of brake linings	104 mm
103. Width of brake linings	47 mm
104. Number of pads per brake	2
105. Total area per brake	9,776 mm ²

FRONT DISC BRAKE

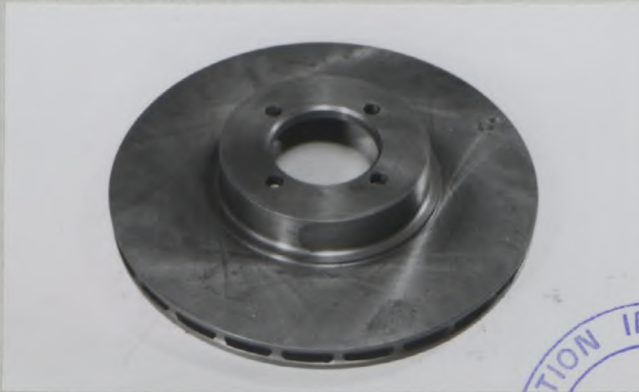

Parts NO.
 Brake rotor
 40206-U0621
 100. Outside diameter
 261 mm



"valable en Groupe 2 uniquement"
 "valid for Group 2 only"

ALTERNATIVE REAR BRAKE

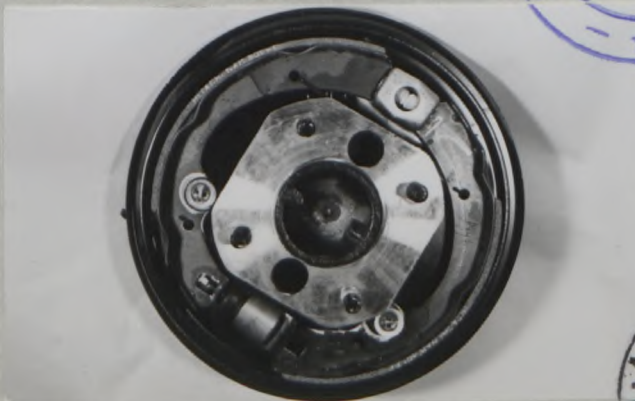

Parts No.
 Back plate
 R/H 44020-U6200
 L/H 44030-U6200
 Brake assy
 R/H 44000-U6301
 L/H 44010-U6301



Make NISSAN

Model PB(L)210
型式

F.I.A. Rec. No. 5568

2/2V

ALTERNATIVE REAR BRAKE DRUM

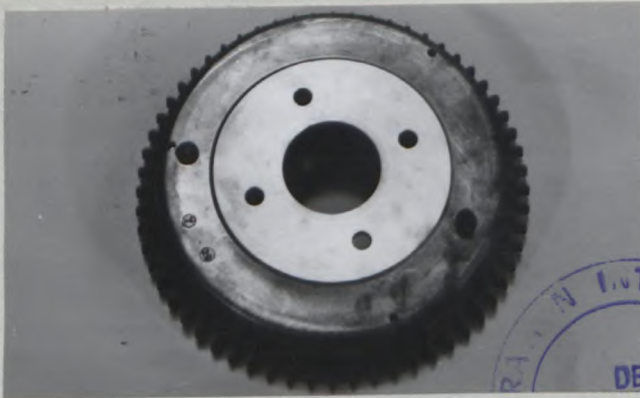

Parts No.
Drum 43206-E4100



- 95. Inside diameter 228 mm
- 96. Length of brake linings 219 mm
- 97. Width of brake linings 40 mm
- 98. Number of shoes per brake 2
- 99. Total area per brake 17,560 mm²

~~WITH REAR AIR SPOILER MODEL~~



"valable en Groupe 2 uniquement"
"valid for Group 2 only"



~~FRONT FENDER~~

FRONT OVER FENDER



Parts No. R/H 63860-H5720
L/H 63861-H5720



Make NISSAN

Model PB(L) 210
型式

J.A.F 公認番号 T-214V-2
F.I.A. Rec. No. 5568 3/3V

CRANK SHAFT



Weight : 13.5 kg
Increases number of fixing bolt.
Parts No. 12200-H6020
Material : Stee

CONNECTING ROD

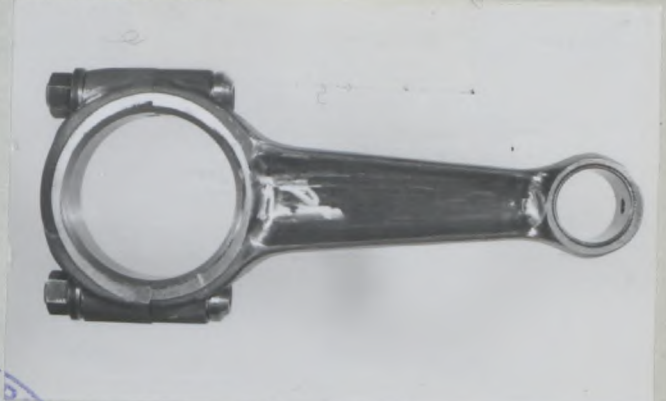

Weight : 0.63 kg
Bolt hole was modified.
Parts No. 12100-H6020

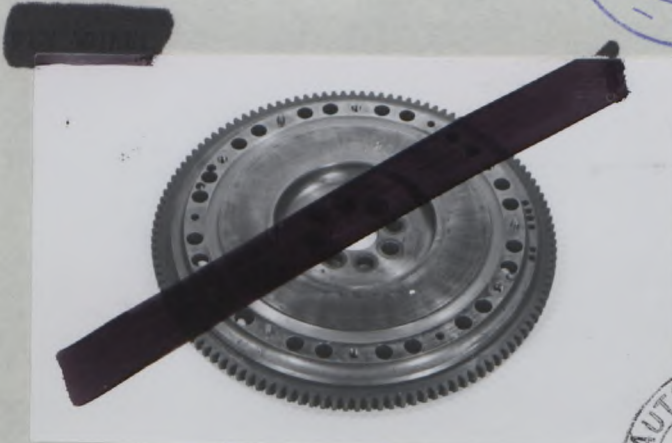

Weight : [redacted] kg
Increases number of bolt hole
Parts No. 12100-H6020



"valable en Groupe 2 uniquement"
"valid for Group 2 only"



INVT
30
INSPECTION
MOBILE & MARINE
NAVY

"Manned & ..."
"also & ..."

COMMISSION SPORTIVE
02552 25.1174
INTERNATIONALE

Make NISSAN

Model PB(L)210
型式

F.I.A. Rec. No. 5568

"valable en Groupe 2 uniquement"
"valid for Group 2 only"

h/w

GEAR BOX CASE
Gear box case cover
Material : Aluminium
Parts No. 32101-N3220
Gear box case
Material : Magnesium
Parts No. 32101-N3221
Adaptor plate
Material : Aluminium
Parts No. 32101-N3220
Gear extension
Material : Magnesium
Parts No. 32101-N3221



LY WHEEL
Modifying fly wheel
Parts No. 37000-H6021



PROPELLER SHAFT
Modifying propeller shaft
Parts No. 37000-H6020



TWIN PLATE CLUTCH

260. Type of clutch	Dry plate
261. No. of plates	2
262. Dia of clutch plates	186 mm
263. Dia of linings, inside	134 mm
263. Dia of linings, outside	184 mm
264. Method of operating clutch	Hydraulic
* Weight	3.2 kg
Parts No.	30200-N3220

CLUTCH COVER

Modifying single plate clutch cover
Weight 3.7 kg
Parts No. 30210-K2520



Make NISSAN

Model PB(L)210
 型式

h/hv

REAR DISC BRAKE

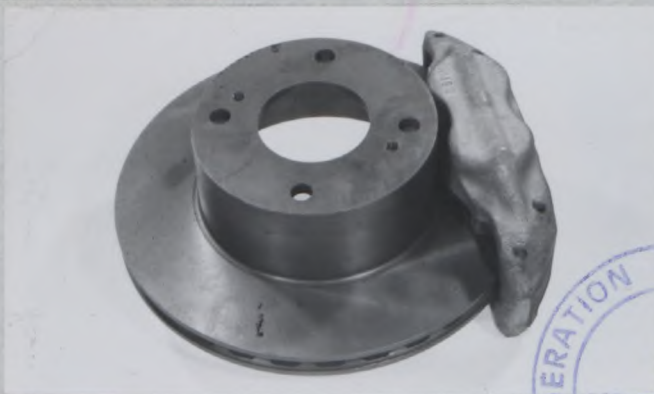

Parts No.

Brake caliper R/H 41000-E4621
 L/H 41010-E4621

Caliper adapter plate
 R/H 44155-H6020
 L/H 44165-H6020

Brake rotor 43206-H6020



93. Number of cylinders per wheel	4	
94. Bore of wheel cylinder(s)	41.3	mm
100. Outside diameter	261	mm
101. Thickness of disc	20	mm
102. Length of brake linings	104	mm
103. Width of brake linings	47	mm
104. Number of pads per brake	2	
105. Total area per brake	9,776	mm

FRONT TRANSVERSE LINK

Modifying transverse link
 Parts No. R/H 54499-K2220
 L/H 54500-K2220

"valable en Groupe 2 uniquement"
 "valid for Group 2 only"



Make NISSAN

Model
型式

PB(L) 210

F.I.A. Rec. No.

7/70

~~CLUTCH COVER~~
~~Modifying clutch cover~~
~~Weight 3.7 kg~~
~~Parts No. 30210-K2520~~

CLUTCH COVER

Modifying clutch cover

Weight 3.7 kg

Parts No. 30210-K2520



~~5-SPEED GEAR BOX~~

	Manual			
	Ratio	No. teeth	Ratio	No. teeth
1	3.32	$\frac{31}{22} \times \frac{33}{14}$	2.82	$\frac{31}{22} \times \frac{32}{16}$
2	2.27	$\frac{31}{22} \times \frac{29}{18}$	1.97	$\frac{31}{22} \times \frac{28}{20}$
3	1.60	$\frac{31}{22} \times \frac{25}{22}$	1.47	$\frac{31}{22} \times \frac{24}{23}$
4	1.24	$\frac{31}{22} \times \frac{22}{25}$	1.19	$\frac{31}{22} \times \frac{22}{26}$
5	1.00		1.00	
	3.38	$\frac{31}{22} \times \frac{23}{15} \times \frac{36}{23}$	3.38	$\frac{31}{22} \times \frac{23}{15} \times \frac{36}{23}$

"valable en Groupe 2 uniquement"
"valid for Group 2 only"

~~Modifying the dimensions of gear and shaft~~
~~Type (n): Sleeve type of rear end.~~
~~Parts No. J2020-B9011~~

~~Type (d): Flange type of rear end.~~
~~Parts No. J2020-B9011~~

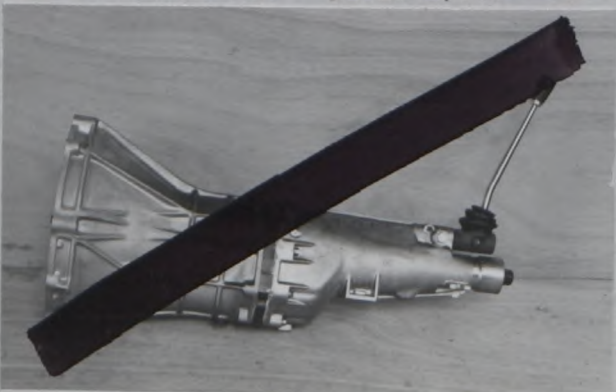



JAPAN AUTOMOBILE FEDERATION

社団法人 日本自動車連盟

J.A.F.公認番号

T-214 V-6

発効年月日

昭和52年9月30日

F.I.A. Homol. No

5568/

7/7V

FEDERATION INTERNATIONALE DE L'AUTOMOBILE

Form of recognition accordance with Appendix J to the International Sporting Code.

国際スポーツ法典付則J項及びJAF国内競技車両規則に従った公認書式。

Make NISSAN MOTOR CO., LTD.

製造会社名

Modification's application starts with serial

Application of this amendment started the 適用年月日

Commercial denomination after application of modifications

Model

型式及び通称名

PB(L)210 DATSUN SUNNY 1400

No.

chassis engine

適用シャーシー番号 PB(L)210-
適用エンジン番号 L14

FEB, 1977

PB(L)210, KPB(L)210, PB(L)211 & KPB(L)211.

The modifications are to be considered as: Variant / ~~modification~~ ~~variant~~ ~~modification~~ of the type
変型 / ~~変型~~ ~~変型~~ ~~変型~~

Date amendment is valid from -1.JAN.1978

List

Description of amendment 内容

VALID FOR GROUP 2 ONLY

OPTIONAL EQUIPMENT

CONNECTING ROD

Bolt hole was modified.

Weight: 0.63 kg

Parts No. 12100-H6020

CRANK SHAFT

Increases number of fixing bolt.

Weight: 13.5 kg

Material: Steel

Parts No. 12200-H6020



Stamp and signature of the JAF

JAF公認印及び署名

難波靖彦

Yasuharu Nanba



Stamp and signature of the F.I.A.



Signature of the F.I.A. official

Make NISSAN

Model PB(L) 210
型式

J.A.F. 公認番号 T-214 V-6
F.I.A. Rec. No. 7/7V

FRONT SUSPENSION STRUT

Adjustable type & modifying spindle.

Parts No. R/H 54302-H5820
L/H 54303-H5820

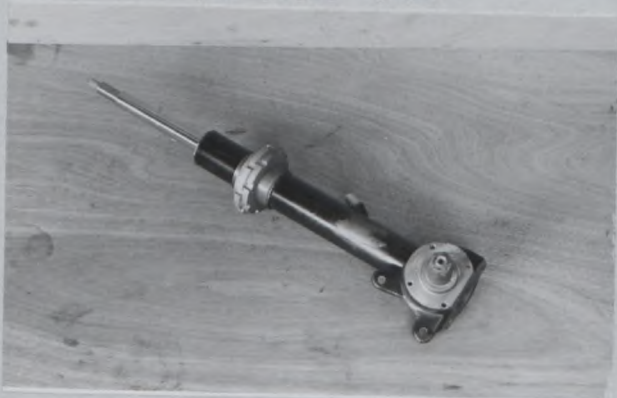

FRONT TRANSVERSE LINK

Heavy duty front transverse link.

Parts No. R/H 54529-H5820
L/H 54530-H5820



HEAVY DUTY REAR AXLE CASE

Parts No. 43010-H5820



HEAVY DUTY REAR AXLE SHAFT

Parts No. 38162-N1200



ALTERNATIVE FINAL DRIVE

Parts No. 38300-25525

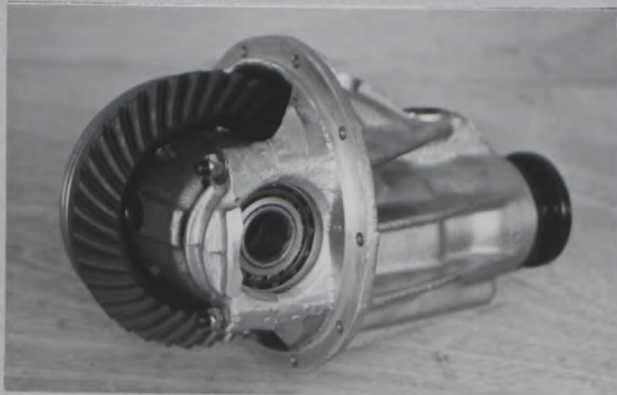

ALUMINUM REAR BRAKE DRUM

Parts No. 43206-E4100

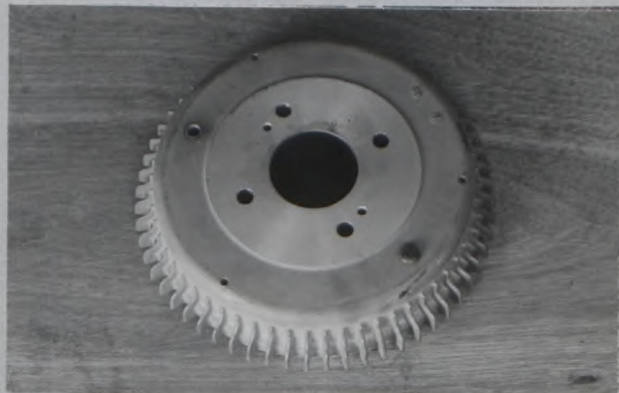

"valable en Groupe 2 uniquement"
"valid for Group 2 only"



Make NISSAN

Model PB(L) 210
型式

F.I.A. Rec. No.

7/7J

DISC BRAKES

NOTE: The item number in the brackets is according to the old recognition form.

- 53. (93) Number of cylinders per wheel-----
- 54. (94) Bore -----
- 58. (103) Width of brake linings -----
- 59. (104) Number of pads per brake -----
- 60. (105) Total area per brake -----

Front	Rear
4	4
41.3 mm	41.3 mm
47 mm	47 mm
2	2
9,776 mm ²	9,776 mm ²

FRONT DISC BRAKE

Parts No.

- Brake caliper R/H 41000-A1280
- Brake caliper L/H 41010-A1280
- Disc brake rotor 40206-U0621

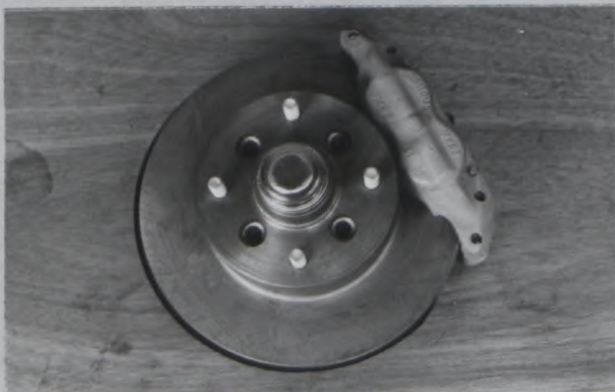

REAR DISC BRAKE

Parts No.

- Brake caliper R/H 41000-A1280
- Brake caliper L/H 41010-A1280
- Disc brake rotor 43206-H6020
- Caliper adapter plate
R/H 44155-H6020
L/H 44165-H6020



"valable en Groupe 2 uniquement"
"valid for Group 2 only"





JAPAN AUTOMOBILE FEDERATION

社団法人 日本自動車連盟

REPORT ON MOTOR VEHICLE PRODUCTION

生産証明書

Sub-Commission of Recognition
International Sporting Commission
FEDERATION INTERNATIONALE OF AUTOMOBILE

Date 13TH, APR. 1976
年月日
COMMISSION SPORTIVE
01692 03.5.76
INTERNATIONALE

Manufactured by NISSAN MOTOR CO., LTD.
製造者名
Name of the Car DATSUN SUNNY 1400 PB(L)210
適用車種名, 型式
Production Number of CAR(1,600 cm³ engine model)
生産台数

Month/ Year 年月	NUMBER				
	A	B	C	D	E
DEC / 1975	1,532	879			
JAN / 1976	3,324	1,703			
FEB / 1976	3,168	1,657			
MAR / 1976		1,746			
Total 合計	8,024	5,985			
Remarks 注 A: 1,600cm ³ engine 4door sedan model B: 1,600cm ³ engine coupe model					

I hereby swear that the production of this name of CAR(1,600 cm³ engine model)
上記の通り確かに生産したことを

has been certainly done as above.
証明いたします。

Signature 署名 Ryozo Takamatu
Position 所属, 役職 MANAGER
PRODUCTION CONTROL DEPARTMENT

Signature
Position

Certified by

JAPAN AUTOMOBILE FEDERATION

難波靖治
Yasuharu Nanba



FÉDÉRATION INTERNATIONALE DE L'AUTOMOBILE



JAPAN AUTOMOBILE FEDERATION (JAF)

社団法人 日本自動車連盟

PRODUCTION CERTIFICATE

生産証明書

08/08V

Manufacturer
製造者 NISSAN MOTOR CO., LTD.

Date
年月日 6th, Nov, 1979.

Car Model
型式 PB(L)210

Type or
commercial designation
タイプ又は通称名 DATSUN SUNNY 1400

Production period
生産時間 from 自 Oct, 1978.
to 至 Dec, 1978.

Monthly production
月間平均生産台数 2,392

I hereby certify that the production mentioned hereabove concerns cars which are entirely completed, identical and in conformity with the recognition form submitted for the said model.

上記車両型式について提出された公認書に完全に一致し、この車両を確かに生産したことをここに証明いたします。

	Month/year 月/年	Number 生産数
1	Oct / 1978	2,371
2	Nov / 1978	2,393
3	Dec / 1978	2,414
4		
5		
6		
7		
8		
9		
10		
11		
12		
TOTAL		7,178
Remarks: CAR(Cylinder block Type A) 注		

Signature
署名 Ichiro Egawa.
ICHIRO EGAWA
Position
所属役職 GENERAL MANAGER
PRODUCTION CONTROL DEPARTMENT

JAPAN AUTOMOBILE FEDERATION (JAF)

難波靖治

Yasuharu Nanba



JAPAN AUTOMOBILE FEDERATION

社団法人 日本自動車連盟

REPORT ON MOTOR VEHICLE PRODUCTION

生産証明書

Sub-Commission of Recognition

Date 13th, September, 1977.

International Sporting Commission

年月日

FEDERATION INTERNATIONAL OF AUTOMOBILE

Manufactured by

NISSAN MOTOR CO., LTD.

製造者名

Name of the Car

DATSUN SUNNY 1400

PB(L)210

適用車種名, 型式

Production Number of

Car(Connecting rod, Crank shaft, Fly wheel, Clutch cover &

生産台数

Gear box)

Month/ Year 年月	NUMBER				
	A	B	C	D	E
FEB / 1977	300set	250	300	400	1,500
MAR / 1977	300set	300	400	400	
APR / 1977	400set	300	400	400	
MAY / 1977		300			
JUN / 1977					
Total 合計	1,000set	1,150	1,100	1,200	1,500

Remarks 注

A: Connecting rod
 B: Crank shaft
 C: Fly wheel
 D: Clutch cover
 E: Gear box

I hereby swear that the production of this name of Car(Connecting rod, Crank shaft, Fly wheel,
 上記の通り確かに生産したことを

Clutch cover & Gear box)

has been certainly done as above.

証明いたします。

Signature

署名

S. Uemura
 SATOSHI UEMURA

Signature

Position

所属, 役職

GENERAL MANAGER
 PRODUCTION CONTROL DEPARTMENT

Position

Certified by

JAPAN AUTOMOBILE FEDERATION

難波靖治

Yasuharu Nanba



JAPAN AUTOMOBILE FEDERATION

社団法人 日本自動車連盟

REPORT ON MOTOR VEHICLE PRODUCTION

生産証明書

T-214 V-6

Sub-Commission of Recognition
International Sporting Commission
FEDERATION INTERNATIONALE OF AUTOMOBILE

Date 13th, September, 1977.
年月日

Manufactured by NISSAN MOTOR CO., LTD.
製造者名
Name of the Car DATSUN SUNNY 1400 PB(L) 210
適用車種名, 型式
Production Number of Car(Final drive) [REDACTED]
生産台数

Month/ Year 年月	NUMBER				
	A	B	C	D	E
FEB / 1977	2,000	[REDACTED]			
MAR / 1977		[REDACTED]			
APR / 1977		[REDACTED]			
MAY / 1977		[REDACTED]			
JUN / 1977					
Total 合計	2,000	[REDACTED]			

Remarks 注
A: Final drive
[REDACTED]

I hereby swear that the production of this name of Car(Final drive) [REDACTED]
上記の通り確かに生産したことを

has been certainly done as above.
証明いたします。

Signature S. Uemura
署名 SATOSHI UEMURA
Position GENERAL MANAGER
所属, 役職 PRODUCTION CONTROL DEPARTMENT

Signature _____
Position _____

Certified by

JAPAN AUTOMOBILE FEDERATION

難波靖治

Yasuharu Nanba



JAPAN AUTOMOBILE FEDERATION

社団法人 日本自動車連盟

REPORT ON MOTOR VEHICLE PRODUCTION

生産証明書

Sub-Commission of Recognition

Date 10TH, JUN, 1975

International Sporting Commission

年月日

FEDERATION INTERNATIONAL OF AUTOMOBILE

Manufactured by

NISSAN MOTOR CO., LTD.

製造者名

Name of the Car

DATSUN SUNNY 1400

PB(L)210

適用車種名, 型式

Production Number of

CYLINDER HEAD, GEAR BOX CASE, FLY WHEEL, PROPELLER SHAFT &

生産台数

TWIN PLATE CLUTCH.

Month/ Year 年月	N U M B E R				
	A	B	C	D	E
JAN / 1975	20	20	50	50	30
FEB / 1975	40	30	50	50	30
MAR / 1975	40	50			50
Total 合計	100	100	100	100	110

Remarks 注

A : CYLINDER HEAD
 B : GEAR BOX CASE
 C : FLY WHEEL
 D : PROPELLER SHAFT
 E : TWIN PLATE CLUTCH

I hereby swear that the production of this name of CYLINDER HEAD, GEAR BOX CASE, FLY WHEEL,
上記の通り確かに生産したことを
PROPELLER SHAFT & TWIN PLATE CLUTCH.

has been certainly done as above.

証明いたします。

Signature

署名

Ryozo Tsukamatsu
RYOZO TSUKAMATSU

Signature

Position

所属, 役職

MANAGER

PRODUCTION CONTROL DEPARTMENT

Position

Certified by

JAPAN AUTOMOBILE FEDERATION

難波靖治

Yasuharu Nanba



JAPAN AUTOMOBILE FEDERATION

社団法人 日本自動車連盟

REPORT ON MOTOR VEHICLE PRODUCTION

生産証明書

Sub-Commission of Recognition

Date 10TH, JUN, 1975

年月日

International Sporting Commission

FEDERATION INTERNATIONAL OF AUTOMOBILE

Manufactured by

NISSAN MOTOR CO., LTD.

製造者名

Name of the Car

DATSUN SUNNY 1400

PB(L)210

適用車輛名, 型式

Production Number of

CLUTCH COVER & FRONT TRANSVERSE LINK.

生産台数

Month / Year 年月	NUMBER				
	A	B	C	D	E
JAN / 1975	100	50 set			
FEB / 1975		50 set			
Total 合計	100	100 set			

Remarks 注
 A : CLUTCH COVER
 B : FRONT TRANSVERSE LINK

I hereby swear that the production of this name of CLUTCH COVER & FRONT TRANSVERSE LINK.
上記の通り確かに生産したことを

has been certainly done as above.

証明いたします。

Signature

Ryozo Tsukamatsu

Signature

署名

RYOZO TSUKAMATSU

Position

MANAGER

Position

所属, 役職

PRODUCTION CONTROL DEPARTMENT

Certified by

JAPAN AUTOMOBILE FEDERATION

難波靖治

Yasuharu Nanba



JAPAN AUTOMOBILE FEDERATION

社団法人 日本自動車連盟

REPORT ON MOTOR VEHICLE PRODUCTION

生産証明書

Sub-Commission of Recognition
International Sporting Commission
FEDERATION INTERNATIONALE OF AUTOMOBILE

Date 13TH. APR. 1976.
年月日
COMMISSION SPORTIVE
01692 03.5.76
INTERNATIONALE

Manufactured by NISSAN MOTOR CO., LTD.
製造者名
Name of the Car DATSUN SUNNY 1400 PB(L)210
適用車種名, 型式
Production Number of CAR(5 speed gear box ratio "B" & "C" type)
生産台数

Month / Year 年月	NUMBER				
	A	B	C	D	E
APR / 1975	319	237			
MAY / 1975	344	218			
JUN / 1975	327	246			
JUL / 1975	351	233			
AUG / 1975		241			
Total 合計	1,341	1,175			

Remarks 注
 A: CAR(5 speed gear box ratio "B")
 1st=2.82, 2nd=1.97, 3rd=1.47, 4th=1.19, 5th=1.00, Rev=3.38
 B: CAR(5 speed gear box ratio "C")
 1st=2.35, 2nd=1.60, 3rd=1.30, 4th=1.14, 5th=1.00, Rev=3.38

I hereby swear that the production of this name of CAR(5 speed gear box ratio "B" & "C" type)
上記の通り確かに生産したことを

has been certainly done as above.

証明いたします。

Signature 署名 Ryozo Takamatu
RYOZO TAKAMATU

Signature _____

Position 所属, 役職 MANAGER
PRODUCTION CONTROL DEPARTMENT

Position _____

Certified by

JAPAN AUTOMOBILE FEDERATION

難波靖治

Yasuharu Nanba

EXHAUST (see page 3)

198. Number of valve springs	2
202. Valves open at	B.B.D.C. $54^{\circ} \pm 3^{\circ}$
203. Valves close at	A.T.D.C. $14^{\circ} \pm 3^{\circ}$

CARBURETION (photograph N)

210. Number of carburettors fitted	2
211. Type	Side-draft
212. Make	HITACHI
213. Model	HJL38W
214. Number of mixture passages per carburettor	1
215. Flange hole diameter of exit port(s) of carburettor	38 mm
216. Minimum dimensions of mixture passage(s) with piston at max. height (example: SU)	29 mm

ENGINE AND CAR PERFORMANCES

250. Max. engine output	95 PS (type of horsepower: JIS) at 6,400 rpm
251. Maximum rpm	6,800 output at that figure 90 PS
252. Maximum torque	12.2 kg-m at 4,000 rpm
253. Maximum speed of the car	165 km/hour



Make NISSAN

Model PB(L) 210
型式

F.I.A. Rec. No. 5568

1/1V

Drawing inlet manifold ports, side of cylinder-head/~~brassing~~ scale or dimensions and manufacturing tolerance.

吸気マニホールドのポート (シリンダーヘッド側)

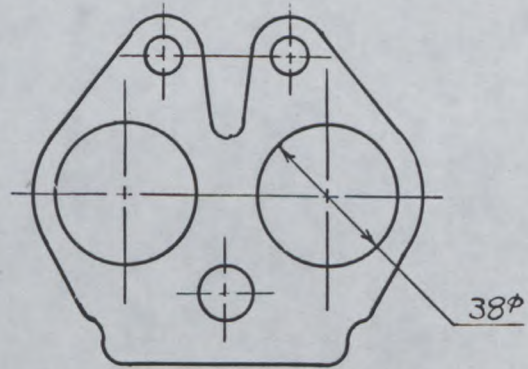

Drawing of entrance to inlet port of cylinder-head/~~brassing~~ scale or dimensions and manufacturing tolerance.

シリンダーヘッドの吸気ポート (吸気マニホールド側)

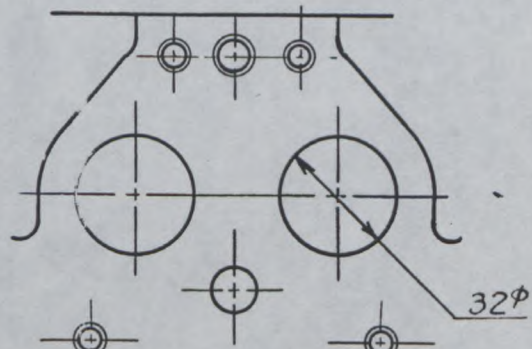

Drawing exhaust manifold ports, side of cylinder-head/~~brassing~~ scale or dimensions and manufacturing tolerance.

排気マニホールドのポート (シリンダーヘッド側)

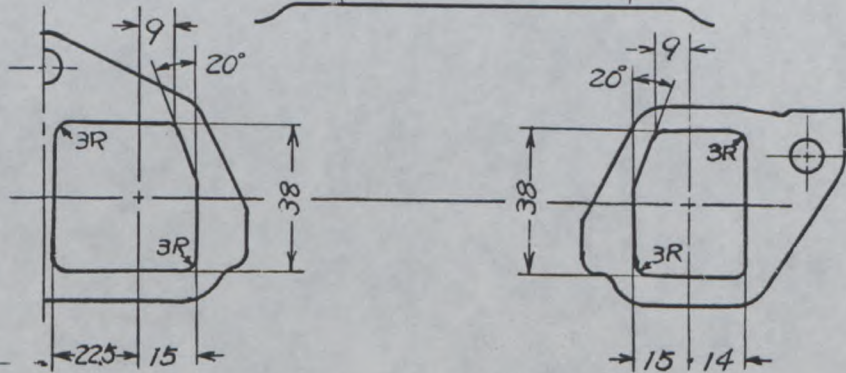

Drawing of exit to exhaust port of cylinderhead/~~brassing~~ Indicate scale or dimensions and manufacturing tolerance.

シリンダーヘッドの排気ポート (排気マニホールド側)

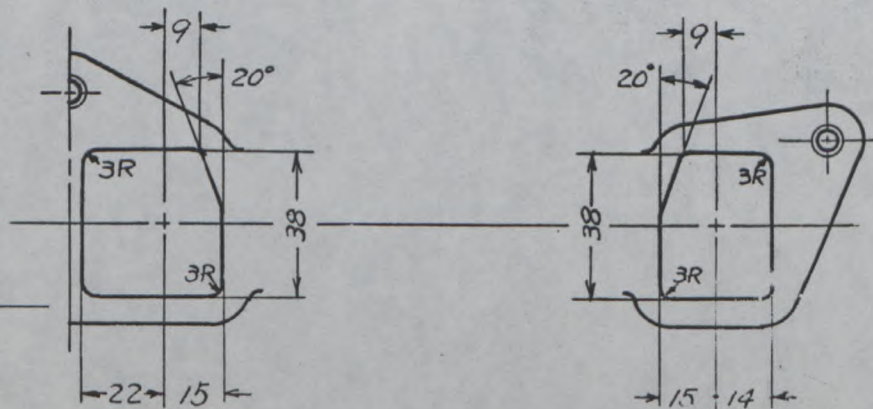

Unit: mm

~~tolerance~~
~~etc~~



Photograph

J, Engine unit out of car, from right.

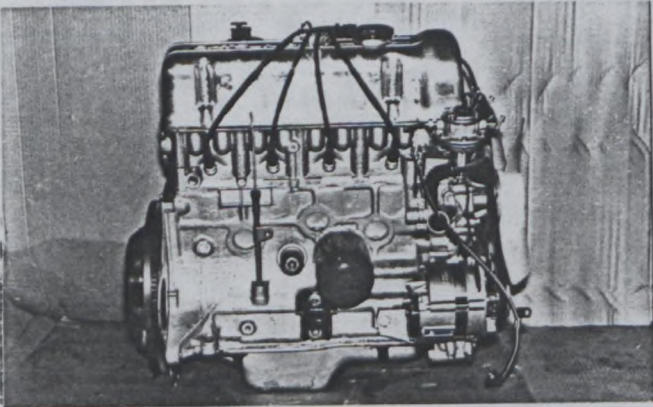

K, Engine unit out of car, from left.

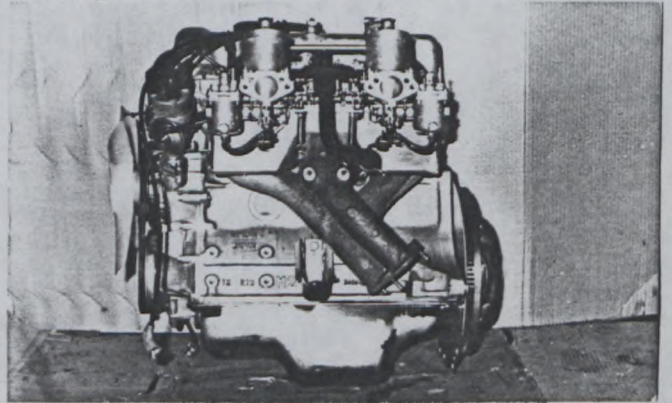

L, Combustion chamber



M, Piston crown



N, Carburettor

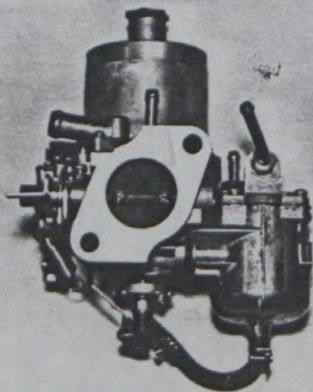

O, Engine in car with all accessories.

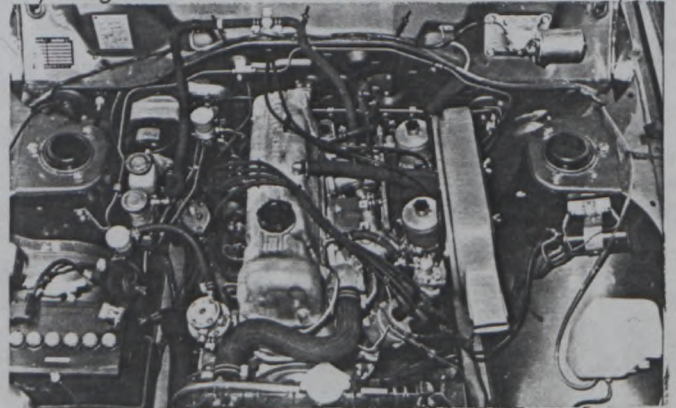

P, Inlet manifold

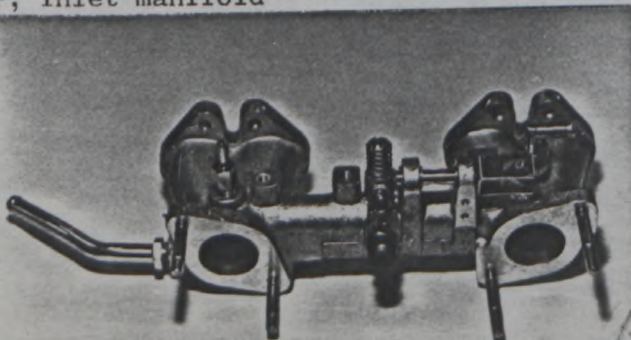



JAPAN AUTOMOBILE FEDERATION

社団法人 日本自動車連盟

J-A-F公認番号 T-214V-/
発効年月日 1974年7月31日
F. I. A. Homol. No 5568

2/20

FEDERATION INTERNATIONALE DE L'AUTOMOBILE

Form of recognition accordance with Appendix J to the International Sporting Code.

国際スポーツ法典付則J項及びJAF国内競技車両規則に従った公認書式。

Make NISSAN MOTOR CO., LTD. **Model** PB(L)210 DATSUN SUNNY 1400
 製造会社名 型式及び通称名
Modification's application starts with serial No. chassis 適用シャーシー型式番号 PB(L)210-000001
 engine 適用エンジン型式 L14
Application of this amendment started the JAN. 1974
 適用年月日
Commercial denomination after application of modifications
 The modifications are to be considered as: Variant / ~~modification~~ evolution of the type
 変型 / ~~改修~~
Date amendment is valid from 1.10.76 List

Description of amendment 内容 DRY SUMP LUBRICATION OPTIONAL EQUIPMENT : VALID FOR GROUP 2 ONLY

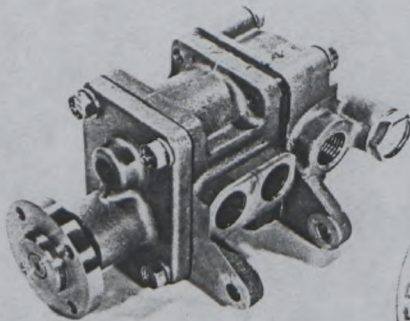

Parts No. 15010-H6020

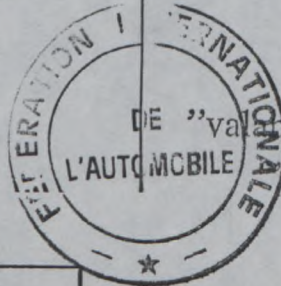

DE "valable en Groupe 2 uniquement"
L'AUTOMOBILE valid for Group 2 only"

ALTERNATIVE 5 SPEEDS GEAR BOX

277	Manual	
	Ratio	No. teeth
1	3.32	$\frac{31}{22} \times \frac{33}{14}$
2	2.27	$\frac{31}{22} \times \frac{29}{18}$
3	1.60	$\frac{31}{22} \times \frac{25}{22}$
4	1.24	$\frac{31}{22} \times \frac{22}{25}$
5	1.00	
Reverse	3.38	$\frac{31}{22} \times \frac{23}{15} \times \frac{36}{23}$

Modifying dimension of gear & case.

Type(a): Sleeve type of rear end.
Parts No. 32020-E9611

Type(b): Flange type of rear end.
Parts No. 32020-E9605

Stamp and signature of the JAF

JAF公認印及び署名

難波靖治

Yasuharu Nanba



2/2V

Rear over fender

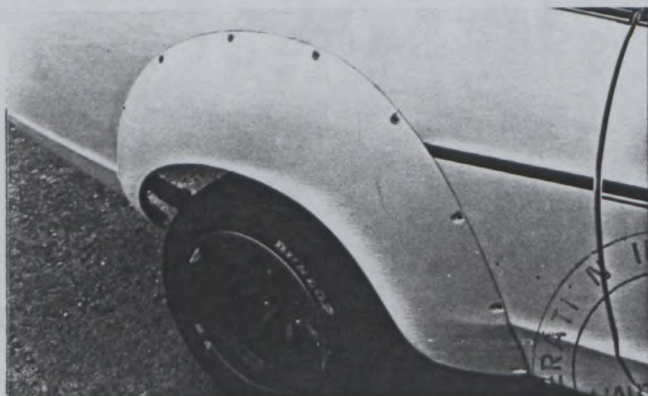

Parts NO. R/H 63862-H5720
L/H 63863-H5720

OVER FENDER(OTHER TYPE)

Front over fender



Parts NO. R/H 63860-M1420

"valable en Groupe 2 uniquement" 63861-M1420

"valid for Group 2 only"

Rear over fender



Parts NO. R/H 63862-M1420
L/H 63863-M1420

This rear over fender is available for 2 door and also 4 door model.
In case of 4 door model, cut this in between





JAPAN AUTOMOBILE FEDERATION

社団法人 日本自動車連盟

J.A.F 公認番号
発効年月日

T-214V-3

1975年6月30日

F. I. A. Homol. No 5568

4/4V

FEDERATION INTERNATIONALE DE L'AUTOMOBILE

Form of recognition accordance with
Appendix J to the International Sporting Code.

国際スポーツ法典付則J項及びJAF国内競技車両規則に従った公認書式。

Make	NISSAN MOTOR CO., LTD.	Model	PB(L)210	DATSUN SUNNY 1400
製造会社名		型式及び通称名		
Modification's application starts with serial		No. chassis engine	適用シャーシー型式番号 適用エンジン型式番号	PB(L)210-000001 L14
Application of this amendment started the		JAN, 1975		
適用年月日				
Commercial denomination after application of modifications			PB(L)210, KPB(L)210.	

The modifications are to be considered as: Variant / ~~original chassis type~~
変型 / ~~原形車~~

Date amendment is valid from 1 10 75 . List

Description of amendment 内容

OPTIONAL EQUIPMENT

VALID FOR GROUP 2 ONLY

"valable en Groupe 2 uniquement"

"valid for Group 2 only"

CYLINDER HEAD

Parts No. 11041-N7120

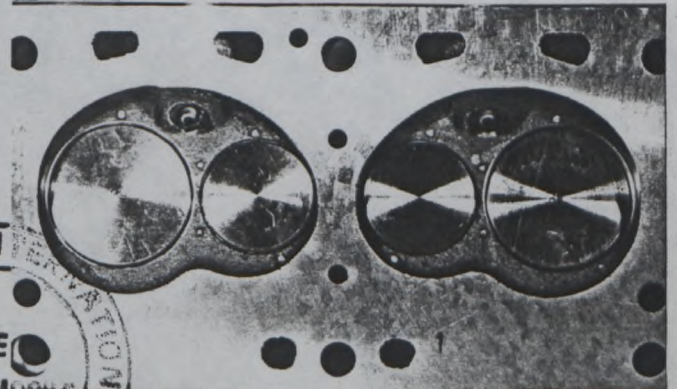
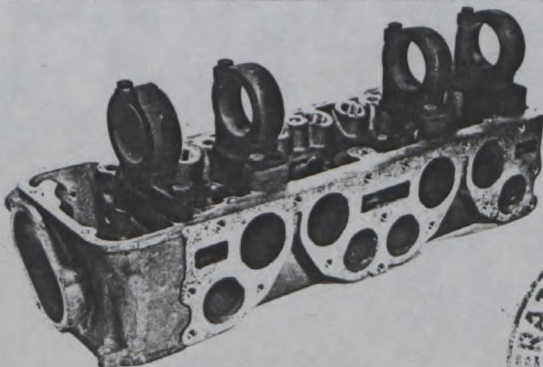

Stamp and signature of the JAF

JAF公認印及び署名

難波靖治

Yasuharu Nanba



Stamp and signature of the F.I.A.



JAPAN AUTOMOBILE FEDERATION

社団法人 日本自動車連盟

J.A.F.公認番号 T-214V-4
発効年月日 昭和51年4月30日
F.I.A. Homol. No 5568
5/5V

FEDERATION INTERNATIONALE DE L'AUTOMOBILE

Form of recognition accordance with Appendix J to the International Sporting Code.

国際スポーツ法典付則J項及びJAF国内競技車両規則に従った公認書式。

Make	NISSAN MOTOR CO., LTD.	Model	PB(L)210	DATSUN SUNNY 1400
製造会社名		型式及び通称名		
Modification's application starts with serial		No. chassis engine	適用シャーシー型式番号 適用エンジン型式	PB(L)210-000001 L14
Application of this amendment started the 適用年月日		DEC, 1975.		
Commercial denomination after application of modifications		PB(L)210, KPB(L)210, GB211, KGB211.		
The modifications are to be considered as:	Variant / Normal Excluded of the code			
Date amendment is valid from	1 7 76	List		

Description of amendment 内容

The following items have been added.

L16 ENGINE MODEL

Applicable to PB210 model seris.

Another type of 1,600 cm³ engine can be selected for PB210 cars as maker's option.

Serial number of production car will be start from No. GB211-000001 for chassis and No. L16-000001 for engine.

Further detailed specifications different from the original engine are described.

NOTE: The item number in the brackets is according to the old recognition form.

Stamp and signature of the JAF

JAF公認印及び署名

難波靖治

Yasuharu Nanba



Stamp and signature of the F.I.A.

会社名
Make NISSAN

型式
Model PB(L)210

FIA Rec. No. 5568

ADDITIONAL DATA FOR GROUP 2
TO THE INTERNATIONAL SPORTING CODE

ENGINE:

65. (133) Bore	83.0	mm	3.27	inches
67. (134) Stroke	73.7	mm	2.90	inches
68. (136) Total cylinder-capacity	1,595	cm ³	97.33	inches ³
69. (==) Maximum cylinder-capacity allowed	1,599	cm ³	97.58	inches ³
70. (139) Material of head	Aluminum-cast			

Photo I, View of the engine, right side.

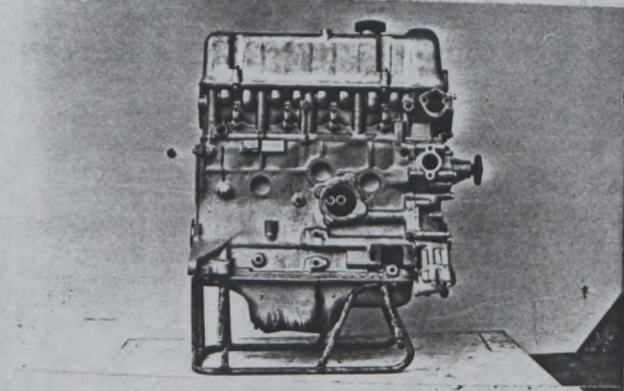

Photo J, View of the engine, left side.

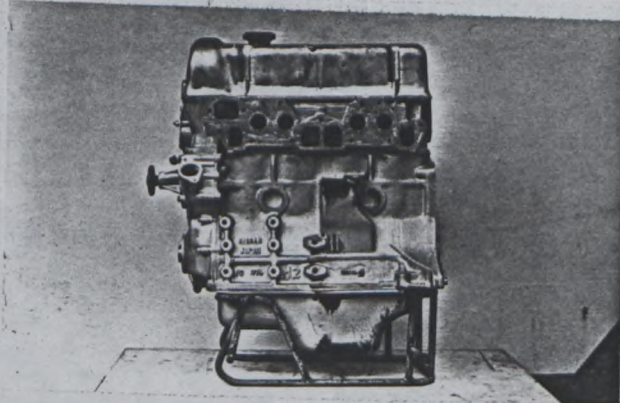
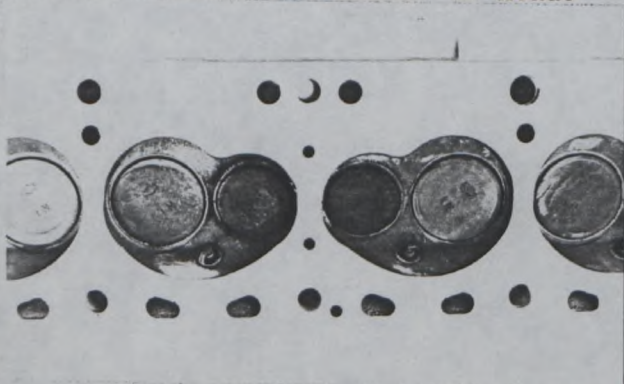

Photo K, Combustion chamber in head.



ADDITIONAL DATA FOR GROUP 1
TO THE INTERNATIONAL SPORTING CODE

CAPACITIES AND DIMENSIONS:

116. (9) Weight				
* 4 door sedan model	830	kg	1,830	lb
** Coupe model	830	kg	1,830	lb

ENGINE:

135. (135) Capacity per cylinder	398.75	cm ³	24.333	inches ³
139. (142) Compression ratio			8.5	
140a. (==) Volume of the combustion chamber			53.1	cm ³
140b. (==) Volume of combustion chamber in head			40.3	cm ³
141. (==) Thickness of head gasket inter tightened			1.20	mm
145. (152) Capacity, lubricant			3.9	ltrs
151. (==) Weight of flywheel(clean)			9.5	kg
152. (160) Weight of flywheel with starter ring			11.4	kg
153. (161) Weight of flywheel with cluth			15.7	kg
154. (162) Weight of crankshaft			13.7	kg
155. (163) Weight of con-rod			0.67	kg
156. (164) Weight of piston with rings and pin			0.47	kg

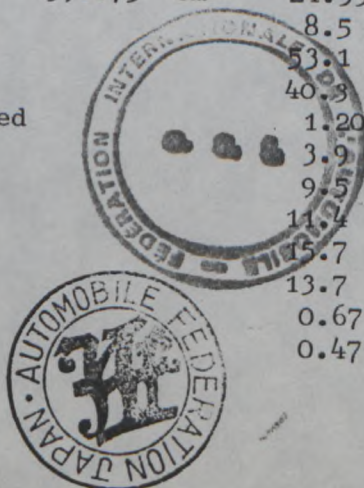

会社名
Make NISSAN

型式
Model PB(L)210

FIA Rec. No. 5568

INLET:

161. (181) Outside diameter of valves	42 mm	1.65 inches
166. (187) Valves open at	B.T.D.C. $12^{\circ} \pm 3^{\circ}$	
167. (188) Valves close at	A.B.D.C. $48^{\circ} \pm 3^{\circ}$	

EXHAUST:

176. (202) Valves open at	B.B.D.C. $54^{\circ} \pm 3^{\circ}$
177. (203) Valves close at	A.T.D.C. $14^{\circ} \pm 3^{\circ}$

CARBURATION:

183. (213) Model	21A304
185. (215) Flange hole diameter of exit port of carburettor	30 & 34 mm
186. (216) Minimum diameter of venturi	23 & 30 mm

ENGINE ACCESSORIES:

205. (255) Camshaft

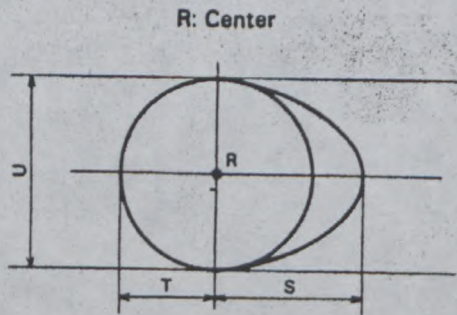

Inlet cam

S=	23.9 mm	0.94 inches
T=	16.5 mm	0.65 inches
U=	33.0 mm	1.30 inches

Exhaust cam

S=	23.9 mm	0.94 inches
T=	16.5 mm	0.65 inches
U=	33.0 mm	1.30 inches

Unit: mm

Drawing of inlet manifold ports, side of cylinder-head with dimensions

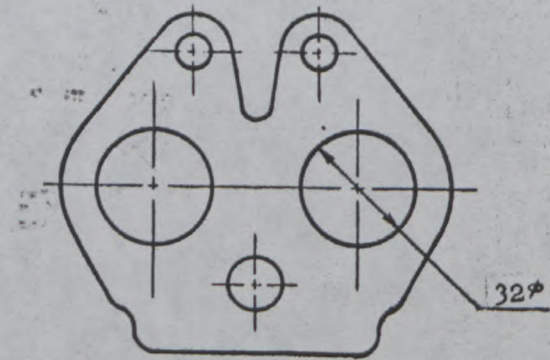

Drawing of entrance to inlet port of cylinder-head with dimensions

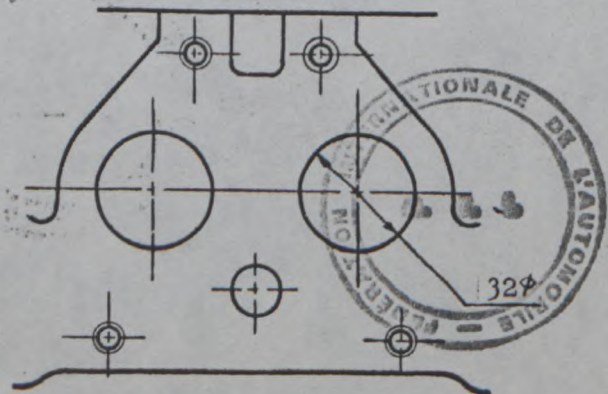

会社名
Make NISSAN

型式
Model PB(L)210

FIA Rec. No. 5568

Photo L,
View of the engine right profile

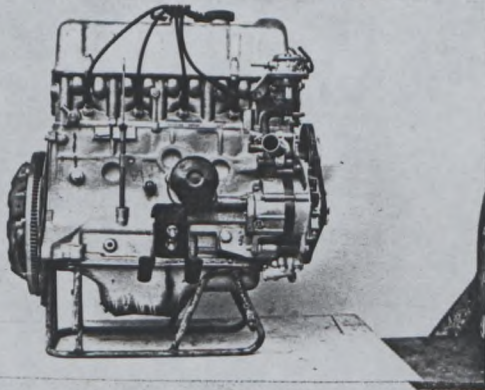

Photo M,
View of the engine left profile

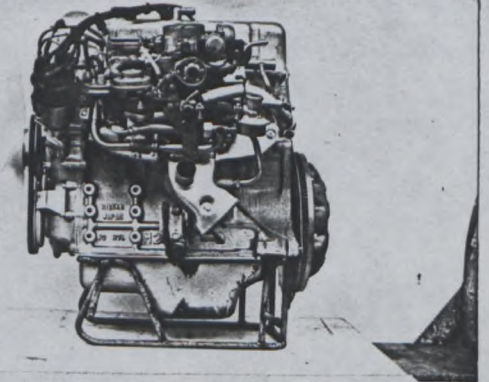

Photo N,
Engine in bay, bonnet removed

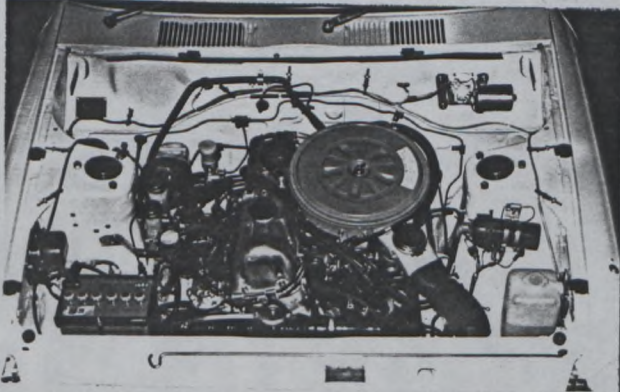

Photo O,
Piston profile



Photo S,
Inlet manifold

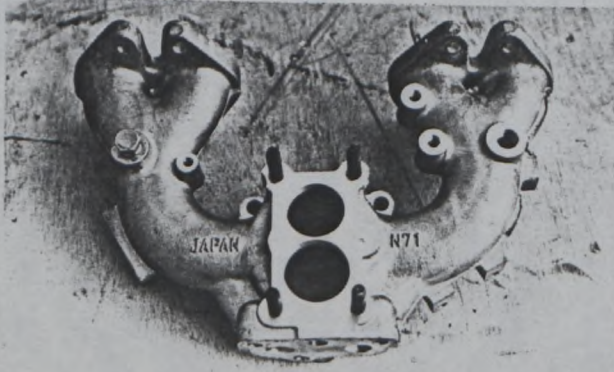

Photo T,
Carburettor

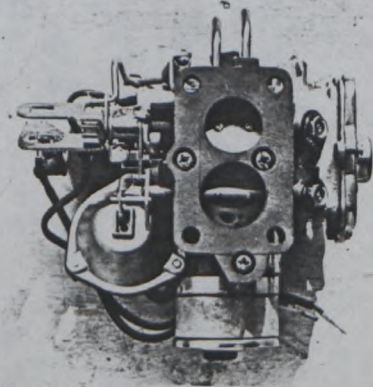

Photo U,
Exhaust piping with muffler



Photo V,
Exhaust manifold





JAPAN AUTOMOBILE FEDERATION

社団法人 日本自動車連盟

J.A.F 公認番号

T-214V-5

発効年月日

昭和51年4月30日

F.I.A. Homol. No. 5568

6/6V

FEDERATION INTERNATIONALE DE L'AUTOMOBILE

Form of recognition accordance with Appendix J to the International Sporting Code.

国際スポーツ法典付則J項及びJAF国内競技車両規則に従った公認書式。

Make NISSAN MOTOR CO., LTD. 製造会社名

Model PB(L)210 DATSUN SUNNY 1400 型式及び通称名

Modification's application starts with serial

No. chassis engine 適用シャーシー型式番号 適用エンジン型式番号 PB(L)210-000001 L14

Application of this amendment started the 通用年月日

APR, 1975.

Commercial denomination after application of modifications PB(L)210,, KP(B)L210, GB211, KGB211,

The modifications are to be considered as: Variant / 変型 / 定規追加

Date amendment is valid from

1 7 76

List

Description of amendment 内容

OPTIONAL EQUIPMENT

VALID FOR GROUP 2 ONLY

NOTE: The item number in the brackets is according to the old recognition form.

GEAR BOX (This type has been recognized at F.I.A. No. 5568/2/2V already. And the following ratios have been added.)

96. (277)

	Manual			
	Ratio	No. teeth	Ratio	No. teeth
1	2.82	$\frac{31}{22} \times \frac{32}{16}$	2.35	$\frac{31}{22} \times \frac{30}{18}$
2	1.97	$\frac{31}{22} \times \frac{28}{20}$	1.60	$\frac{31}{22} \times \frac{25}{22}$
3	1.47	$\frac{31}{22} \times \frac{24}{23}$	1.30	$\frac{31}{22} \times \frac{23}{25}$
4	1.19	$\frac{31}{22} \times \frac{22}{26}$	1.14	$\frac{31}{22} \times \frac{21}{26}$
5	1.00		1.00	
reverse	3.38	$\frac{31}{22} \times \frac{23}{15} \times \frac{36}{23}$	3.38	$\frac{31}{22} \times \frac{23}{15} \times \frac{36}{23}$

"valable en Groupe 2 uniquement" "valid for Group 2 only"

Stamp and signature of the JAF

JAF公認印及び署名

難波靖海

Yasuharu Nanba



Stamp and signature of the F.I.A.

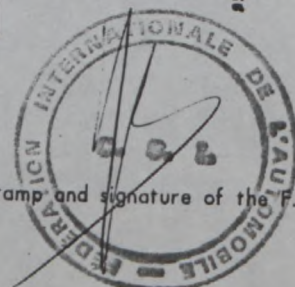

会社名
Make NISSAN

型式
Model PB(L) 210

FIA Rec. No. 5568

FINAL DRIVE

H165 type (This type has been recognized at F.I.A. No. 5568 already.
----- And the following ratios have been added.)

103. (293) Number of teeth 37/10, 37/9, 37/8,

104. (293) Ratio 3.70 , 4.11, 4.625,

H190 type (This type has been recognized at F.I.A. No. 5568/2/2V already.
----- And the following ratios have been added.)

103. (293) Number of teeth 37/11, 39/11, 37/10, 35/9 , 37/9 ,
35/8 , 37/8, 39/8 , 41/8 , 36/7 ,

104. (293) Ratio 3.36 , 3.55, 3.70 , 3.89 , 4.11 ,
4.38 , 4.63, 4.88 , 5.13 , 5.14 ,

"valable en Groupe 2 uniquement"
"valid for Group 2 only"





JAPAN AUTOMOBILE FEDERATION

社団法人 日本自動車連盟

J.A.F公認番号 T-214 V-7
発効年月日 1979年11月30日
F.I.A. Homol. No 5568

08/08V

FEDERATION INTERNATIONALE DE L'AUTOMOBILE

Form of recognition accordance with
Appendix J to the International Sporting Code.

国際スポーツ法典付則J項及びJAF国内競技車両規則に従った公認書式。

Make	NISSAN MOTOR CO., LTD.	Model	PB(L)210	DATSUN SUNNY 1400
製造会社名		型式及び通称名		
Modification's application starts with serial		No. chassis	適用シャーシー型式番号	PB(L)210
Application of this amendment started the		engine	適用エンジン型式	L14
適用年月日				
Commercial denomination after application of modifications				
The modifications are to be considered as:	Variant / modification of the type			
	変型 / 変型			
Date amendment is valid from	-1. JAN. 1980			List

Description of amendment 内容

The following items have been added for group 1.

This variant engine(cylinder block) can be selected for DATSUN SUNNY 1400 series cars as maker's option for each country.

These cylinder block are different just outside view because of anti-pollution equipment, are same all other specifications completely.

CYLINDER BLOCK TYPE:"A"

Parts No. 11011-A7600

Photo

View of the cylinder block, right side.

View of the cylinder block, left side.

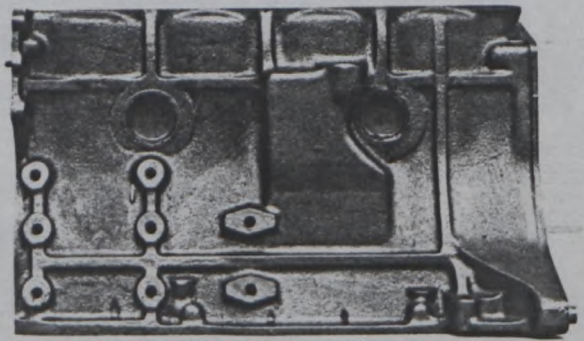
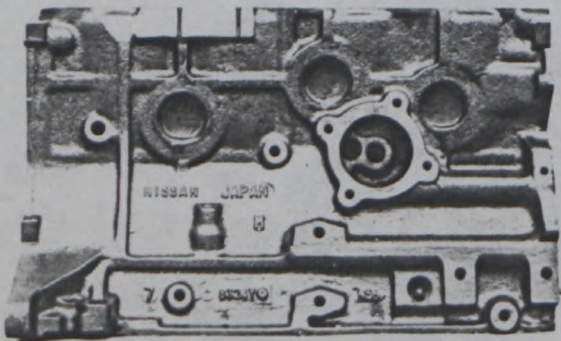

Stamp and signature of the JAF

Stamp and signature of the F.I.A.

JAF公認印及び署名

難波靖治

Yasuharu Nanba



Signature

会社名
Make NISSAN

型式
Model PB(L)210

JAF公認番号 T-214 V-7

FIA Rec. No. 5568

CYLINDER BLOCK TYPE "B"

08/08V

Parts No. 11011-A7610

Photo

View of the cylinder block, right side.

View of the cylinder block, left side.

