

FÉDÉRATION INTERNATIONALE DE L'AUTOMOBILE

FICHE D'HOMOLOGATION CONFORME A L'ANNEXE J DU CODE SPORTIF INTERNATIONAL
POUR LES VOITURES DES GROUPES 1 A 5

BOOK OF RECOGNITION IN ACCORDANCE WITH APPENDIX J TO THE INTERNATIONAL
SPORTING CODE FOR CARS OF GROUPS 1 TO 5

Constructeur/Manufacturer FORD Modèle / Model Escort 1.3
Cylindrée / Cylinder capacity 1297 cc
Constructeur du châssis / Chassis Manufacturer FORD
Constructeur du moteur / Engine Manufacturer FORD
Homologation valable à partir du / Recognition valid as from 1st April 1981
Modèle homologué en groupe 1 Numéro d'homologation
Model recognized in group 1 Recognition number **5834**
Photo A : voiture vue de 3/4 AV Photo B : voiture vue de 3/4 AR
Photo A : 3/4 view of car from front Photo B : 3/4 view of car from rear



CARACTÉRISTIQUES GÉNÉRALES / GENERAL CHARACTERISTICS :

- 1) Mode de construction : ~~construction séparée~~ / monocoque.
Type of car construction : ~~separate~~ / unitary construction.
- 2) Matériau du châssis Steel Matériau de la carrosserie Steel
Material of chassis Material of coachwork
- 3) Empattement droit 2395 mm Gauche 2395 mm
Wheelbase right Left
- 4) Largeur de la carrosserie mesurée aux axes AV 1615 mm
Width of bodywork measured at front axle
- 5) Largeur de la carrosserie mesurée aux axes AR 1645 mm
Width of bodywork measured at rear axle
- 6) Longueur hors-tout avec pare-chocs 4060 mm Sans pare-chocs 3963 mm
Overall length with bumpers Without bumpers
- 7) Type de suspension : AV MacPherson Strut AR Indépendant strut
Type of suspension : Front Rear

(Photo D)

(Photo E)

Signature et cachet de
l'autorité sportive nationale,

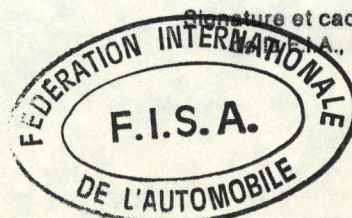

M. irque / Make FORD Modèle / Model Escort 1.3 N° 5834

MOTEUR :

- 8) Cycle 4
- 9) Nombre et disposition des cylindres 4 in line
Number and disposition of cylinders
- 10) Système de refroidissement Water by forced circulation
Cooling system
- 11) Emplacement et position du moteur Transverse in front
Location and position of engine
- 12) Matériau du bloc moteur Cast iron
Material of engine block
- 13) Roues motrices : AV - AR Front
Drive wheels : Front - Rear
- 14) Emplacement de la boîte de vitesses Rear of engine
Location of gear-box

CARROSSERIE ET ÉQUIPEMENT INTÉRIEUR / COACHWORK AND INTERIOR

- 20) Nombre de portes 2
Number of doors
- 21) Matériau des portes : AV steel AR steel
Material of doors : Front Rear
- 22) Matériau du capot moteur steel
Material of bonnet
- 23) Matériau du capot coffre steel
Material of boot lid
- 24) Matériau de la lunette AR Glass
Material of rear window
- 25) Matériau du pare-brise Laminated only for competition
Material of windscreen
- 26) Matériau des glaces des portières AV Glass
Material of front door windows
- 27) Matériau des glaces des portières AR -
Material of rear door windows
- 28) Système d'ouverture des vitres portières AV Rotating handle AR -
Sliding system of door windows Front Rear
- 29) Matériau des glaces de custode Glass
Material of rear quarter lights
- 30) Poids siège (s) AV (enlevés de la voiture avec dossiers, glissières et supports) 13,9 Kg.
Weight of front seat(s) (complete with supports and rails, out of the car)
- 31) Matériau du pare-choc AV Steel/Plastic Poids 4,25 Kg.
Front bumper material Weight
- 32) Matériau du pare-choc AR Steel/Plastic Poids 4,25 Kg.
Rear bumper material Weight
- 33) Ventilation : oui non / yes no

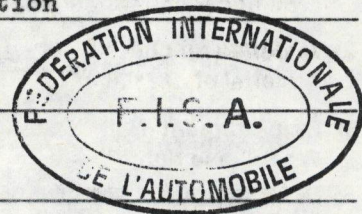

DIRECTION / STEERING

- 40) Type Rack and pinion
- 41) Servo-assistance No
42. Ratio: 3,6

SUSPENSION

- 45) Suspension AV (photo D) Type de ressort Coil
Front suspension (photo D) Type of spring
- 46) Nombre d'amortisseurs One per wheel
Number of shock absorbers
- 47) Suspension AR (Photo E) Type de ressort Coil
Rear suspension (Photo E) Type of spring
- 48) Nombre d'amortisseurs One per wheel
Number of shock absorbers
- 49) Système de fixation des roues Cone bolts
Method of fixation of wheels

FREINS - BRAKES

- 50) Système Hydraulic
Method of operation
- 51) Servo frein (si prévu) Type : Vacumn
Servo assistance (if fitted) Type :
- 52) Nombre de maîtres-cylindres Two
Number of master-cylinders

	AVANT / FRONT	ARRIERE / REAR
53) Nombre de cylindres par roue Number of cylinders per wheel	One	One
54) Alésage Bore	54 mm	19,05 mm
Freins à tambour / Drum brakes		
55) Diamètre intérieur Inside diameter		180 mm
56) Nombre de mâchoires par frein Number of shoes per brake		Two
57) Surface de freinage par frein Total area per brake		169 cm ²
Freins à disques / Disc brakes		
58) Largeur des sabots Width of brake linings	38,5 mm	
59) Nombre de sabots par frein Number of pads per brake	Two	
60) Surface de freinage par frein Total area per brake	1369,7 cm ²	

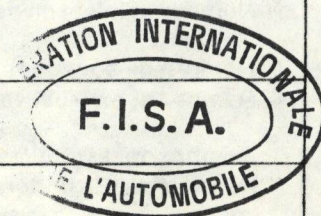

MOTEUR / ENGINE

- 65) Alésage 79,96 mm
Bore
- 67) Course 64,52 mm
Stroke
- 68) Cylindrée totale 1296 cc
Total cylinder-capacity
- 69) Cylindrée maximum autorisée 1299,9 cc
Maximum cylinder-capacity allowed
- 70) Culasse : matériau Alum
Head : material
- 71) Nombre One
Number
- 72) Type de vilebrequin One piece
Type of crankshaft
- Coulé / estampé Moulded
Moulded / stamped
- 73) Nombre de paliers de vilebrequin Five
Number of crankshaft main bearings
- 74) Diamètre maximal des manetons de vilebrequin 47,91 mm
Maximum diameter of the big end journal
- 75) Tête de bielle : type Split diamètre 50,91 mm
Connecting rod big end type
- 76) Matériau des chapeaux des paliers de vilebrequin Cast iron
Material of bearing cap
- 77) Matériau du volant moteur Cast iron
Material of flywheel
- 78) Matériau du vilebrequin Cast iron
Crankshaft material
- 79) Matériau de la bielle Steel forging
Connecting rod material
- 80) Système de graissage : carter sec - carter humide Oil in sump
Lubrication system : dry-sump - oil in sump
- 81) Nombre de pompes à huile One
Number of oil pumps

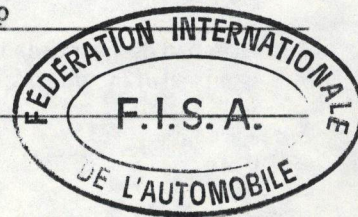

Moteur 4 temps / 4 stroke engines

- 82) Nombre d'arbres à cames One Emplacement in cylinder head
Number of camshafts Location
- 83) Système de commande Tooth bolt
Type of camshaft drive
- 84) Système de commande des soupapes Follower and rockers
Type of valve operation
- 85) Nombre de soupapes d'admission par cylindre One
Number of inlet valves per cylinder
- 86) Nombre de soupapes d'échappement par cylindre One
Number of exhaust valves per cylinder
- 87) Nombre de distributeurs One
Number of distributors
- 88) Nombre de bougies par cylindre One
Number of spark plug per cylinder

TRANSMISSION AUX ROUES / DRIVE TRAIN

Embrayage / Clutch

- 90) Nombre de disques One
 Number of plates _____
- 91) Système de commande Cable & lever system
 Method of operating clutch _____

Boîte de vitesses / Gear-box

- 92) Contrôle manuel, marque Ford
 Manual type, make _____
- 93) Nombre de rapports AV Four
 Number of gear-box ratios forward _____
- 94) Boîte automatique, marque -
 Automatic, make _____
- 95) Nombre de rapports AV -
 Number of gear-ratios forward _____

96	Manuelle / Manual		Automatique		Supp. manuel / Automatique			
	Rapport Ratio	N. dents Nr teeth	Rapport Ratio	N. dents Nr teeth	Rapport Ratio	N. dents Nr teeth	Rapport Ratio	N. dents Nr teeth
1	3,15	41:13			2,83	34:12		
2	1,90	40:21			2,00	32:16		
3	1,28	37:29			1,55	28:18		
4	0,95	39:41			1,30	26:20		
5								
6								
M. AR / Rev.	3,62	47:13			3,77	49:13		

- 97) Surmultiplication type N.A.
 Overdrive type _____
- 98) Nombre de dents N.A.
 Number of teeth _____
- 99) Rapport Ratio N.A.

- 100) Vitesses en marche AV avec surmultiplication N.A.
 Forward gears on which overdrive can be selected _____

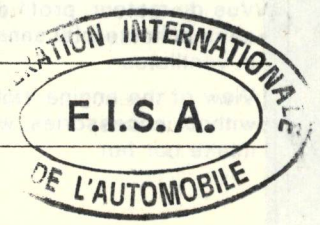

Pont/moteur / Final drive

- 101) Type du pont moteur Helical gear
 Type of final drive _____
- 102) Type de différentiel Star wheel
 Type of differential _____
- 103) Nombre de dents 68:19
 Number of teeth _____
- 104) Rapport Ratio 3,58

Photo C



Photo D

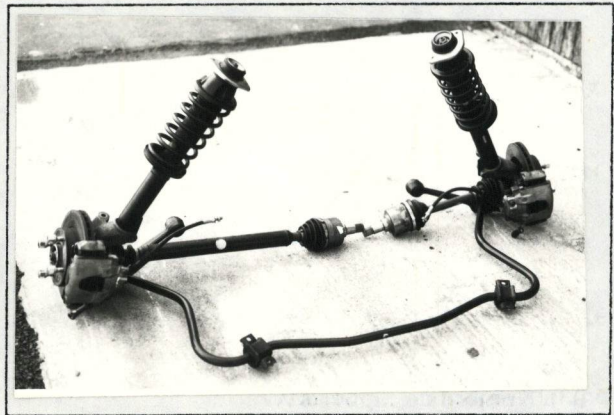

Photo E

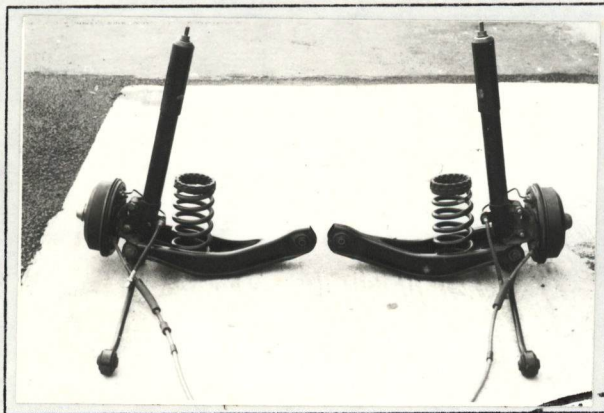

Photo F

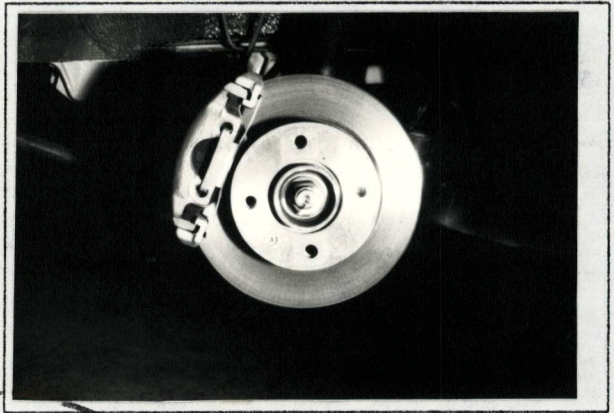

Photo G



Photo H

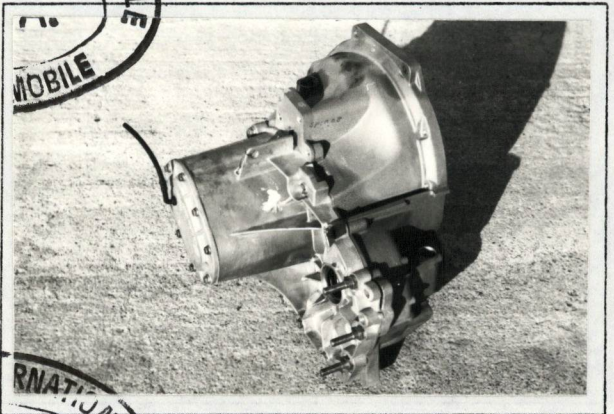

Photo I

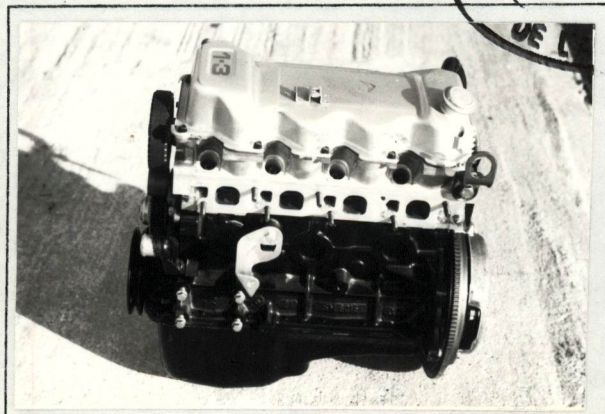

Photo J

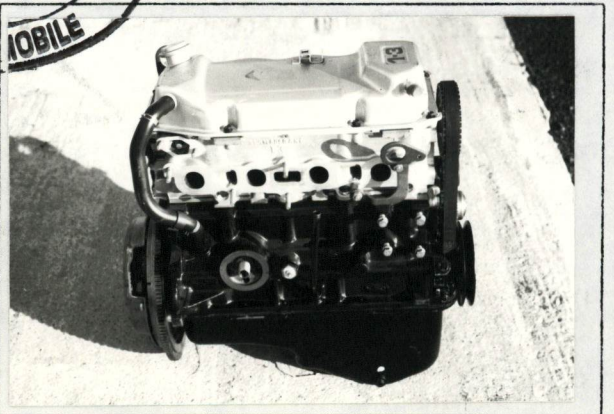
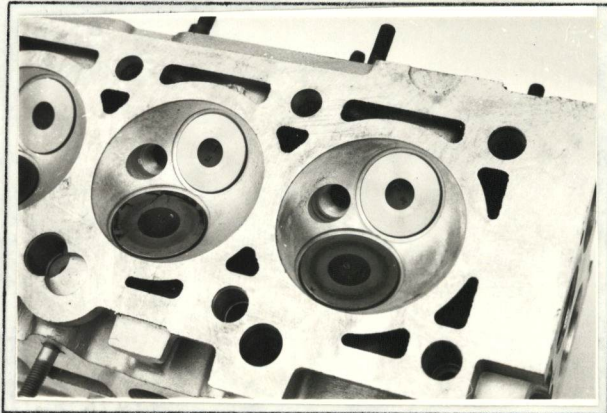
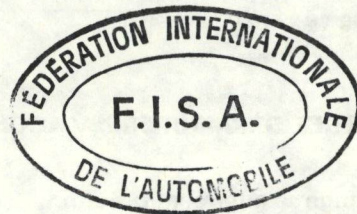

Photo K



Informations supplémentaires
Additional informations.

- 3a. Front overhang 760 mm
- 3b. Rear overhang 890 mm
- 61. Disc thickness 10 mm
- 62. Disc O.D. 238,7 mm



- B = 1016 mm
- C = 1321
- D = 914
- E = 1372

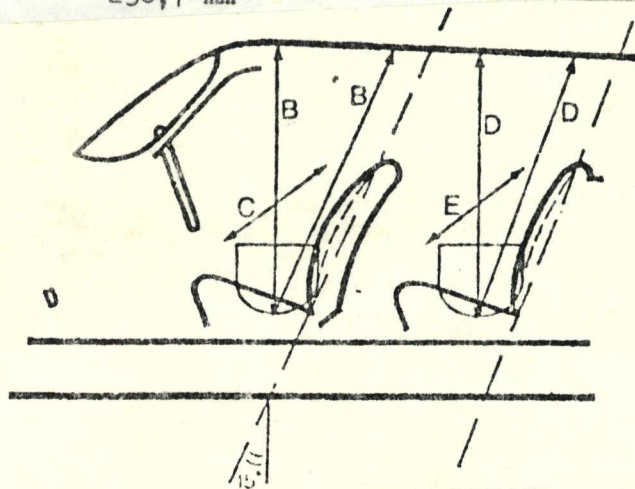

- K = 482 mm
- L = 343
- M = 451
- P = 711
- K + L + M = 1098

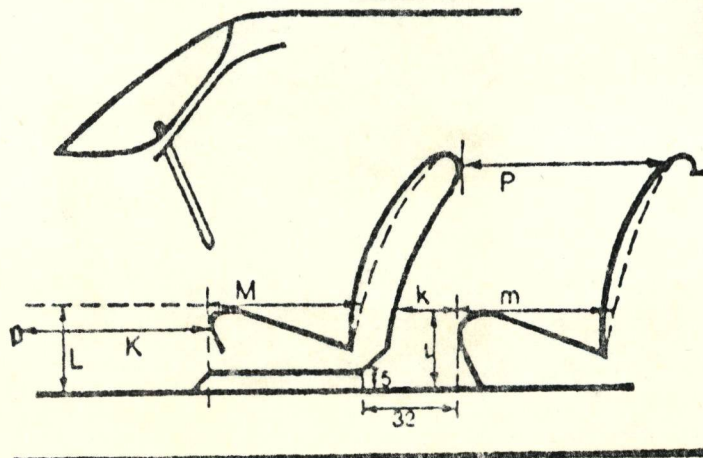

Marque / Make FORD Modèle / Model Escort 1.3 N° 5834

COMPLÉMENT POUR LES GROUPES 1 ET 3
DU CODE SPORTIF INTERNATIONAL

ADDITIONAL DATA FOR GROUPS 1 AND 3
TO THE INTERNATIONAL SPORTING CODE

CAPACITÉS ET DIMENSIONS / CAPACITIES AND DIMENSIONS

- 110) Voie AV / Front track 1395 mm
- 111) Voie AR / Rear track 1435 mm
- 112) Garde au sol (pour vérification de la voie) 260 mm (lowest part of door)
Ground clearance (for verification of the track)
- 113) Hauteur hors-tout de la voiture / Overall height of the car 1336 mm (unladen)
- 114) Capacité du réservoir d'essence (y compris la réserve) 40 L
Fuel tank capacity (including reserve)
- 115) Nombre de places 4 116) Poids 840 Kg.
Seating capacity Weight

EQUIPEMENT ET GARNITURES / ACCESSORIES AND UPHOLSTERY

- 120) Chauffage intérieur : oui - non Yes
Interior heating : yes - no
- 121) Climatisation (sur option) : oui - non No
Air conditioning (in option) : yes - no
- 122) Sièges AV : type Bucket
Front seats : type
- 123) Sièges AR : type Bench
Rear seats : type

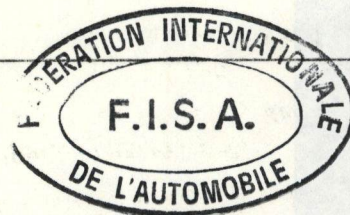

ROUES / WHEELS

- 124) Matériau Steel
Matériau
- 125) Poids unitaire (roue nue) 6,9 kg (tolérance $\pm 5\%$)
Unitary weight (bare wheel)
- 126) Diamètre de la jante 13" (330 mm)
Rim diameter
- 127) Largeur de la jante 4,5" (114 mm)
Rim width

SUSPENSION

- 130) Stabilisateur AV (si prévu) Torsion bar
Front stabilizer (if fitted)
- 131) Stabilisateur AR (si prévu) Torsion bar
Rear stabilizer (if fitted)

MOTEUR / ENGINE

- 135) Cylindrée par cylindre / Capacity per cylinder 323,99 cc
- 136) Chemises : oui / non Both available
Sleeves : yes / no.
- 137) Nombre d'orifices d'admission par cylindres One
Number of inlet ports per cylinder
- 138) Nombre d'orifices d'échappement par cylindre One
Number of exhaust ports per cylinder
- 139) Rapport volumétrique 10,78 Max.
Compression ratio
- 140a) Volume de la chambre de combustion (minimum) 33,2 cc
Volume of the combustion chamber
- 140b) Volume de la chambre de combustion dans la culasse 54 ± 3 cm³
Volume of combustion chamber in head
- 141) Épaisseur du joint de culasse 1,6 + 0,4 mm
Thickness of head gasket inter tightened
- 142) Piston, matériau Alum Alloy
Piston, material
- 143) Nombre de segments Three
Number of rings
- 144) Distance de la médiane de l'axe du piston au sommet du piston 47,8 mm
Distance from gudgeon pin center line to highest point of piston crown
- 145) Capacité du réservoir - carter 3,5
Capacity, lubricant
- 146) Radiateur d'huile : oui - non No
Oil cooler : yes - no
- 147) Capacité du circuit de refroidissement 6,9 L
Capacity of cooling system
- 148) Ventilateur (si prévu), diamètre 278 mm Matériau Plastic
Cooling fan (if fitted), diameter Material
- 149) Nombre de pales du ventilateur Four
Number of fan blades
- 150) Paliers vilebrequin, type Plain, multi layer diamètre 58,00 mm
Crankshaft main bearings, type diameter
- 151) Poids volant (nu) N.A.
Weight of flywheel (clean)
- 152) Poids du volant avec couronne de démarreur 6,1 Kg.
Weight of flywheel with starter ring
- 153) Poids du volant avec embrayage 10,0 Kg.
Weight of flywheel with clutch
- 154) Poids du vilebrequin 9,9 Kg.
Weight of crankshaft
- 155) Poids de la bielle 0.58 kg
Weight of con-rod
- 156) Poids du piston avec axe et segments 0.52 kg
Weight of piston with rings and pin



ADMISSION / INLET

- 160) Matériau du collecteur d'admission Alum
 Material of inlet manifold
- 161) Diamètre extérieur des soupapes 42,1 mm
 Outside diameter of valves
- 162) Levée maximum des soupapes 9,6 mm
 Maximum valve lift
- 163) Nombre de ressorts par soupape 1
 Number of springs per valve
- 164) Type de ressort Coil
 Type of spring
- 165) Jeu théorique pour le calage de la distribution 1 mm - hydraulic
 Theoretical timing clearance
- 166) Avance d'ouverture (avec jeu théorique) 13° B.T.D.C.
 Valves open at (With tolerance for tappet clearance indicated)
- 167) Retard de fermeture 28° A.B.D.C.
 Valves close at

ÉCHAPPEMENT / EXHAUST

- 170) Matériau du collecteur d'échappement Cast iron
 Material of exhaust manifold
- 171) Diamètre extérieur des soupapes 34,1 mm
 Outside diameter of valves
- 172) Levée maximum des soupapes 9,6 mm
 Maximum valve lift
- 173) Nombre de ressorts par soupape 1
 Number of springs per valve
- 174) Type de ressort Coil
 Type of spring
- 175) Jeu théorique pour le calage de la distribution 1 mm - hydraulic
 Theoretical timing clearance
- 176) Avance d'ouverture (avec jeu théorique) 30° B.B.D.C.
 Valves open at (with tolerance for tappet clearance indicated)
- 177) Retard de fermeture 15° A.T.D.C.
 Valves close at

ALIMENTATION PAR CARBURATEURS / CARBURATION

- 180) Nombre de carburateurs One
 Number of carburetors
- 181) Type downdraught
- 182) Marque Ford 183) Modèle VV
 Make Model
- 184) Nombre de passages de gaz par carburateur One
 Number of mixture passages per carburettor

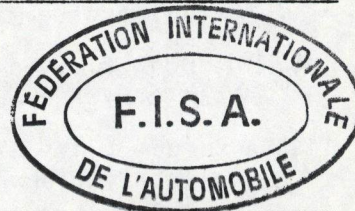

- 185) Diamètre de la tubulure de gaz à la sortie du carburateur 36 mm
 Flange hole diameter of exit port of carburettor
- 186) Diamètre du diffuseur au point d'étranglement maximum N.A.
 Minimum diameter of venturi
- Injection (si prévue) (if fitted)**
- 187) Marque de la pompe N.A.
 Make of pump
- 188) Nombre de pistons N.A.
 Number of plungers
- 189) Modèle ou type de la pompe N.A.
 Model or type of pump
- 190) Nombre total d'injecteurs N.A.
 Total number of injectors
- 191) Emplacement des injecteurs N.A.
 Location of injectors
- 192) Diamètre de la pipe d'admission au point de passage le plus étroit N.A.
 Minimum diameter of inlet pipe

ÉQUIPEMENT DU MOTEUR / ENGINE ACCESSORIES

- 195) Pompe à essence - mécanique et/ou électrique Mechanical
 Fuel pump - mechanical and/or electrical
- 196) Nombre One
 Number
- 197) Type du système d'allumage Electronic
 Type of ignition system
- 198) Nombre de bobines One
 Number of ignition coils
- 199) Génératrice : type Alternator Nombre One
 Generator : type Number
- 200) Système d'entraînement Vee belt
 Method of drive
- 201) Batterie / Battery
 a) Tension 12 b) Emplacement In engine bay
 Voltage Location

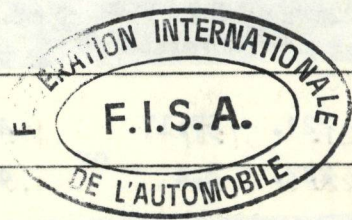

205) Arbres à cames / Camshaft

R : Centre

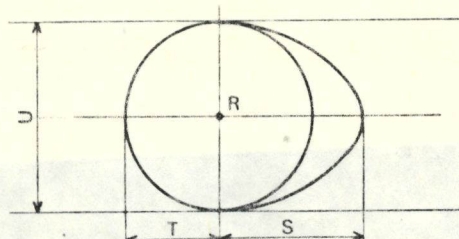

TP can be reduced to mm - no reclain.
 "ST" and "UP" are adjusted accordingly to preserve
 camshaft profile.

	Came admission Inlet cam	Came échappement Exhaust cam
S =	<u>22,1</u> mm _____ inches	S = <u>21,6</u> mm _____ inches
T =	<u>16,2</u> mm _____ inches	T = <u>15,7</u> mm _____ inches
U =	<u>32,7</u> mm _____ inches	U = <u>31,7</u> mm _____ inches

TRANSMISSION AUX ROUES / WHEEL DRIVE

Embrayage / clutch

- 210) Type Diaphragm
- 211) Diamètre / Diameter 190 mm
- 212) Diamètre des garnitures : intérieur 135 mm extérieur 190 mm
 Diameter of linings : interior outside
- 213) Nombre de disques One
 Number of discs

Boîte de vitesses / Gear-box

- 215) Nombre de rapports AV synchronisés Four
 Number of forward synchronised ratios
- 216) Emplacement de la commande Central, on floor
 Location of the gear lever
- 217) Boîte automatique - emplacement de la commande N.A.
 Automatic gear-box - location of gear lever
- 218) Surmultiplication - type N.A.
 Overdrive type
- 219) Rapport de surmultiplication N.A.
 Overdrive ratio

Pont moteur - Final drive

- 220) Type du pont autobloquant (si prévu) _____
 Type of limited slip differential (if provided)
- 221) Nombre de dents du couple conique 68:19 ou 69:17
 Number of teeth of final drive or
- 222) Rapport au couple conique 3,58 ou 4.06
 Final drive ratio or

221. 57:17 or 49:18
 222. 3,4 or 4,08

Final drive
 integral to
 series gear

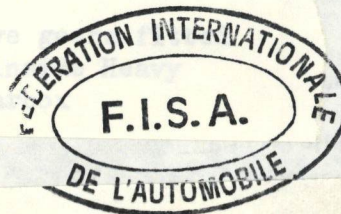

Final drive ratios are integral part of gearbox, consequently in supplementary heavy series gearboxes the final drive gears are also uprated and require different tooth combinations to achieve similar final drive ratios.

Photo K

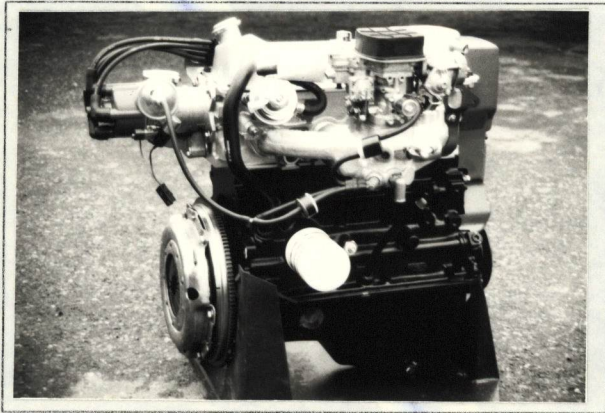

Photo L

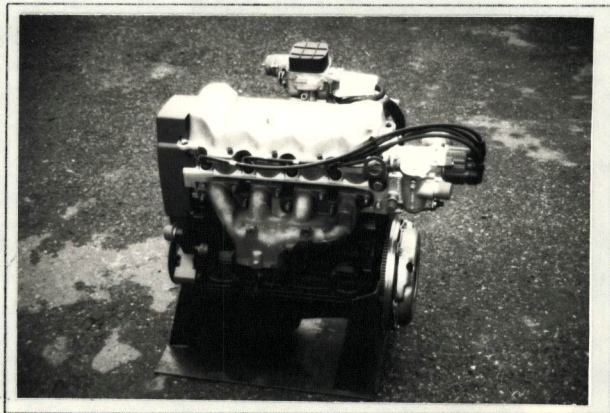

Photo M

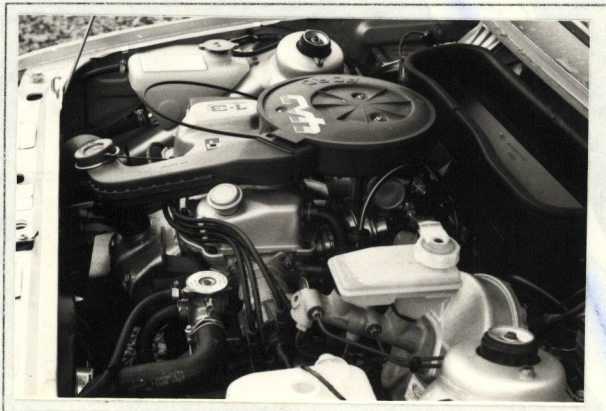

Photo N



Photo P

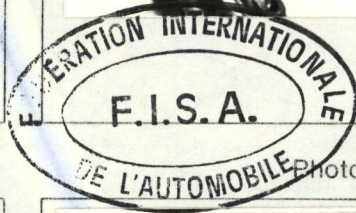

Photo Q



Photo R



Photo S

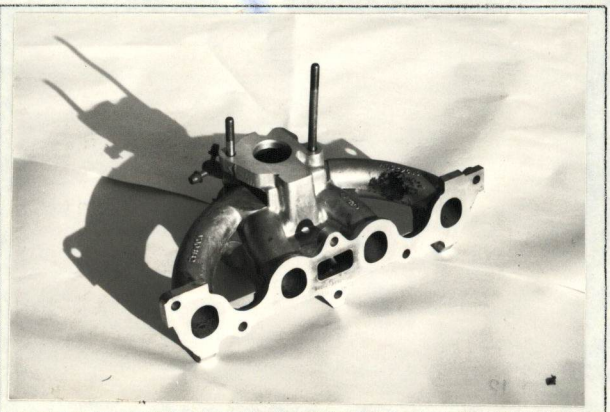

Dessin orifices collecteur admission, face côté culasse.

Drawing inlet manifold ports, side of cylinderhead.

avec dimensions
with

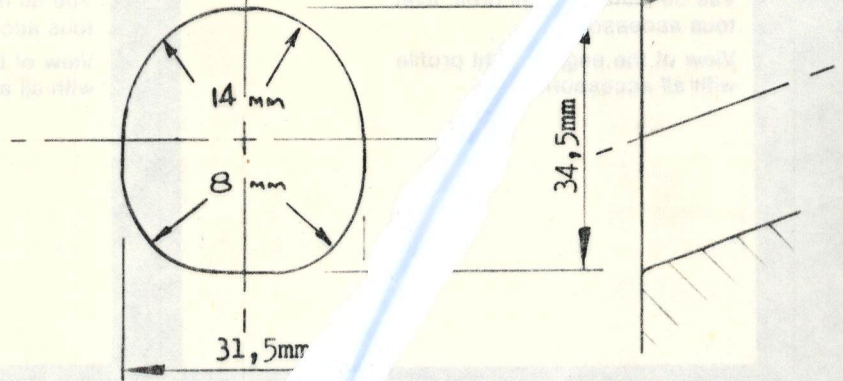

Dessin orifices admission culasse face collecteur.

Drawing of entrance to inlet port of cylinderhead.

avec dimensions
with

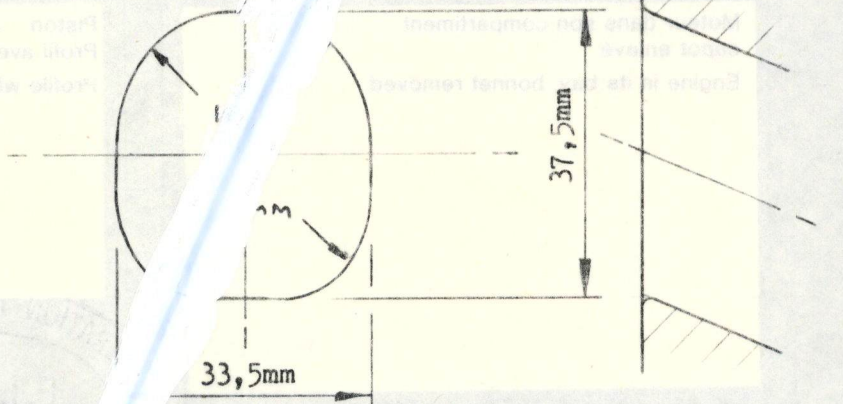

Dessin orifices collecteur échappement face côté culasse.

Drawing of exhaust manifold ports, side of cylinderhead.

avec dimensions
with

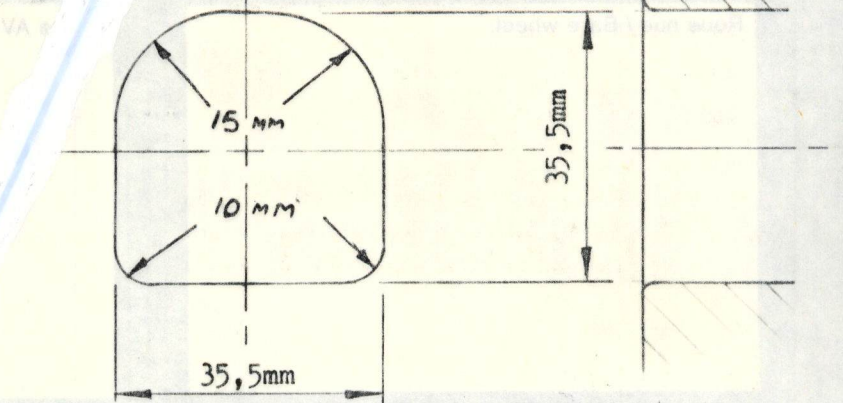

Dessin orifices échappement culasse face collecteur.

Drawing of exit to exhaust port cylinderhead.

avec dimensions
with

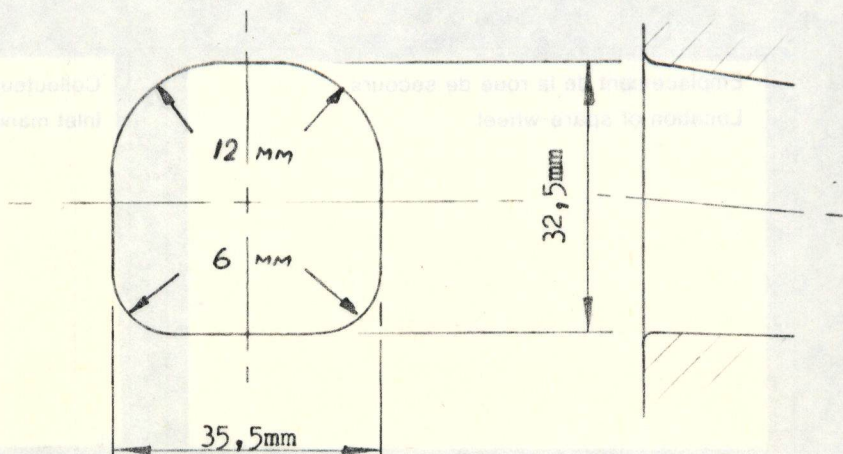

Dessin orifices collecteur admission, face côté culasse.

Drawing inlet manifold ports, side of cylinderhead.

avec dimensions
with

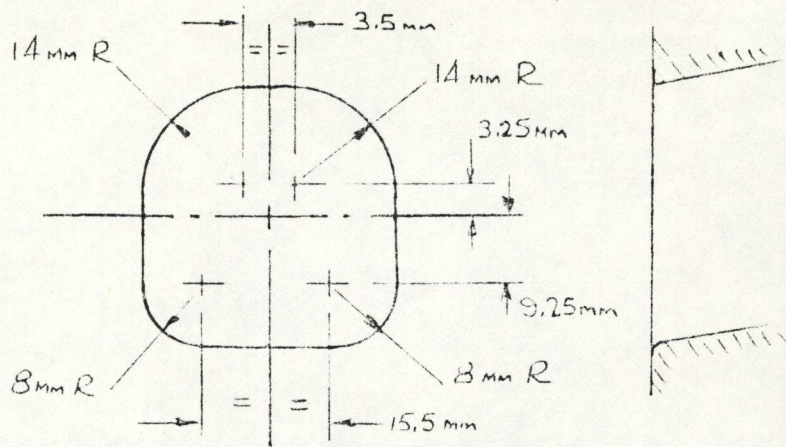

Dessin orifices admission culasse face collecteur.

Drawing of entrance to inlet port of cylinderhead.

avec dimensions
with

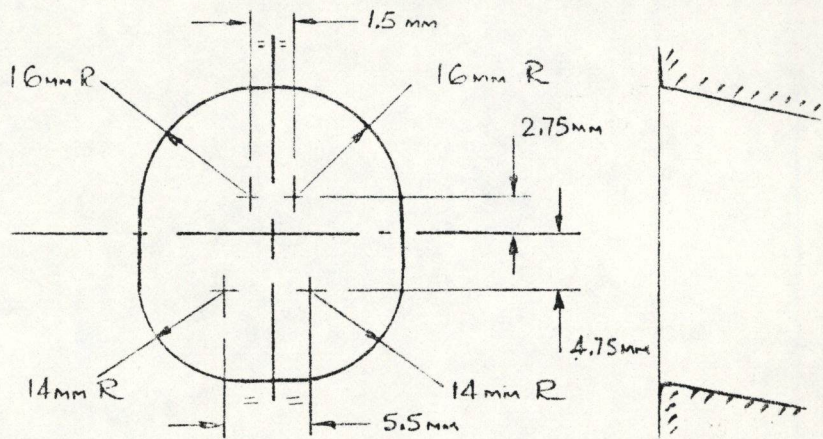

Dessin orifices collecteur échappement face côté culasse.

Drawing of exhaust manifold ports, side of cylinderhead.

avec dimensions
with

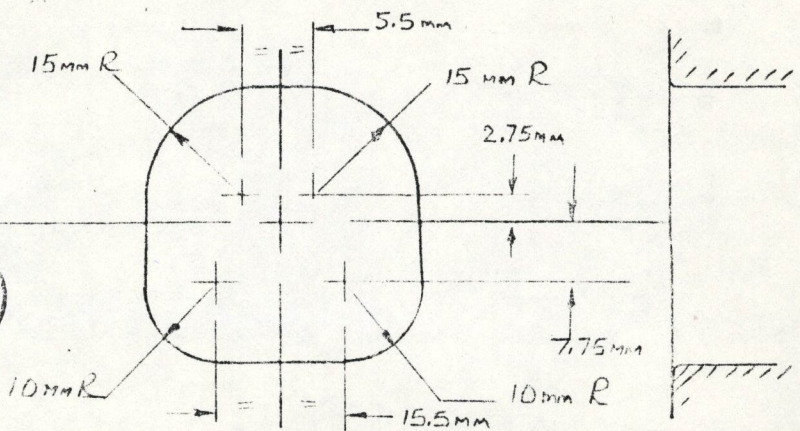
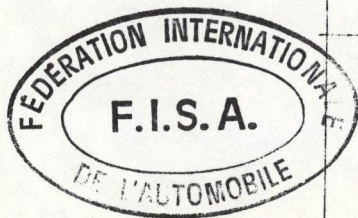

Dessin orifices échappement culasse face collecteur.

Drawing of exit to exhaust port cylinderhead.

avec dimensions
with

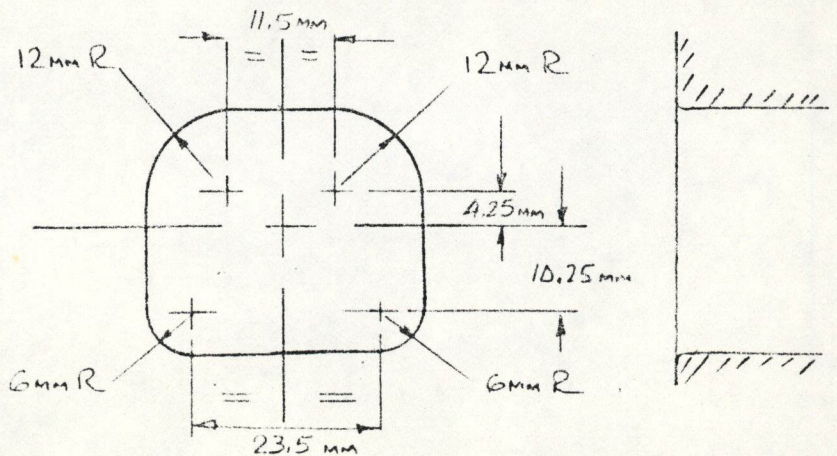

Photo T



Photo U

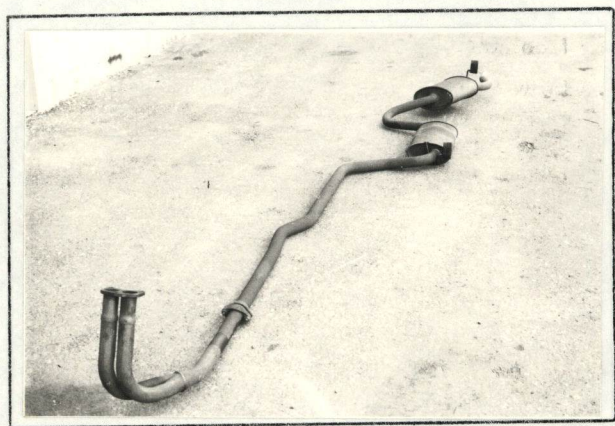
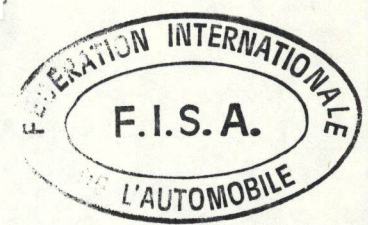

Photo V



Dia. outlet pipe from manifold = 2 x 37 mm

Informations supplémentaires
Additional informations



All inlet and exhaust tracts may be reclaimed by limited fettling within factory. All cast ports have ± 2 mm tolerance to allow for casting miss-match.

(This replaces FIA tolerances)



Photo W

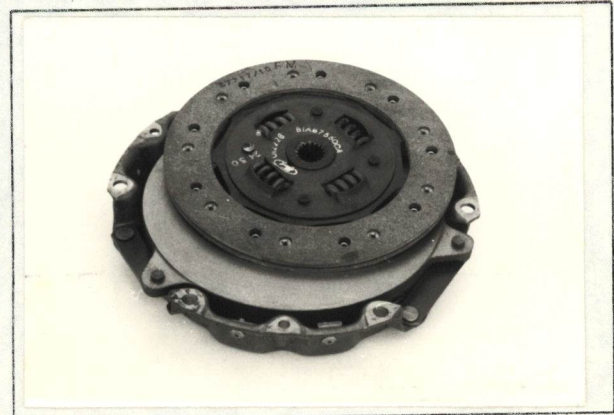

Grille de vitesses
Gear change gate

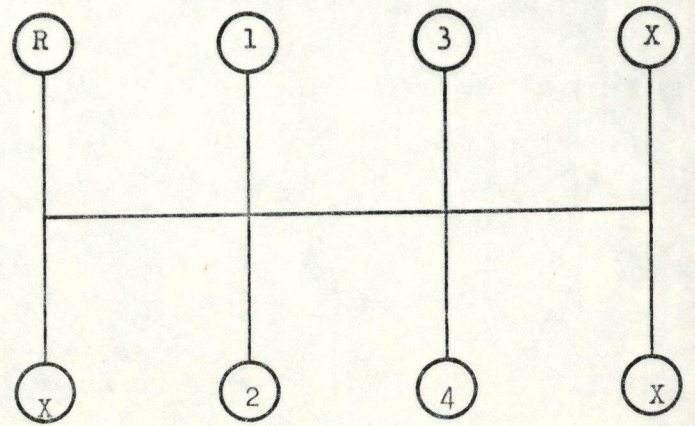



BRITISH MOTOR SPORTS COUNCIL
31 Belgrave Square, London SW1X 8QH

Manufacturer FORD

Model Escort 1.3

F.I.A. Recognition No. 5834

Amendment No. 01/01 V

Amendment to Form of Recognition

FEDERATION INTERNATIONALE DE L'AUTOMOBILE

Valid in Group _____ 1 _____

No.

Reference No.

Product Variant

- | | | | |
|------|---|---------|----------------------|
| 160. | Alum Alloy -- see photo 80-17 | 161. | 42,1 mm |
| 162. | 10,15 mm | 166. | 8° |
| 167. | 36° | 171. | 37,15 mm |
| 172. | 10,1 mm | 176. | 34° |
| 177. | 6° | 182. | Weber -- photo 80-18 |
| 183. | 32/34 DF TM 4 | 184. | 2 |
| 185. | 32/34 mm | 186. | 24/25 mm |
| 205. | Intake | Exhaust | |
| | S = 22,4 mm | 21,9 mm | |
| | T = 16,2 mm | 15,7 mm | |
| | U = 32,7 mm | 31,7 mm | |
| 221. | 73:19 | | |
| 222. | 3,84 | | |
| | Tooth combination used in heavy series box is 56:15 for 3,73 ratio. | | |

Power Steering Rack

- | | | | |
|-----|--------------------|-----|-------------|
| 40. | Rack & pinion | 41. | Hydraulic |
| 42. | Turns L to L = 3,5 | | Photo 80-20 |

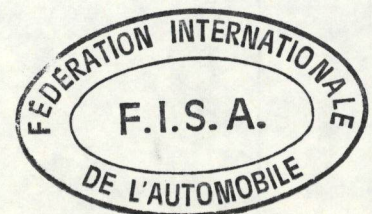



BRITISH MOTOR SPORTS COUNCIL
31 Belgrave Square, London SW1X 8QH

Manufacturer FORD
Model Escort 1.3
F.I.A. Recognition No. 5834
Amendment No. ~~01/01 V~~

Amendment to Form of Recognition

FEDERATION INTERNATIONALE DE L'AUTOMOBILE

Valid in Group 1

No.

Reference No.

Product Variant

The same basic car is sold in and from the U.S. of A. as Ford Escort in "L", "GL", "GLX" and "SS" trim variations, and as Mercury Lynx in "Base", "GL", "GS", "LS" and "RS" trim variations.

These cars differ from European variants externally as a result of "Federal" bumpers - photo 80-10 & 80-11, and also modified facia layout photo 80-12.

- 6. Overall length 4166 mm
- 3a. Front overhang = 845 mm
- 3b. Rear overhang = 925 mm
- 31. Bumper weight (front) 4,2 Kg.
- 32. Bumper weight (rear) 4,2 Kg.
- 116. Weight of base car 890 Kg.

- 124. Steel - photo 80-14
- 125. 6,5 Kg.
- 126. 13" (330 mm)
- 127. 5,0" (127 mm)
- 124. Alum Alloy - photo 80-15
- 125. 6,7 Kg.
- 126. 13" (330 mm)
- 127. 5,5 (139,7 mm)

- 61. Vented disc brake 24 mm thick - photo 80-16

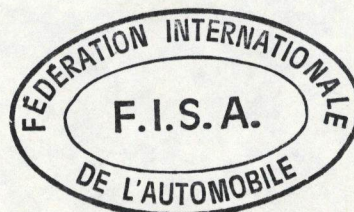



BRITISH MOTOR SPORTS COUNCIL
31 Belgrave Square, London SW1X 8QH

Manufacturer FORD

Model Escort 1.3

F.I.A. Recognition No. 5834

Amendment No. 01701V

Amendment to Form of Recognition

FEDERATION INTERNATIONALE DE L'AUTOMOBILE

Valid in Group 1

No.

Reference No.

Safety roll over cage - complies with min. F.I.A. requirements -
photo's 80-8; 80-9.

Material: Min. specification; cold drawn seamless carbon
steel EN 30 da N.

Min. dimension: 38 mm O.D. x 2,6 mm wall thickness

Weight: 15,1 Kg. 6 or 14 point attachment

54. Rear: 22,2 mm with revised setting in anti lock valve.

Alternative Gear Box ratio,s - same casing.

1	3,58	43:12
2	2,05	41:20
3	1,35	35:26
4	0,95	39:41
Rev	3.77	49:13



Date amendment is valid from.....

Stamp of F.I.A./R.A.C



BRITISH MOTOR SPORTS COUNCIL
31 Belgrave Square, London SW1X 8QH

Manufacturer FORD
Model Escort 1.3
F.I.A. Recognition No. 5834
Amendment No. 01/01V

Amendment to Form of Recognition

FEDERATION INTERNATIONALE DE L'AUTOMOBILE

Valid in Group 1

No.

Reference No.

Product Variant

Alternative Road Wheels

- | | |
|------------------------------|--------------------|
| 124. Steel - photo 80-1 | 125. 6,5 Kg. |
| 126. 13" (330 mm) | 127. 5,0 (127 mm) |
| 124. Alum Alloy - photo 80.2 | 125. 7,5 Kg. |
| 126. 14" (355 mm) | 127. 5,5" (139 mm) |

Alternative sport seat - photo 80-3

Adjustment - sliding runners
Weight: 8 Kg.
Manufacturer: Ford

Alternative sports seat - photo 80-4

Adjustment - sliding runners
Weight: 10 Kg.
Manufacturer: Ford

Heavy duty radiator - photo 80-5

(interchangeable with standard unit as regards position, mounting etc.)

Oil cooler (hot climate package) - photo 80-6

Rear brakes (heavy duty package) - photo 80-7

- 55. 8" (203 mm)
- 56. 2
- 57. 2025 cm²

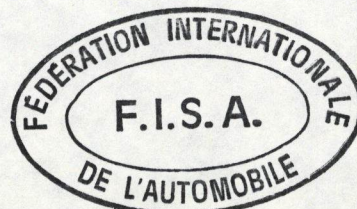



MOTOR SPORT DIVISION
The Royal Automobile Club
31 Belgrave Square, London SW1X 8QH

Manufacturer **FORD**
 Model **Escort 1.3**
 F.I.A. Recognition No. **5834**
 Amendment No. **01/01V**

Amendment to Form of Recognition

FEDERATION INTERNATIONALE DE L'AUTOMOBILE

Valid in Group One

Photographs must be 3" x 2" and a matt finish



80-7



80-8



80-9

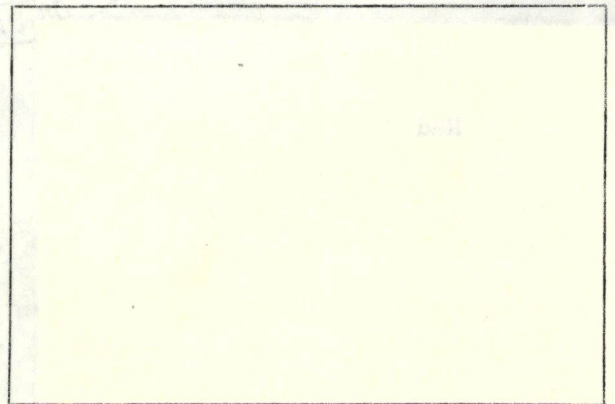
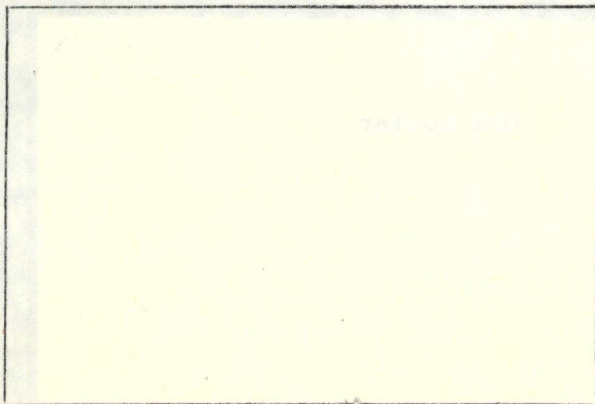
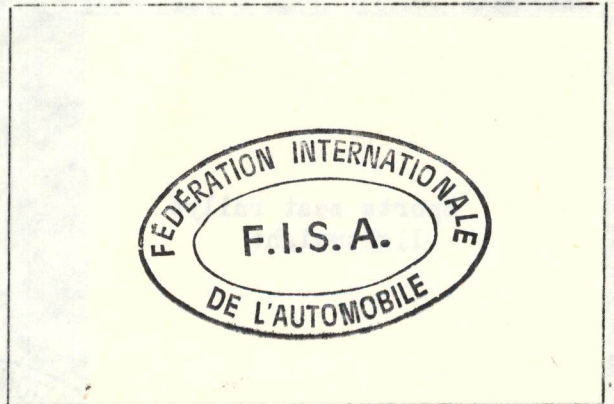

Date amendment is valid from.....

Stamp of F.I.A./R.A.C.



MOTOR SPORT DIVISION
The Royal Automobile Club
31 Belgrave Square, London SW1X 8QH

Manufacturer **FORD**
 Model **Escort 1.3**
 F.I.A. Recognition No. **5834**
 Amendment No. **01/01V**

Amendment to Form of Recognition

FEDERATION INTERNATIONALE DE L'AUTOMOBILE

Valid in Group One

Photographs must be 3" x 2" and a matt finish



80-1



80-2



80-3



80-4

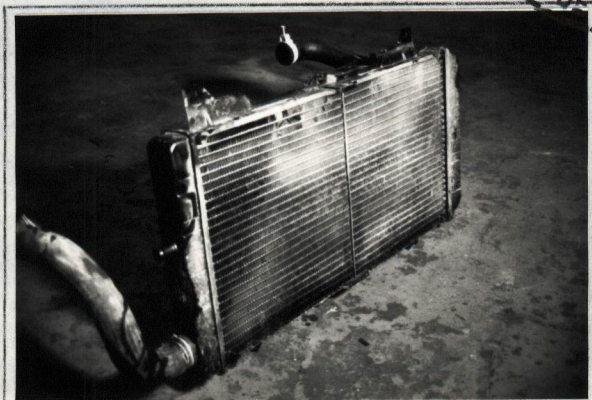
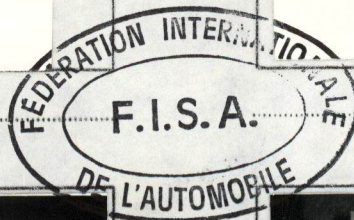

80-5

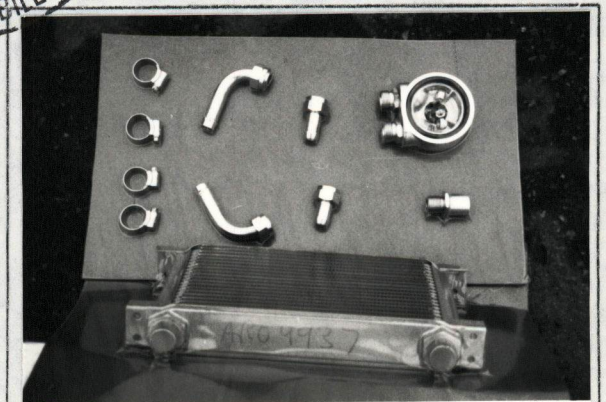

80-6

Date amendment is valid from.....

Stamp of F.I.A./R.A.C.



MOTOR SPORT DIVISION
The Royal Automobile Club
31 Belgrave Square, London SW1X 8QH

Manufacturer FORD
 Model Escort 1.1
 F.I.A. Recognition No. **5834**
 Amendment No.

01/01V

Amendment to Form of Recognition

FEDERATION INTERNATIONALE DE L'AUTOMOBILE

Valid in Group _____

Photographs must be 3" x 2" and a matt finish

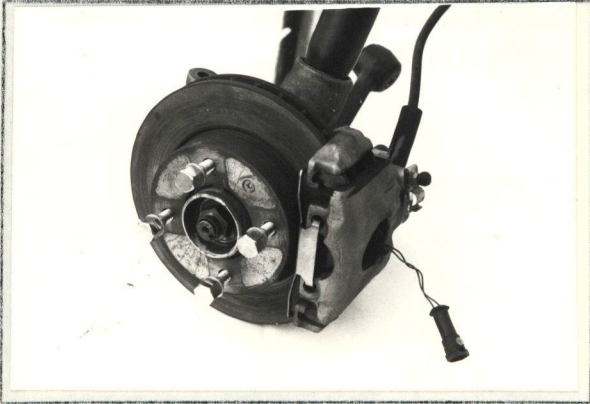

80-16

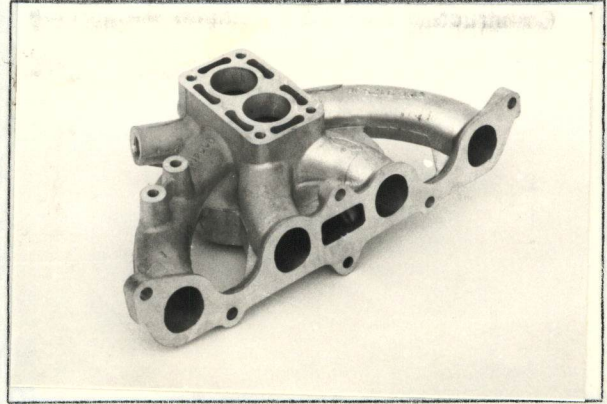

80-17

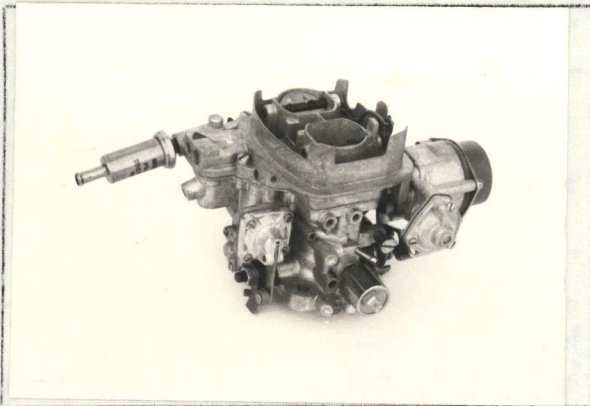

80-18

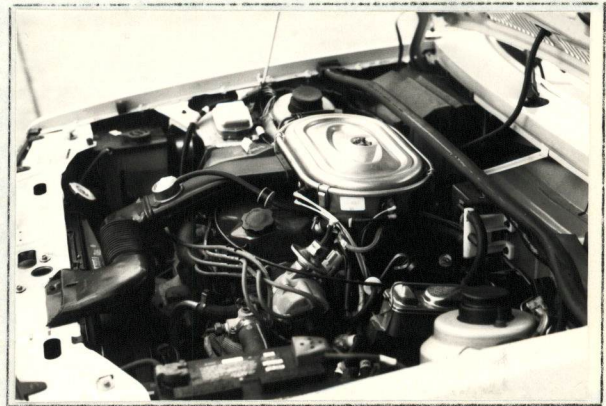

80-19



80-20

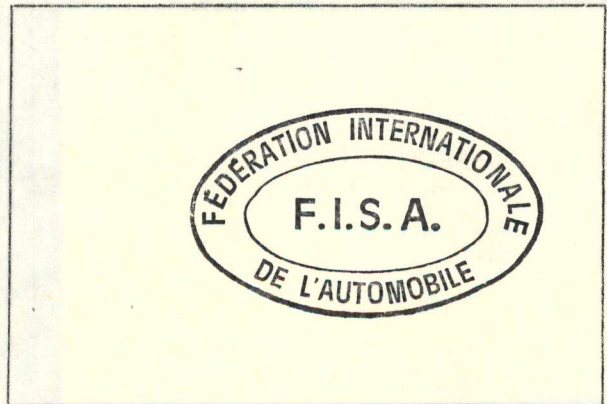

Date amendment is valid from.....

Stamp of F.I.A./R.A.C.



MOTOR SPORT DIVISION
The Royal Automobile Club
 31 Belgrave Square, London SW1X 8QH

Manufacturer FORD
 Model Escort 1.3
 F.I.A. Recognition No. **5834**
 Amendment No. **01/01V**

Amendment to Form of Recognition

FEDERATION INTERNATIONALE DE L'AUTOMOBILE

Valid in Group One

Photographs must be 3" x 2" and a matt finish



80-10



80-11



80-12

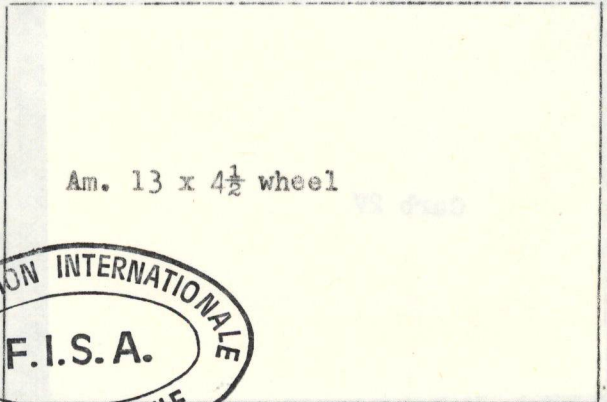

80-13



80-14



80-15

Date amendment is valid from.....

Stamp of F.I.A./R.A.C.