

FÉDÉRATION INTERNATIONALE DE L'AUTOMOBILE

FICHE D'HOMOLOGATION CONFORME A L'ANNEXE J DU CODE SPORTIF INTERNATIONAL
POUR LES VOITURES DES GROUPES 1 A 5

BOOK OF RECOGNITION IN ACCORDANCE WITH APPENDIX J TO THE INTERNATIONAL
SPORTING CODE FOR CARS OF GROUPS 1 TO 5

FISA - Transfert en C

Constructeur/Manufacturer FORD Modèle / Model Escort 1.6
Cylindrée / Cylinder capacity 1597cc
Constructeur du châssis / Chassis Manufacturer FORD
Constructeur du moteur / Engine Manufacturer FORD
Homologation valable à partir du / Recognition valid as from 1st April 1981

Modèle homologué en groupes 1
Model recognized in group

Numéro d'homologation
Recognition number

5835

Photo A : voiture vue de 3/4 AV
Photo A : 3/4 view of car from front

Photo B : voiture vue de 3/4 AR
Photo B : 3/4 view of car from rear

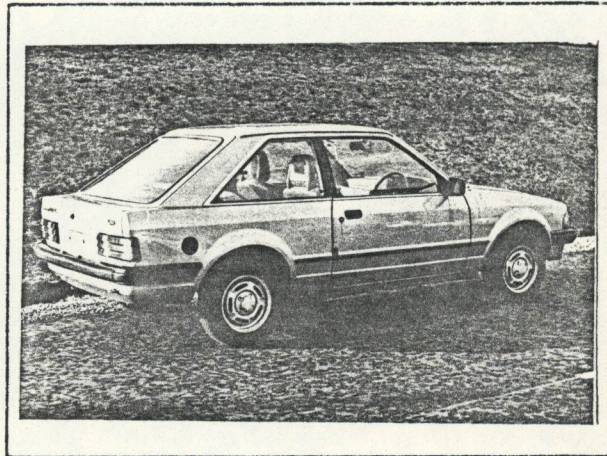

CARACTÉRISTIQUES GÉNÉRALES / GENERAL CHARACTERISTICS :

- 1) Mode de construction : ~~construction séparée~~ / monocoque.
Type of car construction : ~~separate~~ / unitary construction.
- 2) Matériau du châssis Steel Matériau de la carrosserie Steel
Material of chassis Material of coachwork
- 3) Empattement droit 2395 mm Gauche 2395 mm
Wheelbase right Left
- 4) Largeur de la carrosserie mesurée aux axes AV 1615 mm
Width of bodywork measured at front axle
- 5) Largeur de la carrosserie mesurée aux axes AR 1645 mm
Width of bodywork measured at rear axle
- 6) Longueur hors-tout avec pare-chocs 4060 mm Sans pare-chocs 3963 mm
Overall length with bumpers Without bumpers
- 7) Type de suspension : AV MacPherson strut AR Independent strut
Type of suspension : Front Rear

(Photo D)

(Photo E)

Signature et cachet de
l'autorité sportive nationale,

Signature et cachet
de la F.I.A.,

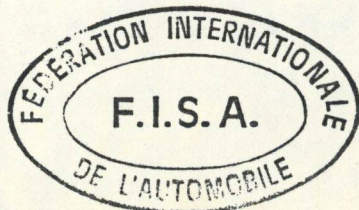

Signature and official stamp of the F.I.A.

Marque / Make FORD Modèle / Model Escort 1.6 N° 5835

MOTEUR :

FISA - Transfert en Gr.A

- 8) Cycle 4
- 9) Nombre et disposition des cylindres 4 in line
 Number and disposition of cylinders
- 10) Système de refroidissement Water by forced circulation
 Cooling system
- 11) Emplacement et position du moteur Transverse in front
 Location and position of engine
- 12) Matériau du bloc moteur Cast iron
 Material of engine block
- 13) Roues motrices : AV - AR Front
 Drive wheels : Front - Rear
- 14) Emplacement de la boîte de vitesses Rear of engine
 Location of gear-box

CARROSSERIE ET ÉQUIPEMENT INTÉRIEUR / COACHWORK AND INTERIOR

- 20) Nombre de portes 2
 Number of doors
- 21) Matériau des portes : AV Steel AR Steel
 Material of doors : Front Rear
- 22) Matériau du capot moteur Steel
 Material of bonnet
- 23) Matériau du capot coffre Steel
 Material of boot lid
- 24) Matériau de la lunette AR Glass
 Material of rear window
- 25) Matériau du pare-brise Laminated only for competition
 Material of windscreen
- 26) Matériau des glaces des portières AV Glass
 Material of front door windows
- 27) Matériau des glaces des portières AR -
 Material of rear door windows
- 28) Système d'ouverture des vitres portières AV Rotating handle AR -
 Sliding system of door windows Front Rear
- 29) Matériau des glaces de custode Glass
 Material of rear quarter lights
- 30) Poids siège (s) AV (enlevés de la voiture avec dossiers, glissières et supports) 13,5 Kg.
 Weight of front seat(s) (complete with supports and rails, out of the car)
- 31) Matériau du pare-choc AV Steel/Plastic Poids 4,25 Kg.
 Front bumper material Weight
- 32) Matériau du pare-choc AR Steel/Plastic Poids 4,25 Kg.
 Rear bumper material Weight
- 33) Ventilation : oui / yes

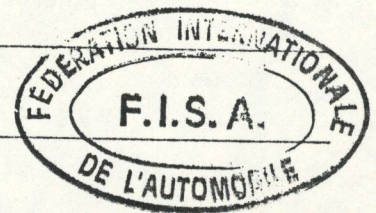

Marque / Make FORD Modèle / Model Escort 1.6 N° 5835

DIRECTION / STEERING

FISA - Transfert en Gr.A

- 40) Type Rack & pinion
 41) Servo-assistance No
 42) Ratio 3.6

SUSPENSION

- 45) Suspension AV (photo D) Type de ressort Coil
 Front suspension (photo D) Type of spring
 46) Nombre d'amortisseurs One per wheel
 Number of shock absorbers
 47) Suspension AR (Photo E) Type de ressort Coil
 Rear suspension (Photo E) Type of spring
 48) Nombre d'amortisseurs One per wheel
 Number of shock absorbers
 49) Système de fixation des roues Cone bolts
 Method of fixation of wheels

FREINS - BRAKES

- 50) Système Hydraulic
 Method of operation
 51) Servo frein (si prévu) Type : Vacumn
 Servo assistance (if fitted) Type :
 52) Nombre de maîtres-cylindres Two
 Number of master-cylinders

	AVANT / FRONT	ARRIERE / REAR
53) Nombre de cylindres par roue Number of cylinders per wheel	One	One
54) Alésage Bore	54 mm	19,05 mm
Freins à tambour / Drum brakes		
55) Diamètre intérieur Inside diameter		180 mm
56) Nombre de mâchoires par frein Number of shoes per brake		Two
57) Surface de freinage par frein Total area per brake		169 cm ²
Freins à disques/Disc brakes		
58) Largeur des sabots Width of brake linings	38,5 mm	
59) Nombre de sabots par frein Number of pads per brake	Two	
60) Surface de freinage par frein Total area per brake	1369,7 cm ²	

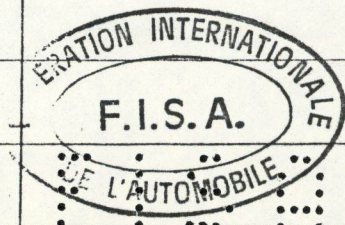

MOTEUR / ENGINE

FISA - Transfert en Gr.A

- 65) Alésage 79,96 mm
Bore
- 67) Course 79,52 mm
Stroke
- 68) Cylindrée totale 1596 cc
Total cylinder-capacity
- 69) Cylindrée maximum autorisée 1599.9 cc
Maximum cylinder-capacity allowed
- 70) Culasse : matériau Alum
Head : material
- 71) Nombre One
Number
- 72) Type de vilebrequin One piece
Type of crankshaft
- Coulé / estampé Moulded
Moulded / stamped
- 73) Nombre de paliers de vilebrequin Five
Number of crankshaft main bearings
- 74) Diamètre maximal des manetons de vilebrequin 47,91 mm
Maximum diameter of the big end journal
- 75) Tête de bielle : type Split diamètre 50,91 mm
Connecting rod big end type
- 76) Matériau des chapeaux des paliers de vilebrequin Cast iron
Material of bearing cap
- 77) Matériau du volant moteur Cast iron
Material of flywheel
- 78) Matériau du vilebrequin Cast iron
Crankshaft material
- 79) Matériau de la bielle Steel forging
Connecting rod material
- 80) Système de graissage : carter sec - carter humide Oil in sump
Lubrication system : dry-sump - oil in sump
- 81) Nombre de pompes à huile One
Number of oil pumps

Moteur 4 temps / 4 stroke engines

- 82) Nombre d'arbres à cames One Emplacement in Cylinder Head
Number of camshafts Location
- 83) Système de commande Tooth belt
Type of camshaft drive
- 84) Système de commande des soupapes Follower & rockers
Type of valve operation
- 85) Nombre de soupapes d'admission par cylindre One
Number of inlet valves per cylinder
- 86) Nombre de soupapes d'échappement par cylindre One
Number of exhaust valves per cylinder
- 87) Nombre de distributeurs One
Number of distributors
- 88) Nombre de bougies par cylindre One
Number of spark plug per cylinder



F I S A

TRANSMISSION AUX ROUES / DRIVE TRAIN

FISA - Transfert en Gr A

Embrayage / Clutch

- 90) Nombre de disques One
 Number of plates _____
- 91) Système de commande Cable & lever system
 Method of operating clutch _____

Boîte de vitesses / Gear-box

- 92) Contrôle manuel, marque Ford
 Manual type, make _____
- 93) Nombre de rapports AV Four
 Number of gear-box ratios forward _____
- 94) Boîte automatique, marque --
 Automatic, make _____
- 95) Nombre de rapports AV --
 Number of gear-ratios forward _____

96	Manuelle / Manual		Automatique		Supp. manuel / Automatique			
	Rapport Ratio	N. dents Nr teeth	Rapport Ratio	N. dents Nr teeth	Rapport Ratio	N. dents Nr teeth	Rapport Ratio	N. dents Nr teeth
1	3,15	41:13			2,83	34:12		
2	1,90	40:21			2,00	32:16		
3	1,28	37:29			1,55	28:18		
4	0,95	39:41			1,30	26:20		
5								
6								
M. AR / Rev.	3,62	47:13			3,77	49:13		

- 97) Surmultiplication type N.A.
 Overdrive type _____
- 98) Nombre de dents N.A.
 Number of teeth _____
- 99) Rapport N.A.
 Ratio _____
- 100) Vitesses en marche AV avec surmultiplication N.A.
 Forward gears on which overdrive can be selected _____

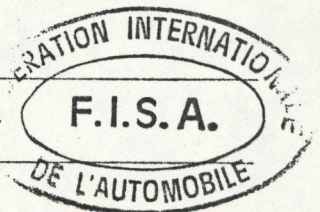

Pont/moteur / Final drive

- 101) Type du pont moteur Helical gear
 Type of final drive _____
- 102) Type de différentiel Star wheel
 Type of differential _____
- 103) Nombre de dents 68:19 73:17 69:17
 Number of teeth _____
- 104) Rapport 3,58 4,29 4,06
 Ratio _____

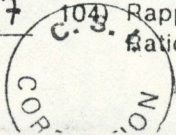

FISA - Transfert en Gr.A

Photo C

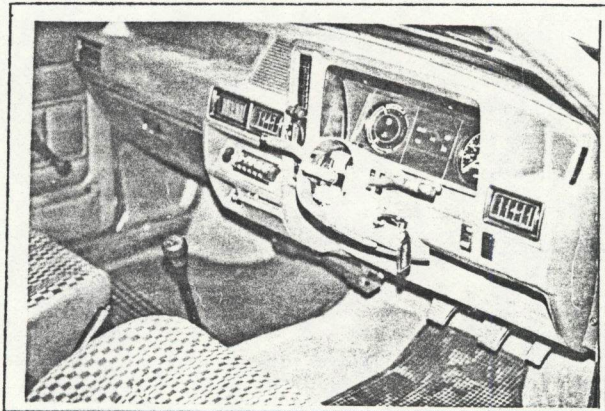

Photo D

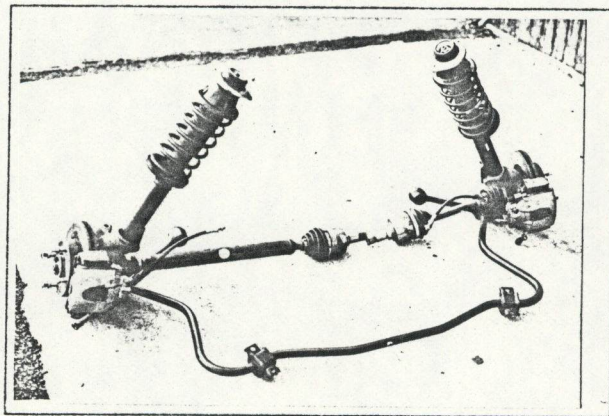

Photo E

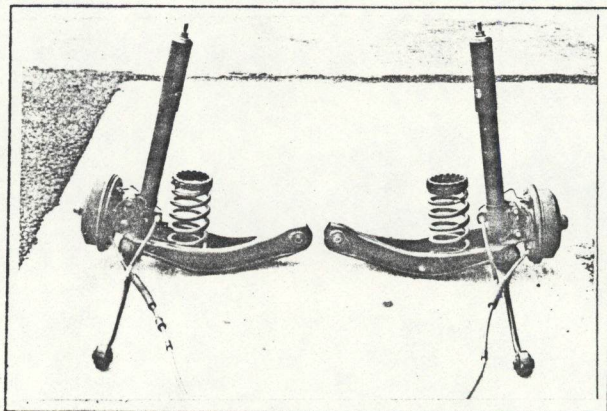

Photo F

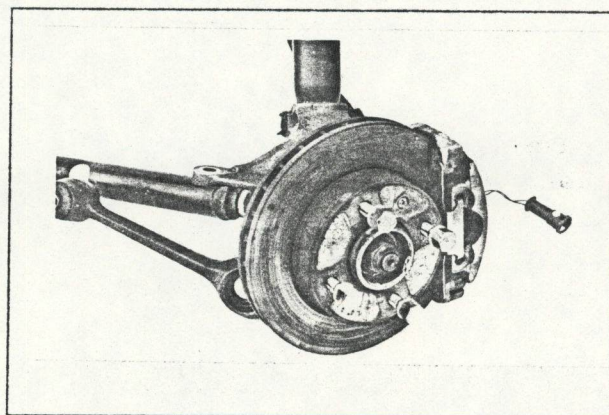

Photo G

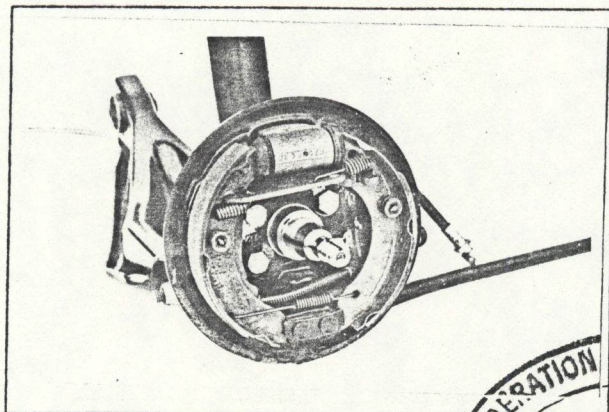

Photo H

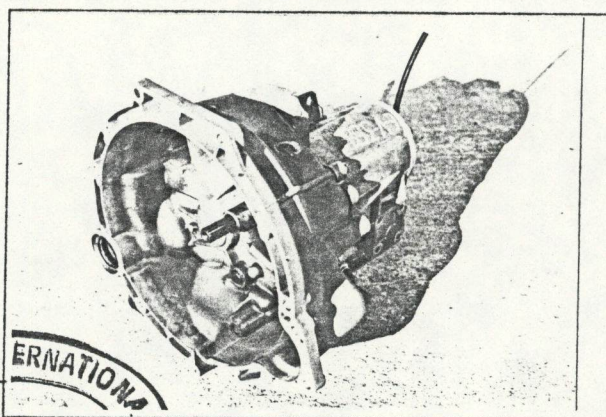

Photo I

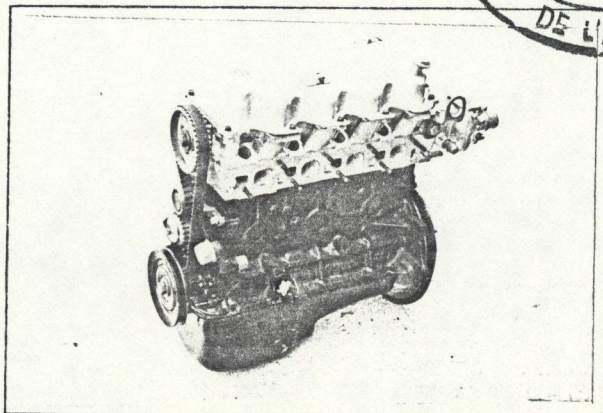
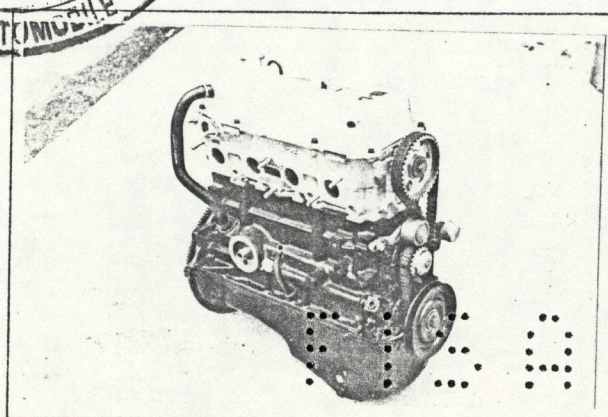

Photo J



FEDERATION INTERNATIONALE
F.I.S.A.
DE L'AUTOMOBILE

FISA - Transfert en

Photo K

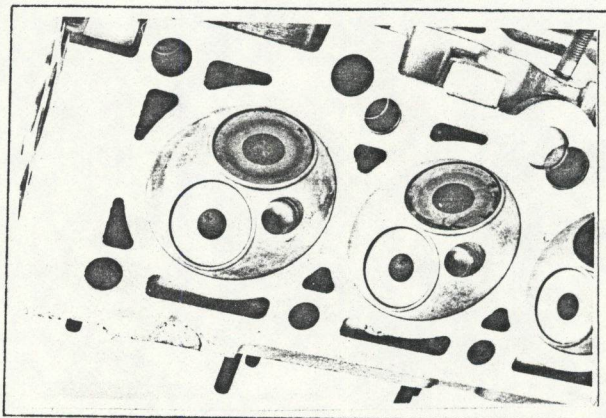

Informations supplémentaires
Additional informations.

Front overhang	760 mm
Rear overhang	890 mm
Disc O.D.	239 mm
Disc Thickness	24 mm



B = 1016 mm
C = 1321
D = 914
E = 1372

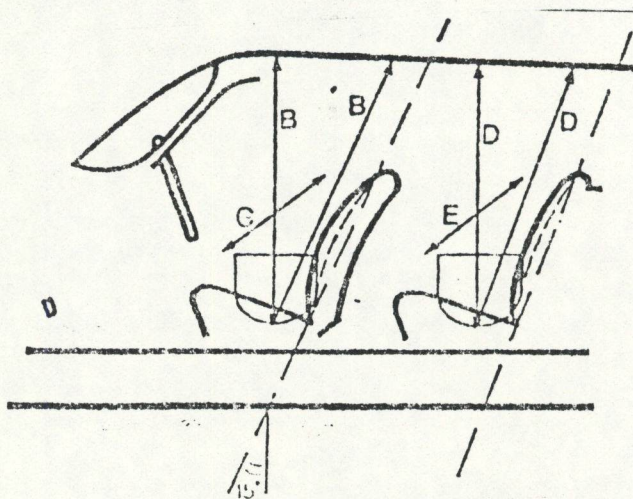

K = 482 mm
L = 343
M = 451
P = 711

$K + L + M = 1098$

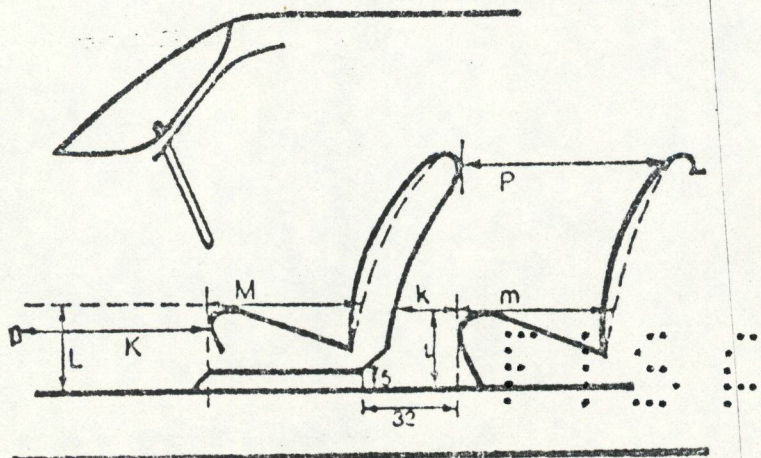

Marque / Make FORD Modèle / Model Escort 1.6 N° 5835

COMPLÉMENT POUR LES GROUPES 1 ET 3
DU CODE SPORTIF INTERNATIONAL

ADDITIONAL DATA FOR GROUPS 1 AND 3 **FISA - I** in Gr.A
TO THE INTERNATIONAL SPORTING CODE

CAPACITÉS ET DIMENSIONS / CAPACITIES AND DIMENSIONS

110) Voie AV / Front track 1395 mm
111) Voie AR / Rear track 1435 mm
112) Garde au sol (pour vérification de la voie) 285 mm (lowest part of door)
Ground clearance (for verification of the track)
113) Hauteur hors-tout de la voiture / Overall height of the car 1336 mm (unladen)
114) Capacité du réservoir d'essence (y compris la réserve) 40 L
Fuel tank capacity (including reserve)
115) Nombre de places 4 116) Poids 880 Kg.
Seating capacity Weight

EQUIPEMENT ET GARNITURES / ACCESSORIES AND UPHOLSTERY

120) Chauffage intérieur : oui - non Yes
Interior heating : yes - no
121) Climatisation (sur option) : oui - non No
Air conditioning (in option) : yes - no
122) Sièges AV : type Bucket
Front seats : type
123) Sièges AR : type Bench
Rear seats : type

ROUES / WHEELS

124) Matériau Steel
Matériel
125) Poids unitaire (roue nue) 6,9 kg (tolérance ± 5%)
Unitary weight (bare wheel)
126) Diamètre de la jante 13" (330 mm)
Rim diameter
127) Largeur de la jante 5" (127 mm)
Rim width



SUSPENSION

130) Stabilisateur AV (si prévu) Torsion bar
Front stabilizer (if fitted)
131) Stabilisateur AR (si prévu) Torsion bar
Rear stabilizer (if fitted)

Marque / Make FORD Modèle / Model Escort 1.6 N° 5835.17

FISA - Transfert en G...

MOTEUR / ENGINE

- 135) Cylindrée par cylindre / Capacity per cylinder 399,25 cc
- 136) Chemises : oui / non / Sleeves : yes / no. Both available
- 137) Nombre d'orifices d'admission par cylindres / Number of inlet ports per cylinder One
- 138) Nombre d'orifices d'échappement par cylindre / Number of exhaust ports per cylinder One
- 139) Rapport volumétrique / Compression ratio 10,75 Max.
- 140a) Volume de la chambre de combustion (minimum) / Volume of the combustion chamber (minimum) 41 cc
- 140b) Volume de la chambre de combustion dans la culasse / Volume of combustion chamber in head 54 ± 3 cm³
- 141) Épaisseur du joint de culasse / Thickness of head gasket inter tightened 1,6 + 0,4 mm
- 142) Piston, matériau / Piston, material Alum alloy
- 143) Nombre de segments / Number of rings Three
- 144) Distance de la médiane de l'axe du piston au sommet du piston / Distance from gudgeon pin center line to highest point of piston crown 47,8 mm
- 145) Capacité du réservoir - carter / Capacity, lubricant 3,5
- 146) Radiateur d'huile : oui - non / Oil cooler : yes - no No
- 147) Capacité du circuit de refroidissement / Capacity of cooling system 6,9
- 148) Ventilateur (si prévu), diamètre / Cooling fan (if fitted), diameter 278 mm Matériau / Material Plastic
- 149) Nombre de pales du ventilateur / Number of fan blades Four
- 150) Paliers vilebrequin, type / Crankshaft main bearings, type Plain, multi layer diamètre / diameter 58,00 mm
- 151) Poids volant (nu) / Weight of flywheel (clean) N.A.
- 152) Poids du volant avec couronne de démarreur / Weight of flywheel with starter ring 6,2 Kg.
- 153) Poids du volant avec embrayage / Weight of flywheel with clutch 11,0 Kg.
- 154) Poids du vilebrequin / Weight of crankshaft 12 Kg.
- 155) Poids de la bielle / Weight of con-rod 580 grams
- 156) Poids du piston avec axe et segments / Weight of piston with rings and pin 520 grams

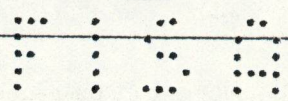
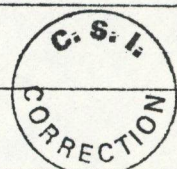

Marque / Make FORD Modèle / Model Escort 1.6

5835

ADMISSION / INLET

FISA - Trans Gr.A

- 160) Matériau du collecteur d'admission Alum
Material of inlet manifold
- 161) Diamètre extérieur des soupapes 42,1 mm
Outside diameter of valves
- 162) Levée maximum des soupapes 9,6 mm
Maximum valve lift
- 163) Nombre de ressorts par soupape 1
Number of springs per valve
- 164) Type de ressort Coil
Type of spring
- 165) Jeu théorique pour le calage de la distribution 1 mm - hydraulic
Theoretical timing clearance
- 166) Avance d'ouverture (avec jeu théorique) 13° B.T.D.C.
Valves open at (With tolerance for tappet clearance indicated)
- 167) Retard de fermeture 28° A.B.D.C.
Valves close at

ÉCHAPPEMENT / EXHAUST

- 170) Matériau du collecteur d'échappement Cast iron
Material of exhaust manifold
- 171) Diamètre extérieur des soupapes 34,1 mm
Outside diameter of valves
- 172) Levée maximum des soupapes 9,6 mm
Maximum valve lift
- 173) Nombre de ressorts par soupape 1
Number of springs per valve
- 174) Type de ressort Coil
Type of spring
- 175) Jeu théorique pour le calage de la distribution 1 mm hydraulic
Theoretical timing clearance
- 176) Avance d'ouverture (avec jeu théorique) 30° B.B.D.C.
Valves open at (with tolerance for tappet clearance indicated)
- 177) Retard de fermeture 15° A.T.D.C.
Valves close at

ALIMENTATION PAR CARBURATEURS / CARBURATION

- 180) Nombre de carburateurs One
Number of carburettors
- 181) Type Downdraught
- 182) Marque Ford
Make
- 183) Modèle ...VV...
Model FISA
- 184) Nombre de passages de gaz par carburateur One
Number of mixture passages per carburettor

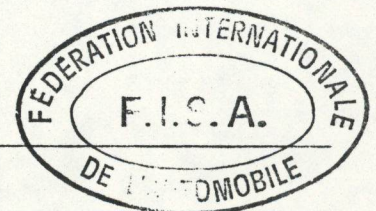

- 185) Diamètre de la tubulure de gaz à la sortie du carburateur 36 mm
 Flange hole diameter of exit port of carburettor
- 186) Diamètre du diffuseur au point d'étranglement maximum N.A.
 Minimum diameter of venturi
FISA - Transfert en G1
- Injection (si prévue) (if fitted)**
- 187) Marque de la pompe N.A.
 Make of pump
- 188) Nombre de pistons N.A.
 Number of plungers
- 189) Modèle ou type de la pompe N.A.
 Model or type of pump
- 190) Nombre total d'injecteurs N.A.
 Total number of injectors
- 191) Emplacement des injecteurs N.A.
 Location of injectors
- 192) Diamètre de la pipe d'admission au point de passage le plus étroit N.A.
 Minimum diameter of inlet pipe

ÉQUIPEMENT DU MOTEUR / ENGINE ACCESSORIES

- 195) Pompe à essence - mécanique et/ou électrique Mechanical
 Fuel pump - mechanical and/or electrical
- 196) Nombre One
 Number
- 197) Type du système d'allumage Electronic
 Type of ignition system
- 198) Nombre de bobines One
 Number of ignition coils
- 199) Génératrice : type Alternator Nombre One
 Generator : type Number
- 200) Système d'entraînement Vee belt
 Method of drive
- 201) Batterie / Battery
 a) Tension 12 b) Emplacement In engine bay
 Voltage Location

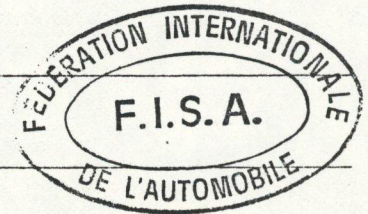

- 205) Arbres à cames / Camshaft

R : Centre

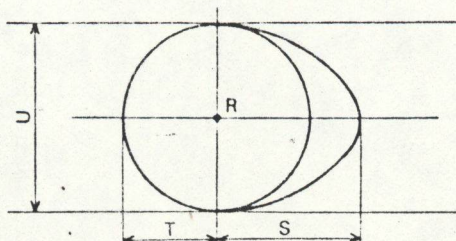

Come admission Inlet cam		Come échappement Exhaust cam	
S = 22,1 mm	inches	S = 21,6 mm	inches
T = 16,2 mm	inches	T = 15,7 mm	inches
U = 32,7 mm	inches	U = 31,7 mm	inches

FISA - Transfert en Gr.A

TRANSMISSION AUX ROUES / WHEEL DRIVE

Embrayage / clutch

- 210) Type Diaphragm
- 211) Diamètre / Diameter 200 mm
- 212) Diamètre des garnitures : intérieur 135 mm extérieur 200 mm
Diameter of linings : interior outside
- 213) Nombre de disques One
Number of discs

Boîte de vitesses / Gear-box

- 215) Nombre de rapports AV synchronisés Four
Number of forward synchronised ratios
- 216) Emplacement de la commande Central, on floor
Location of the gear lever
- 217) Boîte automatique - emplacement de la commande N.A.
Automatic gear-box - location of gear lever
- 218) Surmultiplication - type N.A.
Overdrive type
- 219) Rapport de surmultiplication N.A.
Overdrive ratio

Pont moteur - Final drive

- 220) Type du pont autobloquant (si prévu) _____
Type of limited slip differential (if provided)
- 221) Nombre de dents du couple conique 68:19 ou 69:17
Number of teeth of final drive or
- 222) Rapport au couple conique 3,58 ou 4,06
Final drive ratio or

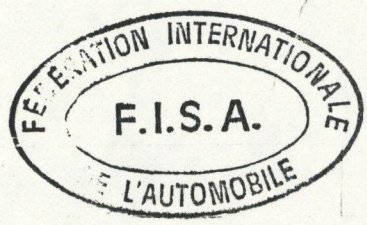

F I S A

FISA - Transfert en Gr.A

Photo K

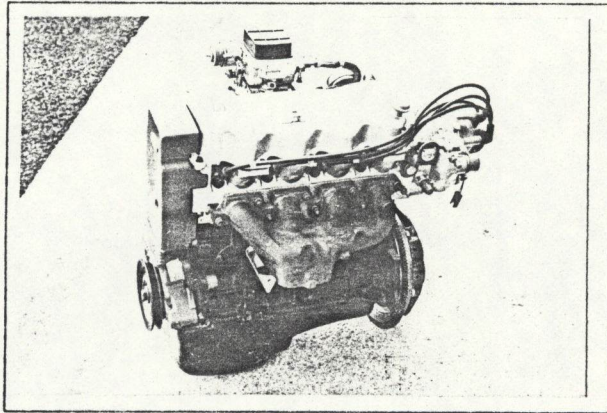

Photo L

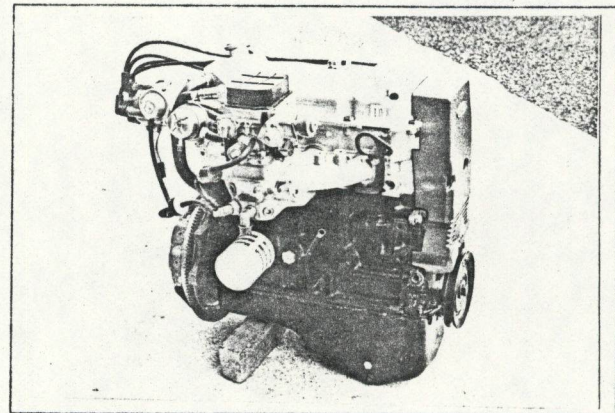

Photo M

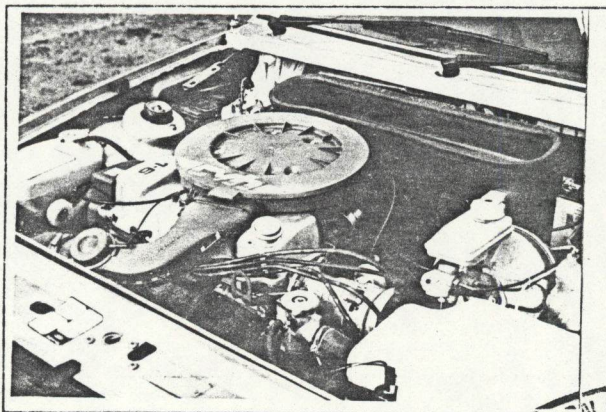

Photo N

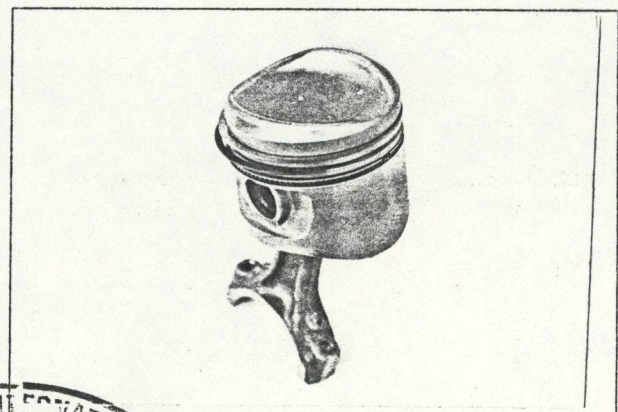

Photo P

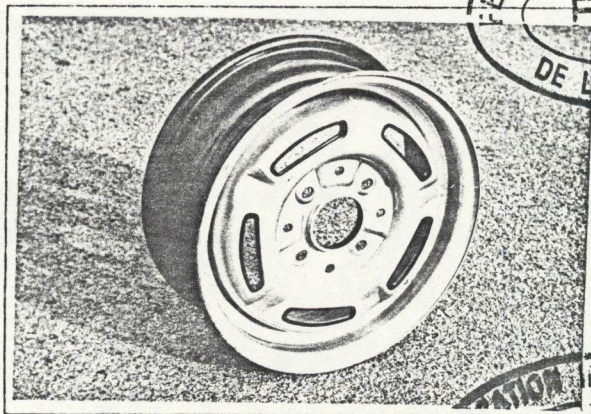

Photo Q

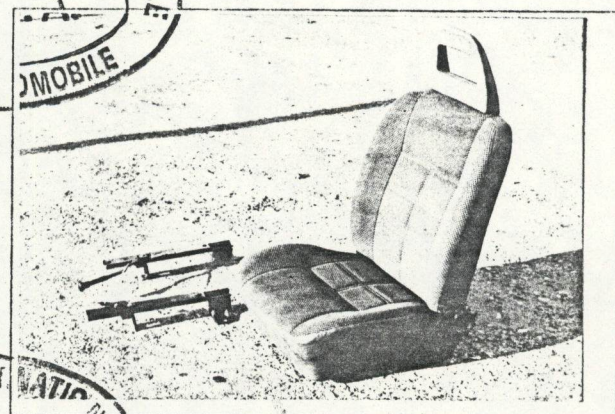
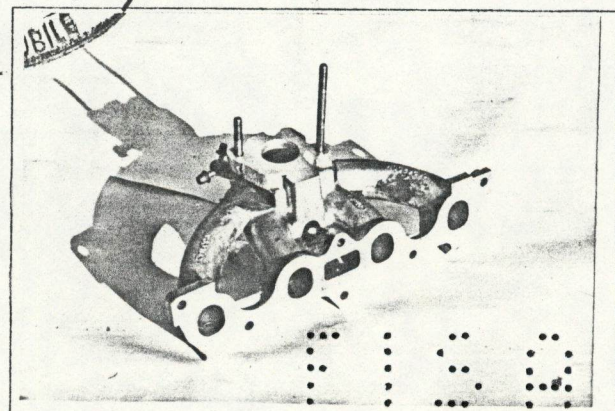

Photo R



Photo S



FEDERATION INTERNATIONALE
F. I. S. A.
DE L'AUTOMOBILE

FISA - Transfert en Gr.A

Dessin orifices collecteur admission, face côté culasse.

Drawing inlet manifold ports, side of cylinderhead.

avec dimensions with

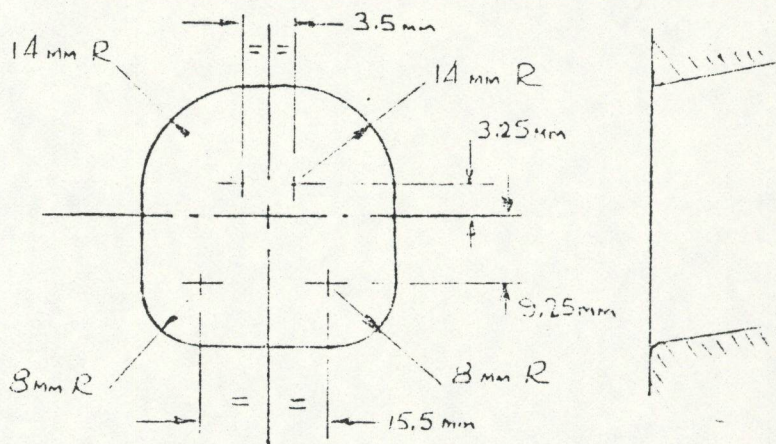

Dessin orifices admission culasse face collecteur.

Drawing of entrance to inlet port of cylinderhead.

avec dimensions with

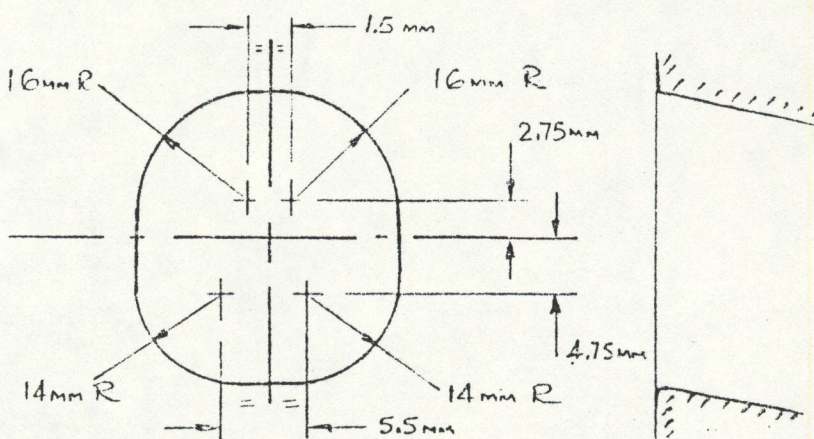

Dessin orifices collecteur échappement face côté culasse.

Drawing of exhaust manifold ports, side of cylinderhead.

avec dimensions with

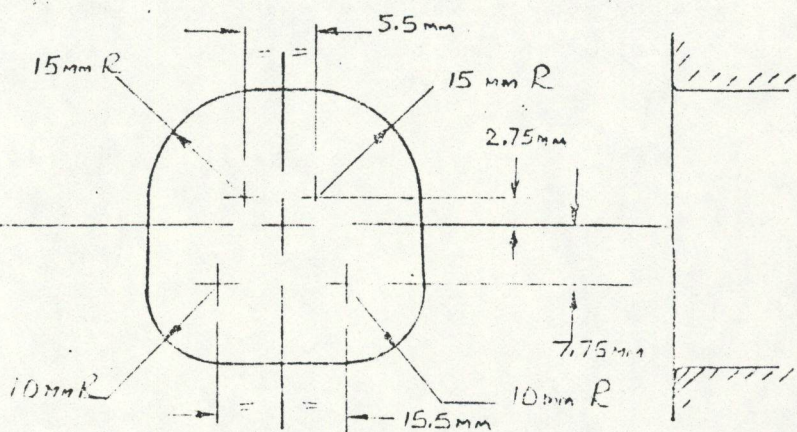
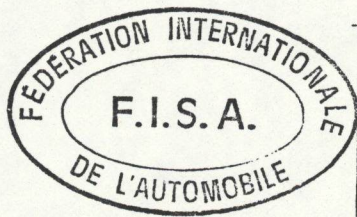

Dessin orifices echappement culasse face collecteur.

Drawing of exit to exhaust port cylinderhead.

avec dimensions with

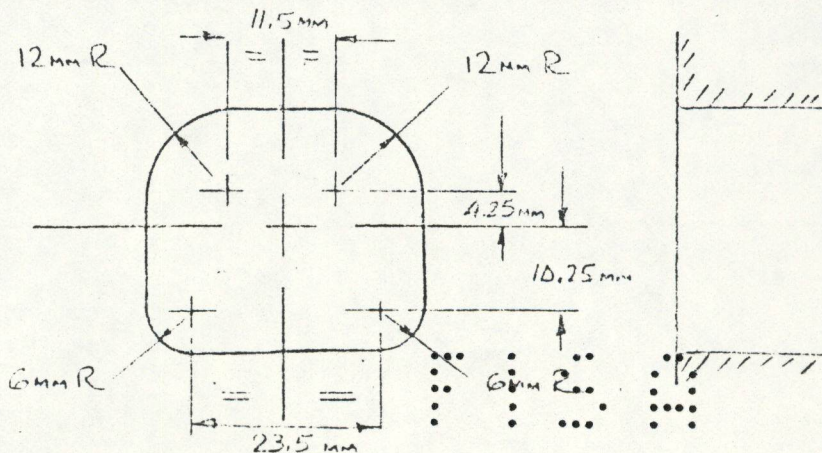

FISA - Transfert en Gr.A

Photo T

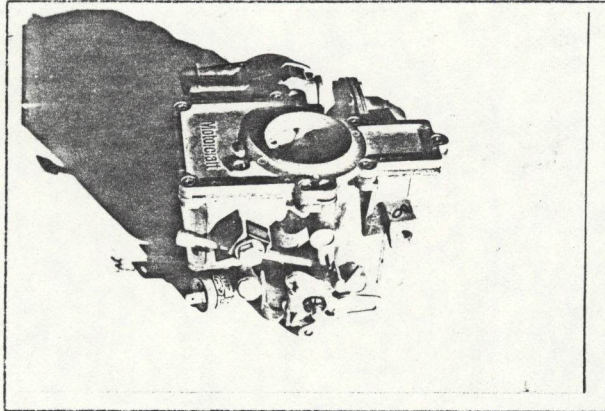

Photo U

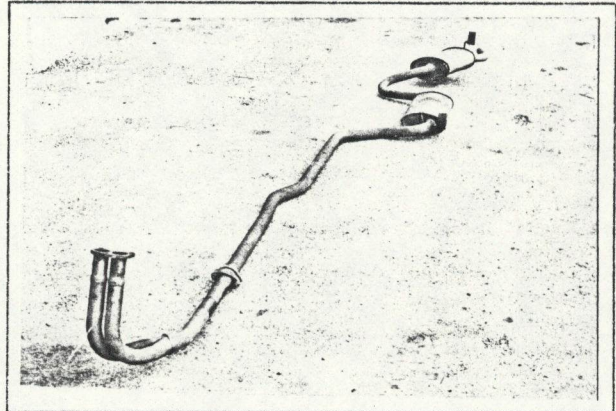
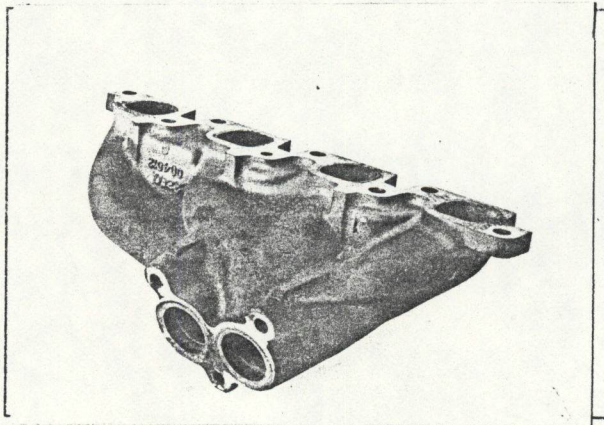

Photo V



Dia. outlet pipe from manifold - 2 x 37 mm

Informations supplémentaires
Additional informations

All inlet and exhaust tracts may be reclaimed by limited fettling within factory to allow for port core mismatch. All cast ports have ± 2 mm tolerance

(This replaces FIA tolerance)

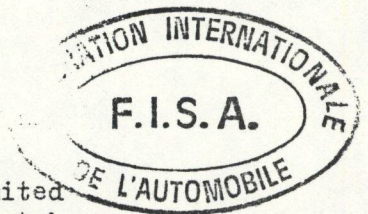
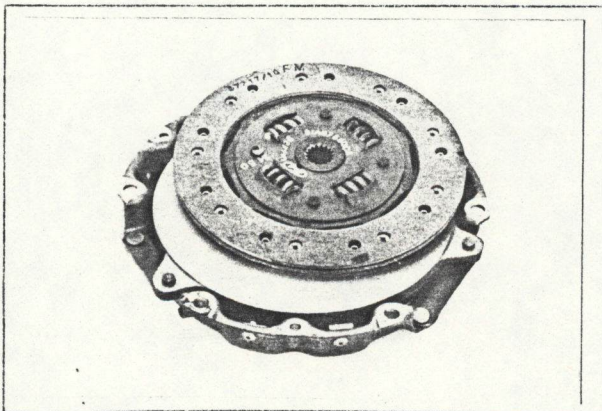
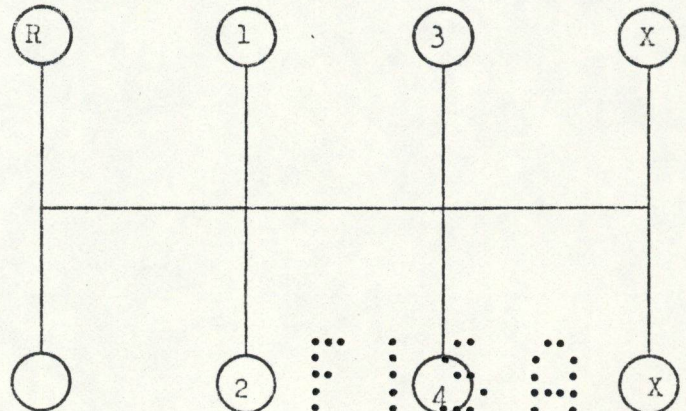

Photo W



Grille de vitesses
Gear change gate





BRITISH MOTOR SPORTS COUNCIL
31 Belgrave Square, London SW1X 8QH

Manufacturer Ford

Model Escort 1.6

F.I.A. Recognition No. 5835

Amendment No. 01/01 V

Amendment to Form of Recognition

FEDERATION INTERNATIONALE DE L'AUTOMOBILE

FISA - Transfert en Gr.A

Valid in Group 1

No.

Reference No.

Product Variant

The same basic car is sold in and from the U.S. of A. as Ford Escort in "L", "GL", "GLX" and "SS" trim variations, and as Mercury Lynx in "Base", "GL", "GS", "LS" and "RS" trim variations.

These cars differ from European variants externally as a result of "Federal" bumpers - photo 80-1 and 80-2, and also modified facia layout - photo 80-3.

- 6. Overall length 4225 mm
- 3a. Front overhang = 880 mm
- 3b. Rear overhang = 950 mm
- 31. Bumper weight (front) = 4,2 Kg.
- 32. Bumper weight (rear) = 4,2 Kg.
- 116. Weight of base car 890 Kg.

C. S.
CORRECT

[Redacted text]

186. 24 & 25 mm

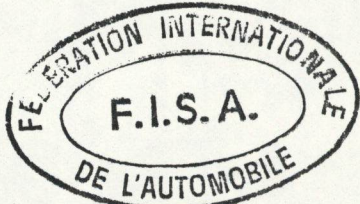

C. S. I.
CORRECTIO

[Redacted text]

[Signature]

Date amendment is valid from -1.AVR.1981

Stamp of F.I.A./R.A.C



MOTOR SPORT DIVISION
 The Royal Automobile Club
 100, Grosvenor Gardens, London SW1X 8QH

Manufacturer Ford
 Model Escort 1.6
 F.I.A. Recognition No. 5835
 Amendment No. 01/01V

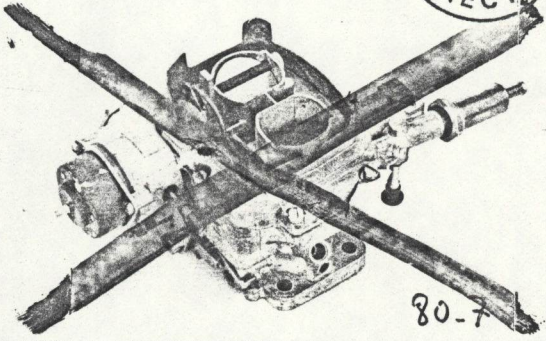

80-7

FEDERATION INTERNATIONALE DE L'AUTOMOBILE

Group 1

must be 3" x 2" and a matt finish

FISA - Transfert en Gr. have
 You can't have
 America Car without
 American 2V carb
 etc



80-1



80-2

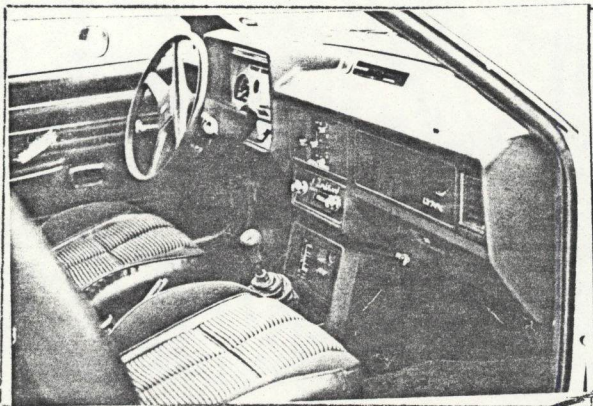

80-3

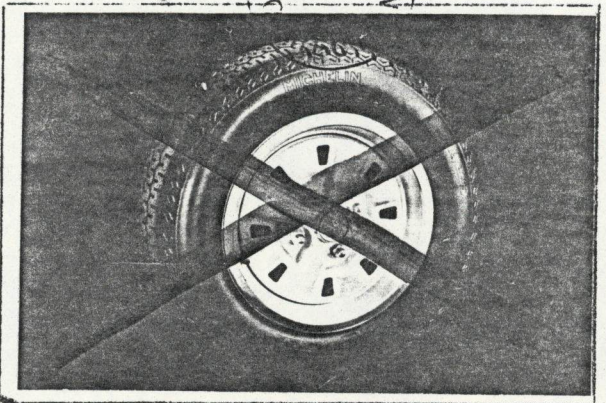

80-4

FEDERATION INTERNATIONALE
F.I.S.A.
 DE L'AUTOMOBILE

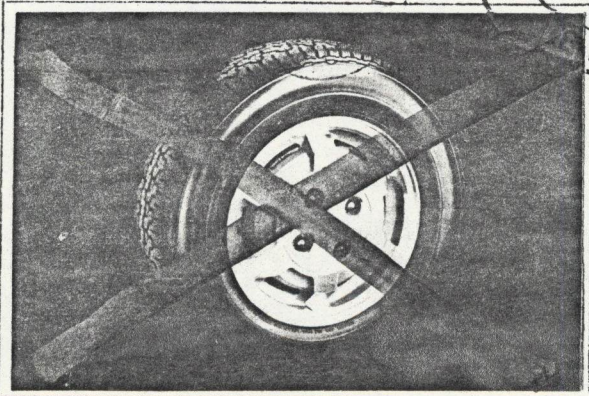

80-5

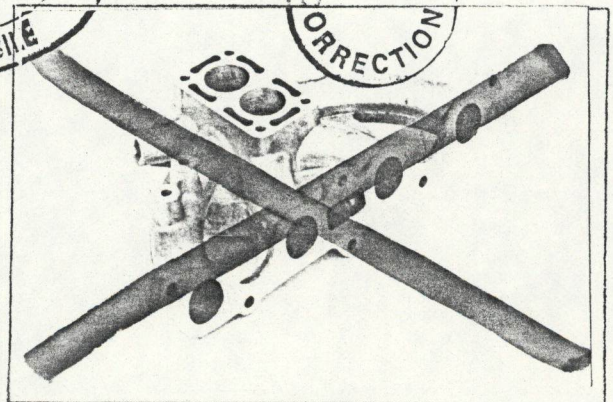

80-6

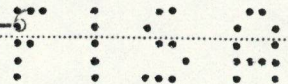

Stamp of F.I.A./R.A.C.

Date amendment is valid from.....



BRITISH MOTOR SPORTS COUNCIL
31 Belgrave Square, London SW1X 8QH

Manufacturer Ford
Model Escort 1.6
F.I.A. Recognition No. 5835
Amendment No. 02/02V

Amendment to Form of Recognition

FEDERATION INTERNATIONALE DE L'AUTOMOBILE

FISA - Transfert en Gr.A

Valid in Group 1

No. Reference No.

Product Variant

[Redacted] photo 80-8 125, 10,2 kg

[Redacted] 127, 12,5 kg

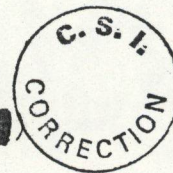

[Redacted] alternative sports seat - photo 80-9

[Redacted] adjustment - sliding runners

[Redacted] weight: 8 kg

[Redacted] manufacturer: Ford

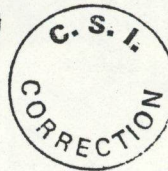

[Redacted] alternative sports seat - photo 80-10

[Redacted] adjustment - sliding runners

[Redacted] weight: 10 kg

[Redacted] manufacturer: Ford

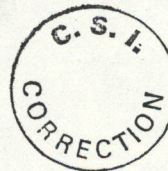

[Redacted] regulator - photo 80-11

[Redacted] interchangeable with standard unit (in regards position, mounting etc.)



[Redacted] (not climate package) photo 80-12

Rear brakes (heavy duty package)

55. 8" (203 mm)

56. 2

57. 202,5 cm²



Power Steering rack -- photo 80-1

40. Rack & pinion

41. Hydraulic

42. Turns L to L = 3.5

[Signature]

F I S A

-1.AVR.1981

Date amendment is valid from.....

Stamp of F.I.A./R.A.C



BRITISH MOTOR SPORTS COUNCIL
31 Belgrave Square, London SW1X 8QH

Manufacturer Ford
Model Escort 1.6
F.I.A. Recognition No. 5835
Amendment No. 02/02V

Amendment to Form of Recognition

FEDERATION INTERNATIONALE DE L'AUTOMOBILE

FISA - Transfert en Gr.A

Valid in Group 1

No.

Reference No.

Product Variant

Safety roll over cage - complies with min. F.I.A. requirements - photos 80-13; 80-14.

Material: Min. specification; cold drawn seamless carbon steel E - 30 da N

Min. dimension: 38 mm OD x 2.6 mm wall thickness

Weight: 15,1 Kg. 6 or 14 point attachment.

54. Rear: 22,2 mm with revised setting in anti lock valve.

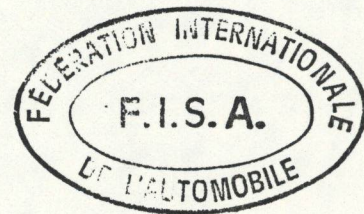

F I S A

Date amendment is valid from

Stamp of F.I.A./R.A.C



MOTOR SPORT DIVISION
The Royal Automobile Club
 31 Belgrave Square, London SW1X 8QH

Manufacturer **Ford**
 Model **Escort 1.6**
 F.I.A. Recognition No. **5835**
 Amendment No. **02/02V**

Amendment to Form of Recognition

FEDERATION INTERNATIONALE DE L'AUTOMOBILE

FISA - Transfert en Gr.A

Valid in Group 1

Photographs must be 3" x 2" and a matt finish

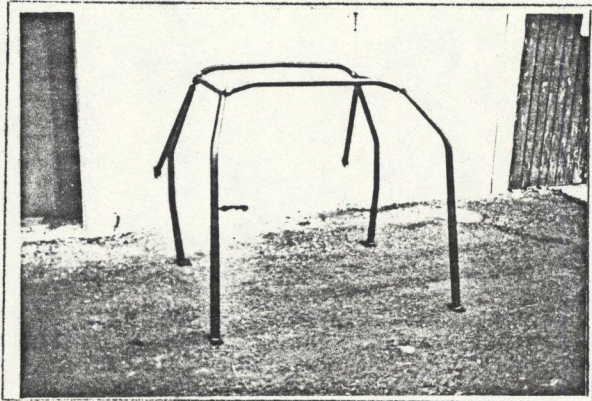

80-13

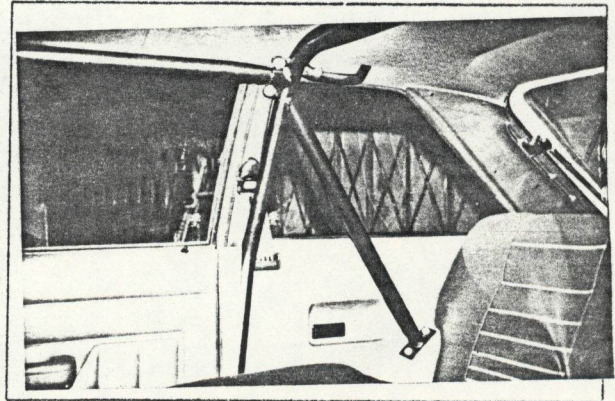

80-14

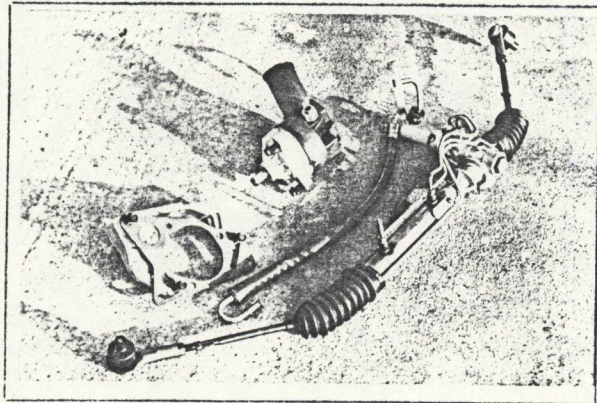

80-15

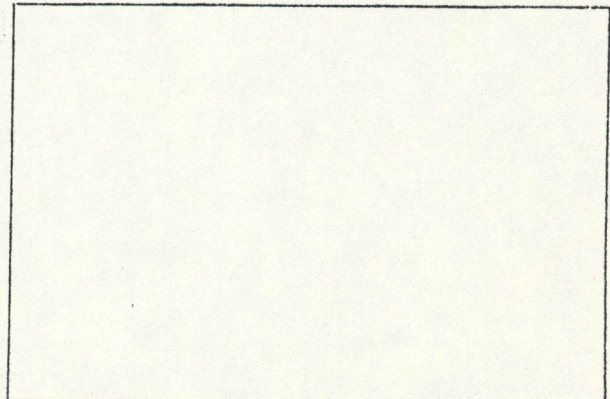
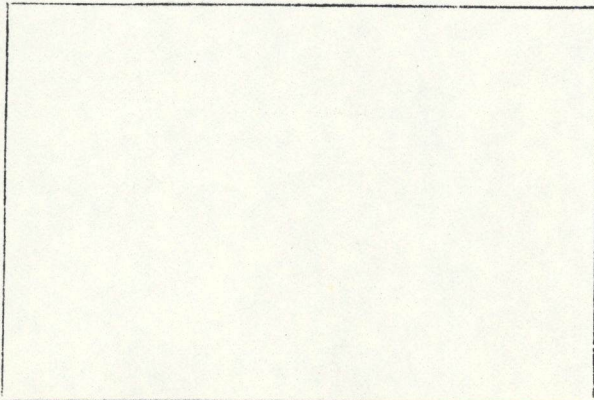
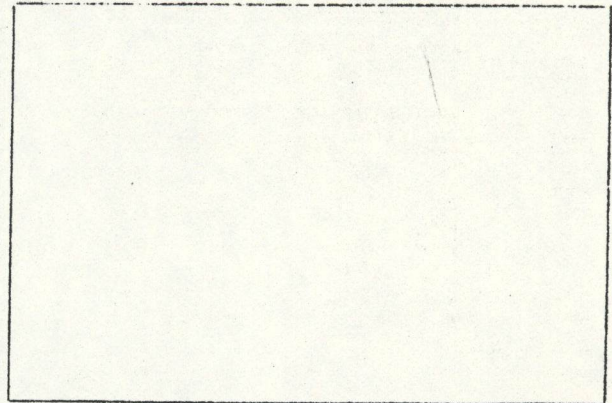

Date amendment is valid from.....

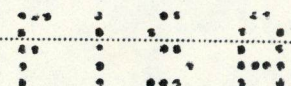

Stamp of F.I.A./R.A.C.



MOTOR SPORT DIVISION
The Royal Automobile Club
 31 Belgrave Square, London SW1X 8QH

Manufacturer Ford
 Model Escort 1.6
 F.I.A. Recognition No. 5835
 Amendment No. 02/02V

Amendment to Form of Recognition

FEDERATION INTERNATIONALE DE L'AUTOMOBILE

Valid in Group 1

FISA - Transfert en Gr.A

Photographs must be 3" x 2" and a matt finish

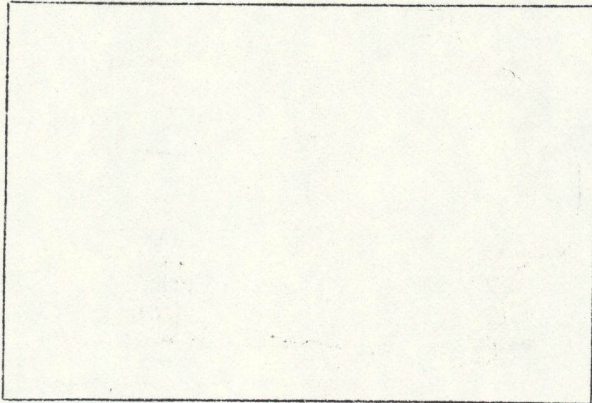

80-7

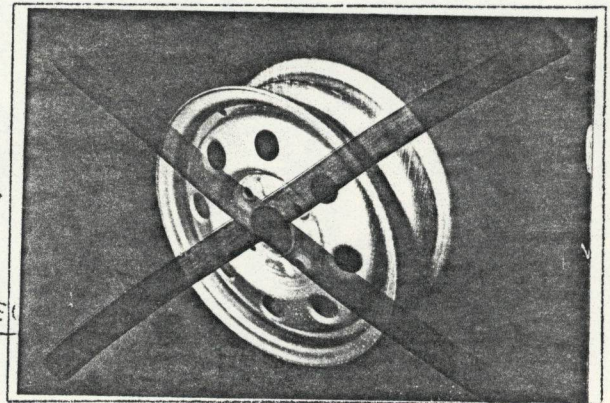

80-8

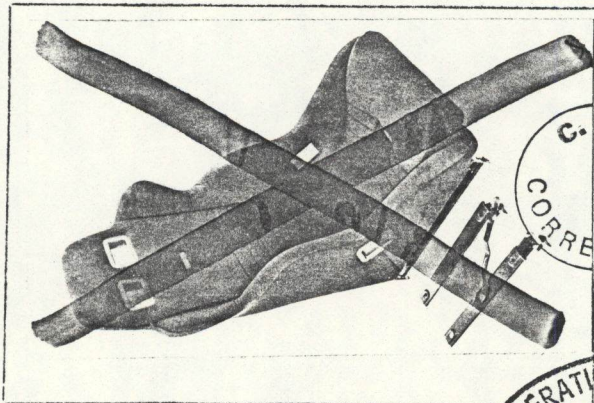

80-9

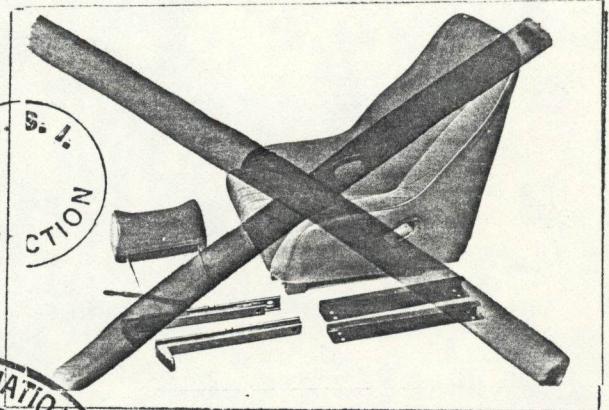

80-10

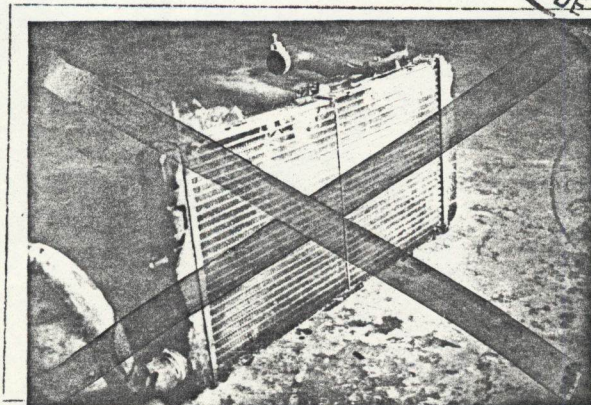
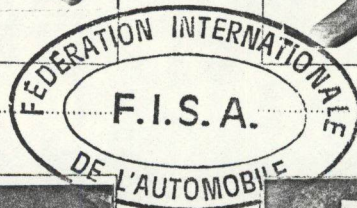

80-11

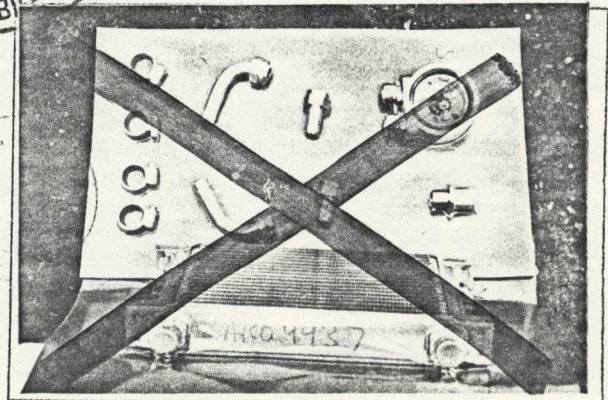

80-12

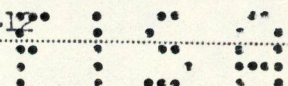

Stamp of F.I.A./R.A.C.

Date amendment is valid from.....