



# JAPAN AUTOMOBILE FEDERATION

社団法人・日本自動車連盟

JAF公認番号 T-227

グループ 1

発効年月日 1975年7月31日

F. I. A. Recognition No. 5609  
Group

## FEDERATION INTERNATIONALE DE L'AUTOMOBILE

Form of recognition in accordance with  
Appendix J to the International Sporting Code.  
国際スポーツ法典付則J項及びJAF国内競技車両規則に従った公認書式。

Manufacturer 製造会社名 NISSAN MOTOR CO., LTD.

Serial No of chassis 製造開始シャシー型式番号 F10-000001  
engine エンジン型式 A12

Recognition is valid from 1 10 75

The manufacturing of the model described in this recognition form was started on SEP, 1974 and the minimum production of 5,000 identical cars, in accordance with the specifications of this form was reached on APR, 1975

Cylinder-capacity 総排気量	レシプロ	Reciprocation 1,171 cm <sup>3</sup>	71.46	cu.in.
		Special	cm <sup>3</sup>	cu.in.
Model 型式及び通称名	F10 NISSAN CHERRY F-II 1200			
Manufacturer	NISSAN MOTOR CO., LTD.			
Manufacturer	NISSAN MOTOR CO., LTD.			
List				

Photograph A, 3/4 view of car from front 写真A. 全体写真(斜め前方)



The vehicle described in this form has been subject to the following amendments :

### Variants

on	19	rec. No.	List
on	19	rec. No.	List
on	19	rec. No.	List
on	19	rec. No.	List
on	19	rec. No.	List

### Normal evolution of the type

on	19	rec. No.	List
on	19	rec. No.	List
on	19	rec. No.	List
on	19	rec. No.	List
on	19	rec. No.	List

Stamp and signature of the JAF

JAF公認印及び署名

難波靖治

Yasuharu Nanba

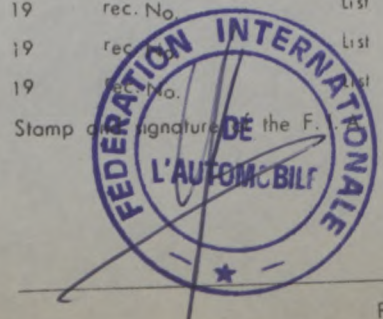

Make NISSAN

Model F10  
型式

J.A.F公認番号

T-227

F.I.A. Rec. No.

5609

IMPORTANT - the underlined items must be stated in two measuring systems, one of which must be the metric system. See conversion table hereafter.

**CAPACITIES AND DIMENSIONS**  
仕様諸元

1. <u>Wheelbase</u> ホイールベース	239.5	cm	94.3	inches
2. <u>Front track</u> トレッド(前)	127.0	cm	50.0	inches
3. <u>Rear track</u> トレッド(後)	123.5	cm	48.6	inches
4. Overall length of the car 全長	382.5	cm		
5. Overall width of the car 全幅	150.0	cm		
6. Overall height of the car 全高	134.5	cm		
7. <u>Capacity of fuel tank</u> (reserve included) 燃料タンク容量	10.6	Gallon US	40	ltrs Gallon Imp
8. Seating capacity 定員				
9. <u>Weight, total weight of the car with normal equipment, water, oil and spare wheel but without fuel nor repair tools:</u> 車両重量 (冷却水、オイル、スペアタイヤを含む標準状態の車両重量、但し燃料、車載工具を除く)	675	kg	1,488	lbs

\* Differences in track caused by the use of other wheels with different rim widths must be stated when recognition is requested for the wheels concerned.

\*\* Specify ground clearance in relation to the track and give drawing of two fixed points of the vehicle's structure at which 車両の標準状態を示すためのサイドメンバー前端及び後端に於ける地上高 measurements are taken.

These ground clearance dimensions are only for information when checking the track and can in no way affect the eligibility of the car.

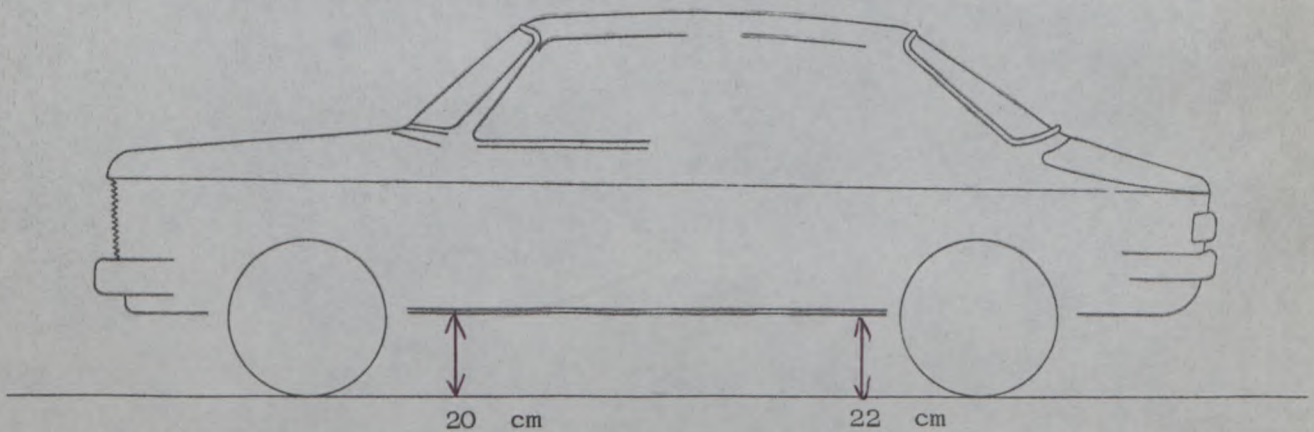

\*\*\* Width of the car measured in the vertical plane passing through the axle of the wheels.

車軸上の車体幅	Front フロント	150.0	cm	Rear リヤ	148.9	cm
---------	---------------	-------	----	------------	-------	----

**CONVERSION TABLE**

1 inch / pouce	--	2.54 cm	1 quart US	--	0.9464 ltrs
1 foot / pied	--	30.4794 cm	1 pint (pt)	--	0.4732 ltrs
1 square inch / pouce carre	--	6.452 cm <sup>2</sup>	1 gallon Imp.	--	4.546 ltrs
1 cubic inch / pouce cube	--	16.387 cm <sup>3</sup>	1 gallon US	--	3.785 ltrs
1 pound / livre (lb)	--	453.593 gr.	1 hundred weight (cwt)	--	90.7185 kg



Make NISSAN Model F10  
型式

**CHASSIS AND COACHWORK** (Photographs A, B and C)

シャーシー、ボデー

- |  |   |  |              |  |
|--|---|--|--------------|--|
| 20. Chassis/body construction :                    |   |  |              |  |
| シャーシー/ボディーの構造                                      |   |  |              | <del>SEPARATE</del> /unitary construction<br><del>別体構造</del> /一体構造 |
| 21. Unitary construction, material (s)             |   |  |              | Steel  |
| 一体構造の場合その材質  |   |  |              |  |
| 22. Separate constructions: material(s) of chassis |   |  |              |  |
| セパレート構造の場合その材質                                     |   |  |              |  |
| 23. Material (s) of coachwork                      |   |  |              |  |
| ボディーの材質  |   |  |              |  |
| 24. Number of doors                                | 2 |  | Material (s) | Steel  |
| ドアの数   |   |  | 材質           |  |
| 25. Material (s) of bonnet                         |   |  |              | Steel  |
| ボンネットの材質   |   |  |              |  |
| 26. Material (s) of boot lid                       |   |  |              | Steel  |
| トランクリッドの材質   |   |  |              |  |
| 27. Material (s) of rear-window                    |   |  |              | Glass  |
| リヤウインドシールドの材質                                      |   |  |              |  |
| 28. Material (s) of windscreen                     |   |  |              | Glass (LAMINATED)  |
| フロントウインドシールドの材質                                    |   |  |              |  |
| 29. Material (s) of front-door windows             |   |  |              | Glass  |
| フロントドアウインドーの材質                                     |   |  |              |  |
| 30. Material (s) of rear-door windows              |   |  |              |  |
| リヤドアウインドーの材質                                       |   |  |              |  |
| 31. Sliding system of door windows                 |   |  |              | Vertical manual  |
| ドアウインドーの開閉方式                                       |   |  |              |  |
| 32. Material (s) of rear-quarter light             |   |  |              | Glass  |
| リヤクォーターウインドーの材質                                    |   |  |              |  |

**ACCESSORIES AND UPHOLSTERY**

アクセサリ

- |  |       |  |                  |                |
|--|-------|--|------------------|----------------|
| 38. Interior heating :   |       |  | yes -            | <del>NO</del>  |
| 39. Air-conditioning :   |       |  | <del>YES</del> - | no             |
| 40. Ventilation :  |       |  | yes -            | <del>NO</del>  |
| 41. Front seats, type of seats and upholstery                                    |       |  |                  | Separate Vinyl |
| フロントシートの形式と表張りの材質  |       |  |                  |                |
| 42. Weight of front seat (s), complete with supports and rails, out of the car : |       |  |                  |                |
| フロントシートの重量 (ブラケット、シートレール付)   |       |  |                  | 11 kg X 2      |
| 43. Rear seats, type of seats and upholstery                                     |       |  |                  | Bench Vinyl    |
| リヤシートの形式と表張りの材質  |       |  |                  |                |
| 44. Front bumper, material (s)   | Steel |  | Weight           | 3.3 kg         |
| フロントバンパーの材質  |       |  | 重量               |                |
| 45. Rear bumper, material (s)  | Steel |  | Weight           | 4.0 kg         |
| リヤバンパーの材質  |       |  | 重量               |                |

**WHEELS**

ホイール

- |                                      |     |    |     |               |
|--------------------------------------|-----|----|-----|---------------|
| 50. Type                             |     |    |     | Pressed steel |
| 形式                                   |     |    |     |               |
| 51. Weight (per wheel, without tyre) |     |    | 4.5 | kg            |
| 重量                                   |     |    |     |               |
| 52. Method of attachment             |     |    | 4   | Nuts          |
| 取付け方法                                |     |    |     |               |
| 53. Rim diameter                     | 305 | mm | 12  | inches        |
| リム径                                  |     |    |     |               |
| 54. Rim width                        | 102 | mm | 4   | inches        |
| リム幅                                  |     |    |     |               |

**STEERING**

ステアリング

- |   |  |  |                  |                 |
|---|--|--|------------------|-----------------|
| 60. Type  |  |  |                  | Rack and pinion |
| 形式  |  |  |                  |                 |
| 61. Servo-assistance :                                  |  |  | <del>YES</del> - | no              |
| パワーステアリング   |  |  | 有                | 無               |
| 62. Number of turns of steering wheel from lock to lock |  |  | 3.2              |                 |
| ロックツーロック  |  |  |                  |                 |
| 63. In case of servo-assistance                         |  |  |                  |                 |



Make NISSAN

Model F10  
型式

J.A.F公認番号 T-227  
F.I.A. Rec. No. 5609

**SUSPENSION**

サスペンション

- 70. Front suspension (photogr. D), type  
フロントサスペンションの形式 Mcpherson
- 71. Type of spring  
スプリングの種類 Coil
- 72. Stabiliser (if fitted)  
スタビライザーの形式
- 73. Number of shockabsorbers  
ショックアブソーバーの数 2
- 74. Type  
形式 Hydraulic telescopic
  
- 78. Rear suspension (photogr. E), type  
リヤサスペンションの形式 Trailing arm
- 79. Type of spring  
スプリングの種類 Coil
- 80. Stabiliser (if fitted)  
スタビライザーの形式
- 81. Number of shockabsorbers  
ショックアブソーバーの数 2
- 82. Type  
形式 Hydraulic telescopic

**BRAKES** (photographs F and G)  
ブレーキ

- 90. System  
作動方式 Hydraulic
  - 91. Servo-assistance (if fitted), type  
サーボシステムの形式
  - 92. Number of hydraulic master cylinders  
マスターシリンダーの数 1
- |  | FRONT<br>フロント |                 | REAR<br>リヤ |                 |
|--|---------------|-----------------|------------|-----------------|
| 93. Number of cylinders per wheel<br>ホイール当りのシリンダー数 |               |                 |            |                 |
| 94. Bore of wheel cylinder (s)<br>ホイールシリンダーの内径     | 22.2          | mm              | 17.5       | mm              |
| <b>Drum Brakes</b><br>ドラムブレーキ                      |               |                 |            |                 |
| 95. Inside diameter<br>ドラムの内径                      | 203           | mm              | 180        | mm              |
| 96. Length of brake linings<br>ライニングの長さ            | 195           | mm              | 173        | mm              |
| 97. Width of brake linings<br>ライニングの幅              | 35            | mm              | 30         | mm              |
| 98. Number of shoes per brake<br>ブレーキ当りのシューの数      | 2             |                 | 2          |                 |
| 99. Total area per brake<br>1ブレーキ当りの総摩擦面積          | 13,650        | mm <sup>2</sup> | 10,380     | mm <sup>2</sup> |
| <b>Disc brakes</b><br>ディスクブレーキ                     |               |                 |            |                 |
| 100. Outside diameter<br>ディスクの外径                   |               | mm              |            | mm              |
| 101. Thickness of disc<br>ディスクの厚さ                  |               | mm              |            | mm              |
| 102. Length of brake linings<br>パッドの長さ             |               | mm              |            | mm              |
| 103. Width of brake linings<br>パッドの幅               |               | mm              |            | mm              |
| 104. Number of pads per brake<br>ブレーキ当りのパッドの数      |               |                 |            |                 |
| 105. Total area per brake<br>1ブレーキ当りの総摩擦面積         |               | mm <sup>2</sup> |            | mm <sup>2</sup> |



Make NISSAN

Model F10  
型式

**ENGINE** (photographs J and K) \*\*

130. Cycle	エンジン	4		
131. Number of cylinders	サイクル	4		
132. Cylinder arrangement	シリンダー数	In-line		
133. Bore	シリンダー配列	73 mm	2.87	inches
134. Stroke	ボア	70 mm	2.76	inches
135. Capacity per cylinder	ストローク	293 cm <sup>3</sup>	17.88	cu. in.
136. Total cylinder-capacity	1シリンダーの排気量	1,171 cm <sup>3</sup>	71.46	cu. in.
137. Material (s) of cylinder block	総排気量	Cast-iron		
138. Material (s) of sleeves (if fitted)	シリンダーブロックの材質			
139. Cylinder-head, material (s)	スリーブの材質	Aluminum alloy	Number fitted	1
140. Number of inlet ports	シリンダーヘッドの材質	4	数	
141. Number of exhaust ports	吸気孔の数	4		
142. Compression ratio	排気孔の数	9.0		
143. Volume of one combustion chamber	圧縮比	36.6 cm <sup>3</sup>		
144. Piston, material	燃焼室の容積	Aluminum alloy		
145. Number of rings	ピストンの材質	3		
146. Distance from gudgeon pin centre line to highest point of piston crown	リングの数	32.5 mm		
147. Crankshaft :	リングの距離	<del>cast iron</del> / stamped (Steel)		
148. Type of crankshaft :	クランクシャフト	<del>cast iron</del> / 鍛造		
149. Number of crankshaft main bearings	クランクシャフトの形式 :	integral / XXXXX		
150. Material of bearing cap	クランクシャフトの形式 :	一体式 /		
151. System of lubrication :	メインベアリングの数	5		
152. Capacity, lubricant	ベアリングキャップの材質	Cast iron		
153. Oil cooler :	ベアリングキャップの材質	<del>cast iron</del> / oil in sump		
154. Method of engine cooling	潤滑方式 :	<del>cast iron</del> / ウェットサンプ		
155. Capacity of cooling system	潤滑油量	3.4 ltrs		
156. Cooling fan (if fitted), dia.	オイルクーラー :	<del>cast iron</del> / no		
157. Number of blades of cooling fan	エンジン冷却方式	<del>cast iron</del> / 無		
	Water			
	5.4 ltrs			
	220 mm			
	6			
<b>Bearings **</b>				
158. Crankshaft main, type	ベアリング	Plain	Dia.	50 mm
159. Connecting rod big end,	メインベアリングの形式	Plain	Dia.	45 mm
	コンロッド大端部ベアリングの形式		内径	
<b>Weights **</b>				
160. Flywheel (clean)	重量	4.7 kg		
161. Flywheel with clutch (all turning parts)	フライホイール	5.2 kg		
162. Crankshaft	クラッチ付フライホイール	11.0 kg		
163. Connecting rod	クランクシャフト	0.41 kg		
164. Piston with rings and pin	コンロッド	0.34 kg		
	ピストン (リング、ピン含む)			

\*\* for additional information concerning Wankel rotary engines see page  
ロータリーエンジンは 参照



**FOUR STROKE ENGINES \*, \*\***

4サイクルエンジン

- 170. Number of camshafts  
カムシャフトの数
- 171. Location  
カムシャフトの位置
- 172. Type of camshaft drive  
カムシャフトの駆動方式
- 173. Type of valve operation  
バルブの作動方式

1  
Cylinder block  
Chain  
Push rod

**INLET (see page 8) \*, \*\***  
吸気系

- 180. Material(s) of inlet manifold  
マニホールドの材質
- 181. Diameter of valves  
バルブの径
- 182. Max. valve lift  
バルブリフト
- 183. Number of valve springs  
バルブスプリングの数
- 184. Type of spring  
バルブスプリングの種類
- 185. Number of valves per cylinder  
シリンダー当りのバルブの数
- 186. Tappet clearance for checking timing (cold)
- 187. Valves open at (with tolerance for tappet clearance indicated)  
バルブ開き始め
- 188. Valves close at (with tolerance for tappet clearance indicated)  
バルブ閉じ終り
- 189. Air filter, type  
エアークリーナーの形式

Aluminum alloy  
35 mm 1.38 inches  
9 mm 0.33 inches  
2  
Coil  
1  
0.35 mm  
B.T.D.C.  $14^{\circ} \pm 3^{\circ}$   
A.B.D.C.  $54^{\circ} \pm 3^{\circ}$   
Dry

**EXHAUST (see page 8) \*, \*\***  
排気系

- 195. Material (s) of exhaust manifold  
マニホールドの材質
- 196. Diameter of valves  
バルブの径
- 197. Max. valve lift  
バルブリフト
- 198. Number of valve springs  
バルブスプリングの数
- 199. Type of spring  
バルブ・スプリングの種類
- 200. Number of valves per cylinder  
シリンダー当りのバルブ数
- 201. Tappet clearance for checking timing (cold)
- 202. Valves open at (with tolerance for tappet clearance indicated)  
バルブ開き始め
- 203. Valves close at (with tolerance for tappet clearance indicated)  
バルブ閉じ終り

Cast iron  
29 mm 1.14 inches  
9 mm 0.33 inches  
2  
Coil  
1  
0.35 mm  
B.B.D.C.  $56^{\circ} \pm 3^{\circ}$   
A.T.D.C.  $12^{\circ} \pm 3^{\circ}$

**CARBURETION (photograph N)**  
気化器

- 210. Number of carburetors fitted  
キャブレターの数
- 211. Type  
形式
- 212. Make  
製造会社
- 213. Model  
型式
- 214. Number of mixture passages per carburettor  
キャブレター当りのバルブ数
- 215. Flange hole diameter of exit port(s) of carburettor  
キャブレター出口内径
- 216. Minimum dimensions of mixture passage(s)  
with piston at max. height (example: SU)  
ベンチュリーの最小寸法 (SUなどはピストン最上部で測定)

1  
Down draft  
HITACHI  
DCG306-8A  
2  
26 & 30 mm  
20 & 26 mm

\* ) for additional information concerning two-stroke engines and super-charged engines see page 2  
2サイクルエンジン、過給機付エンジンは 頁参照

\*\* ) for additional information concerning Wankel rotary engines see page  
ロータリーエンジンは 頁、参照



Make NISSAN

Model F10  
型式

F.I.A. Rec. No. 5609

**INJECTION (if fitted)**  
燃料噴射

- 220. Make of pump  
ポンプの製造会社
- 221. Number of plungers  
プランジャーの数
- 222. Model or type of pump  
ポンプの型式
- 223. Total number of injectors  
ノズルの総数
- 224. Location of injectors  
ノズルの位置
- 225. Minimum diameter of inlet pipe  
吸気管の最小径

**ENGINE ACCESSORIES**  
エンジン補機

- 230. Fuel pump :  
燃料ポンプ  
mechanical ~~or~~ / ~~or~~ electrical  
機械式 / 電気式
- 231. No. fitted  
ポンプの数  
1
- 232. Type of ignition system  
点火方式  
Make & break
- 233. No. of distributors  
ディストリビューターの数  
1
- 234. No. of ignition coils  
コイルの数  
1
- 235. No. of spark plugs per cylinder / ~~or~~  
シリンダー当りのプラグ数 ( ~~or~~ )  
1
- 236. Generator,  
発電機  
type: ~~dynamic~~ / ~~alternator~~ - number fitted 1  
交流 / 交流 数
- 237. Method of drive  
駆動方式  
V-Belt
- 238. Voltage of generator  
発電機電圧  
12 volts
- 239. Battery, number  
バッテリーの数  
1
- 240. Location  
バッテリー位置  
Engine room
- 241. Voltage of battery  
バッテリー電圧  
12 volts

**ENGINE AND CAR PERFORMANCES (as declared by manufacturer in catalogue)**

- 250. Max. engine output 68 ps (type of horsepower: JIS ) at 6,000 rpm
- 251. Maximum rpm 6,400 output at that figure 65 ps
- 252. Maximum torque 9.7 kg-m at 3,600 rpm
- 253. Maximum speed of the car 150 km/hour

255. Cam profile  
カムプロフィール

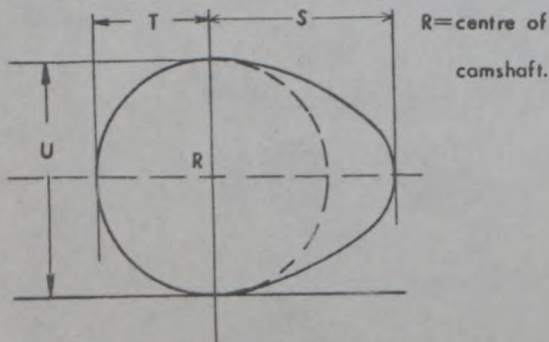

Inlet cam

吸気カム				
S =	20.9	mm	0.82	inches
T =	15.3	mm	0.60	inches
U =	30.6	mm	1.20	inches

Exhaust cam

排気カム				
S =	20.9	mm	0.82	inches
T =	15.3	mm	0.60	inches
U =	30.6	mm	1.20	inches



Make NISSAN

Model F10  
型式

Drawing inlet manifold ports, side of cylinder-head/~~hexagon~~ scale or dimensions and manufacturing tolerance.

吸気マニホールドのポート (シリンダーヘッド側)

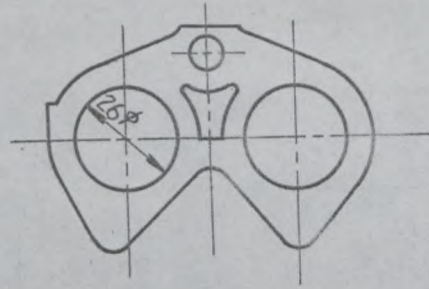

Drawing of entrance to inlet port of cylinder-head/~~hexagon~~ scale or dimensions and manufacturing tolerance.

シリンダーヘッドの吸気ポート (吸気マニホールド側)

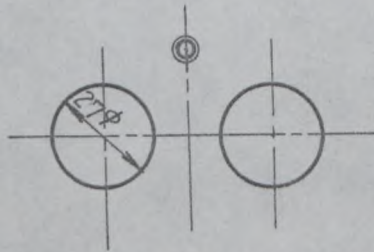

Drawing exhaust manifold ports, side of cylinder-head/~~hexagon~~ scale or dimensions and manufacturing tolerance.

排気マニホールドのポート (シリンダーヘッド側)

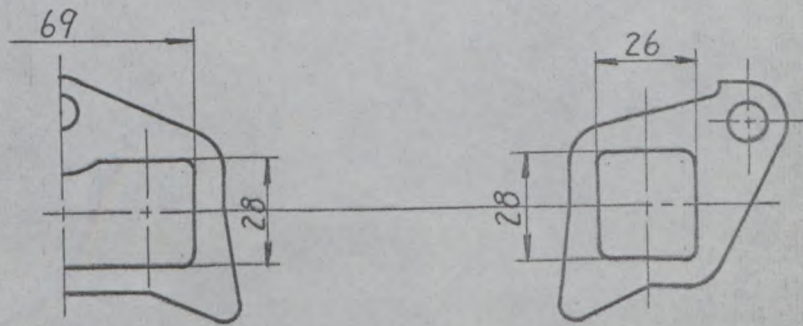

Drawing of exit to exhaust port of cylinderhead/~~hexagon~~ Indicate scale or dimensions and manufacturing tolerance.

シリンダーヘッドの排気ポート (排気マニホールド側)

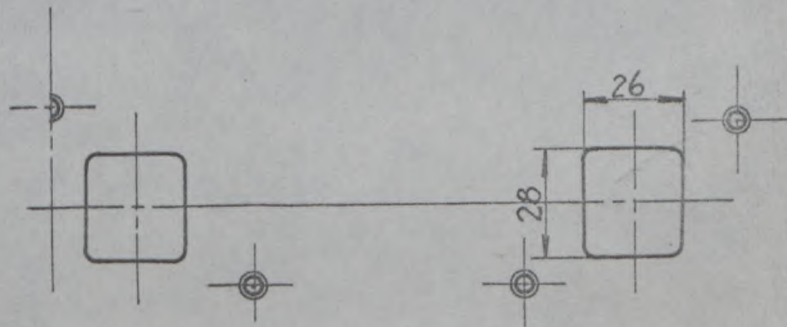

Unit: mm

~~tolerance~~  
~~XXXXXX~~





Make NISSAN

Model F10  
型式

F.I.A. Rec. No.

5609

**DRIVE TRAIN**

駆動系

**CLUTCH**

クラッチ

260. Type of clutch 形式 Dry plate  
261. No. of plates プレッシュャープレートの数 1  
262. Dia. of clutch plates 196 mm プレッシュャープレートの外径  
263. Dia. of linings, inside 132 mm フェーシングの内径 outside 190 mm 外径  
264. Method of operating clutch 作動方式 Mechanical

**GEAR BOX** (photograph H)  
トランスミッション

270. Manual type, make NISSAN 手動式の製造会社名 Method of operation Mechanical 作動方式  
271. No. of gear-box ratios forward 前進段数 4  
272. Synchronized forward ratios 1, 2, 3 & 4.  
273. Location of gear-shift シフトレバーの位置 Floor  
274. Automatic, make 自動式の製造会社名 type 形式  
275. No. of forward ratios 前進段数  
276. Location of gear-shift シフトレバーの位置

277.	Manual 手動		Automatic 自動		Alternative manual/automatic 手動/自動			
	Ratio ギヤー比	No. teeth 歯数	Ratio ギヤー比	No. teeth 歯数	Ratio ギヤー比	No. teeth 歯数	Ratio ギヤー比	No. teeth 歯数
1	3.28	$\frac{32 \times 35}{19 \times 18}$			3.67	$\frac{34 \times 35}{18 \times 18}$		
2	1.98	$\frac{32 \times 27}{19 \times 23}$			2.22	$\frac{34 \times 27}{18 \times 23}$		
3	1.38	$\frac{32 \times 23}{19 \times 28}$			1.45	$\frac{34 \times 25}{18 \times 30}$		
4	1.00				1.00			
5								
6								
reverse リバース	3.65	$\frac{32 \times 16 \times 39}{19 \times 18 \times 16}$			4.09	$\frac{34 \times 16 \times 39}{18 \times 18 \times 16}$		

278. Overdrive, type オーバードライブ形式  
279. Forward gears on which overdrive can be selected オーバードライブの作動段数  
280. Overdrive ratio オーバードライブ比

**FINAL DRIVE**  
ファイナル

290. Type of final drive 形式 Herical gear  
291. Type of differential 差動機形式 Bevel gear  
292. Type of limited slip differential (if fitted) リミテッドスリップデフの形式  
293. Final drive ratio ギヤー比 4.29 4.07  
Number of teeth 歯数 60/14 61/15



Make NISSAN

Model F10  
型式

J.A.F公認番号 T-227

F.I.A. Rec. No. 5609

**REBORING DIMENSION**

* Max Bore	73.3 mm	2.88	inches
** Max Capacity Per Cylinder	295.25 cm <sup>3</sup>	18.018	cu. in
*** Max Total Cylinder Capacity	1,181 cm <sup>3</sup>	72.07	cu. in

**COMBUSTION CHAMBER**

* Volume of one combustion chamber of cylinder head.	27.5 cm <sup>3</sup>	1.678	cu. in
** Thickness of cylinder headgasket when compressed.	0.75 mm		

Optional equipment affecting preceding information. This to be stated together with reference number.  
オプション:

The following items have been added.

LEFT-HAND DRIVE MODEL  
=====

Applicable to left-hand drive model serial number of production car will be start from No. LF-000001 for chassis.



Make NISSAN

Model F10  
型式

F.I.A. Rec. No.

Photograph  
写真

B, 3/4 view of car from rear 全体写真(斜め後方)



C, Interior view of car through driver's door (open or removed) with dashboard 運転席附近



D, Front axle complete, removed from car. Without wheels. フロントサスペンション

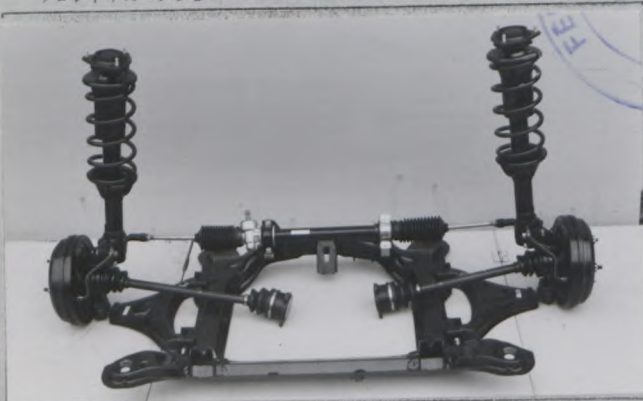

E, Rear axle complete without wheels, removed from car. リヤサスペンション



F, Front brake, drum removed フロントブレーキ

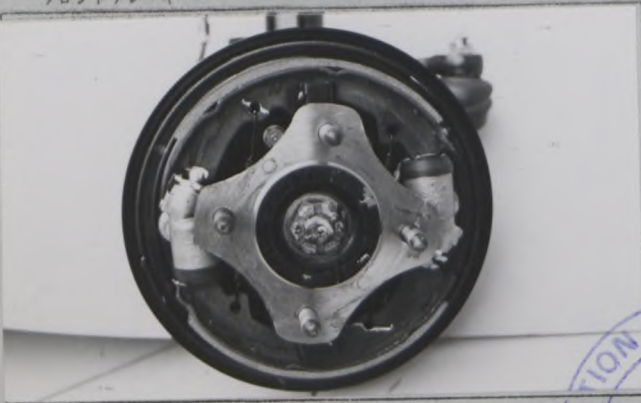

G, Rear brake, drum removed リヤブレーキ



H, Gear-box, view from side トランスミッション

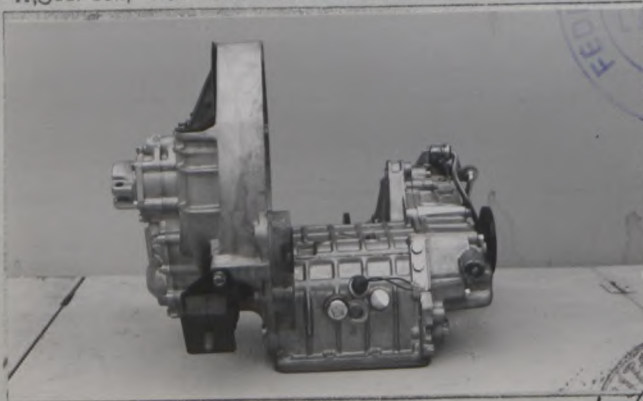

I, Silencer + exhaust pipes after exhaust manifold. 排気系

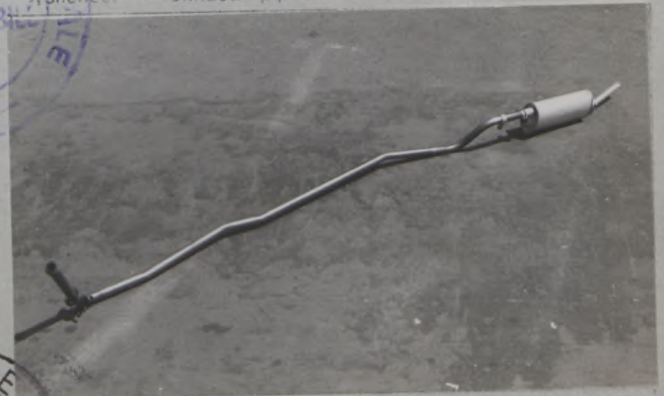

FEDERATION OF MOTOR VEHICLE INSPECTORS  
DEPARTMENT OF TRANSPORT  
JAPAN



Photograph

写真

J, Engine unit out of car, from right. With clutch and accessories but without air filter nor gear-box. エンジン右側面

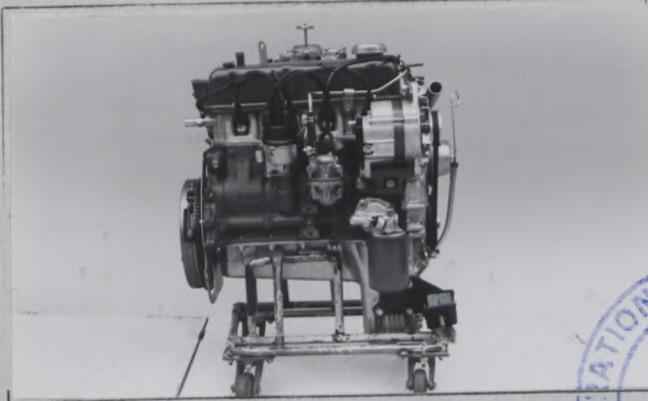

K, Engine unit out of car, from left. With clutch and accessories but without gear-box nor air filter. エンジン左側面

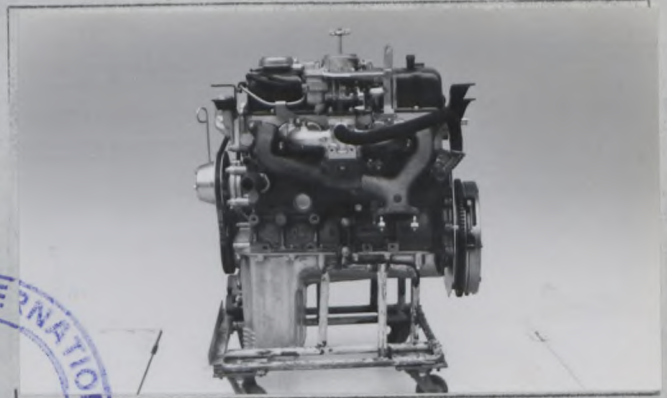

L, Combustion chamber 燃焼室 / Rotor housing

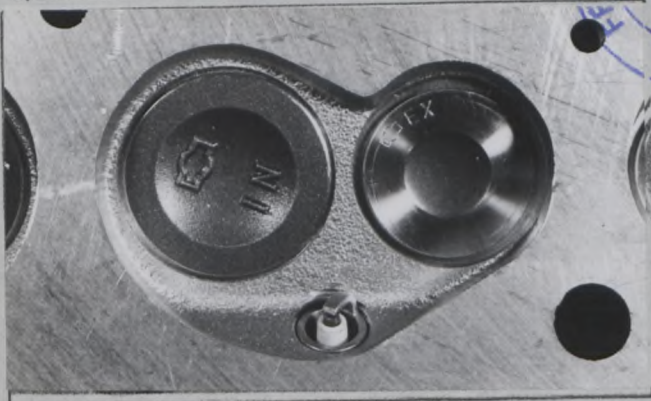

M, Piston crown ピストンクラウン / Rotor frame



N, Carburettor (view from side of manifold) 気化器

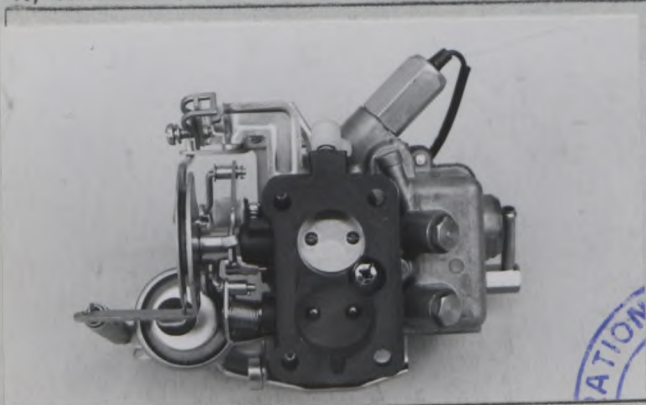

O, Engine in car with all accessories, bonnet open or removed. エンジンルーム

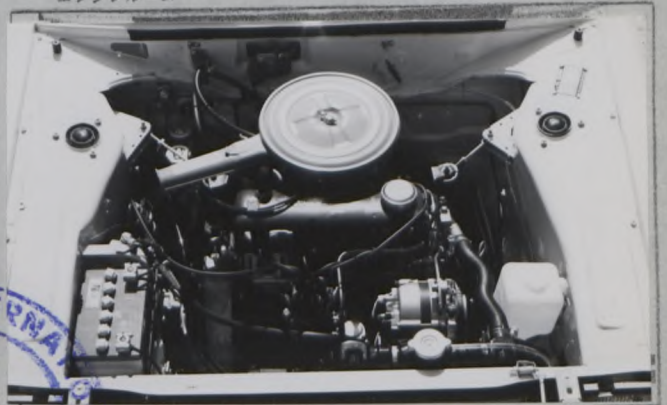

P, Inlet manifold 吸気マニホールド

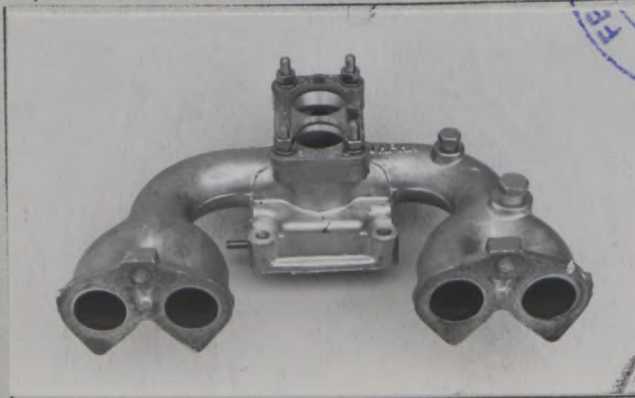

Q, Exhaust manifold 排気マニホールド

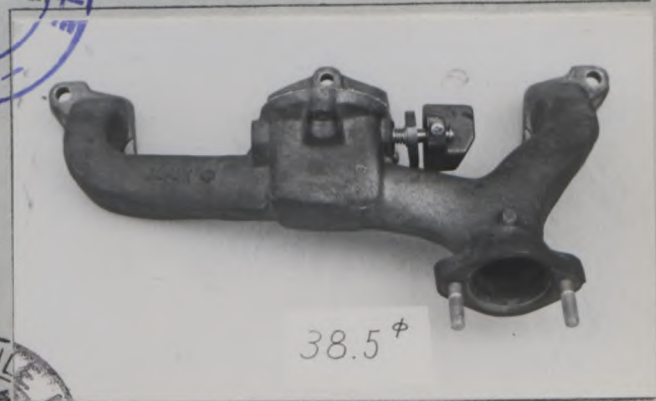

**DIMENSIONS OF INTERIOR**  
室内寸法  
(Conform to Art. 253 b of Appendix J)

For four seaters:  
4座席

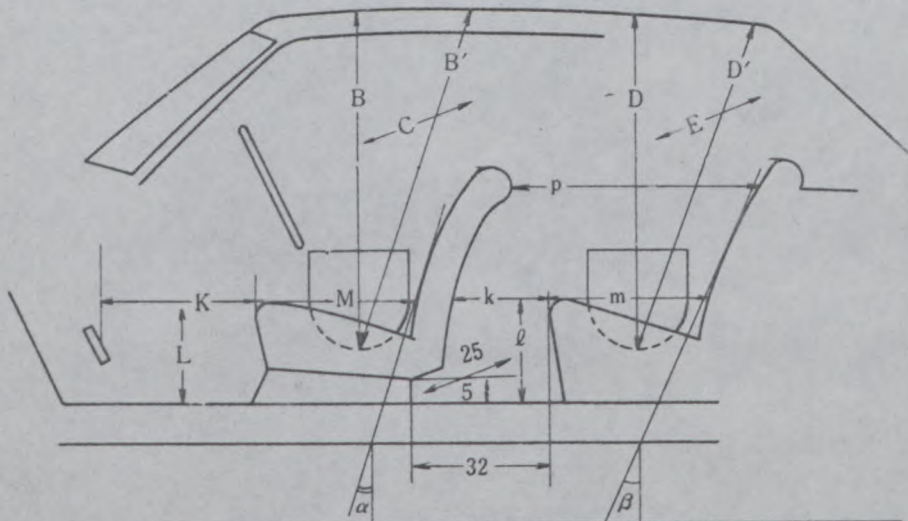

Minimum Dimensions (cm)							
B	B'	$\alpha$	C	D	D'	$\beta$	E
90	94	15	127	87	86	16	125

Minimum Dimensions (cm)								
L	$l$	M	m	k+m	p	k	k+l+m	K+L+M
35	34	46	46	70	76	24	104	125
0.9L = 31.5		0.85M = 39.1		0.85(k+m) = 59.5		(15)	(95)	(120)

For two seaters:  
2座席

Minimum Dimensions	
B	C
cm	cm

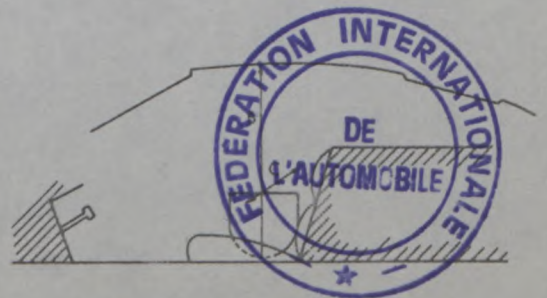



JAPAN AUTOMOBILE FEDERATION

社団法人 日本自動車連盟

J.A.F.公認番号 T-227V-5  
発効年月日 1975年7月31日  
F.I.A. Homol. No 5609 1/IV

FEDERATION INTERNATIONALE DE L'AUTOMOBILE

Form of recognition accordance with Appendix J to the International Sporting Code.

国際スポーツ法典付則J項及びJAF国内競技車両規則に従った公認書式。

**Make** NISSAN MOTOR CO., LTD. **Model** F10 NISSAN CHERRY F-II 1200  
 製造会社名 型式及び通称名  
**Modification's application starts with serial No.** chassis 適用シャーシー型式番号 F10-000001  
 engine 適用エンジン型式 A12  
**Application of this amendment started the** NOV, 1974  
 適用年月日  
**Commercial denomination after application of modifications** F10, LF10, KF10, KLF10.  
 The modifications are to be considered as: Variant / normal evolution of the type  
 変型 / 正常進化  
**Date amendment is valid from** 1 10 75 List

Description of amendment 内容

OPTIONAL EQUIPMENT

VALID FOR GROUP 2 ONLY

FRONT DISC BRAKE

- 93. Number of cylinders per wheel
- 94. Bore of wheel cylinder(s) 41.3 mm
- 100. Outside diameter 261 mm
- 101. Thickness of disc 20 mm
- 102. Length of brake linings 104 mm
- 103. Width of brake linings 47 mm
- 104. Number of pads per brake 2
- 105. Total area per brake 9,776 mm<sup>2</sup>

"valable en Groupe 2 uniquement"  
"valid for Group 2 only"



- Parts No.**
- Brake caliper R/H 41000-E4621  
L/H 41010-E4621
  - Caliper adapter plate R/H 41155-M5020  
L/H 41165-M5020
  - Brake rotor 40206-M5020
  - Steering knuckle R/H 40014-M5601  
L/H 40015-M5601
  - Front wheel hub 40204-M5020

Stamp and signature of the JAF

JAF会認印及び署名

難波靖治

Yasuharu Nanba



Stamp and signature of the F.I.A.



CYLINDER HEAD

235. No. of spark plugs per cylinder 2

Parts No. 11041-M5020

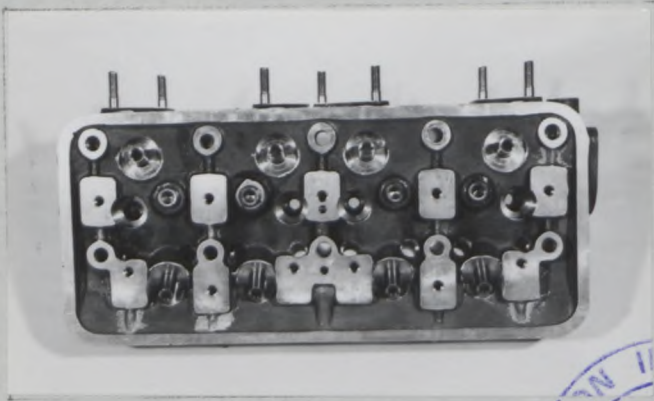

DRY SUMP LUBRICATION SYSTEM

151. System of lubrication:

Parts No.

- Oil tank 15260-M0820
- Oil pump 15010-M0820
- Oil hose 21356-M0820  
21356-M0819

Dry sump

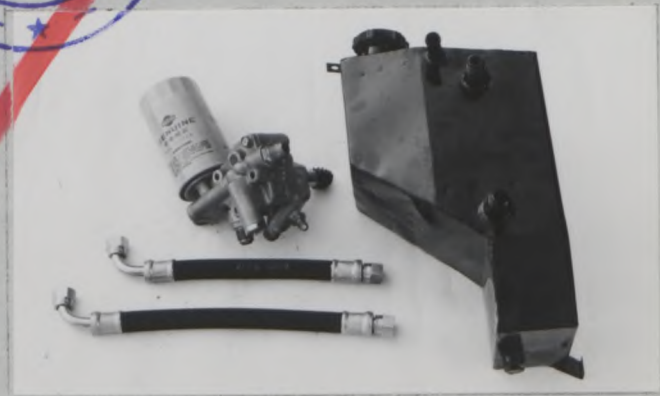

DRIVE SHAFT

Parts No. R/H 40010-M5601  
L/H 40011-M5601

"valable en Groupe 2 uniquement"  
"valid for Group 2 only"

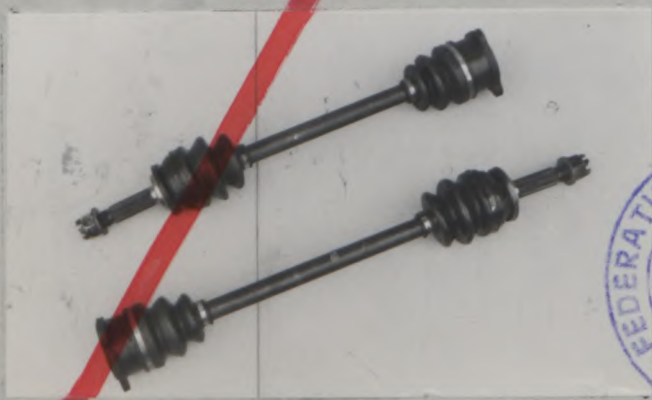

Make NISSAN

Model F10  
型式

J.A.F 公認番号 T-227 V-5

F.I.A. Rec. No. 5609 1/IV

OVER FENDER

Front over fender

Parts No. R/H 63860-M5020  
L/H 63861-M5020



Rear over fender

Parts No. R/H 63862-M5020  
L/H 63863-M5020



"valable en Groupe 2 uniquement"  
"valid for Group 2 only"







JAPAN AUTOMOBILE FEDERATION

社団法人 日本自動車連盟

J-A-F公認番号 T-227 V-2

発効年月日 1975年7月31日

F.I.A. Homol. No 5609 2/2v

FEDERATION INTERNATIONALE DE L'AUTOMOBILE

Form of recognition accordance with Appendix J to the International Sporting Code.

国際スポーツ法典付則J項及びJAF国内競技車両規則に従った公認書式。

Make NISSAN MOTOR CO., LTD. Model F10 NISSAN CHERRY F-II 1200  
 製造会社名 型式及び通称名  
 Modification's application starts with serial No. chassis 適用シャーシー型式番号 KF10-000001  
 engine 適用エンジン型式 A12  
 Application of this amendment started the SEP, 1974.  
 適用年月日  
 Commercial denomination after application of modifications KF10, KLF10.  
 The modifications are to be considered as: Variant / ~~normal evolution of the type~~  
 変型 / ~~正常進化~~  
 Date amendment is valid from 1 10 75 List

Description of amendment 内容

The following items have been added for group 1.

COUPE MODEL

A, 3/4 view of car from front



B, 3/4 view of car from rear



6. Overall height of the car 131.5 cm  
 9. Weight, total weight of the car with normal equipment, water, oil and spare wheel but without fuel nor repair tools.  
 700 kg 1,543 lbs

\* Width of the car measured in the vertical plane passing through the axle of the wheels.  
 Front 150.0 cm Rear 149.2 cm

Stamp and signature of the JAF

JAF公認印及び署名

難波靖治

Yasuharu Nanba



Stamp and signature of the F.I.A.





JAPAN AUTOMOBILE FEDERATION

社団法人 日本自動車連盟

J.A.F.公認番号 T-227 V-3

発効年月日 1975年7月31日

F. I. A. Homol. No 5609 3/3V

FEDERATION INTERNATIONALE DE L'AUTOMOBILE

Form of recognition accordance with Appendix J to the International Sporting Code.

国際スポーツ法典付則J項及びJAF国内競技車両規則に従った公認書式。

<b>Make</b> NISSAN MOTOR CO., LTD.	<b>Model</b> F10	NISSAN CHERRY F-II 1200
製造会社名	型式及び通称名	
<b>Modification's application starts with serial</b>	<b>No.</b> chassis 適用シャーシー型式番号	KF10-000001
	engine 適用エンジン型式番号	A12
<b>Application of this amendment started the</b>	SEP, 1974.	
適用年月日		
<b>Commercial denomination after application of modifications</b>	KF10, KLF10.	
<b>The modifications are to be considered as:</b> Variant / normal evolution of the type		
	変型 / 正常進化	
<b>Date amendment is valid from</b>		List

Description of amendment 内容

The following items have been added for group 2.

CAR WITH REAR AIR SPOILER MODEL

VALID FOR GROUP 2 ONLY

Photograph B, 3/4 view of car from rear



"valable en Groupe 2 uniquement" "valid for Group 2 only"

6. Overall height of the car	1.5	cm
9. <u>Weight</u> , total weight of the car with normal equipment, water, oil and spare wheel but without fuel nor repairs	700	kg
	1,543	lbs

\* Width of the car measured in the vertical plane passing through the axle of the wheels

Front	150.0	cm	Rear	149.2	cm
-------	-------	----	------	-------	----

Stamp and signature of the JAF

JAF公認印及び署名

難波靖治

Yasuharu Nanba



Stamp and signature of the F.I.A.





JAPAN AUTOMOBILE FEDERATION

社団法人 日本自動車連盟

J.A.F.公認番号 T-227 V-1

発効年月日 1975年7月31日

F. I. A. Homol. No 5609

h/hv

FEDERATION INTERNATIONALE DE L'AUTOMOBILE

Form of recognition accordance with Appendix J to the International Sporting Code.

国際スポーツ法典付則J項及びJAF国内競技車両規則に従った公認書式。

<b>Make</b> NISSAN MOTOR CO., LTD.	<b>Model</b> F10	NISSAN CHERRY F-II 1200
製造会社名	型式及び通称名	
<b>Modification's application starts with serial</b>	<b>No. chassis engine</b>	F10-000001
	適用シャーシー型式番号	
	適用エンジン型式	A12
<b>Application of this amendment started the</b>	<b>SEP, 1974.</b>	
適用年月日		
<b>Commercial denomination after application of modifications</b>	<b>F10, LF10.</b>	
<b>The modifications are to be considered as:</b> Variant / <del>modification</del> <del>of this type</del>		
	変型 / <del>変更</del>	
<b>Date amendment is valid from</b>	<u>1 10 75</u> List	

Description of amendment 内容

The following items have been added for group 1.

4DOOR SEDAN MODEL

A, 3/4 view of car from front



B, 3/4 view of car from rear



9. Weight, total weight of the car with normal equipment, water, oil and spare wheel but without fuel nor repair tools:

695	kg	1,532	lbs
-----	----	-------	-----

Stamp and signature of the JAF

JAF公認印及び署名

難波靖治

Yasuharu Nanba



Stamp and signature of the F.I.A.





JAPAN AUTOMOBILE FEDERATION

社団法人 日本自動車連盟

J.A.F公認番号 T-227 V-4  
発効年月日 1975年7月31日  
F.I.A. Homol. No 5609

5/5V

FEDERATION INTERNATIONALE DE L'AUTOMOBILE

Form of recognition accordance with Appendix J to the International Sporting Code.

国際スポーツ法典付則J項及びJAF国内競技車両規則に従った公認書式。

<b>Make</b> : NISSAN MOTOR CO., LTD. 製造会社名	<b>Model</b> F10 型式及び通称名	NISSAN CHERRY F-II 1200
Modification's application starts with serial	<b>No. chassis</b> 適用シャーシー型式番号 <b>engine</b> 適用エンジン型式	F10-000001 A12
Application of this amendment started the 適用年月日	SEP, 1974.	
Commercial denomination after application of modifications	F10, LF10, KF10, KLF10.	
The modifications are to be considered as: Variant / <del>modification</del> 変型 / <del>変更</del>		
Date amendment is valid from	1 10 75	List

Description of amendment 内容

The following items have been added for group 1.

F10 SERIES MODEL VARIATION

WHEELS

50. Type	Pressed steel		
51. Weight(per wheel without tyre)	6.9	kg	
52. Method of attachment	4 Nuts		
53. Rim diameter	330	mm	13 inches
54. Rim width	114	mm	4.5 inches

SUSPENSION

72. Stabilizer Torsion bar

Photograph  
Road wheel



D, Front axle complete

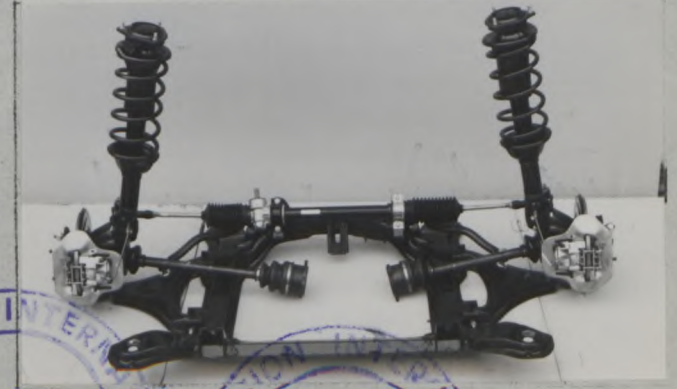

Stamp and signature of the JAF

JAF公認印及び署名

難波靖治

Yasuharu Nanba

Stamp and signature of the F.I.A.

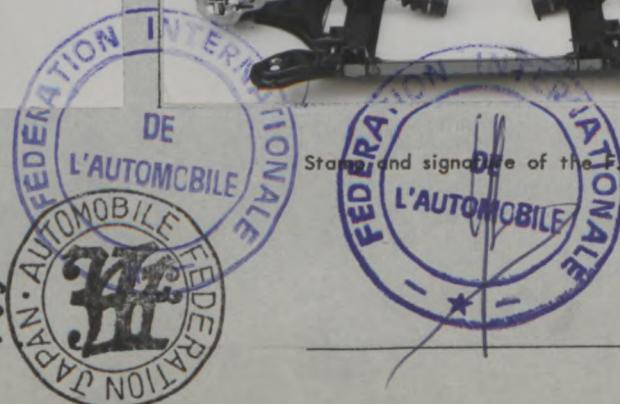

Make NISSAN

Model F10  
型式

5/5V

FRONT DISC BRAKES

93. Number of cylinders per wheel	1	
94. Bore of wheel cylinder(s)	48.1	mm
100. Outside diameter	220	mm
101. Thickness of disc	10	mm
102. Length of brake lining	56.8	mm
103. Width of brake lining	42	mm
104. Number of pads per brake	2	
105. Total area per brake	4,700	mm <sup>2</sup>

Photograph

F, Front brake, disc with caliper(s)



GEAR BOX(5Speed)

270. Manual type make	NISSAN
Method of operation	Mechanical
271. No. of gear-box ratios forward	5
272. Synchronized forward ratios	1,2,3,4 & 5.
273. Location of gear-shift	Floor

277	Manual	
	Ratio	No. teeth
1	4.02	$\frac{35}{18} \times \frac{31}{15}$
2	2.66	$\frac{35}{18} \times \frac{26}{19}$
3	1.72	$\frac{35}{18} \times \frac{23}{26}$
4	1.18	$\frac{35}{18} \times \frac{20}{33}$
5	1.00	
reverse	4.09	$\frac{35}{18} \times \frac{19}{22} \times \frac{39}{16}$



Photograph  
H, Gear box

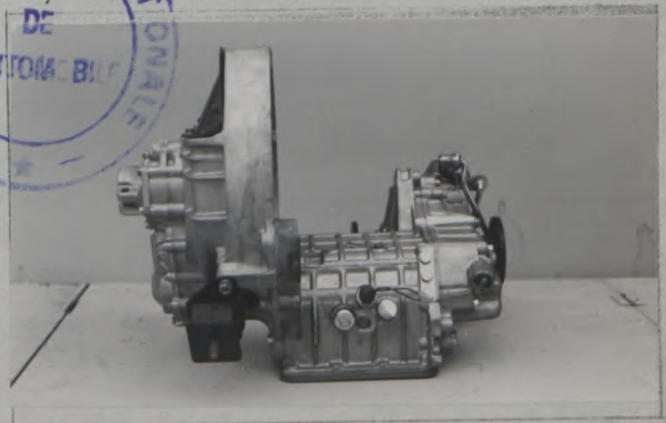



JAPAN AUTOMOBILE FEDERATION

社団法人 日本自動車連盟

J.A.F 公認番号  
発効年月日

T-227V-6

昭和51年4月30日

F.I.A. Homol. No 5609

*Handwritten signature*

FEDERATION INTERNATIONALE DE L'AUTOMOBILE

Form of recognition accordance with  
Appendix J to the International Sporting Code.

国際スポーツ法典付則J項及びJAF国内競技車両規則に従った公認書式。

Make NISSAN MOTOR CO., LTD. Model F10 NISSAN CHERRY F-II 1200  
 製造会社名 型式及び通称名  
 Modification's application starts with serial No. chassis 適用シャーシー型式番号 F10-000001  
 engine 適用エンジン型式番号 A12  
 Application of this amendment started the APR, 1975.  
 適用年月日  
 Commercial denomination after application of modifications (L)F10, K(L)F10  
 The modifications are to be considered as: Variant / ~~type of evolution of the type~~  
 変型 / ~~進化型~~  
 Date amendment is valid from 1976 List

Description of amendment 内容

**VALID FOR GROUP 2 ONLY**

OPTIONAL EQUIPMENT

NOTE: The item number in the brackets is according to the old recognition form.

GEAR-BOX (This type has been recognized at F.I.A. No. 5609/5/5V already.  
And the following ratios have been added.)

	Manual			
	Ratio	No. teeth	Ratio	No. teeth
1	3.17	$\frac{27 \times 29}{19 \times 13}$	2.56	$\frac{27 \times 27}{19 \times 15}$
2	2.13	$\frac{27 \times 17}{19 \times 18}$	1.78	$\frac{27 \times 25}{19 \times 20}$
3	1.48	$\frac{27 \times 24}{19 \times 23}$	1.36	$\frac{27 \times 23}{19 \times 24}$
4	1.20	$\frac{27 \times 22}{19 \times 26}$	1.15	$\frac{27 \times 21}{19 \times 26}$
5	1.00		1.00	
reverse	2.99	$\frac{27 \times 19 \times 39}{19 \times 22 \times 16}$	2.99	$\frac{27 \times 19 \times 39}{19 \times 22 \times 16}$

FINAL DRIVE (This type has been recognized at F.I.A. No. 5609 already.  
And the following ratios have been added.)

103. (293) Number of teeth 62/17, 59/15, 62/14, 64/14, 62/13.

104. (293) Ratio 3.65, 3.93, 4.43, 4.57, 4.77.

Stamp and signature of the JAF

JAF公認印及び署名

*Handwritten signature: Yasuharu Nanba*

Yasuharu Nanba



Stamp and signature of the F.I.A.





JAPAN AUTOMOBILE FEDERATION

社団法人 日本自動車連盟

J.A.F. 公認番号

T-227V-7

発効年月日

昭和52年1月31日

F.I.A. Homol. No

5609/ 717V

FEDERATION INTERNATIONALE DE L'AUTOMOBILE

Form of recognition accordance with Appendix J to the International Sporting Code.

国際スポーツ法典付則J項及びJAF国内競技車両規則に従った公認書式。

Make	NISSAN MOTOR CO., LTD.	Model	F10	NISSAN CHERRY F-II 1200
製造会社名		型式及び通称名		
Modification's application starts with serial No.		chassis No.	F10	
		適用シャーシー型式番号		
		engine No.	A12	
		適用エンジン型式		
Application of this amendment started the	OCT, 1976			
適用年月日				
Commercial denomination after application of modifications	F11, LF11, KF11, KLF11.			
The modifications are to be considered as:	Variant / normal evolution of the type			
	変型 / 正常進化			
Date amendment is valid from	1.4.77	List		

Description of amendment 内容

The following items have been added for group 1.

The changes of commercial denomination and serial number

The production right-hand drive model cars will start No. F11-000001 for chassis have been added.

Applicable to left-hand drive model serial number of production car will be start from No. LF11-000001 for chassis.

Stamp and signature of the JAF

JAF公認印及び署名

難波靖治

Yasuharu Nanba



Stamp and signature of the F.I.A.

