



# JAPAN AUTOMOBILE FEDERATION

社団法人・日本自動車連盟

FEDERATION INTERNATIONALE DE L'AUTOMOBILE

JAF公認番号 T-220

グループ T

発効年月日 1974年12月31日

F. I. A. Recognition No.

Group

5603

1

Form of recognition in accordance with Appendix J to the International Sporting Code.

国際スポーツ法典付則J項及びJAF国内競技車両規則に従った公認書式。

Manufacturer 製造会社名 Toyota Motor Co., Ltd.

Serial No of 製造開始シャシー型式番号 chassis TE30-000001

engine エンジン型式 T

Recognition is valid from 1. 8. 75

Cylinder-capacity 総排気量

Model 型式及び通称名

Manufacturer

Manufacturer

List

Reciprocation レシプロ 1407cm<sup>3</sup> 85.9 cu.in.

Special 特殊 cm<sup>3</sup> cu.in.

Toyota Corolla, TE30

Toyota Motor Co., Ltd.

Toyota Motor Co., Ltd.

The manufacturing of the model described in this recognition form was started on Apr. 1974 and the minimum production of 5000 identical cars, in accordance with the specifications of this form was reached on Jun. 1974

Photograph A, 3/4 view of car from front 写真A、全体写真(斜め前方)



The vehicle described in this form has been subject to the following amendments :

Variants

|    |    |          |      |
|----|----|----------|------|
| on | 19 | rec. No. | List |
| on | 19 | rec. No. | List |
| on | 19 | rec. No. | List |
| on | 19 | rec. No. | List |
| on | 19 | rec. No. | List |

Normal evolution of the type

|    |    |          |      |
|----|----|----------|------|
| on | 19 | rec. No. | List |
| on | 19 | rec. No. | List |
| on | 19 | rec. No. | List |
| on | 19 | rec. No. | List |
| on | 19 | rec. No. | List |

Stamp and signature of the JAF

JAF公認印及び署名

難波靖治

Yasuharu Nanba



Stamp and signature of the F. I. A.

Make **Toyota**

Model **TE30**  
型式

J.A.F.公認番号 **T-220**

F.I.A. Rec. No.

**IMPORTANT** - the underlined items must be stated in two measuring systems, one of which must be the metric system. See conversion table hereafter.

**CAPACITIES AND DIMENSIONS**

仕様諸元

|   |       |           |      |                    |
|---|-------|-----------|------|--------------------|
| 1. <u>Wheelbase</u><br>ホイールベース  | 237.0 | cm        | 93.3 | inches             |
| 2. <u>Front track</u><br>トレッド(前)  | 130.0 | cm        | 51.2 | inches             |
| 3. <u>Rear track</u><br>トレッド(後)   | 128.5 | cm        | 50.6 | inches             |
| 4. Overall length of the car<br>全長  | 399.5 | cm        |      |                    |
| 5. Overall width of the car<br>全幅   | 157.0 | cm        |      |                    |
| 6. Overall height of the car<br>全高  | 137.5 | cm        |      |                    |
| 7. <u>Capacity of fuel tank (reserve included)</u><br>燃料タンク容量   | 13.2  | Gallon US | 50   | ltrs<br>Gallon Imp |
| 8. Seating capacity<br>定員   | 5     |           |      |                    |
| 9. <u>Weight, total weight of the car with normal equipment, water, oil and spare wheel but without fuel nor repair tools.</u><br>車両重量(冷却水、オイル、スペアタイヤを含む標準状態の車両重量、但し燃料、車載工具を除く) | 840   | kg        | 1854 | lbs                |

\* Differences in track caused by the use of other wheels with different rim widths must be stated when recognition is requested for the wheels concerned.

\*\* Specify ground clearance in relation to the track and give drawing of two fixed points of the vehicle's structure at which measurements are taken.  
車両の標準状態を示すためのサイドメンバー前端及び後端に於ける地上高

These ground clearance dimensions are only for information when checking the track and can in no way affect the eligibility of the car.

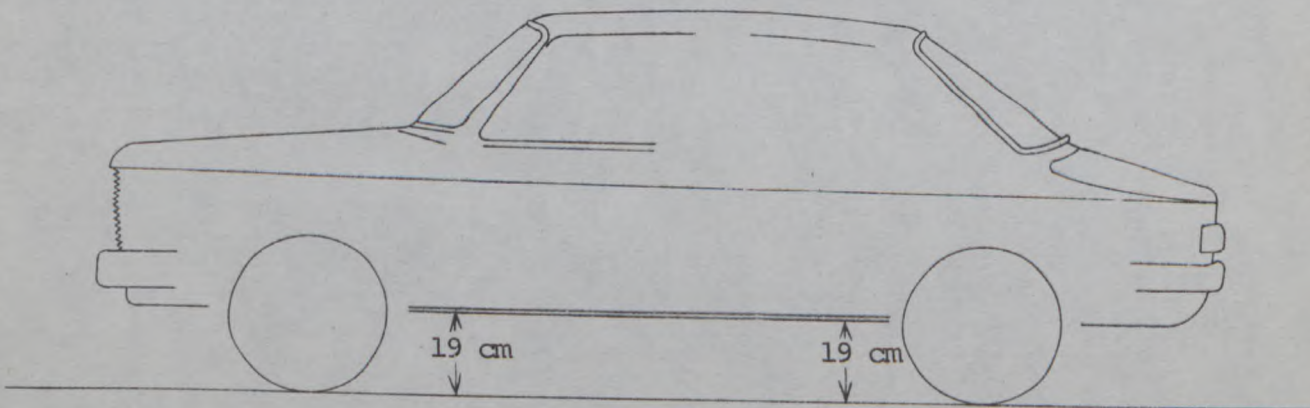

Unit : cm

\*\*\* Width of the car measured in the vertical plane passing through the axle of the wheels.

車軸上の車体幅

|               |     |    |            |     |    |
|---------------|-----|----|------------|-----|----|
| Front<br>フロント | 155 | cm | Rear<br>リア | 156 | cm |
|---------------|-----|----|------------|-----|----|

**CONVERSION TABLE**

|                             |                        |                        |             |
|-----------------------------|------------------------|------------------------|-------------|
| 1 inch / pouce              | 2.54 cm                | 1 quart US             | 0.9464 ltrs |
| 1 foot / pied               | 30.4794 cm             | 1 pint (pt)            | 0.568 ltrs  |
| 1 square inch / pouce carre | 6.452 cm <sup>2</sup>  | 1 gallon Imp.          | 4.546 ltrs  |
| 1 cubic inch / pouce cube   | 16.387 cm <sup>3</sup> | 1 gallon US            | 3.785 ltrs  |
| 1 pound / livre (lb)        | 453.593 gr.            | 1 hundred weight (cwt) | 50.802 kg   |



Make Toyota

Model TE30  
型式

**CHASSIS AND COACHWORK** (Photographs A, B and C)

シャーシー、ボデー

20. Chassis/body construction : ~~XXXXXX~~/unitary construction  
シャーシー/ボディーの構造 ~~XXXXXX~~/一体構造
21. Unitary construction, material (s) Steel  
一体構造の場合その材質
22. Separate constructions: material (s) of chassis  
セパレート構造の場合その材質
23. Material (s) of coachwork  
ボディーの材質
24. Number of doors 2 Material (s) Steel  
ドアの数 材質
25. Material (s) of bonnet Steel  
ボンネットの材質
26. Material (s) of boot lid Steel  
トランクリッドの材質
27. Material (s) of rear-window Glass  
リヤウインドシールドの材質
28. Material (s) of windscreen Glass [LAMINATED]  
フロントウインドシールドの材質
29. Material (s) of front-door windows Glass  
フロントドアウインドーの材質
30. Material (s) of rear-door windows  
リヤドアウインドーの材質
31. Sliding system of door windows Vertical, Manual  
ドアウインドーの開閉方式
32. Material (s) of rear-quarter light Glass  
リヤクォーターウインドーの材質

**ACCESSORIES AND UPHOLSTERY**

アクセサリ

38. Interior heating : yes - ~~XX~~
39. Air-conditioning : ~~XX~~ - no
40. Ventilation : yes - ~~XX~~
41. Front seats, type of seats and upholstery Separate, Vinyl  
フロントシートの形式と表張りの材質
42. Weight of front seat (s), complete with supports and rails, out of the car :  
フロントシートの重量 (ブラケット、シートレール付) 13.4x2 kg
43. Rear seats, type of seats and upholstery Bench, Vinyl  
リヤシートの形式と表張りの材質
44. Front bumper, material (s) Steel Weight 5.0 kg  
フロントバンパーの材質 重量
45. Rear bumper, material (s) Steel Weight 4.5 kg  
リヤバンパーの材質 重量

**WHEELS**

ホイール

50. Type Pressed steel  
形式
51. Weight (per wheel, without tyre) 6.0 kg  
重量
52. Method of attachment 4 Nuts  
取付け方法
53. Rim diameter 329 mm 13 inches  
リム径
54. Rim width 102 mm 4 inches  
リム幅

**STEERING**

ステアリング

60. Type Recirculating ball  
形式
61. Servo-assistance : ~~XX~~ - no  
パワーステアリング ~~XX~~ - 無
62. Number of turns of steering wheel from lock to lock 3.6  
ロックソーロック
63. In case of servo-assistance



Make Toyota

Model TE30  
型式

F.I.A. Rec. No.

**SUSPENSION**

サスペンション

|   |                      |
|---|----------------------|
| 70. Front suspension (photogr. D), type<br>フロントサスペンションの形式 | Mc.pherson           |
| 71. Type of spring<br>スプリングの種類                            | Coil                 |
| 72. Stabiliser (if fitted)<br>スタビライザーの形式                  | Torsion bar          |
| 73. Number of shockabsorbers<br>ショックアブソーバーの数              | 2                    |
| 74. Type<br>形式  | Hydraulic telescopic |
|   |                      |
| 78. Rear suspension (photogr. E), type<br>リヤサスペンションの形式    | Rigid axle           |
| 79. Type of spring<br>スプリングの種類                            | Leaf                 |
| 80. Stabiliser (if fitted)<br>スタビライザーの形式                  |                      |
| 81. Number of shockabsorbers<br>ショックアブソーバーの数              | 2                    |
| 82. Type<br>形式  | Hydraulic telescopic |

**BRAKES** (photographs F and G)

ブレーキ

|   |           |                 |       |                 |
|---|-----------|-----------------|-------|-----------------|
| 90. System<br>作動方式                                      | Hydraulic |                 |       |                 |
| 91. Servo-assistance (if fitted), type<br>サーボシステムの形式    | Vaccum    |                 |       |                 |
| 92. Number of hydraulic master cylinders<br>マスターシリンダーの数 | 1         |                 |       |                 |
|   |           | FRONT<br>フロント   |       | REAR<br>リヤ      |
| 93. Number of cylinders per wheel<br>ホイール当りのシリンダー数      |           | 2               |       | 1               |
| 94. Bore of wheel cylinder (s)<br>ホイールシリンダーの内径          | 22.2      | mm              | 17.4  | mm              |
| <b>Drum Brakes</b><br>ドラムブレーキ                           |           |                 |       |                 |
| 95. Inside diameter<br>ドラムの内径                           | 228       | mm              | 228   | mm              |
| 96. Length of brake linings<br>ライニングの長さ                 | 219       | mm              | 219   | mm              |
| 97. Width of brake linings<br>ライニングの幅                   | 45        | mm              | 40    | mm              |
| 98. Number of shoes per brake<br>ブレーキ当りのシューの数           |           | 2               |       | 2               |
| 99. Total area per brake<br>1 ブレーキ当りの総摩擦面積              | 19710     | mm <sup>2</sup> | 17520 | mm <sup>2</sup> |
| <b>Disc brakes</b><br>ディスクブレーキ                          |           |                 |       |                 |
| 100. Outside diameter<br>ディスクの外径                        |           | mm              |       | mm              |
| 101. Thickness of disc<br>ディスクの厚さ                       |           | mm              |       | mm              |
| 102. Length of brake linings<br>パッドの長さ                  |           | mm              |       | mm              |
| 103. Width of brake linings<br>パッドの幅                    |           | mm              |       | mm              |
| 104. Number of pads per brake<br>ブレーキ当りのパッドの数           |           |                 |       |                 |
| 105. Total area per brake<br>1 ブレーキ当りの総摩擦面積             |           | mm <sup>2</sup> |       | mm <sup>2</sup> |



Make Toyota

Model TE30  
型式**ENGINE** (photographs J and K) \*\*

エンジン

|   |                                   |                 |       |                    |
|---|-----------------------------------|-----------------|-------|--------------------|
| 130. Cycle  | 4                                 |                 |       |                    |
| サイクル  |                                   |                 |       |                    |
| 131. Number of cylinders  | 4                                 |                 |       |                    |
| シリンダー数  |                                   |                 |       |                    |
| 132. Cylinder arrangement   | In-line                           |                 |       |                    |
| シリンダー配列   |                                   |                 |       |                    |
| 133. Bore   | 80.0                              | mm              | 3.14  | inches             |
| ボア  |                                   |                 |       |                    |
| 134. Stroke   | 70.0                              | mm              | 2.75  | inches             |
| ストローク   |                                   |                 |       |                    |
| 135. Capacity per cylinder  | 352                               | cm <sup>3</sup> | 21.48 | cu. in.            |
| 1シリンダーの排気量  |                                   |                 |       |                    |
| 136. Total cylinder-capacity  | 1407                              | cm <sup>3</sup> | 85.86 | cu. in.            |
| 総排気量  |                                   |                 |       |                    |
| 137. Material (s) of cylinder block   | Cast-iron                         |                 |       |                    |
| シリンダーブロックの材質  |                                   |                 |       |                    |
| 138. Material (s) of sleeves (if fitted)                                    |                                   |                 |       |                    |
| スリーブの材質   |                                   |                 |       |                    |
| 139. Cylinder-head, material (s)  | Aluminum alloy                    | Number fitted   | 1     |                    |
| シリンダーヘッドの材質   |                                   | 数               |       |                    |
| 140. Number of inlet ports  | 4                                 |                 |       |                    |
| 吸気孔の数   |                                   |                 |       |                    |
| 141. Number of exhaust ports  | 4                                 |                 |       |                    |
| 排気孔の数   |                                   |                 |       |                    |
| 142. Compression ratio  | 8.5                               |                 |       |                    |
| 圧縮比   |                                   |                 |       |                    |
| 143. Volume of one combustion chamber                                       | 46.9                              | cm <sup>3</sup> |       |                    |
| 燃焼室の容積  |                                   |                 |       |                    |
| 144. Piston, material   | Aluminum alloy                    |                 |       |                    |
| ピストンの材質   |                                   |                 |       |                    |
| 145. Number of rings  | 3                                 |                 |       |                    |
| リングの数   |                                   |                 |       |                    |
| 146. Distance from gudgeon pin centre line to highest point of piston crown | 46                                | mm              |       |                    |
| ピストンピンとピストンクラウン最頂点との距離  |                                   |                 |       |                    |
| 147. Crankshaft :   |                                   |                 |       |                    |
| クランクシャフト  |                                   |                 |       |                    |
| 148. Type of crankshaft :   | moulded / <del>xxxxxx</del>       |                 |       | (material : Steel) |
| クランクシャフトの形式 :   | 鑄造 / <del>鑄造</del>                |                 |       |                    |
| 149. Number of crankshaft main bearings                                     | 5                                 |                 |       |                    |
| メインベアリングの数  |                                   |                 |       |                    |
| 150. Material of bearing cap  | Cast-iron                         |                 |       |                    |
| ベアリングキャップの材質  |                                   |                 |       |                    |
| 151. System of lubrication :  | <del>dry sump</del> / oil in sump |                 |       |                    |
| 潤滑方式 :  | <del>ドライサンプ</del> / ウェットサンプ       |                 |       |                    |
| 152. Capacity, lubricant  | 3.7                               | ltrs            |       |                    |
| 潤滑油量  |                                   |                 |       |                    |
| 153. Oil cooler :   | <del>yes</del> / no               |                 |       |                    |
| オイルクーラー :   | <del>有</del> / 無                  |                 |       |                    |
| 154. Method of engine cooling   | Water                             |                 |       |                    |
| エンジン冷却方式  |                                   |                 |       |                    |
| 155. Capacity of cooling system   | 6.5                               | ltrs            |       |                    |
| 冷却水の総量  |                                   |                 |       |                    |
| 156. Cooling fan (if fitted), dia.  | 320                               | mm              |       |                    |
| 冷却ファンの直径  |                                   |                 |       |                    |
| 157. Number of blades of cooling fan  | 4                                 |                 |       |                    |
| 冷却ファンのブレード数   |                                   |                 |       |                    |
| <b>Bearings **</b>  |                                   |                 |       |                    |
| ベアリング   |                                   |                 |       |                    |
| 158. Crankshaft main, type  | Plain                             | Dia.            | 58    | mm                 |
| メインベアリングの形式   |                                   | 内径              |       |                    |
| 159. Connecting rod big end,  | Plain                             | Dia.            | 48    | mm                 |
| コンロッド大端部ベアリングの形式  |                                   | 内径              |       |                    |
| <b>Weights **</b>   |                                   |                 |       |                    |
| 重量  |                                   |                 |       |                    |
| 160. Flywheel (clean)   | 10.5                              | kg              |       |                    |
| フライホイール   |                                   |                 |       |                    |
| 161. Flywheel with clutch (all turning parts)                               | 15.0                              | kg              |       |                    |
| クラッチ付フライホイール  |                                   |                 |       |                    |
| 162. Crankshaft   | 11.8                              | kg              |       |                    |
| クランクシャフト  |                                   |                 |       |                    |
| 163. Connecting rod   | 0.62                              | kg              |       |                    |
| コンロッド   |                                   |                 |       |                    |
| 164. Piston with rings and pin  | 0.53                              | kg              |       |                    |
| ピストン (リング、ピン含む)   |                                   |                 |       |                    |



\*\* for additional information concerning Wankel rotary engines see page  
ロータリーエンジンは 参照



Make Toyota

Model TE30  
型式

T-220  
J.A.F.公認番号 T-220  
F.I.A. Rec. No.

**INJECTION** (if fitted)  
燃料噴射

- 220. Make of pump  
ポンプの製造会社
- 221. Number of plungers  
プランジャーの数
- 222. Model or type of pump  
ポンプの型式
- 223. Total number of injectors  
ノズルの総数
- 224. Location of injectors  
ノズルの位置
- 225. Minimum diameter of inlet pipe  
吸気管の最小径

mm

**ENGINE ACCESSORIES**  
エンジン補機

- 230. Fuel pump :  
燃料ポンプ : mechanical pump / ~~mechanical~~  
機械式 ~~XXXX~~
- 231. No. fitted 1
- 232. Type of ignition system Make & Break
- 233. No. of distributors 1
- 234. No. of ignition coils 1
- 235. No. of spark plugs per cylinder ~~XXXX~~ 1  
シリンダー当りのプラグ数 ~~XXXXXXXX~~
- 236. Generator, type: ~~DC~~ / ~~alternator~~ - number fitted 1  
発電機 交流 数
- 237. Method of drive V-belt
- 238. Voltage of generator 12 volts
- 239. Battery, number 1
- 240. Location Engine room
- 241. Voltage of battery 12 volts

**ENGINE AND CAR PERFORMANCES** (as declared by manufacturer in catalogue)

- 250. Max. engine output 86PS (type of horsepower: JIS ) at 6000 rpm
- 251. Maximum rpm 6350 output at that figure 86 PS (JIS)
- 252. Maximum torque 12.0 at 3800 rpm
- 253. Maximum speed of the car 160 km/hour

255. Cam profile  
カムプロフィール

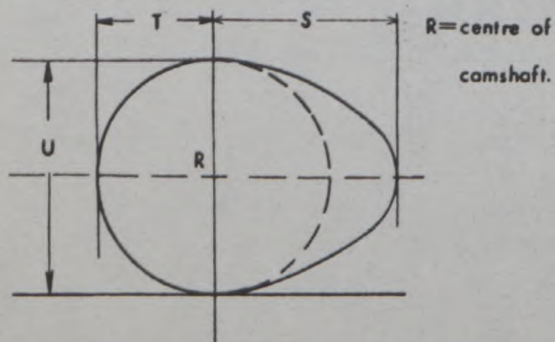

Inlet cam  
吸気カム

|     |      |    |      |        |
|-----|------|----|------|--------|
| S = | 22.4 | mm | 0.88 | inches |
| T = | 16.0 | mm | 0.63 | inches |
| U = | 32.0 | mm | 1.26 | inches |

Exhaust cam  
排気カム

|     |      |    |      |        |
|-----|------|----|------|--------|
| S = | 22.4 | mm | 0.88 | inches |
| T = | 16.0 | mm | 0.63 | inches |
| U = | 32.0 | mm | 1.26 | inches |



Make Toyota

Model TE30  
型式

Drawing inlet manifold ports, side of cylinder-head/housing scale or dimensions and manufacturing tolerance.

吸気マニホールドのポート (シリンダーヘッド側)

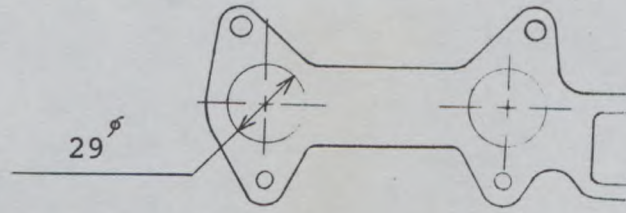

Drawing of entrance to inlet port of cylinder-head/housing scale or dimensions and manufacturing tolerance.

シリンダーヘッドの吸気ポート (吸気マニホールド側)

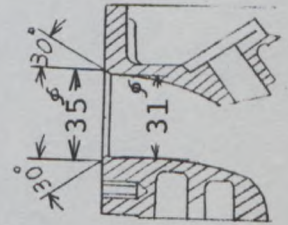
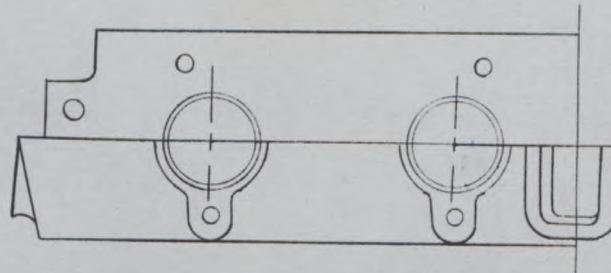

Drawing exhaust manifold ports, side of cylinder-head/housing scale or dimensions and manufacturing tolerance.

排気マニホールドのポート (シリンダーヘッド側)

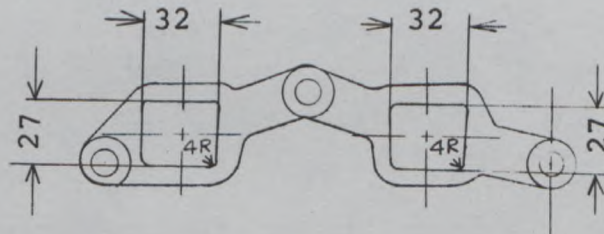

Drawing of exit to exhaust port of cylinderhead/housing. Indicate scale or dimensions and manufacturing tolerance.

シリンダーヘッドの排気ポート (排気マニホールド側)

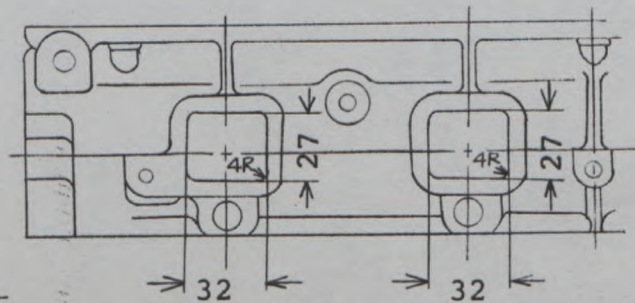

Unit: mm

Tolerance: 製造公差





Make Toyota

Model TE30  
型式

**DRIVE TRAIN**

**CLUTCH**  
クラッチ

260. Type of clutch 形式 Dry single plate  
261. No. of plates プレッシュャープレートの数 1  
262. Dia. of clutch plates プレッシュャープレートの外径 194 mm  
263. Dia. of linings, inside フェーシングの内径 132 mm  
264. Method of operating clutch 作動方式 Hydraulic

**GEAR BOX** (photograph H)  
トランスミッション

270. Manual type, make 手動式の製造会社名 Toyota Method of operation 作動方式 Mechanical  
271. No. of gear-box ratios forward 前進段数 4  
272. Synchronized forward ratios 1, 2, 3 & 4  
273. Location of gear-shift シフトレバーの位置 Floor  
274. Automatic, make 自動式の製造会社名 type 形式  
275. No. of forward ratios 前進段数  
276. Location of gear-shift シフトレバーの位置

| 277.            | Manual 手動     |                                      | Automatic 自動  |                 | Alternative manual / automatic 手動 / 自動 |                 |               |                 |
|-----------------|---------------|--------------------------------------|---------------|-----------------|--|-----------------|---------------|-----------------|
|                 | Ratio<br>ギヤー比 | No. teeth<br>歯数                      | Ratio<br>ギヤー比 | No. teeth<br>歯数 | Ratio<br>ギヤー比                          | No. teeth<br>歯数 | Ratio<br>ギヤー比 | No. teeth<br>歯数 |
| 1               | 3.58          | $\frac{33}{23} \times \frac{35}{14}$ |               |                 |  |                 |               |                 |
| 2               | 2.02          | $\frac{33}{23} \times \frac{31}{22}$ |               |                 |  |                 |               |                 |
| 3               | 1.38          | $\frac{33}{23} \times \frac{27}{28}$ |               |                 |  |                 |               |                 |
| 4               | 1.00          |                                      |               |                 |  |                 |               |                 |
| 5               |               |                                      |               |                 |  |                 |               |                 |
| 6               |               |                                      |               |                 |  |                 |               |                 |
| reverse<br>リバース | 3.48          | $\frac{33}{23} \times \frac{34}{14}$ |               |                 |  |                 |               |                 |

278. Overdrive, type オーバードライブ形式  
279. Forward gears on which overdrive can be selected オーバードライブの作動段数  
280. Overdrive ratio オーバードライブ比

**FINAL DRIVE**  
ファイナル

290. Type of final drive 形式 Hypoid gear  
291. Type of differential 差動機形式 Bevel gear  
292. Type of limited slip differential (if fitted) リミテッドスリップデフの形式  
293. Final drive ratio ギヤー比 4.100 4.300  
Number of teeth 歯数  $\frac{41}{10}$   $\frac{43}{10}$



**REBORING DIMENSION**

|                                 |      |                 |       |        |
|---------------------------------|------|-----------------|-------|--------|
| * Max Bore                      | 80.3 | mm              | 3.16  | inches |
| ** Max Capacity Per Cylinder    | 354  | cm <sup>3</sup> | 21.60 | cu. in |
| *** Max Total Cylinder Capacity | 1417 | cm <sup>3</sup> | 86.47 | cu. in |

**COMBUSTION CHAMBER**

|  |         |                 |      |        |
|--|---------|-----------------|------|--------|
| * Volume of one combustion chamber of cylinder head. | 68.9    | cm <sup>3</sup> | 4.21 | cu. in |
| ** Thickness of cylinder headgasket when compressed. | 1.0~1.2 | mm              |      |        |

Optional equipment affecting preceding information. This to be stated together with reference number.  
オプション:

**BRAKE**

| Disc brake on front               | Front                | Rear (Drum) |
|-----------------------------------|----------------------|-------------|
| 93. Number of cylinders per wheel | 2                    | 1           |
| 94. Bore of wheel cylinder(s)     | 50.8 mm              | 20.6 mm     |
| 100. Outside diameter             | 228 mm               |             |
| 101. Thickness of side            | 10 mm                |             |
| 102. Length of brake linings      | 97 mm                |             |
| 103. Width of brake linings       | 46 mm                |             |
| 104. Number of pads brake         | 2                    |             |
| 105. Total area per brake         | 8924 mm <sup>2</sup> |             |



Photo. F, Front brake disc with caliper(s)

**Caliper**

part No. 47710-12100 (RH)  
47720-12100 (LH)

**Disc**

Part No. 43512-20032



Make Toyota

Model TE30  
型式

J.A.F 公認番号 T-220

F.I.A. Rec. No.

Photograph

B. 3/4 view of car from rear 全体写真(斜め後方)



D. Front axle complete, removed from car. Without wheels.  
フロントサスペンション

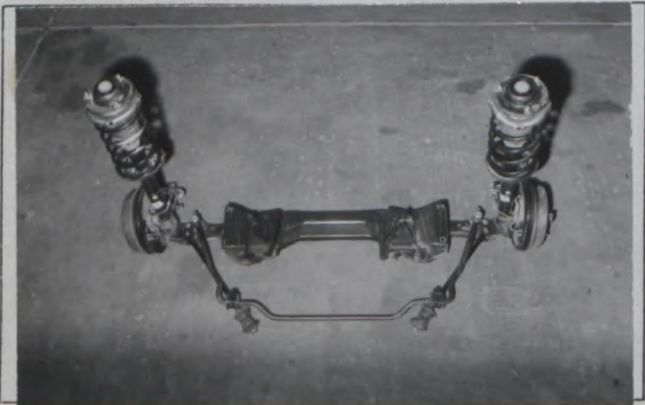

F. Front brake, drum removed  
フロントブレーキ



H. Gear-box, view from side トランスミッション



C. Interior view of car through driver's door (open) with dashboard  
写真  
運転席付近



E. Rear axle complete without wheels, removed from car.  
リヤサスペンション

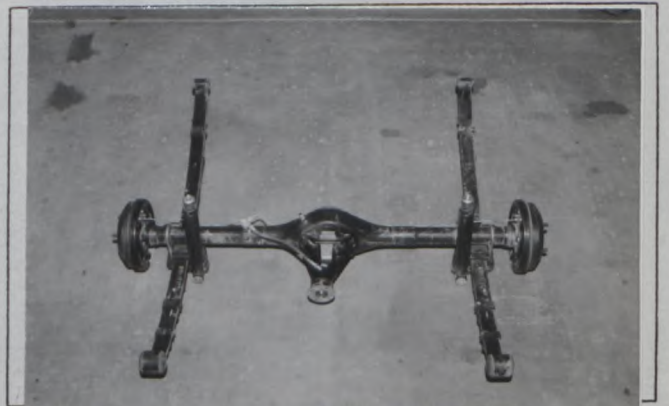

G. Rear brake, drum removed  
リヤブレーキ



I. Silencer + exhaust pipes after exhaust manifold. 排気系

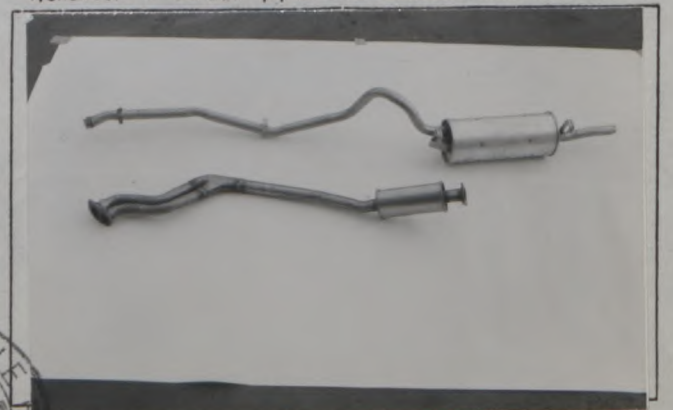

Make Toyota

Model TE30  
型式

J.A.F.公認番号 T-220

F.I.A. Rec. No.

Photograph

写真

J, Engine unit out of car, from right. With clutch and accessories but without air filter nor gear-box. エンジン右側面

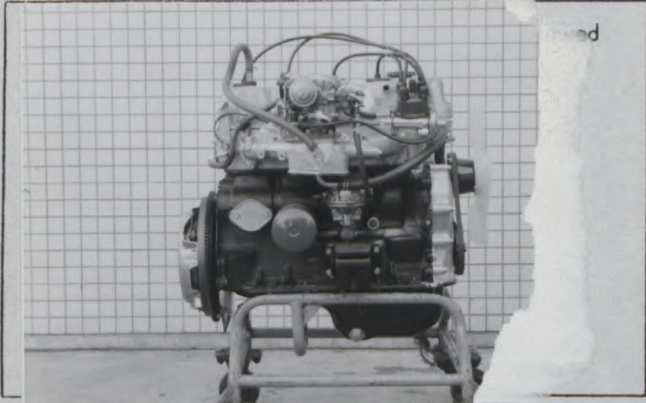

K, Engine unit out of car, from left. With clutch and accessories but without gear-box nor air filter. エンジン左側面

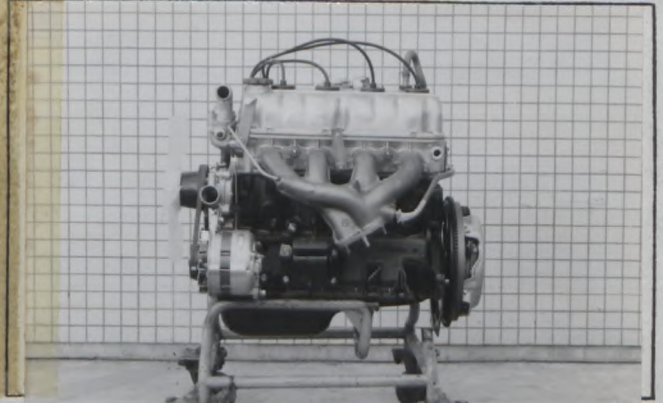

L, Combustion chamber 燃焼室 XXXXXXXXXXXXXXXXXXXX

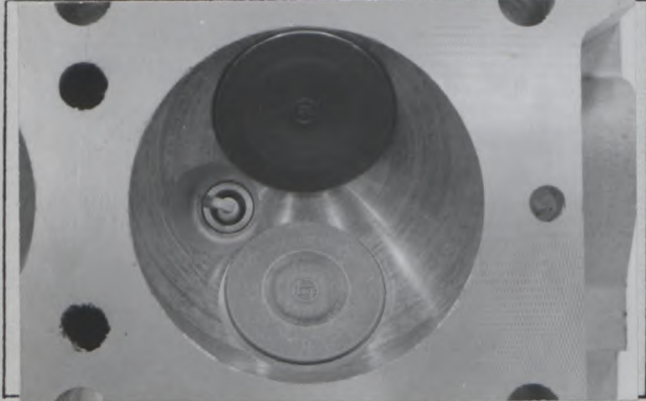

M, Piston crown ピストンクラウン XXXXXXXX



N, Carburettor (view from side of manifold) 気化器

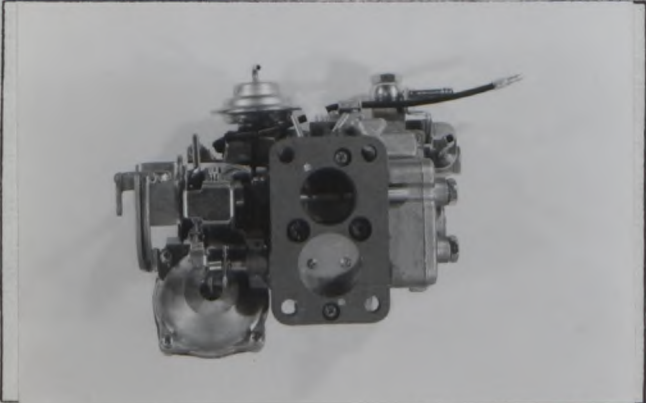

O, Engine in car with all accessories, bonnet open. エンジンルーム

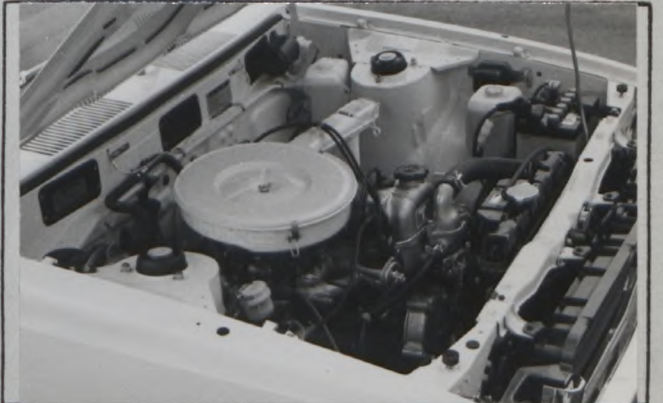

P, Inlet manifold 吸気マニホールド

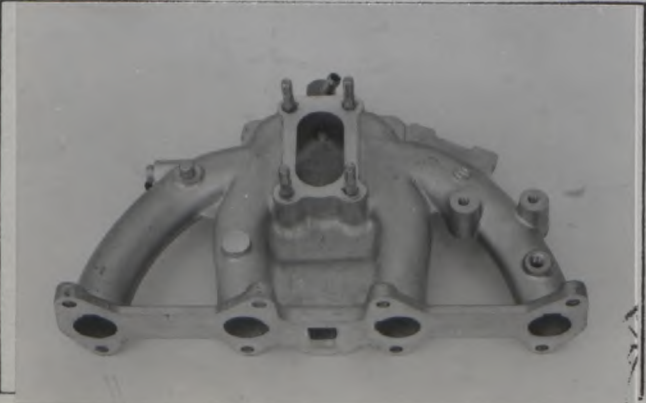

Q, Exhaust manifold 排気マニホールド

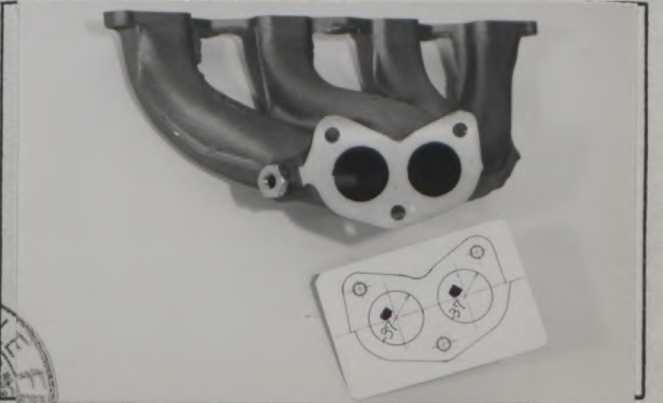

**DIMENSIONS OF INTERIOR**  
室内寸法  
(Conform to Art. 253 b of Appendix J)

For four seaters:  
4座席

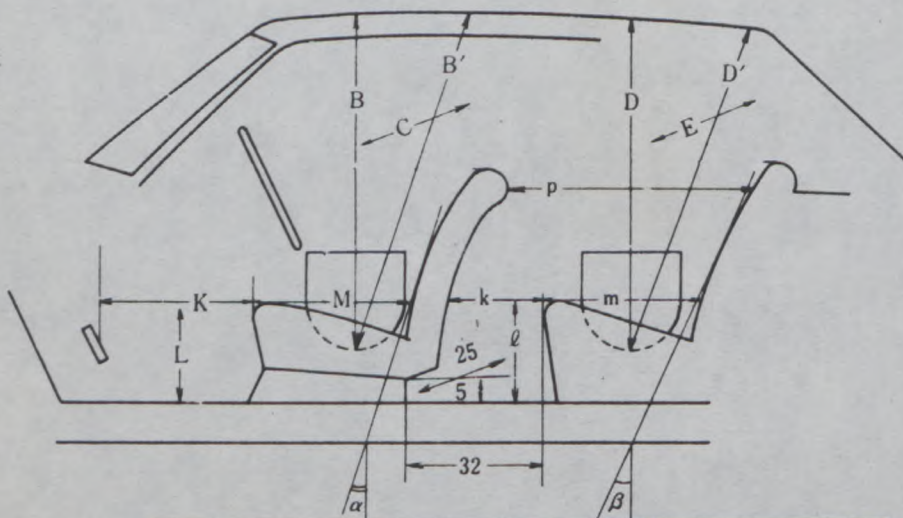

| Minimum Dimensions (cm) |       |          |       |      |      |         |       |
|-------------------------|-------|----------|-------|------|------|---------|-------|
| B                       | B'    | $\alpha$ | C     | D    | D'   | $\beta$ | E     |
| 97.0                    | 104.5 | 25°      | 131.5 | 96.5 | 97.0 | 24°     | 133.0 |

| Minimum Dimensions (cm) |        |              |      |                  |      |      |              |       |
|-------------------------|--------|--------------|------|------------------|------|------|--------------|-------|
| L                       | $\ell$ | M            | m    | k+m              | p    | k    | k+ $\ell$ +m | K+L+M |
| 28.0                    | 32.5   | 47.5         | 41.5 | 63.0             | 69.0 | 21.5 | 95.5         | 120   |
| 0.9L = 25.2             |        | 0.85M = 40.4 |      | 0.85(k+m) = 53.6 |      | (15) | (95)         | (120) |

For two seaters:  
2座席

| Minimum Dimensions |    |
|--------------------|----|
| B                  | C  |
| cm                 | cm |

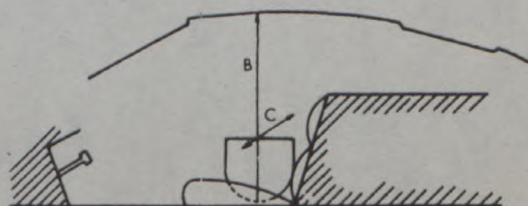

Make Toyota

Model TE30  
型式

F.I.A. Rec.No.

Optional equipment affecting preceding information.  
This to be stated together with reference number.

GEAR BOX

photograph H

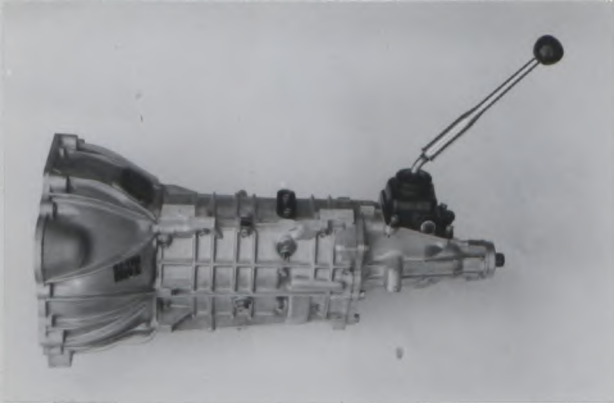

Part No. 33020-12030

271. No. of gear-box ratios forward 5
272. Synchronized forward ratios 1, 2, 3, 4, 5

| 277.    | Manual |                                      | Alternative manual |                                      |
|---------|--------|--------------------------------------|--------------------|--------------------------------------|
|         | Ratio  | No. teeth                            | Ratio              | No. teeth                            |
| 1       | 3.59   | $\frac{33}{23} \times \frac{35}{14}$ | 2.70               | $\frac{33}{23} \times \frac{32}{17}$ |
| 2       | 2.02   | $\frac{33}{23} \times \frac{31}{22}$ | 1.73               | $\frac{33}{23} \times \frac{29}{24}$ |
| 3       | 1.38   | $\frac{33}{23} \times \frac{27}{28}$ | 1.29               | $\frac{33}{23} \times \frac{26}{29}$ |
| 4       | 1.00   |                                      | 1.00               |                                      |
| 5       | 0.86   | $\frac{33}{23} \times \frac{21}{35}$ | 0.89               | $\frac{33}{23} \times \frac{21}{34}$ |
| 6       |        |                                      |                    |                                      |
| reverse | 3.48   | $\frac{33}{23} \times \frac{34}{14}$ |                    |                                      |

FINAL DRIVE

292. Type of limited slip differential (if fitted) Friction
293. Final drive ratio 4.30 4.63
- Number of teeth 43/10 37/8



Photograph

C, Interior view of car through driver's door (open with dashboard)



- Toyota Corolla 1400, TE30
- Toyota Corolla Hardtop  
1400, TE35
- Toyota Corolla 1600, TE31
- Toyota Corolla Hardtop  
1600, TE37
- Toyota Sprinter 1400, TE40
- Toyota Sprinter 1600, TE41



Toyota Corolla Levin, TE37





JAPAN AUTOMOBILE FEDERATION

社団法人 日本自動車連盟

J.A.F.公認番号 T-220V-1  
発効年月日 1974年12月31日  
F.I.A. Homol. No 5603

1/IV

FEDERATION INTERNATIONALE DE L'AUTOMOBILE

Form of recognition accordance with  
Appendix J to the International Sporting Code.

国際スポーツ法典付則J項及びJAF国内競技車両規則に従った公認書式

Make Toyota Moter Co.,Ltd. Model Toyota Corolla, TE30  
製造会社名 型式及び通称名  
Modification's application starts with serial No. chassis 適用シャーシー型式番号  
engine 適用エンジン型式番号 ) Re. following table  
Application of this amendment started the Apr. 1974  
適用年月日  
Commercial denomination after application of modifications Toyota Corolla Series.

The modifications are to be considered as: Variant / ~~XXXXXXXXXXXXXXXXXXXX~~  
変型 / ~~XXXX~~

Date amendment is valid from 1.8.75 List

Description of amendment 内容

Another type of coachwork can be selected for TE30 cars as  
maker's option.  
Serial No.of Chassis and Weight.

| Serial No. of Chassis | Type of body              | Engine capacity | Car weight       |
|-----------------------|---------------------------|-----------------|------------------|
| TE30 - 000001         | 4door Sedan               | 1400cc          | 855 kg           |
| TE31 - 000001         | 4door Sedan               | 1600cc          | 855 kg           |
| TE35 - 000001         | 2door Hardtop             | 1400cc          | 845 kg           |
| TE37 - 000001         | 2door Hardtop             | 1600cc          | 845 kg (*860 kg) |
| TE40 - 000001         | 4door Sedan<br>(Sprinter) | 1400cc          | 860 kg           |
| TE41 - 000001         | 4door Sedan<br>(Sprinter) | 1600cc          | 860 kg           |

\*1600 (D.O.H.C.) engine

Stamp and signature of the JAF

JAF公認印及び署名

難波靖治

Yasuharu Nanba



Stamp and signature of the I.A.





Make Toyota

Model TE30  
型式

J.A.F.公認番号 T-220V-1

F.I.A. Rec.No. 5603

1/1V

COACHWORK

1. 4Door SEDAN

Photo. A

3/4 view of car from front

Photo. B

3/4 view of car from rear



Weight 855 kg

1887 lbs



2. 2Door HARDTOP

Photo. A

3/4 view of car front

Photo, B

3/4 view of car from rear



Weight 845 kg

1865 lbs

\*860 kg

1898 lbs



\*1600 (D.O.H.C.) engine



Make Toyota

Model TE30  
型式

J.A.F公認番号) T-220V-1  
F.I.A.Rec.No. 5603

3 . 4 Door SEDAN (Sprinter)

1/1V

photo. A

photo. B

3/4 view of car from front

3/4 view of car from rear



Weight 860



kg 898

lbs.





JAPAN AUTOMOBILE FEDERATION

社団法人 日本自動車連盟

J.A.F.公認番号 T-220V-2

発効年月日

1974年12月31日

F. I. A. Homol. No

5603

2/W

FEDERATION INTERNATIONALE DE L'AUTOMOBILE

Form of recognition accordance with Appendix J to the International Sporting Code.

国際スポーツ法典付則J項及びJAF国内競技車両規則に従った公認書式。

Make Toyota Motor Co., Ltd. Model Toyota Corolla, TE30  
 製造会社名 型式及び通称名  
 Modification's application starts with serial No. chassis 適用シャーシー型式番号 TE31-000001, TE37-000001  
 engine 適用エンジン型式番号 2T TE41-000001  
 Application of this amendment started the Apr. 1974  
 適用年月日  
 Commercial denomination after application of modifications Toyota Corolla 1600 Series.  
 The modifications are to be considered as: Variant / ~~normal modification of the type~~  
 変型 / ~~通常の変型~~  
 Date amendment is valid from List

Description of amendment 内容

Another type of engine can be selected for TE30 cars as maker's option.  
Engine

136. Total cylinder capacity 1588 cc 96.91 cu.in.

Photo. J

Engine unit out of car, from right

Photo. K

Engine unit out of car, from left

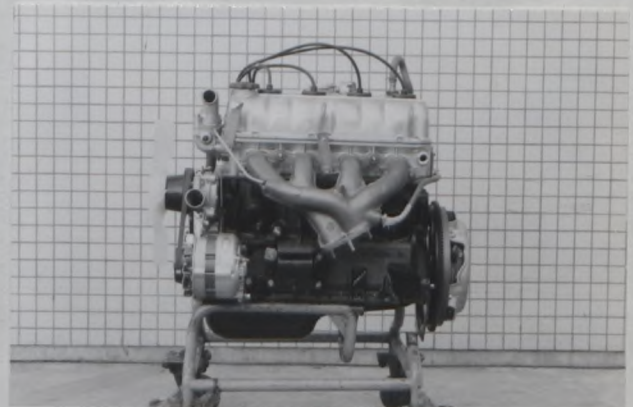
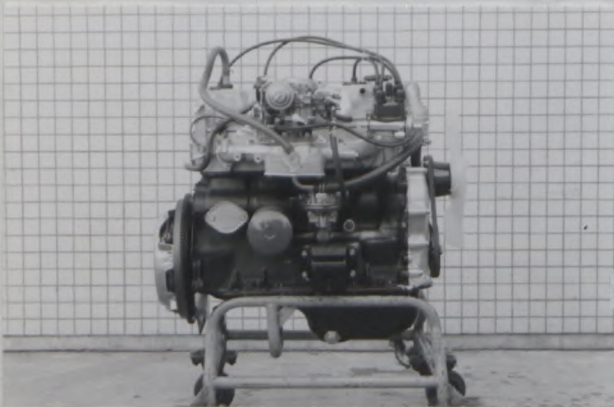

This engine is called type 2T.

The No. of chassis installed this engine include on and after  
TE31-000001 (2 Door & 4 Door Sedan model)  
TE37-000001 (2 Door Hardtop model)  
TE41-000001 (4 door Sedan Sprinter model)

Further detailed specifications different from the original engine are described on attached sheets.

Stamp and signature of the JAF

JAF公認印及び署名

難波靖治

Yasuharu Nanba



Stamp and signature of the F.I.A.



Make Toyota

Model TE30  
型式

J.A.F公認番号 T-220V-2

F.I.A.Rec.No. 5603

2/2

ENGINE (Photographs J & K)

|  |                      |              |
|--|----------------------|--------------|
| 133. <u>Bore</u>   | 85 mm                | 3.35 in.     |
| 135. <u>Capacity per cylinder</u>  | 397 cm <sup>3</sup>  | 24.23 cu.in. |
| 136. <u>Total cylinder-capacity</u>  | 1588 cm <sup>3</sup> | 96.91 cu.in. |
| 143. Volume of one combustion chamber  |                      |              |
| 146. Distance from gudgeon pin center line to highest point of piston crown. | 45 mm                |              |

CARBURETION (Photograph N )

|  |    |                                   |
|--|----|-----------------------------------|
| 213. Model                                     | 2T |                                   |
| 216. Minimum dimensions of mixtuer passage (s) |    | 23 <sup>ø</sup> & 27 <sup>ø</sup> |

ENGINE AND CAR PERFORMANCES (as declared by manufacturer in catalogue)

250. Max. engine output 100 PS (type of horse power : JIS )  
at 6000 rpm
251. Maximum rpm 6350 rpm output at that figure 98 PS (JIS)
252. Maximum torque 13.7 kg·m at 3800 rpm
253. Maximum speed of the car 160 km/hour

REBORING DIMENSION

|                                  |                      |              |
|----------------------------------|----------------------|--------------|
| * Max. Bore                      | 85.3 mm              | 3.36 in.     |
| ** Max. Capacity Per Cylinder    | 400 cm <sup>3</sup>  | 24.40 cu.in. |
| *** Max. Total Cylinder Capacity | 1600 cm <sup>3</sup> | 97.64 cu.in. |



2/2

Photograph

L, Combustion chamber

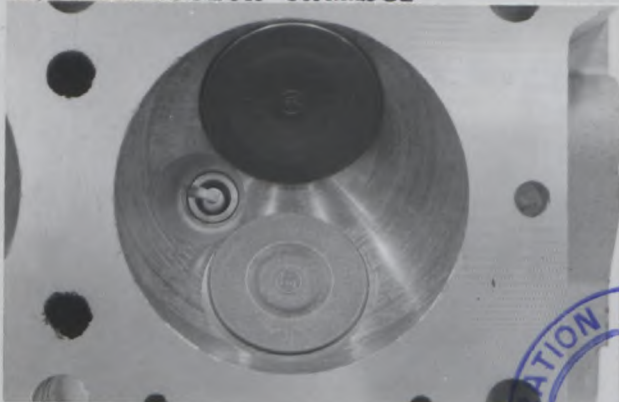

M, Piston crown



N, Carburettor  
(view from side of manifold)

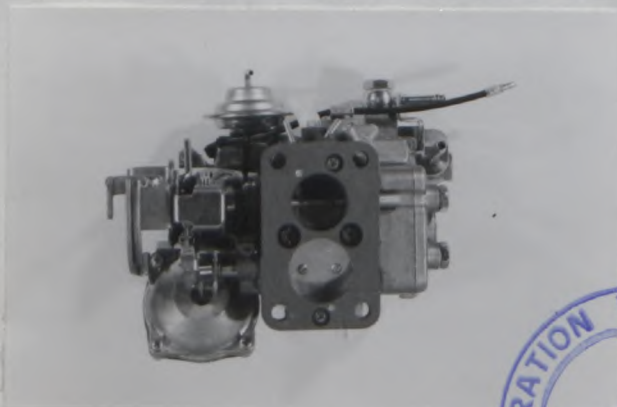

O, Engine in car with all accessories, bonnet open.

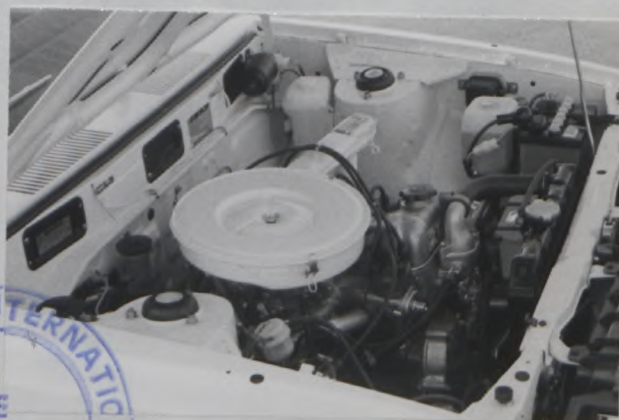



JAPAN AUTOMOBILE FEDERATION

社団法人 日本自動車連盟

J.A.F公認番号 T-220V-3  
発効年月日

1974年12月31日

F.I.A. Homol. No

5603

3/3V

FEDERATION INTERNATIONALE DE L'AUTOMOBILE

Form of recognition accordance with  
Appendix J to the International Sporting Code.

国際スポーツ法典付則J項及びJAF国内競技車両規則に従った公認書式。

Make Toyota Motor Co.,  
製造会社名  
Modification's application starts with serial  
Ltd.

Model Toyota Corolla, TE30  
型式及び通称名

No. chassis 適用シャーシー型式番号 TE37-000001  
engine 適用エンジン型式番号 2T

Application of this amendment started the  
適用年月日 Apr. 1974

Commercial denomination after application of modifications Toyota Corolla Levin, TE37

The modifications are to be considered as: Variant / ~~evolution of the type~~  
変型 / ~~型式改良~~

Date amendment is valid from 1. 8. 75 List

Description of amendment 内容

Another type of engine can be selected for TE30 cars as maker's option.

ENGINE

136. Total cylinder capacity 1588 cc 96.91 cu.in.

170. Number of camshafts 2

171. Location Cylinder-head

Photo. J

Photo. K

Engine unit out of car, from right

Engine unit out of car, left

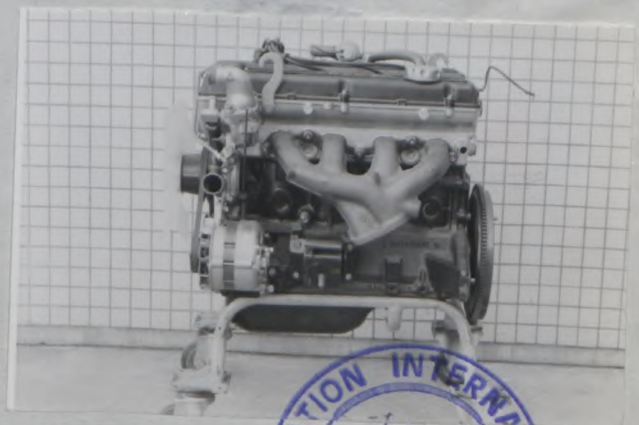
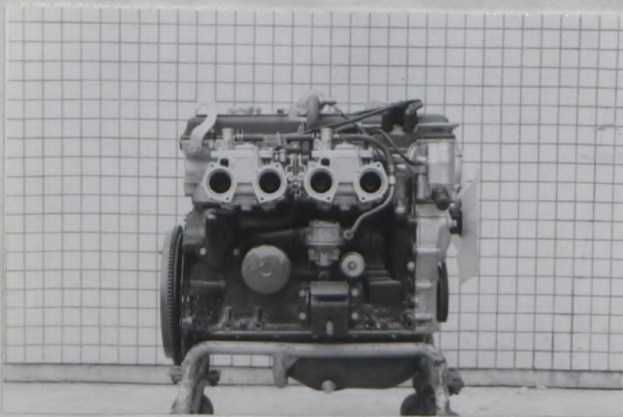

This engine is called type 2T-(G)  
Further detailed specifications different from the original engine  
are described on attached sheets.



Stamp and signature of the JAF

JAF公認印及び署名



難波靖治

Yasuharu Nanba

Stamp and signature of the F.I.A.

ENGINE (Photographs J & K )

|   |                      |              |
|---|----------------------|--------------|
| 133. <u>Bore</u>  | 85 mm                | 3.32 in.     |
| 135. <u>Capacity per cylinder</u>   | 397 cm <sup>3</sup>  | 24.23 cu.in. |
| 136. <u>Total Cylinder-capacity</u>   | 1588 cm <sup>3</sup> | 96.91 cu.in. |
| 142. Compression ratio  | 9.8                  |              |
| 143. Volum of one combustion chamber  | 45.1 cm              |              |
| 146. Distance from gudgeon pin center line to highest point of piston crown | 46 mm                |              |
| 152. Capacity lubricant   | 4.5 ltrs.            |              |
| 155. Capacity of cooling system   | 8.7 ltrs.            |              |

Weights

|                                |         |
|--------------------------------|---------|
| 164. Piston with rings and pin | 0.95 kg |
|--------------------------------|---------|

FOUR STROKE ENGINE

|                              |               |
|------------------------------|---------------|
| 170. Number of camshaft      | 2             |
| 171. Location                | Cylinder head |
| 173. Type of valve operation | Direct        |



INLET

|   |         |          |
|---|---------|----------|
| 181. <u>Diameter of valves</u>                                      | 45 mm   | 1.75 in. |
| 182. <u>Max. valve lift</u>   | 10 mm   | 0.40 in. |
| 186. Tappet clearance for checking timing (cold)                    | 0.29 mm |          |
| 187. Valves open at (with tolerance for tappet clearance indicated) | B.T.D.C | 33°      |
| 188. Valve close at (with tolerance for tappet clearance indicated) | A.T.D.C | 89°      |



EXHAUST

|  |         |          |
|--|---------|----------|
| 196. <u>Diameter of valves</u>                                       | 39 mm   | 1.52 in. |
| 197. <u>Max. valve lift</u>  | 10 mm   | 0.40 in. |
| 201. Tappet clearance for checking timing (cold)                     | 0.34 mm |          |
| 202. Valves open at (with tolerance for tappet clearance indicated)  | B.B.D.C | 71°      |
| 203. Valves close at (with tolerance for tappet clearance indicated) | A.T.D.C | 39°      |



CARBRETION (Photograph N )

|                             |            |
|-----------------------------|------------|
| 210. Number of carburettors | 2          |
| 211. Type                   | Side-draft |
| 212. Make                   | Mikuni     |



- 213. Model 2T-G
- 214. Number of mixture passages per carburettor 2
- 215. Flange hold diameter of exit port(s) of carburettor 40 mm
- 216. Minimum dimensions of mixture passage(s) 32° & 32°

ENGINE AND CAR PERFORMANCES (as declared by manufacture in catalogue)

- 250. Max. engine output 115 PS (type of horsepower:JIS) at 6400 rpm
- 251. Maximum rpm 6800 output at that figure 113 PS (JIS)
- 252. Maximum torque 14.5 kg·m at 5200 rpm
- 253. Maximum speed of the car 190 km/hour
- 255. Com profile

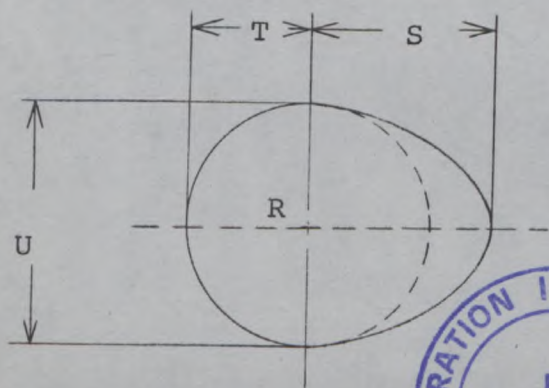

R= center of camshaft



Inlet cam.

|           |          |
|-----------|----------|
| S=28.4 mm | 1.12 in. |
| T=18.0 mm | 0.71 in. |
| U=36.2 mm | 1.43 in. |

Exhaust cam.

|           |          |
|-----------|----------|
| S=28.4 mm | 1.12 in. |
| T=18.0 mm | 0.71 in. |
| U=36.2 mm | 1.43 in. |



REBORING DIMENSION

|                                  |                      |              |
|----------------------------------|----------------------|--------------|
| * Max. Bore                      | 85.3 mm              | 3.36 in.     |
| ** Max. Capacity Per Cylinder    | 400 cm <sup>3</sup>  | 24.40 cu.in. |
| *** Max. Total Cylinder Capacity | 1600 cm <sup>3</sup> | 97.64 cu.in. |

COMBUSTION CHAMBER

- \* Volume of one combustion chamber of cylinder head. 63.5 cm<sup>3</sup> 3.87 cu.in.
- \*\* Thickness of cylinder headgasket when compressed. 1.0 mm



Make Toyota

Model TE30  
型式

J.A.F.公認 T-220V-3

F.I.A. Rec. No.

Drawing inlet manifold ports side of cylinder-head. Indicate scale or dimensions and manufacturing tolerance.

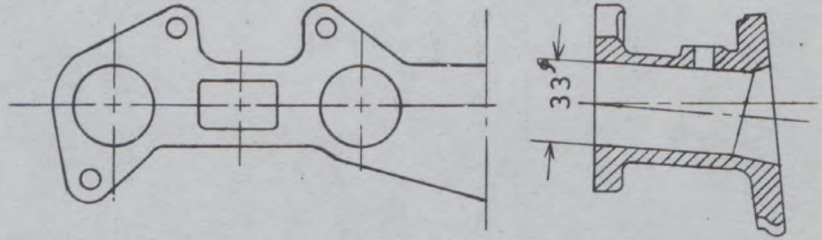

Drawing of entrance to inlet port of cylinder-head. Indicate scale or dimensions and manufacturing tolerance.

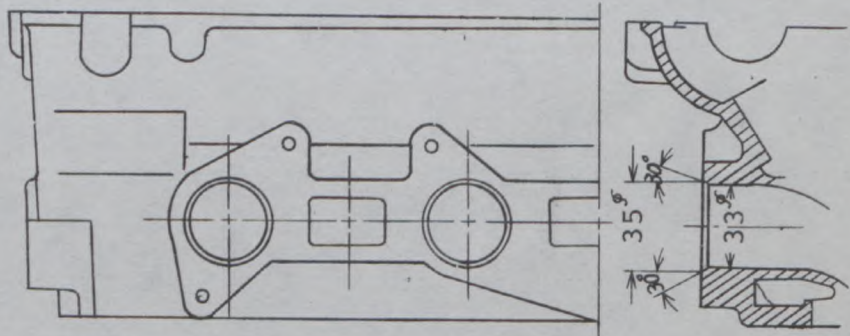

Unit : mm

Tolerance :



Photograph

L, Combution chamber

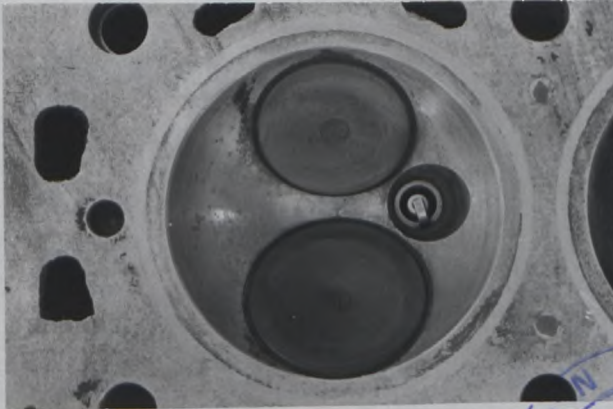

M, Piston crown



N, Carburettor  
(view from side of manifold)

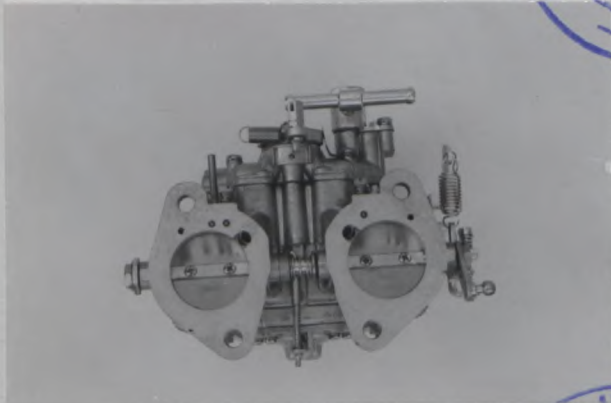

O, Engine in car with all accessories bonnet open.

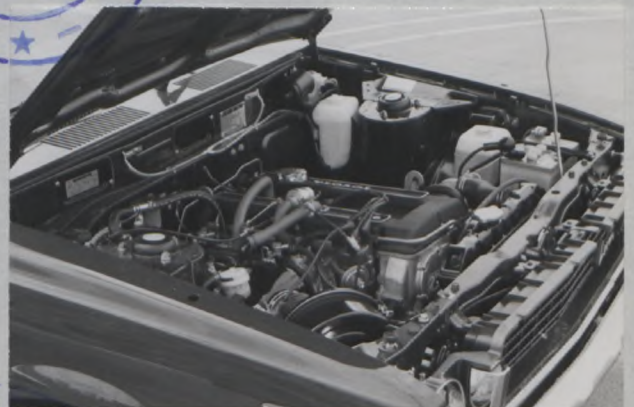

P, Inlet manifold

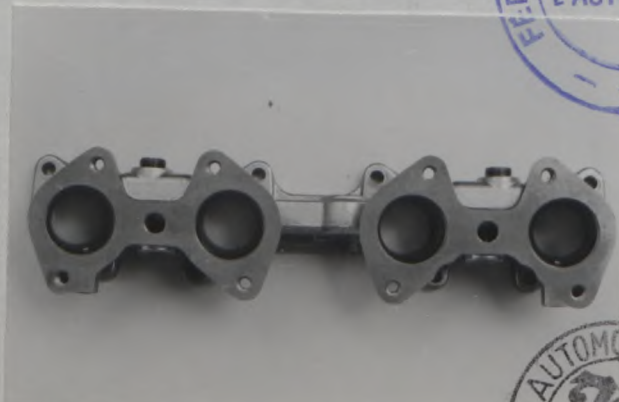

Q, Exhaust manifold



Make Toyota

Model TE30  
型式

J.A.F.公認番号 T-220V-3

F.I.A.Rec.No.

I, Silencer + exhaust pipes after  
exhaust manifold.





JAPAN AUTOMOBILE FEDERATION

社団法人 日本自動車連盟

J.A.F. 登録番号 T-220 V-5  
発給年月日 昭和51年4月30日  
F.I.A. Homol. No 5603

G/hv

FEDERATION INTERNATIONALE DE L'AUTOMOBILE

Form of recognition accordance with  
Appendix J to the International Sporting Code.

国際自動車連盟規約に準じて日本自動車連盟が発給する承認書式

**Make** Toyota Motor Co., Ltd. **Model** Toyota Corolla 1400, TE30  
 製造会社名 型式及通称名  
**Modification's application starts with serial** No. chassis 適用シャーシー型式番号 TE30  
 適用エンジン型式 T  
**Application of this amendment started the** 1st. Apr. 1974  
 適用年月日  
**Commercial denomination after application of modifications** Toyota Corolla TE30 Series  
 適用後商標名  
 The modifications are to be considered as: Variant / ~~Normal evolution of the type~~  
 0 / ~~1~~  
**Date amendment is valid from** 1 7 76 **List**

Description of amendment 内容

Following equipment can be selected for TE30 series car as maker's option.

- 1 - A DISC WHEEL
- 124) Material Pressed steel
- 125) Unitary weight (bare wheel) 7.5 Kg
- 126) Rim diameter 330 mm 13 inches
- 127) Rim width 114 mm 4.5 inches

Photo P: 4.5J wheel



"valable en Groupe 2 uniquement"  
"valid for Group 2 only"

(Part No. 42611 - 14100)

Stamp and signature of the JAF

JAF 承認印及署名

難波靖治

Yasuharu Nanba

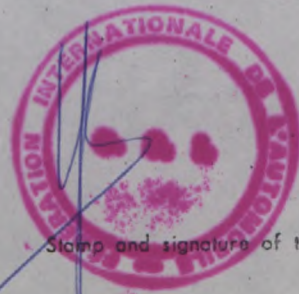

Stamp and signature of the F.I.A.

Make TOYOTA

Model TE30

1. - B DISC WHEEL

124) Material

Pressed steel

125) Unitary weight (bare wheel)

8.0 Kg

126) Rim diameter

330 mm 13 inches

127) Rim width

127 mm 5 inches

Photo P: 5J wheel



"valable en Groupe 2 uniquement"  
"valid for Group 2 only"

(Part No. 42611 - 12240)



VALID FOR GROUP 2 ONLY

REINFORCED FRONT LOWER ARM

Photo: Reinforced front lower arm



(Part No. 48068 - TE351 - A (RH)  
48069 - TE351 - A (LH))



会社名  
Make TOYOTA

型式  
Model TE30

FIA Rec. No. 5603

2 HEAVY DUTY FRONT LOWER ARM

Photo: Heavy duty front lower arm



(Part No. 48068 - TE301 (RH)  
48069 - TE301 (LH) )

3 HEAVY DUTY STRUT BAR

Photo: Heavy duty strut bar



(Part No. 48063 - TE301)

*"valable en Groupe 2 uniquement"*  
*"valid for Group 2 only"*

4 FINAL DRIVE

- 101) Type of final drive
- 102) Type of differential
- 103) Number of teeth
- 104) Ratio

Hypoid gear  
 Bevel gear  
37/8 , 39/8 , 41/8  
4.63 , 4.88 , 5.13





JAPAN AUTOMOBILE FEDERATION

社団法人 日本自動車連盟

J.A.F. 公認番号: T - 220 V-6  
発効年月日: 昭和51年7月31日  
F.I.A. Homol. No: 5603 515V

FEDERATION INTERNATIONALE DE L'AUTOMOBILE

Form of recognition accordance with Appendix J to the International Sporting Code.

国際スポーツ法典付則J項及びJAF国内競技車両規則に従った公認書式。

**Make** Toyota Motor Co., Ltd. **Model** Toyota Corolla, TE30  
製造会社名 型式及び通称名  
**Modification's application starts with serial** **No. chassis** 適用シャーシ型式番号 TE30  
適用年月日 適用エンジン型式 T, 2T  
**Application of this amendment started the** 1st. July 1976  
適用年月日  
**Commercial denomination after application of modifications** Toyota Corolla TE30 series, TE31, TE35, TE37, TE40, TE41  
変型 / normally reduction of the max 変型 / XXXXX  
**The modifications are to be considered as:** Variant / normally reduction of the max 変型 / XXXXX  
**Date amendment is valid from** -1. OCT. 1976 **List**

Description of amendment 内容

VALID FOR GROUP 2 ONLY

Following equipment can be selected for TE30 series car as maker's option.

LIMITED SLIP DIFFERENTIAL

220) Type of limited slip

Friction

Photo: Limited slip differential



valable en Groupe 2 uniquement  
"valid for Group 2 only"

(Part No. 41301 - 14010)

Stamp and signature of the JAF

JAF公認印及び署名

難波靖彦

Yasuharu Nanba

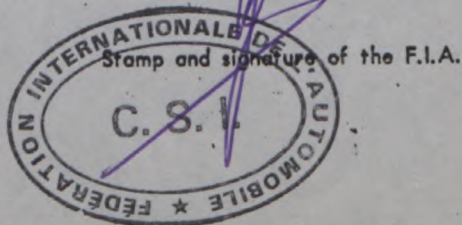

会社名  
Make TOYOTA

型式  
Model TE30

FIA Rec. No. 5603

VALID FOR GROUP 2 ONLY

BRAKE (Disc brake on front)

|                                  |                      |
|----------------------------------|----------------------|
| 53) Number of cylinder per wheel | 2                    |
| 54) Bore of cylinder(s)          | 52.4 mm              |
| 58) Width of brake lining        | 53 mm                |
| 59) Number of pads per brake     | 2                    |
| 60) Total area per brake         | 7700 mm <sup>2</sup> |

Photo F: Front brake , disc & caliper



(Part No. 47710 - 05860 (RH)  
47720 - 05860 (LH) )

BRAKE (Drum brake on rear)

|                      |                   |
|----------------------|-------------------|
| 54) Bore of cylinder | 20.6 mm & 22.2 mm |
|----------------------|-------------------|

*"valable en Groupe 2 uniquement"*  
*"valid for Group 2 only"*







JAPAN AUTOMOBILE FEDERATION

社団 日本自動車連盟  
法人

J.A.F公認番号 T-220V-7  
発効年月日 昭和52年4月30日

F.I.A. Homol. No 5603 6/6V

FEDERATION INTERNATIONALE DE L'AUTOMOBILE

Form of recognition accordance with  
Appendix J to the International Sporting Code.

国際スポーツ法典付則J項及びJAF国内競技車両規則に従った公認書式。

Make Toyota Motor Co., Ltd. Model Toyota Corolla, TE30  
 製造会社名 型式及び通称名  
 Modification's application starts with serial No. chassis 適用シャーシー型式番号 TE30  
 engine 適用エンジン型式 T, 2T  
 Application of this amendment started the 1st. Sep. 1975  
 適用年月日  
 Commercial denomination after application of modifications Toyota Corolla TE30 series, TE31, TE35, TE37  
 TE40, TE41  
 The modifications are to be considered as: Variant / ~~XXXXXXXXXXXXXXXXXXXX~~  
 変型 / ~~XXXXXXXX~~  
 Date amendment is valid from 1.7.77 List

Description of amendment 内容

OPTIONAL

BRAKE (Disc brake on front)

- 53) Number of cylinder per wheel 1
- 54) Bore 50.8 mm
- 58) Width of brake lining 50 mm
- 59) Number of pads per brake 2
- 60) Total area per brake 10600 mm<sup>2</sup>

Photo F : Front disc brake & caliper

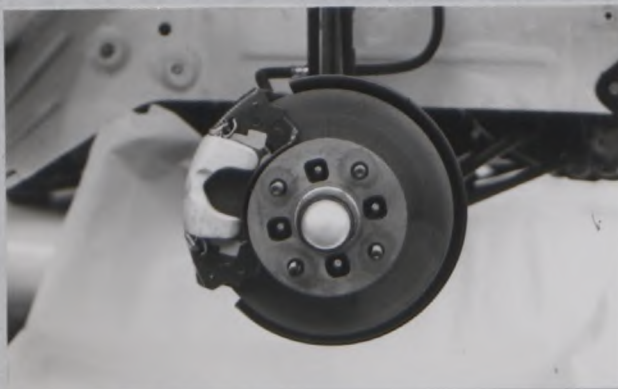

Caliper  
(Part No, 47710 - 14050 (RH)  
47720 - 14050 (LH))

FINAL DRIVE

- 221) Number of teeth
- 222) Ratio

39/8  
4.88

Stamp and signature of the JAF

Stamp and signature of the F.I.A.

JAF公認印及び署名

難波靖治

Yasuharu Nanba



*(Signature)*



JAPAN AUTOMOBILE FEDERATION

社団法人 日本自動車連盟

J.A.F. 公認番号 T-220V-8

発効年月日 昭和52年4月30日

F.I.A. Homol. No 5603 717V

FEDERATION INTERNATIONALE DE L'AUTOMOBILE

Form of recognition accordance with Appendix J to the International Sporting Code.

国際スポーツ法典付則J項及びJAF国内競技車両規則に従った公認書式。

**Make** Toyota Motor Co., Ltd. **Model** Toyota Corolla, TE30  
 製造会社名 型式及び通称名  
**Modification's application starts with serial No.** chassis 適用シャーシ型式番号 TE30  
 適用エンジン型式 T, 2T  
**Application of this amendment started the** 1st. Sep. 1975  
 適用年月日  
**Commercial denomination after application of modifications** Toyota Corolla TE30 series, TE31, TE35, TE37  
 TE40, TE41  
**The modifications are to be considered as:** Variant / ~~normally produced by the maker~~  
 変型 / ~~通常製造~~  
**Date amendment is valid from** 1.7.77 List

Description of amendment 内容

VALID FOR GROUP 2 ONLY

OPTIONAL

GEAR BOX  
96)

|      | Alternative manual |   |
|------|--------------------|---|
|      | Ratio              | Number of teeth   |
| 1    | 2.34               | $\frac{33}{23} \times \frac{31}{19}$                      |
| 2    | 1.61               | $\frac{33}{23} \times \frac{28}{25}$                      |
| 3    | 1.20               | $\frac{33}{23} \times \frac{25}{30}$                      |
| 4    | 1.00               |   |
| 5    | 0.93               | $\frac{33}{23} \times \frac{22}{34}$                      |
| Rev. | 3.48               | $\frac{33}{23} \times \frac{21}{14} \times \frac{34}{21}$ |

"valable en Groupe 2 uniquement"  
"valid for Group 2 only"



Stamp and signature of the JAF

JAF公認印及び署名

難波靖治

Yasuharu Nanba



Stamp and signature of the F.I.A.

[Signature]

会社名  
Make TOYOTA

型式  
Model TE30

FIA Rec. No. 5603 7/7V

FINAL DRIVE

- 221) Number of teeth 41/8
- 222) Ratio 5.13

REAR SPOILER

Photo : Rear spoiler



(Part No, 64005 - TE301)

BRAKE (Disc brake on front, ventilated disc)

- 53) Number of cylinders per brake 2
- 54) Bore 50.8 mm,
- 58) Width of brake lining 53 mm
- 59) Number of pads per brake 2
- 60) Total area per brake 7700 mm<sup>2</sup>
- Out side diameter 266 mm
- Thickness of disc 20 mm

Photo F : Front disc brake & caliper



**"valable en Groupe 2 uniquement"**  
**"valid for Group 2 only"**

- Caliper
- Part No, 47710 - 08050 (RH)
- 47720 - 08050 (LH)
- Disc
- Part No, 43512 - 08050 (RH)
- 43522 - 08050 (LH)



会社名  
Make TOYOTA

型式  
Model TE30

FIA Rec. No. 5603 717V

WHEEL SPACER  
Photo : Wheel spacer

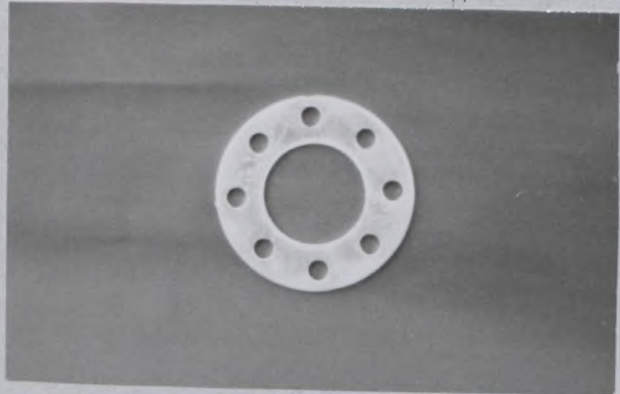

(Part No, 42248 - SPO01)  
thickness : 6 mm

*"valable en Groupe 2 uniquement"*  
*"valid for Group 2 only"*





JAPAN AUTOMOBILE FEDERATION

社団法人 日本自動車連盟

J.A.F. 登録番号 T-220E-9

昭和52年7月31日

F.I.A. Homol. No 5603

8/AE

FEDERATION INTERNATIONALE DE L'AUTOMOBILE

Form of recognition accordance with Appendix J to the International Sporting Code.

国際自動車連盟規約第J条に準じて承認される型式

Make Toyota Motor Co., Ltd. Model Toyota Corolla, TE30

Modification's application starts with serial No. chassis 適用シャーシー型式番号 TE30 engine 適用エンジン型式 T, 2T

Application of this amendment started the 1 Dec. 1976

Commercial denomination after application of modifications Toyota Corolla, TE31-, TE37-, TE41-

The modifications are to be considered as: ~~XXXXXX~~ normal evolution of the type ~~修正進化~~

Date amendment is valid from -1.0C1.1977 List

Description of amendment: Following items are changed.

DASHBOARD

Photo C: Driver's seat and dashboard steering-wheel removed (TYPE 1) (TYPE 2)



WHEELS

[Number of] [Number of] new form old form

125) 51) Unitary weight

6.5 kg

126) 53) Rim diameter

330 mm, 13 inches

127) 54) Rim Width

114 mm 4.5 inches

Stamp and signature of the JAF

JAF 登録番号

難波靖治

Yasuharu Nanba



Stamp and signature of the F.I.A.

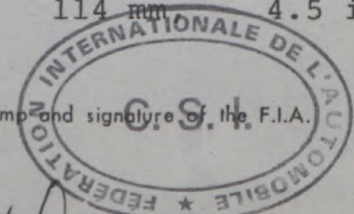

Signature of the F.I.A. official

ENGINE ( 2T ENGINE, 1600cc Single Carb. )

8/1E

[Number of new form] [Number of old form]

|             |       |                                      |         |             |
|-------------|-------|--------------------------------------|---------|-------------|
| 139 )       | 142 ) | Compression ratio                    | 9.0     |             |
| 145 )       | 152 ) | Capacity, lubricant                  | 4.2     | ltrs        |
| 147 )       | 155 ) | Capacity of cooling system           | 8.0     | ltrs        |
| 151 )       | 160 ) | Weight of flywheel ( clean )         | 8.5     | kg          |
| 152 )       | ---   | Weight of flywheel with starter ring | 9.4     | kg          |
| 153 )       | 161 ) | Weight of flywheel with clutch       | 14.4    | kg          |
| 154 )       | 162 ) | Weight of crankshaft                 | 11.7    | kg          |
| 155 )       | 163 ) | weight of con-rod                    | 0.56    | kg          |
| 156 )       | 164 ) | Weight of piston with rings and pin  | 0.58    | kg          |
| INLET       |       |                                      |         |             |
| 162 )       | 182 ) | Maximum valve lift                   | 8.7 mm, | 0.34 inches |
| EXHAUST     |       |                                      |         |             |
| 172 )       | 197 ) | Maximum valve lift                   | 8.7 mm, | 0.34 inches |
| CARBURATION |       |                                      |         |             |
| 186 )       | 216 ) | Minimum diameter of venturi          | 22 x 26 | mm          |

ENGINE ( 2T-G ENGINE, 1600cc DOHC Solex twin Carb. )

|       |       |                                     |      |      |
|-------|-------|-------------------------------------|------|------|
| 145 ) | 152 ) | Capacity, lubricant                 | 3.8  | ltrs |
| 156 ) | 164 ) | Weight of piston with rings and pin | 0.59 | kg   |

Photo M : View of the engine, left profile with all accessories

(2T ENGINE)

(2T-G ENGINE)

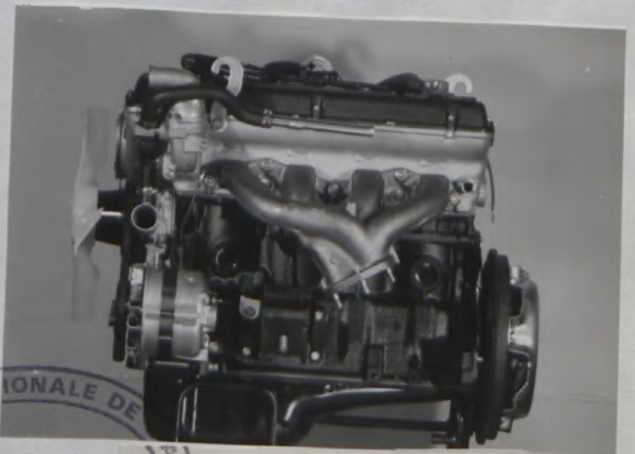
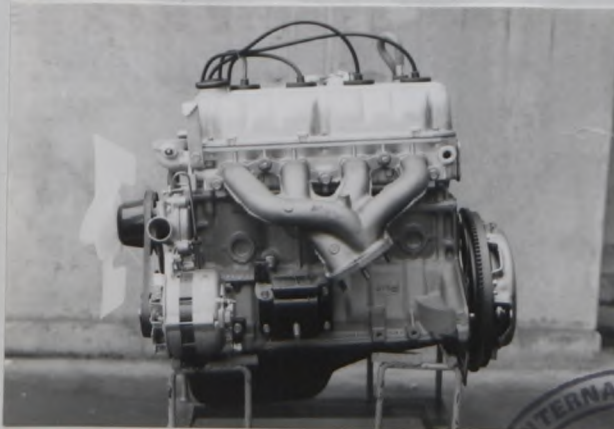
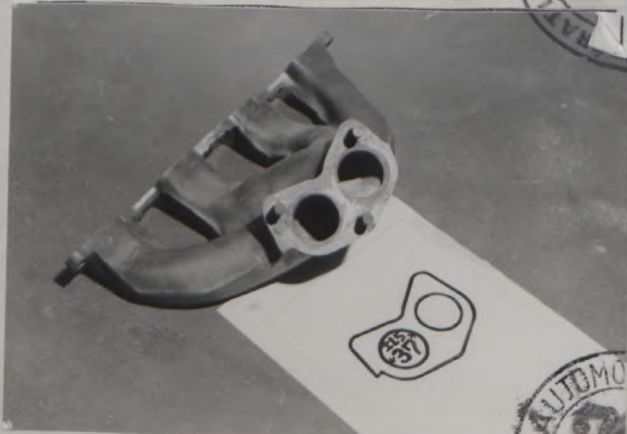

Photo V : Exhaust manifold C. S. I. Photo P : Bare wheel



Make

TOYOTA

Model  
型式

TE30

J.A.F.公認番号 T-220E-9

F.I.A. Rec.No.5603

Additional items and photos due to change of recognition forms are as follows. 81E

MOTOR (2T ENGINE & 2T-G ENGINE )

- |                                      |                      |
|--------------------------------------|----------------------|
| 11 ) Location and position of engine | Front (Longitudinal) |
| 13 ) Drive wheels                    | Rear                 |
| 14 ) Location of gear-box            | Attached to Engine   |

ENGINE (2T ENGINE & 2T-G ENGINE )

- |  |  |
|--|--|
| 69 ) Maximum cylinder capacity allowed       | 1600 cm <sup>3</sup> , 97.63 inches <sup>3</sup> |
| 74 ) Maximum diameter of the-big end journal | 58.0 mm  |
| 77 ) Material of flywheel                    | Cast-iron  |
| 79 ) Material of Connecting rod              | Stamped, Steel                                   |
| 81 ) Number of oil pumps                     | 1  |

Photo I: View of the engine, right side, without accessories, without manifolds intake nor fan  
(2T ENGINE) (2T-G ENGINE)

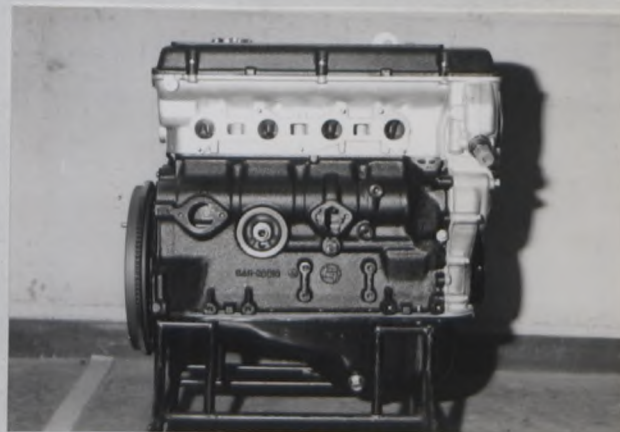
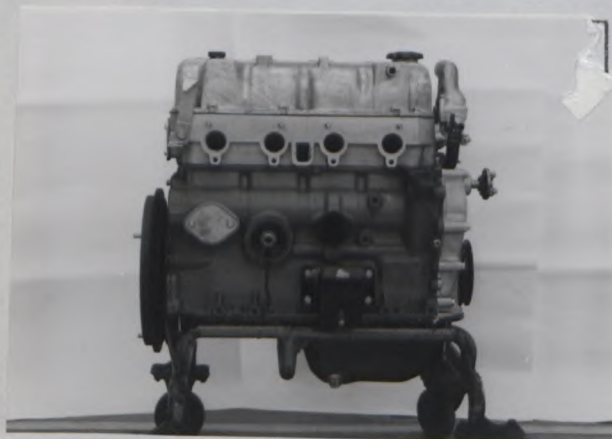
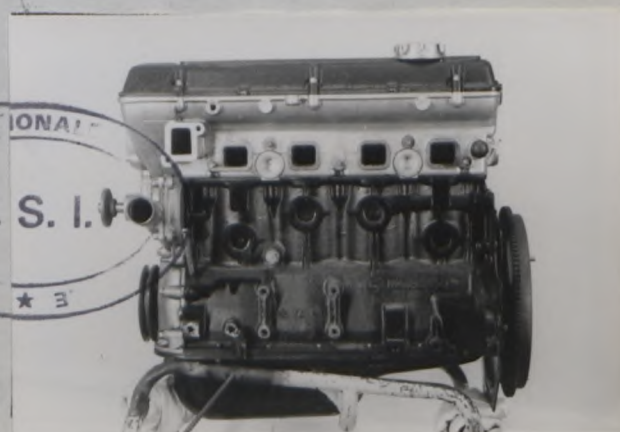
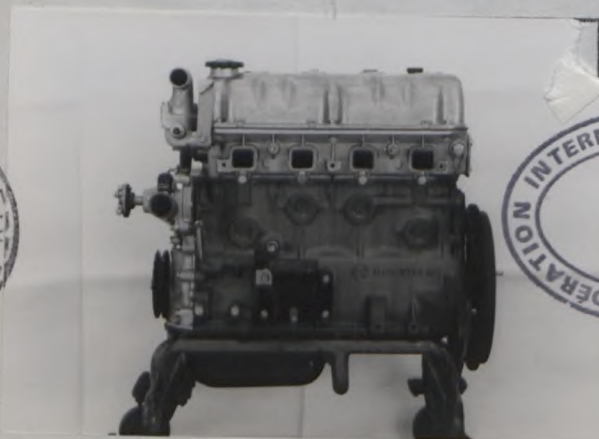

Photo J: View of the engine, left side, without accessories, without manifolds intake nor fan  
(2T ENGINE) (2T-G ENGINE)



CAPACITIES AND DIMENSIONS

- |                        |                                    |
|------------------------|------------------------------------|
| 112 ) Ground clearance | 155 or 160 cm<br>6.1 or 6.3 inches |
|------------------------|------------------------------------|

ENGINE (2T ENGINE & 2T-G ENGINE )

- |  |    |
|--|----|
| 136 ) Sleeves                            | No |
| 137 ) Number of inlet ports per cylinder | 1  |

Make TOYOTA

Model TE30  
71A

J.A.F.公認 T-220 F-9

F.I.A. Rec.No. 5603

138 ) Number of exhaust ports per cylinder 8/1E  
 140b) Volume of combustion chamber in head 1  
 141 ) Thickness of head gasket inter tightened 68.9 cm<sup>3</sup>  
1.20 mm

WHEEL DRIVE

213 ) Number of discs 1

Photo Q; Front seat



Weight of front seat 14 kgx2

Photo R: Location of spare wheel

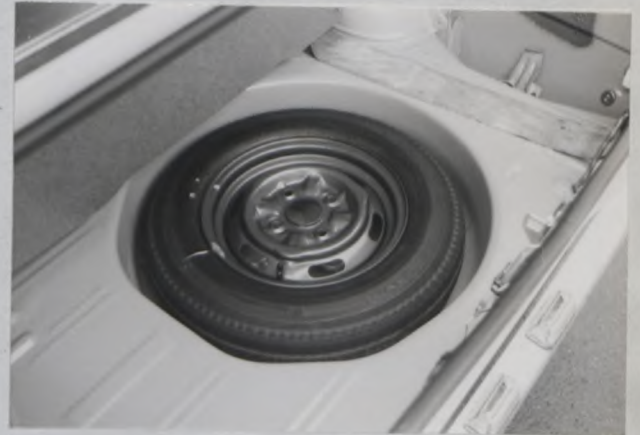
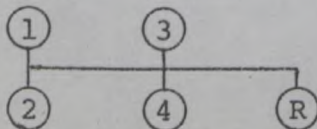

Photo W : Clutch



GEAR CHANGE GATE

4 speed manual transmission



5speed manual transmission

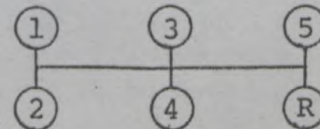





JAPAN AUTOMOBILE FEDERATION

社団法人 日本自動車連盟

J.A.F. 登録番号 T-220 E-10  
登録年月日 昭和52年7月31日  
F.I.A. Homol. No 5603

9/2E

FEDERATION INTERNATIONALE DE L'AUTOMOBILE

Form of recognition accordance with  
Appendix J to the International Sporting Code.  
国際自動車連盟 (F.I.A.) の国際競技規則 (ISCR) の付録 J に従って

Make Toyota Motor Co., Ltd. Model Toyota Corolla, TE30  
Modification's application starts with serial No. chassis 適用シャーシー型式番号 TE30  
engine 適用エンジン型式 T, 2T  
Application of this amendment started the 1 Apr. 1974  
Commercial denomination after application of modifications Toyota Corolla, TE31-, TE37-, TE41-  
The modifications are to be considered as: ~~XXXXXX~~ / normal evolution of the type  
~~XX~~ 正常進化  
Date amendment is valid from -1.OCT.1977 List

Description of amendment

Revision of error (2T ENGINE, 1600cc Single Carb.)

[Number of new form] [Number of old form]

205) 255) Camshaft

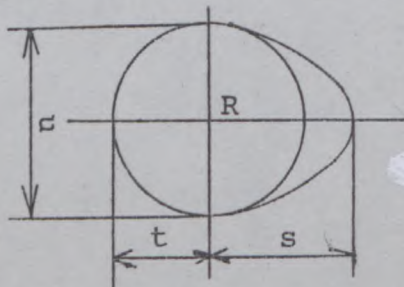

EXHAUST CAM

t= 15.9 mm, 0.63 inches

u= 31.9 mm, 1.26 inches

Stamp and signature of the JAF

JAF 印 20788

難波靖治

Yasuharu Nanba



Stamp and signature of the F.I.A.





JAPAN AUTOMOBILE FEDERATION

社団法人 日本自動車連盟

J.A.F. 公認番号 T-220V-11  
発効年月日 昭和52年9月30日  
F.I.A. Homol. No 5603 10/8V

FEDERATION INTERNATIONALE DE L'AUTOMOBILE

Form of recognition accordance with Appendix J to the International Sporting Code.

国際スポーツ法典付則J項及びJAF国内競技車両規則に従った公認書式。

Make Toyota Motor Co., Ltd. Model Toyota Corolla, TE30  
 製造会社名 型式及び通称名  
 Modification's application starts with serial No. chassis 通用シャーシ型式番号 TE30  
 engine 通用エンジン型式 2T  
 Application of this amendment started the 1st. Aug. 1977  
 適用年月日  
 Commercial denomination after application of modifications Toyota Corolla TE30 series, TE31, TE35, TE3  
 TE40, TE41  
 The modifications are to be considered as: Variant / normal evolution of the type  
 変型 / 正常進化  
 Date amendment is valid from 1.10.77 List

VALID FOR GROUP 2 ONLY

OPTIONAL EQUIPMENT

ENGINE

80) Lubrication system : Dry sump  
Photo : oil dry sump system

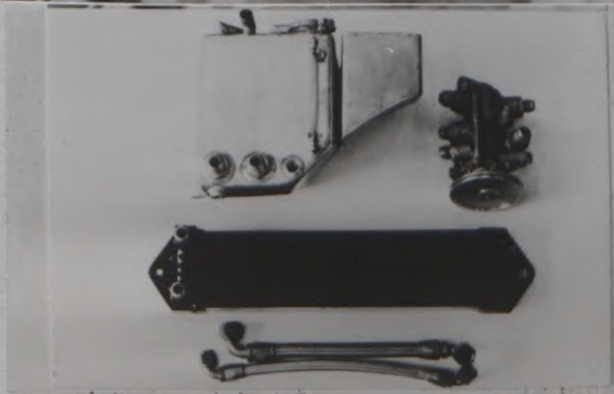

- Pump assy oil  
Part No, 15100 - 26010
- Cooler assy oil  
Part No, 15710 - TA001
- Tank assy oil  
Part No, 15750 - 26010
- Flexible hose  
Part No, 27009 - 2H004  
27009 - 2H005



Stamp and signature of the JAF

JAF公認印及び署名

難波靖治

Yasuharu Nanba



Stamp and signature of the F.I.A.