



F.I.A. Recognition No. 5542

Group 1

# ROYAL AUTOMOBILE CLUB

31, Belgrave Square, London, S.W.1

Form of recognition in accordance with appendix J to the International Sporting Code of the  
FEDERATION INTERNATIONALE DE L'AUTOMOBILE

Manufacturer Triumph Motors British Leyland (UK) Ltd Cylinder-capacity 1998 cm.<sup>3</sup> 122 in.<sup>3</sup>  
 Serial No. of chassis/body VAL DL or LDL Model Dolomite Sprint  
 Serial No. of engine VAL HE or LE Manufacturer Triumph  
 Recognition is valid from 1.1.74 Manufacturer Triumph  
 The manufacturing of the model described in this recognition form started on 1st January 1973  
 and the minimum production of 5000 List  
 identical cars, in accordance with the specifications of  
 this form was reached on 19

Photograph A. 1/4 view of car from front



F.I.A. Stamp  
*[Handwritten signature]*

R.A.C. Stamp

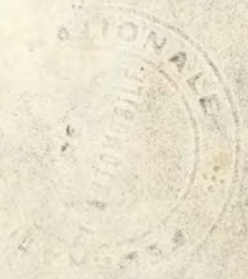



B



C



D

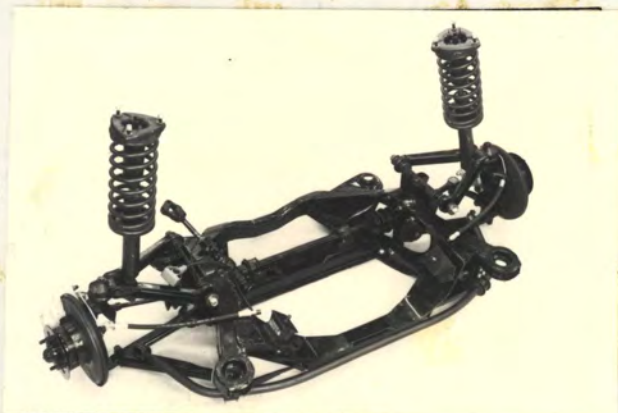

E

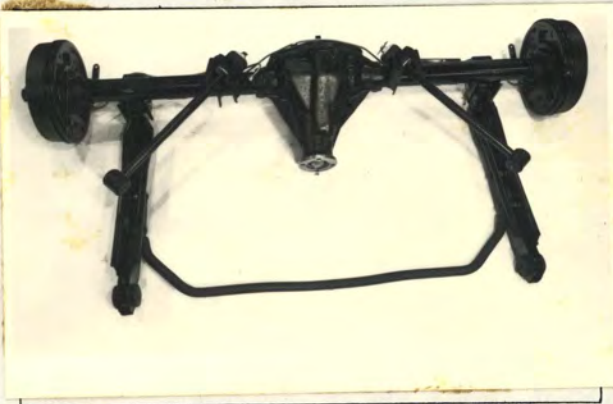

F



G

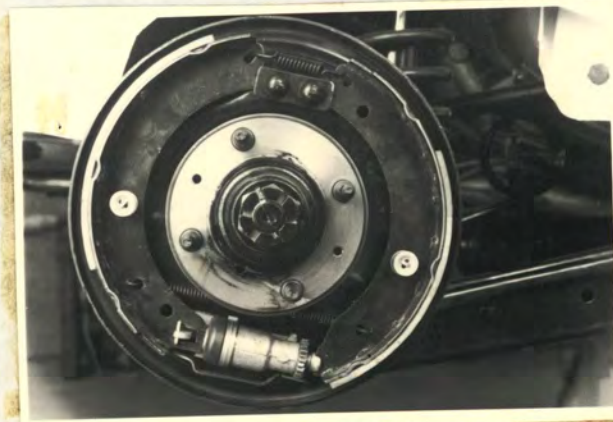

H



I

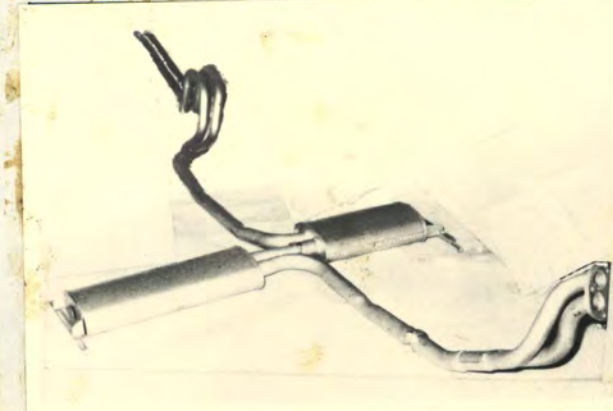



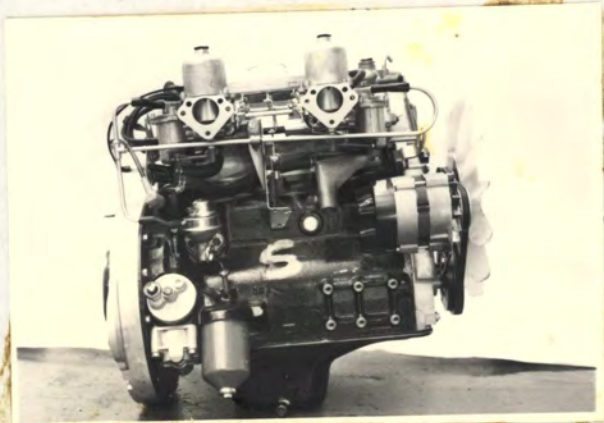

J



K

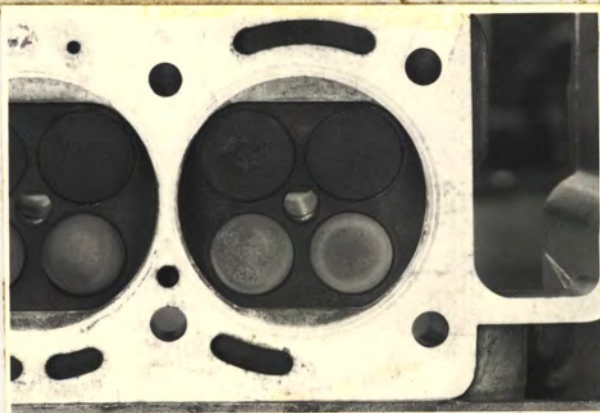

L



M

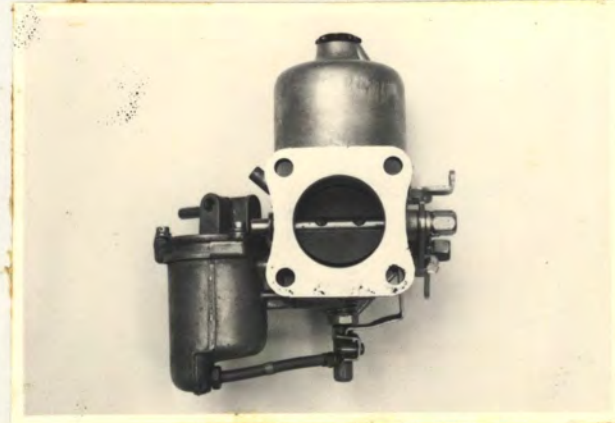

N

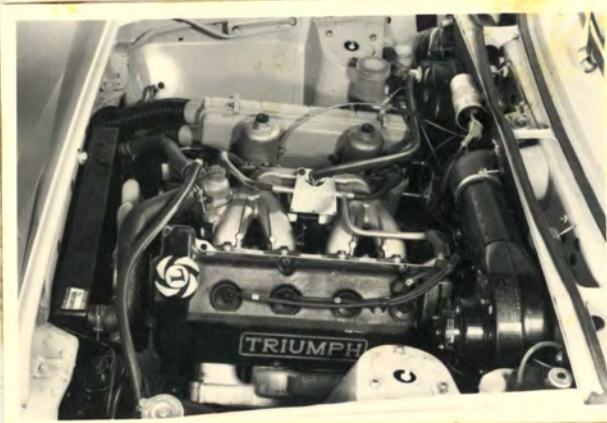

O

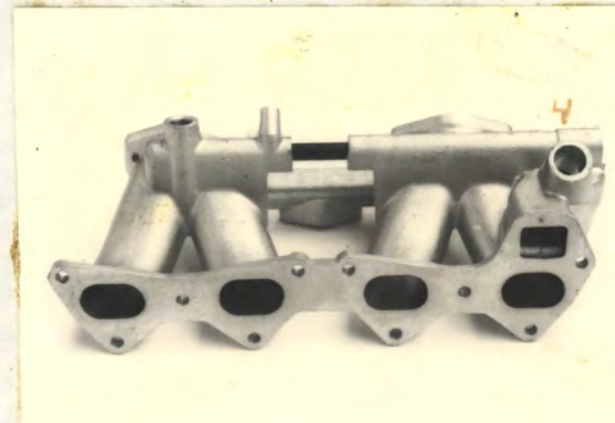

P

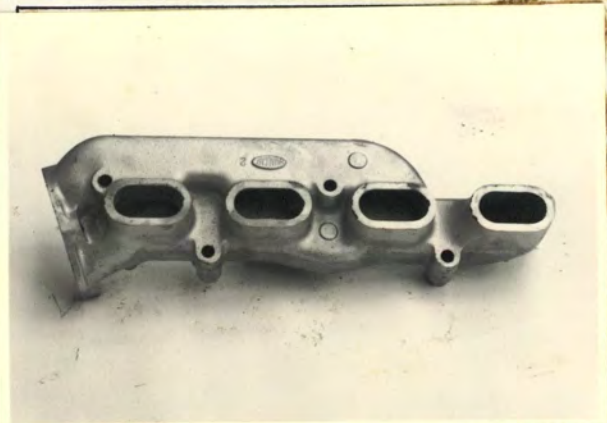

Q



Drawing inlet manifold ports, side of cylinderhead. Indicate scale or dimensions and manufacturing tolerance.

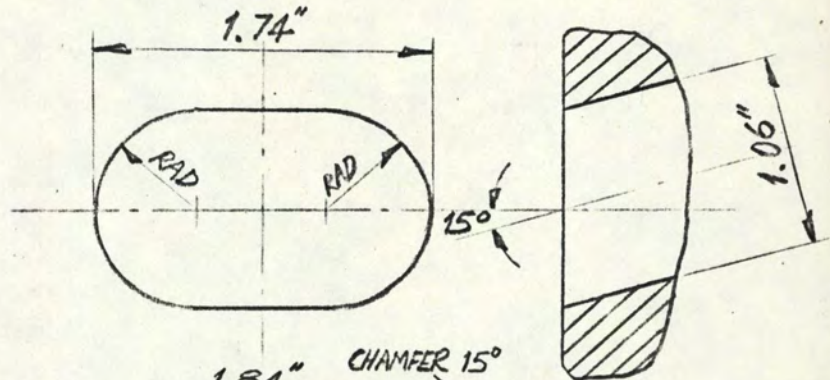

Drawing of entrance to inlet port of cylinderhead. Indicate scale or dimensions and manufacturing tolerance.

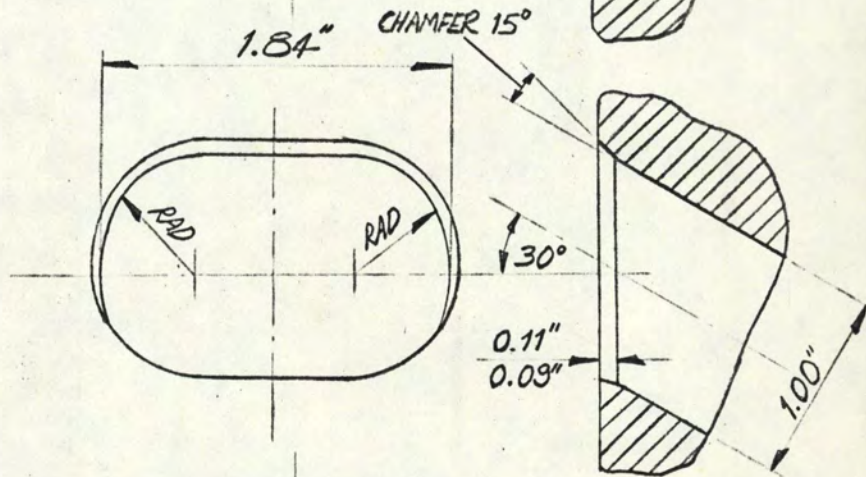

Drawing of exhaust manifold ports, side of cylinderhead. Indicate scale or dimensions and manufacturing tolerance.

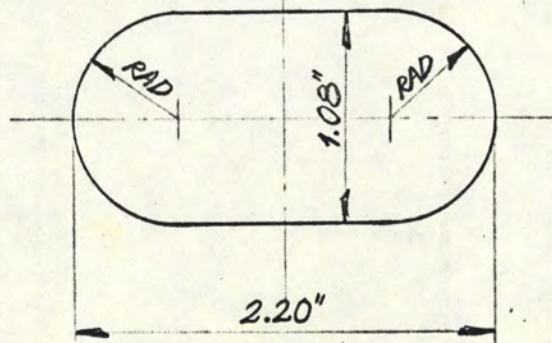

Drawing of exit to exhaust port of cylinderhead. Indicate scale or dimensions and manufacturing tolerance.

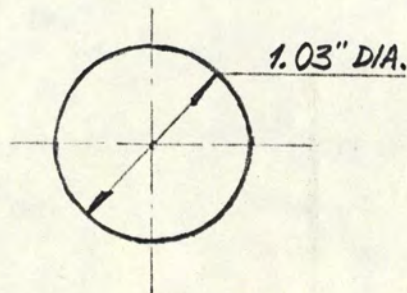

ALL DIMENSIONS  $\pm 0.03$ " UNLESS OTHERWISE SHOWN. ALL DRAWINGS FULL SIZE.



Make British Leyland

Model Triumph Dolomite Sprint

F.I.A. Rec. No. ....

**NOTE 1.**

All dimensions must be given in two measuring systems, see Note 3.

**CAPACITIES AND DIMENSIONS**

- |                |          |              |
|----------------|----------|--------------|
| 1. Wheelbase   | 2454 mm. | 96.6 inches  |
| 2. Front track | 1356 mm. | 53.4 inches  |
| 3. Rear track  | 1290 mm. | 50.75 inches |

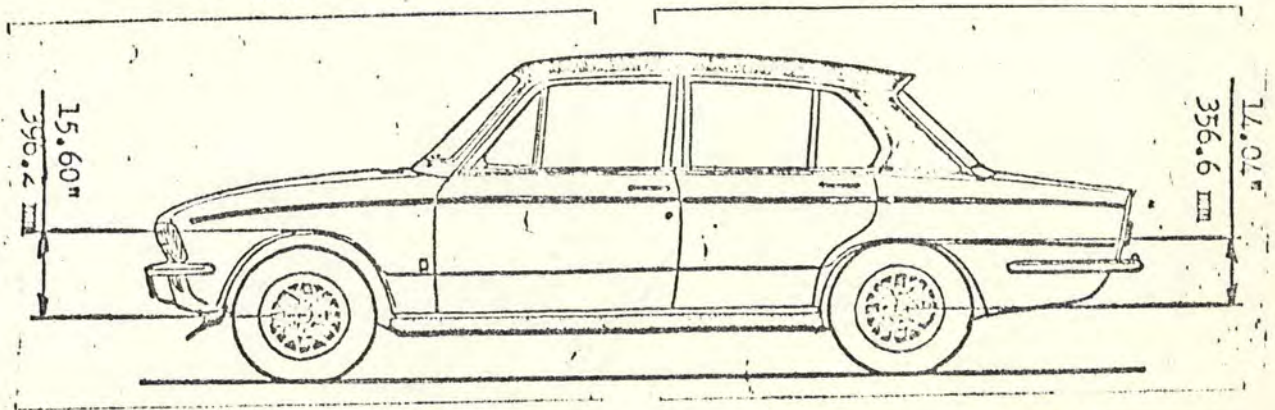

- |   |           |              |
|---|-----------|--------------|
| 4. Overall length of the car                    | 411.8 cm. | 162 inches   |
| 5a Overall width of car at axle of front wheels | 155.6 cm. | 61.25 inches |
| 5. Overall width of the car                     | 156.8 cm. | 61.75 inches |
| 5b Overall width of car at axle of rear wheels  | 150.0 cm. | 59.0 inches  |
| 6. Overall height of the car                    | 137.2 cm. | 54 inches    |
7. Capacity of fuel tank (reserve included)
- |          |               |                 |
|----------|---------------|-----------------|
| 57 ltrs. | 15 gall. U.S. | 12.5 gall. Imp. |
|----------|---------------|-----------------|
8. Seating Capacity. 4
9. Weight. Total weight of the car with normal equipment, water, oil, and spare wheel but without fuel or repair tools :
- |         |           |            |
|---------|-----------|------------|
| 970 kg. | 2140 lbs. | 19.1 cwts. |
|---------|-----------|------------|

**NOTE 2.**

Differences in track caused by the use of other wheels with different rim widths must be stated when recognition is requested for the wheels concerned. Specify ground clearance in relation to the track and give drawing of two easily recognisable points at front and rear at which measurements are taken. These ground clearance dimensions are only for information when checking the track and can in no way affect the eligibility of the car.

**NOTE 3.**

**CONVERSION TABLE**

1 inch/pouce	— 2.54	cm.	1 quart US	— 0.9464	ltrs.
1 foot/pied	— 30.4794	cm.	1 pint (pt)	— 0.568	ltrs.
1 sq. inch/pouce carre	— 6.452	cm. <sup>2</sup>	1 gallon Imp.	— 4.546	ltrs.
1 cubic inch/pouce cube	— 16.387	cm. <sup>3</sup>	1 gallon US	— 3.785	ltrs.
1 pound/livre (lb)	— 453.593	gr.	1 hundred weight (cwt.)	— 50.802	kg.



COMMISSION SPORTIVE  
INTERNATIONALE  
01451 1.C.1173



Make British Leyland

Model Triumph Dolomite Sprint

F.I.A. Rec. No. ....

**CHASSIS AND COACHWORK (Photographs A, B and C)**

- |  |                            |
|--|----------------------------|
| 20. Chassis/body construction: separate/unitary construction | Unitary                    |
| 21. Unitary construction, material(s)                        | Steel                      |
| 22. Separate construction, Material(s) of chassis            | Steel                      |
| 23. Material(s) of coachwork                                 | Steel                      |
| 24. Number of doors <u>4</u> Material(s)                     | Steel                      |
| 25. Material(s) of bonnet                                    | Steel                      |
| 26. Material(s) of boot lid                                  | Steel                      |
| 27. Material(s) of rear-window                               | Toughened safety glass     |
| 28. Material(s) of windscreen                                | Zebra zone toughened glass |
| 29. Material(s) of front-door windows                        | Toughened safety glass     |
| 30. Material(s) of rear-door windows                         | Toughened safety glass     |
| 31. Sliding system of door windows                           | Regulator handles          |
| 32. Material(s) of rear-quarter light                        | Toughened safety glass     |

**ACCESSORIES AND UPHOLSTERY**

- |   |   |
|---|---|
| 38. Interior heating : yes — <del>no</del>                                      | 39. Air conditioning : <del>yes</del> — no  |
| 40. Ventilation : yes — <del>no</del>   | 41. Front seats, type of seat and upholstery, individual -<br>PVC with Bri-nylon seat and squab facings |
| 42. Weight of front seat(s), complete with supports and rails, out of the car : |   |
|   | 13.6 kg. 30 lbs.  |
| 43. Rear seats, type of seat and upholstery                                     | Divan - leathercloth with Bri-nylon seat and squab facings  |
| 44. Front bumper, material(s) Steel Weight                                      | 7 kg. 15.5 lbs.   |
| 45. Rear bumper, material(s) Steel Weight                                       | 6.1 kg. 13.5 lbs.   |

**WHEELS**

- |  |  |
|--|--|
| 50. Type Alloy   |  |
| 51. Weight (per wheel, without tyre)                             | 6.24 kg. 13.75 lbs.                    |
| 52. Method of attachment <u>4 x 3/8"</u> UNF studs and dome nuts |  |
| 53. Rim diameter <u>330.2</u> mm. 13 ins.                        | 54. Rim width <u>139.7</u> mm. 5½ ins. |

**STEERING**

- |   |     |
|---|-----|
| 60. Type Rack and Pinion                                |     |
| 61. Servo-assistance : <del>yes</del> — no              |     |
| 62. Number of turns of steering wheel from lock to lock | 3.8 |
| 63. In case of servo-assistance                         | -   |



**SUSPENSION**

70. Front suspension (photograph D), type Independent - wishbone  
 Coil  
 71. Type of spring  
 72. Stabiliser (if fitted) Anti-roll bar  
 73. Number of shock absorbers 2  
 74. Type Telescopic Hydraulic  
 78. Rear suspension (photograph E), type 4 link system - live axle  
 Coil  
 79. Type of spring  
 80. Stabiliser (if fitted) Anti-roll bar  
 81. Number of shock absorbers 2  
 82. Type Telescopic Hydraulic

**BRAKES** (photographs F and G)

90. Method of operation Hydraulic service brakes. Cable parking brake on rear wheels.  
 91. Servo-assistance (if fitted), type Direct acting - Girling type 50 supervac  
 92. Number of hydraulic master cylinders one (tandem master cylinder when divided system fitted)

	FRONT		REAR	
93. Number of cylinders per wheel	F2	R1		
94. Bore of wheel cylinder(s)	48 mm.	1.890 inches	15.8 mm.	.622 inches

**Drum Brakes**

95. Inside diameter	mm.	inches	228.6 mm.	9.0 inches
96. Length of brake linings	mm.	inches	179.6 mm.	7.07 inches
97. Width of brake linings	mm.	inches	4.44 mm.	1.75 inches
98. Number of shoes per brake			2	
99. Total area per brake	mm. <sup>2</sup>	sq. in.	15980 mm. <sup>2</sup>	24.7 sq. in.

**Disc Brakes**

100. Outside diameter	222 mm.	8.69 inches	mm.	inches
101. Thickness of disc	9.5 mm.	.375 inches	mm.	inches
102. Length of brake linings	60.4 mm.	2.375 inches	mm.	inches
103. Width of brake linings	47.7 mm.	1.88 inches	mm.	inches
104. Number of pads per brake		2		
105. Total area per brake	5610 mm. <sup>2</sup>	8.7 sq. in.	mm. <sup>2</sup>	sq. in.



**ENGINE** (photographs J and K)

130. Cycle <sup>4</sup> 131. Number of cylinders 4
132. Cylinder Arrangement in line - inclined 45°
133. Bore 90.3 mm. 3.56 in. 134. Stroke 78 mm. 3.07 in.
135. Capacity per cylinder 499.5 cm.<sup>3</sup> 30.5 cu. in.
136. Total cylinder capacity 1998 cm.<sup>3</sup> 121.9 cu. in.
137. Material(s) of cylinder block Chromium Iron 138. Material(s) of sleeves (if fitted) -
139. Cylinder head, material(s) Aluminium Alloy Number fitted 1
140. Number of inlet ports 4 141. Number of exhaust ports 8
142. Compression ratio 9.5 : 1 ± 0.35
143. Volume of one combustion chamber 56.5 - 61.25 cm.<sup>3</sup> 3.448 - 3.737 cu. in.
144. Piston, material Aluminium Alloy 145. Number of rings 3
146. Distance from gudgeon pin centre line to highest point of piston crown 33.95 - 34.05 mm. 1.337 - 1.341 in.
147. Crankshaft: ~~mounted~~/stamped 148. Type of crankshaft: integral/.....
149. Number of crankshaft main bearings 5
150. Material of bearing cap Chromium Iron
151. System of lubrication: ~~dry sump~~/oil in sump
152. Capacity, lubricant 4.25 ltrs. 7.5 pts. 4.5 quarts U.S. Water cooled. "No loss"
153. Oil cooler: ~~yes~~/no 154. Method of engine cooling pressurised system
155. Capacity of cooling system 5.40 ltrs. 9.5 pts. 5.1 quarts U.S.
156. Cooling fan (if fitted) dia. (with viscous coupling) 35.6 cm. 14 in.
157. Number of blades of cooling fan 13
- Bearings** Steel backed shells - overlaid
158. Crankshaft main, type copper lead/lead bronze or tin aluminium. dia. 54.013 m.m. 2.1265 in.
159. Connecting rod big end, type overlaid copper lead/lead bronze or tin aluminium dia. 54.000 m.m. 2.1260 in.
- 44.463 m.m. 1.7505 in.
- 44.450 m.m. 1.7500 in.
- Weights**
160. Flywheel (clean) 9.98 kg. 22 lbs.
161. Flywheel with clutch (all turning parts) 15.65 kg. 34.5 lbs.
162. Crankshaft 12.34 kg. 27.2 lbs. 163. Connecting rod 0.73 kg. 1.6 lbs.
164. Piston with rings and pin 0.663 ± 0.012 kg. 1.426 ± 0.026 lbs.
- All weights + 7% - 3% unless otherwise stated.







Make British Leyland Model Triumph Dolomite F.I.A. Rec. No.  
 Sprint

**ENGINE ACCESSORIES**

- |  |  |
|--|--|
| 230. Fuel pump : mechanical <del>and/or electrical</del>             |  |
| 231. No. fitted 1  |  |
| 232. Type of ignition system Coil                                    | 233. No. of distributors 1   |
| 234. No. of ignition coils 1   | 235. No. of spark plugs per cylinder 1   |
| 236. Generator, type : <del>dynamo</del> /alternator—number fitted 1 | 167. Rebore Dimension 90.335mm<br>3.556ins   |
| 237. Method of drive Vee Belt  | Resultant Cylinder Capacity 499.9cm <sup>3</sup>   |
| 238. Voltage of generator 12 volts                                   | 168. Volume of combustion chamber in head:<br>50.0 ± 0.5 cm <sup>3</sup><br>3.051 ± 0.03 cu in |
| 239. Battery, number 1   |  |
| 240. Location Under bonnet   |  |
| 241. Voltage of battery 12 volts                                     | 169. Thickness of head gasket after tightening:<br>1.19 ± 0.10mm<br>0.047 ± 0.004in            |

**ENGINE AND CAR PERFORMANCES** (as declared by manufacturer in catalogue)

- |  |
|--|
| 250. Max. engine output 127 nett (type of horsepower: BHP ) at 5700 r.p.m. |
| 251. Max. r.p.m. 6500 output at that figure 112                            |
| 252. Max. torque 1465 lb.ins. nett at 4500 r.p.m.                          |
| 253. Max. speed of the car 187 km./hour 116 miles/hour                     |

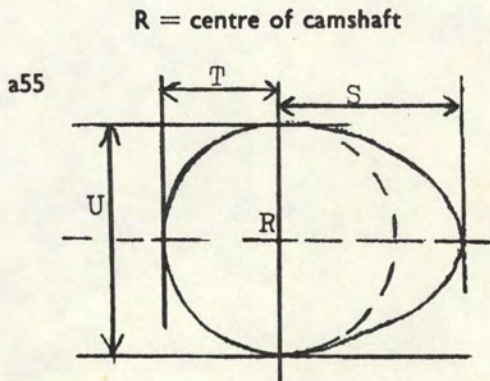

**Inlet cam**

S = 24.49	mm.	0.964	inches
T = 15.09	mm.	0.594	inches
U = 30.20	mm.	1.188	inches

**Exhaust cam** - as inlet cam

S =	mm.		inches
T =	mm.		inches
U =	mm.		inches







COMMISSION SPORTIVE  
01451 16.1173  
INTERNATIONALE



**IMPORTANT :**

During the scrutineering of cars entered in group 5 (Sportscars) only the following items of the present recognition form are to be taken into consideration : 1, 2, 3, 9, 20, 21, 22, 23, 24, 25, 26, 70, 71, 78, 79, 90, 130, 131, 132, 133, 134, 135, 136, 137, 138, 139, 140, 141, 147, 148, 149, 150, 158, 159, 170, 171, 172, 173, 185, 200, 270, 271, 274, 275, 290, 291, 292 and photographs A, B, D, E, F, G, H, J, K and O.

---

The vehicle described in this form has been subject to the following amendments :

on.....	19.....	rec. no.....	List.....	on.....	19.....	rec. no.....	List.....
on.....	19.....	rec. no.....	List.....	on.....	19.....	rec. no.....	List.....
on.....	19.....	rec. no.....	List.....	on.....	19.....	rec. no.....	List.....
on.....	19.....	rec. no.....	List.....	on.....	19.....	rec. no.....	List.....
on.....	19.....	rec. no.....	List.....	on.....	19.....	rec. no.....	List.....

---

Optional equipment affecting preceding information. This to be stated together with reference number.  
reference no. 278 279 280

Overdrive gearbox.

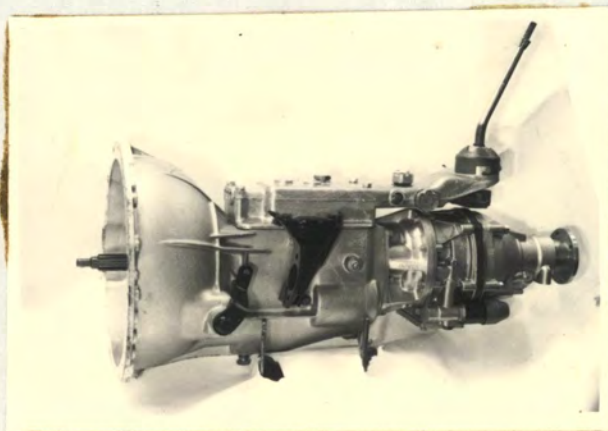





**MOTOR SPORT DIVISION**  
**The Royal Automobile Club**  
**31 Belgrave Square, London SW1X 8QH**

Manufacturer BRITISH LEYLAND  
 Model TRIUMPH DOLOMITE SPRINT  
 F.I.A. Recognition No. 55h2  
 Amendment No. 1/IV

*Amendment to Form of Recognition*

**FEDERATION INTERNATIONALE DE L'AUTOMOBILE**

**VALID IN GROUP.....**

No.

Reference No.

VARIANT - HEAVY DUTY SUSPENSION

Comprising stiffer springs and dampers. This option is standard in certain export territories. There is no visual change to the suspension shown in photographs D and E.

VARIANT - AUTOMATIC TRANSMISSION

- 274 Automatic make : Borg Warner Type : 65
- 275 No. of forward ratios : 3
- 276 Location of gear shift : centre tunnel

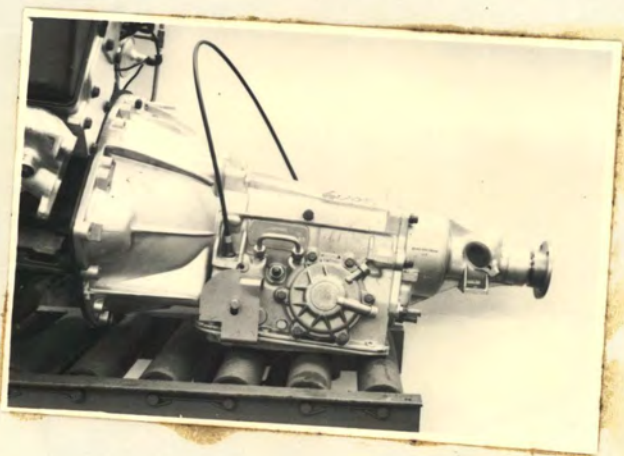

Date amendment is valid from 1.1.76

Stamp of F.I.A./R.A.C.





MOTOR SPORT DIVISION  
The Royal Automobile Club  
25 Bedford Square, London, W1P 2AP

Annex to Form of Recognition  
FEDERATION INTERNATIONALE DE L'AUTOMOBILE

VALID IN GROUP

COMMISSION SPORTIVE  
01451 16.1173  
INTERNATIONALE







**MOTOR SPORT DIVISION**  
**The Royal Automobile Club**  
**31 Belgrave Square, London SW1X 8QH**

Manufacturer BRITISH LEYLAND

Model DOLOMITE SPRINT

F.I.A. Recognition No. 55h2  
 Amendment No. 2/2V  
 COMMISSION SPORTIVE  
 00424 18.2.74  
 INTERNATIONALE

*Amendment to Form of Recognition*

**FEDERATION INTERNATIONALE DE L'AUTOMOBILE**

**VALID IN GROUP.....2.....**

No.	Reference No.
1	FRONT STRUT LINK BAR. PART NO. C-AHT 649.

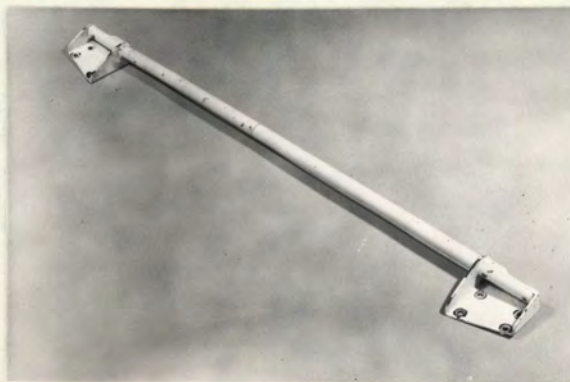

"valable en Groupe 2 uniquement"  
 "valid for Group 2 only"

2	SUMP SHIELD. PART NO. C-AHT 650.
---	----------------------------------



Date amendment is valid from.....1.4.74

Stamp of F.I.A./R.A.C.





**MOTOR SPORT DIVISION**  
**The Royal Automobile Club**  
**31 Belgrave Square, London SW1X 8QH**

Manufacturer British Leyland  
 Model Dolomite Sprint

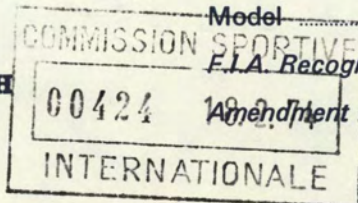

Recognition No. 5542  
 Amendment No. 3/E

*Amendment to Form of Recognition*

**FEDERATION INTERNATIONALE DE L'AUTOMOBILE**

**VALID IN GROUP 1**

No.	Reference No.
	<u>Errata - Page 11</u>
	(Incorrect number of teeth on 1st motion shaft)
1	277 Alternative gears (Manual)
	1st            2.995:1            35/22 x 32/17
	2nd            1.958:1            35/22 x 32/26
	3rd            1.536:1            35/22 x 28/29
	Reverse      3.369:1            35/22 x 36/17
	<u>Errata - Page 8</u>
164	Piston with Rings and Pins
	Weight of Piston should be.    0.647 $\pm$ 0.012 kg.    1.426 $\pm$ 0.026 lbs.
	Alternative supplier            0.663 $\pm$ 0.012 Kg.    1.462 $\pm$ 0.026 lbs.
	Appearance in photograph M on page 3 unchanged.

Date amendment is valid from 1.4.76

Stamp of F.I.A./R.A.C.





**MOTOR SPORT DIVISION**  
**The Royal Automobile Club**  
**31 Belgrave Square, London SW1X 8QH**

Manufacturer British Leyland  
 Model Dolomite Sprint  
 F.I.A. Recognition No. 5542  
 Amendment No. \_\_\_\_\_

*Amendment to Form of Recognition*

**FEDERATION INTERNATIONALE DE L'AUTOMOBILE**

Photographs must be 3" x 2" and a matt finish



.....Heavy Duty Rear Axle - C-AHT 662.....

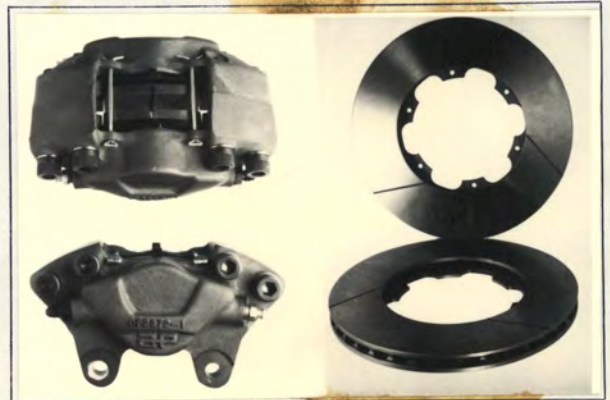

.....Front Disc Brakes - C-AJJ 4129.....

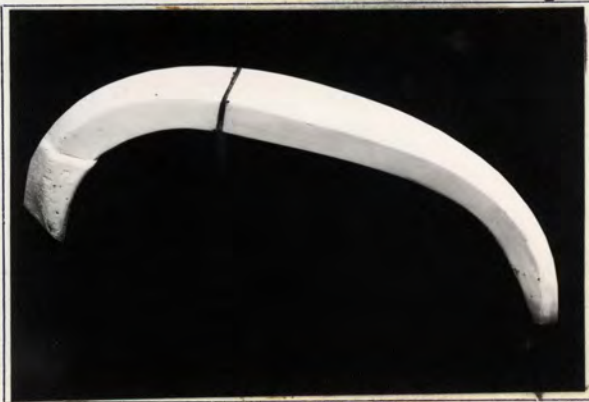

.....Wing Extensions C-AJJ 4128.....



.....Wing Extensions C-AJJ 4128 (Fitted).....

"valable en Groupe 2 uniquement"  
 "valid for Group 2 only"

Date amendment is valid from.....

Stamp of F.I.A./R.A.C.





**MOTOR SPORT DIVISION**  
**The Royal Automobile Club**  
**31 Belgrave Square, London SW1X 8QH**

Manufacturer British Leyland  
 Model Dolomite Sprint

COMMISSION SPORTIVE INTERNATIONALE  
 F.T.A. Recognition No. 5542  
 Amendment No. h/W  
 00424 18.2.74  
 INTERNATIONALE

*Amendment to Form of Recognition*

**FEDERATION INTERNATIONALE DE L'AUTOMOBILE**

**VALID IN GROUP 2**

No.	Reference No.		
1	Heavy Duty Rear Axle	Part No. C-AHT 662	
2	Wing Extensions	Part No. C-AJJ 4128	
3	Front Disc Brakes	Part No. C-AJJ 4129	
Alternative brakes of a different type and dimensions which may include larger hubs and spindles.			
100	Outside Diameter	261.62 m/m	10.3 inches
101	Thickness of Disc	20.57 m/m	0.81 inches
102	Length of Brake Linings	64.77 m/m	2.55 inches
103	Width of Brake Linings	52.07 m/m	2.05 inches
104	Number of Pads per Brake	2	
105	Total area per Brake	690.32 m/m <sup>2</sup>	107 inches <sup>2</sup>

*"valable en Groupe 2 uniquement"*  
*"valid for Group 2 only"*

Date amendment is valid from 1.6.74

  
 Stamp of F.I.A./R.A.C.





**MOTOR SPORT DIVISION**  
**The Royal Automobile Club**  
**31 Belgrave Square, London SW1X 8QH**

Manufacturer British Leyland

Model Dolomite Sprint

F.I.A. Recognition No. 5542

Amendment No. 5/4V



*Amendment to Form of Recognition*

**FEDERATION INTERNATIONALE DE L'AUTOMOBILE**

**VALID IN GROUP...2.....**

No.	Reference No.	Description
1	70	Strengthened front suspension brackets. Part No's. STR 0009 - STR 0029.



2	78	Strengthened rear radius arm. Part No. STR 0007.
---	----	---



*"valable en Groupe 2 uniquement"*  
*"valid for Group 2 only"*

Date amendment is valid from 1.7.74

Stamp of F.I.A./R.A.C.



**ERRATA PAGE 4**

Drawing inlet manifold ports, side of cylinderhead. Indicate scale or dimensions and manufacturing tolerance.

Tolerance + 4% - 2%

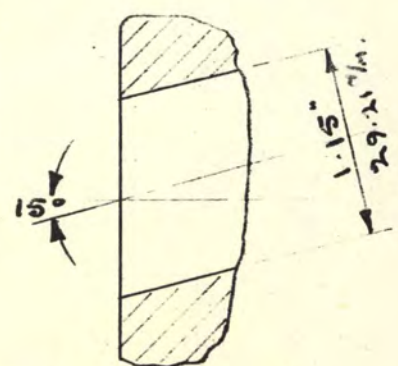
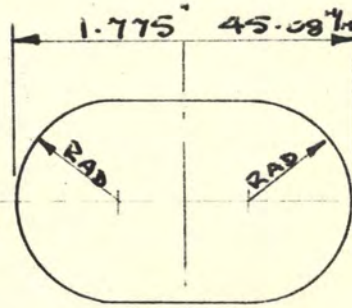

Drawing of entrance to inlet port of cylinderhead. Indicate scale or dimensions and manufacturing tolerance.

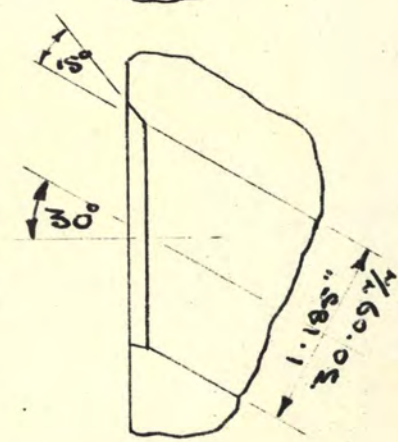
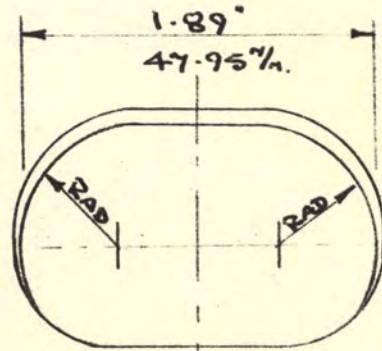

Drawing of exhaust manifold ports, side of cylinderhead. Indicate scale or dimensions and manufacturing tolerance.

Tolerance + 4% - 2%

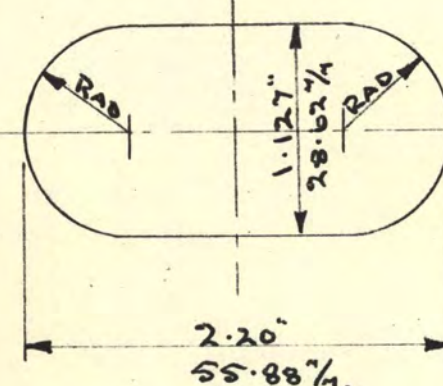

Drawing of exit to exhaust port of cylinderhead. Indicate scale or dimensions and manufacturing tolerance.

All dimensions  $\pm 0.03$ " ( $\pm 0.762$ m/m) unless otherwise shown.



**ERRATA PAGE 8**

160 Flywheel (clean) 9.71 kg 21 lbs 7 ozs  
 163 Connecting rod 0,6.79 kg 1.5 lbs  
 Tolerance +7% - 3%



COMMISSION SPORTIVE  
01988 13.5.74  
INTERNATIONALE

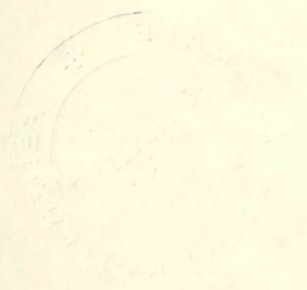





**MOTOR SPORT DIVISION**  
**The Royal Automobile Club**  
**31 Belgrave Square, London SW1X 8QH**

Manufacturer BRITISH LEYLAND  
 Model DOLOMITE SPRINT  
 F.I.A. Recognition No. 5542  
 Amendment No. 7/SV

*Amendment to Form of Recognition*

**FEDERATION INTERNATIONALE DE L'AUTOMOBILE**

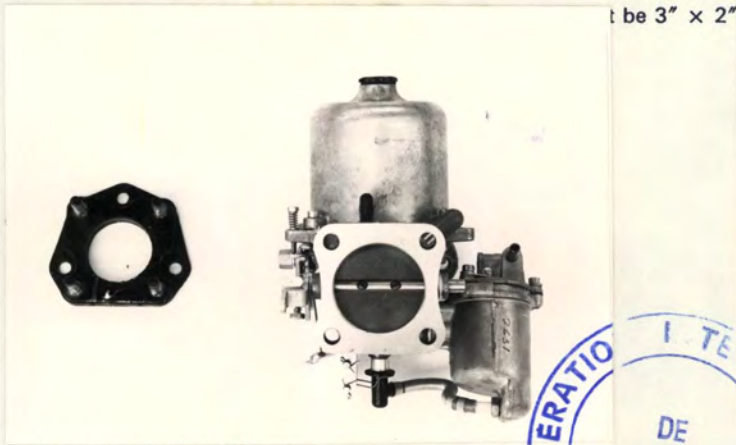

PHOTOGRAPH NO. 1



PHOTOGRAPH NO. 2



PHOTOGRAPH NO. 3

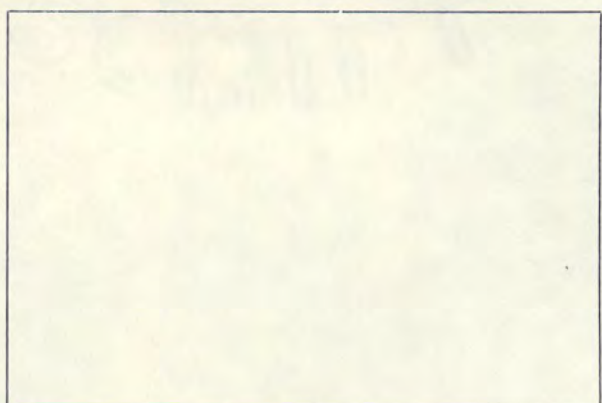
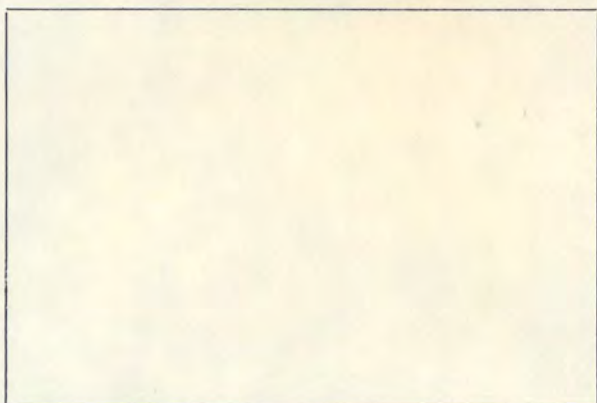

Date amendment is valid from.....

Stamp of F.I.A./R.A.C.





**MOTOR SPORT DIVISION**  
**The Royal Automobile Club**  
**31 Belgrave Square, London SW1X 8QH**

Manufacturer ..... BRITISH LEYLAND  
 Model ..... DOLOMITE SPRINT  
 F.I.A. Recognition No. .... 5542  
 Amendment No. .... 7/SV

*Amendment to Form of Recognition*

**FEDERATION INTERNATIONALE DE L'AUTOMOBILE**

**VALID IN GROUP ..... ONE .....**

No.	Reference No.
	Production variant on Emission Control Cars
1.	142. 10.35:1 $\pm$ 0.35
	256. 45.0 cc / 2.74 cu.ins $\pm$ 0.5 cc
	213. HS 8 Photograph No. 1 & 3
	215. 50.8% / 2.0 ins
	216. 43.4% / 1.71 ins
	Camshaft Part No. RKC 2032
	182. 11.04% / 0.435 ins
	186. 0.07% / 0.003 ins
	187. 68° BTDC
	188. 92° ABDC
	197. 9.90% / 0.390 ins
	201. 0.07% / 0.003 ins
	202. 104° BBDC
	203. 56° ATDC
a.55.	Inlet S = 24.85% 0.978 ins T = 13.95% 0.549 ins U = 27.95% 1.100 ins
	Exhaust - as above
	Exhaust system Part No. RKC 2031 - Photograph No. 2

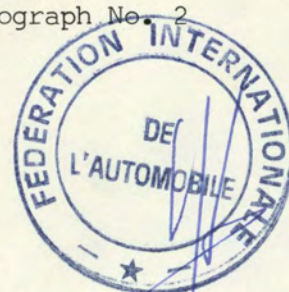

Date amendment is valid from 1.2.75

Stamp of F.I.A./R.A.C.





**MOTOR SPORT DIVISION**  
**The Royal Automobile Club**  
**31 Belgrave Square, London SW1X 8QH**

Manufacturer ..... BRITISH LEYLAND  
 Model ..... DOLOMITE SPRINT  
 F.I.A. Recognition No. .... 5542  
 Amendment No. .... 8/3E

*Amendment to Form of Recognition*

**FEDERATION INTERNATIONALE DE L'AUTOMOBILE**

**VALID IN GROUP ...ONE.....**

No.	Reference No.
	ERRATA. PAGE 2



PHOTOGRAPH M

Dimensions as Page 8 unchanged.

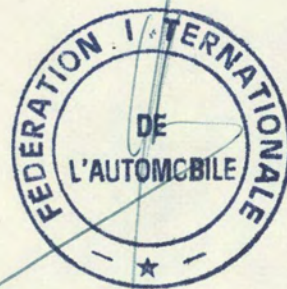

Date amendment is valid from... 1.4.75

Stamp of F.I.A./R.A.C.





**MOTOR SPORT DIVISION**  
**The Royal Automobile Club**  
**31 Belgrave Square, London SW1X 8QH**

Manufacturer ..... **BRITISH LEYLAND**  
 Model ..... **DOLOMITE SPRINT**  
 F.I.A. Recognition No. .... **5542**  
 Amendment No. .... **916V**

*Amendment to Form of Recognition*

**FEDERATION INTERNATIONALE DE L'AUTOMOBILE**

**VALID IN GROUP** ..... **TWO** .....

No.	Reference No.				
1	BRAKES				
		<u>FRONT</u>			
	100. Outside Diameter	247.90%		9.76 ins	
	101. Thickness of Disc	20.57%		0.81 ins	
	102. Length of Brake Lining	115.06%		4.53 ins	
	103. Width of Brake Lining	42.67%		1.68 ins	
	104. Number of Pads per Brake				2
	105. Total area of Brake	54838.6 %		85 sq. ins	
	94. Bore of Wheel Cylinder	38.1 %		1.5 ins	
	93. Number of Cylinders per Wheel				
		<u>FOOT BRAKE</u>		<u>REAR</u> <sup>4</sup>	
				<u>HANDBRAKE</u>	
	100. Outside Diameter	266.7%	10.5ins	266.7%	10.5ins
	101. Thickness of Disc	12.7%	0.5ins	12.7%	0.5ins
	102. Length of Brake Linings	50.8%	2.0ins	38.35%	1.51ins
	103. Width of Brake Linings	74.9%	2.95ins	57.65%	2.27ins
	104. Number of Pads per Brake		2		2
	105. Total area of Brake	69032.12%	107sq.ins	54838.6%	85sq.ins
	94. Bore of Wheel Cylinder	50.8%	2.0ins	41.27%	1.625ins
	93. Number of Cylinders per Wheel		2		1



"valable en Groupe 2 uniquement"  
 "valid for Group 2 only"

Date amendment is valid from 1.10.75







**MOTOR SPORT DIVISION**  
**The Royal Automobile Club**  
**31 Belgrave Square, London SW1X 8QH**

Manufacturer ..... BRITISH LEYLAND  
 Model ..... DOLOMITE SPRINT  
 F.I.A. Recognition No. .... 5542  
 Amendment No. **1014E**

*Amendment to Form of Recognition*

**FEDERATION INTERNATIONALE DE L'AUTOMOBILE**  
**VALID IN GROUP.....ONE.....**

No.	Reference No.
1.	<del>EVOLUTION</del> <del>.....</del>

2.	<p><u>EVOLUTION</u></p> <p>Overdrive now standard production</p> <p>278. Overdrive type Laycock J Type</p> <p>279. Forward Gears on which Overdrive can be selected 2</p> <p>280. Overdrive Ratio 0.797:1</p>
----	---

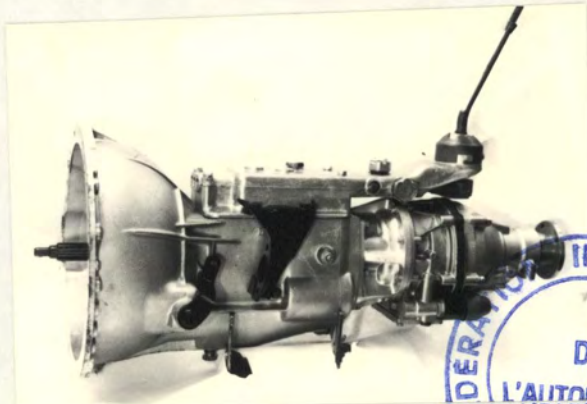

Date amendment is valid from **1.10.75**

Stamp of F.I.A./R.A.C.





**MOTOR SPORT DIVISION**  
**The Royal Automobile Club**  
**31 Belgrave Square, London SW1X 8QH**

Manufacturer ..... BRITISH LEYLAND  
 Model ..... DOLOMITE SPRINT  
 F.I.A. Recognition No. .... 5542  
 Amendment No. .... 11/SE

*Amendment to Form of Recognition*

**FEDERATION INTERNATIONALE DE L'AUTOMOBILE**

**VALID IN GROUP ..... ONE**

No.	Reference No.
<u>EVOLUTION</u>	
1.	292. Differential - four pinion type - Part No. RKC 2026



Date amendment is valid from 1.10.75

Stamp of F.I.A./R.A.C.





**MOTOR SPORT DIVISION**  
**The Royal Automobile Club**  
**31 Belgrave Square, London SW1X 8QH**

Manufacturer ..... BRITISH LEYLAND  
 Model ..... DOLOMITE SPRINT  
 F.I.A. Recognition No. .... 5542  
 Amendment No. .... 12/GE

*Amendment to Form of Recognition*

**FEDERATION INTERNATIONALE DE L'AUTOMOBILE**

**VALID IN GROUP..... ONE.....**

No. | Reference No.

Evolution:-



EMISSION CONTROL CARS

183. ~~183~~ 1

198. ~~198~~ 1



Date amendment is valid from... 1.2.96

Stamp of F.I.A./R.A.C.





**MOTOR SPORT DIVISION**  
**The Royal Automobile Club**  
**31 Belgrave Square, London SW1X 8QH**

Manufacturer ..... BRITISH LEYLAND  
 Model ..... DOLOMITE SPRINT  
 F.I.A. Recognition No. .... 5542  
 Amendment No. .... 13/20

*Amendment to Form of Recognition*

**FEDERATION INTERNATIONALE DE L'AUTOMOBILE**

**VALID IN GROUP.....<sup>TWO</sup>.....**

**"valable en Groupe 2 uniquement"**  
**"valid for Group 2 only"**

No.	Reference No.		
1.	Reinforced rear axle	STR 0239	Photograph A
2.	Reinforced suspension elements		
	1. Front stub axle	STR 0241	Photograph B
	2. Front sub frame	STR 0243	Photograph C
	3. Front tie bar	STR 0244	Photograph D
	4. Front top arm assy	STR 0242	Photograph E
	5. Front lower arm	STR 0245	Photograph F
	6. Front hub assy	STR 0246	Photograph G
	7. Rear radius arm	STR 0240	Photograph H
3.	Brake calipers	STR 0247	Photograph I
4.	Steering arm	STR 0248	Photograph J
5.	Steering rod	STR 0249	Photograph K
6.	Dash board	STR 0250	Photograph L
7.	Roll Over Bar. [REDACTED] Approval No. 59		
	a) Race Part No.	STR 0025	
	b) Rally Part No.	STR 0003	
	c) Front cage Part No.	STR 0024	
8.	Safety Fuel Tank RT 260 complying to F.I.A./Spec/FT3. Capacity 100 litres		
	Part No.	STR 0252	



Date amendment is valid from... 1.3.76

Stamp of F.I.A./R.A.C.





**MOTOR SPORT DIVISION**  
**The Royal Automobile Club**  
**31 Belgrave Square, London SW1X 8QH**

Manufacturer BRITISH LEYLAND  
 Model DOLOMITE SPRINT  
 F.I.A. Recognition No. 5542  
 Amendment No. 13/7V

*Amendment to Form of Recognition*

**FEDERATION INTERNATIONALE DE L'AUTOMOBILE**

*"valable en Groupe 2 uniquement"*  
*"valid for Group 2 only"*

Photographs must be 3" x 2" and a matt finish



PHOTOGRAPH A



PHOTOGRAPH B



PHOTOGRAPH C



PHOTOGRAPH D



PHOTOGRAPH E



PHOTOGRAPH F

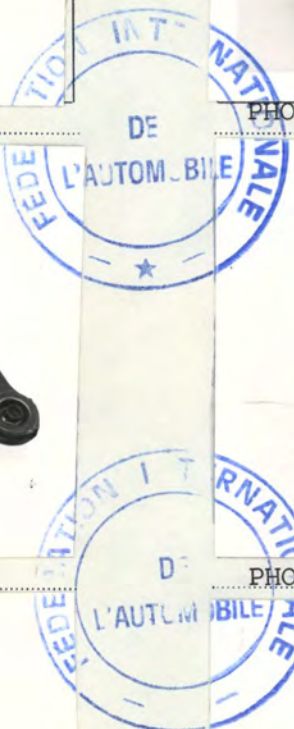

Date amendment is valid from.....

Stamp of F.I.A./R.A.C.





**MOTOR SPORT DIVISION**  
**The Royal Automobile Club**  
**31 Belgrave Square, London SW1X 8QH**

Manufacturer BRITISH LEYLAND  
 Model DOLOMITE SPRINT  
 F.I.A. Recognition No. 5542  
 Amendment No. 1319V

*Amendment to Form of Recognition*

**FEDERATION INTERNATIONALE DE L'AUTOMOBILE**

*"valable en Groupe 2 uniquement"*  
*"valid for Group 2 only"*

Photographs must be 3" x 2" and a matt finish



PHOTOGRAPH G

PHOTOGRAPH H



PHOTOGRAPH I

PHOTOGRAPH J



PHOTOGRAPH K

PHOTOGRAPH L

Date amendment is valid from.....

Stamp of F.I.A./R.A.C.





**MOTOR SPORT DIVISION**  
**The Royal Automobile Club**  
**31 Belgrave Square, London SW1X 8QH**

Manufacturer ..... BRITISH LEYLAND  
 Model ..... DOLOMITE SPRINT  
 F.I.A. Recognition No. 5542  
 Amendment No. 13/7V

*Amendment to Form of Recognition*

**FEDERATION INTERNATIONALE DE L'AUTOMOBILE**

TWO

**VALID IN GROUP .....**

No.	Reference No.		
1.	277.	ALTERNATIVE GEARS	
	1ST	2.254	35/22 x 34/24
	2ND	1.705	35/22 x 30/28
	3RD	1.293	35/22 x 26/32
2.		ALTERNATIVE FINAL DRIVE RATIOS	
	3.091	11 x 34	
	3.455	11 x 38	
	3.727	11 x 41	
	3.900	10 x 39	
	4.100	10 x 41	
	4.333	9 x 39	
	4.555	9 x 41	
	4.750	8 x 38	

"valable en Groupe 2 uniquement"  
 "valid for Group 2 only"

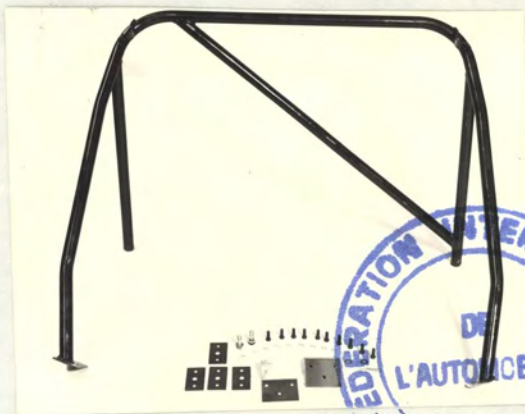

Date amendment is valid from.....

Stamp of F.I.A./R.A.C.





**MOTOR SPORT DIVISION**  
**The Royal Automobile Club**  
**31 Belgrave Square, London SW1X 8QH**

Manufacturer BRITISH LEYLAND  
 Model DOLOMITE SPRINT  
 F.I.A. Recognition No. 5542  
 Amendment No. 14/87

*Amendment to Form of Recognition*

**FEDERATION INTERNATIONALE DE L'AUTOMOBILE**

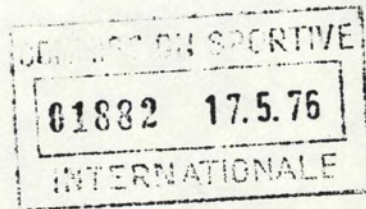

No.	Reference No.
	<u>GROUP ONE</u>
60.	HEAVY DUTY STEERING RACK FOR CERTAIN EXPORT TERRITORIES WEIGHT 4.6 kg                      10.1 lbs
62.	NUMBER OF TURNS OF STEERING WHEEL FROM LOCK TO LOCK                      3.28

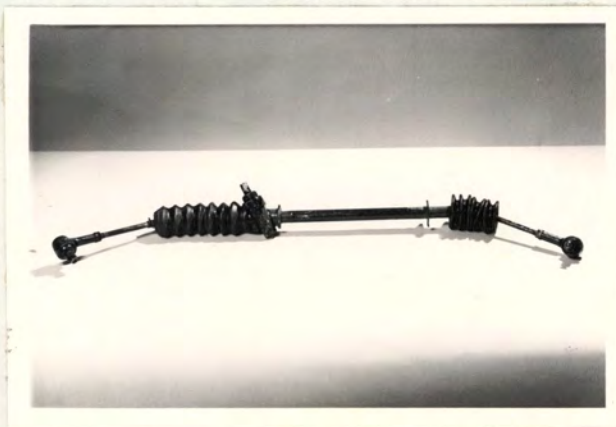

Date amendment is valid from 1.7.76



Stamp of F.I.A./R.A.C.





**MOTOR SPORT DIVISION**  
**The Royal Automobile Club**  
**31 Belgrave Square, London SW1X 8QH**

Manufacturer ..... BRITISH LEYLAND  
 Model ..... DOLOMITE SPRINT  
 F.I.A. Recognition No. .... 5542  
 Amendment No. .... 15/90

*Amendment to Form of Recognition*  
**FEDERATION INTERNATIONALE DE L'AUTOMOBILE**



No. | Reference No.

GROUP ONE

SPORT DRIVING SEAT

PART NUMBER STR 0329

WEIGHT 5.1 kg. 11.2 lbs



Date amendment is valid from 1.7.76







**MOTOR SPORT DIVISION**  
**The Royal Automobile Club**  
**31 Belgrave Square, London SW1X 8QH**

Manufacturer BRITISH LEYLAND  
 Model DOLOMITE SPRINT  
 F.I.A. Recognition No. 5542  
 Amendment No. 16/7E

*Amendment to Form of Recognition*

**FEDERATION INTERNATIONALE DE L'AUTOMOBILE**

No. | Reference No.

GROUP ONE

ERRATA

OMISSION ON AMENDMENT 7/5V

183. - 2

198. - 2



Date amendment is valid from.....

Stamp of F.I.A./R.A.C.





**MOTOR SPORT DIVISION**  
**The Royal Automobile Club**  
**31 Belgrave Square, London SW1X 8QH**

Manufacturer ..... **BRITISH LEYLAND**  
 Model ..... **DOLOMITE SPRINT**  
 F.I.A. Recognition No. **5542**  
 Amendment No. **17/10V**

*Amendment to Form of Recognition*

**FEDERATION INTERNATIONALE DE L'AUTOMOBILE**

**Valid in Group** ONE

No.            Reference No.  
 PRODUCTION OPTION  
 1.            Twin Weber Carburetter Pac. STN 0093.

- 210.    2
- 211.    Side Draught
- 212.    Weber
- 213.    48 DCOE
- 214.    2
- 215.    48m/m    1.890
- 216.    42m/m    1.575

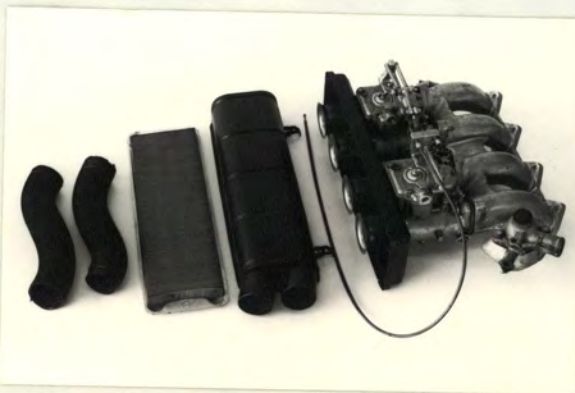

2.            GEARBOX - ALTERNATIVE GEARS

- 277.    1    2.186     $\frac{31}{26} \times \frac{33}{18}$
- 2    1.5738     $\frac{31}{26} \times \frac{33}{25}$
- 3    1.2348     $\frac{31}{26} \times \frac{29}{28}$
- 4    1.00
- Rev 2.5249     $\frac{31}{26} \times \frac{36}{17}$

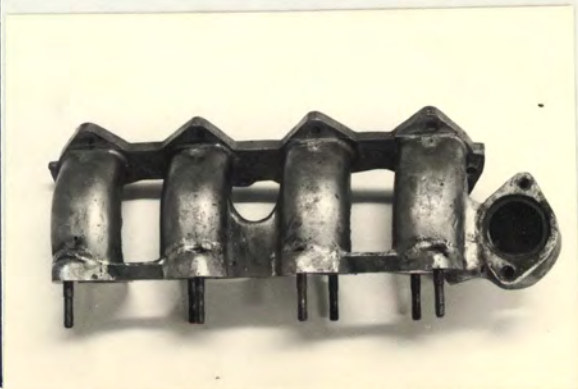
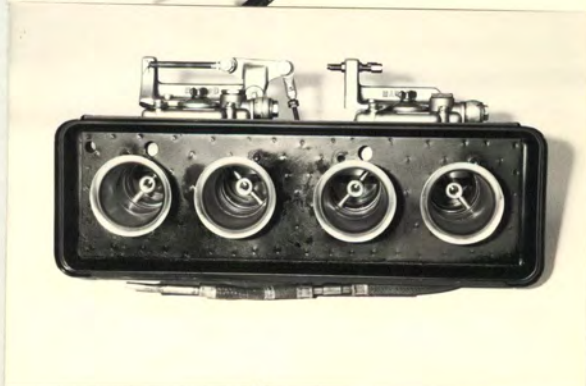
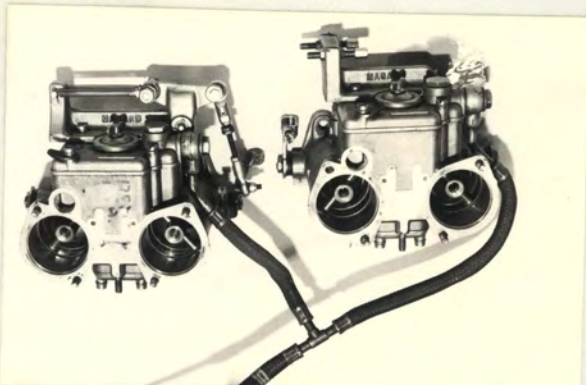

**DIMENSIONS UNCHANGED**

Date amendment is valid from 1.1.77

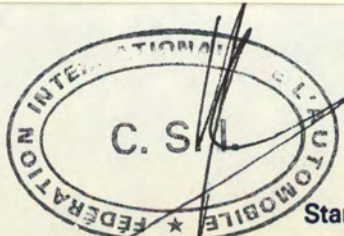

Stamp of F.I.A./R.A.C





**MOTOR SPORT DIVISION**  
**The Royal Automobile Club**  
**31 Belgrave Square, London SW1X 8QH**

Manufacturer BRITISH LEYLAND  
 Model DOLOMITE SPRINT  
 F.I.A. Recognition No. 5542  
 Amendment No. 18/8E

*Amendment to Form of Recognition*

**FEDERATION INTERNATIONALE DE L'AUTOMOBILE**

**Valid in Group** ONE EVOLUTION

No.	Reference No.
1.	INTRODUCTION OF LARGER WHEEL STUDS, NUTS, AND RESPECTIVE HUB ASSEMBLIES.  STUD AND NUT SIZE. 11.11m/m 0.4375"
2.	204. TWO OUTLET (EACH) 42.7m/m 1.68"

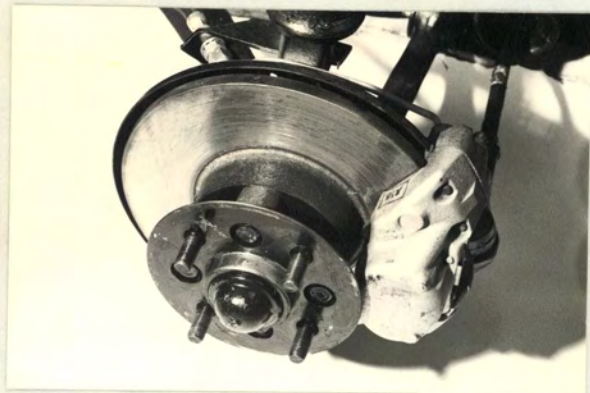
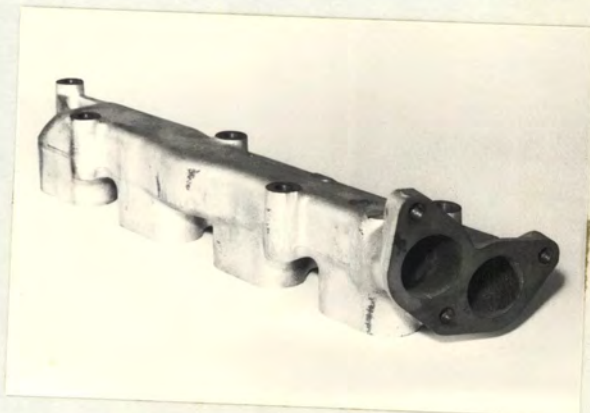

Date amendment is valid from 1.1.77

*[Signature]*  
 Stamp of F.I.A./R.A.C





**MOTOR SPORT DIVISION**  
**The Royal Automobile Club**  
**31 Belgrave Square, London SW1X 8QH**

Manufacturer BRITISH LEYLAND  
 Model DOLOMITE SPRINT  
 F.I.A. Recognition No. 5542  
 Amendment No. 19/11V

*Amendment to Form of Recognition*

**FEDERATION INTERNATIONALE DE L'AUTOMOBILE**

**Valid in Group** ONE

No.

Reference No.

PRODUCTION VARIANT

SPECIFICATION FOR CERTAIN EXPORT TERRITORIES (HIGH TEMPERATURE COUNTRIES)

1. ENGINE OIL COOLER - STN 0003 (PHOTOGRAPH A)
2. IMPROVED EFFICIENCY RADIATOR - STR 0322 (PHOTOGRAPH B)

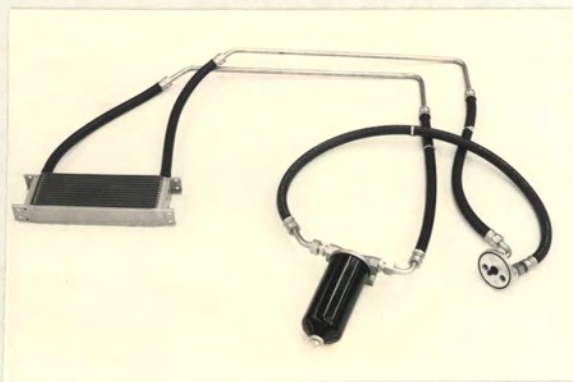

PHOTOGRAPH A



PHOTOGRAPH B



Date amendment is valid from 1.1.77

Stamp of F.I.A./R.A.C





**MOTOR SPORT DIVISION**  
**The Royal Automobile Club**  
**31 Belgrave Square, London SW1X 8QH**

Manufacturer BRITISH LEYLAND  
 Model DOLOMITE SPRINT  
 F.I.A. Recognition No. 5542  
 Amendment No. 20/9E

*Amendment to Form of Recognition*

**FEDERATION INTERNATIONALE DE L'AUTOMOBILE**

**Valid in Group** ONE

No.	Reference No.
	ERRATA
105.	51200m/m <sup>2</sup> 79.6 sq.ins.



Date amendment is valid from 1.1.77

Stamp of F.I.A./R.A.C





**MOTOR SPORT DIVISION**  
**The Royal Automobile Club**  
**31 Belgrave Square, London SW1X 8QH**

Manufacturer ..... **BRITISH LEYLAND**  
 Model ..... **DOLOMITE SPRINT**  
 F.I.A. Recognition No. .... **5542**  
 Amendment No. .... ~~31/12V~~ **21/12V**

*Amendment to Form of Recognition*

**FEDERATION INTERNATIONALE DE L'AUTOMOBILE**

**Valid in Group** ONE

No.

Reference No.

AUTOMATIC TRANSMISSION IN COMPLIANCE WITH ARTICLE 258 (f) OF APPENDIX J

274. BORG WARNER - TYPE 65 (PHOTOGRAPH A)

275. 3

276. CENTRE TUNNEL

277. RATIO      1.      2.39:1 - 4.57:1  
                   2.      1.45:1 - 2.77:1  
                   3.      1.00:1 - 1.91:1  
                   Reverse 2.09:1 - 3.99:1

TRANSMISSION OIL COOLER - STN 0083 (PHOTOGRAPH B)

ALTERNATIVE FINAL DRIVE      4.555:1

NUMBER OF TEETH      9 x 41

DUAL BRAKE SYSTEM IN COMPLIANCE WITH ARTICLE 258 (i) OF APPENDIX J -  
 (PHOTOGRAPH C)

101.	19.05%	0.75 inches	102.	76.2%	3.00 inches
103.	55.9%	2.20 inches	105.	57.200% <sup>2</sup>	88.8 sq.in.



*Valid only with automatic transmission*

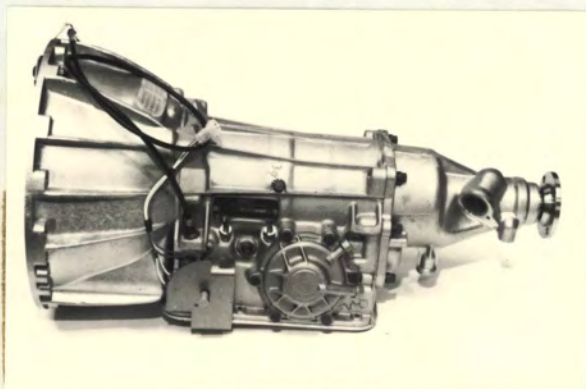

PHOTOGRAPH A

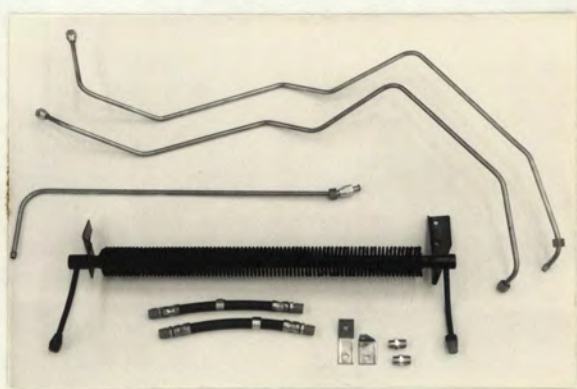

PHOTOGRAPH B

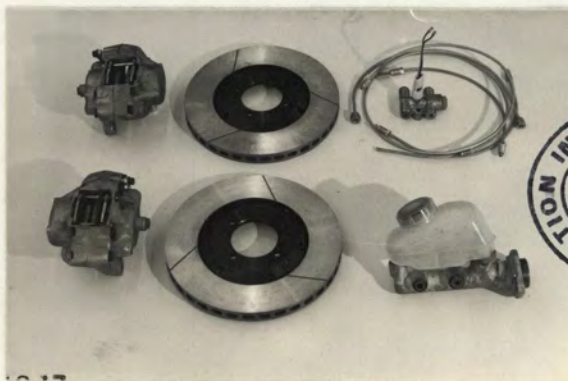

PHOTOGRAPH C

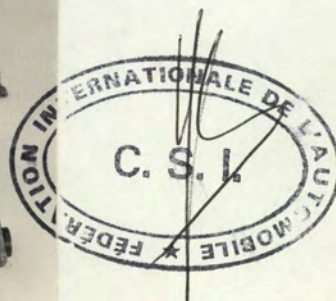

-1. JAN.

Date amendment is valid from.....

Stamp of F.I.A./R.A.C





**MOTOR SPORT DIVISION**  
**The Royal Automobile Club**  
**31 Belgrave Square, London SW1X 8QH**

Manufacturer British Leyland  
 Model Dolomite Sprint  
 F.I.A. Recognition No. 5542  
 Amendment No. 22/10 E

*Amendment to Form of Recognition*

**FEDERATION INTERNATIONALE DE L'AUTOMOBILE**

**Valid in Group** One

No.	Reference No.
	Errata - Amendment number 17/10V
	Gearbox - Alternative gears
277	1. 2.1742 $\frac{31}{26} \times \frac{31}{17}$



Date amendment is valid from 1.4.77

Stamp of F.I.A./R.A.C



Managers  
Model  
1935  
1936

RECEIVED

JAN 24 '77

RAC.  
Motor Sport Division

Valid in Group





**MOTOR SPORT DIVISION**  
**The Royal Automobile Club**  
**31 Belgrave Square, London SW1X 8QH**

Manufacturer LEYLAND CARS  
 Model DOLOMITE SPRINT  
 F.I.A. Recognition No. 5542  
 Amendment No. 23/13V

*Amendment to Form of Recognition*

**FEDERATION INTERNATIONALE DE L'AUTOMOBILE**

No.	Reference No.	GROUP ONE
1.	a 55	DIMENSION 'T' MAY BE REDUCED BY UP TO 1.01mm 0.040" TOGETHER WITH A REDUCTION IN 'U' AS A PRODUCTION RECLAIM

Date amendment is valid from 1.9.77

Stamp of F.I.A./R.A.C







**MOTOR SPORT DIVISION**  
**The Royal Automobile Club**  
**31 Belgrave Square, London SW1X 8QH**

Manufacturer ..... BRITISH LEYLAND  
Model ..... DOLOMITE SPRINT  
F.I.A. Recognition No. 5542  
Amendment No. 24/14V

*Amendment to Form of Recognition*

**FEDERATION INTERNATIONALE DE L'AUTOMOBILE**

No.	Reference No.
	GROUP ONE
	ENGINE OIL COOLER REFERENCE AMENDMENT 19/11V -
	CHANGE IN PART NUMBER - STN 0055

Date amendment is valid from -1 OCT. 1977

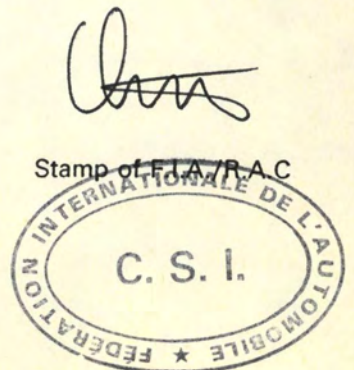





**MOTOR SPORT DIVISION**  
**The Royal Automobile Club**  
 31 Belgrave Square, London SW1X 8QH

Manufacturer ..... BRITISH LEYLAND  
 Model ..... DOLOMITE SPRINT  
 F.I.A. Recognition No. .... 5542  
 Amendment No. .... 25/15V

*Amendment to Form of Recognition*

**FEDERATION INTERNATIONALE DE L'AUTOMOBILE**

**VALID IN GROUP ..... ONE .....**

No.	Reference No.
1.	293. ALTERNATIVE FINAL DRIVE RATIO 3.89:1      35 x 9
2.	139. CYLINDER BLOCK - ALTERNATIVE SUPPLIER - PART NUMBER PKC 0609 MATERIAL - CHROMIUM IRON      DIMENSION UNCHANGED FROM ORIGINAL



Date amendment is valid from ..... -1.FEV.1978

Stamp of F.I.A./R.A.C.





**MOTOR SPORT DIVISION**  
**The Royal Automobile Club**  
 31 Belgrave Square, London SW1X 8QH

Manufacturer LEYLAND CARS  
 Model DOLOMITE SPRINT  
 F.I.A. Recognition No. 5542  
 Amendment No. 26/16V

*Amendment to Form of Recognition*

**FEDERATION INTERNATIONALE DE L'AUTOMOBILE**  
**VALID IN GROUP** ..... ONE .....

No. 1. Reference No. SAFETY ROLL BAR  
 IN COMPLIANCE WITH ARTICLE 253(e). AS DRAWING NO. 2

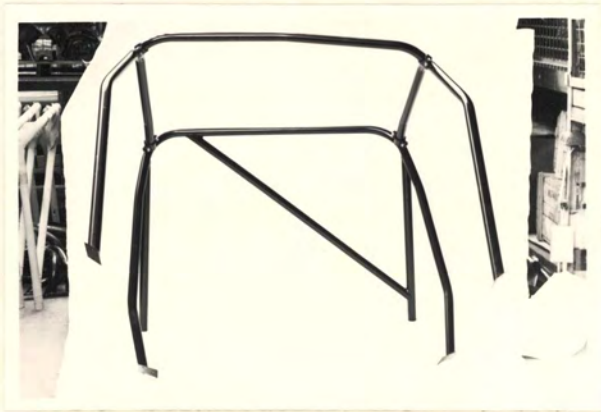

MATERIAL	ALUMINIUM	
TYPE	HE17TF	
E ~	30 daN	
TENSILE STRENGTH	36 daN	
TUBE DIA	40mm	1.57 ins
TUBE WALL THICKNESS	3mm	0.118 ins
WEIGHT	10.5 kg	23.1 lbs

-1.AVR.1978



Date amendment is valid from.....

Stamp of F.I.A./R.A.C.





**MOTOR SPORT DIVISION**  
**The Royal Automobile Club**  
**31 Belgrave Square, London SW1X 8QH**

Manufacturer BRITISH LEYLAND  
 Model DOLOMITE SPRINT  
 F.I.A. Recognition No. 5542  
 Amendment No. 27/111

*Amendment to Form of Recognition*

**FEDERATION INTERNATIONALE DE L'AUTOMOBILE**

**Valid in Group** ONE

No. | Reference No.

EVOLUTION

1 | CRANKSHAFT DAMPER STR 0452  
 WEIGHT 2.75 KG 6.06 LBS



EVOLUTION

2 | HEAVY DUTY SUSPENSION AS 1/1V  
 RE-DESIGNED FRONT TIE BARS AND RUBBERS STN 0109

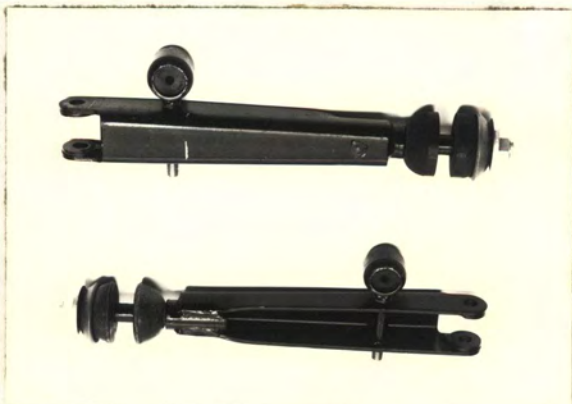

Date amendment is valid from.....-1. JUL. 1978

Stamp of F.I.A./R.A.C





**MOTOR SPORT DIVISION**  
**The Royal Automobile Club**  
 31 Belgrave Square, London SW1X 8QH

Manufacturer ..... **BRITISH LEYLAND**  
 Model ..... **DOLOMITE SPRINT**  
 F.I.A. Recognition No. .... **5542**  
 Amendment No. .... **28 / 12 E**

*Amendment to Form of Recognition*

**FEDERATION INTERNATIONALE DE L'AUTOMOBILE**  
**VALID IN GROUP ..... ONE**

No.	Reference No.	
		<b>ERRATA</b>
1.	5b.	<b>OVERALL WIDTH OF CAR AT AXLE OF REAR WHEELS</b>
	<b>DELETE</b>	150.0cm                      59.0 ins
	<b>INSERT</b>	152.71cm                      60.125 ins



-1.OCT.1978

Date amendment is valid from.....

Stamp of F.I.A./R.A.C.





**MOTOR SPORT DIVISION**  
**The Royal Automobile Club**  
 31 Belgrave Square, London SW1X 8QH

Manufacturer B.L. CARS LIMITED  
 Model DOLOMITE SPRINT  
 F.I.A. Recognition No. 5542  
 Amendment No. 29/13E

*Amendment to Form of Recognition*

**FEDERATION INTERNATIONALE DE L'AUTOMOBILE**

**VALID IN GROUP** ..... ONE .....

No. Reference No.

EXHAUST MANIFOLD

1. PRODUCTION RECLAIM OUTLETS. MACHINED UP TO 1.75" 45%.

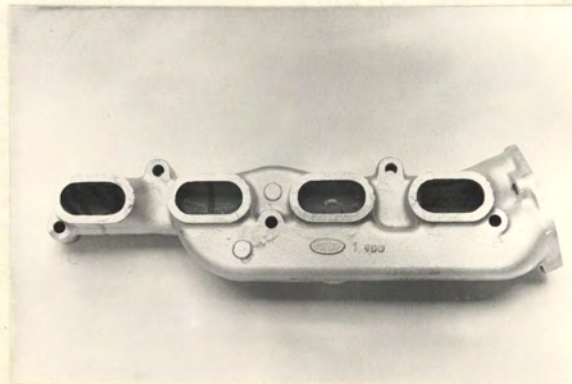
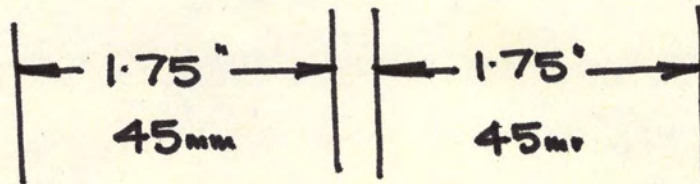
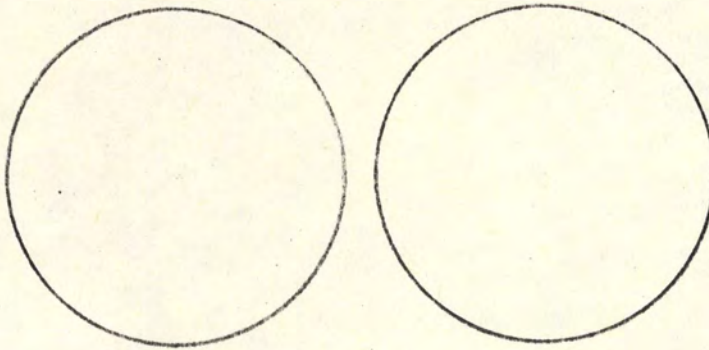

*[Handwritten signature]*



Date amendment is valid from 1 NOV 1979

Stamp of F.I.A./R.A.C.