

FEDERATION INTERNATIONALE
DU SPORT AUTOMOBILE

Homologation No

A-5524

Groupe A/B
Group

FICHE D'HOMOLOGATION CONFORME A L'ANNEXE J DU CODE SPORTIF INTERNATIONAL
HOMOLOGATION FORM IN ACCORDANCE WITH APPENDIX J OF THE INTERNATIONAL SPORTING CODE

Homologation valable à partir du 01 JUIL. 1994*
Homologation valid as from

A) Voiture vue de 3/4 avant
Car seen from 3/4 front



B) Voiture vue de 3/4 arrière
Car seen from 3/4 rear



1. GENERALITES / GENERAL

- 101. Constructeur PERUSAHAAN OTOMOBIL NASIONAL BERHAD
Manufacturer
- 102. Dénomination(s) commerciale(s) - Modèle et type PROTON WIRA 1.6XLi (C98S)
Commercial name(s) - Model and type PROTON PERSONA 1.6XLi (C98S)
- 103. Cylindrée 1597 cm³ Cylindrée corrigée XXXX x XXXX = XXXX cm³
Cylinder capacity Corrected cylinder capacity
- 104. Mode de construction : a) Mode :

séparée	monocoque
separate	unitary construction

Type of car construction : Type :
b) Matériau du châssis / coque Steel
Material of chassis / bodyshell
- 105. Nombre de volumes 3
Number of volumes
- 106. Nombre de places 5
Number of places

19 FISA - FC - 1990 - 008.01 FEB.10.90

AUTOMOBILE ASSOCIATION MALAYSIA
25, Jalan Yap Kwan Seng
50450 Kuala Lumpur
Tel: 2125277/2125219 (Transit)
2125212 (Customer Services)

FEDERATION INTERNATIONALE
DE L'AUTOMOBILE
8, Place de la Concorde, 8
75008 PARIS

Marque
Make

PROTON

Modèle
Model

WIRA 1.6XLi (C98S)
PERSONA 1.6XLi (C98S)

Homologation No

A - 5524

2. DIMENSIONS, POIDS / DIMENSIONS, WEIGHT

202. Longueur hors-tout Overall length 4360 mm +/- 1 %

203. Largeur hors-tout Overall width 1690 mm +/- 1 %

Endroit de mesure Where measured At Front Axle

204. Largeur de carrosserie Width of bodywork a) A la hauteur de l'axe avant At front axle 1695 mm +/- 1 %

b) A la hauteur de l'axe arrière At rear axle 1680 mm +/- 1 %

206. Empattement Wheelbase 2500 mm +/- 1 %

209. Porte-à-faux Overhang a) Avant Front 820 mm +/- 1 % b) Arrière Rear 1040 mm +/- 1 %

210. Distance *G* (volant - paroi de séparation arrière) Distance *G* (steering wheel - rear bulkhead) 1575 mm

AUTOMOBILE ASSOCIATION MALAYSIA
25, Jalan Yap Kwan Song
50450 Kuala Lumpur
Tel: 2425777/2426216 (Travel)
2425812 (Breakdown Services)

FEDERATION INTERNATIONALE
DE L'AUTOMOBILE
8, Place de la Concorde, 8
75008 PARIS

Marque
Make

PROTON

Modèle
Model

WIRA 1.6XLi (C98S)
PERSONA 1.6XLi (C98S)

Homologation No

A-5524

3. MOTEUR / ENGINE

(en cas de moteur rotatif, voir Art. 335 sur fiche additionnelle)
(in case of rotative engine, see Art. 335 on additional form)

301. Emplacement et position du moteur
Location and position of the engine

Inclination (R/L) : 0°
Front, Transversal, Vertical Angle : 10° towards the front

303. Cycle
Cycle

4 Otto

C) Profil droit du moteur déposé
Right hand view of dismantled engine

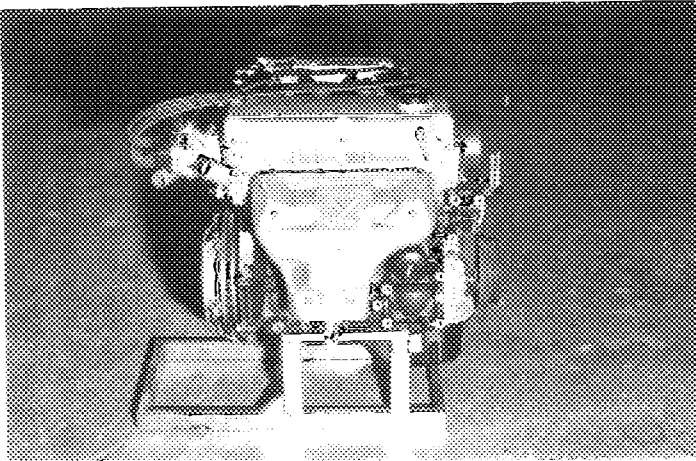

D) Profil gauche du moteur déposé
Left hand view of dismantled engine

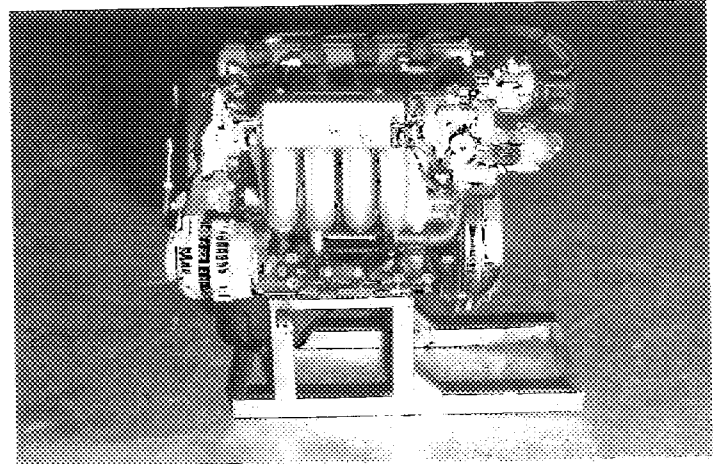

E) Moteur dans son compartiment
Engine in its compartment

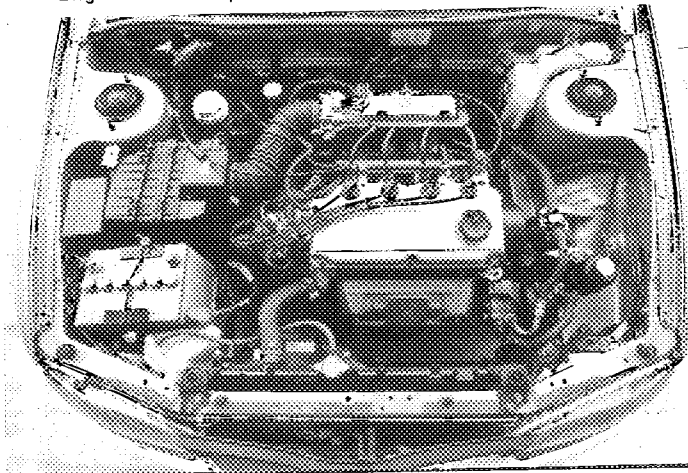

304. Suralimentation
Supercharging

oui	non
yes	no

(en cas de suralimentation, voir Art. 334 sur fiche additionnelle)
(in case of supercharging, see Art. 334 on additional form)

Type et nombre de compresseurs
Type and number of compressors

X X X X

(C) FISA - FC - 1990 - 0083.01.FEB.10.90

AUTOMOBILE ASSOCIATION MALAYSIA
25, Jalan Yap Kwan Seng
50450 Kuala Lumpur
Tel: 331 2111, 331 2112, 331 2113
Fax: 331 2114, 331 2115, 331 2116

FEDERATION INTERNATIONALE
DE L'AUTOMOBILE
8, Place de la Concorde, 8
75008 PARIS

Marque / Make: PROTON

Modèle / Model: WIRA 1.6XLi (C98S)
PERSONA 1.6XLi (C98S)

Homologation No

A-5524

305. Nombre et disposition des cylindres / Number and layout of cylinders: 4 In-Line

306. Mode de refroidissement / Type of cooling: Liquid

307. Cylindrée / Cylinder capacity: a) Unitaire / Unitary: 399.25 cm³; b) Totale / Total: 1597.5 cm³

c) Totale max. autorisée / Max. total allowed: 1599.5 cm³

INDICATION NON VALABLE EN GROUPE N / NOT VALID FOR GROUP N

312. Matériau du bloc-cylindre / Cylinder block material: Cast Iron

313. Chemises / Sleeves: a)

oui	non
yes	no

c)

humides	seches
wet	dry

314. Alésage / Bore: Ø 81.0 mm

315. Alésage maximum autorisé / Maximum bore allowed: Ø 81.05 mm

INDICATION NON VALABLE EN GROUPE N / NOT VALID FOR GROUP N

316. Course / Stroke: 77.5 mm

318. Bielle / Connecting rod: a) Matériau / Material: Steel; b) Type de la tête de bielle / Big end type: Separate

c) Diamètre intérieur de la tête de bielle (sans coussinets) / Interior diameter of the big end (without shell bearings): Ø 48.0 mm

d) Longueur entre axes / Length between the axes: 120.0 +/- 0.1 mm; e) Poids minimum / Minimum weight: 430 g

319. Vilebrequin / Crankshaft: a) Type de construction / Type of manufacture: One Piece

b) Matériau / Material: Steel

c)

coulé	forgé
cast	forged

d) Nombre de paliers / Number of bearings: 5

e) Type de paliers / Type of bearings: Plain

f) Diamètre des paliers / Diameter of bearings: Ø 50.0 mm

g) Matériau des chapeaux de paliers / Bearing caps material: Cast-iron

h) Poids minimum du vilebrequin nu / Minimum weight of bare crankshaft: 12400 g

320. Volant moteur / Flywheel:

a) Matériau / Material: _____
b) Poids minimum avec couronne de démarreur / Minimum weight with starter ring: _____

Boîte manuelle/Manual gearbox	Boîte automatique/Automatic gearbox
Cast iron	X X X X
<u>6600</u> g	<u>X X X X</u> g
	Utilisable uniquement avec boîte de vitesses automatique Only usable with an automatic gearbox

(C) FISA - FC - 1930 - COR.01.FR.10.90

AUTOMOBILE ASSOCIATION MALAYSIA
25, Jalan Yap Kwan Seng
50451 Kuala Lumpur
Tel: 34041211 (10 lines)
34041212 (10 lines)

FEDERATION INTERNATIONALE
DE L'AUTOMOBILE
8, Place de la Concorde, 8
75008 PARIS

Marque
Make

PROTON

Modèle
Model

WIRA (C98S)
PERSONA 1.6XLi (C98S)

Homologation No

A-5524

321. Culasse : a) Nombre 1 b) Matériau Aluminum alloy
Cylinderhead : Number Material
- e) Angle entre soupape d'admission et la verticale 28.5°
Angle between intake valve and vertical
- f) Angle entre soupape d'échappement et la verticale 20.0°
Angle between exhaust valve and vertical

F) Culasse nue
Bare cylinderhead

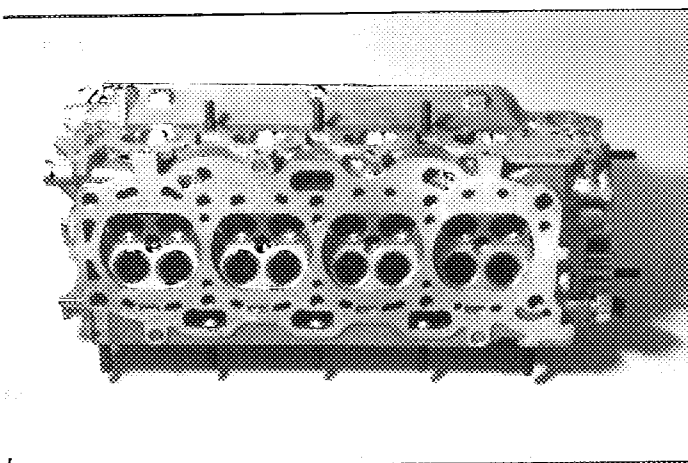

G) Chambre de combustion
Combustion chamber

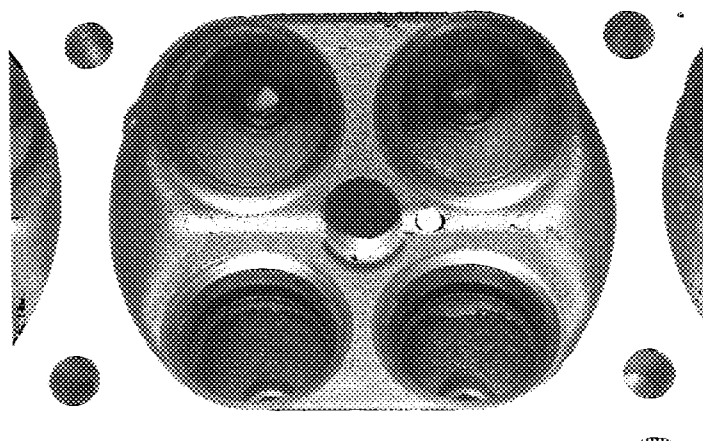

323. Alimentation par carburateur : a) Nombre de carburateurs X X X X
Fuel feed by carburettor : Number of carburetors
- b) Type X X X X c) Marque et modèle X X X X
Type Make and model
- d) Nombre de passages de gaz par carburateur X X X X
Number of mixture passages per carburettor
- e) Diamètre maximum de la sortie de gaz du carburateur X X X X mm
Maximum diameter of the carburettor mixture exit port
- f) Diamètre du diffuseur au point d'étranglement maximum X X X X +/- 0.25 mm
Diameter of the venturi at the narrowest point

H) Carburateur(s)
Carburettor(s)

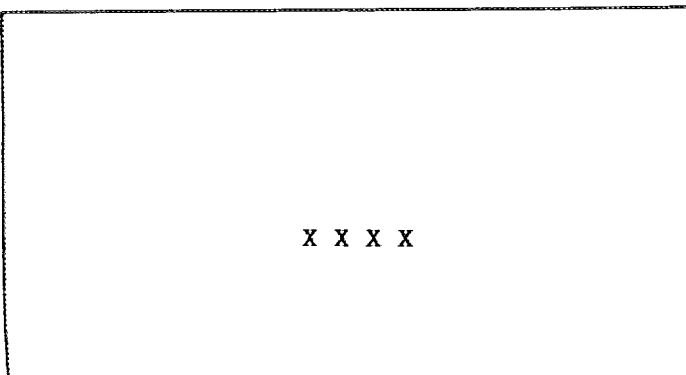

AUTOMOBILE ASSOCIATION MALAYSIA
25, Jalan Yap Kwan Seng
Bangsar Kuala Lumpur
50450 Kuala Lumpur

FEDERATION INTERNATIONALE
DE L'AUTOMOBILE
8, Place de la Concorde, 8
75008 PARIS

Marque PROTON
 Make _____

Modèle WIRA 1.6XLi (C98S)
 Model PERSONA 1.6XLi (C98S)

A-5524

324. Alimentation par injection : a) Marque MITSUBISHI b) Modèle ECI-MULTI
 Fuel feed by injection : Make _____ Model _____

c) Mode de dosage du carburant :
 Kind of fuel measurement :

mécanique	électronique	hydraulique
mechanical	electronic	hydraulic

d) Dimensions du conduit d'admission au niveau du papillon ou de la guillotine Ø 50.0 +/- 0.25 mm
 Dimensions of intake pipe at the throttle or slide location _____

e) Nombre de sorties effectives de carburant 4
 Number of effective fuel outlets _____

f) Position des injecteurs
 Position of injectors _____

11)

Collecteur Manifold	Culasse Cylinderhead
------------------------	---

g) Capteurs du système d'injection Water temperature sensor, Air temperature sensor,
 Sensors of injection system _____

Pressure sensor, Throttle position sensor, Karman vortex type Air flow meter,

Crank angle sensor, Cam angle sensor, Knock sensor

(Oxygen sensor fitted to PERSONA 1.6XLi model only)

h) Actionneurs du système d'injection Injectors, Pressure regulator
 Actuators of injection system _____

H) Système d'injection
 Injection system

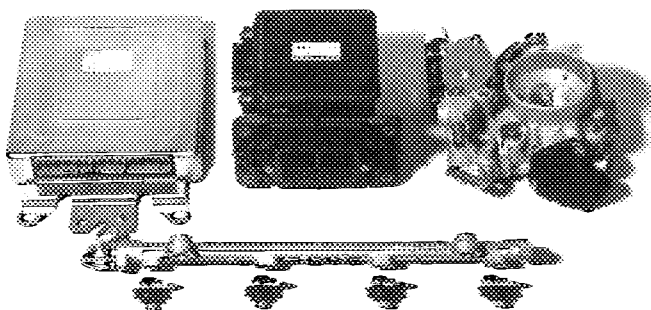

P/BA-FC-1990-00801/FBI 10 90

AUTOMOBILE ASSOCIATION MALAYSIA
 25, Jalan Yap Kwan Seng
 50450 Kuala Lumpur, Malaysia

FEDERATION INTERNATIONALE
 DE L'AUTOMOBILE
 6, Place de la Concorde, 8
 75008 PARIS

Marque
Make

PROTON

Modèle
Model

WIRA 1.6XLi (C98S)
PERSONA 1.6XLi (C98S)

Homologation No

A-5524

XIV) LOCALISATION DES CAPTEURS ET ACTIONNEURS / LOCATION OF SENSORS AND ACTUATORS :

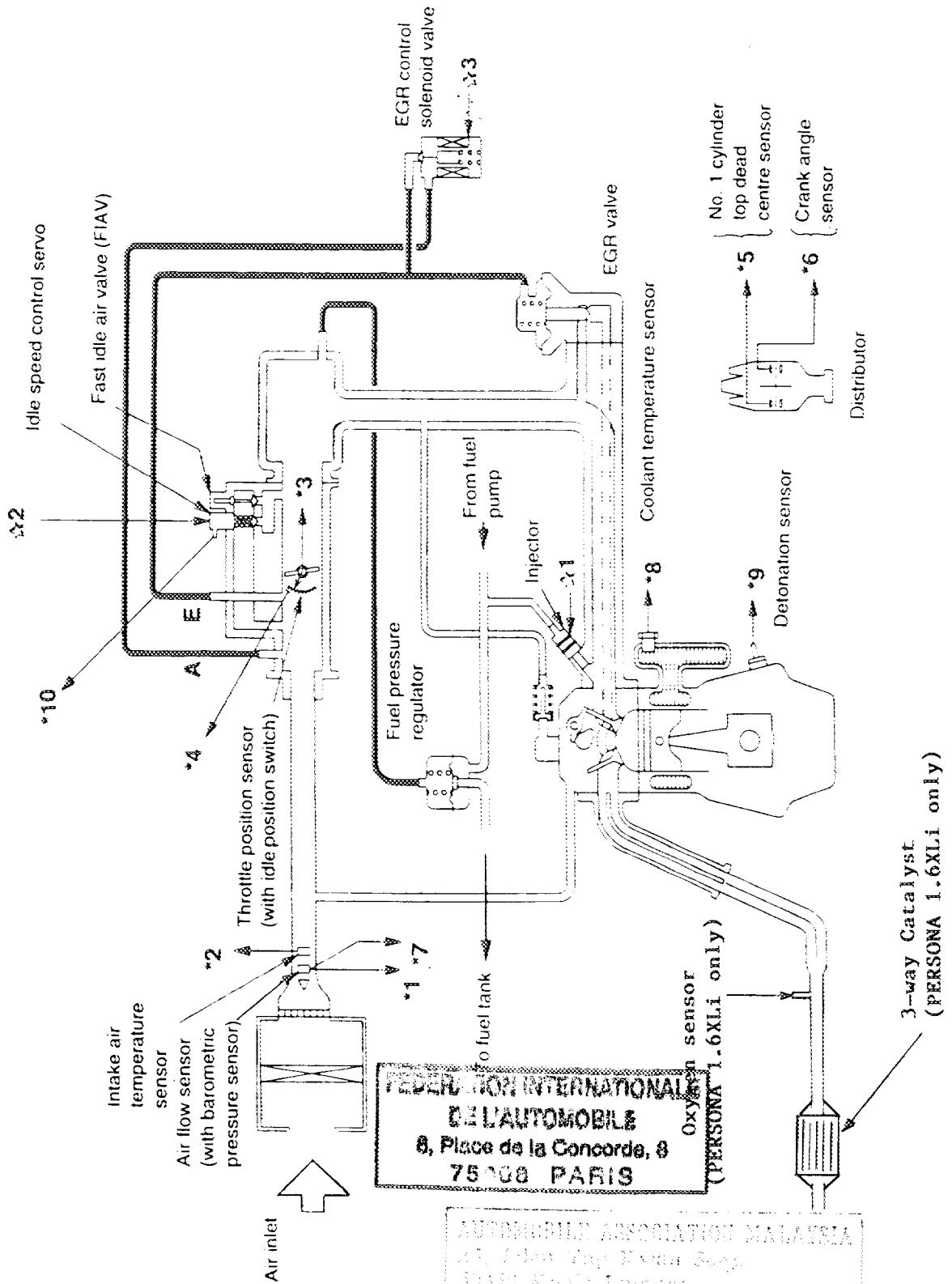

(C) PSA - FC - 1990 - 008.01.FB.10.90

AUTOMOBILE ASSOCIATION MALAYSIA
 25, Jalan Yap Kwan Seng,
 50450 Kuala Lumpur
 Tel: 330 2222, 330 2223
 Fax: 330 2224, 330 2225

Marque PROTON
Make _____

Modèle
Model

WIRA 1.6XLi (C98S)
PERSONA 1.6XLi (C98S)

Homologation No

A-5524

325. Arbre à cames : a) Nombre 1 b) Emplacement TOP (SOHC)
Camshaft : Number Location
- c) Système d'entraînement Notched Belt d) Nombre de paliers par arbre 5
Drive system Number of bearings per shaft
- f) Système de commande de soupapes Rocker Arm
Type of valve operation

327. Admission : a) Matériau du collecteur Aluminum Alloy
Intake : Material of manifold
- b) Nombre d'éléments du collecteur 1 c) Nombre de soupapes par cylindre 2
Number of manifold elements Number of valves per cylinder
- d) Diamètre maximum de soupape ∅ 30.2 mm e) Diamètre de tige de soupape dans guide ∅ 6.15 $+0/-0.2$ mm
Maximum diameter of the valve Diameter of the valve stem in guide
- f) Longueur de soupape 110.15 $+/- 1.5$ mm g) Type des ressorts de soupape Helical
Valve length Type of valve springs

328. Echappement : a) Matériau du collecteur Cast-iron
Exhaust : Material of manifold
- b) Nombre d'éléments du collecteur 1 c) Dimensions intérieures de sortie collecteur ∅ 44.0 ± 2.0 mm
Number of manifold elements Internal dimensions of manifold exit
- d) Nombre de soupapes par cylindre 2 e) Diamètre maximum de soupape ∅ 27.2 mm
Number of valves per cylinder Maximum diameter of the valve
- f) Diamètre de tige de soupape dans guide ∅ 6.15 $+0/-0.2$ mm g) Longueur de soupape 113.7 $+/-1.5$ mm
Diameter of the valve stem in guide Valve length
- h) Type des ressorts de soupape Helical
Type of valve springs

I) Collecteur d'admission
Intake manifold

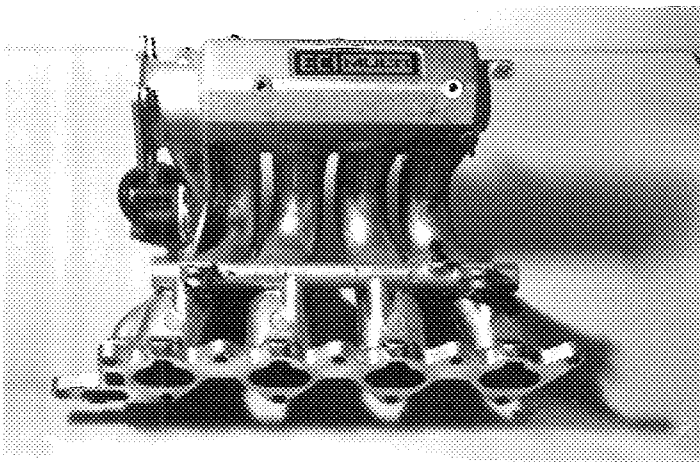

J) Collecteur d'échappement
Exhaust manifold

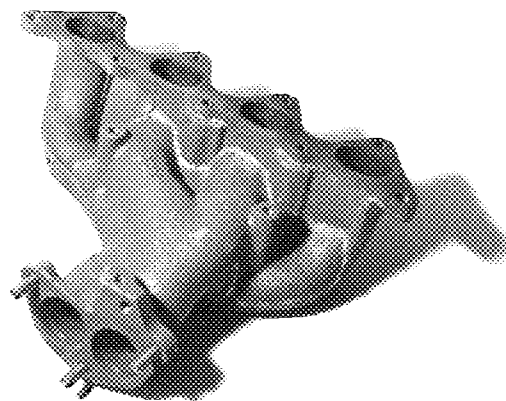

Q/PSA-FC-1920-008.01.FB.10.90

AUTOMOBILE ASSOCIATION MALAYSIA
25, Jalan Yap Kwan Seng
50450 Kuala Lumpur
Tel: 3425777/3425210 (Travel)
2425212 (Breakdown Services)

FEDERATION INTERNATIONALE
DE L'AUTOMOBILE
8, Place de la Concorde, 8
75008 PARIS

$\emptyset 44 \pm 2.0$ mm

Marque
Make

PROTON

Modèle
Model

WIRA 1.6XLi (C98S)
PERSONA 1.6XLi (C98S)

A-5524

Dessins des orifices du moteur - tolérances sur les dimensions : -2%, +4%
Drawings of engine ports - tolerances on dimensions : -2%, +4%

I) Culasse, face collecteur / Cylinderhead, manifold side

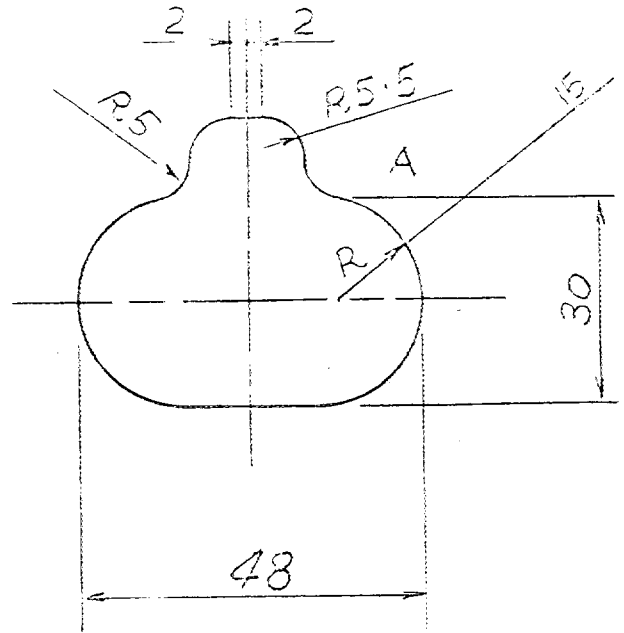
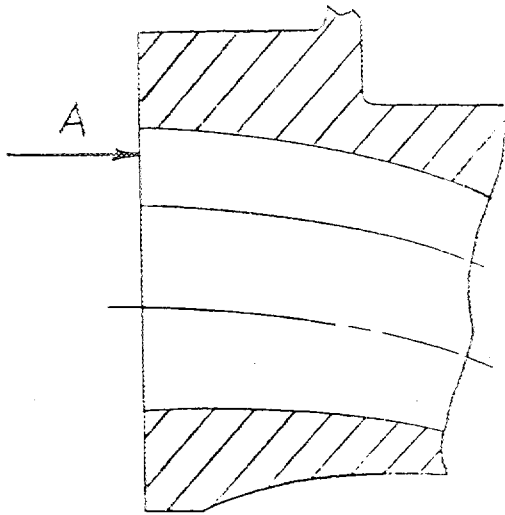

II) Collecteur, côté culasse / Manifold, cylinderhead side

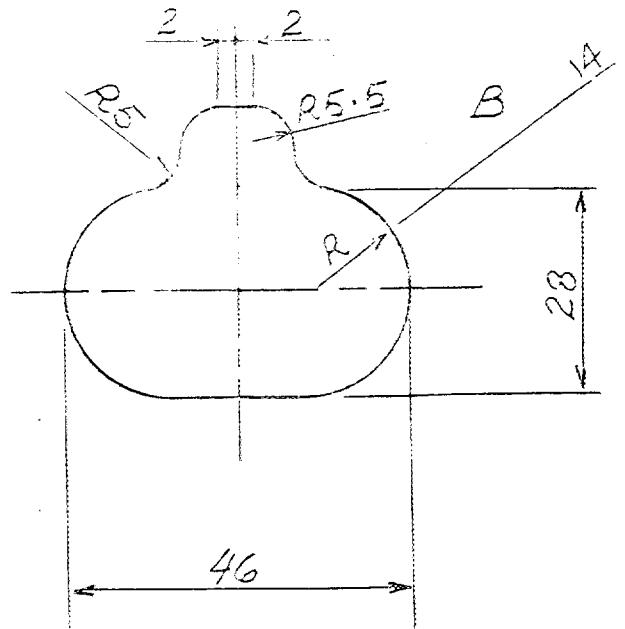
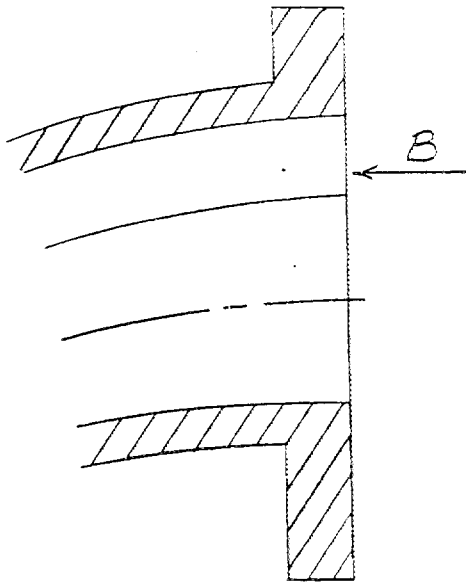

ADMISSION/INTAKE

Marque
Make

PROTON

Modèle
Model

WIRA 1.6XLi (C98S)
PERSONA 1.6XLi (C98S)

Homologation No

A - 5524

Dessins des orifices du moteur - tolérances sur les dimensions : -2%, +4%
Drawings of engine ports - tolerances on dimensions : -2%, +4%

III) Cuiasse, face collecteur / Cylinderhead, manifold side

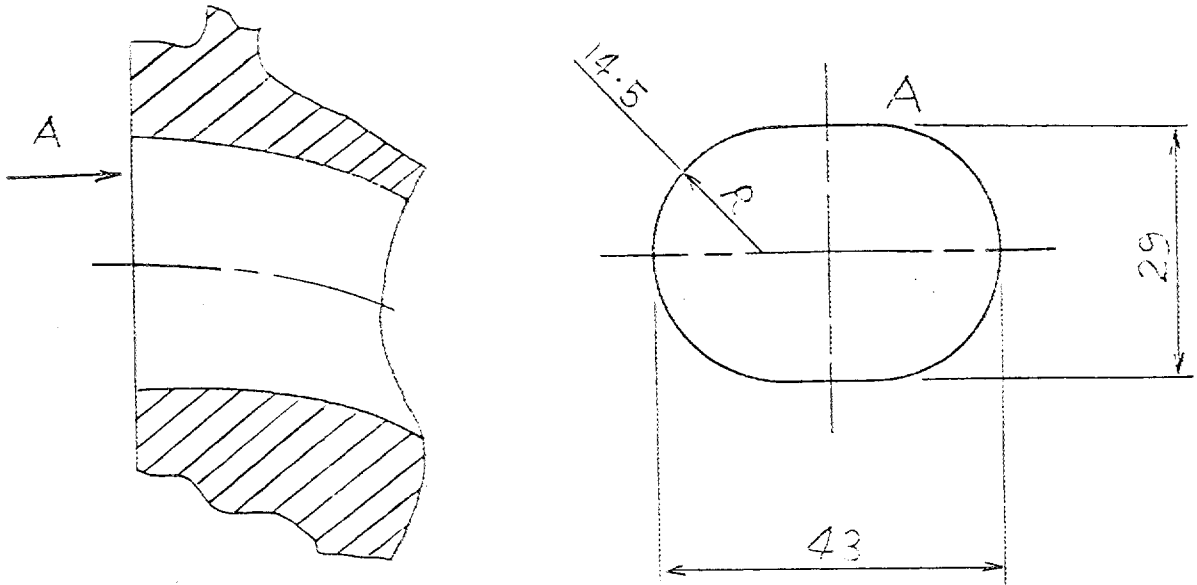

IV) Collecteur, côté cuiasse / Manifold, cylinderhead side

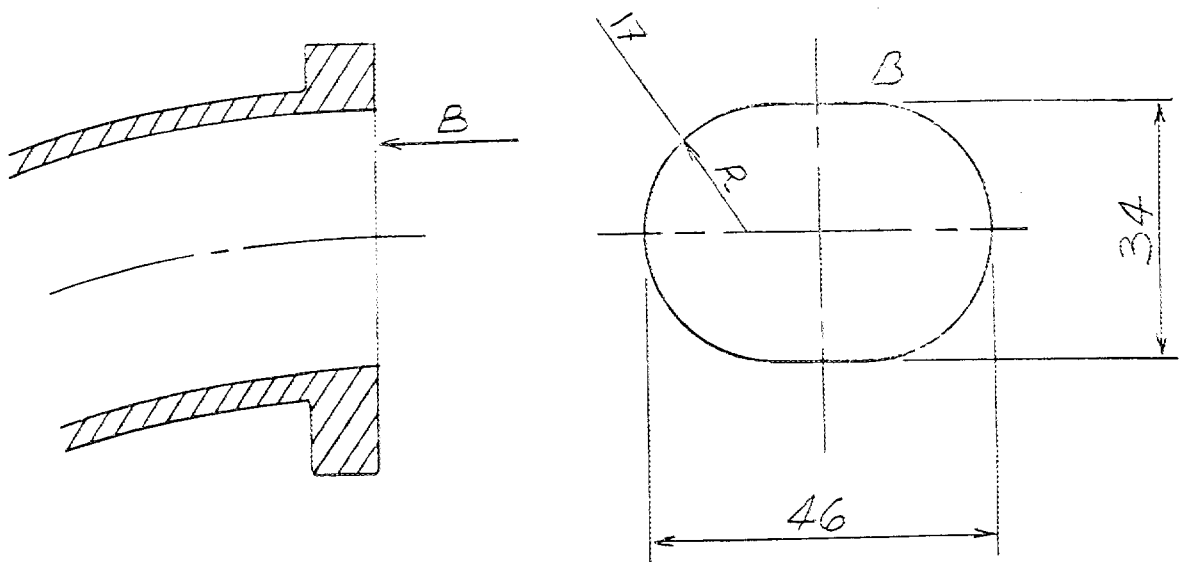

Marque PROTON
 Make _____

Modèle WIRA 1.6XLi (C98S)
 Model PERSONA 1.6XLi (C98S)

A - 5 5 2 4

330. Système d'allumage :
 Ignition system :

b) Nombre de bougies par cylindre 1 c) Nombre de distributeurs 1
 Number of plugs per cylinder _____ Number of distributors _____

333. Système de lubrification : a) Type Wet Sump b) Nombre de pompes à huile 1
 Lubrication system : Type _____ Number of oil pumps _____

AUTOMOBILE ASSOCIATION MALAYSIA
 25, Jalan Yap Kwan Seng
 50450 Kuala Lumpur
 Tel: 2425777/2425210 (Travel)
 2425212 (Breakdown Services)

FEDERATION INTERNATIONALE
 DE L'AUTOMOBILE
 8, Place de la Concorde, 8
 75008 PARIS

Marque Make PROTON

Modèle Model WIRA 1.6XLi (C98S)
PERSONA 1.6XLi (C98S)

Homologation No

A-0524

4. CIRCUIT DE CARBURANT / FUEL CIRCUIT

401. Réservoir : a) Nombre 1
Fuel tank : Number 1
b) Emplacement Under the rear seat
Location Under the rear seat
c) Matériau Steel
Material Steel

5. EQUIPEMENT ELECTRIQUE / ELECTRICAL EQUIPMENT

501. Batteries : a) Nombre 1 b) Tension 12 volts
Batteries : Number 1 Tension 12 volts

6. TRANSMISSION / POWER TRAIN

601. Roues motrices : avant

oui	non
yes	no

 arrière

oui	non
yes	no

Driven wheels : front rear

602. Embrayage : b) Système de commande Hydraulic c) Nombre de disques 1
Clutch : Control system Number of plates

603. Boîte de vitesses : a) Emplacement Engine Compartment of the car
Gearbox : Location

b) Marque "manuelle" MITSUBISHI c) Marque "automatique" X X X X
"Manual" make "Automatic" make

d) Type et emplacement de commande Mechanical, on floor
Type and location of control

(C) FSA - FC - 1990 - 00801.FE.10.90

AUTOMOBILE ASSOCIATION MALAYSIA
25, Jalan Yap Kwan Seng
50450 Kuala Lumpur
Tel: 2425777/2425210 (Travel)
2425212 (Breakdown Services)

FEDERATION INTERNATIONALE
DE L'AUTOMOBILE
8, Place de la Concorde, 8
75008 PARIS

Marque PROTON
 Make _____

Modèle WIRA 1.6XLi (C98S)
 Model PERSONA 1.6XLi (C98S)

Homologation No

A - 5 5 2 4

e) Rappports Ratios

	Manuelle Manual			
	nombre de dents number of teeth	rapport ratio	constant	synchro
1	37/12	3.083	X	X
2	37/19	1.947	X	X
3	36/28	1.285	X	X
4	31/33	0.939	X	X
5	28/37	0.756	X	X
6	-	-	-	-
AR / R	37/12	3.083	X	
Constante Constant	34/31	1.096		

f) Grille de vitesses
 Gear change gate

	Automatique Automatic		
	nombre de dents number of teeth	rapport ratio	synchro
1			
2			
3			
4			
5			
AR/R			

g) Type de lubrification By Splash
 Type of lubrication _____

h) Carter de boîte de vitesses et cloche d'embrayage
 Gearbox casing and clutch bell housing

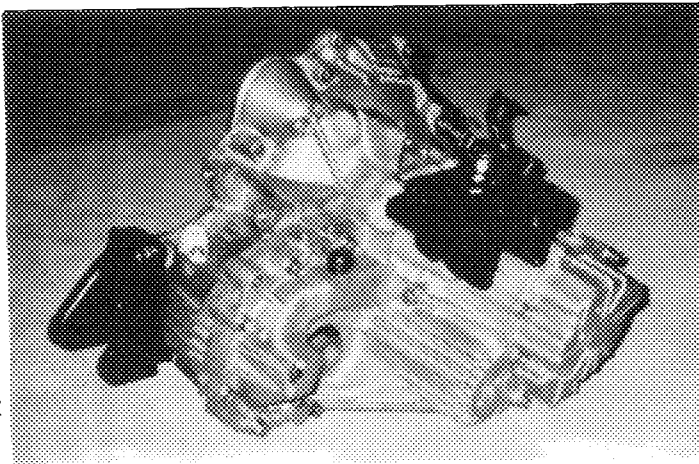

AUTOMOBILE ASSOCIATION MALAYSIA
 25, Jalan Yap Siew Song
 50450 Kuala Lumpur
 Tel: 2425777/2425210 (Travel)
 2425211 (Car & Motor Services)

FEDERATION INTERNATIONALE
 DE L'AUTOMOBILE
 8, Place de la Concorde, 8
 75008 PARIS

Marque PROTON
 Make _____

Modèle WIRA 1.6XLi (C98S)
 Model PERSONA 1.6XLi (C98S)

A - 5 5 2 4

604. Boîte de transfert / différentiel central : a) Rapports X X X X
 Transfer box / central differential : Ratios
 b) Nombres de dents X X X X
 Numbers of teeth
 c) Système de commande de boîte de transfert X X X X
 Control system of transfer box
 d) Type de différentiel central X X X X
 Type of central differential

605. Couple final
 Final drive

	Avant / Front	Arrière / Rear
a) Type de couple final Type of final drive	Helical Gear	X X X X
b) Rapport Ratio	3.941	X X X X
c) Nombre de dents Number of teeth	67/17	X X X X
e) Type de lubrification Type of lubrication	Oil Bath	X X X X

606. Arbres : a) Type des arbres longitudinaux X X X X
 Shafts : Type of longitudinal shafts
 b) Matériau des arbres longitudinaux X X X X
 Material of longitudinal shafts
 c) Type des demi-arbres transversaux Ball joint + Tripod joint
 Type of transversal half-shafts
 d) Matériau des demi-arbres transversaux Steel
 Material of transversal half-shafts

XII) CHAÎNE CINÉMATIQUE (4 roues motrices) / KINEMATIC TRAIN (4 wheel drive) :

X X X X

ANTONETTI & C. S.p.A. MILANO
 25, Viale Val d'Aosta 1000
 50450 Monte Catini (PT)
 Tel: 2425777/2425210 (central)
 2425212 (branch town service)

FEDERATION INTERNATIONALE
 DE L'AUTOMOBILE
 8, Place de la Concorde, 8
 75008 PARIS

Marque
Make

PROTON

Modèle
Model

WIRA 1.6XLi (C98S)
PERSONA 1.6XLi (C98S)

Homologation No

A-5524

7. SUSPENSION / SUSPENSION

701. Généralités
General

	Avant / Front	Arrière / Rear
a) Type de suspension Type of suspension	Independent McPherson with Coil spring	Independent Multi link with trailing arm and coil spring
702. Ressorts hélicoïdaux Helicoïdal springs	<input checked="" type="checkbox"/> oui <input checked="" type="checkbox"/> yes	<input checked="" type="checkbox"/> oui <input checked="" type="checkbox"/> yes
703. Ressorts à lames Leaf springs	<input type="checkbox"/> oui <input checked="" type="checkbox"/> yes	<input type="checkbox"/> oui <input checked="" type="checkbox"/> yes
704. Barres de torsion Torsion bars	<input checked="" type="checkbox"/> oui <input checked="" type="checkbox"/> yes	<input type="checkbox"/> oui <input checked="" type="checkbox"/> yes

705. Autre type de suspension :
Other type of suspension :

Voir description sur fiche additionnelle
See description on additional form

707. Amortisseurs :
Shock absorbers :

	Avant / Front	Arrière / Rear
a) Nombre par roue Number per wheel	<u>1</u>	<u>1</u>
b) Type Type	Telescopic	Telescopic
c) Principe de fonctionnement Principle of operation	Hydraulic	Hydraulic

T) Train avant complet déposé
Complete dismantled front axle

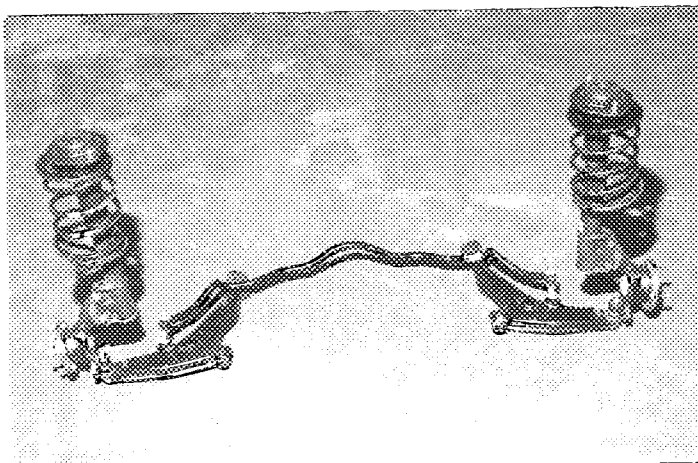

U) Train arrière complet déposé
Complete dismantled rear axle

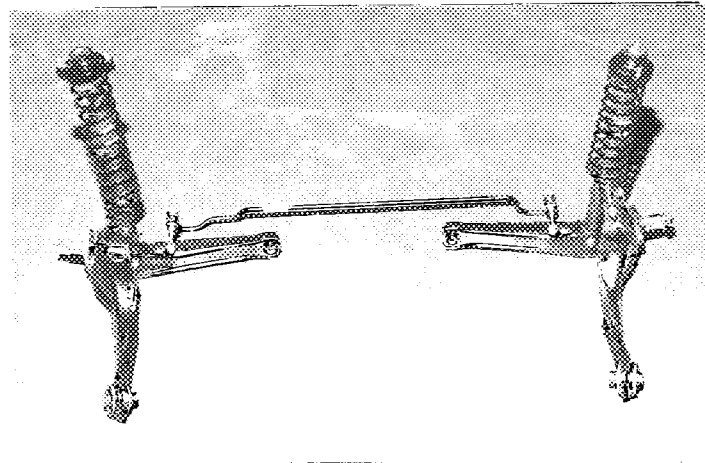

(C) FISA - FC - 1990 - 08/01/FR/10/90

AUTOMOBILE ASSOCIATION MALAYSIA
25, Jalan Yap Kwan Song
50450 Kuala Lumpur
Tel: 2425777/2425219 (Travel)
2425212 (Breakdown Services)

FEDERATION INTERNATIONALE
DE L'AUTOMOBILE
8, Place de la Concorde, 8
75008 PARIS

Marque / Make: PROTON

Modèle / Model: WIRA 1.6XLi (C98S)
PERSONA 1.6XLi (C98S)

Homologation No

A-5524

8. TRAIN ROULANT / RUNNING GEAR

	Avant / Front	Arrière / Rear
801. Roues / Wheels:		
a) Diamètre / Diameter:	<u>14</u> " / <u>Ø 355.6</u> mm	<u>14</u> " / <u>Ø 355.6</u> mm

803. Freins / Brakes:

a) Système de freinage / Braking system: Hydraulic

b) Nombre de maître-cylindres / Number of master cylinders: Tandem

bt) Alésages / Bores: Ø 22.22 mm / Ø 22.22 mm

c) Servo-frein / Servo-brakes: oui / yes

c1) Marque et type / Make and type: JIDOSHAKIKI, Vacuum

d) Régulateur de freinage / Braking regulator: oui / yes

d1) Emplacement / Location: Under the master cylinder in the engine compartment.

	Avant / Front	Arrière / Rear
e) Nombre de cylindres par roue / Number of cylinders per wheel:	<u>1</u>	<u>1</u>
e1) Alésage / Bore:	<u>Ø 53.97</u> mm	<u>Ø 30.16</u> mm
f) Freins à tambours / Drum brakes:		
f1) Diamètre intérieur / Internal diameter:	<u>X X X X</u> +/- 1.5 mm	<u>X X X X</u> +/- 1.5 mm
f2) Nombre de garnitures par roue / Number of linings per wheel:	<u>X X X X</u>	<u>X X X X</u>
f3) Longueur développée des garnitures / Developed length of linings:	<u>X X X X</u> +/- 1.5 mm	<u>X X X X</u> +/- 1.5 mm
f4) Largeur des garnitures / Width of the linings:	<u>X X X X</u> +/- 1 mm	<u>X X X X</u> +/- 1 mm
g) Freins à disques / Disc brakes:		
g1) Nombre de plaquettes par roue / Number of pads per wheel:	<u>2</u>	<u>2</u>
g2) Nombre d'étriers par roue / Number of calipers per wheel:	<u>1</u>	<u>1</u>
g3) Matériau des étriers / Caliper material:	<u>Cast iron</u>	<u>Cast iron</u>
g4) Epaisseur du disque neuf / Thickness of new disc:	<u>24</u> +/- 1 mm	<u>10</u> +/- 1 mm
g5) Diamètre extérieur du disque / External diameter of the disc:	<u>256</u> +/- 1.5 mm	<u>260</u> +/- 1.5 mm
g6) Diamètre extérieur de frottement des plaquettes / External diameter of rubbing surface of pads:	<u>254</u> +/- 1.5 mm	<u>258</u> +/- 1.5 mm

© FISA - FC - 1990 - 00601/FB/10.90

ASSOCIATION MALAYSIA
50450 Kuala Lumpur
Tel: 2425777 / 2425210 (Travel)
2425212 (Breakdown Services)

FEDERATION INTERNATIONALE
DE L'AUTOMOBILE
8, Place de la Concorde, 8
75008 PARIS

Marque PROTON
 Make _____

Modèle WIRA 1.6XLi (C98S)
 Model PERSONA 1.6XLi (C98S)

Homologation No

A - 5524

g7) Diamètre intérieur de frottement des plaquettes
 Internal diameter of pads' rubbing surface

Avant / Front	Arrière / Rear								
166 +/- 1.5 mm	195 +/- 1.5 mm								
112 +/- 1.5 mm	80 +/- 1.5 mm								
<table border="1"> <tr> <td>oui</td> <td>non</td> </tr> <tr> <td>yes</td> <td>no</td> </tr> </table>	oui	non	yes	no	<table border="1"> <tr> <td>oui</td> <td>non</td> </tr> <tr> <td>yes</td> <td>no</td> </tr> </table>	oui	non	yes	no
oui	non								
yes	no								
oui	non								
yes	no								

g8) Longueur hors-tout des plaquettes
 Overall length of the pads

g9) Disques ventilés
 Ventilated discs

h) Frein de stationnement :
 Parking brake :

h1) Système de commande Cable
 Control system

h2) Emplacement de commande
 Location of lever

Between front seat

h3) Effet sur roues
 On which wheels

Avant	Arrière
Front	Rear

V) Frein avant
 Front brake

W) Frein arrière
 Rear brake

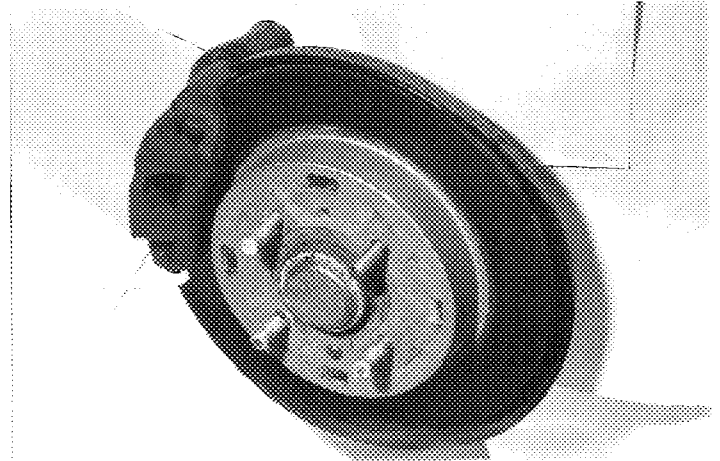
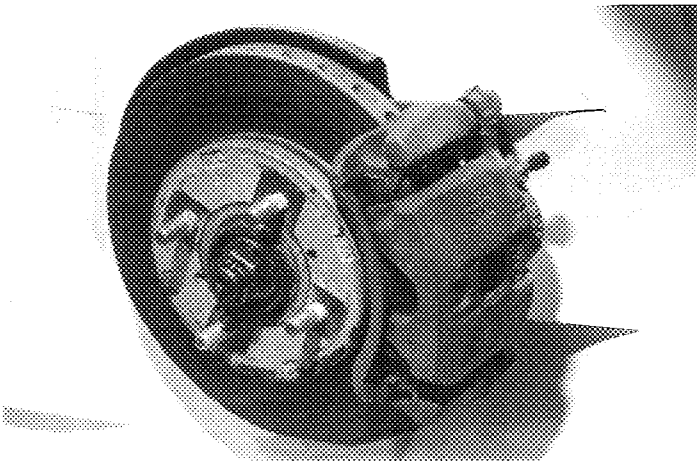

804. Direction :
 Steering :

a) Type
 Type

Avant / Front	Arrière / Rear								
Rack & Pinion	X X X X								
<table border="1"> <tr> <td>oui</td> <td>non</td> </tr> <tr> <td>yes</td> <td>no</td> </tr> </table>	oui	non	yes	no	<table border="1"> <tr> <td>oui</td> <td>non</td> </tr> <tr> <td>yes</td> <td>no</td> </tr> </table>	oui	non	yes	no
oui	non								
yes	no								
oui	non								
yes	no								
Hydraulic	X X X X								

b) Servo-assistance
 Power assisted

Type
 Type

Marque PROTON
 Make _____

Modèle WIRA 1.6XLi (C98S)
 Model PERSONA 1.6XLi (C98S)

Homologation No

A-5524

9. CARROSSERIE / BODYWORK

901. Intérieur : a) Ventilation

oui	non
yes	no

b) Chauffage

oui	non
yes	no

f) Toit ouvrant optionnel

oui	non
yes	no

f1) Type X X X X
 Type _____

f2) Système de commande X X X X
 Control system _____

Avant / Front	Arrière / Rear
Manual	Manual

g) Système d'ouverture des vitres latérales
 Opening system for side windows

X) Tableau de bord
 Dashboard

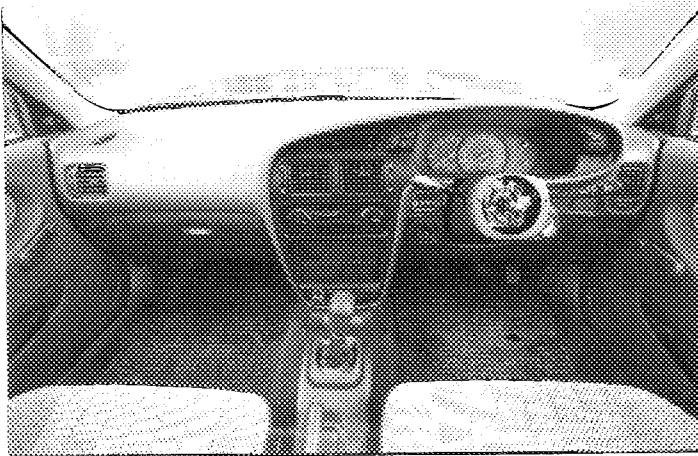

Y) Toit ouvrant
 Sunroof

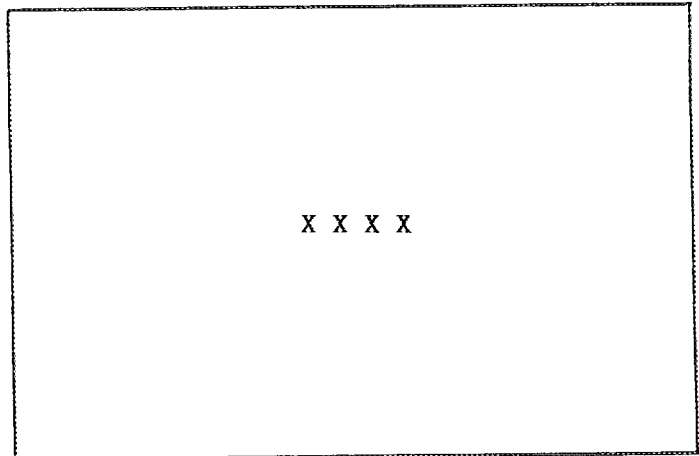

(C) PSA - FC - 1990 - 008.01.FB.10.90

AUTOMOBILE ASSOCIATION MALAYSIA
 25, Jalan Yap Kwan Song
 50450 Kuala Lumpur
 Tel: 24239773 / 24239770 (Toll-free)
 24239710 (Kuala Lumpur Division)

FEDERATION INTERNATIONALE
 DE L'AUTOMOBILE
 8, Place de la Concorde, 8
 75008 PARIS

Marque
Make

PROTON

Modèle
Model

WIRA 1.6XLi (C98S)
PERSONA 1.6XLi (C98S)

Homologation No

A-5524

902. Extérieur :
Exterior :

a) Nombre de portes
Number of doors 4

b) Hayon
Tailgate

oui	non
yes	no

c) Matériau des portières
Door material

Avant / Front	Arrière / Rear
Steel	Steel

d) Matériau du capot avant
Front bonnet material Steel

e) Matériau du capot arrière / hayon
Rear bonnet / tailgate material Steel

f) Matériau de la carrosserie
Bodywork material Steel

h) Matériau de lunette arrière
Rear window material Safety Glass

i) Matériau des glaces de custode
Rear quarter window material Safety Glass

k) Matériau des vitres latérales
Side window material

Avant / Front	Arrière / Rear
Safety Glass	Safety Glass
Plastics (Modified Poly-Propylene)	Plastics (Modified Poly-Propylene)

l) Matériau du pare-choc
Material of bumper

XIII) PARTIES DE CARROSSERIE SYNTHETIQUES / SYNTHETIC PARTS OF THE BODY :

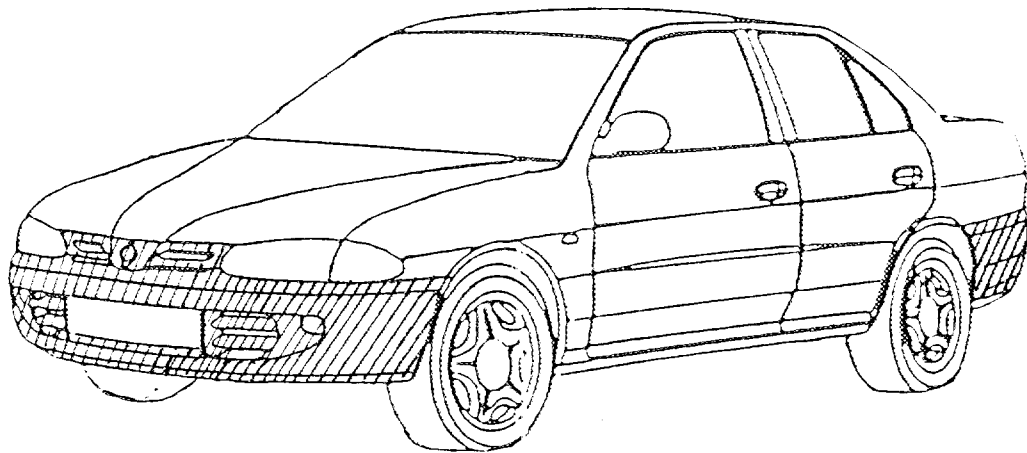

(C) FISA - FC- 1990 - 00601FR10.90

AUTOMOBILE ASSOCIATION MALAYSIA
 25, Jalan Yap Kwan Song
 50450 Kuala Lumpur
 Tel: 2425777/2425210 (Travel)
 2425212 (Breakdown Services)

FEDERATION INTERNATIONALE
 DE L'AUTOMOBILE
 8, Place de la Concorde, 8
 75008 PARIS

Marque
Make

PROTON

Modèle
Model

WIRA 1.6XLi (C98S)
PERSONA 1.6XLi (C98S)

Homologation No

A-5524

INFORMATIONS COMPLEMENTAIRES / COMPLEMENTARY INFORMATION :

X X X X

(C) FISA - FC - 1990 - 008.01.FR.10.90

AUTOMOBILE ASSOCIATION MALAYSIA
25, Jalan Yap Kwan Seng
50450 Kuala Lumpur
Tel: 2425777/2426210 (Travel)
2427111 (Breakdown Services)

FEDERATION INTERNATIONALE
DE L'AUTOMOBILE
8, Place de la Concorde, 8
75008 PARIS



FEDERATION INTERNATIONALE DU SPORT AUTOMOBILE

Homologation No

A-5524

Extension No

Groupe A/B/II
Group

CERTIFICAT DE DIMENSIONS INTERIEURES
CERTIFICATE FOR INTERIOR DIMENSIONS

PERUSAHAAN OTOMOBIL NASIONAL
BERHAD

PROTON WIRA 1.6XLi (C98S)
PROTON PERSONA 1.6XLi (C98S)

Véhicule: Constructeur
Vehicle: Manufactureur

Modèle et type
Model and type

Dimensions intérieures comme définies par le Règlement d'Homologation
Interior dimensions as defined by the Homologation Regulations

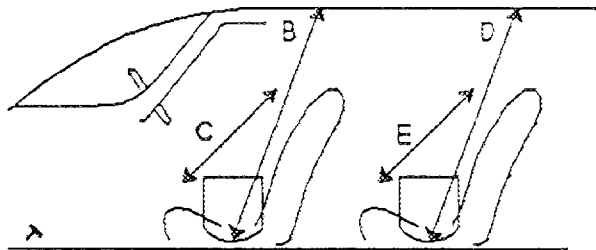

B	(Hauteur sur sièges avant) (Height above front seats)	<u>1015</u>	mm
C	(Largeur aux sièges avant) (Width at front seats)	<u>1240</u>	mm
D	(Hauteur sur sièges arrière) (Height above rear seats)	<u>935</u>	mm
E	(Largeur aux sièges arrière) (Width at rear seats)	<u>1375</u>	mm

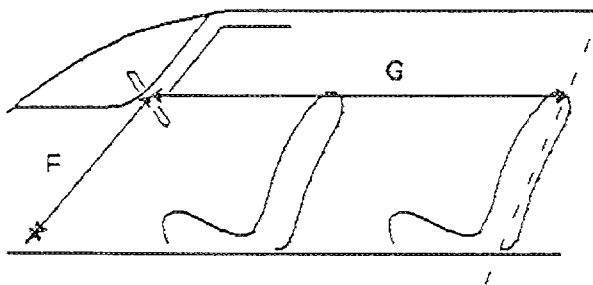

F	(Volant - Pédale de frein) (Steering wheel - Brake pedal)	<u>655</u>	mm
G	(Volant - paroi de séparation arrière) (Steering wheel - rear bulkhead)	<u>1575</u>	mm
H	= F + G =	<u>2230</u>	mm

© FISA - FC - 1990 - 004 02/ FB 10 90

AUTOMOBILE ASSOCIATION MALAYSIA
25, Jalan Yap Kwan Seng,
50450 Kuala Lumpur
Tel: 2425777/2425210 (Fax)
2425210 (Breakdown Services)

FEDERATION INTERNATIONALE
DE L'AUTOMOBILE
8, Place de la Concorde, 8
75008 PARIS

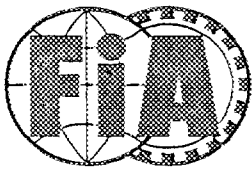

FEDERATION INTERNATIONALE
DU SPORT AUTOMOBILE

Homologation No

A-5524

Groupe A/B/N/T1
Group

Extension No

01/01VO

FICHE D'EXTENSION D'HOMOLOGATION POUR ARMATURE DE SECURITE
FORM OF HOMOLOGATION EXTENSION FOR SAFETY CAGE

VO Variante option / Option variant

Véhicule: Constructeur PERUSAHAAN OTOMOBIL NASIONAL BERHAD Modèle et type PROTON WIRA 1.6XLi (C98S)
Vehicle: Manufactureur PERUSAHAAN OTOMOBIL NASIONAL BERHAD Model and type PROTON PERSONA 1.6XLi (C98S)

Homologation valable à partir du 01 JUL. 1994
Homologation valid as from

	Arceau principal Main rollbar	Entretoise longitudinale Longitudinal strut	Entretoise diagonale Diagonal Strut	Arceau avant Front rollbar
Matériau Material	Steel	Steel	Steel	Steel
Diamètre extérieur Exterior diameter	38.1 mm	38.1 mm	38.1 mm	38.1 mm
Epaisseur de paroi Wall thickness	2.4 mm	1.6 mm	1.6 mm	2.4 mm
Limite élastique Elastic limit	76.3 kg/mm ²	70.0 kg/mm ²	70.0 kg/mm ²	76.3 kg/mm ²
Résistance à la traction Tensile strength	84.1 kg/mm ²	77.0 kg/mm ²	77.0 kg/mm ²	84.1 kg/mm ²

Fabricant de l'armature EON MOTORSPORTS Poids total y compris les fixations 35.0 kg
Structure manufacturer Total weight including fixations

Armature complète hors de la voiture
Complete structure outside the car

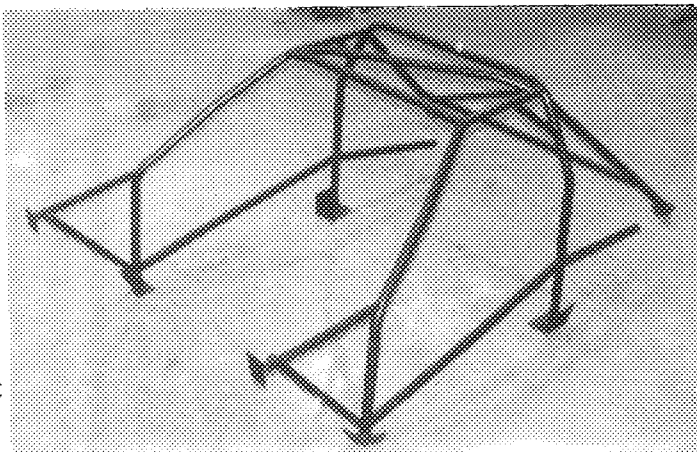

Nous attestons que la présente armature de sécurité répond aux dispositions de l'Annexe J de la FISA, en particulier en ce qui concerne ses implantations, ses connexions, et ses résistances aux contraintes.

We certify that the present safety structure complies with the conditions of the FISA Appendix J, in particular with regard to its attachments, its connections, and its strengths.

FEDERATION INTERNATIONALE
DE L'AUTOMOBILE
8, Place de la Concorde, 8
75008, PARIS

Signature du représentant du constructeur du véhicule
Signature of the car manufacturer representative

Kisai B Rahmat

KISAI B RAHMAT
Deputy Managing Director
Manufacturing
PROTON.

Marque
Make

PROTON

Modèle
Model

WIRA 1.6XLi (C98S)
PERSONA 1.6XLi (C98S)

Homologation No

A-5524

Extension No

01/01V0

PHOTO No 1 Lateral bar to floor

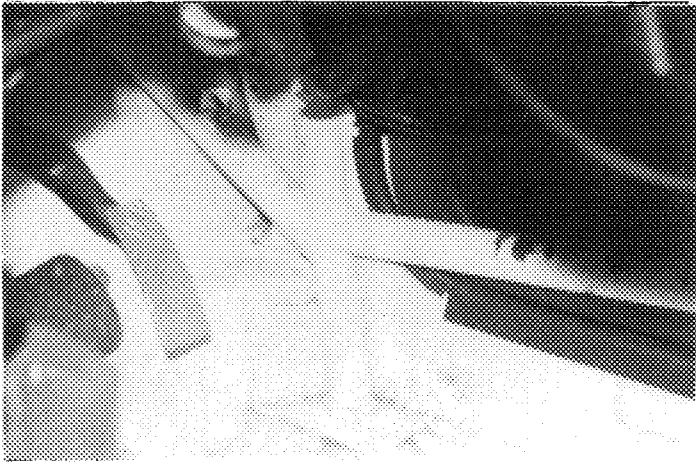

PHOTO No 2 Lateral bar to A-pillar

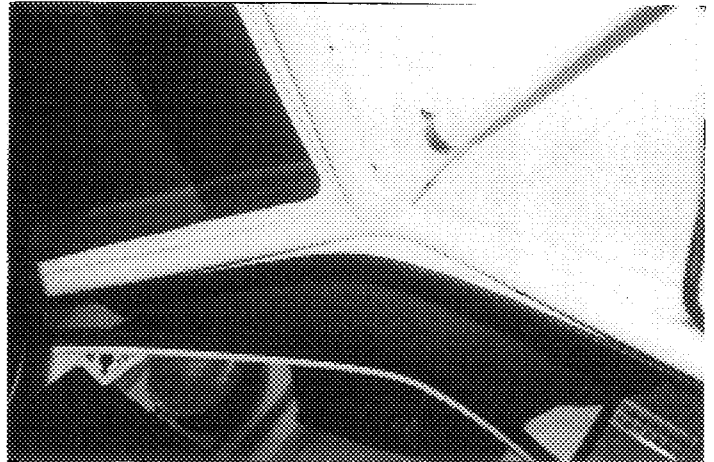

PHOTO No 3 Main rollbar to floor

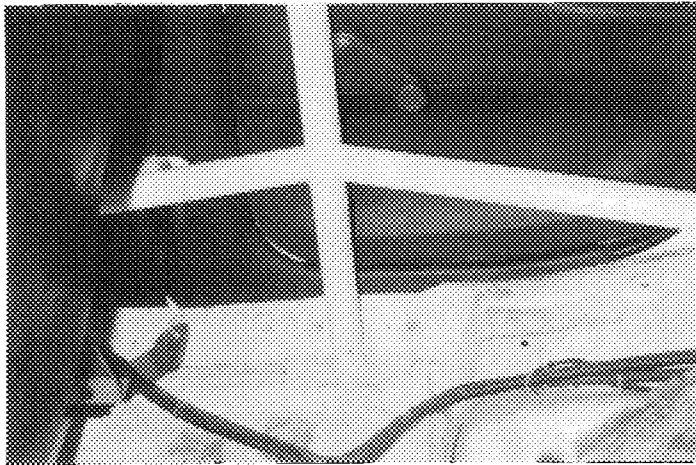

PHOTO No 4 Main rollbar to B-pillar

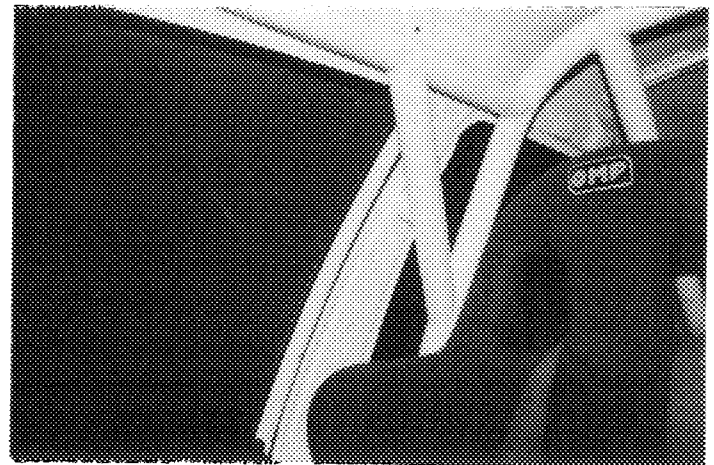

PHOTO No 5 Main/Lateral/Diagonal bar joint

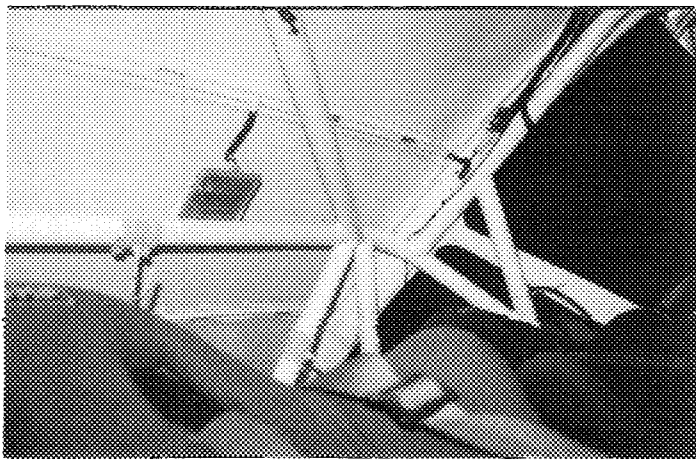
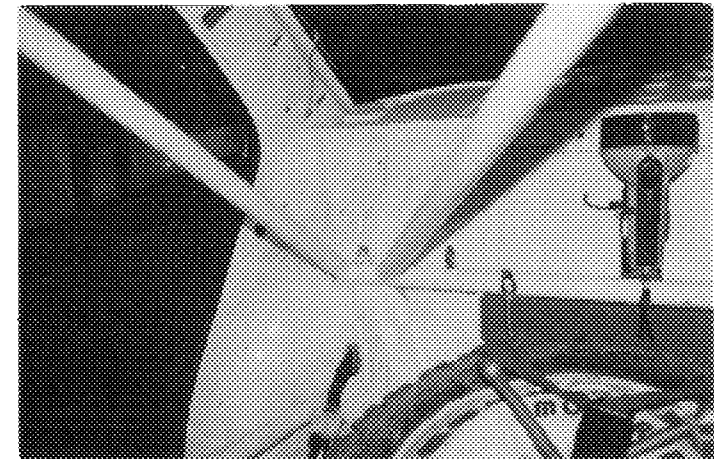

PHOTO No 6 Rear longitudinal/Diagonal to bulkhead



Marque PROTON
Make _____

Modèle PERSONA 1.6XLi (C98S)
Model _____

WIRA 1.6XLi (C98S)
PERSONA 1.6XLi (C98S)

Homologation No
A-5524

Extension No
01/01V0

PHOTO No 7 Rear longitudinal to rear turret

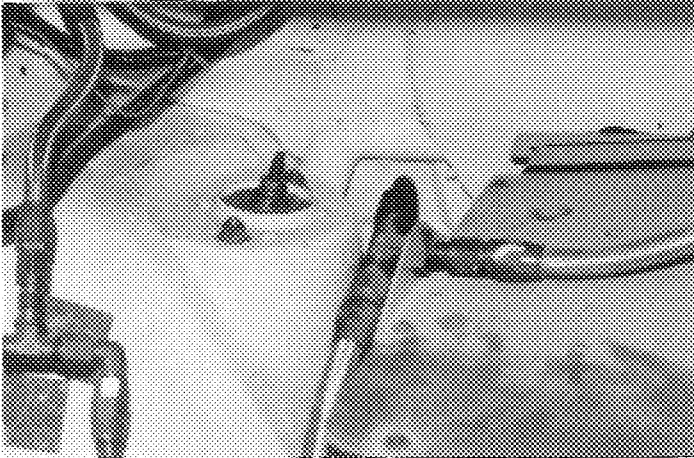

PHOTO No 8 Front turret framework to bulkhead

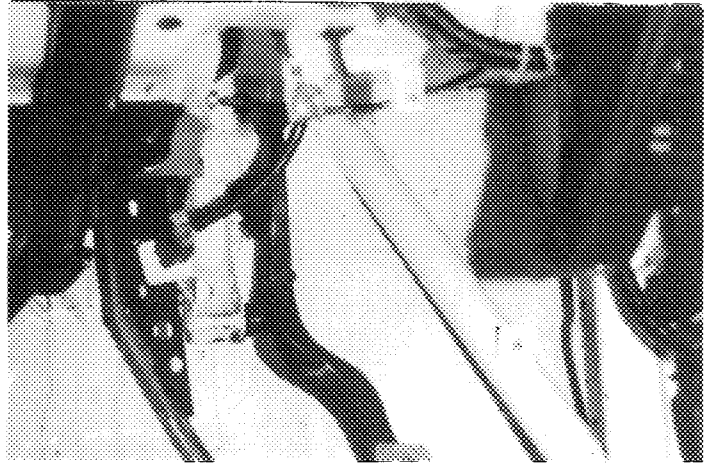

PHOTO No 9 Front framework to turret

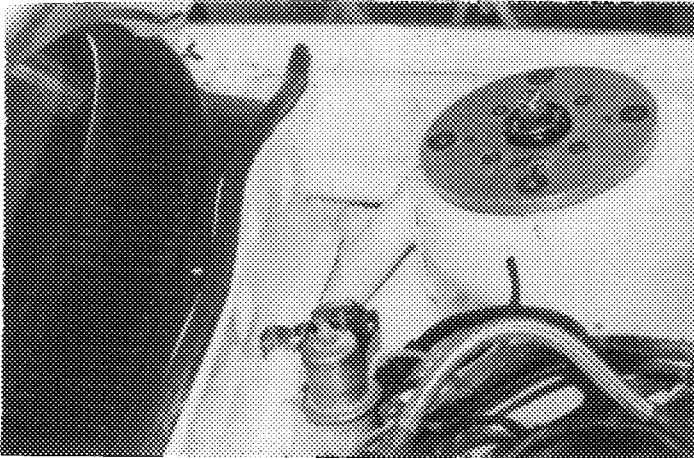

PHOTO No

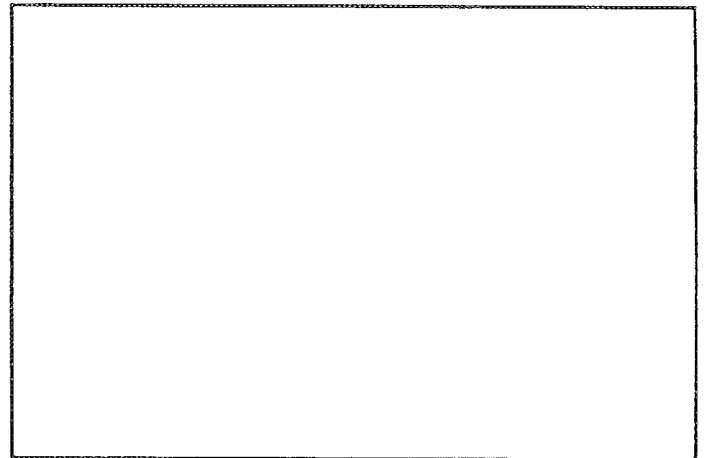

PHOTO No

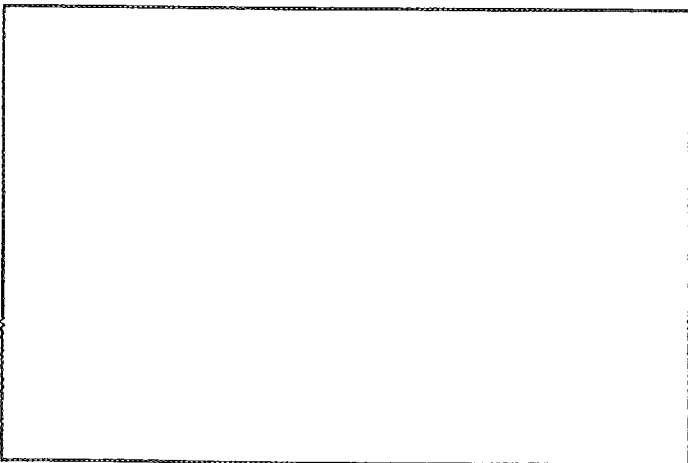
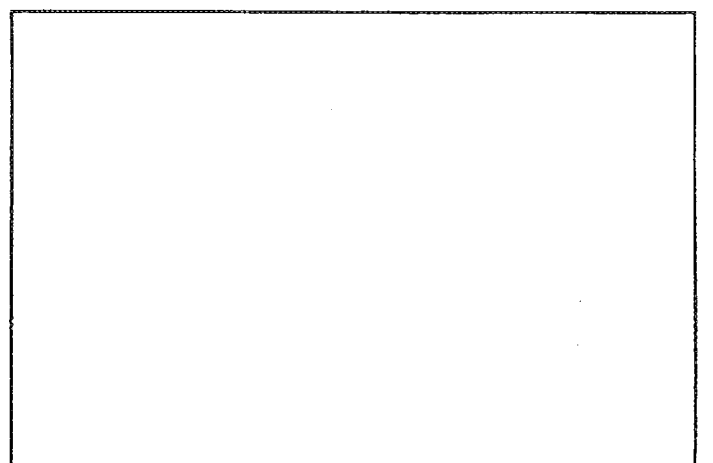
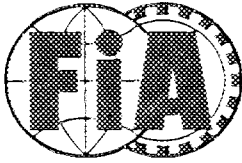

PHOTO No



AUTOMOBILE ASSOCIATION MALAYSIA
25, Jalan Tasek, Petaling Jaya
50450 Kuala Lumpur
Tel: 2472 2222 (Ext. 2222)
2472 2222 (Ext. 2222)

FEDERATION INTERNATIONALE
DE L'AUTOMOBILE
8, Place de la Concorde, 8
75008 PARIS



FEDERATION INTERNATIONALE
DU SPORT AUTOMOBILE

Homologation No

A-5524

Groupe
Group

A/B/N/T1

Extension No

02/02 VO

FICHE D'EXTENSION D'HOMOLOGATION
FORM OF HOMOLOGATION EXTENSION

- ES Evolution sportive du type / Sporting evolution of the type
- ET Evolution normale du type / Normal evolution of the type
- VF Variante de fourniture / Supply variant
- VO Variante option / Option variant
- ER Erratum / Erratum

PERUSAHAAN OTOMOBIL NASIONAL

PROTON WIRA 1.6XLi (C98S)

Véhicule: Constructeur
Vehicle: Manufactureur

BERHAD

Modèle et type
Model and type

PROTON PERSONA 1.6XLi (C98S)

Homologation valable à partir du
Homologation valid as from

01 JUL. 1994

Page ou ext. Page or ext.	Article Article	Description Description																																																		
	603	<p>GEARBOX</p> <p>b) Make : EON MOTORSPORTS</p> <p>d) Type and location : Mechanical, on floor</p> <p>e) Ratios</p> <table border="1"> <thead> <tr> <th colspan="5">Manual</th> </tr> <tr> <th></th> <th>Number of Teeth</th> <th>Ratio</th> <th>Constant</th> <th>Synchro</th> </tr> </thead> <tbody> <tr> <td>1</td> <td>33/16</td> <td>2.64</td> <td>X</td> <td></td> </tr> <tr> <td>2</td> <td>30/20</td> <td>1.92</td> <td>X</td> <td></td> </tr> <tr> <td>3</td> <td>25/21</td> <td>1.524</td> <td>X</td> <td></td> </tr> <tr> <td>4</td> <td>24/24</td> <td>1.28</td> <td>X</td> <td></td> </tr> <tr> <td>5</td> <td>23/27</td> <td>1.09</td> <td>X</td> <td></td> </tr> <tr> <td>6</td> <td>21/28</td> <td>0.96</td> <td>X</td> <td></td> </tr> <tr> <td>R</td> <td>38/12</td> <td>4.053</td> <td></td> <td></td> </tr> <tr> <td>Constant</td> <td>25/32</td> <td>1.280</td> <td></td> <td></td> </tr> </tbody> </table> <p>f) Gear change gate</p>	Manual						Number of Teeth	Ratio	Constant	Synchro	1	33/16	2.64	X		2	30/20	1.92	X		3	25/21	1.524	X		4	24/24	1.28	X		5	23/27	1.09	X		6	21/28	0.96	X		R	38/12	4.053			Constant	25/32	1.280		
Manual																																																				
	Number of Teeth	Ratio	Constant	Synchro																																																
1	33/16	2.64	X																																																	
2	30/20	1.92	X																																																	
3	25/21	1.524	X																																																	
4	24/24	1.28	X																																																	
5	23/27	1.09	X																																																	
6	21/28	0.96	X																																																	
R	38/12	4.053																																																		
Constant	25/32	1.280																																																		

(C) FISA - FC - 1990 - 01001/FBI10.90

AUTOMOBILE ASSOCIATION MALAYSIA
25, Jalan Yap Kwan Seng
50450 Kuala Lumpur
Tel: 2425777/2425210 (Travel)
2425232 (Breakdown Services)

Marque
Make

PROTON

Modèle
Model

WIRA 1.6XLi (C98S)
PERSONA 1.6XLi (C98S)

Homologation No

A-5524

Extension No

02/02VO

Page ou ext. Page or ext.	Article Article	Description Description
	603	GEARBOX (Cont'd)
Photo 1		Alternative gearbox case
	605	FINAL DRIVE
	a)	Type of final drive : Spur Gear
	b)	Ratio : 4.714 , 4.642 , 4.571 , 4.428 , 4.285
	c)	Number of teeth : 66/14 , 65/14 , 64/14 , 62/14 , 60/14
	606	SHAFTS
Photo 2		Reinforced Driveshaft, Front (LH)
Photo 3		Reinforced Driveshaft, Front (RH)
	7	SUSPENSION
Photo 4		Alternative Heavy Duty Front Knuckle.
Photo 5		Front Stabilizer bar Diameter : Ø 19mm - 26mm.
Photo 6		Rear Stabilizer bar Diameter : Ø 10mm - 20mm.
		Reinforced Front Wishbone Type : 1, 2, 3 Photo : 7, 8, 9
		Reinforced Trailing Arm Type : 1, 2, 3 Photo : 10, 11, 12
Photo 13		Reinforced Upper Transverse Link (Rear) Reinforced Lower Transverse Link (Rear) Type : 1, 2 Photo : 14, 15
Photo 16		Reinforced Toe Control Link (Rear) Reinforced Strut Top Mount Type : 1, 2, 3, 4 Photo : 17, 18, 19, 20

© FISA - FC - 1990 - 01001/11.10.90

AUTOMOBILE ASSOCIATION MALAYSIA
 25, Jalan Sultan Ismail
 50000 Kuala Lumpur
 Tel: 2425777/2425210 (Travel)
 2425212 (Breakdown Services)

FEDERATION INTERNATIONALE
 DE L'AUTOMOBILE
 8, Place de la Concorde, 8
 75008 PARIS

Marque
Make

PROTON

Modèle
Model

WIRA 1.6XLi (C98S)
PERSONA 1.6XLi (C98S)

Homologation No
A - 5524

Extension No
02/02V0

Page ou ext. Page or ext.	Article Article	Description Description
	7	SUSPENSION (Cont'd)
		Reinforced Rear Shock Absorber Top Mount
		Type : 1, 2, 3
		Photo : 21, 22, 20
Photo 23		Reinforced Front Wishbone Rear Mount
Photo 24		Reinforced Front Cross Member
Photo 25		Liquid Cooled Front Shock Absorber
Photo 26		Liquid Cooled Rear Shock Absorber
Photo 27		Suspension Cooling Tank, Pump and Radiator Capacity 0.75 Lt.
	801	WHEELS
Photo 28		Wheel Spacer
	803	BRAKES
Photo 29		Hydraulic Handbrake
Photo 30		Fluid Distribution Valve
Photo 31		Pedal Box for Dual Master Cylinder
Photo 32		Master Cylinder
	b)	Number of master cylinders : 2
	b1)	Bore : \emptyset 15.9mm - \emptyset 25.4mm
		Parts No : CP2623, CP4623
		Master cylinder may be front or rear
	c)	Servo-brakes : No
	d)	Braking regulator : Yes
	d1)	Location : Dashboard in cabin
Photo 33		Brake Regulator
Photo 34		Pressure Control Valve
Photo 35		Brake Stoneguard
Photo 36		Wheel Scraper

© FISA - FC - 1990 - 01001FH10.90

AUTOMOBILE ASSOCIATION MALAYSIA
25, Jalan Yap Kwan Seng
50450 Kuala Lumpur
Tel: 252276 (Travel)
2425212 (Breakdown Services)

FEDERATION INTERNATIONALE
DE L'AUTOMOBILE
8, Place de la Concorde, 8
75008 PARIS

Marque
Make

PROTON

Modèle
Model

WIRA 1.6XLi (C98S)
PERSONA 1.6XLi (C98S)

Homologation No
A - 5524

Extension No
02/02VO

Page ou ext. Page or ext.	Article Article	Description Description																																																						
	803	<p>BRAKES (Cont'd)</p> <p>Brake Bell</p> <p>Type : 1, 2, 3 Photo : 37, 38, 39</p> <p>Brake Caliper Mount</p> <p>Type : 1, 2, 3, 4 Photo : 40, 41, 42, 43</p>																																																						
		<p>Front and/or rear brake caliper (Lug or radial mounting)</p> <table border="1"> <thead> <tr> <th>Type 1</th> <th>Type 2</th> <th>Type 3</th> <th>Type 4</th> <th>Type 5</th> <th>Type 6</th> </tr> </thead> <tbody> <tr> <td>e)</td> <td>2</td> <td>2</td> <td>2</td> <td>4</td> <td>4</td> </tr> <tr> <td>e1)</td> <td>38.1</td> <td>36.0</td> <td>41.28</td> <td>38.1/41.3</td> <td>38.1</td> </tr> <tr> <td>g1)</td> <td colspan="5">2</td> </tr> <tr> <td>g2)</td> <td colspan="5">1</td> </tr> <tr> <td>g3)</td> <td colspan="5">Aluminium Alloy</td> </tr> <tr> <td>g8)</td> <td colspan="2">69.0 ± 1.5</td> <td>113.5</td> <td colspan="2">133.0</td> </tr> <tr> <td>Part No</td> <td>CP3176</td> <td>CP3177</td> <td>CP2577</td> <td>CP3344</td> <td>CP3479</td> </tr> <tr> <td>Photo</td> <td colspan="2">44</td> <td>46</td> <td colspan="2">45</td> </tr> </tbody> </table>	Type 1	Type 2	Type 3	Type 4	Type 5	Type 6	e)	2	2	2	4	4	e1)	38.1	36.0	41.28	38.1/41.3	38.1	g1)	2					g2)	1					g3)	Aluminium Alloy					g8)	69.0 ± 1.5		113.5	133.0		Part No	CP3176	CP3177	CP2577	CP3344	CP3479	Photo	44		46	45	
Type 1	Type 2	Type 3	Type 4	Type 5	Type 6																																																			
e)	2	2	2	4	4																																																			
e1)	38.1	36.0	41.28	38.1/41.3	38.1																																																			
g1)	2																																																							
g2)	1																																																							
g3)	Aluminium Alloy																																																							
g8)	69.0 ± 1.5		113.5	133.0																																																				
Part No	CP3176	CP3177	CP2577	CP3344	CP3479																																																			
Photo	44		46	45																																																				
		<p>Type 7</p> <table border="1"> <tbody> <tr> <td>e)</td> <td>4</td> </tr> <tr> <td>e1)</td> <td>41.3</td> </tr> <tr> <td>g1)</td> <td>2</td> </tr> <tr> <td>g2)</td> <td>1</td> </tr> <tr> <td>g3)</td> <td>Aluminium Alloy</td> </tr> <tr> <td>g8)</td> <td>126.0</td> </tr> <tr> <td>Part No</td> <td>CP2270</td> </tr> <tr> <td>Photo</td> <td>47</td> </tr> </tbody> </table>	e)	4	e1)	41.3	g1)	2	g2)	1	g3)	Aluminium Alloy	g8)	126.0	Part No	CP2270	Photo	47																																						
e)	4																																																							
e1)	41.3																																																							
g1)	2																																																							
g2)	1																																																							
g3)	Aluminium Alloy																																																							
g8)	126.0																																																							
Part No	CP2270																																																							
Photo	47																																																							

© 1984 - FC - 1660 - 010001 FB 10 90

AUTOMOBILE ASSOCIATION MALAYSIA
25, Jalan Yap Kwan Seng
50450 Kuala Lumpur
Tel: 2425777/2425210 (Travel)
2425212 (Breakdown Services)

FEDERATION INTERNATIONALE
DE L'AUTOMOBILE
8, Place de la Concorde, 8
75008 PARIS

Marque PROTON
 Make _____

Modèle WIRA 1.6XLi (C98S)
 Model: PERSONA 1.6XLi (C98S)

Homologation No
A-5524

Extension No
02/02VO

FICHE D'HOMOLOGATION VO POUR FREINS A DISQUE (à utiliser avec première page de " Fiche d'Extension d'Homologation ")
VO HOMOLOGATION FORM FOR DISC BRAKES (to be used with first page of " Form of Homologation Extension ")

803. Freins :
 Brakes :

e) Nombre de cylindres par roue
 Number of cylinders per wheel

e1) Alésage
 Bore

g) Freins à disques :
 Disc brakes :

g1) Nombre de plaquettes par roue
 Number of pads per wheel

g2) Nombre d'étriers par roue
 Number of calipers per wheel

g3) Matériau des étriers
 Caliper material

g4) Epaisseur du disque neuf
 Thickness of new disc

g5) Diamètre extérieur du disque
 External diameter of the disc

g6) Diamètre extérieur de frottement des
 plaquettes
 External diameter of pads' rubbing surface

g7) Diamètre intérieur de frottement des plaquettes
 Internal diameter of pads' rubbing surface

g8) Longueur hors-tout des plaquettes
 Overall length of the pads

g9) Disques ventilés
 Ventilated discs

	Avant / Front	Arrière/Rear								
e)	4	2								
e1)	∅ 38.1/41.3 mm	∅ 44.5 mm								
g)										
g1)	2	2								
g2)	1	1								
g3)	Aluminum Alloy	Aluminum Alloy								
g4)	25.4 +/- 1 mm	10.0 +/- 1 mm								
g5)	∅ 289.0 +/- 1.5 mm	∅ 260.0 +/- 1.5 mm								
g6)	∅ 289.0 +/- 1.5 mm	∅ 258.0 +/- 1.5 mm								
g7)	∅ 190.0 +/- 1.5 mm	∅ 195.0 +/- 1.5 mm								
g8)	114.0 +/- 1.5 mm	70.0 +/- 1.5 mm								
g9)	<table border="1" style="display: inline-table;"> <tr> <td>oui</td> <td>non</td> </tr> <tr> <td>yes</td> <td>no</td> </tr> </table>	oui	non	yes	no	<table border="1" style="display: inline-table;"> <tr> <td>oui</td> <td>non</td> </tr> <tr> <td>yes</td> <td>no</td> </tr> </table>	oui	non	yes	no
oui	non									
yes	no									
oui	non									
yes	no									

FEDERATION INTERNATIONALE
 DE L'AUTOMOBILE
 8, Place de la Concorde, 8
 75008 PARIS

PHOTO No 58

Avant / Front

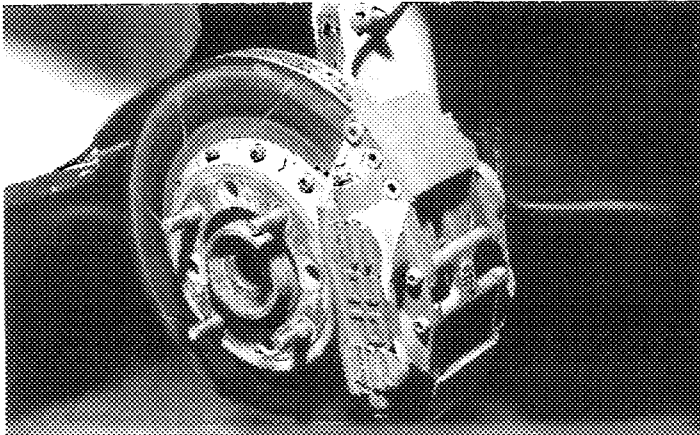
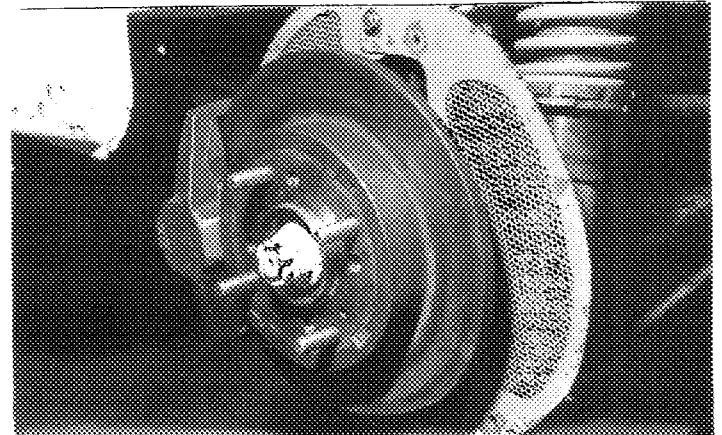

PHOTO No 59

Arrière / Rear



Marque
Make

PROTON

Modèle
Model

WIRA 1.6XLi (C98S)
PERSONA 1.6XLi (C98S)

Homologation No

A-5524

Extension No

02/02V0

Page ou ext. Page or ext.	Article Article	Description Description																																																																																																																								
	803	BRAKES (Cont'd)																																																																																																																								
		Front and/or Rear brake disc. (Plain or grooved and/or cross drilled) All discs may be 8, 10, or 12 bolt fixing.																																																																																																																								
		<table border="1"> <thead> <tr> <th></th> <th>Type 1</th> <th>Type 2</th> <th>Type 3</th> <th>Type 4</th> </tr> </thead> <tbody> <tr> <td>g4)</td> <td>25.4</td> <td>28.0</td> <td>25.4</td> <td>28.0</td> </tr> <tr> <td>g5)</td> <td>290.0</td> <td>304.0</td> <td>280.0</td> <td>328.0</td> </tr> <tr> <td>g6)</td> <td>290.0</td> <td>304.0</td> <td>280.0</td> <td>328.0</td> </tr> <tr> <td>g7)</td> <td>188.4</td> <td>203.0</td> <td>178.4</td> <td>222.0</td> </tr> <tr> <td>g9)</td> <td>Yes</td> <td>Yes</td> <td>Yes</td> <td>Yes</td> </tr> <tr> <td>Parts No</td> <td>CP3099</td> <td>CP3580</td> <td>CP3099</td> <td>CP3580</td> </tr> <tr> <td>Photo</td> <td>48</td> <td>49</td> <td>50</td> <td>49</td> </tr> <tr> <td></td> <td>Type 5</td> <td>Type 6</td> <td>Type 7</td> <td>Type 8</td> </tr> <tr> <td>g4)</td> <td>20.7</td> <td>25.4</td> <td>20.7</td> <td>28.0</td> </tr> <tr> <td>g5)</td> <td>266.7</td> <td>304.0</td> <td>280.0</td> <td>315.0</td> </tr> <tr> <td>g6)</td> <td>266.7</td> <td>304.0</td> <td>280.0</td> <td>315.0</td> </tr> <tr> <td>g7)</td> <td>155.0</td> <td>203.2</td> <td>192.0</td> <td>195.0</td> </tr> <tr> <td>g9)</td> <td>Yes</td> <td>Yes</td> <td>Yes</td> <td>Yes</td> </tr> <tr> <td>Parts No</td> <td>CP2261-48</td> <td>CP2261-528/9</td> <td>CP2261-746/7</td> <td>CP3047-64/65</td> </tr> <tr> <td>Photo</td> <td>48</td> <td>48</td> <td>48</td> <td>48</td> </tr> <tr> <td></td> <td>Type 9</td> <td>Type 10</td> <td>Type 11</td> <td>Type 12</td> </tr> <tr> <td>g4)</td> <td>28.0</td> <td></td> <td></td> <td></td> </tr> <tr> <td>g5)</td> <td>304.0</td> <td></td> <td></td> <td></td> </tr> <tr> <td>g6)</td> <td>304.0</td> <td></td> <td></td> <td></td> </tr> <tr> <td>g7)</td> <td>203.2</td> <td></td> <td></td> <td></td> </tr> <tr> <td>g9)</td> <td>Yes</td> <td></td> <td></td> <td></td> </tr> <tr> <td>Parts No</td> <td>CP2748-66/67</td> <td></td> <td></td> <td></td> </tr> <tr> <td>Photo</td> <td>51</td> <td></td> <td></td> <td></td> </tr> </tbody> </table>		Type 1	Type 2	Type 3	Type 4	g4)	25.4	28.0	25.4	28.0	g5)	290.0	304.0	280.0	328.0	g6)	290.0	304.0	280.0	328.0	g7)	188.4	203.0	178.4	222.0	g9)	Yes	Yes	Yes	Yes	Parts No	CP3099	CP3580	CP3099	CP3580	Photo	48	49	50	49		Type 5	Type 6	Type 7	Type 8	g4)	20.7	25.4	20.7	28.0	g5)	266.7	304.0	280.0	315.0	g6)	266.7	304.0	280.0	315.0	g7)	155.0	203.2	192.0	195.0	g9)	Yes	Yes	Yes	Yes	Parts No	CP2261-48	CP2261-528/9	CP2261-746/7	CP3047-64/65	Photo	48	48	48	48		Type 9	Type 10	Type 11	Type 12	g4)	28.0				g5)	304.0				g6)	304.0				g7)	203.2				g9)	Yes				Parts No	CP2748-66/67				Photo	51			
	Type 1	Type 2	Type 3	Type 4																																																																																																																						
g4)	25.4	28.0	25.4	28.0																																																																																																																						
g5)	290.0	304.0	280.0	328.0																																																																																																																						
g6)	290.0	304.0	280.0	328.0																																																																																																																						
g7)	188.4	203.0	178.4	222.0																																																																																																																						
g9)	Yes	Yes	Yes	Yes																																																																																																																						
Parts No	CP3099	CP3580	CP3099	CP3580																																																																																																																						
Photo	48	49	50	49																																																																																																																						
	Type 5	Type 6	Type 7	Type 8																																																																																																																						
g4)	20.7	25.4	20.7	28.0																																																																																																																						
g5)	266.7	304.0	280.0	315.0																																																																																																																						
g6)	266.7	304.0	280.0	315.0																																																																																																																						
g7)	155.0	203.2	192.0	195.0																																																																																																																						
g9)	Yes	Yes	Yes	Yes																																																																																																																						
Parts No	CP2261-48	CP2261-528/9	CP2261-746/7	CP3047-64/65																																																																																																																						
Photo	48	48	48	48																																																																																																																						
	Type 9	Type 10	Type 11	Type 12																																																																																																																						
g4)	28.0																																																																																																																									
g5)	304.0																																																																																																																									
g6)	304.0																																																																																																																									
g7)	203.2																																																																																																																									
g9)	Yes																																																																																																																									
Parts No	CP2748-66/67																																																																																																																									
Photo	51																																																																																																																									

N.B. : Swept area of disc may be less depending on caliper used.

AUTOMOBILE ASSOCIATION MALAYSIA
25, Jalan Yap Kwan Seng
50450 Kuala Lumpur
Tel: 2425777/2425210 (Travel)
2425312 (Breakdown Services)

FEDERATION FRANÇAISE
DE L'AUTOMOBILE
8, Place de la Concorde, 8
75008 PARIS

Marque
Make

PROTON

Modèle
Model

WIRA 1.6XLi (C98S)
PERSONA 1.6XLi (C98S)

Homologation No

A-5524

Extension No

02/02V0

Page ou ext. Page or ext.	Article Article	Description Description
	804	STEERING
Photo 52		Reinforced Steering Column Alternative Steering Rack Type : 1 2 Ratio : 11.6 : 1 10.3 : 1 Photo : 53 54
Photo 55		Heavy Duty Power Steering Pump
	901	BODYWORK
Photo 56		Reinforced Seat Mounting
a)		Ventilation : Yes
f1)		Type : Fixed with internal valve
f2)		Control system : Manual Maximum height is within 100mm Maximum width is within 500mm Mounted within first third of roof.
Photo 57		Ventilation Foil (Valid for rallies only)

AUTOMOBILE ASSOCIATION MALAYSIA
25, Jalan Yap Kwan Seng
50450 Kuala Lumpur
Tel: 2425777/2425210 (Toll-free)
2425212 (Breakdown services)

FEDERATION FRANÇAISE
DE L'AUTOMOBILE
8, Place de la Concorde, 8
75008 PARIS

Marque
Make

PROTON

Modèle
Model

WIRA 1.6XLi (C98S)
PERSONA 1.6XLi (C98S)

Homologation No

A-5524

Extension No

02/02V0

PHOTO No 1 ALTERNATIVE GEARBOX ASSY

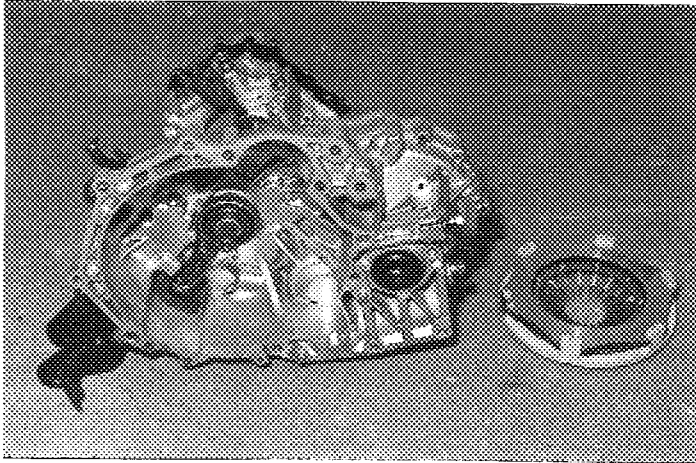

PHOTO No 2 REINFORCED DRIVESHAFT, FRONT (LH)

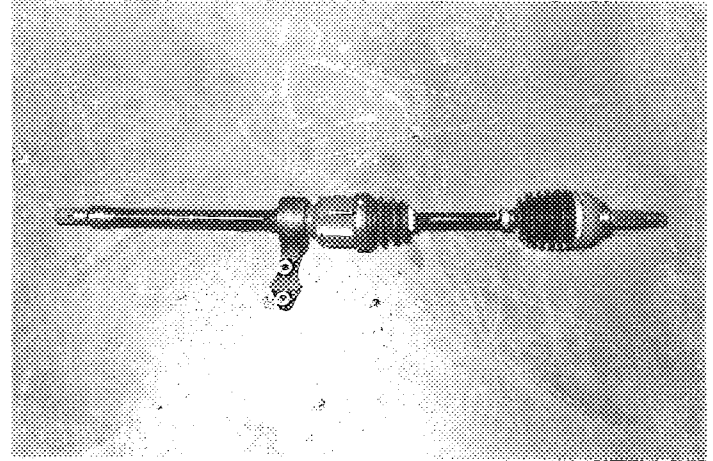

PHOTO No 3 REINFORCED DRIVESHAFT, FRONT (RH)

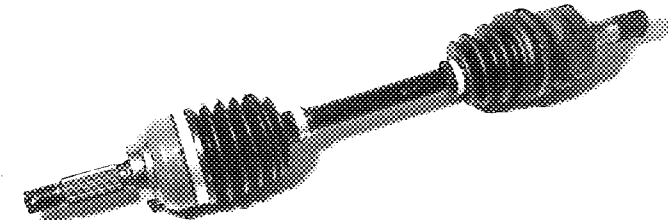

PHOTO No 4 ALTERNATIVE HEAVY DUTY FRONT KNUCKLE

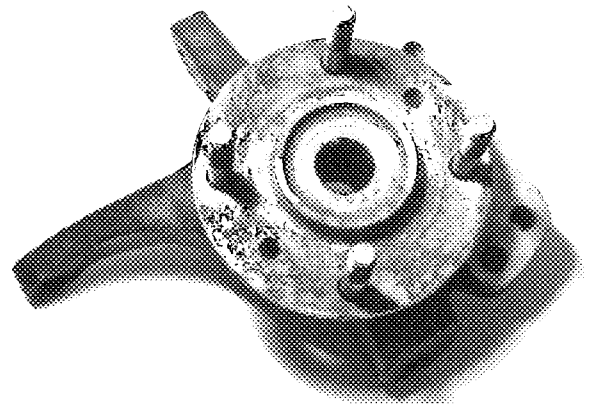

PHOTO No 5 FRONT STABILIZER BAR

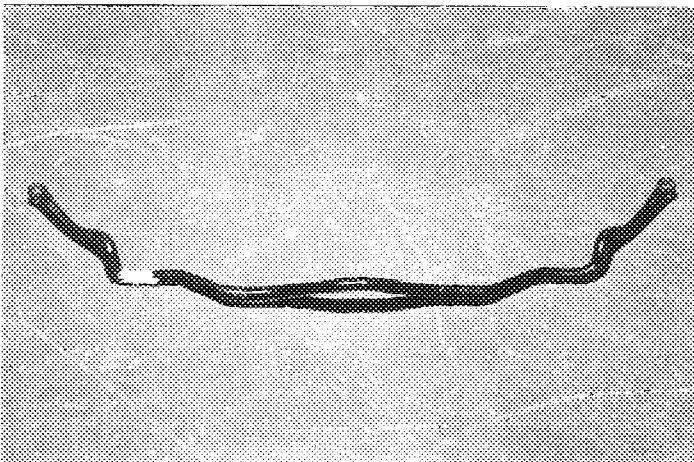
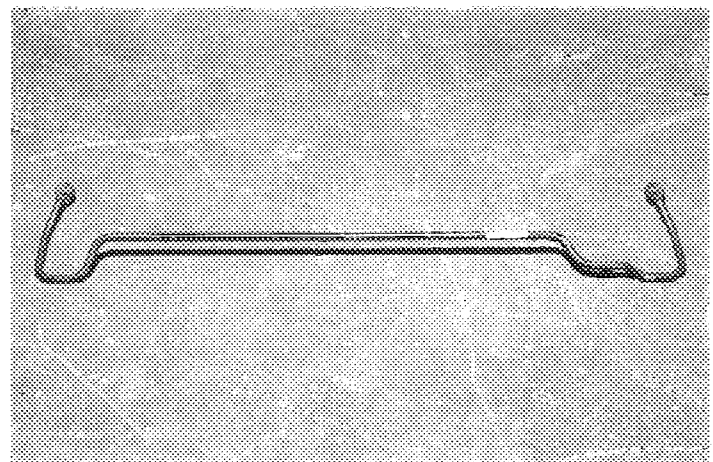

PHOTO No 6 REAR STABILIZER BAR



Marque PROTON
Make _____

Modèle WIRA 1.6XLi (C98S)
Model PERSONA 1.6XLi (C98S)

Homologation No
A-5524

Extension No
02/02V0

PHOTO No7 REINFORCED FRONT WISHBONE TYPE 1

PHOTO No 8 REINFORCED FRONT WISHBONE TYPE 2

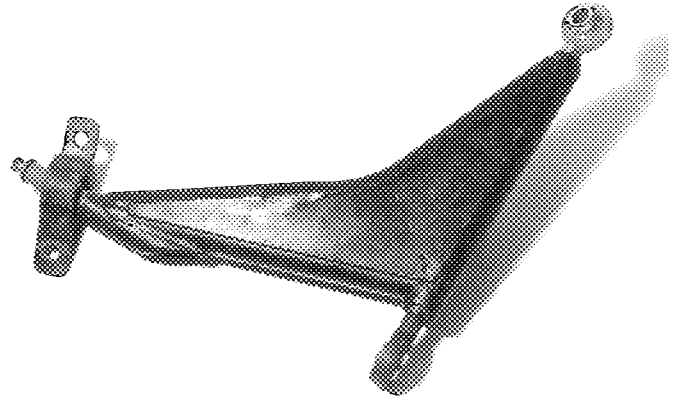
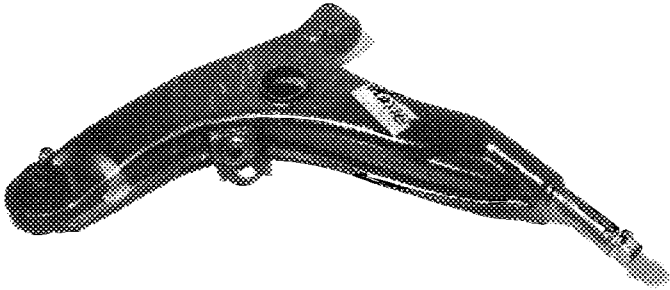

PHOTO No9 REINFORCED FRONT WISHBONE TYPE 3

PHOTO No 10 REINFORCED TRAILING ARM TYPE 1

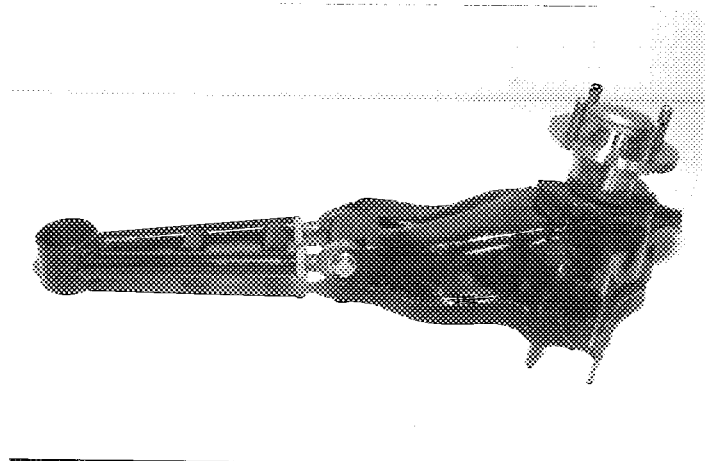
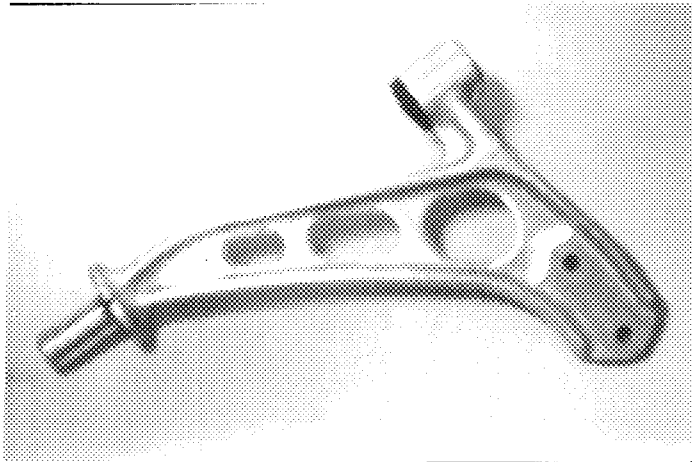
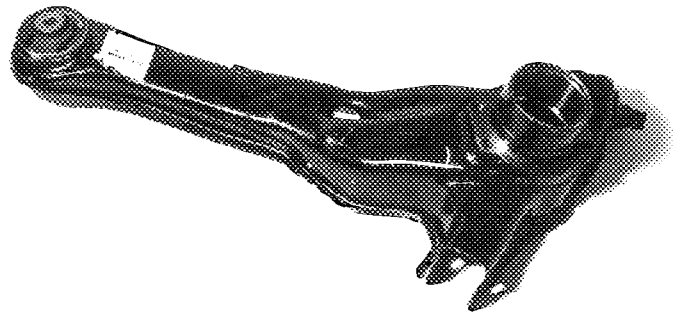
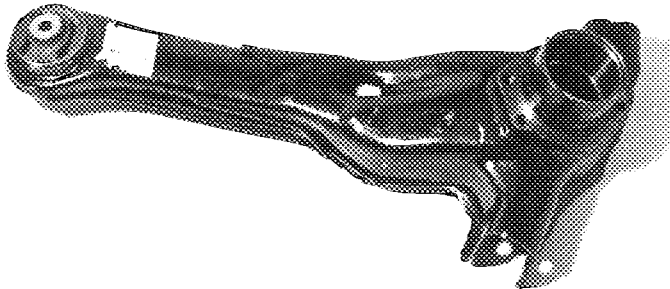

PHOTO No11 REINFORCED TRAILING ARM TYPE 2

PHOTO No 12 REINFORCED TRAILING ARM TYPE 3



AUTOMOBILE ASSOCIATION MALAYSIA
25, Jalan Yap Kwan Seng
50450 Kuala Lumpur
Tel: 2425777/242 310 (Travel)
212 212 (Breakdown Services)

**FEDERATION INTERNATIONALE
DE L'AUTOMOBILE**
8, Place de la Concorde, 8
75008 PARIS

Marque
Make

PROTON

Modèle
Model

WIRA 1.6XLi (C98S)
PERSONA 1.6XLi (C98S)

Homologation No

A-5524

Extension No

02/02V0

PHOTO No 13 REINFORCED UPPER TRANSVERSE LINK - REAR

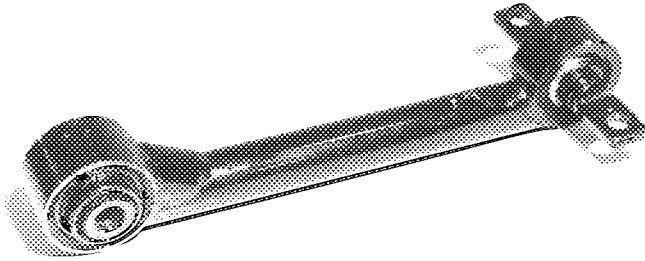

PHOTO No 14 REINFORCED LOWER TRANSVERSE LINK - REAR TYPE 1

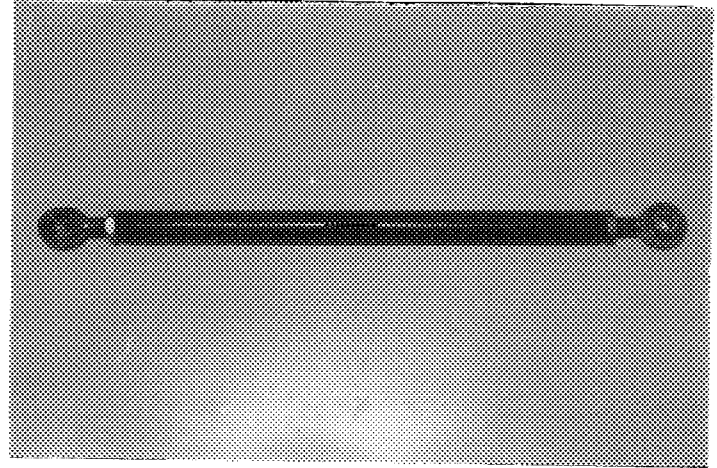

PHOTO No 15 REINFORCED LOWER TRANSVERSE LINK - REAR TYPE 2

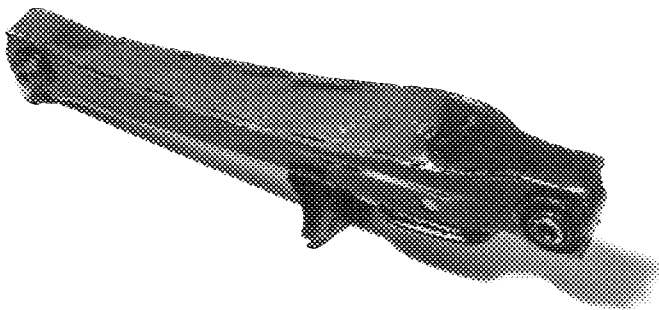

PHOTO No 16 REINFORCED TOE CONTROL LINK REAR

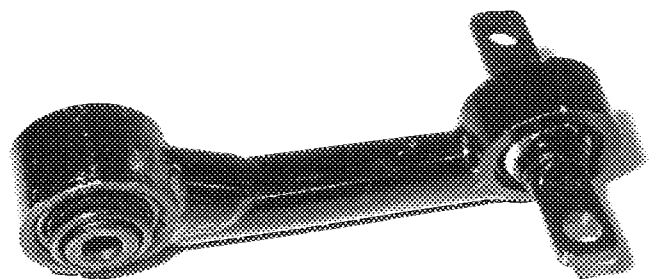

PHOTO No 17 REINFORCED STRUT TOP MOUNT TYPE 1

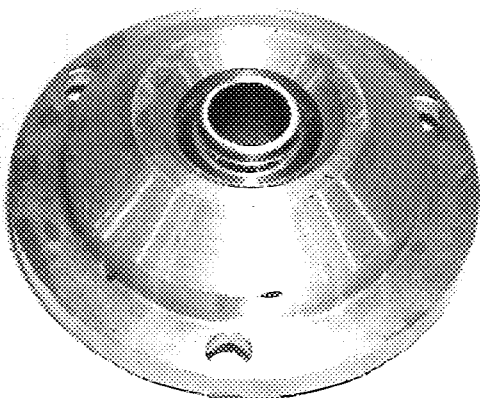
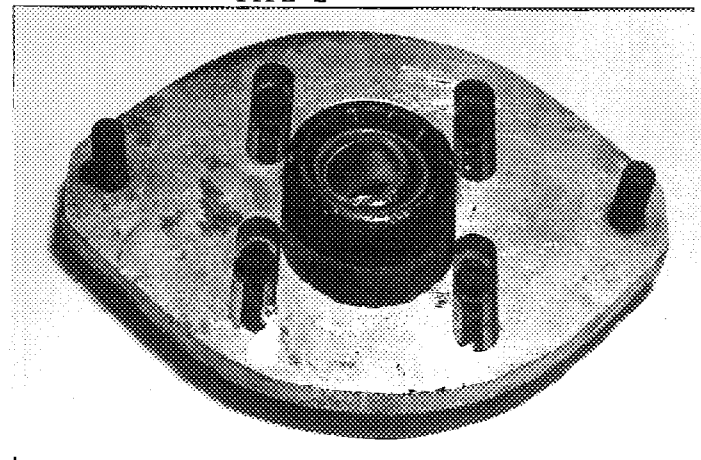

PHOTO No 18 REINFORCED STRUT TOP MOUNT TYPE 2



Marque PROTON
Make _____

Modèle
Model _____

WIRA 1.6XLi (C98S)
PERSONA 1.6XLi (C98S)

Homologation No
A-5524

Extension No
02/02V0

PHOTO No 19 REINFORCED STRUT TOP MOUNT
TYPE 3

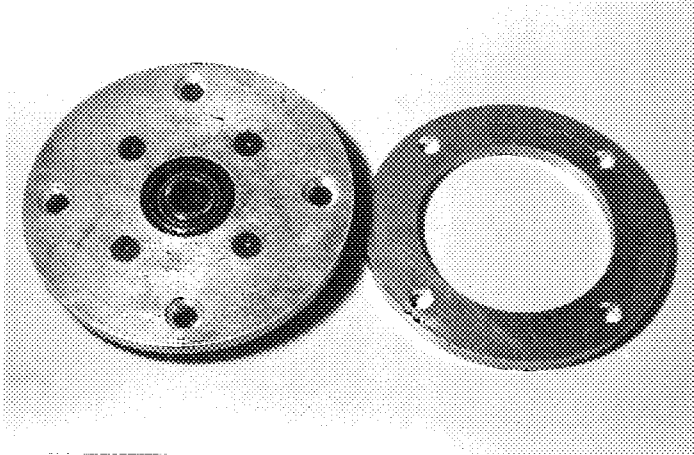

PHOTO No 20 REINFORCED STRUT TOP MOUNT
TYPE 4

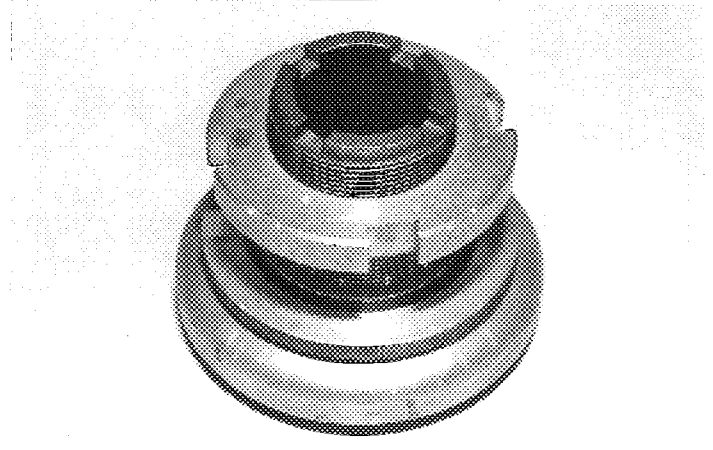

PHOTO No 21 REINFORCED REAR SHOCK ABSORBER
TOP MOUNT TYPE 1

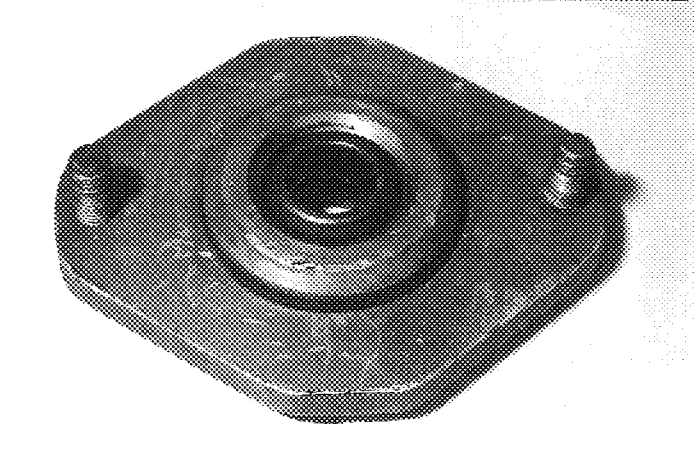

PHOTO No 22 REINFORCED REAR SHOCK ABSORBER
TOP MOUNT TYPE 2

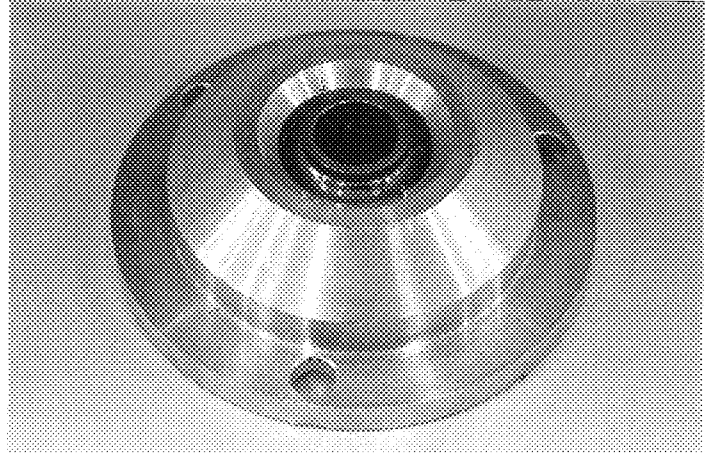

PHOTO No 23 REINFORCED FRONT WISHBONE
REAR MOUNT

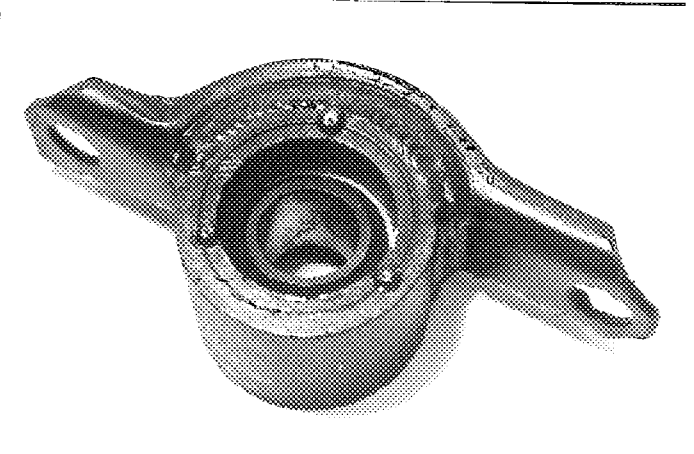
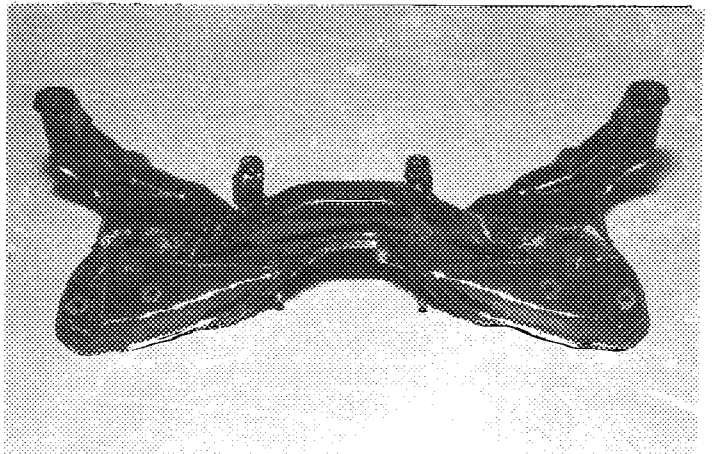

PHOTO No 24 REINFORCED FRONT CROSS MEMBER



Marque PROTON
Make _____

Modèle
Model _____

WIRA 1.6XLi (C98S)
PERSONA 1.6XLi (C98S)

Homologation No
A-5524

Extension No
02/02/0

PHOTO No 25 LIQUID COOLED FRONT SHOCK ABSORBER

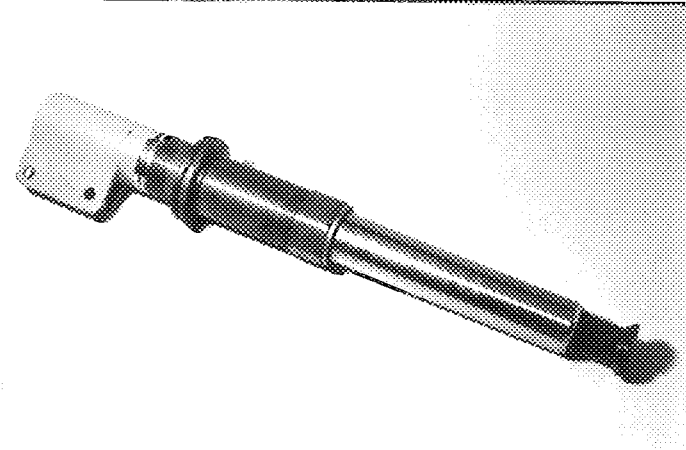

PHOTO No 26 LIQUID COOLED REAR SHOCK ABSORBER

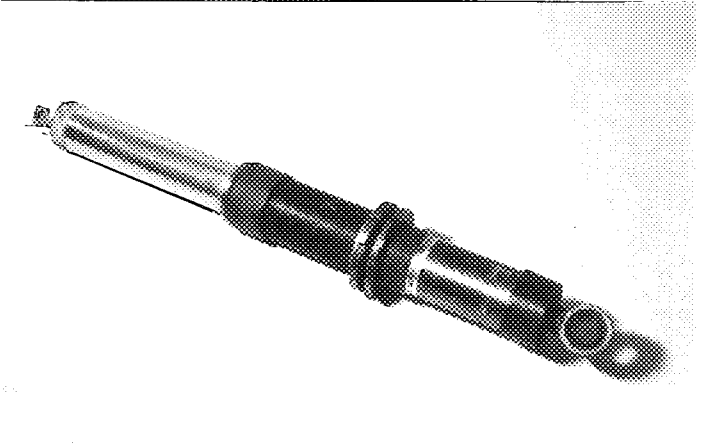

PHOTO No 27 SUSPENSION COOLING TANK, PUMP AND RADIATOR

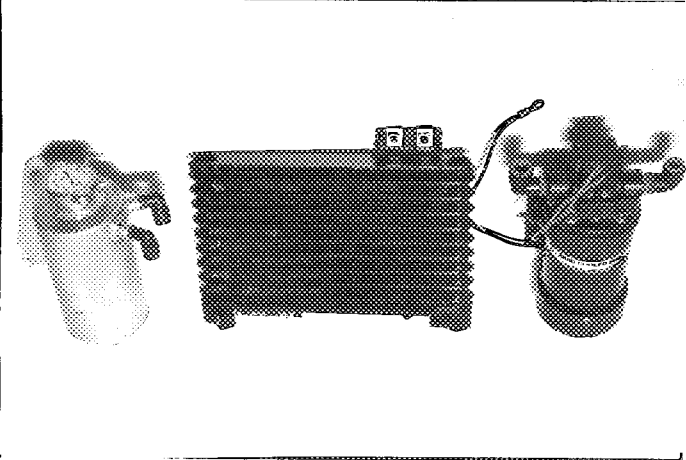

PHOTO No 28 WHEEL SPACER

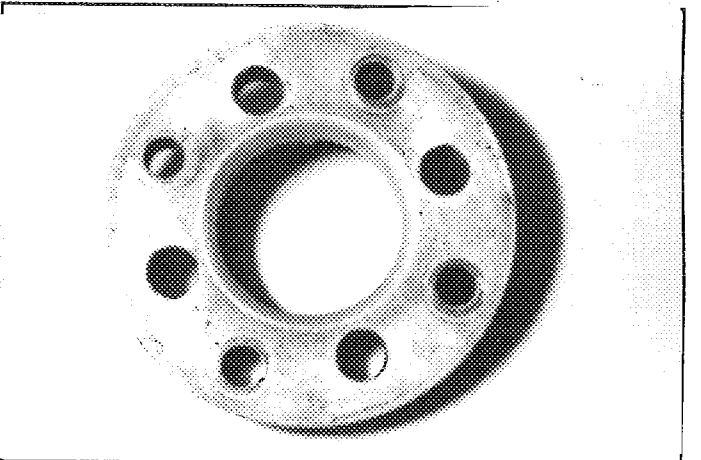

PHOTO No 29 HYDRAULIC HANDBRAKE

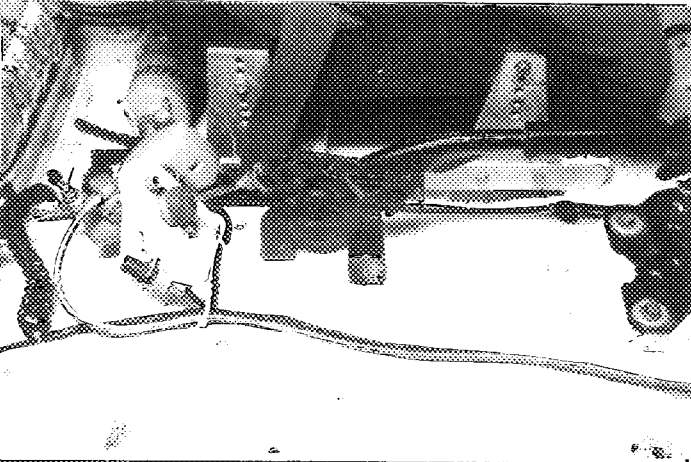
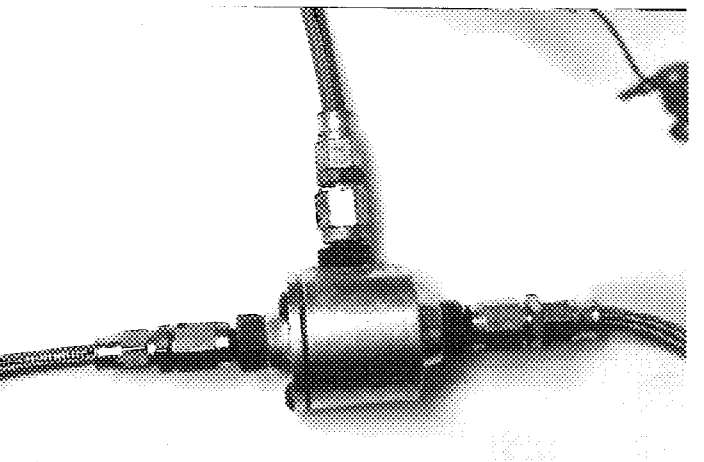

PHOTO No 30 FLUID DISTRIBUTION VALVE



Marque PROTON
Make _____

Modèle WIRA 1.6XLi (C98S)
Model PERSONA 1.6XLi (C98S)

Homologation No
A-5524

Extension No
02/02V0

PHOTO No 31 PEDAL BOX FOR DUAL MASTER CYLINDER

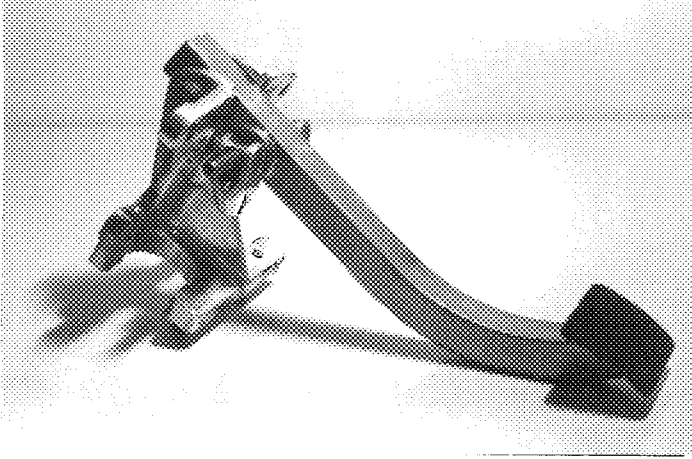

PHOTO No 32 MASTER CYLINDER

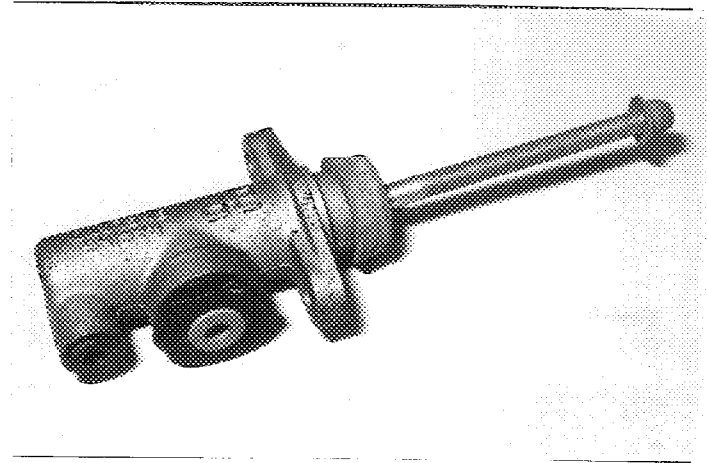

PHOTO No 33 BRAKE REGULATOR

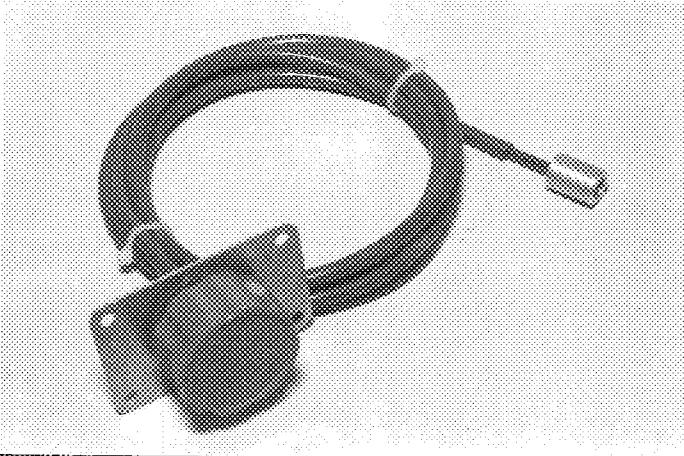

PHOTO No 34 PRESSURE CONTROL VALVE

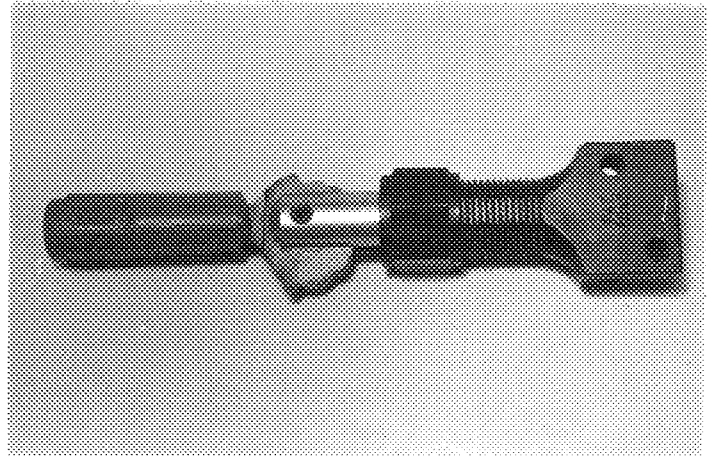

PHOTO No 35 BRAKE STONEGUARD

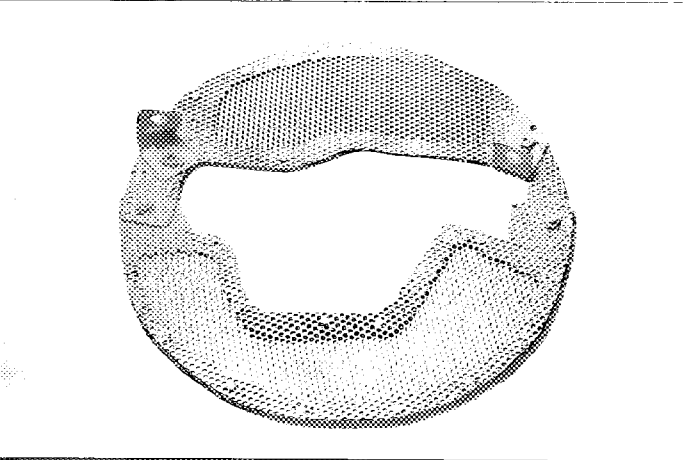
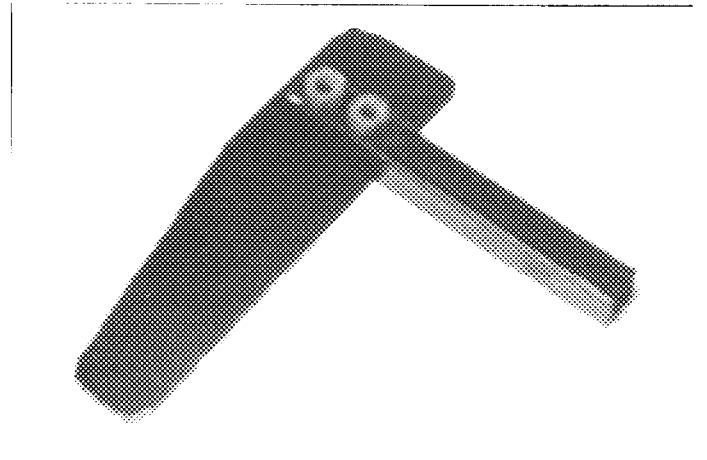

PHOTO No 36 WHEEL SCRAPER



Marque PROTON
Make _____

Modèle WIRA 1.6XLi (C98S)
Model PERSONA 1.6XLi (C98S)

Homologation No
A-5524

Extension No
02/02V0

PHOTO No 37 BRAKE BELL TYPE 1

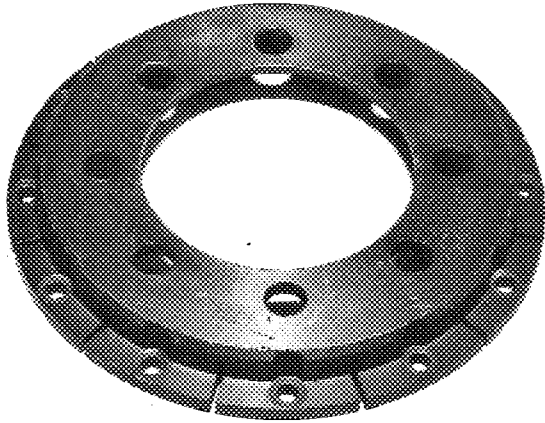

PHOTO No 38 BRAKE BELL TYPE 2

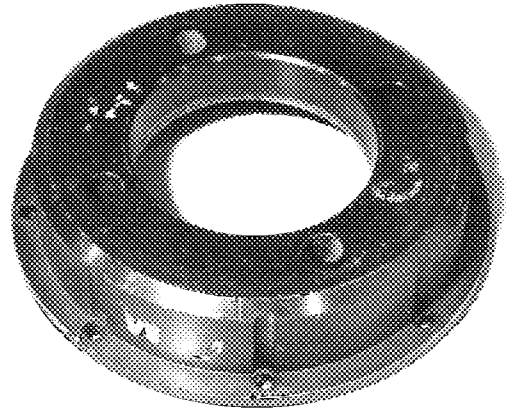

PHOTO No 39 BRAKE BELL TYPE 3

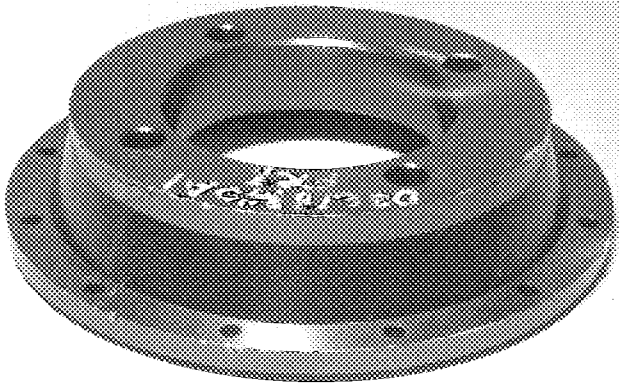

PHOTO No 40 BRAKE CALIPER MOUNT TYPE 1

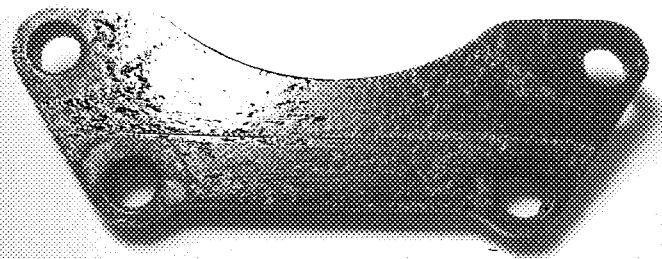

PHOTO No 41 BRAKE CALIPER MOUNT TYPE 2

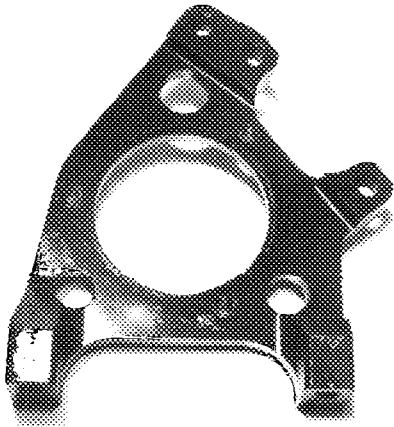
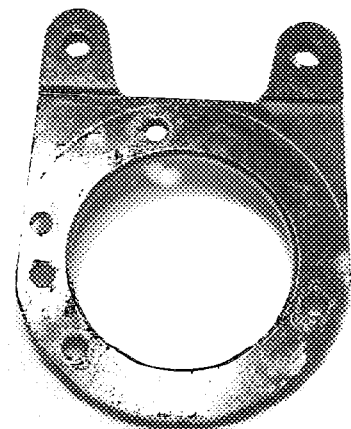

PHOTO No 42 BRAKE CALIPER MOUNT TYPE 3



Marque PROTON
Make _____

Modèle WIRA 1.6XLi (C98S)
Model PERSONA 1.6XLi (C98S)

Homologation No
A - 5524

Extension No
02/02V0

PHOTO No 43 BRAKE CALIPER MOUNT TYPE 4

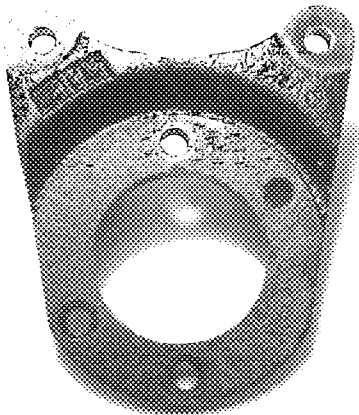

PHOTO No 44 FRONT AND/OR REAR BRAKE CALIPER TYPE 1, 2, 3

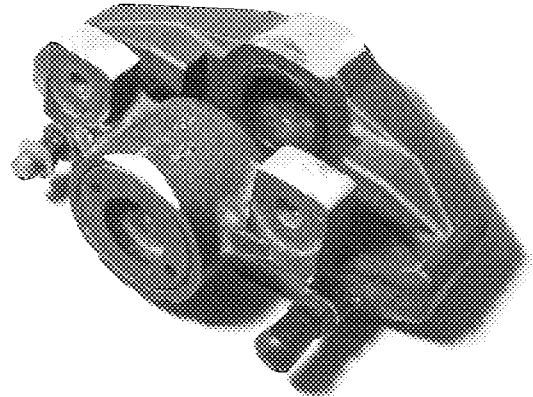

PHOTO No 45 FRONT AND/OR REAR BRAKE CALIPER TYPE 5, 6

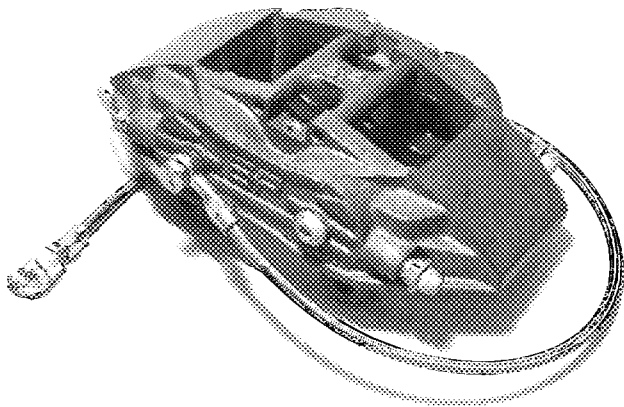

PHOTO No 46 FRONT AND/OR REAR BRAKE CALIPER TYPE 4

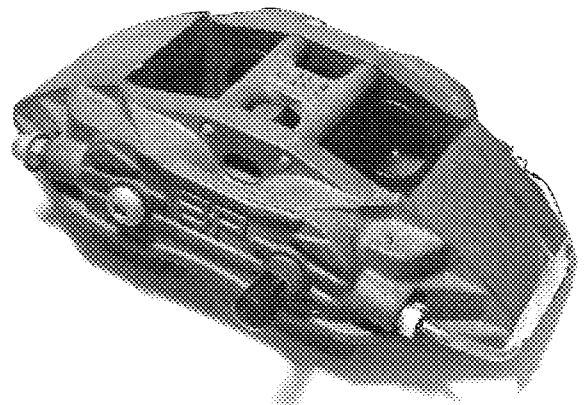

PHOTO No 47 FRONT AND/OR REAR BRAKE CALIPER TYPE 7

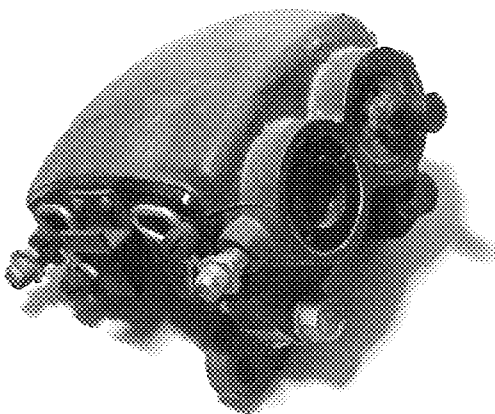
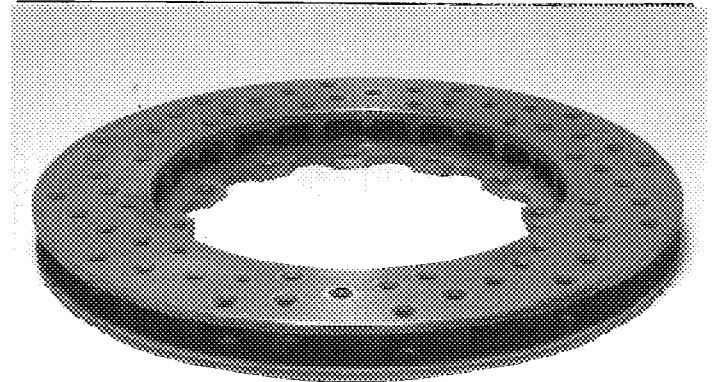

PHOTO No 48 FRONT AND/OR REAR BRAKE DISC TYPE 1, 5, 6, 7, 8



Marque PROTON
Make _____

Modèle WIRA 1.6XLi (C98S)
Model PERSONA 1.6XLi (C98S)

Homologation No
A-5524

Extension No
02/02V0

PHOTO No 49 FRONT AND/OR REAR BRAKE DISC TYPE 2, 4

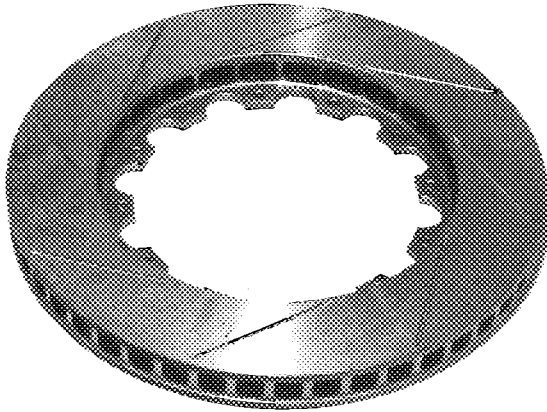

PHOTO No 50 FRONT AND/OR REAR BRAKE DISC TYPE 3

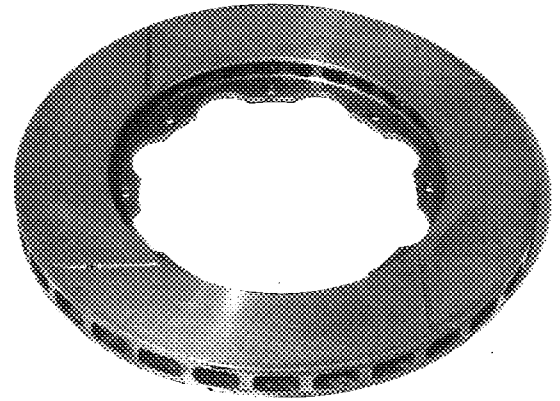

PHOTO No 51 FRONT AND/OR REAR BRAKE DISC TYPE 9

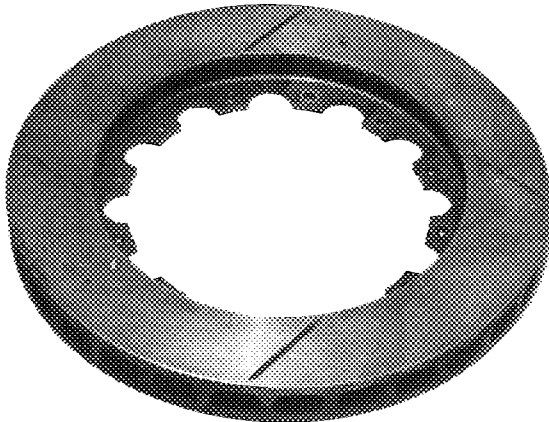

PHOTO No 52 REINFORCED STEERING COLUMN

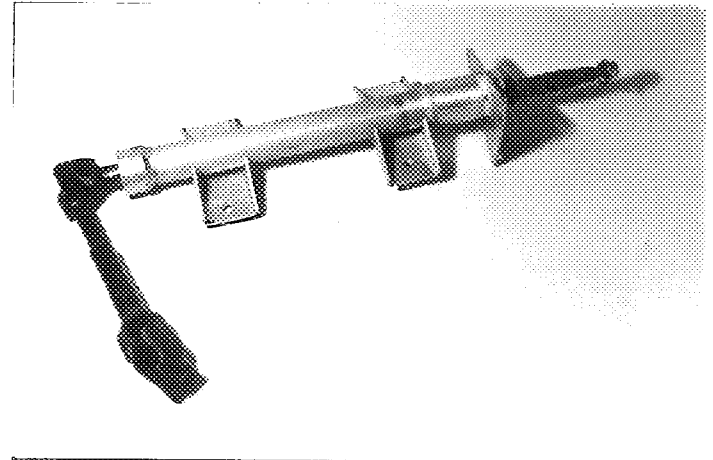

PHOTO No 53 ALTERNATIVE STEERING RACK TYPE 1

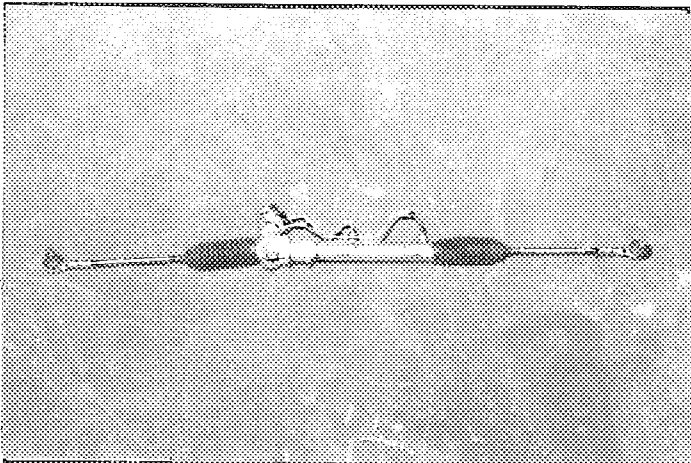
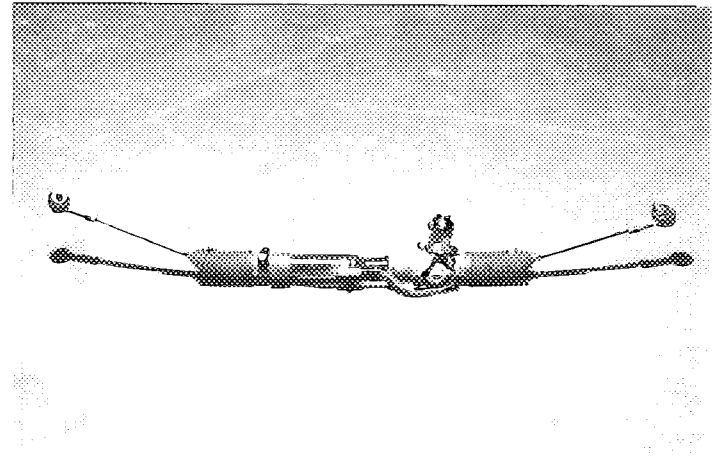

PHOTO No 54 ALTERNATIVE STEERING RACK TYPE 2



Marque
Make

PROTON

Modèle
Model

**WIRA 1.6XLi (C98S)
PERSONA 1.6XLi (C98S)**

Homologation No

A-5524

Extension No

02/02V0

PHOTO No 55 **HEAVY DUTY POWER STEERING PUMP**

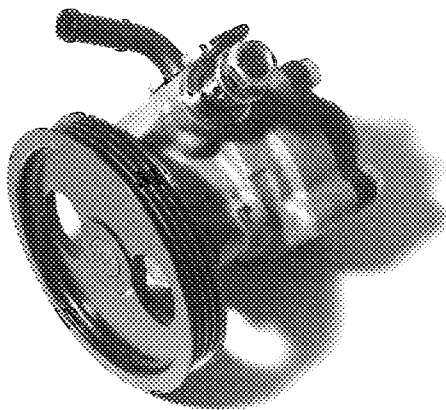

PHOTO No 56 **REINFORCED SEAT MOUNTING**

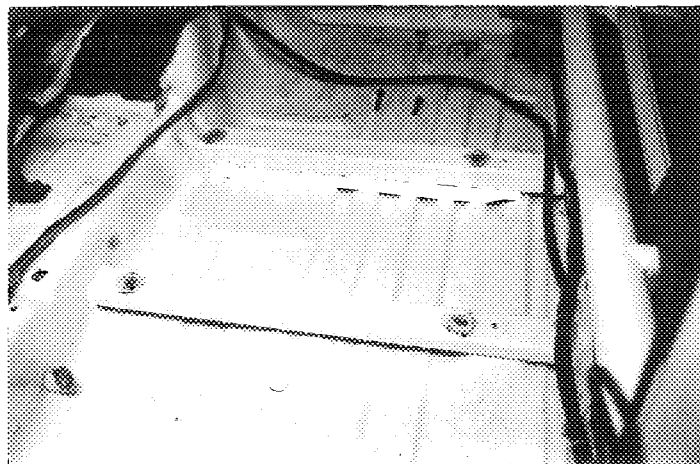

PHOTO No 57 **VENTILATION**

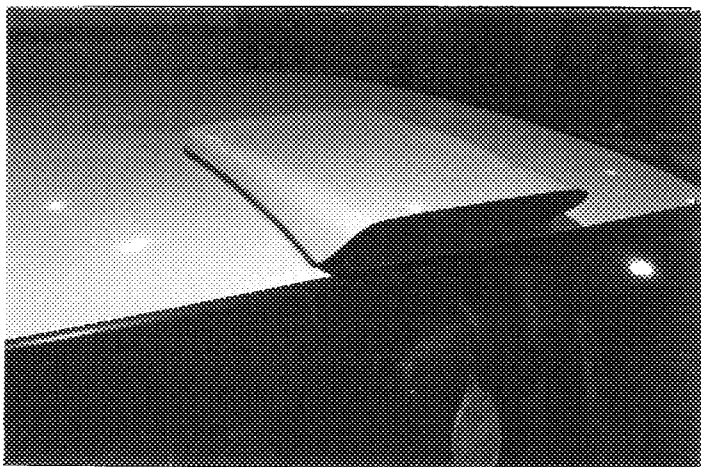

PHOTO No

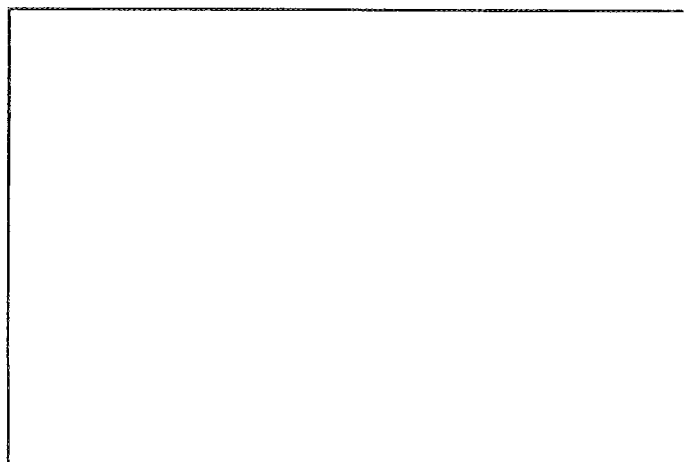

PHOTO No

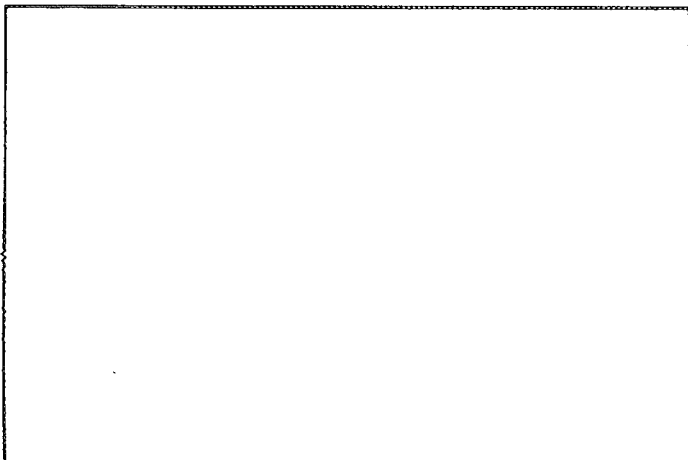
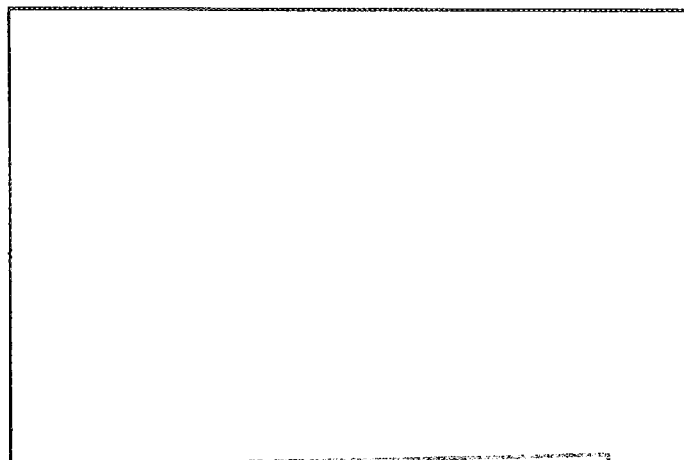

PHOTO No



AUTOMOBILE ASSOCIATION MALAYSIA
25, Jalan Yap Kwan Seng
50450 Kuala Lumpur
Tel: 2425777/2425210 (Travel)
2425212 (Breakdown Services)

**ASSOCIATION INTERNATIONALE
DE L'AUTOMOBILE**
8, Place de la Concorde, 8
75008 PARIS Page 17



FEDERATION INTERNATIONALE
DE L'AUTOMOBILE

Homologation N°

A 5524

Groupe
Group **A / B / N**

Extension N°

03 / 01 VF

FICHE D'EXTENSION D'HOMOLOGATION
FORM OF HOMOLOGATION EXTENSION

- ES** Evolution sportive du type / Sporting evolution of the type **VO** Variante option / Option variant
- ET** Evolution normale du type / Normal evolution of the type **ER** Erratum / Erratum
- VF** Variante de fourniture / Supply variant

Véhicule : Constructeur
Vehicle : Manufacturer

PERUSAHAAN OTOMOBIL NASIONAL BERHAD

Modèle et type
Model and type

WIRA 1.6 XLi (C98S) / PERSONA 1.6 XLi (C98S)

Homologation valable à partir du
Homologation valid as from

01 SEP. 2001

Page or ext.	Article	Description
Page 1		BODYWORK
	Photo	
	1	Car seen from 3/4 front view.
	2	Car seen at full front view. Note: Redesigned front grille.
	3	Car seen from 3/4 rear view.
	4	Car seen from full rear view. Note: Redesigned taillight assy. and rear license plate holder

Fédération Internationale de l'Automobile
2 chemin de Blandonnet
CH-1215 GENEVE 15
Tél.: 41 22 544 44 00
Fax Sport: 41 22 544 44 50

Homologation N°

A 5524

Extension N°

03 / 01 VF

Marque
Make **PERUSAHAAN OTOMOBIL
NASIONAL BERHAD**

Modèle
Model **WIRA 1.6XLI (C98S)
PERSONA 1.6XLI (C98S)**

PHOTO N° 1

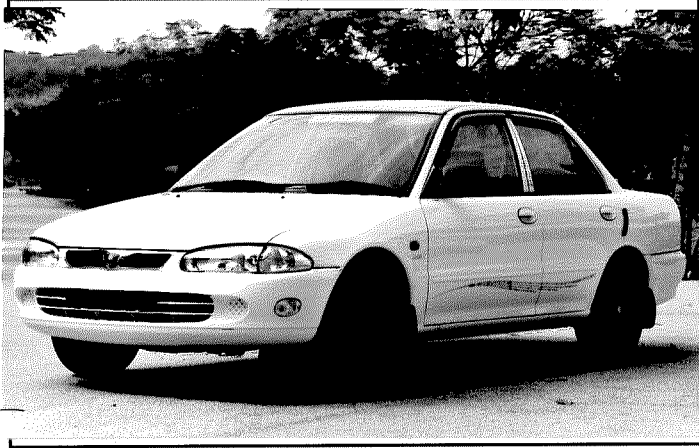

PHOTO N° 2



PHOTO N° 3

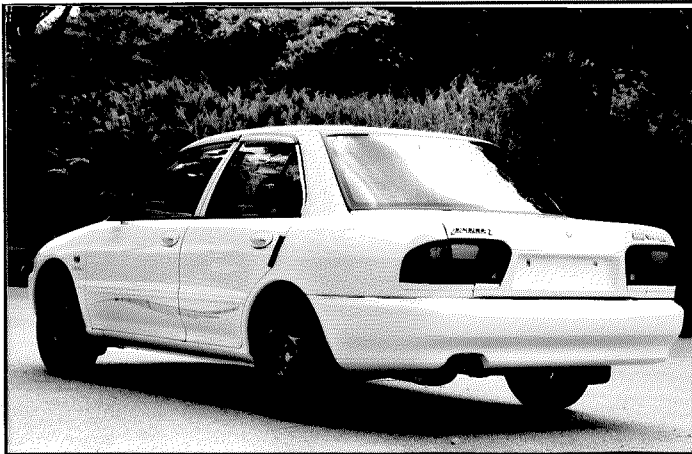

PHOTO N° 4



PHOTO N°

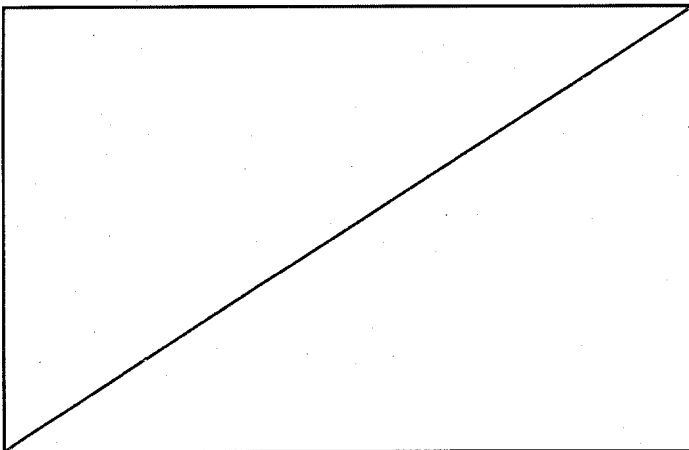

PHOTO N°

