



# JAPAN AUTOMOBILE FEDERATION

社団法人 日本自動車連盟

JAF公認番号 **I-184**  
グループ **ツーリング・カー**  
発効年月日 **46.10.31**

F. I. A. Recognition No. **5453**  
Group **1**

## FEDERATION INTERNATIONALE DE L'AUTOMOBILE

Form of recognition in accordance with  
Appendix J to the International Sporting Code.

国際スポーツ法典付則J項及びJAF国内競技車両規則に従った公認書式。

Manufacturer 製造会社名	FUJI HEAVY INDUSTRIES LTD.	Cylinder-capacity 総排気量	Reciprocation 1361 cm <sup>3</sup> 83.0 cu.in. レシプロ
Serial No of chassis 製造開始シャシー番号	A22-200001	Model 型式及び通称名	Special cm <sup>3</sup> cu.in. 特殊
Serial No of engine 製造開始エンジン番号	EA63-217806	Manufacturer	FUJI HEAVY INDUSTRIES LTD.
Recognition is valid from		Manufacturer	FUJI HEAVY INDUSTRIES LTD.
		List	

The manufacturing of the model described in this recognition form was started on **Sept, 1971** and the minimum production of **5000** identical cars, in accordance with the specifications of this form was reached on **Jan, 1972**

Photograph A, 3/4 view of car from front 写真A、全体写真(斜め前方)



The vehicle described in this form has been subject to the following amendments :

### Variants

on	19	rec. No.	List
on	19	rec. No.	List
on	19	rec. No.	List
on	19	rec. No.	List
on	19	rec. No.	List

### Normal evolution of the type

on	19	rec. No.	List
on	19	rec. No.	List
on	19	rec. No.	List
on	19	rec. No.	List
on	19	rec. No.	List

Stamp and signature of the JAF

JAF公認印及び署名

**難波靖彦**

Yasuharu Nanba



Stamp and signature of the F. I. A.

*[Handwritten signature]*



Make FUJI

Model A22  
型式

J.A.F.公認番号 T-184  
F.I.A. Rec. No. 5453

IMPORTANT - the underlined items must be stated in two measuring systems, one of which must be the metric system. See conversion table hereafter.

**CAPACITIES AND DIMENSIONS**  
仕様諸元

1. <u>Wheelbase</u> ホイールベース	2455 cm	96.7 inches
2. <u>Front track</u> トレッド (前)	126.0 cm	49.6 inches *
3. <u>Rear track</u> トレッド (後)	120.5 cm	47.5 inches *
4. Overall length of the car 全長	399.5 cm	inches
5. Overall width of the car 全幅	150.0 cm	inches
6. Overall height of the car 全高	134.5 cm	inches
7. <u>Capacity of fuel tank</u> (reserve included) 燃料タンク容量	13.2 Gallon US	50 ltrs Gallon Imp.
8. Seating capacity 定員	5	
9. <u>Weight, total weight of the car with normal equipment, water, oil and spare wheel but without fuel nor repair tools:</u> 車両重量 (冷却水、オイル、スペアタイヤを含む標準状態の車両重量、但し燃料、車載工具を除く)	715 kg	1578 lbs cwt

\* Differences in track caused by the use of other wheels with different rim widths must be stated when recognition is requested for the wheels concerned.

Specify ground clearance in relation to the track and give drawing of two fixed points of the vehicle's structure at which measurements are taken.

These ground clearance dimensions are only for information when checking the track and can in no way affect the eligibility of the car.

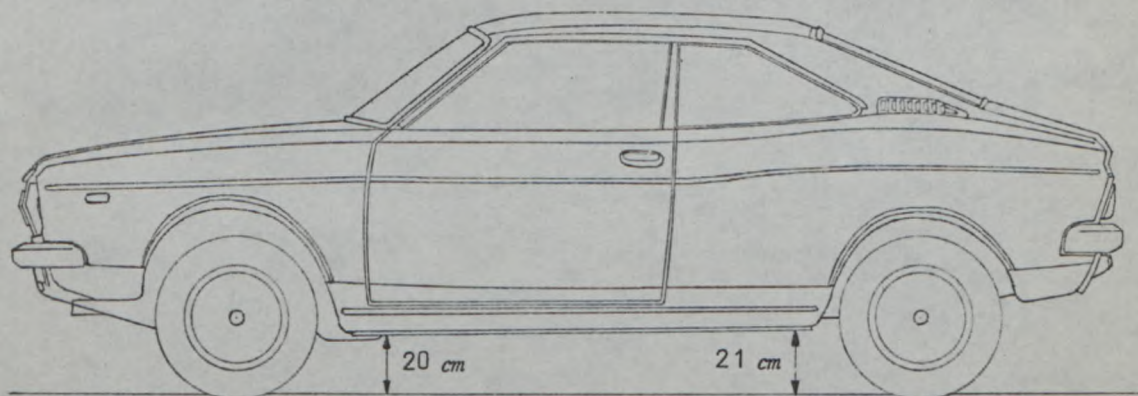

Width of the car measured in the vertical plane passing through the axle of the wheels.

車軸上の車体幅	Front フロント	150.0 cm	Rear リヤ	150.0 cm
---------	---------------	----------	------------	----------

**CONVERSION TABLE**

1 inch / pouce	-- 2.54 cm	1 quart US	-- 0.9464 ltrs
1 foot / pied	-- 30.4794 cm	1 pint (pt)	-- 0.568 ltrs
1 square inch / pouce carre	-- 6.452 cm <sup>2</sup>	1 gallon Imp.	-- 4.546 ltrs
1 cubic inch / pouce cube	-- 16.387 cm <sup>3</sup>	1 gallon US	-- 3.785 ltrs
1 pound / livre (lb)	-- 453.593	1 hundred weight (cwt)	-- 50.802 kg





**CHASSIS AND COACHWORK** (Photographs A, B and C)

シャーシー、ボデー

20. Chassis/body construction : ~~XXXXX~~ / unitary construction  
シャーシー/ボディーの構造 ~~XXXXX~~ / 一体構造
21. Unitary construction, material (s) **Steel**  
一体構造の場合その材質
22. Separate constructions: material (s) of chassis  
セパレート構造の場合その材質
23. Material (s) of coachwork  
ボディーの材質
24. Number of doors **2** Material (s) **Steel**  
ドアの数 材質
25. Material (s) of bonnet **Steel**  
ボンネットの材質
26. Material (s) of boot lid **Steel**  
トランクリッドの材質
27. Material (s) of rear-window **Glass**  
リアウインドシールドの材質
28. Material (s) of windscreen **Glass**  
フロントウインドシールドの材質
29. Material (s) of front-door windows **Glass**  
フロントドアウインドーの材質
30. Material (s) of rear-door windows  
リアドアウインドーの材質
31. Sliding system of door windows **Vertical, manual**  
ドアウインドーの開閉方式
32. Material (s) of rear-quarter light **Glass**  
リアクォーターウインドーの材質

**ACCESSORIES AND UPHOLSTERY**  
アクセサリ

38. Interior heating : yes - ~~XX~~ 39. Air-conditioning : ~~XX~~ - no
40. Ventilation : yes - ~~XX~~
41. Front seats, type of seats and upholstery **Separate, Vinyl**
42. Weight of front seat (s), complete with supports and rails, out of the car :  
**12 kg × 2 lbs**
43. Rear seats, type of seats and upholstery **Bench, Vinyl**
44. Front bumper, material (s) **Steel** Weight **3.5 kg** lbs  
フロントバンパーの材質 重量
45. Rear bumper, material (s) **Steel** Weight **3.5 kg** lbs  
リアバンパーの材質 重量

**WHEELS**  
ホイール

50. Type **Pressed steel**  
形式
51. Weight (per wheel, without tyre) **4.5 kg** lbs  
重量
52. Method of attachment **4 Nuts**  
取付け方法
53. Rim diameter **330 mm** **13 inches**  
リム径
54. Rim width **102 mm** **4 inches**  
リム幅

**STEERING**  
ステアリング

60. Type **Rack and pinion**  
形式
61. Servo-assistance : ~~XX~~ - no  
パワーステアリング ~~XX~~ - 無
62. Number of turns of steering wheel from lock to lock **3.3**  
ロックツーロック
63. In case of servo-assistance





Make FUJI

Model A 22  
型式

J·A·F公認番号 1-184  
F.I.A. Rec. No. 5453

**SUSPENSION**  
サスペンション

70. Front suspension (photogr. D), type  
フロントサスペンションの形式 Mc Pherson.
71. Type of spring  
スプリングの種類 Coil.
72. Stabiliser (if fitted) Torsion bar
73. Number of shockabsorbers 2  
ショックアブソーバーの数
74. Type Hydraulic Telescopic.  
形式
78. Rear suspension (photogr. E), type  
リヤサスペンションの形式 Trailing arm.
79. Type of spring  
スプリングの種類 Torsion bar.
80. Stabiliser (if fitted)
81. Number of shockabsorbers 2  
ショックアブソーバーの数
82. Type Hydraulic Telescopic.  
形式

**BRAKES** (photographs F and G)  
ブレーキ

90. System Hydraulic  
作動方式
91. Servo-assistance (if fitted), type  
サーボシステムの形式
92. Number of hydraulic master cylinders 1  
マスターシリンダーの数

	FRONT フロント		REAR リヤ	
93. Number of cylinders per wheel ホイール当りのシリンダー数	1		1	
94. Bore of wheel cylinder (s) ホイールシリンダーの内径	54.0 mm	in.	14.3 mm	in.
<b>Drum Brakes</b> ドラムブレーキ				
95. Inside diameter ドラムの内径	mm	in.	180 mm	in.
96. Length of brake linings ライニングの長さ	mm	in.	141 mm	in.
97. Width of brake linings ライニングの幅	mm	in.	30 mm	in.
98. Number of shoes per brake ブレーキ当りのシューの数			2	
99. Total area per brake 1 ブレーキ当りの総摩擦面積	mm <sup>2</sup>	sq. in.	8460 mm <sup>2</sup>	sq. in.
<b>Disc brakes</b> ディスクブレーキ				
100. Outside diameter ディスクの外径	229 mm	in.	mm	in.
101. Thickness of disc ディスクの厚さ	10 mm	in.	mm	in.
102. Length of brake linings パッドの長さ	97 mm	in.	mm	in.
103. Width of brake linings パッドの幅	45 mm	in.	mm	in.
104. Number of pads per brake. ブレーキ当りのパッドの数	2			
105. Total area per brake 1 ブレーキ当りの総摩擦面積	7800 mm <sup>2</sup>	sq. in.	mm <sup>2</sup>	sq. in.





Make FUJI

Model A22  
型式

**ENGINE** (photographs J and K) \*\*

- エンジン
130. Cycle サイクル 4 131. Number of cylinders シリンダー数 4
132. Cylinder arrangement シリンダー配列 Horizontally opposed
133. Bore ボア 85.0 mm 3.35 in. 134. Stroke ストローク 60.0 mm 2.36 in.
135. Capacity per cylinder シリンダーの排気量 340.3 cm<sup>3</sup> 20.76 cu. in.
136. Total, cylinder-capacity 総排気量 1361.2 cm<sup>3</sup> 83.04 cu. in.
137. Material (s) of cylinder block シリンダーブロックの材質 Aluminum alloy.
138. Material (s) of sleeves (if fitted) スリーブの材質 Cast iron.
139. Cylinder-head, material (s) シリンダーヘッドの材質 Aluminum alloy. Number fitted 2
140. Number of inlet ports 1 per cylinder head 吸気孔の数 141. Number of exhaust ports 2 per cylinder head 排気孔の数 2
142. Compression ratio 10.0
143. Volume of one combustion chamber 285 cm<sup>3</sup> cu. in.
144. Piston, material ピストンの材質 Aluminum alloy. 145. Number of rings リングの数 3
146. Distance from gudgeon pin centre line to highest point of piston crown 33 mm inches
147. Crankshaft : ~~cast~~ / stamped クランクシャフト ~~鋳造~~ / 鍛造 148. Type of crankshaft : integral / ~~cast~~ クランクシャフトの形式 : 一体式 / ~~鋳造~~
149. Number of crankshaft main bearings メインベアリングの数 3
150. Material of bearing cap ベアリングキャップの材質
151. System of lubrication : ~~dry sump~~ / oil in sump 潤滑方式 : ~~ドライサンプ~~ / ウェットサンプ
152. Capacity, lubricant 潤滑油量 3.3 ltrs pts quarts US
153. Oil cooler : ~~yes~~ / no オイルクーラー : ~~有~~ / 無 154. Method of engine cooling エンジン冷却方式 Water, quarts US
155. Capacity of cooling system 6.0 ltrs pints
156. Cooling fan (if fitted), dia. 260 mm (Electric fan) inches
157. Number of blades of cooling fan 4

**Bearings \*\***

- ベアリング
158. Crankshaft main, type メインベアリングの形式 Plain, Dia. 50 mm in.
159. Connecting rod big end, コンロッド大端部ベアリングの形式 Plain, Dia. 45 mm in.

**Weights \*\***

160. Flywheel (clean) 10.6 kg lbs
161. Flywheel with clutch (all turning parts) 14.6 kg lbs
162. Crankshaft 6.3 kg lbs 163. Connecting rod 0.43 kg lbs
164. Piston with rings and pin 0.45 kg lbs

\*\* for additional information concerning Wankel rotary engines see page 15, 16  
ロータリーエンジンは15、16頁参照





Make FUJI

Model A22  
型式

**FOUR STROKE ENGINES \* , \*\***  
4サイクルエンジン

- 170. Number of camshafts **1** 171. Location **Crank case.**  
カムシャフトの数 カムシャフトの位置
- 172. Type of camshaft drive **Gear.**  
カムシャフトの駆動方式
- 173. Type of valve operation **Push rod.**  
バルブの作動方式

**INLET** (see page 8) \* , \*\*  
吸気系

- 180. Material(s) of inlet manifold **Aluminum alloy**  
マニホールドの材質
- 181. Diameter of valves **37 mm** 1.46 inches  
バルブの径
- 182. Max. valve lift **9 mm** 0.35 in.  
バルブリフト
- 183. Number of valve springs **2**  
バルブスプリングの数
- 184. Type of spring **Coil**  
バルブスプリングの種類
- 185. Number of valves per cylinder **1**  
シリンダー当りのバルブの数
- 186. Tappet clearance for checking timing (cold) **0.25 mm** inches
- 187. Valves open at (with tolerance for tappet clearance indicated) **B.T.D.C. 40° ± 5°**
- 188. Valves close at (with tolerance for tappet clearance indicated) **A.B.D.C. 76° ± 5°**
- 189. Air filter, type **Dry**

**EXHAUST** (see page 8) \* , \*\*  
排気系

- 195. Material(s) of exhaust manifold **Steel**
- 196. Diameter of valves **33 mm** 1.30 inches  
バルブの径
- 197. Max. valve lift **9 mm** 0.35 in.  
バルブリフト
- 198. Number of valve springs **2**  
バルブスプリングの数
- 199. Type of spring **Coil**  
バルブ・スプリングの種類
- 200. Number of valves per cylinder **1**  
シリンダー当りのバルブの数
- 201. Tappet clearance for checking timing (cold) **0.30 mm** inches
- 202. Valves open at (with tolerance for tappet clearance indicated) **B.B.D.C. 76° ± 5°**
- 203. Valves close at (with tolerance for tappet clearance indicated) **A.T.D.C. 40° ± 5°**

**CARBURETION** (photograph N)  
気化器

- 210. Number of carburetors fitted **2**
- 211. Type **Down draft.**
- 212. Make **HITACHI**
- 213. Model **DCG 306**  
型式
- 214. Number of mixture passages per carburettor **2**
- 215. Flange hole diameter of exit port(s) of carburettor **26 & 30 mm** in.
- 216. Minimum dimensions of mixture passage(s) ~~XXXXXX~~  
ベンチュリーの最小寸法 **18 & 27 mm** inches

**INJECTION** (if fitted)  
燃料噴射

- 220. Make of pump  
ポンプの製造会社
- 221. Number of plungers  
プランジャーの数
- 222. Model or type of pump  
ポンプの型式
- 223. Total number of injectors  
ノズルの総数
- 224. Location of injectors  
ノズルの位置
- 225. Minimum diameter of inlet pipe **mm** inches  
吸気管の最小径

\* ) for additional information concerning two-stroke engines and super-charged engines see page 14.  
2サイクルエンジン、過給機付エンジンは14頁参照

\*\* ) for additional information concerning Wankel rotary engines see page 15, 16.  
ロータリーエンジンは15, 16頁、参照





Make FUJI

Model A 22  
型式

J.A.F 公認番号 T-184  
F.I.A. Rec. No. 5453

**ENGINE ACCESSORIES**  
エンジン補機

- 230. Fuel pump : ~~mechanical~~ / ~~electric~~  
燃料ポンプ ~~機械式~~ / ~~電気式~~
- 231. No. fitted 1  
ポンプの数
- 232. Type of ignition system **Make & break.**  
点火方式
- 233. No. of distributors 1  
ディストリビューターの数
- 234. No. of ignition coils 1  
コイルの数
- 235. No. of spark plugs per cylinder / ~~XXXX~~ 1  
シリンダー当りのプラグ数 ~~XXXX~~
- 236. Generator, type: ~~dynamo~~ / alternator - number fitted 1  
発電器 ~~直流~~ / 交流 数
- 237. Method of drive **V-Belt.**  
駆動方式
- 238. Voltage of generator 12 volts  
バッテリーの電圧
- 239. Battery, number 1
- 240. Location **Engine room.**  
バッテリー位置
- 241. Voltage of battery 12 volts  
バッテリー電圧

**ENGINE AND CAR PERFORMANCES** (as declared by manufacturer in catalogue)

- 250. Max. engine output 93PS (type of horsepower: JIS ) at 6800 rpm
- 251. Maximum rpm 7000 output at that figure 92PS
- 252. Maximum torque **11.0 Kg - m** at 4800 rpm
- 253. Maximum speed of the car 170 km/hour miles / hour

255. Cam profile  
カムプロフィール

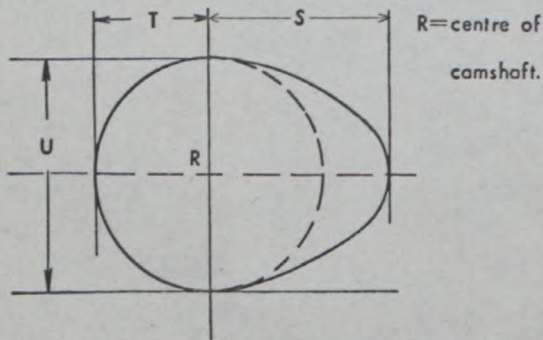

Inlet cam

	mm	inches
S =	19.7	0.78
T =	13.5	0.53
U =	27.0	1.06

Exhaust cam

	mm	inches
S =	19.7	0.78
T =	13.5	0.53
U =	27.0	1.06





Make FUJI

Model A22  
 型式

Drawing inlet manifold ports, side of cylinder-head/~~housing~~ scale or dimensions and manufacturing tolerance.

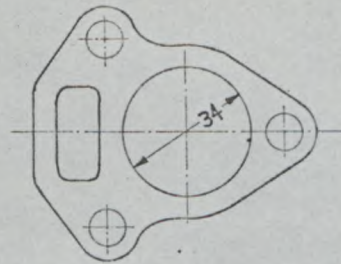

Drawing of entrance to inlet port of cylinder-head/~~housing~~ scale or dimensions and manufacturing tolerance.

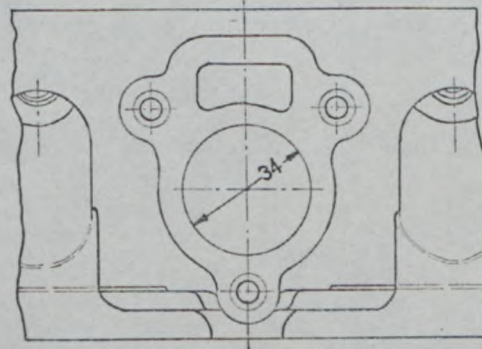

Drawing exhaust manifold ports, side of cylinder-head/~~housing~~ scale or dimensions and manufacturing tolerance.

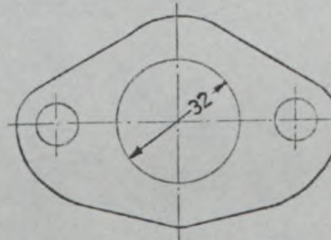

Drawing of exit to exhaust port of cylinderhead/~~housing~~ Indicate scale or dimensions and manufacturing tolerance.

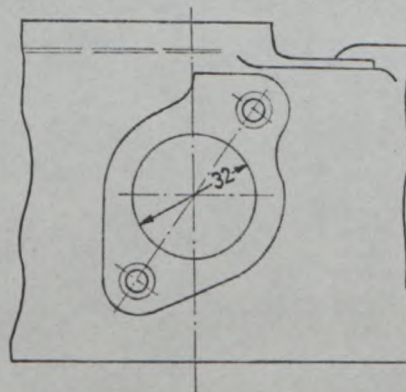

Unit: mm  
 Tolerance:  $\pm 1.5$

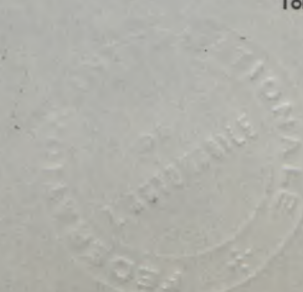



**DRIVE TRAIN**

駆動系

**CLUTCH**

クラッチ

260. Type of clutch **Dry plate.** 261. No. of plates **1**  
形式 プレッシャープレートの数
262. Dia. of clutch plates **180 mm** inches  
プレッシャープレートの外径
263. Dia. of linings, inside **125 mm** in. outside **180 mm** in.  
フェーシングの内径 外径
264. Method of operating clutch **Mechanical.**  
作動方式

**GEAR BOX** (photograph H)

トランスミッション

270. Manual type, make **FUJI HEAVY INDUSTRIES LTD.** Method of operation **Mechanical.**  
手動式の製造会社名 作動方式
271. No. of gear-box ratios forward **4** 272. Synchronized forward ratios **1, 2, 3 & 4**  
前進段数
273. Location of gear-shift **Floor**  
シフトレバーの位置
274. Automatic, make **type**  
自動式の製造会社名 形式
275. No. of forward ratios **276. Location of gear-shift**  
前進段数 シフトレバーの位置

277.	Manual 手動		Automatic 自動		Alternative <del>Manual/Automatic</del> 手動/自動			
	Ratio ギヤー比	No. teeth 歯数	Ratio ギヤー比	No. teeth 歯数	Ratio ギヤー比	No. teeth 歯数	Ratio ギヤー比	No. teeth 歯数
1	3.3 1	43/13			2.7 4	41/15		
2	2.1 8	37/17			1.8 4	35/19		
3	1.4 8	37/25			1.3 5	35/26		
4	1.0 3	31/30			1.1 0	32/29		
5								
6								
reverse リバース	4.1 0	41/10			4.1 0	41/10		

278. Overdrive, type **オーバードライブ形式**
279. Forward gears on which overdrive can be selected **オーバードライブの作動段数**
280. Overdrive ratio **オーバードライブ比**

**FINAL DRIVE**

ファイナル

290. Type of final drive **Hypoid gear.**  
形式
291. Type of differential **Bevel gear.**  
差動機形式
292. Type of limited slip differential (if fitted)  
リミテッドスリップデフの形式
293. Final drive ratio **3.89 3.56**  
ギヤー比  
Number of teeth **35/9 32/9**  
歯数





Make FUJI

Model A 22  
型式

J·A·F公認番号 T-184  
F.I.A. Rec. No. 5453  
1/17

Optional equipment affecting preceding information. This to be stated together with reference number.  
オプション:

**VALID FOR GROUP II ONLY.**

- \* 91. Servo-assistance, type Vacuum
- \* Rear spoiler (parts No. 000404108)



\* Over fender

"A" type Front



Rear



"B" type Front



Rear





Make FUJI

Model A22  
型式



J.A.F.公認番号 T-184  
F.I.A. Rec. No. 5453

Photograph  
写真

B, 3/4 view of car from rear 全体写真(斜め後方)



C, Interior view of car through driver's door (open or removed) with dashboard 運転席附近



D, Front axle complete, removed from car. Without wheels. フロントサスペンション



E, Rear axle complete without wheels, removed from car. リヤサスペンション

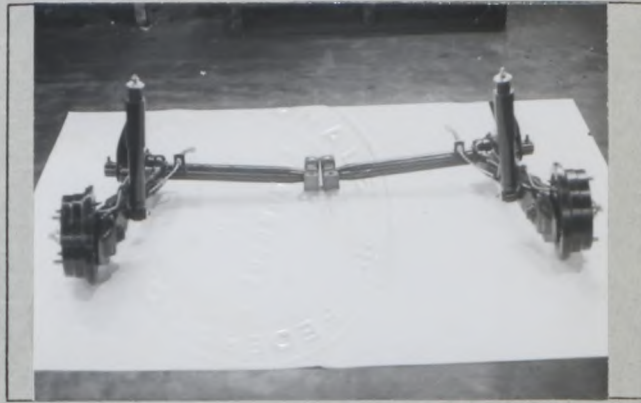

F, Front brake, drum removed or disc with caliper(s) フロントブレーキ



G, Rear brake, drum removed or disc with caliper(s) リヤブレーキ



H, Gear-box, view from side トランスミッション

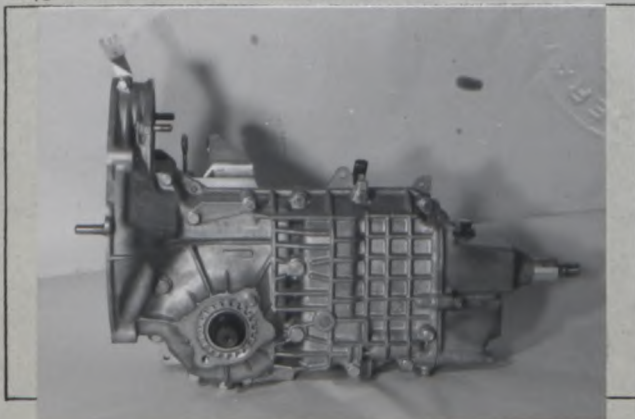

I, Silencer + exhaust pipes after exhaust manifold. 排気系





Make FUJI

Model A 22  
型式



J.A.F.公認番号 T-184

F.I.A. Rec. No. 5453

Photograph

Engine unit out of car, from right. With clutch and accessories but without air filter nor gear-box. エンジン右側面

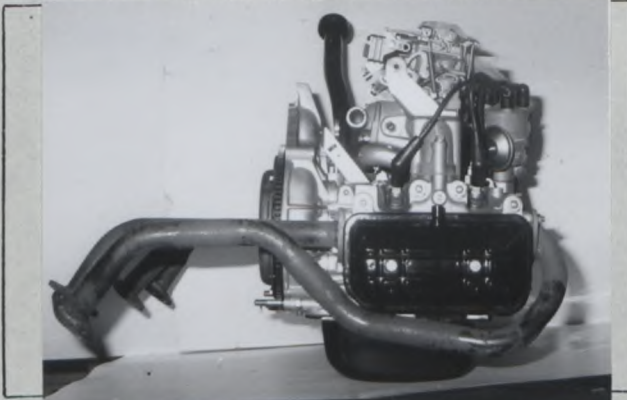

L, Combustion chamber 燃焼室 / Rotor housing

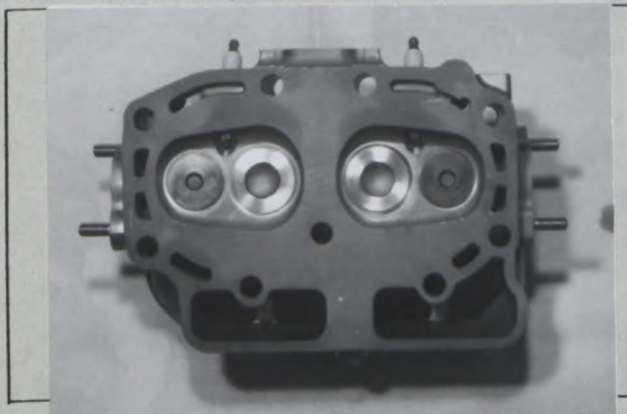

N, Carburettor (view from side of manifold) 気化器

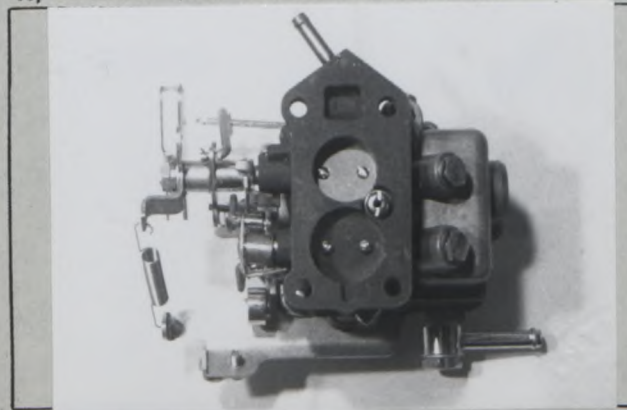

P, Inlet manifold 吸気マニホールド

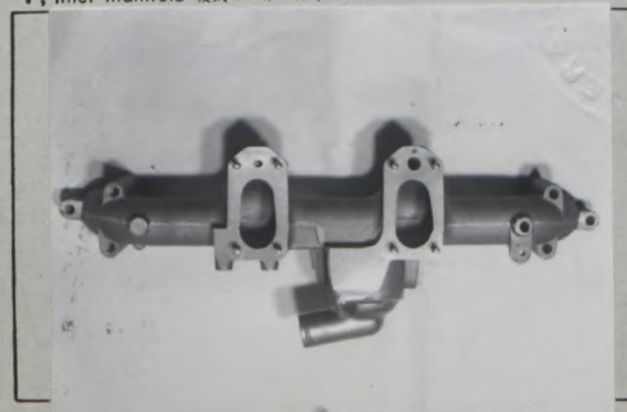

写真

Engine unit out of car, from left. With clutch and accessories but without gear-box nor air filter. エンジン左側面

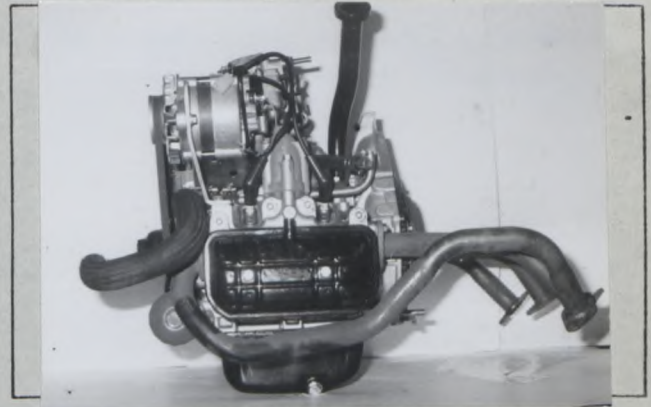

M, Piston crown ピストンクラウン / Rotor crank



O, Engine in car with all accessories, bonnet open or removed. エンジンルーム

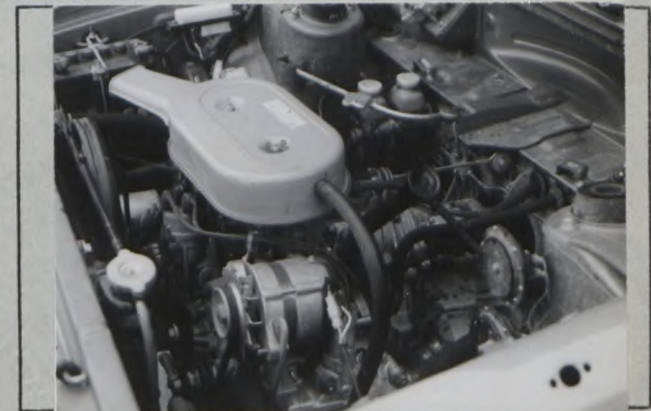

Q, Exhaust manifold 排気マニホールド





DIMENSIONS OF INTERIOR  
室内寸法  
(Conform to Art. 253 b of Appendix J)

For four seaters:  
4座席

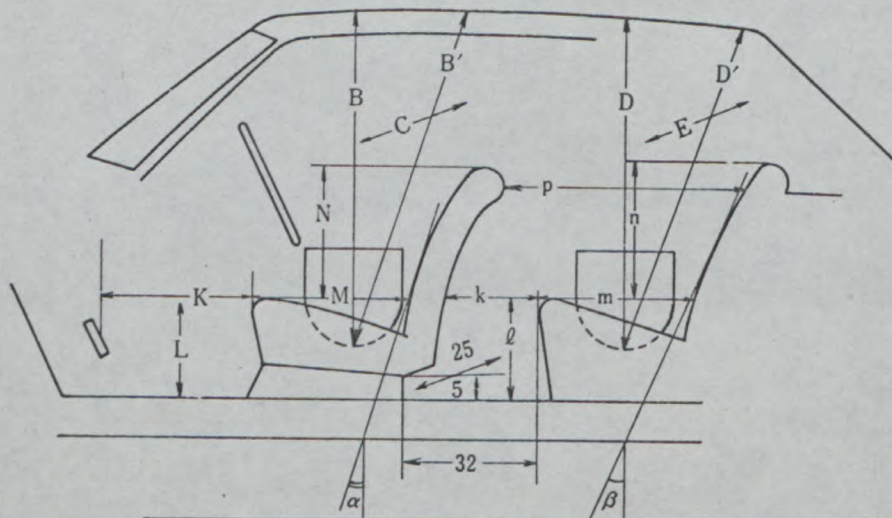

Minimum Dimensions (cm)							
B	B'	$\alpha$	C	D	D'	$\beta$	E
88	94	15°	122	87	86	22°	126

Minimum Dimensions (cm)										
L	$\ell$	M	m	N	n	k+m	p	k	k+l+m	K+L+M
33	32	46	42.5			65.5	65	23	97.5	121
0.9L = 29.7		0.85M = 39.1		0.8N =		0.8(k+m) = 52.4		(15)	(95)	(120)

For two seaters:  
2座席

Minimum Dimensions	
B	C
cm	cm

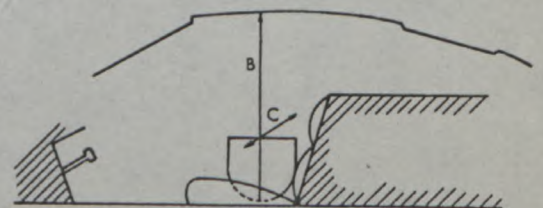



Make FUJI

Model A22  
型式

J·A·F 公認番号 T-184  
F.I.A. Rec. No. 5453

TWO STROKE ENGINES  
2 サイクルエンジン

300. System of cylinder scavenging 掃気方式					
301. Type of lubrication 潤滑方式					
302. Inlet ports, length measured around cylinder wall 吸気孔の幅			mm		inches
303. Height inlet port 吸気孔の高さ	mm	in.		304. Area 吸気孔の総面積	mm <sup>2</sup> sq. in.
305. Exhaust ports, length measured around cylinder wall 排気孔の幅			mm		inches
306. Height exhaust port 排気孔の高さ	mm	in.		307. Area 排気孔の総面積	mm <sup>2</sup> sq. in.
308. Transfer port, length measured around cylinder wall 掃気孔の幅			mm		inches
309. Height transfer port 掃気孔の高さ	mm	in.		310. Area 掃気孔の総面積	mm <sup>2</sup> sq. in.
311. Piston ports, length measured around piston ピストンポートの幅			mm		inches
312. Height piston port ピストンポートの高さ	mm	in.		313. Area ピストンポートの総面積	mm <sup>2</sup> sq. in.
314. Method of precompression プレコンプレッション方式				315. Precompression cyl.:	yes /no
316. Bore	mm	inches		317. Stroke	mm inches
318. Distance from top of cyl. block to highest point of exhaust port : 排気孔の最高点とブロック上面との距離			mm		inches
319. Distance from top of cyl. block to lowest point of inlet port : 吸気孔の最下点とブロック上面との距離			mm		inches
320. Distance from top of cyl. block to highest point of transfer port : 掃気孔の最高点とブロック上面との距離			mm		inches
321. Drawing of cylinder ports. シリンダーポート展開図					

330. Supercharging—state full details hereafter :  
過給器

Unit: mm  
Tolerance:





Make FUJI Model A 22  
 型式

Wankel Rotary Engine (photographs J and K)  
 ローターエンジン

400. Type & cycle 形式及びサイクル			
401. No of rotors ローターの数			
402. Rotor arrangement ローターの配列			
403. Trochoid, length of major Axis トロコイド長軸長さ	mm		in.
404. Trochoid, length of minor Axis トロコイド短軸長さ	mm		in.
405. Trochoid, width トロコイドの幅	mm		in.
406. Trochoid, generating radius (Containing equidistance) トロコイドの創成半径 (平行移動量を含む)	mm		in.
407. Eccentricity 偏心率	mm		in.
408. Capacity per Rotor 1ローター当りの排気量	cm <sup>3</sup>		cu. in.
409. Total capacity 総排気量	cm <sup>3</sup>		cu. in.
410. Equivalent total capacity (by App. J Art. 252) 換算総排気量 (J項 252条による)	cm <sup>3</sup>		cu. in.
411. Material(s) of side housing サイドハウジングの材質			
412. Material(s) of rotor housing ローターハウジングの材質			
413. Number of inlet ports 吸気孔の数			
414. Number of exhaust ports 排気孔の数			
415. Compression ratio			
416. Volume of one combustion chamber	cm <sup>3</sup>		cu. in.
417. Rotor material ローターの材質			
418. Number of apex seal per rotor ローター当りのアペックスシールの数			
419. Number of corner seal per rotor ローター当りのコーナースीलの数			
420. Number of side seal per rotor ローター当りのサイドシールの数			





Make FUJI

Model A22  
 型式

421. Number of oil scraping ring per rotor 1 ローター当りのオイルリングの数					
422. Eccentric shaft: moulded/stamped 偏心軸: 鋳造/鍛造					
423. Type of eccentric shaft: integral/ 偏心軸の形式: 一体式/					
424. Number of eccentric shaft main bearings メインベアリングの数					
Bearing ベアリング					
440. Eccentric shaft, main メインベアリング	Type 形式	Dia. 内径	mm		in.
441. Rotor bearing ローターベアリング	Type 形式	Dia. 外径	mm		in.
Weights					
450. Flywheel (clean)				kg	
451. Flywheel with clutch (all turning parts)				kg	
452. Eccentric shaft				kg	
453. Rotor with seals, gear and bearing				kg	
Inlet (See page 8) 吸気系					
460. Material(s) of inlet manifold マニホールドの材質					
461. Location of inlet ports 吸気孔の位置					
462. Inlet port area per rotor.			mm <sup>2</sup>		sq. in.
463. Inlet port open at (with tolerance) 吸気孔開き始め (公差を含む)					
464. Inlet port close at (with tolerance) 吸気孔閉じ終り (公差を含む)					
465. Air filter type					
Exhaust (See page 8) 排気系					
470. Material(s) of exhaust manifold マニホールドの材質					
471. Location of exhaust Ports 排気孔の位置					
472. Exhaust port area per rotor			mm <sup>2</sup>		sq. in.
473. Exhaust port open at (with tolerance) 排気孔開き始め (公差を含む)					
474. Exhaust port close at (with tolerance) 排気孔閉じ終り (公差を含む)					







JAPAN AUTOMOBILE FEDERATION

社団 日本自動車連盟  
法人

J.A.F.公認番号 T-184V-8  
発効年月日 1975年 4月30日  
F.I.A. Homol. No 5453

1/1V

2/11

FEDERATION INTERNATIONALE DE L'AUTOMOBILE

Form of recognition accordance with  
Appendix J to the International Sporting Code.

国際スポーツ法典付則J項及びJAF国内競技車両規則に従った公認書式。

<b>Make</b> FUJI HEAVY INDUSTRIES LTD. 製造会社名	<b>Model</b> A22 SUBARU LEONE 型式及び通称名
<b>Modification's application starts with serial</b>	<b>No. chassis engine</b> 適用シャーシー型式番号 適用エンジン型式
Application of this amendment started the 適用年月日	A22-2350D1 EA63
Commercial denomination after application of modifications	OCT 1974

The modifications are to be considered as: Variant / ~~normal evolution of the type~~  
変型 / ~~正常進化~~

Date amendment is valid from

1-8-75

List

Description of amendment 内容

\* Different appearance ( 4 Lights)

Photo A



\* Different wheels

51 Weight 6.0 kg

54 Rim Width 127.0 mm 5 inches



Stamp and signature of the JAF

JAF公認印及び署名

難波靖治

Yasuharu Nanba



Stamp and signature of the F.I.A.





\* 1 Port exhaust type (Cylinder head)  
141, Number of exhaust ports

1 per cylinder head

2/11  
1/11

Photo L



Photo Q



Photo P

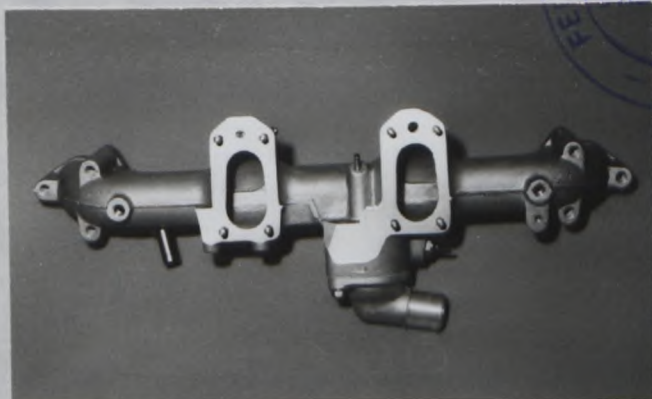

Photo I

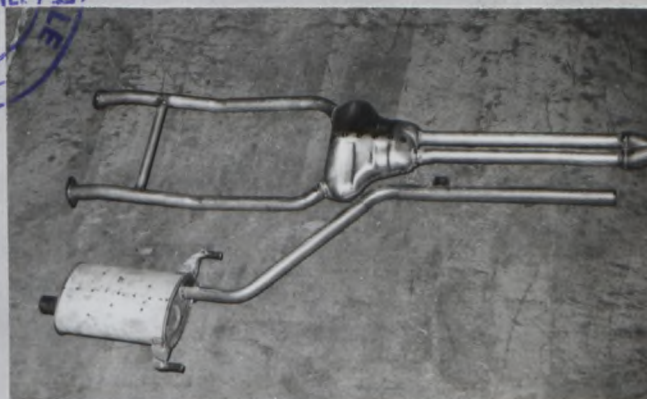

Photo J

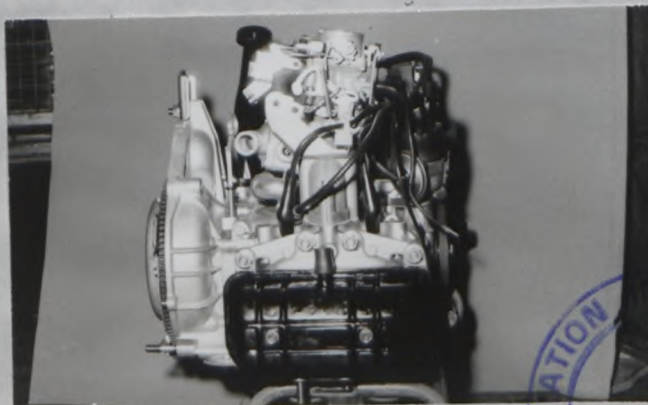

Photo K

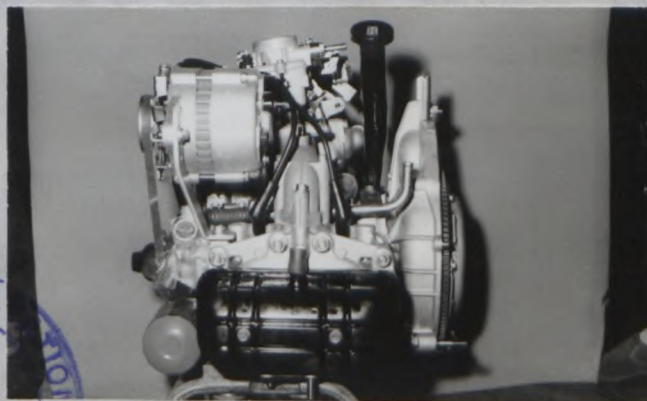

Photo D



FEDERATION INTERNATIONALE DE L'AUTOMOBILE  
FEDERATION INTERNATIONALE DE L'AUTOMOBILE  
FEDERATION INTERNATIONALE DE L'AUTOMOBILE JAPAN



2/11

COMBUSTION CHAMBER

\* Volume of one combustion chamber of cylinder head. 31.3 cm<sup>3</sup> 1.91 cu. in

\*\* Thickness of cylinder headgasket when compressed. 1.5 mm

Drawing exhaust manifold ports, side of cylinder-head/ scale or dimensions and manufacturing tolerance.

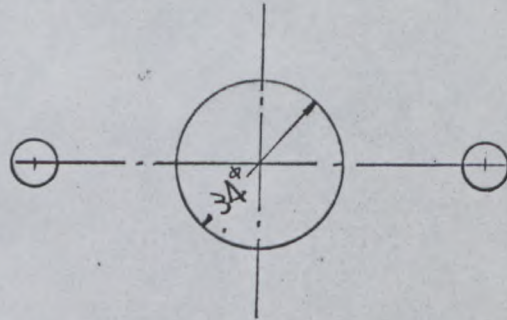

Drawing of exit to exhaust port of cylinderhead/ Indicate scale or dimensions and manufacturing tolerance.

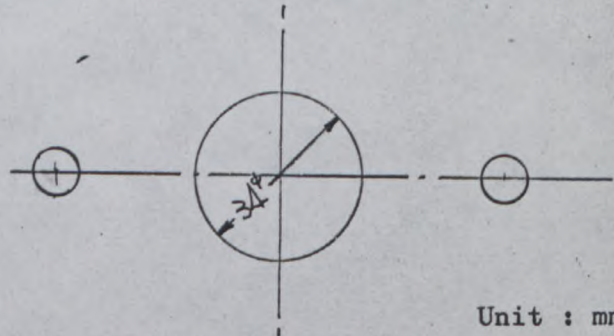

Unit : mm







JAPAN AUTOMOBILE FEDERATION

社団法人 日本自動車連盟

J.A.F 公認番号  
発効年月日

T-184 *V-20*  
47. 6. 30  
F.I.A. Homol. No 5453 *2/2V*

FEDERATION INTERNATIONALE DE L'AUTOMOBILE

Form of recognition accordance with  
Appendix J to the International Sporting Code.

国際スポーツ法典付則J項及びJAF国内競技車両規則に従った公認書式。

Make FUJI HEAVY Model A22 "SUBARU LEONE"  
 製造会社名 INDUSTRIES LTD. 型式及び通称名  
 Modification's application starts with serial No. chassis 適用シャーシー番号 A22-208015  
 engine 適用エンジン番号 EA63-217806  
 Application of this amendment started the Jan. 1972  
 適用年月日  
 Commercial denomination after application of modifications 2-door sedan & 4-door sedan  
 The modifications are to be considered as: Variant / ~~normal~~ evolution of the type  
 変型 / ~~正常進化~~  
 Date amendment is valid from List

Description of amendment 内容

1. Different coachwork models

2-door sedan



4-door sedan



Stamp and signature of the JAF

JAF公認印及び署名

難波清祐

Yasuharu Nanba



Stamp and signature of the F.I.A.

*[Signature]*



Make FUJI

Model A22  
型式

J.A.F.公認番号 T-184V-~~3~~  
F.I.A. Rec. No. 5453

		2- door type	4- door type
6.	Overall height of the car.	138.5cm	
9.	Weight, total weight of the car with normal equipment.	705 Kg 1556 lbs	735Kg 1622lbs
24.	Number of doors.	*	4
30.	Material (s) of rear-door windows.	*	Glass

\* Same as the basic form.

2. Different dashboard





**DIMENSIONS OF INTERIOR**  
室内寸法  
(Conform to Art. 253 b of Appendix J)

For four seaters:  
4座席

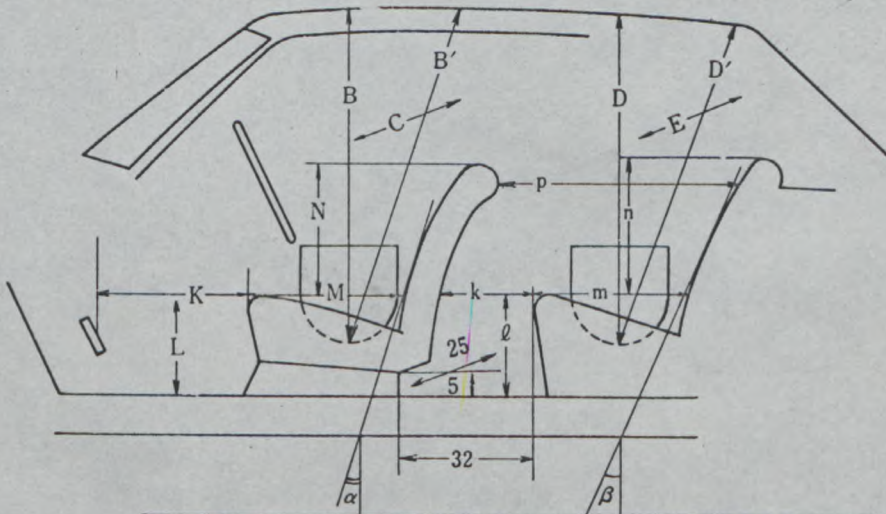

Minimum Dimensions (cm)							
B	B'	$\alpha$	C	D	D'	$\beta$	E
92	96	15°	125	92	90	20°	125

Minimum Dimensions (cm)										
L	$l$	M	m	N	n	k+m	p	k	k+l+m	K+L+M
32	32	48	45			67	67	22	99	120
0.9L = 28.8		0.85M = 40.8		0.8N =		0.85 0.8(k+m) = 57.0		(15)	(95)	(120)

For two seaters:  
2座席

Minimum Dimensions	
B	C
cm	cm

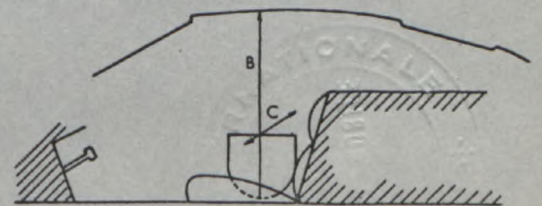





JAPAN AUTOMOBILE FEDERATION

社団法人 日本自動車連盟

J.A.F公認番号

発効年月日

T-184V-S

1973年7月31日

F.I.A. Homol. No 5453

3/3V

FEDERATION INTERNATIONALE DE L'AUTOMOBILE

Form of recognition accordance with Appendix J to the International Sporting Code.

国際スポーツ法典付則J項及びJAF国内競技車両規則に従った公認書式。

Make FUJI HEAVY INDUSTRIES LTD. Model A22 SUBARU LEONE
製造会社名 型式及び通称名
Modification's application starts with serial No. chassis 適用シャーシー番号 A22-200001
engine 適用エンジン番号 EA63

Application of this amendment started the November, 1972.

適用年月日
Commercial denomination after application of modifications

The modifications are to be considered as: Variant / normal evolution of the type

Date amendment is valid from 1 10 1973

List

Description of amendment 内容

\* 91. servo-assistance, type Vacuum

\* 5 speeds gear box "VALID FOR GROUP 2 ONLY"

Table with 3 columns: No., Ratio, No. teeth. Rows include 271. No. of gear-box ratios forward (5), 272. Synchronized forward ratios (1,2,3,4, & 5), and 277. Ratio and No. teeth for gears 1-5 and reverse.

Photo. H. Gear box, view from side (Parts No. 300001704)

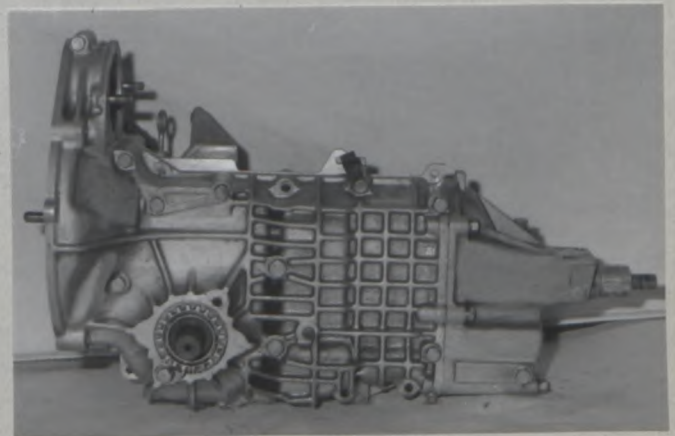

"valable en Groupe 2 uniquement"
"valid for Group 2 only"

Stamp and signature of the JAF

JAF公認印及び署名

Handwritten signature: Yasuharu Nanba



Yasuharu Nanba

Stamp and signature of the F.I.A.

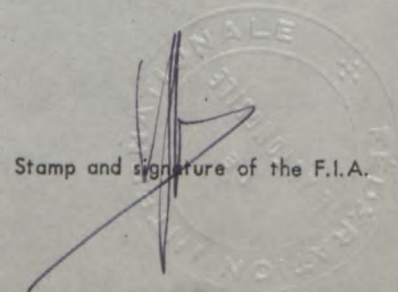



\* 4-wheel disc brakes "VALID FOR GROUP 2 ONLY"

	FRONT	REAR
94. Bore of wheel cylinder	51.1mm	30.2mm
100. Outside diameter	245mm	218mm
101. Thickness of disc	10mm	8mm
102. Length of brake linings	62mm	53mm
103. Width of brake linings	41mm	36mm
104. Number of pads per brake	2	2
105. Total area per brake	5,040mm <sup>2</sup>	3,820mm <sup>2</sup>

Photo. F. Front brake, disc with caliper(s)

(Parts No. L 625020051+623820040)  
R 625020041+623820040



Photo. G. Rear brake, disc with caliper(s)

(Parts No. L 625020070+623820060)  
R 625020060+623820060

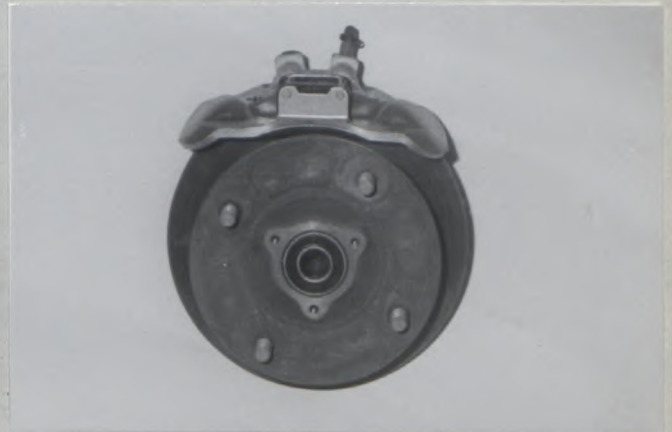

\* Under guard "VALID FOR GROUP 2 ONLY"

(Parts No. 000460931)



"valable en Groupe 2 uniquement"  
"valid for Group 2 only"







JAPAN AUTOMOBILE FEDERATION

社団法人 日本自動車連盟

J.A.F公認番号 T-184V-6  
発効年月日 46. 10. 31

F. I. A. Homol. No 5453

h/hv

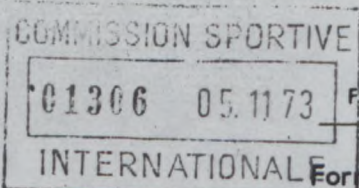

FEDERATION INTERNATIONALE DE L'AUTOMOBILE

Form of recognition accordance with Appendix J to the International Sporting Code.

国際スポーツ法典付則J項及びJAF国内競技車両規則に従った公認書式。

<b>Make</b> FUJI HEAVY INDUSTRIES LTD	<b>Model</b> A22 SUBARU LEONE
製造会社名	型式及び通称名
Modification's application starts with serial No.	適用シャーシー型式番号 A22
	適用エンジン型式番号 EA63

Application of this amendment started the OCT 1973  
適用年月日

Commercial denomination after application of modifications

The modifications are to be considered as: Variant / ~~normal evolution of the type~~  
変型 正命進化

Date amendment is valid from 1.1.74 List

Description of amendment 内容

\* Different coach work model ( Hard top Type )



9 Weight, total weight of the car with normal equipment 720 kg

\* Different WHEELS

51 Weight 5.0 kg

54 Rim width mm 4.5 inches

Stamp and signature of the JAF

JAF公認印及び署名

難波靖彦

Yasuharu Nanba



Stamp and signature of the F.I.A.

[Signature]



\* Different appearance

Photo. A. 3/4 View of car from front

Coupe, type

2 door, type



4 door  
type



Photo. B. 3/4 View of car from rear

Coupe, type

2 door, type



4 door  
type





\* Different dashboard

Coupe type



2 door and 4 door type



Hard top type







JAPAN AUTOMOBILE FEDERATION

社団法人 日本自動車連盟

J.A.F公認番号 T-184V-7  
発効年月日 1974年7月31日  
F.I.A. Homol. No 5453

5/5V

FEDERATION INTERNATIONALE DE L'AUTOMOBILE

Form of recognition accordance with Appendix J to the International Sporting Code.

国際スポーツ法典付則J項及びJAF国内競技車両規則に従った公認書式。

Model A22 SUBARU  
Make FUJI HEAVY INDUSTRIES LTD. 型式及び通称名  
Modification's application starts with serial No. chassis 適用シャーシー番号 A22-200001  
engine 適用エンジン番号 EA63  
Application of this amendment started the November, 1972  
適用年月日  
Commercial denomination after application of modifications

The modifications are to be considered as: Variant / ~~normal evolution of the type~~  
変型 / ~~正常進化~~

Date amendment is valid from 4.10.74 List

Description of amendment 内容

5 Speeds Gear Box: Transfer from Group 2 to Group 1

- 271. No. of gear-box ratios forward 5
- 272. Synchronized forward ratios 1, 2, 3, 4 & 5
- 277.

	Ratio	No. teeth
1	3.31	43/13
2	2.16	41/19
3	1.52	41/27
4	1.16	37/32
5	0.94	33/35
reverse	4.10	41/10

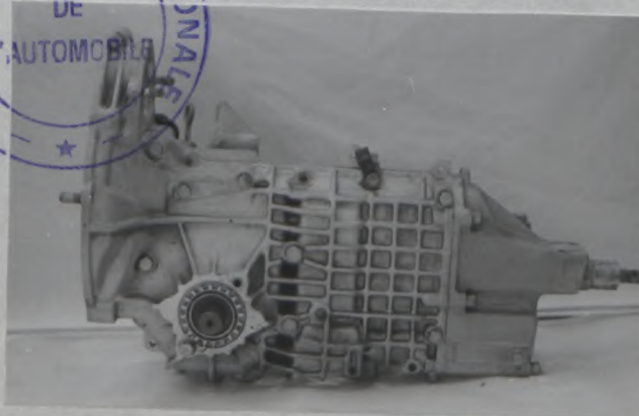

Photo, H.

Gear-box, view from side  
(Part No. 300001704)

Stamp and signature of the JAF

JAF公認印及び署名

難波靖治

Yasuharu Nanba



Stamp and signature of the F.I.A.





JAPAN AUTOMOBILE FEDERATION

社団 日本自動車連盟  
法人

J.A.F.公認番号

T-184V-9

発効年月日

昭和51年1月31日

F.I.A. Homol. No 5453

G/W

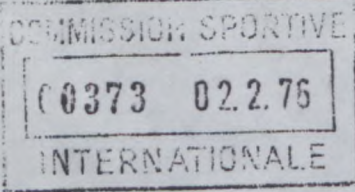

FEDERATION INTERNATIONALE DE L'AUTOMOBILE

Form of recognition accordance with  
Appendix J to the International Sporting Code.

国際スポーツ法典付則J項及びJAF国内競技車両規則に従った公認書式。

Make FUJI HEAVY INDUSTRIES LTD. Model A22 SUBARU LEONE  
製造会社名 型式及び通称名  
 Modification's application starts with serial No. chassis 適用シャーシー型式番号 A26-002001, A22-235001  
 engine 適用エンジン型式 EA71

Application of this amendment started the Sep. 1975

適用年月日

Commercial denomination after application of modifications

The modifications are to be considered as: Variant / ~~normal evolution of the type~~  
変型 / 正常進化

Date amendment is valid from

1 h 76 List

Description of amendment 内容

\* Different appearance (Front GRILLE & BUMPER)

Photo A



Photo B



\* 1600cc engine

65) Bore 92.0 mm 3.62 inches

66) Maximum bore allowed 92.1 mm 3.63 inches

68) Total cylinder-capacity 1595 cm<sup>3</sup> 97.33 inches<sup>3</sup>

69) Maximum cylinder-capacity allowed 1600 cm<sup>3</sup> 97.64 inches<sup>3</sup>

112) Ground clearance 17.0 cm 6.69 inches

Stamp and signature of the JAF

JAF公認印及び署名

難波靖治

Yasuharu Nanba



Stamp and signature of the F.I.A.





- 135) Capacity per cylinder 398.86 cm<sup>3</sup> 24.340 inches<sup>3</sup>
- 139) Compression ratio 9.2
- 140a) Volume of the combustion chamber 43.5 cm<sup>3</sup>
- 140b) Volume of combustion chamber in head 33.1 cm<sup>3</sup>
- 147) Capacity lubricant 5.5 liters
- 148) Cooling fan diameter 280 mm
- 151) Weight of flywheel 10.9 kg
- 152) Weight of flywheel with starter ring 11.4 kg
- 153) Weight of flywheel with clutch 16.3 kg
- 156) Weight of piston with rings and pin 0.57 kg
- 161) Outside diameter of Valves 40 mm 1.57 inches
- 171) Outside diameter of Valves 37 mm 1.46 inches
- 186) Minimum diameter of venturi 20 & 27 mm
- 211) Diameter 202 mm
- 212) Diameter of linings : interior 130 mm outside 200 mm
- 221) Number of teeth of final drive 33/8 or 35/9
- 222) Final drive ratio 4.13 or 3.89

96)

手動/Manual		
	比 Ratio	歯数 Nr teeth
1	3.31	43/13
2	2.53	38/15
3	1.96	45/23
4	1.52	41/27
5	1.03	35/34
6		
リバース/Rev.	4.10	41/10





Photo I

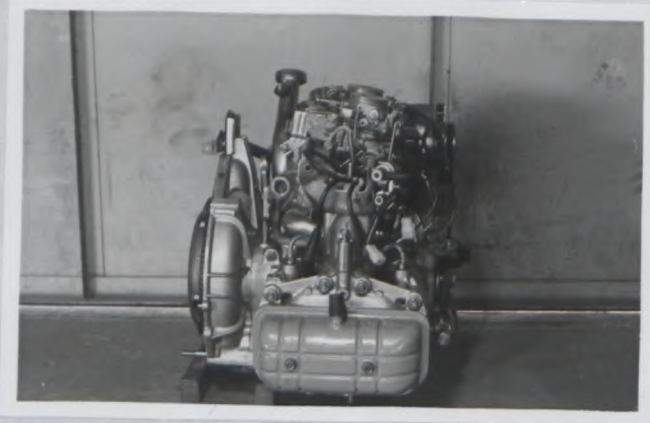

Photo J

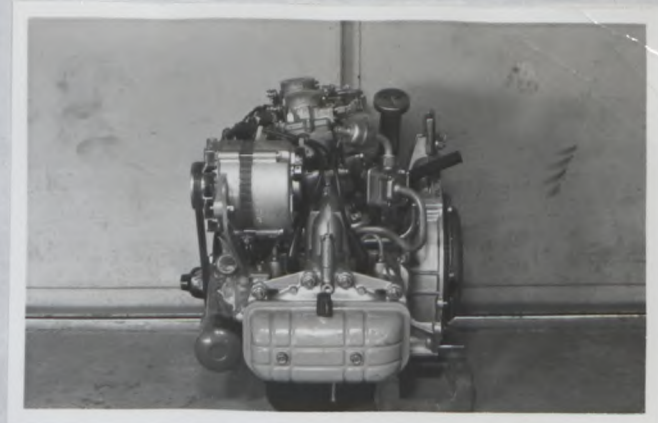

Photo K

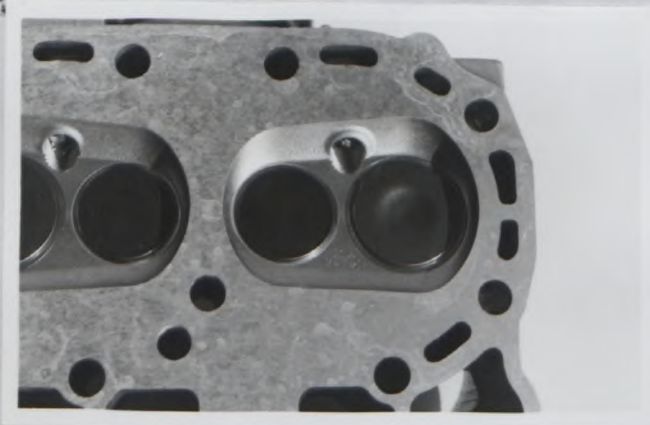

Photo L

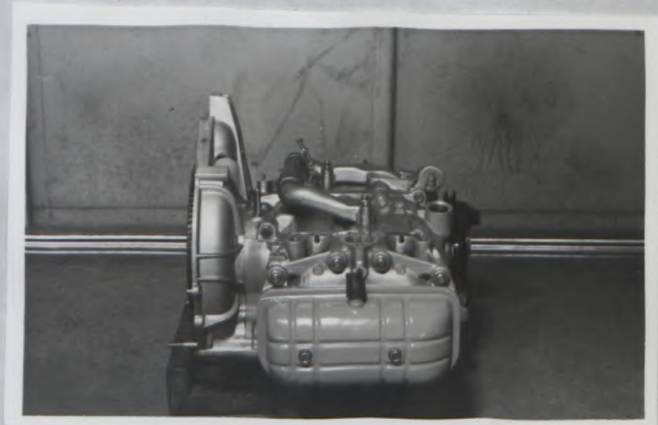

Photo M

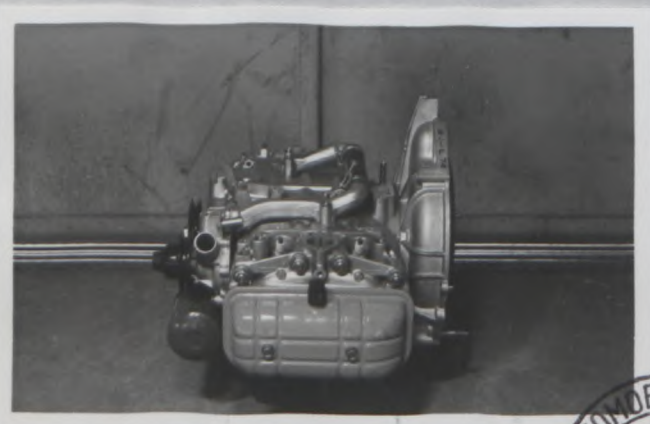

Photo P



Photo Q



Photo R

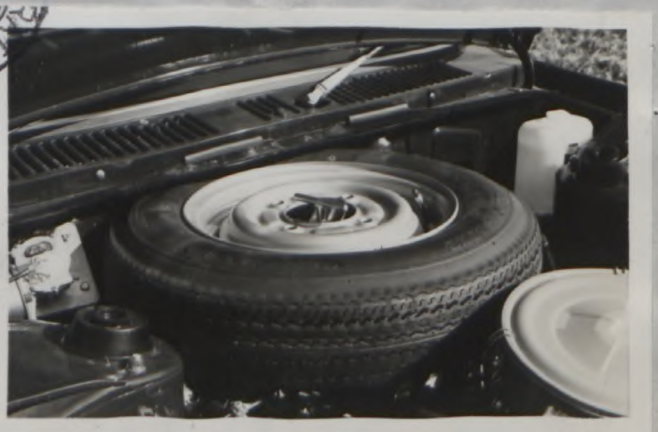



会社名  
Make

FUJI

型式  
Model

A 2 6

FIA Rec. No. 5 4 5 3

Unit: mm

吸気マニホールドのポートの寸法  
(シリンダーヘッド又はハウジング側)  
Drawing of inlet manifold ports, side  
of cylinderhead/housing  
with dimensions

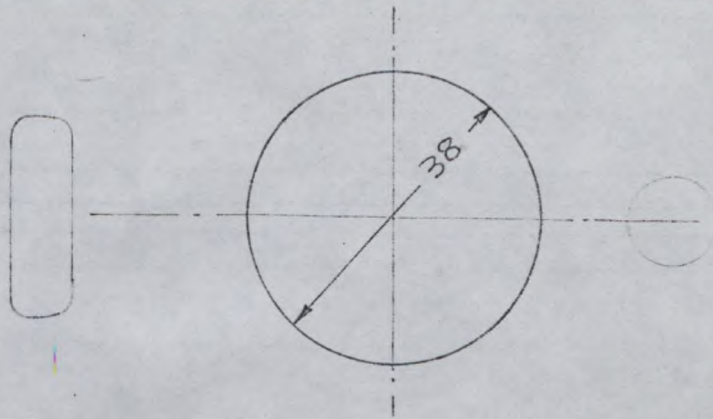

シリンダーヘッド又はハウジングの吸気ポート  
の寸法  
(吸気マニホールド側)  
Drawing of entrance to inlet port  
of cylinderhead/housing  
with dimensions

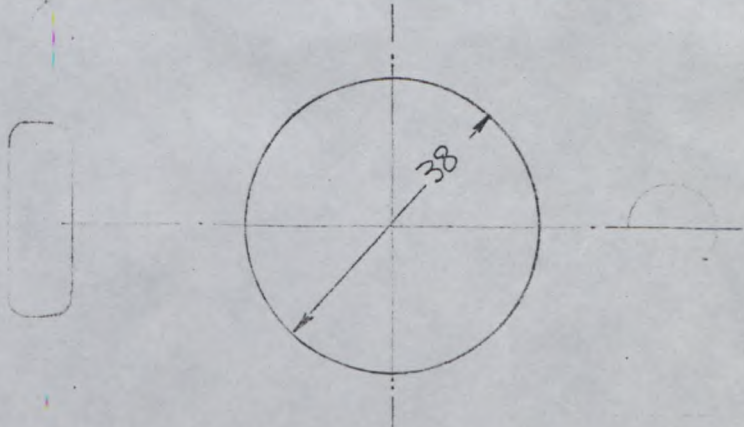

排気マニホールドのポートの寸法  
(シリンダーヘッド又はハウジング側)  
Drawing of exhaust manifold ports,  
side of cylinderhead/housing  
with dimensions

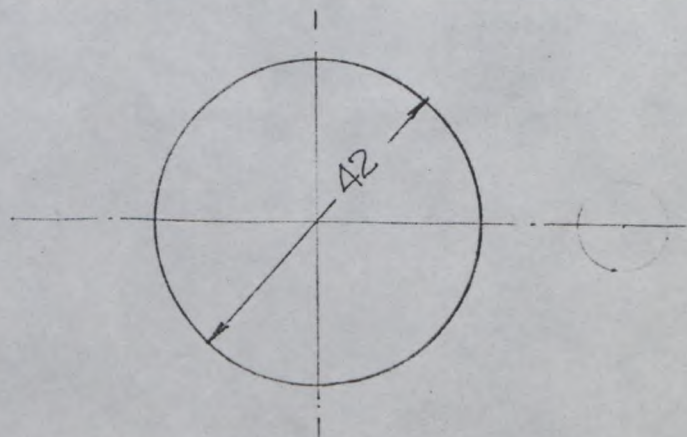

シリンダーヘッド又はハウジングの排気ポート  
の寸法  
(排気マニホールド側)  
Drawing of exit to exhaust port of  
cylinderhead/housing  
with dimensions

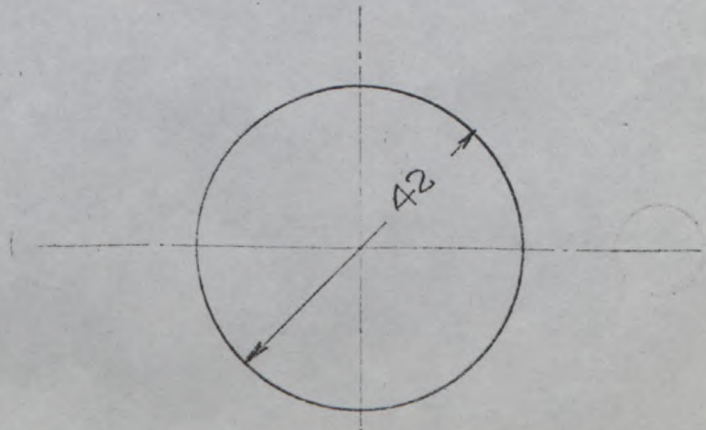



\* Different exhaust type (Exhaust piping with muffler & manifold)

TYPE A

Photo V

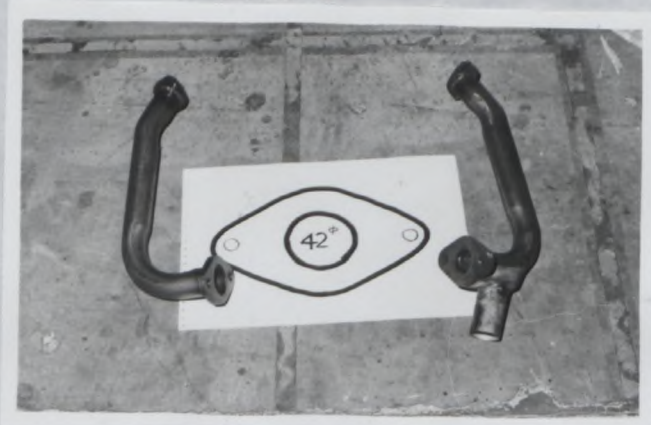
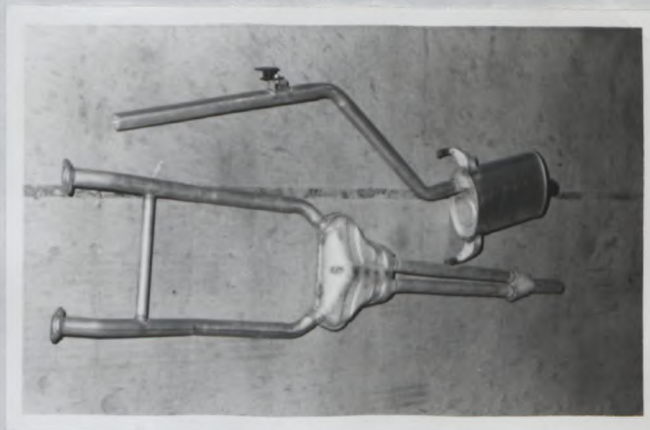

Photo V



TYPE B

Photo U

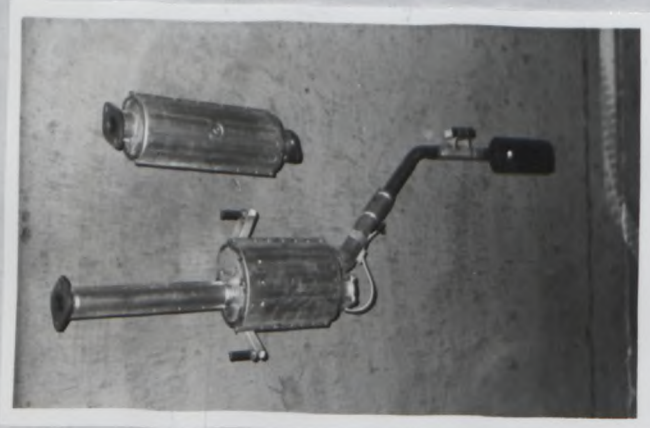
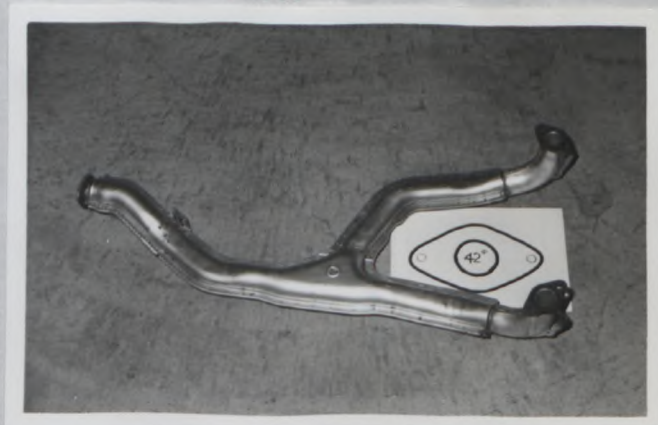

Photo V



\* Different appearance (Rear combination lamp)

Photo B





Make FUJI

Model A26

JAF 公認番号 T-184V-9  
FIA. Rec. NO 5453

\* Different front seat

Photo Q

A type



B type



\* Different Location of spare-wheel

Photo R

A type



~~B type~~

\* Different Wheels

- 124) Material Aluminum
- 125) Unitary Weight 5.0 kg
- 127) Rim Width 127 mm 5 inchs

Photo P







JAPAN AUTOMOBILE FEDERATION

社団法人 日本自動車連盟

J-A-F公認番号 T-184V-10

発効年月日 昭和52年5月31日

F.I.A. Homol. No 5453 7/7J

FEDERATION INTERNATIONALE DE L'AUTOMOBILE

Form of recognition accordance with Appendix J to the International Sporting Code.

国際スポーツ法典付則J項及びJAF国内競技車両規則に従った公認書式。

Make **FUJI HEAVY INDUSTRIES LTD** Model **SUBARU A22**  
 製造会社名 型式及び通称名  
 Modification's application starts with serial No. chassis 適用シャーシー型式番号 **A22 (A26, A32, A33, A34)**  
 engine 適用エンジン型式 **EA63, EA71**  
 Application of this amendment started the **Feb. 1977**  
 適用年月日  
 Commercial denomination after application of modifications **A26-05051~, A32-002001~, A33-002001~, A34-002001~**  
 The modifications are to be considered as: Variant / ~~normal evolution of the type~~  
 変型 / ~~正統進化~~  
 Date amendment is valid from **1.7.77** List

Description of amendment 内容

\* Different appearance  
(A) coupe type

Photo A : 3/4 view of car from front  
(B) 2 door type



(C) 4 door type

(D) Hard top type



Stamp and signature of the JAF

Stamp and signature of the F.I.A.

JAF公認印及び署名

難波靖治

Yasuharu Nanba





会社名 FUJI  
Make

型式 A22  
Model A26, A32, A33, A34

FIA Rec. No. 5453 7/7U

Photo B : 3/4 view of car from rear

(A) Coupe type



(B) 2 door type



(C) 4 door type



(D) Hard top type



51) Servo assistance (if fitted) Type :  
111) Rear track

Vacuum  
126.0 cm      49.6 inches

Photo C : dashboad (A)



Photo C : dashboad (B)





会社名 FUJI  
Make

型式 A22  
Model A26, A32, A33, A34

FIA Rec. No. 5453

7170

\* Exhaust pipe

Photo U : Exhaust piping with muffler

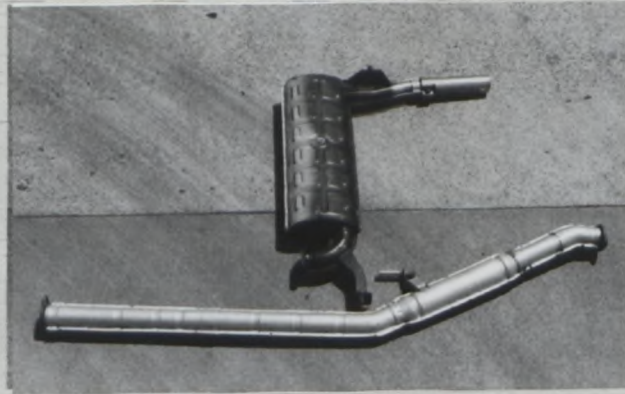

\* Different appearance (Wheel)

Photo P : Bare Wheel



\* Different Exhaust Manifold

Type-L

Photo V: Exhaust manifold

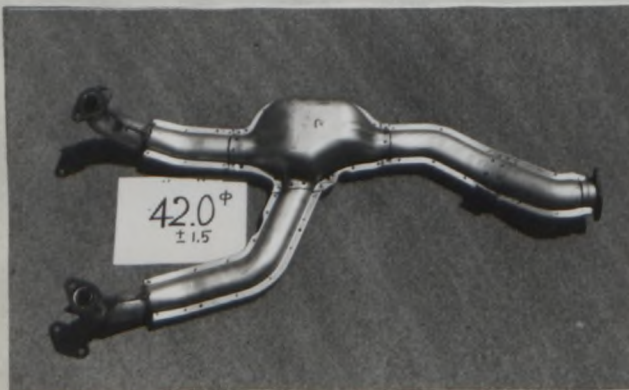

Type-S

Photo V: Exhaust manifold

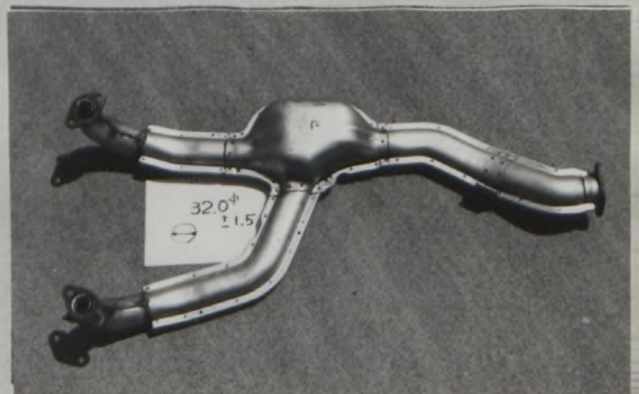



会社名  
Make **FUJI**

型式 <sup>A22</sup>  
Model **A26, A32, A33, A34**

JAF公認番号 **T-184V-10**

FIA Rec. No. **5453**

**717V**

**\* 4-Wheel disc brakes**

**Type-A**

	<b>Front</b>	<b>Rear</b>
54) Bore	51.1 mm	31.1 mm
58) Width of brake linings	41.2 mm	36.0 mm
60) Total area per brake	5040 mm <sup>2</sup>	3820 mm <sup>2</sup>

**Photo F: Front brake**

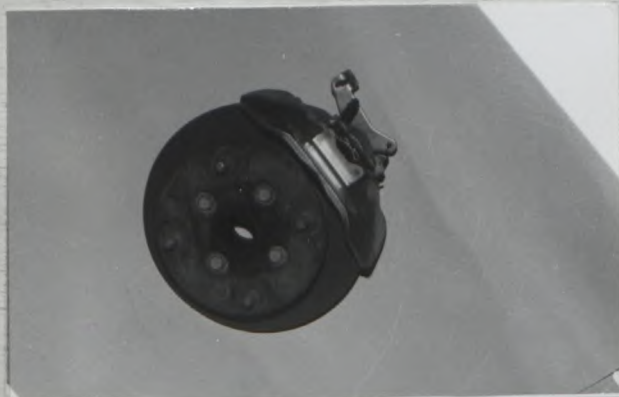

**Photo G: Rear brake**

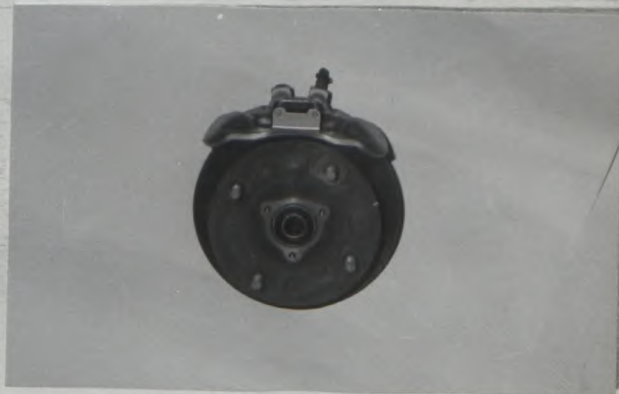

**Type-F**

	<b>Front</b>	<b>Rear</b>
54) Bore	63.5 mm	31.1 mm
58) Width of brake linings	45.0 mm	36.0 mm
60) Total area per brake	7800 mm <sup>2</sup>	3820 mm <sup>2</sup>

**Photo F: Front brake**

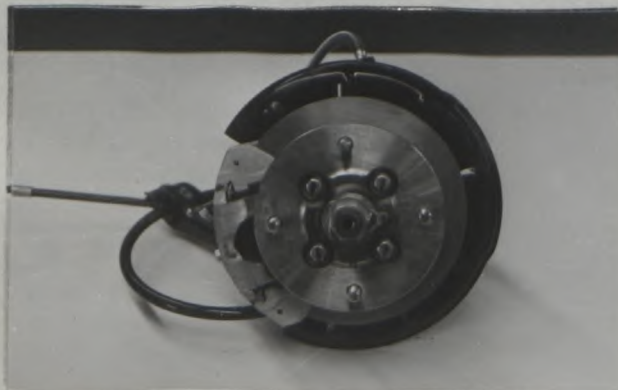



会社名 FUJI  
Make

型式 A22  
Model A26, A32, A33, A34

FIA Rec. No. 5453 717V

\* Under guard

Photo



Photo



\* Different appearance (Bumper)

Photo A: 3/4 view of car from front



Photo

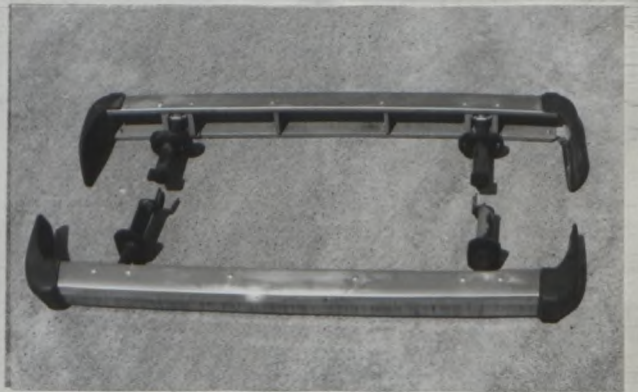

6) Overall length with Bumper

4170 cm

\* Different gear ratio (4 speed Type)

	/Manual	
	Ratio	Nr teeth
1	3.67	44/12
2	2.16	41/19
3	1.46	41/28
4	1.03	35/34
5		
6		
/Rev	4.10	41/10



221) Number of teeth of final drive 37/10 or 33/8

222) Final drive ratio 3.70 or 4.13





会社名  
Make FUJI

型式  
Model A22  
A26, A32, A33, A34

JAF公認番号 T-184V-10

FIA Rec. No. 5453

717V

\* Different gear ratio (5 Speed Type)

96)	/Manual	
	Ratio	Nr teeth
1	3.67	44/12
2	2.16	41/19
3	1.46	41/28
4	1.03	35/34
5	0.79	32/41
6		
/Rev	4.10	41/10

221) Number of teeth of final drive 35/9 or 37/10

222) Final drive ratio 3.89 or 3.70

\* Different appearance

4 Lights A Type



4 Lights B Type



2 Lights Type





会社名 FUJI  
Make

型式 A22  
Model A26, A32, A33, A34

FIA Rec. No. 5453 717V

~~Drive train (4 wheel drive)~~

- ~~10) Drive wheels: 4 wheel~~
- ~~11) Ground clearance 21 cm 8.3 inches~~
- ~~116) Weight 790 kg 1744 lb~~

Photo C: dashboad



Photo H: Gear-box

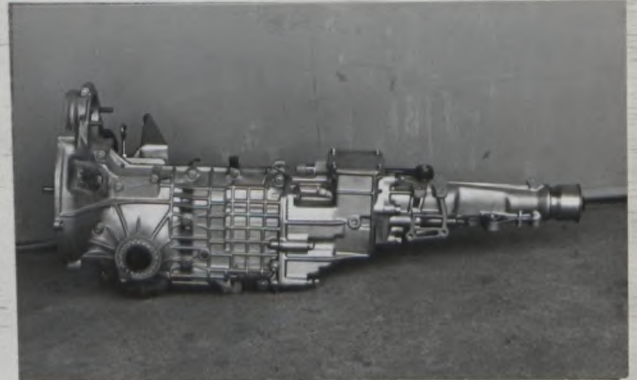

Photo U: Exhaust piping with muffler

