



JAPAN AUTOMOBILE FEDERATION

社団法人 日本自動車連盟

JAF公認番号 T-182

グループ ツーリング・カー

発効年月日 46.11.1

F. I. A. Recognition No. 5432

Group 1

FEDERATION INTERNATIONALE DE L'AUTOMOBILE

Form of recognition in accordance with Appendix J to the International Sporting Code.

国際スポーツ法典付則J項及びJAF国内競技車両規則に従った公認書式。

Manufacturer NISSAN MOTOR CO., LTD.
製造会社名

Serial No of chassis 製造開始シャシー番号 PB110-000001

engine 製造開始エンジン番号 L14-000001

Recognition is valid from 1/1/72

Cylinder-capacity 総排気量
Reciprocation 1,428 cm³ 87.1 cu.in.
レシプロ
Special 特殊 cm³ cu.in.

Model 型式及び通称名 PB110 (DATSUN SUNNY 1400)

Manufacturer NISSAN

Manufacturer NISSAN

List 72/1

The manufacturing of the model described in this recognition form was started on MAR. 1971 and the minimum production of 5,000 identical cars, in accordance with the specifications of this form was reached on MAY. 1971

Photograph A, 3/4 view of car from front 写真A、全体写真(斜め前方)



The vehicle described in this form has been subject to the following amendments :

Variants

on	19	rec. No.	List
on	19	rec. No.	List
on	19	rec. No.	List
on	19	rec. No.	List
on	19	rec. No.	List

Normal evolution of the type

on	19	rec. No.	List
on	19	rec. No.	List
on	19	rec. No.	List
on	19	rec. No.	List
on	19	rec. No.	List

Stamp and signature of the JAF

JAF公認印及び署名

難波清治

Yasuharu Nanba



Stamp and signature of the F. I. A.

[Handwritten signature]

Make **NISSAN**

Model **PE110**
型式

J·A·F公認番号

F.I.A. Rec. No.

T-182
5432

IMPORTANT - the underlined items must be stated in two measuring systems, one of which must be the metric system. See conversion table hereafter.

CAPACITIES AND DIMENSIONS
仕様諸元

1. <u>Wheelbase</u> ホイールベース	234.0	cm	92.1	inches
2. <u>Front track</u> トレッド (前)	125.5	cm	49.4	inches *
3. <u>Rear track</u> トレッド (後)	124.5	cm	49.0	inches *
4. Overall length of the car 全長	400.0	cm		inches
5. Overall width of the car 全幅	150.0	cm		inches
6. Overall height of the car 全高	139.5	cm		inches
7. Capacity of fuel tank (reserve included) 燃料タンク容量	10.6	Gallon US	4.0	ltrs Gallon Imp.
8. Seating capacity 定員	5			
9. <u>Weight, total weight of the car with normal equipment, water, oil and spare wheel but without fuel nor repair tools:</u> 車両重量 (冷却水、オイル、スペアタイヤを含む標準状態の車両重量、但し燃料、車載工具を除く)	800	kg	1764	lbs cwt

* Differences in track caused by the use of other wheels with different rim widths must be stated when recognition is requested for the wheels concerned.

Specify ground clearance in relation to the track and give drawing of two fixed points of the vehicle's structure at which measurements are taken.

These ground clearance dimensions are only for information when checking the track and can in no way affect the eligibility of the car.

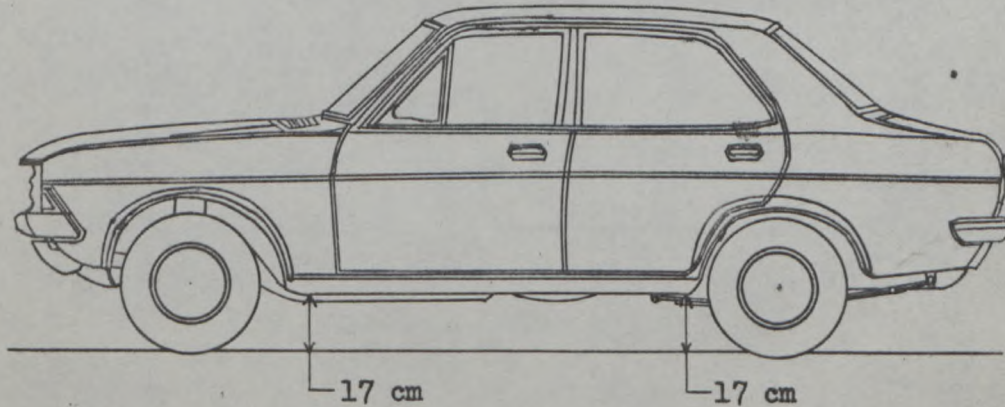

Width of the car measured in the vertical plane passing through the axle of the wheels.

車軸上の車体幅	Front フロント	150	cm	Rear リヤ	149	cm
---------	---------------	-----	----	------------	-----	----

CONVERSION TABLE

1 inch / pouce	--	2.54 cm	1 quart US	--	0.9464 ltrs
1 foot / pied	--	30.4794 cm	1 pint (pt)	--	0.568 ltrs
1 square inch / pouce carre	--	6.452 cm ²	1 gallon Imp.	--	4.546 ltrs
1 cubic inch / pouce cube	--	16.387 cm ³	1 gallon US	--	3.785 ltrs
1 pound / livre (lb)	--	453.593 gr.	1 hundred weight (cwt)	--	50.802 kg



CHASSIS AND COACHWORK (Photographs A, B and C)
シャーシー、ボデー

- 20. Chassis/body construction : ~~XXXXXX~~ / unitary construction
シャーシー/ボディーの構造 ~~XXXXXX~~ / 一体構造
- 21. Unitary construction, material (s) **Steel**
一体構造の場合その材質
- 22. Separate constructions: material (s) of chassis
セパレート構造の場合その材質
- 23. Material (s) of coachwork
ボディーの材質
- 24. Number of doors **4** Material (s) **Steel**
ドアの数 材質
- 25. Material (s) of bonnet **Steel**
ボンネットの材質
- 26. Material (s) of boot lid **Steel**
トランクリッドの材質
- 27. Material (s) of rear-window **Glass**
リヤウインドシールドの材質
- 28. Material (s) of windscreen **Glass**
フロントウインドシールドの材質
- 29. Material (s) of front-door windows **Glass**
フロントドアウインドーの材質
- 30. Material (s) of rear-door windows **Glass**
リヤドアウインドーの材質
- 31. Sliding system of door windows **Vertical, Manual**
ドアウインドーの開閉方式
- 32. Material (s) of rear-quarter light
リヤクォーターウインドーの材質

ACCESSORIES AND UPHOLSTERY
アクセサリ

- 38. Interior heating : yes - ~~YES~~
- 39. Air-conditioning : ~~YES~~ - no
- 40. Ventilation : yes - ~~YES~~
- 41. Front seats, type of seats and upholstery **Separate, Vinyl**
- 42. Weight of front seat (s), complete with supports and rails, out of the car :
10 x 2 kg lbs
- 43. Rear seats, type of seats and upholstery **Bench, Vinyl**
~~Bentch~~
- 44. Front bumper, material (s) **Steel** Weight **3.5 kg** lbs
フロントバンパーの材質 重量
- 45. Rear bumper, material (s) **Steel** Weight **3.7 kg** lbs
リヤバンパーの材質 重量

WHEELS
ホイール

- 50. Type **Pressed Steel**
形式
- 51. Weight (per wheel, without tyre) **6.5 kg** lbs
重量
- 52. Method of attachment **4 Nuts**
取付け方法
- 53. Rim diameter **330 mm** **13 inches**
リム径
- 54. Rim width **101 mm** **4 inches**
リム幅

STEERING
ステアリング

- 60. Type **Recirculating ball**
形式
- 61. Servo-assistance : ~~YES~~ - no
パワーステアリング ~~有~~ - 無
- 62. Number of turns of steering wheel from lock to lock **3.1**
ロックツーロック
- 63. In case of servo-assistance



Make NISSAN

Model PBI10
型式

J.A.F.公認番号 T-182
F.I.A. Rec. No. 5432

SUSPENSION

サスペンション

- | | | | |
|---|--|----------------|----------------------|
| 70. Front suspension (photogr. D), type
フロントサスペンションの形式 | | | Mc Pherson |
| 71. Type of spring
スプリングの種類 | | | Coil |
| 72. Stabiliser (if fitted) | | | Torsion bar |
| 73. Number of shockabsorbers 2
ショックアブソーバーの数 | | 74. Type
形式 | Hydraulic telescopic |
| 78. Rear suspension (photogr. E), type
リヤサスペンションの形式 | | | Rigid axle |
| 79. Type of spring
スプリングの種類 | | | Leaf |
| 80. Stabiliser (if fitted) | | | |
| 81. Number of shockabsorbers 2
ショックアブソーバーの数 | | 82. Type
形式 | Hydraulic telescopic |

BRAKES (photographs F and G)
ブレーキ

- | | | |
|---|---|-----------|
| 90. System
作動方式 | | Hydraulic |
| 91. Servo-assistance (if fitted), type
サーボシステムの形式 | | |
| 92. Number of hydraulic master cylinders
マスターシリンダーの数 | 1 | |

	FRONT フロント		REAR リヤ	
	2		1	
93. Number of cylinders per wheel ホイール当りのシリンダー数				
94. Bore of wheel cylinder (s) ホイールシリンダーの内径	22.2 mm	in.	20.6 mm	in.
Drum Brakes ドラムブレーキ				
95. Inside diameter ドラムの内径	228 mm	in.	203 mm	in.
96. Length of brake linings ライニングの長さ	220 mm	in.	195 mm	in.
97. Width of brake linings ライニングの幅	40 mm	in.	35 mm	in.
98. Number of shoes per brake ブレーキ当りのシューの数	2		2	
99. Total area per brake 1ブレーキ当りの総摩擦面積	17,600 mm ²	sq. in.	13,650 mm ²	sq. in.
Disc brakes ディスクブレーキ				
100. Outside diameter ディスクの外径	mm	in.	mm	in.
101. Thickness of disc ディスクの厚さ	mm	in.	mm	in.
102. Length of brake linings パッドの長さ	mm	in.	mm	in.
103. Width of brake linings パッドの幅	mm	in.	mm	in.
104. Number of pads per brake. ブレーキ当りのパッドの数				
105. Total area per brake 1ブレーキ当りの総摩擦面積	mm ²	sq. in.	mm ²	sq. in.



ENGINE (photographs J and K) **

130. Cycle エンジン サイクル	4			131. Number of cylinders シリンダー数	4		
132. Cylinder arrangement シリンダー配列	In-line						
133. Bore ボア	83.0 mm	3.27 in.		134. Stroke ストローク	66.0 mm	2.60 in.	
135. Capacity per cylinder 1シリンダーの排気量		357 cm ³			21.77 cu. in.		
136. Total cylinder-capacity 総排気量		1,428 cm ³			87.08 cu. in.		
137. Material (s) of cylinder block シリンダーブロックの材質		Cast-iron					
138. Material (s) of sleeves (if fitted) スリーブの材質							
139. Cylinder-head, material (s) シリンダーヘッドの材質		Cast-iron		Number fitted 数	1		
140. Number of inlet ports 吸気孔の数	4			141. Number of exhaust ports 排気孔の数	4		
142. Compression ratio	9.0						
143. Volume of one combustion chamber		37 cm ³				cu. in.	
144. Piston, material ピストンの材質	Aluminum alloy			145. Number of rings リングの数	3		
146. Distance from gudgeon pin centre line to highest point of piston crown	38 mm					inches	
147. Crankshaft : casted / stamped クランクシャフト : 鋳造 / 鍛造				148. Type of crankshaft : integral / XXXX クランクシャフトの形式 : 一体式 / XXXX			
149. Number of crankshaft main bearings メインベアリングの数	5						
150. Material of bearing cap ベアリングキャップの材質		Cast-iron					
151. System of lubrication : dry sump / oil in sump 潤滑方式 : ドライサンプ / ウェットサンプ							
152. Capacity, lubricant 潤滑油量	4.6 ltrs				pts	quarts US	
153. Oil cooler : yes / no オイルクーラー : 有 / 無				154. Method of engine cooling エンジン冷却方式	Water		
155. Capacity of cooling system	6.0 ltrs				pints	quarts US	
156. Cooling fan (if fitted), dia.	330 mm				inches		
157. Number of blades of cooling fan	4						

Bearings **
ベアリング

158. Crankshaft main, type メインベアリングの形式	Plain			Dia. 内径	55 mm	in.
159. Connecting rod big end, コンロッド大端部ベアリングの形式	Plain			Dia. 内径	50 mm	in.

Weights **

160. Flywheel (clean)	9.5 kg			lbs
161. Flywheel with clutch (all turning parts)			12.3 kg	lbs
162. Crankshaft	13.4 kg		lbs	
163. Connecting rod			0.66 kg	lbs
164. Piston with rings and pin	0.52 kg		lbs	

** for additional information concerning Wankel rotary engines see page 15, 16 .
ロータリーエンジンは15、16頁参照



Make NISSAN

Model PB110
型式

J·A·F公認番号 T-182
F.I.A. Rec. No. 5432

FOUR STROKE ENGINES * , **

4サイクルエンジン

- 170. Number of camshafts **1**
- 172. Type of camshaft drive **Chain**
- 173. Type of valve operation **Rocker arm**
- 171. Location of camshaft position **Cylinder-head**

INLET (see page 8) * , **
吸気系

- 180. Material(s) of inlet manifold **Aluminum alloy**
- 181. Diameter of valves **38 mm** **1.49 inches**
- 182. Max. valve lift **10 mm** **0.39 in.**
- 183. Number of valve springs **1**
- 184. Type of spring **Coil**
- 185. Number of valves per cylinder **1**
- 186. Tappet clearance for checking timing (cold) **0.25 mm** **inches**
- 187. Valves open at (with tolerance for tappet clearance indicated) **B.T.D.C 80° ± 7°**
- 188. Valves close at (with tolerance for tappet clearance indicated) **A.B.D.C 44° ± 7°**
- 189. Air filter, type **Dry**

EXHAUST (see page 8) * , **
排気系

- 195. Material (s) of exhaust manifold **Cast-iron**
- 196. Diameter of valves **35 mm** **1.38 inches**
- 197. Max. valve lift **10 mm** **0.39 in.**
- 198. Number of valve springs **1**
- 199. Type of spring **Coil**
- 200. Number of valves per cylinder **1**
- 201. Tappet clearance for checking timing (cold) **0.30 mm** **inches**
- 202. Valves open at (with tolerance for tappet clearance indicated) **B.B.D.C 50° ± 7°**
- 203. Valves close at (with tolerance for tappet clearance indicated) **A.T.D.C 10° ± 7°**

CARBURETION (photograph N)
気化器

- 210. Number of carburetors fitted **1**
- 211. Type **Down-draft**
- 212. Make **NIHON KIKAKI**
- 213. Model **213282**
- 214. Number of mixture passages per carburettor **2**
- 215. Flange hole diameter of exit port(s) of carburettor **28 & 32 mm** **in.**
- 216. Minimum dimensions of mixture passage (s) **21 & 28 mm** **inches**

INJECTION (if fitted)
燃料噴射

- 220. Make of pump
- 221. Number of plungers
- 222. Model or type of pump
- 222. Total number of injectors
- 224. Location of injectors
- 225. Minimum diameter of inlet pipe **mm** **inches**

*) for additional information concerning two-stroke engines and super-charged engines see page 14.
2サイクルエンジン、過給機付エンジンは14頁参照

**) for additional information concerning Wankel rotary engines see page 15, 16.
ロータリーエンジンは15, 16頁、参照



Make NISSAN

Model PB110
型式

J·A·F 公認番号 T-182
F.I.A. Rec. No. 5432

ENGINE ACCESSORIES
エンジン補機

- | | | |
|---|--|-------------|
| 230. Fuel pump : mechanical and electric
燃料ポンプ 機械式 電気式 | 231. No. fitted
ポンプの数 | 1 |
| 232. Type of ignition system
点火方式 | 233. No. of distributors
ディストリビューターの数 | 1 |
| 234. No. of ignition coils
コイルの数 | 235. No. of spark plugs per cylinder/rotor
シリンダー当りのプラグ数(交流) | 1 |
| 236. Generator, type: DC /alternator-number fitted
発電機 交流/交流 数 | 237. Method of drive
駆動方式 | V-Belt |
| 238. Voltage of generator
発電機電圧 | 239. Battery, number
バッテリーの数 | 12 volts |
| 240. Location
バッテリー位置 | | Engine room |
| 241. Voltage of battery
バッテリー電圧 | | 12 volts |

ENGINE AND CAR PERFORMANCES (as declared by manufacturer in catalogue)

- | | | | |
|-------------------------------|-----------|----------------------------|--------------|
| 250. Max. engine output | 85 ps | (type of horsepower: JIS) | at 6000 rpm |
| 251. Maximum rpm | 6500 rpm | output at that figure | 80 ps |
| 252. Maximum torque | 11.8 kg-m | at 3600 rpm | |
| 253. Maximum speed of the car | 155 | km/hour | miles / hour |

255. Cam profile
カムプロフィール

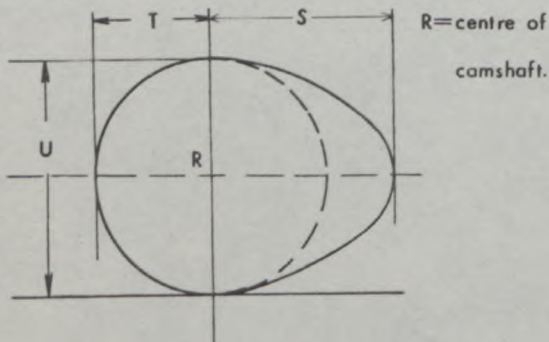

Inlet cam
吸気カム

S =	23.5	mm	0.93	inches
T =	16.5	mm	0.65	inches
U =	33.1	mm	1.30	inches

Exhaust cam
排気カム

S =	23.5	mm	0.93	inches
T =	16.5	mm	0.65	inches
U =	33.1	mm	1.30	inches



Make NISSAN

Model PBL10
型式

J.A.F 公認番号 T-182
F.I.A. Rec. No. 5432

Drawing inlet manifold ports, side of cylinder-head/~~bearing~~ scale or dimensions and manufacturing tolerance.

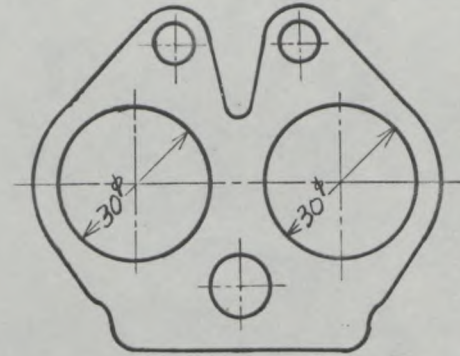

Drawing of entrance to inlet port of cylinder-head/~~bearing~~ scale or dimensions and manufacturing tolerance.

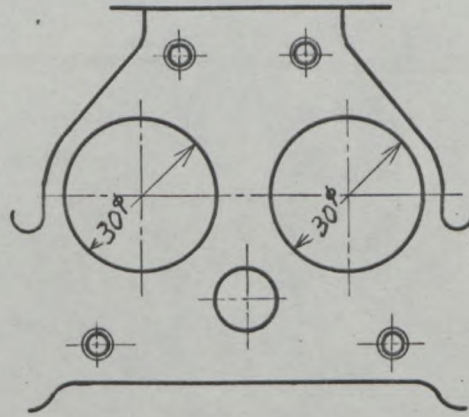

Drawing exhaust manifold ports, side of cylinder-head/~~bearing~~ scale or dimensions and manufacturing tolerance.

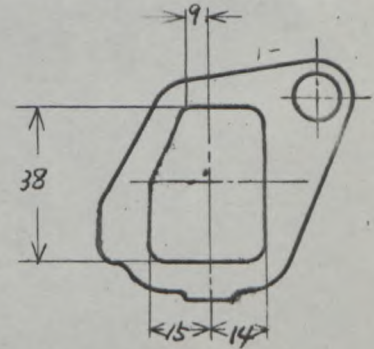
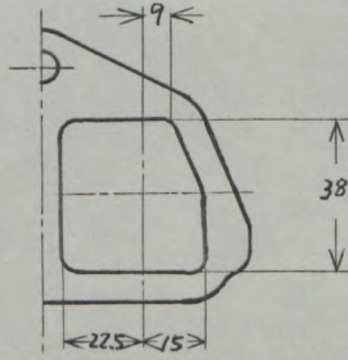

Drawing of exit to exhaust port of cylinderhead/~~bearing~~. Indicate scale or dimensions and manufacturing tolerance.

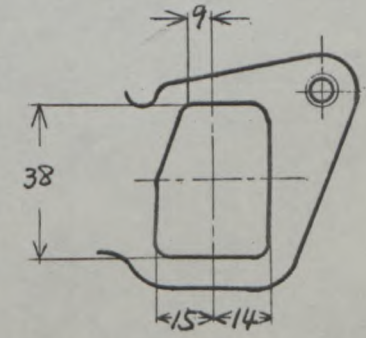
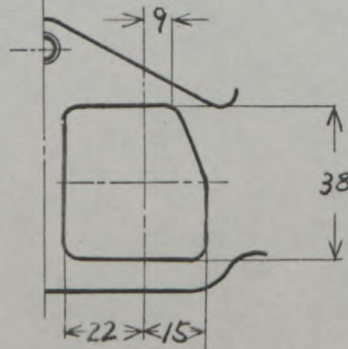

Unit: mm
Tolerance: ± 1.5



Make NISSAN

Model PB110
型式

J·A·F公認番号 T-182

F.I.A. Rec. No. 5432

DRIVE TRAIN

駆動系

CLUTCH

クラッチ

260. Type of clutch **Dry plate** 261. No. of plates **1**
形式 プレッシュャープレートの数
262. Dia. of clutch plates **182** mm inches
プレッシュャープレートの外径
263. Dia. of linings, inside **125** mm in. outside **180** mm in.
フェーシングの内径 外径
264. Method of operating clutch **Hydraulic**
作動方式

GEAR BOX (photograph H)

トランスミッション

270. Manual type, make **NISSAN** Method of operation **Mechanical**
手動式の製造会社名 作動方式
271. No. of gear-box ratios forward **4** 272. Synchronized forward ratios **1, 2, 3 & 4**
前進段数
273. Location of gear-shift **Floor**
シフトレバーの位置
274. Automatic, make **NISSAN** type **3N71**
自動式の製造会社名 形式
275. No. of forward ratios **3** 276. Location of gear-shift **Floor**
前進段数 シフトレバーの位置

277.	Manual 手動		Automatic 自動		Alternative manual/automatic 手動/自動			
	Ratio ギヤー比	No. teeth 歯数	Ratio ギヤー比	No. teeth 歯数	Ratio ギヤー比	No. teeth 歯数	Ratio ギヤー比	No. teeth 歯数
1	3.66	$\frac{32}{21} \times \frac{36}{15}$	2.46	$2 + \frac{33}{72}$				
2	2.18	$\frac{32}{21} \times \frac{30}{21}$	1.46	$1 + \frac{33}{72}$				
3	1.42	$\frac{32}{21} \times \frac{27}{29}$	1.00					
4	1.00							
5								
6								
reverse リバース	3.64	$\frac{32 \times 18 \times 39}{21 \times 21 \times 14}$	2.18	$\frac{72}{33}$				

278. Overdrive, type
オーバードライブ形式
279. Forward gears on which overdrive can be selected
オーバードライブの作動段数
280. Overdrive ratio
オーバードライブ比

FINAL DRIVE

ファイナル

290. Type of final drive **Hypoid gear**
形式
291. Type of differential **Bevel gear**
差動機形式
292. Type of limited slip differential (if fitted)
リミテッドスリップデフの形式
293. Final drive ratio
ギヤー比
- Number of teeth **3.89** **4.11**
歯数 **35/9** **37/9**



Make NISSAN

Model PB110

J.A.F.公認番号 T-182
F.I.A. Rec. No. 5432

Optional equipment affecting preceding information. This to be stated together with reference number.
オプション:

The following items have been added.

COUPE MODEL (KPBL10)

Photograph A. 3/4 View, Front



Photograph B. 3/4 View, Rear



4. Overall length of the car		399.5	cm
5. Overall width of the car		151.5	cm
6. Overall height of the car		133.5	cm
7. <u>Capacity of fuel tank</u>	38 ltrs	10.1	Gallon US
9. <u>Weight</u>	795 kg	1,753	lbs
24. Number of doors			
32. Material(s) of rear-quarter light		Glass	

FRONT DISC BRAKE

91. Servo-assistance (if fitted), type		Vacuum
93. Number of cylinder per wheel		1
94. Bore of wheel cylinder(s)		51.1 mm
100. Outside diameter		232 mm
101. Thickness of disc		10 mm
102. Length of brake linings		63 mm
103. Width of brake linings		41 mm
104. Number of pads per brake		2
105. Total area per brake		5,166 mm ²

Photograph F. Front brake disc with calipers



Make NISSAN

Model PB110
型式

J.A.F公認番号 T-182

F.I.A. Rec. No. 5432

Photograph

写真

B, 3/4 view of car from rear 全体写真(斜め後方)



D, Front axle complete, removed from car. Without wheels.
フロントサスペンション

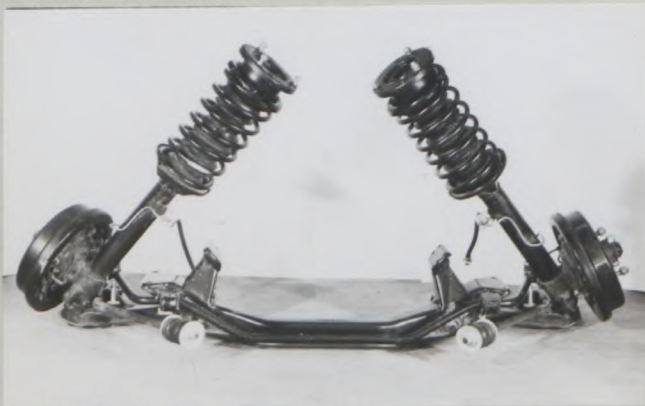

F, Front brake, drum removed or disc with caliper(s)
フロントブレーキ

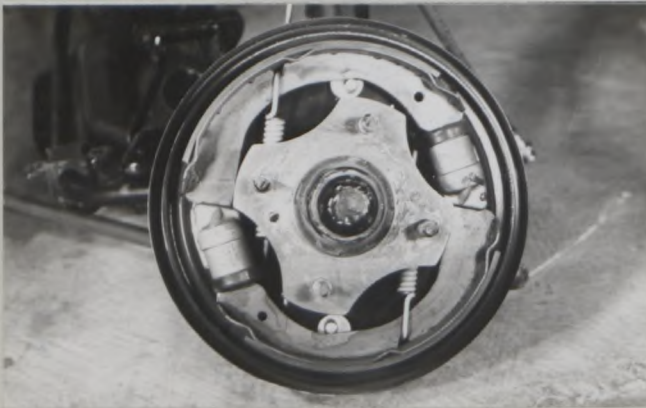

H, Gear-box, view from side トランスミッション

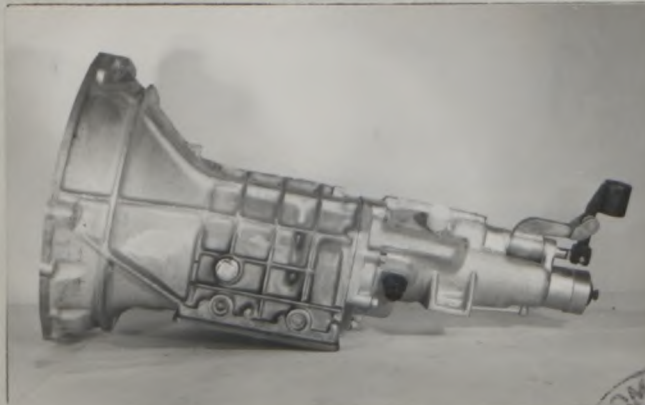

C, Interior view of car through driver's door (open or removed) with dashboard 運転席附近



E, Rear axle complete without wheels, removed from car.
リヤサスペンション

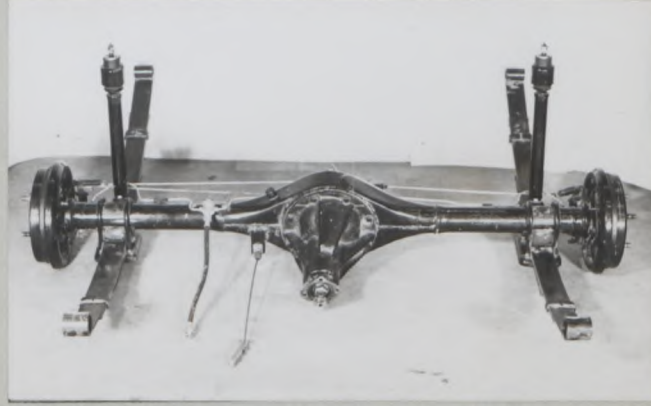

G, Rear brake, drum removed or disc with caliper(s)
リヤブレーキ



I, Silencer + exhaust pipes after exhaust manifold. 排気系



Photograph

J, Engine unit out of car, from right. With clutch and accessories but without air filter nor gear-box. エンジン右側面

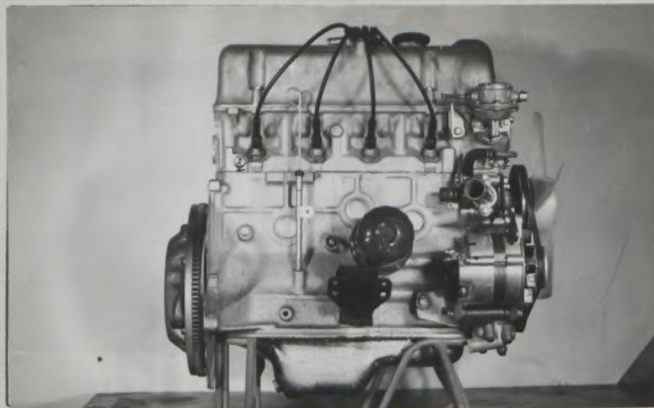

写真

K, Engine unit out of car, from left. With clutch and accessories but without gear-box nor air filter. エンジン左側面

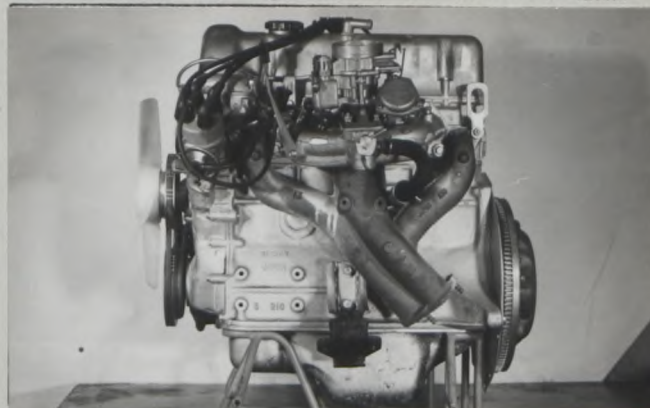

L, Combustion chamber 燃焼室

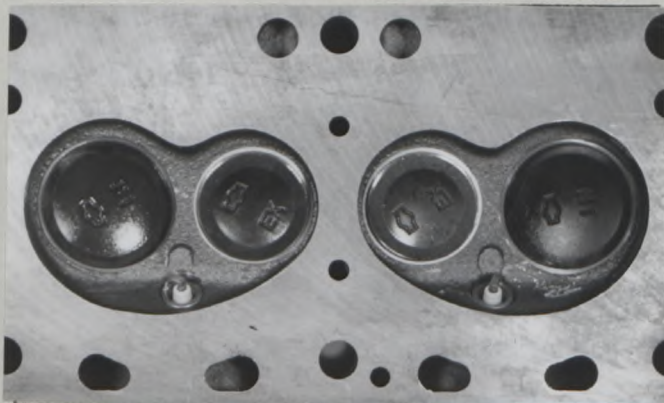

M, Piston crown ピストンクラウン



N, Carburettor (view from side of manifold) 気化器

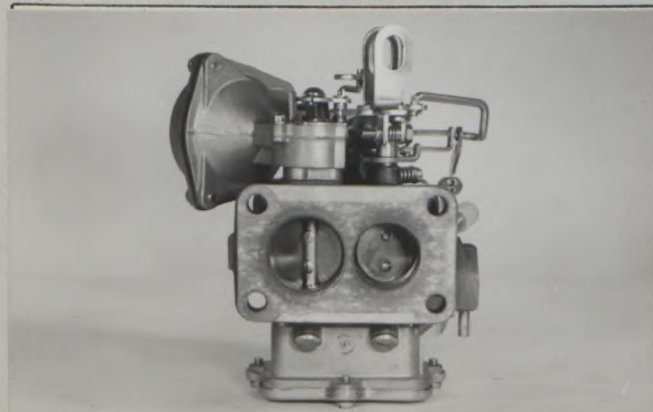

O, Engine in car with all accessories, bonnet open or removed. エンジンルーム

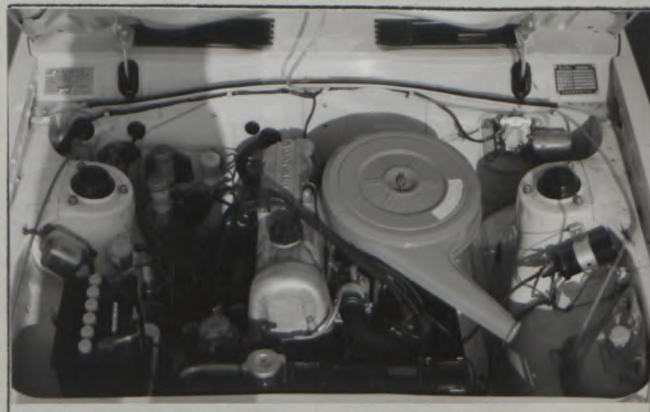

P, Inlet manifold 吸気マニホールド

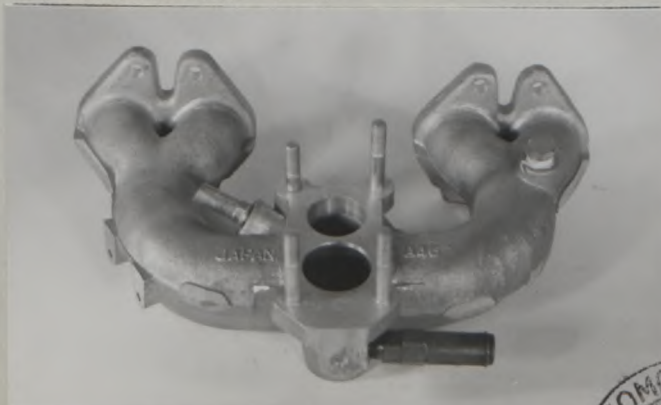

Q, Exhaust manifold 排気マニホールド



Make: NISSAN

Model PB110
型式

DIMENSIONS OF INTERIOR

室内寸法

(Conform to Art. 253 b of Appendix J)

For four seaters:
4座席

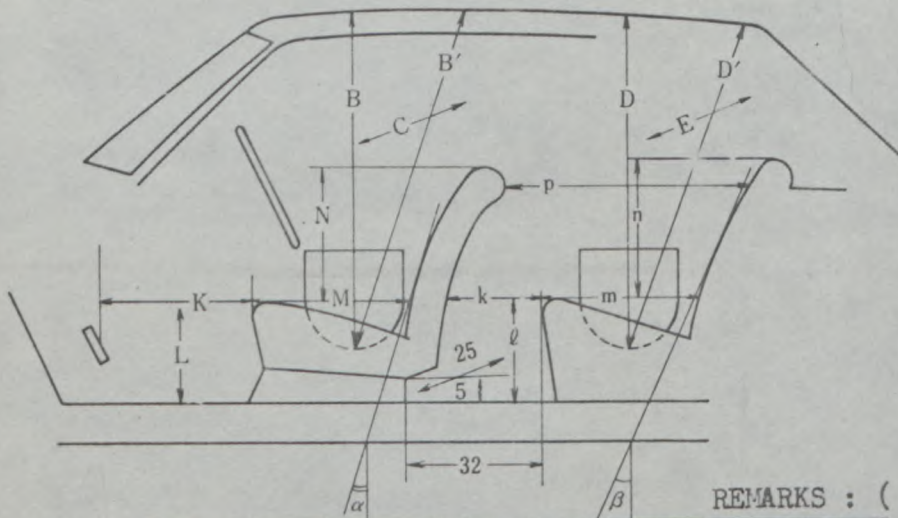

REMARKS : () COUPE MODEL KP110

Minimum Dimensions (cm)							
B	B'	α	C	D	D'	β	E
94 (93)	98 (97)	15°	126	94 (92)	94 (92)	20°	126

Minimum Dimensions (cm)										
L	ℓ	M	m	N	n	k+m	p	k	k+ ℓ +m	K+L+M
29	30	48	48	48	50	70	67	22	100	122
0.9L = 26.1		0.85M = 40.8		0.8N = 38.4		0.8(k+m) = 56		(15)	(95)	(120)

For two seaters:
2座席

Minimum Dimensions	
B	C
cm	cm

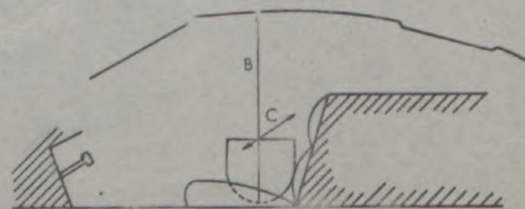

Make NISSAN

Model PB110
型式

F.I.A. Rec. No.

TWO STROKE ENGINES
2 サイクルエンジン

300. System of cylinder scavenging 掃気方式					
301. Type of lubrication 潤滑方式					
302. Inlet ports, length measured around cylinder wall 吸気孔の幅			mm		inches
303. Height inlet port 吸気孔の高さ	mm	in.	304. Area 吸気孔の総面積	mm ²	sq. in.
305. Exhaust ports, length measured around cylinder wall 排気孔の幅			mm		inches
306. Height exhaust port 排気孔の高さ	mm	in.	307. Area 排気孔の総面積	mm ²	sq. in.
308. Transfer port, length measured around cylinder wall 掃気孔の幅			mm		inches
309. Height transfer port 掃気孔の高さ	mm	in.	310. Area 掃気孔の総面積	mm ²	sq. in.
311. Piston ports, length measured around piston ピストンポートの幅			mm		inches
312. Height piston port ピストンポートの高さ	mm	in.	313. Area ピストンポートの総面積	mm ²	sq. in.
314. Method of precompression プレコンプレッション方式			315. Precompression cyl.:	yes / no	
316. Bore	mm	inches	317. Stroke	mm	inches
318. Distance from top of cyl. block to highest point of exhaust port : 排気孔の最高点とブロック上面との距離			mm		inches
319. Distance from top of cyl. block to lowest point of inlet port : 吸気孔の最下点とブロック上面との距離			mm		inches
320. Distance from top of cyl. block to highest point of transfer port : 掃気孔の最高点とブロック上面との距離			mm		inches
321. Drawing of cylinder ports. シリンダーポート展開図					

330. Supercharging—state full details hereafter :
過給器

Unit: mm
Tolerance:



Make NISSAN

Model
型式 PB110Wankel Rotary Engine (photographs J and K)
ロータリーエンジン

400. Type & cycle 形式及びサイクル			
401. No of rotors ローターの数			
402. Rotor arrangement ローターの配列			
403. Trochoid, length of major Axis トロコイド長軸長さ	mm		in.
404. Trochoid, length of minor Axis トロコイド短軸長さ	mm		in.
405. Trochoid, width トロコイドの幅	mm		in.
406. Trochoid, generating radius (Containing equidistance) トロコイドの生成半径 (平行移動量を含む)	mm		in.
407. Eccentricity 偏心率	mm		in.
408. Capacity per Rotor 1ローター当りの排気量	cm ³		cu. in.
409. Total capacity 総排気量	cm ³		cu. in.
410. Equivalent total capacity (by App. J Art. 252) 換算総排気量 (J項 252条による)	cm ³		cu. in.
411. Material(s) of side housing サイドハウジングの材質			
412. Material(s) of rotor housing ローターハウジングの材質			
413. Number of inlet ports 吸気孔の数			
414. Number of exhaust ports 排気孔の数			
415. Compression ratio			
416. Volume of one combustion chamber	cm ³		cu. in.
417. Rotor material ローターの材質			
418. Number of apex seal per rotor ローター当りのアペックスシールの数			
419. Number of corner seal per rotor ローター当りのコーナースीलの数			
420. Number of side seal per rotor ローター当りのサイドシールの数			



Make NISSAN

Model PB110
 型式

421. Number of oil scraping ring per rotor
 1ローター当りのオイルリングの数
422. Eccentric shaft: moulded/stamped
 偏心軸: 鋳造/鍛造
423. Type of eccentric shaft: integral/
 偏心軸の形式: 一体式/
424. Number of eccentric shaft main bearings
 メインベアリングの数

Bearing
 ベアリング

- | | | | | |
|--|------------|------------|----|-----|
| 440. Eccentric shaft, main
メインベアリング | Type
形式 | Dia.
内径 | mm | in. |
| 441. Rotor bearing
ローターベアリング | Type
形式 | Dia.
外径 | mm | in. |

Weights

450. Flywheel (clean) kg
451. Flywheel with clutch (all turning parts) kg
452. Eccentric shaft kg
453. Rotor with seals, gear and bearing kg

Inlet (See page 8)
 吸気系

460. Material(s) of inlet manifold
マニホールドの材質
461. Location of inlet ports
吸気孔の位置
462. Inlet port area per rotor. mm² sq. in.
463. Inlet port open at (with tolerance)
吸気孔開き始め (公差を含む)
464. Inlet port close at (with tolerance)
吸気孔閉じ終り (公差を含む)
465. Air filter type

Exhaust (See page 8)
 排気系

470. Material(s) of exhaust manifold
マニホールドの材質
471. Location of exhaust Ports
排気孔の位置
472. Exhaust port area per rotor mm² sq. in.
473. Exhaust port open at (with tolerance)
排気孔開き始め (公差を含む)
474. Exhaust port close at (with tolerance)
排気孔閉じ終り (公差を含む)



Make NISSAN

Model PBI10
型式

J.A.F公認番号 T-182

F.I.A. Rec. No. 5432

1/15

ENGINE (TWIN CARBURETOR)

- 139. Cylinder-head materials Al-Cast
- 181. Diameter of valves 42 mm 1.65 inches
- 183. Number of valve springs 2
- 196. Diameter of valves 35 mm 1.38 inches
- 197. Max. valve lift 10.5 mm 0.42 inches
- 198. Number of valve springs 2
- 210. Number of carburettors 2
- 211. Type Side-draft
- 212. Make HITACHI
- 213. Model HJL 38 W
- 214. Number of mixture passages per carburettor 1
- 215. Flange held diameter of exit port(s) of carburettor 38 mm
- 216. Minimum dimensions of mixture passange(s) with piston at max height (example : SU) 37.6 mm
- 250. Max. engine out put 95 PS(type of horsepower : JIS) at 6400 rpm
- 251. Maximum rpm 6800 out put at that figure 90PS
- 252. Maximum torque 12.2 kg-m at 4000 rpm
- 253. Maximum speed at the car 165 km/h
- 255. Cam profile

Inlet cam

Exhaust cam

S = 23.5 mm 0.93 inches

S = 23.8 mm 0.93 inches

T = 16.5 mm 0.65 inches

T = 16.5 mm 0.65 inches

U = 33.1 mm 1.30 inches

U = 33.1 mm 1.30 inches



Make NISSAN

Model PB110
型式

J.A.F 公認番号

T-182
5432

F.I.A. Rec. No.

Drawing inlet manifold ports, side of cylinder-head / ~~drawing~~ scale or dimensions and manufacturing tolerance.

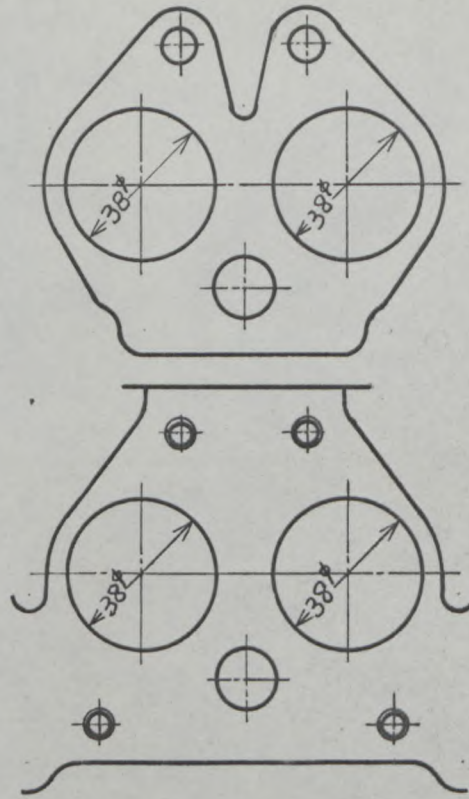

Drawing of entrance to inlet port of cylinder-head / ~~drawing~~ scale or dimensions and manufacturing tolerance.

Drawing exhaust manifold ports, side of cylinder-head / ~~drawing~~ scale or dimensions and manufacturing tolerance.

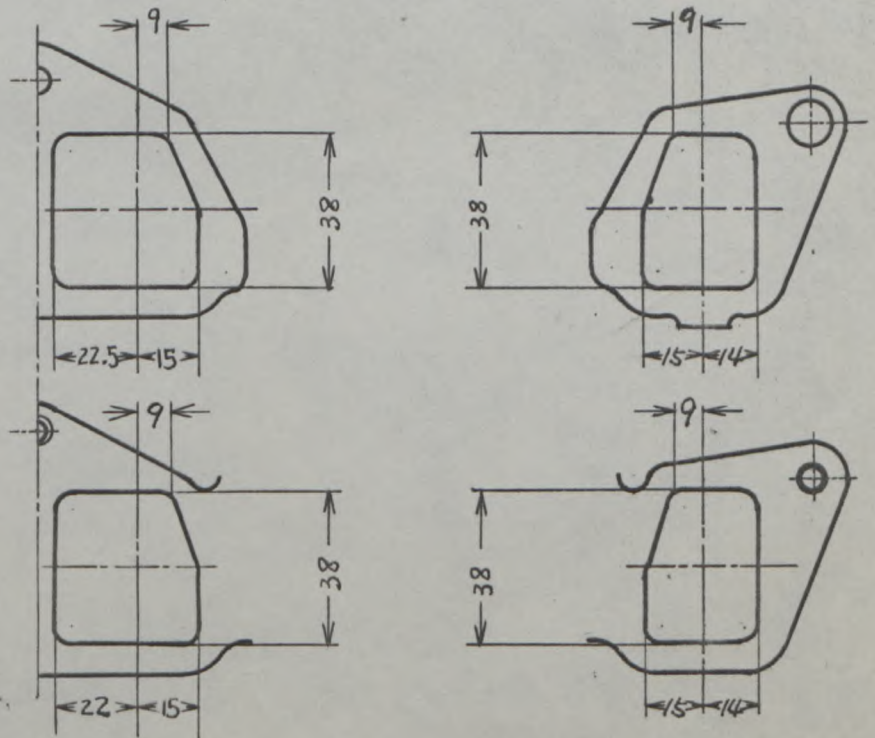

Drawing of exit to exhaust port of cylinderhead / ~~drawing~~ Indicate scale or dimensions and manufacturing tolerance.

Unit: mm
Tolerance: ± 1.5



Photograph

J. Engine from right

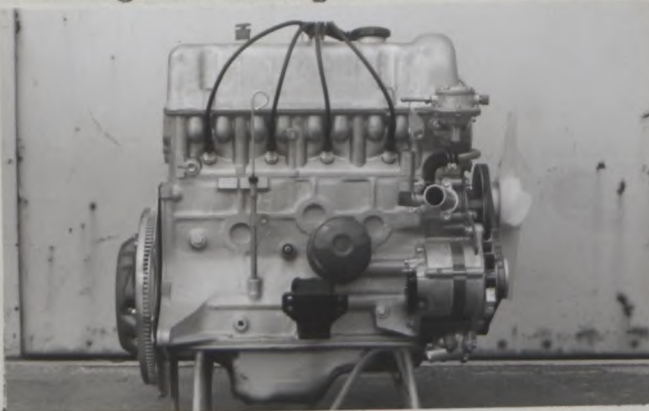

K. Engine from left

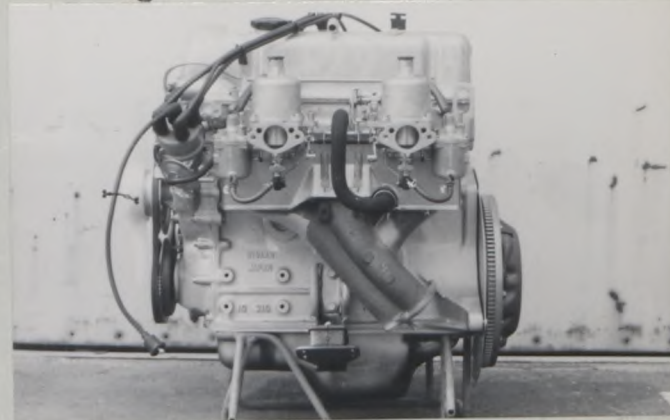

L. Combustion chamber



M. Piston crown



N. Carburetor

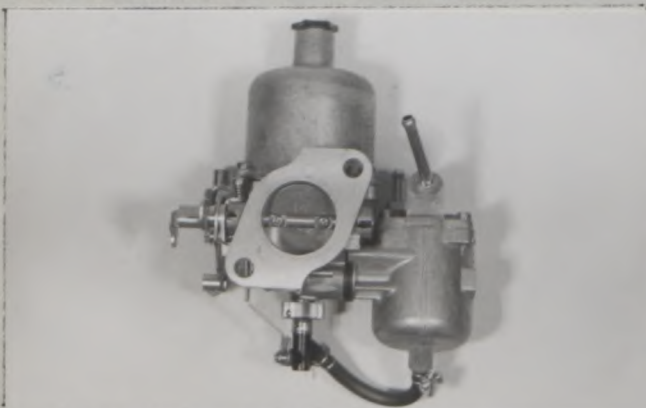

O. Engine in car

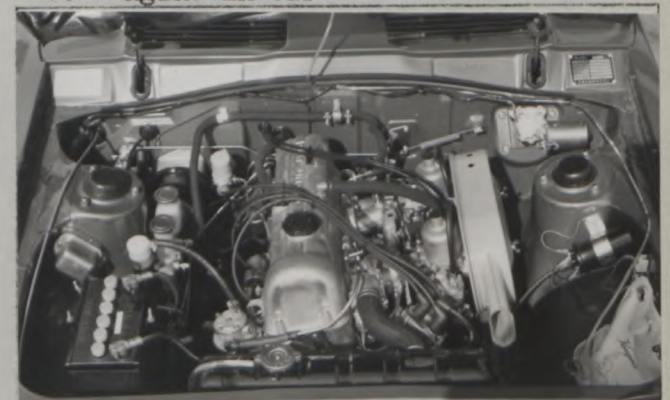

P. Inlet manifold

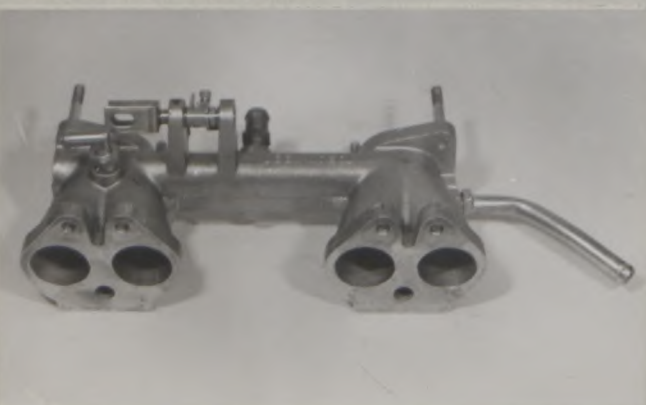



JAPAN AUTOMOBILE FEDERATION

社団法人 日本自動車連盟

T-182E-2

J.A.F公認番号
発効年月日

47. 3. 31

F. I. A. Homol. No 5432

1/IE

FEDERATION INTERNATIONALE DE L'AUTOMOBILE

Form of recognition accordance with
Appendix J to the International Sporting Code.

国際スポーツ法典付則J項及びJAF国内競技車両規則に従った公認書式。

Make	NISSAN MOTOR CO., LTD.	Model	PB110 (DATSUN SUNNY 1400)
製造会社名		型式及び通称名	
Modification's application starts with serial		No. chassis	適用シャーシー番号 PB110-030,001
		engine	適用エンジン番号 L14-000,001

Application of this amendment started the DEC. 1971

適用年月日

Commercial denomination after application of modifications

The modifications are to be considered as: ~~variant~~ / normal evolution of the type
変種 / 正常進化

Date amendment is valid from

List

Description of amendment 内容

Photograph

C, Interior view



Stamp and signature of the JAF

JAF公認印及び署名

延山博史

Hiroshi Niwayama



Stamp and signature of the F.I.A.