

F.I.A. Recognition No. **5406**  
Group **1 - Series production.**



## ROYAL AUTOMOBILE CLUB

31, Belgrave Square, London, S.W.1

Form of recognition in accordance with appendix J to the International Sporting Code of the  
FEDERATION INTERNATIONALE DE L'AUTOMOBILE

Manufacturer Chrysler United Kingdom Ltd. Cylinder-capacity 1248 cm.<sup>3</sup> 77.48 in.<sup>3</sup>  
Serial No. of chassis/body 211.000001 Model Hillman Avenger 1250.  
Serial No. of engine 211.000001 Manufacturer Chrysler United Kingdom Ltd.  
Recognition is valid from 1/4/71 Manufacturer Chrysler United Kingdom Ltd.  
List 71/4  
The manufacturing of the model described in this recognition form started on 1st December 1969.  
and the minimum production of 5000 identical cars, in accordance with the specifications of  
this form was reached on 28th February 1970.

Photograph A,  $\frac{3}{4}$  view of car from front



F.I.A. Stamp

R.A.C. Stamp

5406

B



C



D

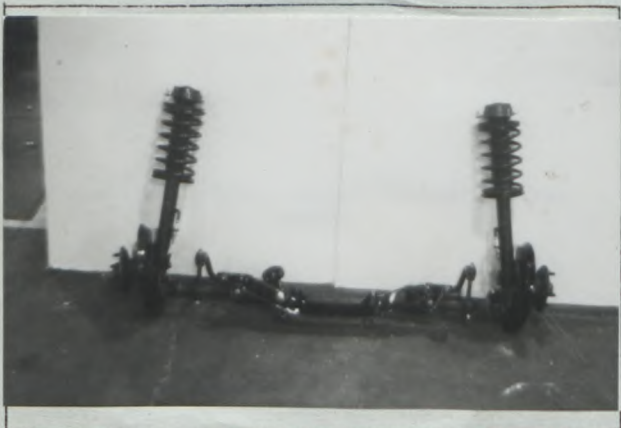

E

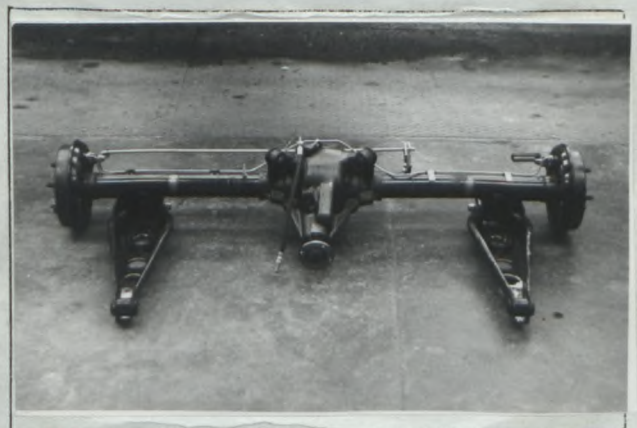

F



G

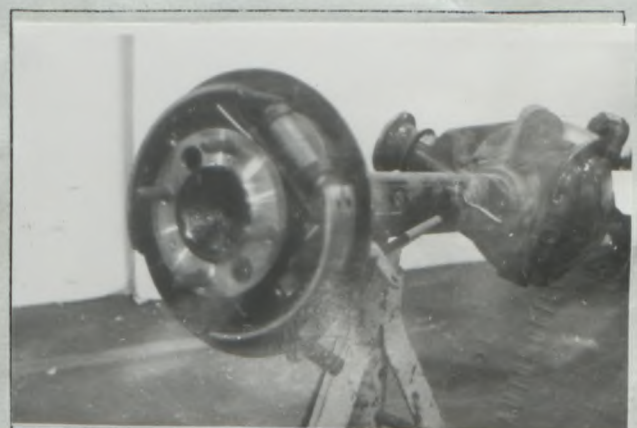

H

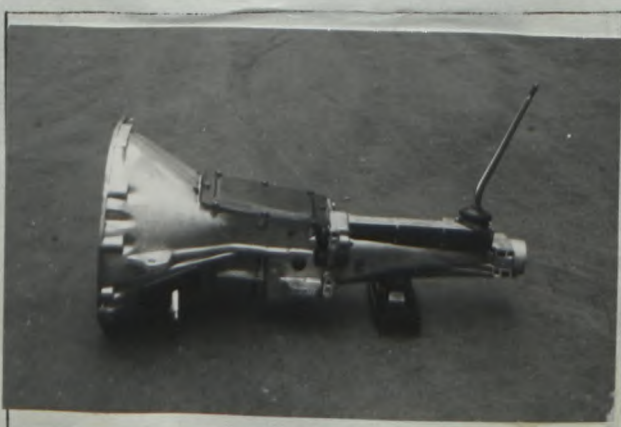

I

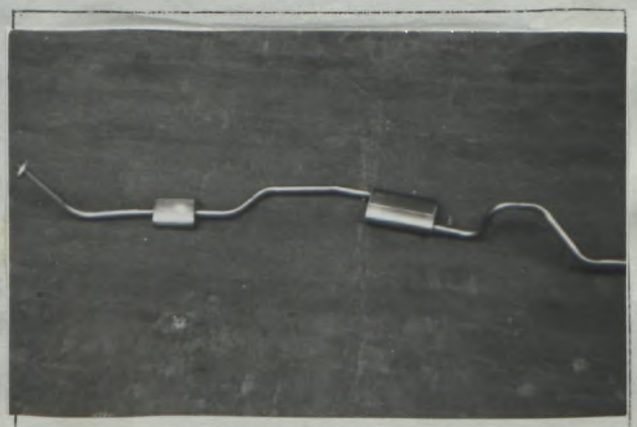

5406

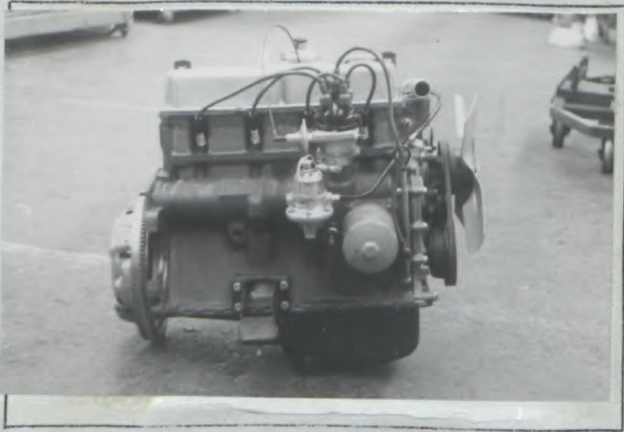

J

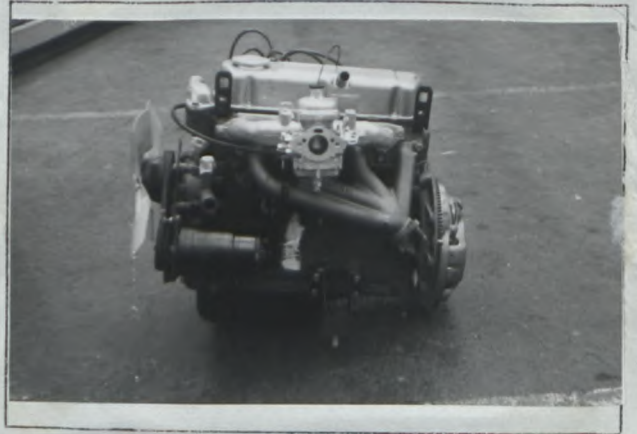

K

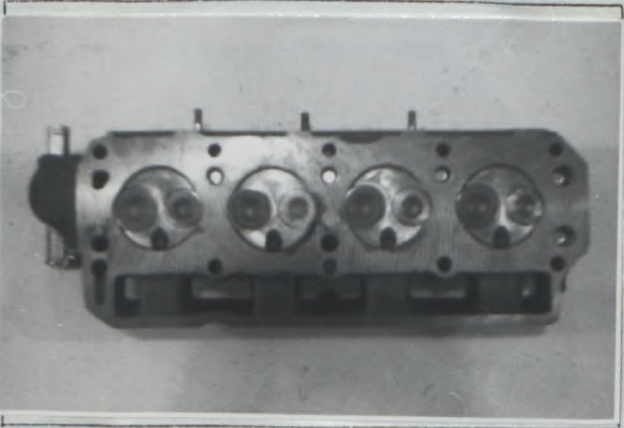

L

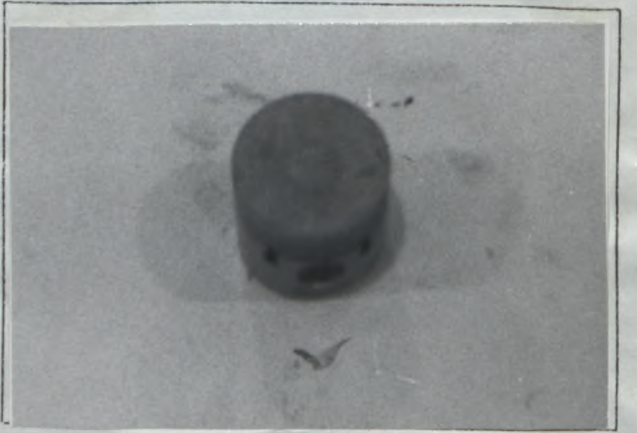

M

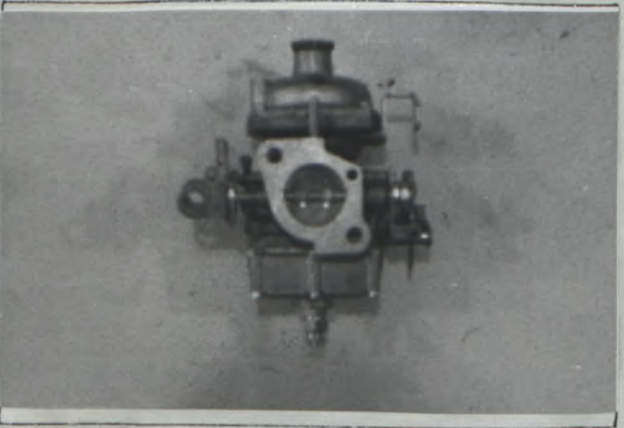

N

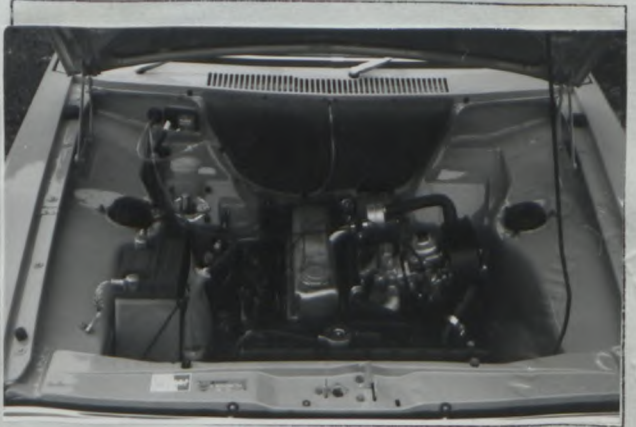

O



P



Q

Drawing inlet manifold ports, side of cylinderhead. Indicate scale or dimensions and manufacturing tolerance.

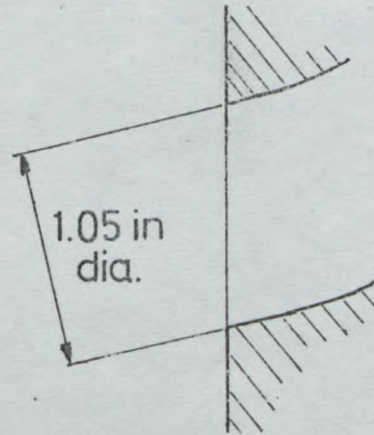

Drawing of entrance to inlet port of cylinderhead. Indicate scale or dimensions and manufacturing tolerance.

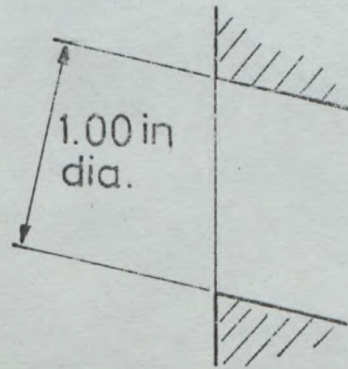

Drawing of exhaust manifold ports, side of cylinderhead. Indicate scale or dimensions and manufacturing tolerance.

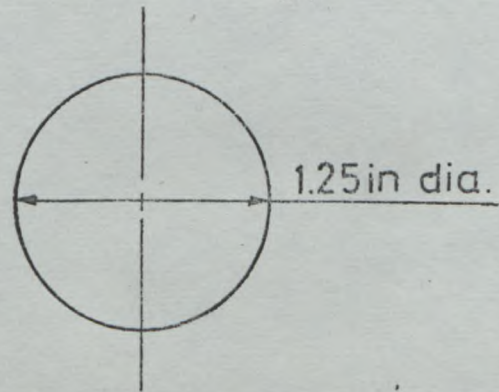

Drawing of exit to exhaust port of cylinderhead. Indicate scale or dimensions and manufacturing tolerance.

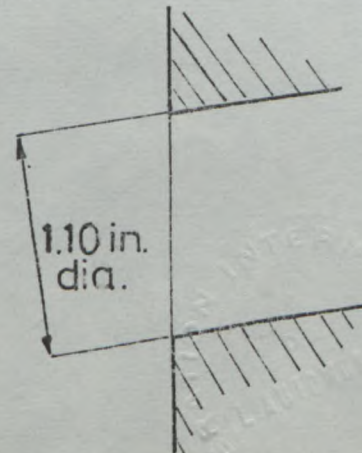

**NOTE 1.**

All dimensions must be given in two measuring systems, see Note 3.

**CAPACITIES AND DIMENSIONS**

1. Wheelbase		2490 mm.	98.0 inches
2. Front track	1295.4 mm.	51.0 inches	
		3. Rear track	
		1301.8 mm.	51.3 inches

Height of bottom of sill panel to the road :-

Front :- 7.25 in. 184 mm.

Rear :- 8.10 in. 206 mm.

4. Overall length of the car		409 cm.	161.3 inches
5. Overall width of the car		159 cm.	62.5 inches
6. Overall height of the car		135 cm.	53.1 inches
7. Capacity of fuel tank (reserve included)			
	40.9 ltrs.	10.8 gall. U.S.	9 gall. Imp.
8. Seating Capacity. 4.			
9. Weight. Total weight of the car with normal equipment, water, oil, and spare wheel but without fuel or repair tools :			
	820 kg.	1810 lbs.	16.2 cwts.

**NOTE 2.**

Differences in track caused by the use of other wheels with different rim widths must be stated when recognition is requested for the wheels concerned. Specify ground clearance in relation to the track and give drawing of two easily recognisable points at front and rear at which measurements are taken. These ground clearance dimensions are only for information when checking the track and can in no way affect the eligibility of the car.

**NOTE 3.**

**CONVERSION TABLE**

1 inch/pouce	— 2.54	cm.	1 quart US	— 0.9464	ltrs.
1 foot/pied	— 30.4794	cm.	1 pint (pt)	— 0.568	ltrs.
1 sq. inch/pouce carre	— 6.452	cm. <sup>2</sup>	1 gallon Imp.	— 4.546	ltrs.
1 cubic inch/pouce cube	— 16.387	cm. <sup>3</sup>	1 gallon US	— 3.785	ltrs.
1 pound/livre (lb)	— 453.593	gr.	1 hundred weight (cwt.)	— 50.802	kg.

Make Hillman

Model Avenger 1250

F.I.A. Rec. No.

**5406**

**CHASSIS AND COACHWORK (Photographs A, B and C)**

- 20. Chassis/body construction: ~~separate~~/unitary construction
- 21. Unitary construction, material(s) **Steel.**
- 22. Separate construction, Material(s) of chassis -
- 23. Material(s) of coachwork **Steel.**
- 24. Number of doors 4 Material(s) **Steel.**
- 25. Material(s) of bonnet **Steel.**
- 26. Material(s) of boot lid **Steel.**
- 27. Material(s) of rear-window **Safety Glass.**
- 28. Material(s) of windscreen **Safety Glass.**
- 29. Material(s) of front-door windows **Safety Glass.**
- 30. Material(s) of rear-door windows **Safety Glass.**
- 31. Sliding system of door windows **Vertical Winding.**
- 32. Material(s) of rear-quarter light **Safety Glass.**

**ACCESSORIES AND UPHOLSTERY**

- 38. Interior heating : yes ~~yes~~
- 39. Air conditioning : ~~yes~~ — no
- 40. Ventilation : yes ~~yes~~
- 41. Front seats, type of seat and upholstery **Ambla on cushion frame.**
- 42. Weight of front seat(s), complete with supports and rails, out of the car : **8.15 kg. 18 lbs.**
- 43. Rear seats, type of seat and upholstery **Ambla on Cushion Frame.**
- 44. Front bumper, material(s) **Steel.** Weight **3.43 kg. 7.55 lbs.**
- 45. Rear bumper, material(s) **Steel.** Weight **4.15 kg. 9.15 lbs.**

**WHEELS**

- 50. Type **Pressed steel ventilated disc.**
- 51. Weight (per wheel, without tyre) **5.9 kg. 13.0 lbs.**
- 52. Method of attachment **4 stud.**
- 53. Rim diameter **330 mm. 13 ins.**
- 54. Rim width **114 mm. 4.5 ins.**

**STEERING**

- 60. Type **Rack and Pinion.**
- 61. Servo-assistance : ~~yes~~ — no
- 62. Number of turns of steering wheel from lock to lock **3.66.**
- 63. In case of servo-assistance -

Make Hillman

Model Avenger 1250

F.I.A. Rec. No. 5406

**SUSPENSION**

- 70. Front suspension (photograph D), type Independent Hydraulic Strut Assemblies.
- 71. Type of spring Coil.
- 72. Stabiliser (if fitted) Transverse anti-roll bar.
- 73. Number of shock absorbers 2.
- 74. Type Telescopic.
- 78. Rear suspension (photograph E), type Live axle with 4 link location.
- 79. Type of spring Coil.
- 80. Stabiliser (if fitted) Nil.
- 81. Number of shock absorbers 2.
- 82. Type Telescopic.

**BRAKES** (photographs F and G)

- 90. Method of operation Hydraulic.
- 91. Servo-assistance (if fitted), type Girling direct acting vacuum ( optional.)
- 92. Number of hydraulic master cylinders 1, tandem master cylinder optional.

	FRONT	2	REAR	1.
94. Bore of wheel cylinder(s)	48.1 mm.	1.893 inches	17.77mm.	0.7 inches

**Drum Brakes**

95. Inside diameter	mm.	inches	2030 mm.	8.0 inches
96. Length of brake linings	mm.	inches	1972 mm.	7.75 inches
97. Width of brake linings	mm.	inches	381 mm.	1.5 inches
98. Number of shoes per brake			2.	
99. Total area per brake	mm. <sup>2</sup>	sq. in.	15000mm. <sup>2</sup>	23.2 sq. in.

**Disc Brakes**

100. Outside diameter	240 mm.	9.44 inches	mm.	inches
101. Thickness of disc	9.5 mm.	0.375 inches	mm.	inches
102. Length of brake linings	61.8 mm.	2.436 inches	mm.	inches
103. Width of brake linings	43.2 mm.	1.70 inches	mm.	inches
104. Number of pads per brake		2.		
105. Total area per brake	5060 mm. <sup>2</sup>	7.82 sq. in.	mm. <sup>2</sup>	sq. in.

Make Hillman Model Avenger 1250 F.I.A. Rec. No. 5406

**ENGINE** (photographs J and K)

- |   |                                       |   |  |
|---|---------------------------------------|---|--|
| 130. Cycle  | 4.                                    | 131. Number of cylinders                | 4.   |
| 132. Cylinder Arrangement   | In line.                              |   |  |
| 133. Bore   | 78.6 mm. 3.09 in.                     | 134. Stroke                             | 64.3 mm. 2.53 in.  |
| 135. Capacity per cylinder  |                                       |   | 312 cm. <sup>3</sup> 19.05 cu. in.   |
| 136. Total cylinder capacity  |                                       |   | 1248 cm. <sup>3</sup> 76.2 cu. in.   |
| 137. Material(s) of cylinder block  | Cast Iron.                            | 138. Material(s) of sleeves (if fitted) | Nil.   |
| 139. Cylinder head, material(s)   | Cast Iron.                            | Number fitted                           | 1.   |
| 140. Number of inlet ports  | 4.                                    | 141. Number of exhaust ports            | 4.   |
| 142. Compression ratio  | 9.2:1.                                |   |  |
| 143. Volume of one combustion chamber                                       |                                       |   | (13.7) cm. <sup>3</sup> (0.836) cu. in.<br>(16.2) cm. <sup>3</sup> (0.990) cu. in. |
| 144. Piston, material   | Aluminium.                            | 145. Number of rings                    | 3.   |
| 146. Distance from gudgeon pin centre line to highest point of piston crown |                                       |   | (44.0) mm. 1.732) in.<br>(44.1) mm. 1.735) in.                                     |
| 147. Crankshaft: <del>crankshaft</del> /stamped                             |                                       | 148. Type of crankshaft: integral/      | Yes.   |
| 149. Number of crankshaft main bearings                                     | 5.                                    |   |  |
| 150. Material of bearing cap  | Cast Iron.                            |   |  |
| 151. System of lubrication: <del>dry sump</del> /oil in sump                |                                       |   |  |
| 152. Capacity, lubricant  | 4.0 ltrs. 7.0 pts. 4.22 quarts U.S.   |   |  |
| 153. Oil cooler: <del>yes</del> /no   |                                       | 154. Method of engine cooling           | Water.   |
| 155. Capacity of cooling system   | 7.32 ltrs. 12.9 pts. 7.73 quarts U.S. |   |  |
| 156. Cooling fan (if fitted) dia.   |                                       |   | 36.8 cm. 14.5 in.  |
| 157. Number of blades of cooling fan  | 4.                                    |   |  |

**Bearings**

- |                                   |              |      |           |           |
|-----------------------------------|--------------|------|-----------|-----------|
| 158. Crankshaft main, type        | Steel shell. | dia. | 54.0 m.m. | 2.125 in. |
| 159. Connecting rod big end, type | Steel shell. | dia. | 50.8 m.m. | 2.000 in. |

**Weights**

- |   |                      |                     |           |                                  |
|---|----------------------|---------------------|-----------|----------------------------------|
| 160. Flywheel (clean)                         |                      |                     | 7.65 kg.  | 16.875 lbs.                      |
| 161. Flywheel with clutch (all turning parts) |                      |                     | 12.45 kg. | 27.475 lbs.                      |
| 162. Crankshaft                               | 12.25 kg. 27.00 lbs. | 163. Connecting rod | 0.723 kg. | 1.594 lbs. <sup>Top</sup> Limit. |
| 164. Piston with rings and pin                |                      |                     | 0.551 kg. | 1.2175 lbs.                      |



**FOUR STROKE ENGINES**

170. Number of camshafts 1. 171. Location Right hand side of the block.  
 172. Type of camshaft drive Chain.  
 173. Type of valve operation Pushrod and rockers.

**INLET** (see page 4)\*

180. Material(s) of inlet manifold Aluminium.  
 181. Diameter of valves 36.06 mm. 1.420 ins.  
 182. Max. valve lift 9.31 mm. 0.367 in. 183. Number of valve springs 1.  
 184. Type of spring Coil. 185. Number of valves per cylinder 1.  
 186. Tappet clearance for checking timing ~~(cold)~~ (warm) 0.23 mm. 0.008 ins.  
 187. Valves open at (with tolerance for tappet clearance indicated) 38° B.T.D.C.  
 188. Valves close at (with tolerance for tappet clearance indicated) 66° A.B.D.C.  
 189. Air filter, type Paper element.

**EXHAUST** (see page 4)\*

195. Material(s) of exhaust manifold Cast iron.  
 196. Diameter of valves 30.50 mm. 1.200 ins.  
 197. Max. valve lift 9.26 mm. 0.365 in. 198. Number of valve springs 1.  
 199. Type of spring Coil. 200. Number of valves per cylinder 1.  
 201. Tappet clearance for checking timing ~~(cold)~~ (warm) 0.325 mm. 0.012 ins.  
 202. Valves open at (with tolerance for tappet clearance indicated) 72° B.B.D.C.  
 203. Valves close at (with tolerance for tappet clearance indicated) 20° A.T.D.C.  
 204. Diameter outlet orifice exhaust manifold 38.1 mm. 1.50 ins.

**CARBURETION** (photograph N)

210. Number of carburettors fitted 1. 211. Type Horizontal.  
 212. Make Zenith. 213. Model 150 CDS.  
 214. Number of mixture passages per carburettor 1.  
 215. Flange hole diameter of exit port(s) of carburettor 38.1 mm. 1.50 ins.  
 216. Minimum diameter of venturi/minimum diam., with piston at maximum height (example : SU)  
25.4 mm. 1.00 ins.

**INJECTION** (if fitted)

220. Make of pump 221. Number of plungers  
 222. Model or type of pump 223. Total number of injectors  
 224. Location of injectors  
 225. Minimum diameter of inlet pipe mm. ins.

\* For additional information concerning two-stroke engines and super-charged engines, see page 13.

Make Hillman

Model Avenger 1250

F.I.A. Rec. No. 5406

ENGINE ACCESSORIES

230. Fuel pump : mechanical ~~and/or electrical~~
231. No. fitted 1.
232. Type of ignition system Coil. 233. No. of distributors 1.
234. No. of ignition coils 1. 235. No. of spark plugs per cylinder 1.
236. Generator, type : dynamo/~~alternator~~—number fitted 1.
237. Method of drive Belt.
238. Voltage of generator 12 volts
239. Battery, number 1.
240. Location Engine compartment.
241. Voltage of battery 12 volts

ENGINE AND CAR PERFORMANCES (as declared by manufacturer in catalogue)

250. Max. engine output 60 (type of horsepower: BHP gross. ) at 5,000 r.p.m.
251. Max. r.p.m. 6,700 output at that figure Not available.
252. Max. torque 66 lbs ft. at 3,000 r.p.m.
253. Max. speed of the car 135 km./hour 84 miles/hour

R = centre of camshaft

a55

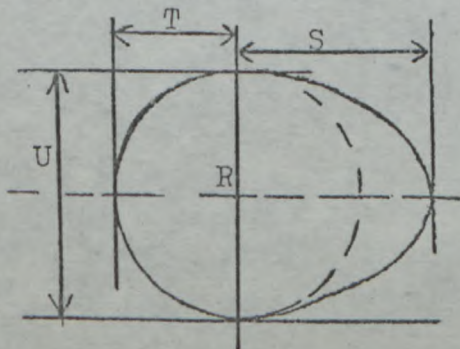

Inlet cam

S = 23.60 - 24.40 mm. 0.930 - 0.960 inches  
T = 17.15 - 17.90 mm. 0.675 - 0.705 inches  
U = 34.22 - 35.80 mm. 1.350 - 1.410 inches

Exhaust cam

S = 23.60 - 24.40 mm. 0.930 - 0.960 inches  
T = 17.15 - 17.90 mm. 0.675 - 0.705 inches  
U = 34.22 - 35.80 mm. 1.350 - 1.410 inches

Make Hillman

Model Avenger 1250

F.I.A. Rec. No. 5406

**DRIVE TRAIN**

**CLUTCH**

- 260. Type of clutch Diaphragm.
- 261. No. of plates 1.
- 262. Dia. of clutch plates 18.4 cm. 7.25 ins.
- 263. Dia. of linings, inside 13.0 cm. 5.125 ins.
- outside 18.4 cm. 7.25 ins.
- 264. Method of operating clutch Cable.

**GEAR BOX** (photograph H)

- 270. Manual type, make CHRYSLER. Method of operation Manual.
- 271. No. of gear-box ratios forward 4. 272. Synchronized forward ratios 4.
- 273. Location of gear-shift Central.
- 274. Automatic, make NIL. type
- 275. No. of forward ratios 276. Location of gear shift

277.	Manual		Automatic		Alternative manual/automatic			
	Ratio	No. teeth	Ratio	No. teeth	Ratio	No. teeth	Ratio	No. teeth
1	3.317	$\frac{23}{16} \cdot \frac{30}{13}$						
2	2.029	$\frac{23}{16} \cdot \frac{24}{17}$						
3	1.366	$\frac{23}{16} \cdot \frac{19}{20}$						
4	1.000	Direct.						
5								
6								
reverse	3.450	$\frac{23}{16} \cdot \frac{36}{15}$						

- 278. Overdrive, type NIL.
- 279. Forward gears on which overdrive can be selected
- 280. Overdrive ratio

**FINAL DRIVE**

- 290. Type of final drive Hypoid. 291. Type of differential Bevel gears.
- 292. Type of limited slip differential (if fitted in series-production) NIL.
- 293. Final drive ratio 4.375 : 1. Number of teeth 8/35.

**IMPORTANT :**

During the scrutineering of cars entered in group 5 (Sportscars) only the following items of the present recognition form are to be taken into consideration : 1, 2, 3, 9, 20, 21, 22, 23, 24, 25, 26, 70, 71, 78, 79, 90, 130, 131, 132, 133, 134, 135, 136, 137, 138, 139, 140, 141, 147, 148, 149, 150, 158, 159, 170, 171, 172, 173, 185, 200, 270, 271, 274, 275, 290, 291, 292 and photographs A, B, D, E, F, G, H, J, K and O.

The vehicle described in this form has been subject to the following amendments :

on.....19.....	rec. no.....	List.....	on.....19.....	rec. no.....	List.....
on.....19.....	rec. no.....	List.....	on.....19.....	rec. no.....	List.....
on.....19.....	rec. no.....	List.....	on.....19.....	rec. no.....	List.....
on.....19.....	rec. no.....	List.....	on.....19.....	rec. no.....	List.....
on.....19.....	rec. no.....	List.....	on.....19.....	rec. no.....	List.....

Optional equipment affecting preceding information. This to be stated together with reference number.

This vehicle is also known as the SUNBEAM AVENGER in certain countries.

293: Final drive ratio :- 3.889 : 1. 9/35 Teeth.

~~Undershields :-~~

~~Sump guard - part no 71250072.~~

~~Petrol tank guard - part no 71248039.~~

~~Gearbox mounting guard - part no 71248024.~~

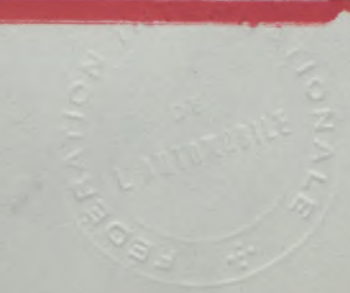



MOTOR SPORT DIVISION  
The Royal Automobile Club,  
31 Belgrave Square, London, S.W.1

Manufacturer Chrysler U.K.Ltd.

Model Avenger 1250.

F.I.A. Recognition No. 5406

Amendment No. 1.

*Amendment to Form of Recognition*

**FEDERATION INTERNATIONALE DE L'AUTOMOBILE**

No.	Reference No.	<u>VARIANT</u> :- Avenger Super.		
9.	Weight :	824 kg.	1818 lb.	16.2 cwt.



Date amendment is valid from.....

Stamp of F.I.A./R.A.C.



MOTOR SPORT DIVISION  
The Royal Automobile Club,  
31 Belgrave Square, London, S.W.1

Manufacturer Chrysler UK Ltd.  
Model Hillman Avenger 1250  
F.I.A. Recognition No. 5406  
Amendment No. 1/IV

*Amendment to Form of Recognition*

**FEDERATION INTERNATIONALE DE L'AUTOMOBILE**

No.

Reference No. Production Variant - 2 Door

*The specification of the two door version of the Avenger 1250, including all the options etc. is identical to the four door version except for the following items:-*

9. *Weight:- 780 Kg      1719 Lbs.      15-36 cwt.*  
24. *Number of doors:- 2.*  
42. *Weight of front seat:- 11.8 Kg      26 Lb.*

A.



Date amendment is valid from 1.7.73

Stamp of F.I.A./R.A.C.



MOTOR SPORT DIVISION  
The Royal Automobile Club,  
31 Belgrave Square, London, S.W.1

Manufacturer Chrysler U.K. Ltd.  
Model Hillman Avenger 1250  
F.I.A. Recognition No. 5406  
Amendment No. 1/IV

Amendment to Form of Recognition

**FEDERATION INTERNATIONALE DE L'AUTOMOBILE**

No.

Reference No. Production Variant - 2 Door

*B*



*e.*

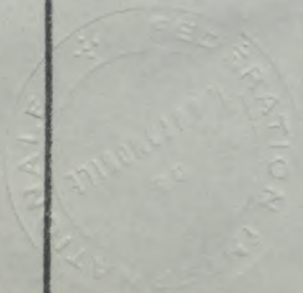

Date amendment is valid from.....

Stamp of F.I.A./R.A.C.



MOTOR SPORT DIVISION  
The Royal Automobile Club,  
31 Belgrave Square, London, S.W.1

Manufacturer Chrysler U.K Ltd  
Model Hillman Avenger 1250  
F.I.A. Recognition No. 5406  
Amendment No. U/W

*Amendment to Form of Recognition*

**FEDERATION INTERNATIONALE DE L'AUTOMOBILE**

No. Reference No. Production Variant - Avenger Super 2 Door.

*The specification of the 2 Door version of the Avenger 1250 Super, including all the options etc., is identical to the 4 Door version except for the following items:-*

- |     |                        |         |           |            |
|-----|------------------------|---------|-----------|------------|
| 9.  | Weight :-              | 788 Kg  | 1737 Lbs. | 15.50 cwt. |
| 24. | Number of doors:-      |         | 2         |            |
| 42. | Weight of front seat:- | 11.8 Kg |           | 26 Lb.     |

A.



Date amendment is valid from 1.7.73

Stamp of F.I.A./R.A.C.





MOTOR SPORT DIVISION  
The Royal Automobile Club,  
31 Belgrave Square, London, S.W.1

Manufacturer *Chrysler U.K. Ltd.*

Model *Hillman Avenger 1250*

F.I.A. Recognition No. *5406*

Amendment No. *2/W*

*Amendment to Form of Recognition*

**FEDERATION INTERNATIONALE DE L'AUTOMOBILE**

No.

Reference No. *Production Variant - Super 2 Door*

*B.*



*c.*



Date amendment is valid from.....

Stamp of F.I.A./R.A.C.



MOTOR SPORT DIVISION  
The Royal Automobile Club,  
31 Belgrave Square, London, S.W.1

Manufacturer Chrysler U.K. Ltd.  
Model Hillman Avenger 1250  
F.I.A. Recognition No. 5406  
Amendment No. 3/E

*Amendment to Form of Recognition*

FEDERATION INTERNATIONALE DE L'AUTOMOBILE

No.	Reference No.	<u>Evolutionary Change - all models.</u>	
181	Diameter of inlet valves :-	36.8 mm.	1.45 in.
196	Diameter of inlet valves :-	31.2 mm.	1.23 in.

Date amendment is valid from 1.7.73



Stamp of F.I.A./R.A.C.



MOTOR SPORT DIVISION  
The Royal Automobile Club,  
31 Belgrave Square, London, S.W.1

Manufacturer *Chrysler U.K. Ltd.*  
Model *Hillman Avenger 1250*  
F.I.A. Recognition No. *5406*  
Amendment No. *6/3V*

*Amendment to Form of Recognition*

**FEDERATION INTERNATIONALE DE L'AUTOMOBILE**

No.

Reference No.

*Supply Variant - alternative supplier.*

*Rear brake assembly.*

94. *Bore of wheel cylinder :- 0.6875 in. 17.46 mm.*



Date amendment is valid from *1.1.76*

Stamp of F.I.A./R.A.C.



MOTOR SPORT DIVISION  
The Royal Automobile Club,  
31 Belgrave Square, London, S.W.1

Manufacturer Chrysler U.K. Ltd  
Model Hillman Avenger 1250  
F.I.A. Recognition No. 5406  
Amendment No. 514V

*Amendment to Form of Recognition*

**FEDERATION INTERNATIONALE DE L'AUTOMOBILE**

No.

Reference No. Optional equipment - Heavy Duty Specification  
- all models.

*In addition to the stiffer suspension and undershields,  
the Heavy Duty Specification now includes  
the following items:-*

1. Turret brace (joining front suspension top mountings  
to bulkhead)

Part No:- 71.203.122.

Weight:- 2.04 Kg 4.5 Lb.

Dimensions:- 109 x 30.5cm.  
43 x 12 in.



2. Engine oil cooler (two Supply Variants)

Part No:- 71.087.504

Weight:- 1.5 Kg 3.3 Lb.

Dimensions:- 33 x 10 x 5 cm.  
13 x 4 x 2 in.



Date amendment is valid from 1.1.76

Stamp of F.I.A./R.A.C.



MOTOR SPORT DIVISION  
The Royal Automobile Club,  
31 Belgrave Square, London, S.W.1

Manufacturer Chrysler U.K. Ltd.  
Model Hillman Avenger 1250  
F.I.A. Recognition No. 5406  
Amendment No. 5/4V

Amendment to Form of Recognition

FEDERATION INTERNATIONALE DE L'AUTOMOBILE

No.

Reference No.

2. Cont'd.

Part No:- 71.235.338.

Weight:- 2.55 Kg 5.63 Lb.

Dimensions:- 52 x 5 Dia. cm.  
20.5 x 2 Dia. in



152. Capacity, lubricant, becomes:-

4.25 ltrs.

7.5 pts.

4.5 quarts U.S.

3. Engine restraints (attached to engine mounting brackets)

Part No:- 71.203.123.

Weight:- .48 Kg 1.1 Lb.  
(each)

Dimensions:- 8.4 x 8 x 6 cm.  
3.3 x 3.1 x 2.4 in

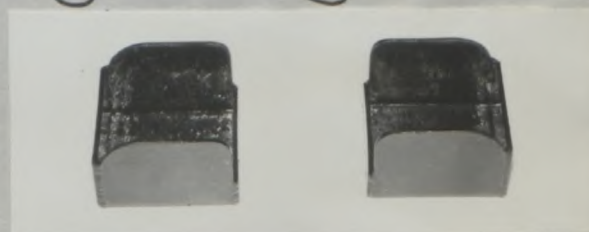

4. Limited slip differential

292 Type of differential:- 4 pinion.



Part No:- 71.203.101

Date amendment is valid from.....

Stamp of F.I.A./R.A.C.



MOTOR SPORT DIVISION  
The Royal Automobile Club,  
31 Belgrave Square, London, S.W.1

Manufacturer Chrysler U.K. Ltd.  
Model Hillman Avenger 1250  
F.I.A. Recognition No. 5406  
Amendment No. 6/2E

Amendment to Form of Recognition

FEDERATION INTERNATIONALE DE L'AUTOMOBILE

No.

Reference No. Normal Evolution - Hillman Avenger 1300.

The specification of the Hillman Avenger 1300, including all options etc. is identical to the Hillman Avenger 1250 except for the following evolutionary changes listed below:-

I

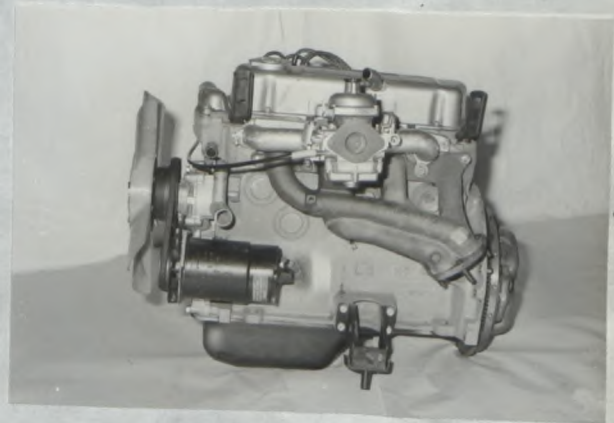

K

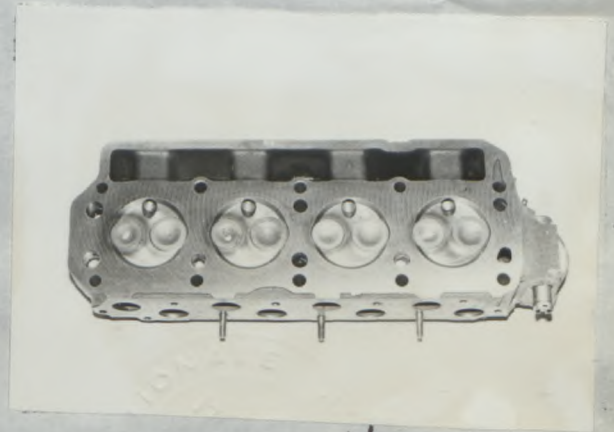
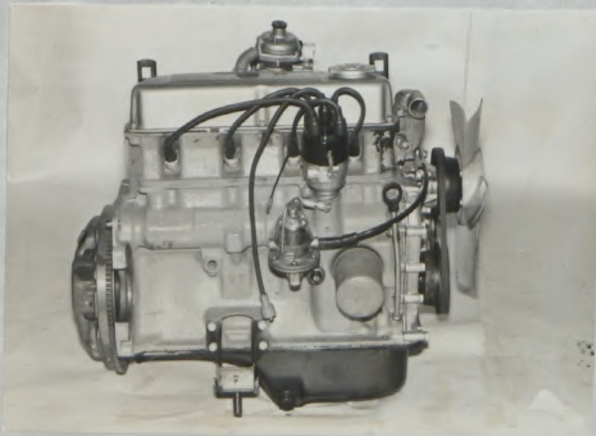

Date amendment is valid from 1.4.76

Stamp of F.I.A./R.A.C.



MOTOR SPORT DIVISION  
The Royal Automobile Club,  
31 Belgrave Square, London, S.W.1

Manufacturer *Chrysler U.K. Ltd*  
Model *Hillman Avenger 1250*  
F.I.A. Recognition No. *5406*  
Amendment No. *6/2E*

Amendment to Form of Recognition

**FEDERATION INTERNATIONALE DE L'AUTOMOBILE**

No. Reference No. *Avenger 1300 - cont'd.*

M

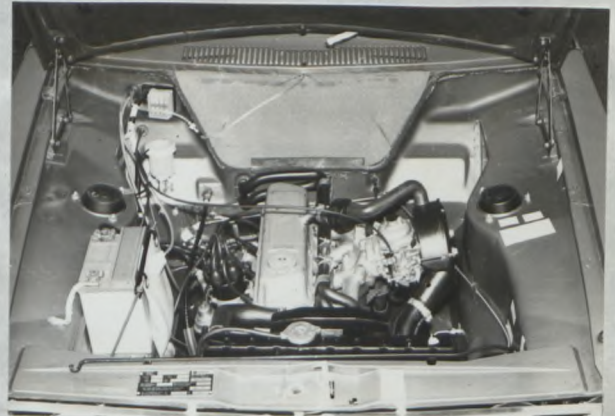

P

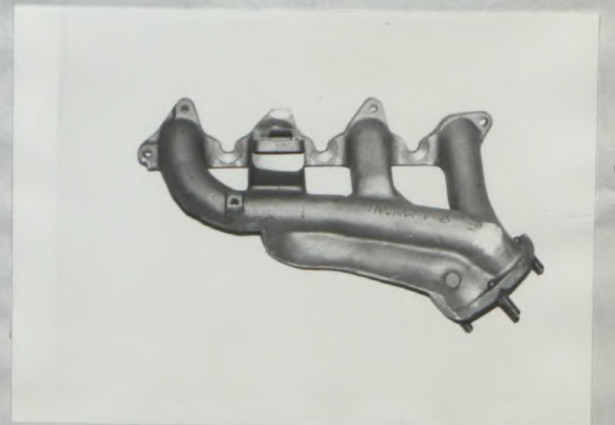

Date amendment is valid from.....

Stamp of F.I.A./R.A.C.

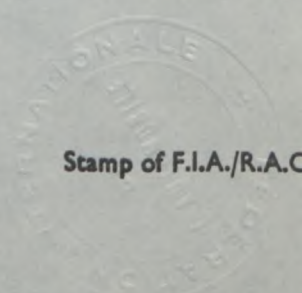



MOTOR SPORT DIVISION  
The Royal Automobile Club,  
31 Belgrave Square, London, S.W.1

Manufacturer Chrysler U.K. Ltd.  
Model Hillman Avenger 1250  
F.I.A. Recognition No. 5406  
Amendment No. 6/2E

Amendment to Form of Recognition

FEDERATION INTERNATIONALE DE L'AUTOMOBILE

No.

Reference No. Avenger 1300 cont'd.

Inlet manifold  
ports

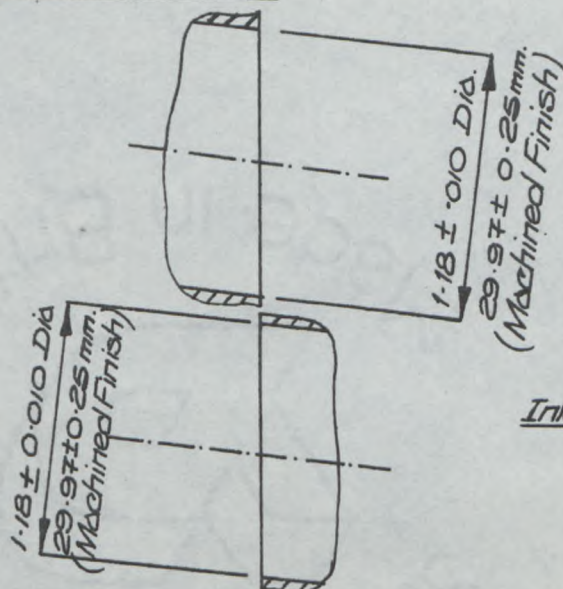

Inlet part of cylinder  
head

Exhaust manifold  
ports

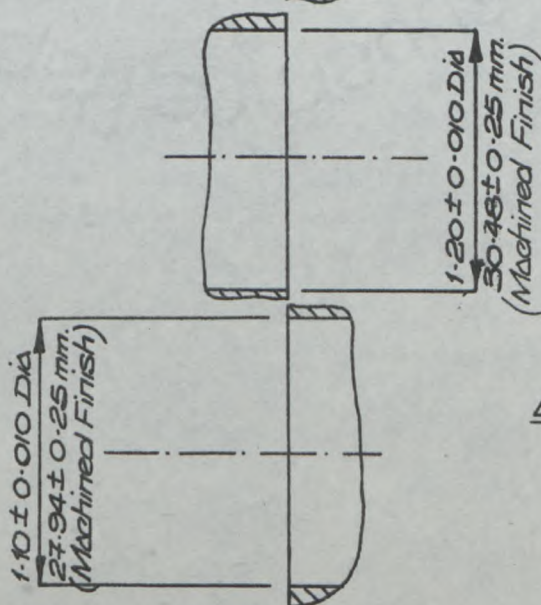

Exhaust part of cylinder  
head

Date amendment is valid from .....

Stamp of F.I.A./R.A.C.





MOTOR SPORT DIVISION  
The Royal Automobile Club,  
31 Belgrave Square, London, S.W.1

Manufacturer Chrysler U.K. Ltd.  
Model Hillman Avenger 1250  
F.I.A. Recognition No. 5406  
Amendment No. 6/2E

Amendment to Form of Recognition

FEDERATION INTERNATIONALE DE L'AUTOMOBILE

No.	Reference No.	<u>Avenger 1300 cont'd.</u>	
7.	Capacity of fuel tank:-	45.5 ltrs.	12 gall U.S. 10 gall. Imp.
133.	Bore:-		3.100 in. 78.72 mm.
133a	Overbore:-	Not possible.	
134.	Stroke:-		2.625 in. 66.67 mm.
135.	Capacity per cylinder:-		19.75 in <sup>3</sup> 323.8 cc.
136	Total cylinder capacity		79.0 in <sup>3</sup> 1,295 cc.
142.	Compression ratio:-		8.6 : 1 ± 0.5
143.	Volume of one combustion chamber:-		16.1 0.98 17.3 cm <sup>3</sup> 1.06 in. <sup>3</sup>
143a.	Compressed thickness of gasket:-		0.97 0.038 0.89 mm. 0.035 in.
156.	Cooling fan dia:-		33.0 cm. 13.0 in.
157.	Nb. blades on cooling fan:-		6
160.	Flywheel weight (clean):-	17.3 15.6 Lb.	7.82 7.09 Kg
161	Flywheel with clutch weight:-	28.0 25.3 Lb.	12.70 11.49 Kg
162	Crankshaft weight:-	25.4 23.0 Lb.	11.52 10.44 Kg
163	Connecting rod weight:-	1.70 1.54 Lb.	0.774 0.699 Kg
164	Piston, rings & pin weight:-	1.24 1.12 Lb.	0.562 0.509 Kg

Date amendment is valid from.....

Stamp of F.I.A./R.A.C.



MOTOR SPORT DIVISION  
The Royal Automobile Club,  
31 Belgrave Square, London, S.W.1

Manufacturer *Chrysler U.K. Ltd*  
Model *Hillman Avenger 1250*  
F.I.A. Recognition No. *5406*  
Amendment No. *6/2E*

Amendment to Form of Recognition

FEDERATION INTERNATIONALE DE L'AUTOMOBILE

No.	Reference No.	
	<i>Avenger 1300 cont'd</i>	
<i>204</i>	<i>Dis. outlet orifice exhaust manifold:-</i>	<i>38.1 mm. 1.25 in.</i> <i>(Two outlets)</i>
<i>250</i>	<i>Max engine output:-</i>	<i>69 BHP gross @ 5,000 RPM.</i>
<i>252.</i>	<i>Max torque:-</i>	<i>69 lb. ft. @ 2,800 RPM.</i>
<i>253.</i>	<i>Max speed of the car:-</i>	<i>87 MPH 139 KPH</i>

*In accordance with Chrysler policy, this vehicle is marketed in certain territories under the following names:-  
Sunbeam Plymouth Dodge.*

Date amendment is valid from .....

Stamp of F.I.A./R.A.C.





MOTOR SPORT DIVISION  
The Royal Automobile Club,  
31 Belgrave Square, London, S.W.1

Manufacturer Chrysler U.K. Ltd.  
Model Hillman Avenger 1250  
F.I.A. Recognition No. 5406  
Amendment No. 8/3E

Amendment to Form of Recognition

**FEDERATION INTERNATIONALE DE L'AUTOMOBILE**

No.

Reference No. Normal Evolution - Hillman Avenger 1300 - 2 door.

The specification of the Avenger 1300 - 2 door, including all the options etc., is identical to the superceded Avenger 1250 - 2 door [ref amendment no. 1/1V] except for the normal evolutionary changes listed under "Avenger 1300"

Date amendment is valid from 1 4 76

Stamp of F.I.A./R.A.C.



MOTOR SPORT DIVISION  
The Royal Automobile Club,  
31 Belgrave Square, London, S.W.1

Manufacturer *Chrysler U.K. Ltd*  
Model *Hillman Avenger 1250*  
F.I.A. Recognition No. *5406*  
Amendment No. *9/6V*

Amendment to Form of Recognition

**FEDERATION INTERNATIONALE DE L'AUTOMOBILE**

No.

Reference No. *Normal Evolution - Avenger 1300 Super*

*The specification of the Avenger 1300 Super, including all options etc., is identical to the superseded Avenger Super [ref. amendment no 1] except for the normal evolutionary changes listed under "Avenger 1300" and those listed below, which apply to this Variant only.*



Date amendment is valid from *1.4.76*

Stamp of F.I.A./R.A.C.