



JAPAN AUTOMOBILE FEDERATION

F. I. A. Recognition No.
Group 1

5354

FEDERATION INTERNATIONALE DE L'AUTOMOBILE

Form of recognition in accordance with
Appendix J to the International Sporting Code.

Manufacturer	DAIHATSU KOGYO Co., Ltd.	Cylinder-capacity	356	cm ³	21.7	cu. in.
Serial No. of chassis	L38-100001	Model	L38.	Manufacturer	DAIHATSU KOGYO Co., Ltd.	
Serial No. of engine	ZM -000001	Manufacturer	DAIHATSU KOGYO Co., Ltd.			
Recognition is valid from	11/170	List	7017			

The manufacturing of the model described in this recognition form was started on march 1970 and the minimum production of 5 000 identical cars, in accordance with the specifications of this form was reached on april 1970.

Photograph A, 3/4 view of car from front



The vehicle described in this form has been subject to the following amendments :

Variants				Normal evolution of the type			
on	19	rec. No.	List	on	19	rec. No.	List
on	19	rec. No.	List	on	19	rec. No.	List
on	19	rec. No.	List	on	19	rec. No.	List
on	19	rec. No.	List	on	19	rec. No.	List
on	19	rec. No.	List	on	19	rec. No.	List

Stamp and signature of the
National Sporting Authority

Stamp and signature of the F. I. A.

[Handwritten signature and official stamp of the F.I.A.]

IMPORTANT - the underlined items must be stated in two measuring systems, one of which must be the metric system. See conversion table hereafter.

CAPACITIES AND DIMENSIONS

1. <u>Wheelbase</u>	2,090	mm	82.3	inches
2. <u>Front track</u>	1,120	mm	44.1	inches *
3. <u>Rear track</u>	1,110	mm	43.7	inches *
4. Overall length of the car		2 9 95	cm	inches
5. Overall width of the car		1 2 95	cm	inches
6. Overall height of the car		1 3 05	cm	inches
7. <u>Capacity of fuel tank</u> (reserve included)				26 ltrs.
	6.9	Gallon US		Gallon Imp.
8. Seating capacity	4			
9. <u>Weight</u> , total weight of the car with normal equipment, water, oil and spare wheel but without fuel nor repair tools:				
	440	kg	970	lbs cwt

* Differences in track caused by the use of other wheels with different rim widths must be stated when recognition is requested for the wheels concerned.

Specify ground clearance in relation to the track and give drawing of two fixed points of the vehicle's structure at which measurements are taken.

These ground clearance dimensions are only for information when checking the track and can in no way affect the eligibility of the car.

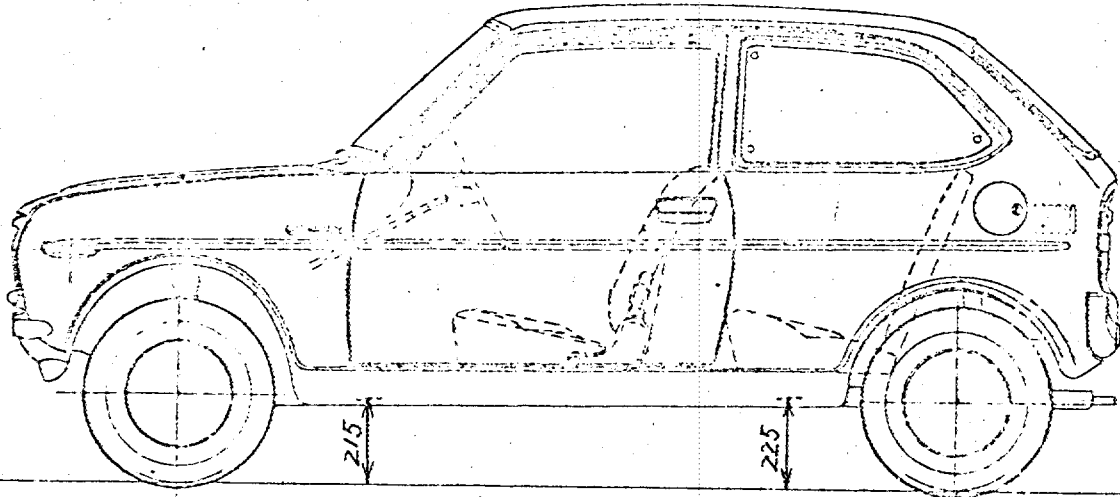

CONVERSION TABLE

1 inch/pouce	— 2.54 cm	1 quart US	— 0.9464 ltrs
1 foot/pied	— 30.4794 cm	1 pint (pt)	— 0.568 ltrs
1 square inch/pouce carré	— 6.452 cm ²	1 gallon Imp.	— 4.546 ltrs
1 cubic inch/pouce cube	— 16.387 cm ³	1 gallon US	— 3.785 ltrs
1 pound/livre (lb)	— 453.593 gr.	1 hundred weight (cwt)	— 50.802 kg

Unit: mm

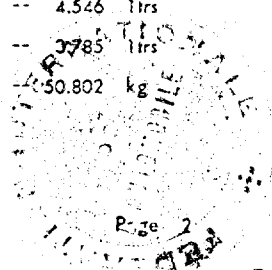

Make DAIHATSU KOGYO Co.,Ltd. Model L38.

F.I.A. Rec. No.

CHASSIS AND COACHWORK (Photographs A, B and C)

20. Chassis/body construction : ~~separate~~ / unitary construction
21. Unitary construction, material (s) Steel.
Separate construction
22. Separate Constructions: Material(s) of chassis
23. Material (s) of coachwork Steel.
24. Number of doors 2 Material (s) Steel.
25. Material (s) of bonnet Steel.
26. Material (s) of boot lid Steel.
27. Material (s) of rear-window Glass.
28. Material (s) of windscreen Glass.
29. Material (s) of front-door windows Glass.
30. Material (s) of rear-door windows
31. Sliding system of door windows Vertical, manual.
32. Material (s) of rear-quarter light Glass.

ACCESSORIES AND UPHOLSTERY

38. Interior heating : ~~yes~~ - no
39. Air-conditioning : ~~yes~~ - no
40. Ventilation : yes - ~~no~~
41. Front seats, type of seats and upholstery Separate, vinyl leather.
42. Weight of front seat (s), complete with supports and rails, out of the car :
7.8 kg x 2 lbs
43. Rear seats, type of seats and upholstery Bench, vinyl leather.
44. Front bumper, material (s) Rubber Weight 0.27 x 2 kg lbs
45. Rear bumper, material (s) Steel Weight 1.2 kg lbs

WHEELS

50. Type Pressed steel.
51. Weight (per wheel, without tyre) 2.4 kg lbs
52. Method of attachment 4 nuts.
53. Rim diameter 253.2 mm 10 inches
54. Rim width 89 mm 3.5 inches

STEERING

60. Type Rack and pinion.
61. Servo-assistance : ~~yes~~ - no
62. Number of turns of steering wheel from lock to lock 3.5
63. In case of servo-assistance



Make **DAIHATSU KOGYO Co., Ltd.** Model **L38.**

F. I. A. Rec. No.

SUSPENSION

- 70. Front suspension (photogr. D), type **Independent, Macpherson.**
- 71. Type of spring **Coil.**
- 72. Stabiliser (if fitted)
- 73. Number of shock absorbers **2** 74. Type **Hydraulic telescopic.**
- 78. Rear suspension (photogr. E), type **Independent, trailing.**
- 79. Type of spring **Coil.**
- 80. Stabiliser (if fitted)
- 81. Number of shock absorbers **2** 82. Type **Hydraulic telescopic.**

BRAKES (photographs F and G)

- 90. System **Hydraulic.**
- 91. Servo-assistance (if fitted), type
- 92. Number of hydraulic master cylinders **1**

		FRONT		REAR	
93. Number of cylinders per wheel		2		1	
94. Bore of wheel cylinder (s)	22.2	mm	in. 15.8	mm	in.
Drum brakes					
95. Inside diameter	180	mm	in. 180	mm	in.
96. Length of brake linings	173	mm	in. 173	mm	in.
97. Width of brake linings	35	mm	in. 35	mm	in.
98. Number of shoes per brake		2		2	
99. Total area per brake	12110	mm ²	sq. in. 12110	mm ²	sq. in.
Disc brakes					
100. Outside diameter		mm	in.	mm	in.
101. Thickness of disc		mm	in.	mm	in.
102. Length of brake linings		mm	in.	mm	in.
103. Width of brake linings		mm	in.	mm	in.
104. Number of pads per brake					
105. Total area per brake		mm ²	sq. in.	mm ²	sq. in.



Make DAIHATSU KOGYO Co.,Ltd.

Model L38.

F. I. A. Rec. No.

ENGINE (photographs J and K)

130. Cycle	2	131. Number of cylinders	2
132. Cylinder arrangement	In line.		
133. Bore	62.0 mm	134. Stroke	59.0 mm
	2.4 in.		2.3 in.
135. Capacity per cylinder	178	cm ³	10.9
			cu. in.
136. Total cylinder-capacity	356	cm ³	21.7
			cu. in.
137. Material (s) of cylinder block	Cast iron.		
138. Material (s) of sleeves (if fitted)			
139. Cylinder-head, material (s)	Aluminum alloy.	Number fitted	1
140. Number of inlet ports	2	141. Number of exhaust ports	2
142. Compression ratio	10.0		
143. Volume of one combustion chamber	19.8	cm ³	cu. in.
144. Piston, material	Aluminum alloy.	145. Number of rings	3
146. Distance from gudgeon pin centre line to highest point of piston crown	37 mm		
		inches	
147. Crankshaft : moulded / stamped		148. Type of crankshaft : integral / assembled.	
149. Number of crankshaft main bearings	4		
150. Material of bearing cap			
151. System of lubrication : dry sump / oil in sump			
152. Capacity, lubricant	3	litrs	pts
			quarts US
153. Oil cooler : yes / no		154. Method of engine cooling	Water.
155. Capacity of cooling system	3	litrs	pints
			quarts US
156. Cooling fan (if fitted), dia.	cm		inches
157. Number of blades of cooling fan			

Bearings

158. Crankshaft main, type	Radial ball.	Dia.	30	mm	in.
159. Connecting rod big end.	Needle roller.	Dia.	30	mm	in.

Weights

160. Flywheel (clean)	3.19	kg	lbs
161. Flywheel with clutch (all turning parts)	5.16	kg	lbs
162. Crankshaft	5.26	kg	lbs
163. Connecting rod	0.21	kg	lbs
164. Piston with rings and pin	0.276	kg	lbs



Make **DAIHATSU KOGYO Co., Ltd.** Model **L38.**

F.I.A. Rec. No.

FOUR STROKE ENGINES

170. Number of camshafts 171. Location
172. Type of camshaft drive
173. Type of valve operation

INLET (see page 8) *

180. Material(s) of inlet manifold **Aluminum alloy.**
181. Diameter of valves mm inches
182. Max. valve lift mm in. 183. Number of valve springs
184. Type of spring 185. Number of valves per cylinder
186. Tappet clearance for checking timing (cold) mm inches
187. Valves open at (with tolerance for tappet clearance indicated)
188. Valves close at (with tolerance for tappet clearance indicated)
189. Air filter, type **Dry.**

EXHAUST (see page 8)

195. Material (s) of exhaust manifold **Steel sheet.**
196. Diameter of valves mm inches
197. Max. valve lift mm in. 198. Number of valve springs
199. Type of spring 200. Number of valves per cylinder
201. Tappet clearance for checking timing (cold) mm inches
202. Valves open at (with tolerance for tappet clearance indicated)
203. Valves close at (with tolerance for tappet clearance indicated)

CARBURETION (photograph N)

210. Number of carburetors fitted **1** 211. Type **Down draft.**
212. Make **MIKUNI & HITACHI.** 213. Model **30PCBI & VCL30.**
214. Number of mixture passages per carburetor **1**
215. Flange hold diameter of exit port(s) of carburetor **30** mm in.
216. Minimum dimensions of mixture passage (s) ~~with piston at max height (example SU)~~
26 & 25 mm inches

INJECTION (if fitted)

220. Make of pump 221. Number of plungers
222. Model or type of pump 223. Total number of injectors
224. Location of injectors
225. Minimum diameter of inlet pipe mm inches

*) for additional information concerning two-stroke engines and super-charged engines see page 13.



Make DAIHATSU KOGYO Co., Ltd.

Model L38.

F.I.A. Rec. No.

ENGINE ACCESSORIES

- 230. Fuel pump : mechanical ~~and/or electric~~
- 232. Type of ignition system Make & break
- 234. No. of ignition coils 1
- 236. Generator, type: ~~dyamo~~/alternator-number fitted 1
- 238. Voltage of generator 12 volts
- 240. Location Engine room.
- 241. Voltage of battery 12 volts

- 231. No. fitted 1
- 233. No. of distributors 1
- 235. No. of spark plugs per cylinder 1
- 237. Method of drive V belt.
- 239. Bottery, number 1

ENGINE AND CAR PERFORMANCES (as declared by manufacturer in catalogue)

- 250. Max. engine output 33 PS (type of horsepower: JIS) at 6,500 rpm
- 251. Maximum rpm 4400 output at that figure 25.2 PS.
- 252. Maximum torque 3.7 mkg at 5500 rpm
- 253. Maximum speed of the car 115 km/hour miles / hour

255.

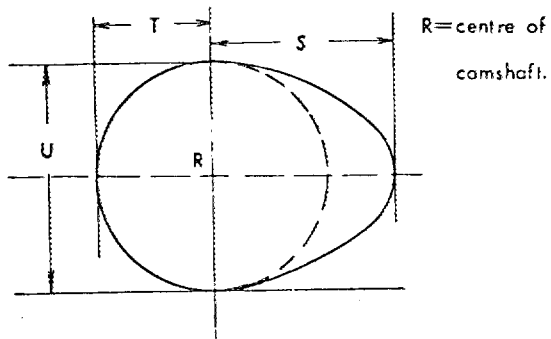

Inlet cam

- S = mm inches
- T = mm inches
- U = mm inches

Exhaust cam

- S = mm inches
- T = mm inches
- U = mm inches



Drawing inlet manifold ports, side of cylinder-head. Indicate scale or dimensions and manufacturing tolerance.

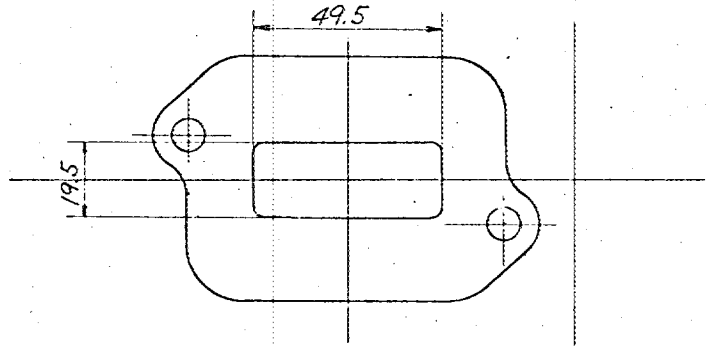

Drawing of entrance to inlet port of cylinder-head. Indicate scale or dimensions and manufacturing tolerance.

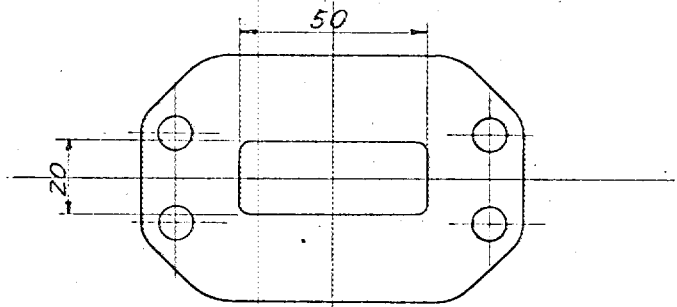

Drawing exhaust manifold ports, side of cylinder-head. Indicate scale or dimensions and manufacturing tolerance.

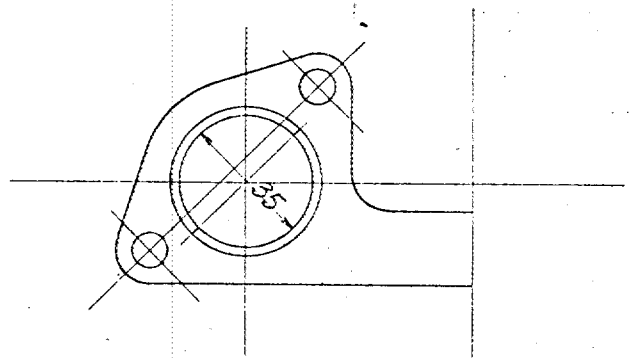

Drawing of exit to exhaust port of cylinderhead. Indicate scale or dimensions and manufacturing tolerance.

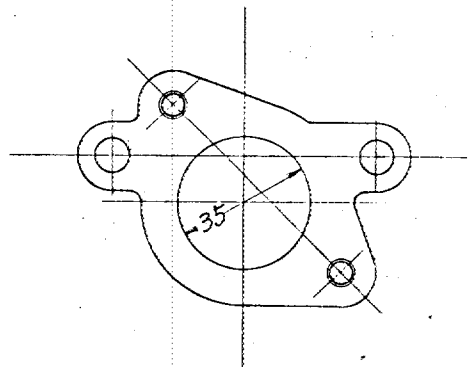

Unit : mm

Tolerance : ± 1.2 mm

Make **DAIHATSU KOGYO Co.,Ltd.** Model **L38.**

F. I. A. Rec. No.

DRIVE TRAIN

CLUTCH

260. Type of clutch **Dry, single plate.** 261. No. of plates **1.**
262. Dia. of clutch plates **15.0** cm inches
263. Dia. of linings, inside **11.0** cm in. outside **15.0** cm in.
264. Method of operating clutch **Mechanical.**

GEAR BOX (photograph H)

270. Manual type, make **DAIHATSU KOGYO Co.,Ltd** Method of operation **Mechanical.**
271. No. of gear-box ratios forward **4** 272. Synchronized forward ratios **1,2,3,4**
273. Location of gear-shift **Floor.**
274. Automatic, make type
275. No. of forward ratios 276. Location of gear-shift

277.	Manual		Automatic		Alternative manual/automatic			
	Ratio	No. teeth	Ratio	No. teeth	Ratio	No. teeth	Ratio	No. teeth
1	4.727	$\frac{52}{11}$						
2	2.823	$\frac{48}{17}$						
3	1.809	$\frac{38}{21}$						
4	1.269	$\frac{33}{26}$						
5								
6								
reverse	4.865	$\frac{22}{13} \times \frac{46}{16}$						

278. Overdrive, type
279. Forward gears on which overdrive can be selected
280. Overdrive ratio

FINAL DRIVE

290. Type of final drive **Helical gear.**
291. Type of differential **Bevel gear.**
292. Type of limited slip differential (if fitted)
293. Final drive ratio **4.450** , **5.056**
 Number of teeth $\frac{89}{20}$, $\frac{91}{18}$



Make DAIHATSU KOGYO Co., Ltd.

Model L38

F. I. A. Rec. No.

IMPORTANT- The conformity of the car with the following items of the present recognition form is to be disregarded during the scrutineering, when the vehicle has been entered in group 2 (Touring cars) or 3 (Grand Touring cars) : 41, 72, 80, 91, 142, 143, 144, 145, 146, 153, 156, 157, 160, 161, 162, 163, 164, 182, 184, 186, 187, 188, 189, 199, 201, 202, 203, 212, 213, 215, 216, 222, 225, 230, 250, 251, 252, 253, and photographs I, M, N, and page 8

During the scrutineering of cars entered in group 4 (Sportscars) only the following items of the present recognition form are to be taken into consideration : 1, 2, 3, 9, 20, 21, 22, 23, 24, 25, 26, 70, 71, 78, 79, 90, 130, 131, 132, 133, 134, 135, 136, 137, 138, 139, 140, 141, 147, 148, 149, 150, 158, 159, 170, 171, 172, 173, 185, 200, 270, 271, 274, 275, 290, 291, 292 and photographs A, B, D, E, F, G, H, J, K, and O.

Optional equipment affecting preceding information. This to be stated together with reference number.



Make DAIHATSU KOGYO Co.,Ltd.

Model L38.

F. I. A. Rec. No.

Photograph

B, 3/4 view of car from rear



C, interior view of car through driver's door (open or removed) with dashboard

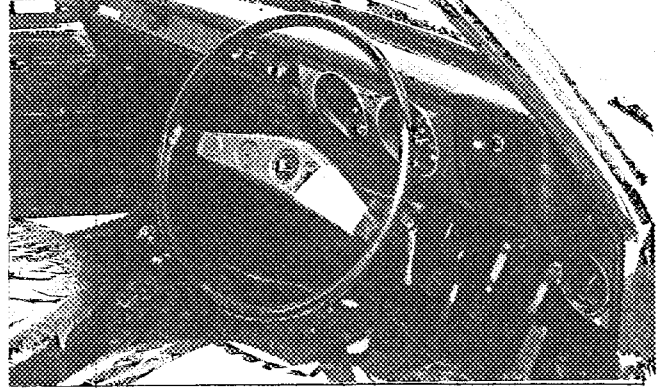

D, front axle complete, removed from car. Without wheels.

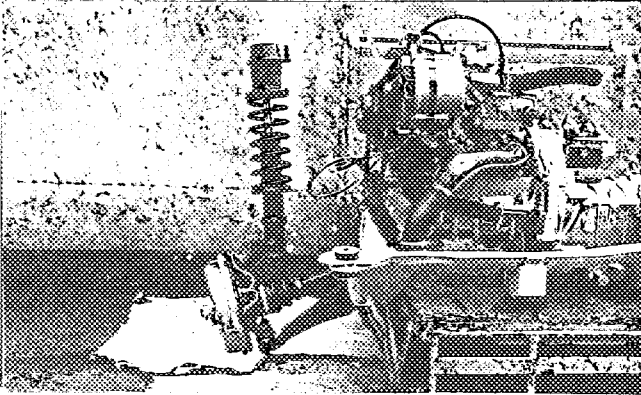

E, Rear axle complete without wheels, removed from car.

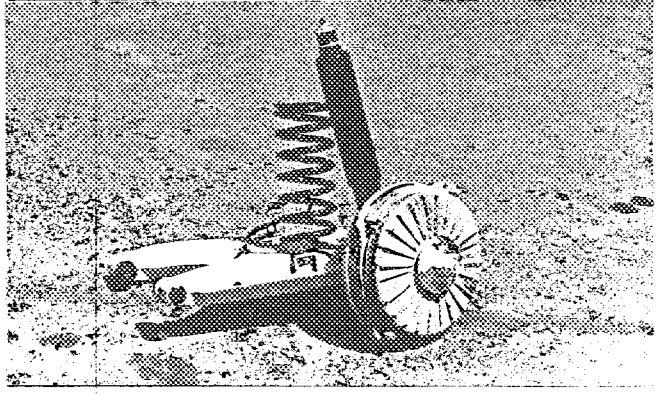

F, front brake, drum removed or disc with caliper(s)

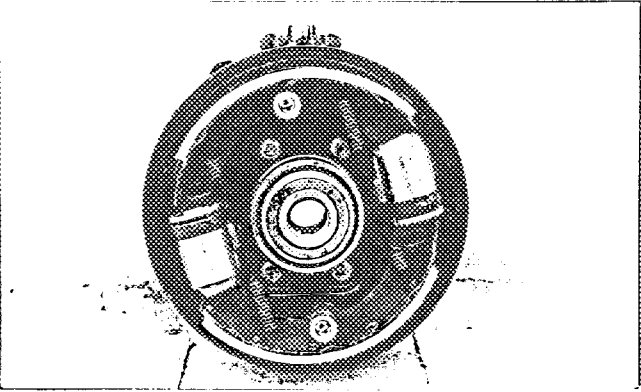

G, rear brake, drum removed or disc with caliper(s)

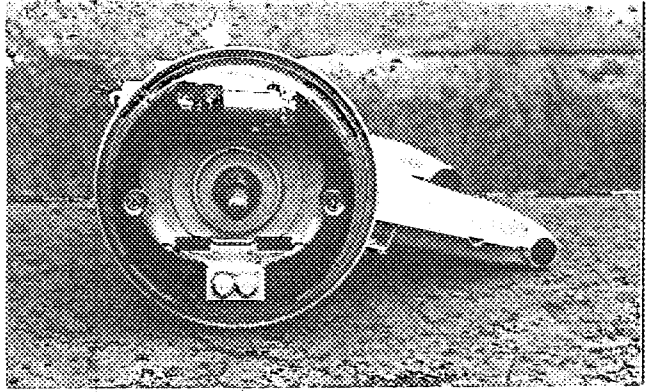

H, gear-box, view from side

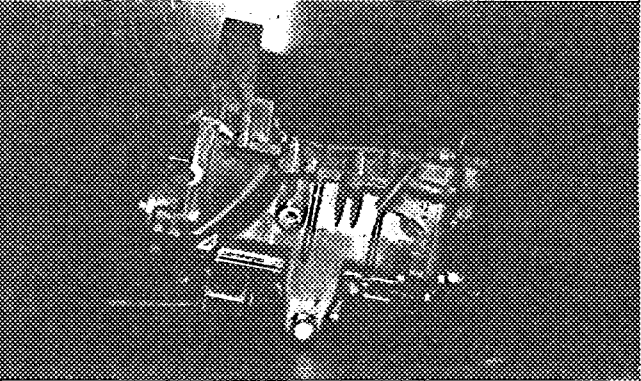

I, silencer + exhaust pipes after exhaust manifold.

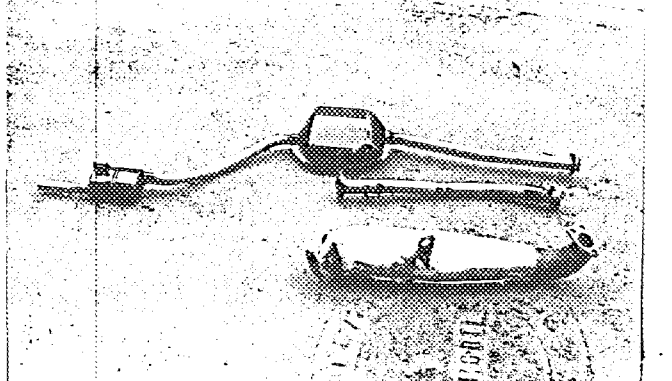

Make **DAIHATSU KOGYO Co., Ltd.** Photograph

Model **L38.**

F.I.A. Rec. No

engine unit out of car, from right. With clutch and accessories but without air filter nor gear-box.

Engine unit out of car, from left. With clutch and accessories but without gear-box nor air filter.

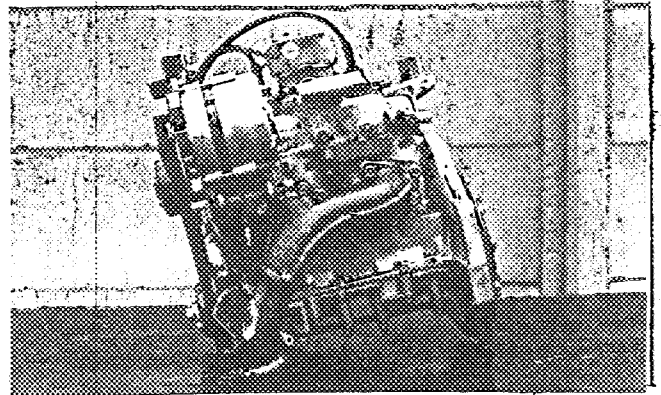
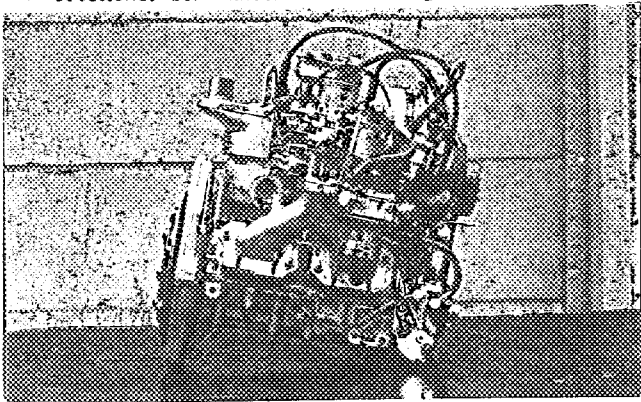

L, combustion chamber

M, piston crown

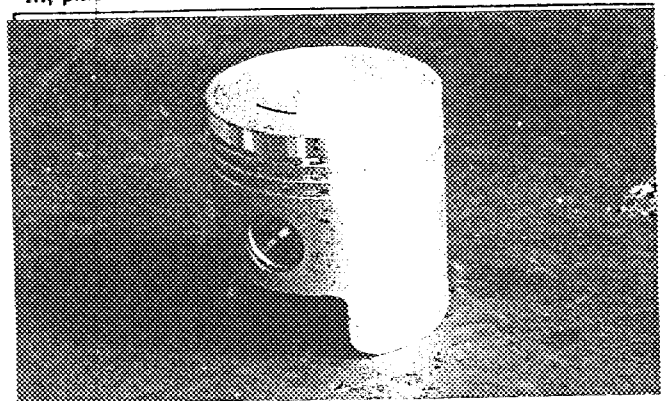
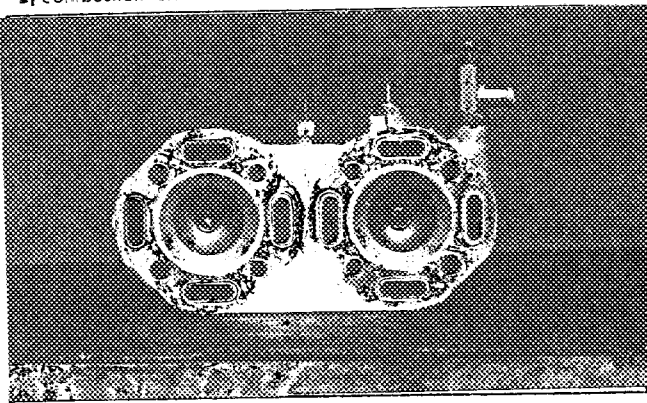

N, Carburettor (view from side of manifold)

O, engine in car with all accessories, bonnet open or removed.

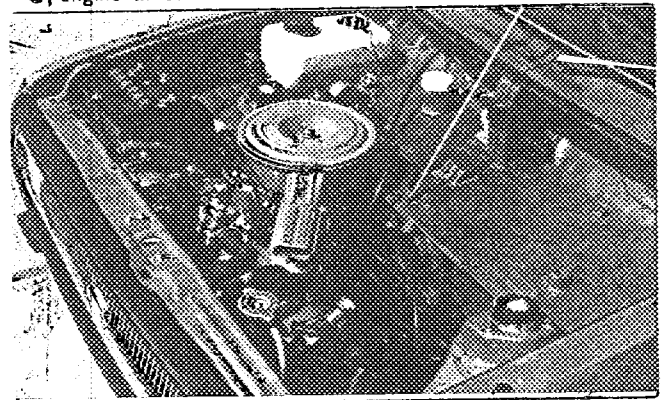
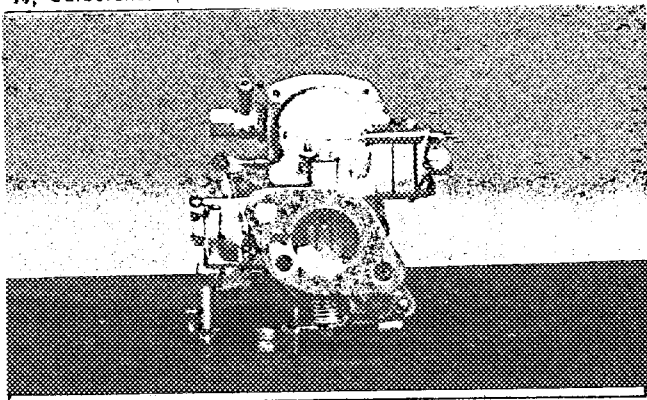

P, inlet manifold

Q, exhaust manifold

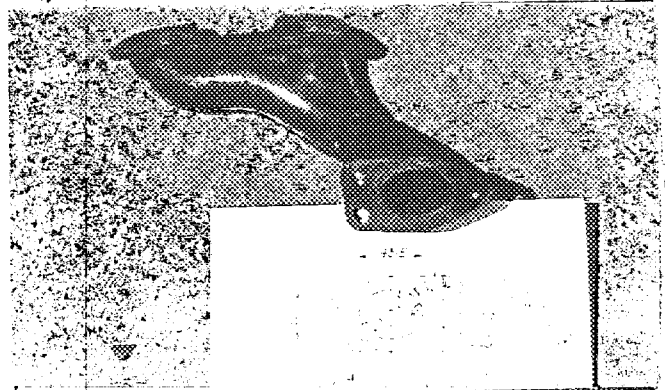
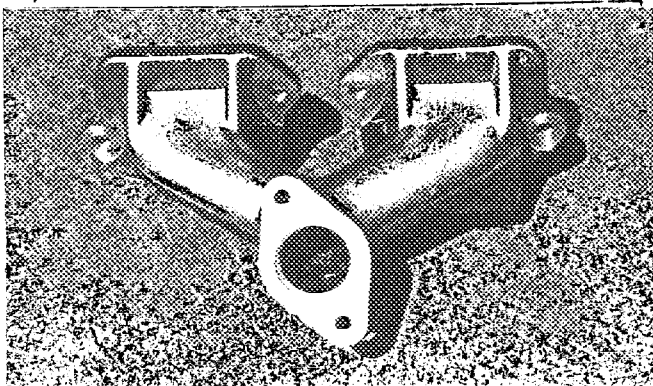

DIMENSIONS OF INTERIOR
(Conform to Art. 253 b of Appendix J)

For four seaters:

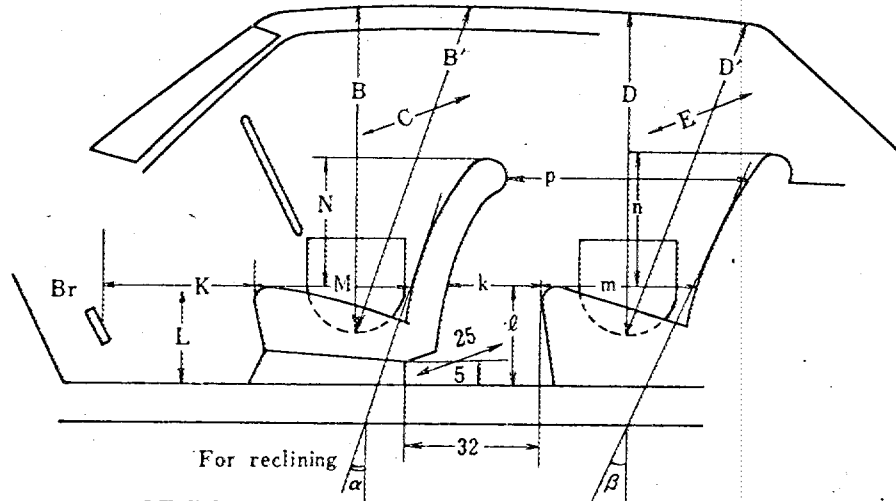

Minimum Dimensions (cm)							
B	B'	α	C	D	D'	β	E
94.5	100	18	115	94.5	95.5	22	115

Minimum Dimensions (cm)										
L	l	M	m	N	n	k+m	p	k	k+l+m	K+L+M
29.0	28.0	45.0	47.5	42.0	39.0	67.5	67.5	20.0	95.5	121.0
0.9L = 26.1		0.85M = 38.3		0.8N = 33.6		0.8(k+m) = 54.0		(15)	(95)	(120)

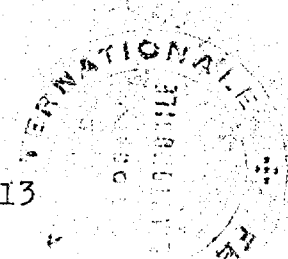

Make DAIHATSU KOGYO Co., Ltd.

Model L38.

F. I. A. Rec. No.

TWO STROKE ENGINES

300. System of cylinder scavenging	Crank-case scavenging.		
301. Type of lubrication	Forced.		
302. Inlet ports, length measured around cylinder wall		mm	inches
303. Height inlet port	mm	in. 304. Area	mm ² sq. in.
305. Exhaust ports, length measured around cylinder wall		43.5	mm inches
306. Height exhaust port	21.5 mm	in. 307. Area	880.4 mm ² sq. in.
308. Transfer port, length measured around cylinder wall		29.7	mm inches
309. Height transfer port	11.5 mm	in. 310. Area	304.3 mm ² sq. in.
311. Piston ports, length measured around piston			mm inches
312. Height piston port	mm	in. 313. Area	mm ² sq. in.
314. Method of precompression		315. Precompression cyl.:	mm /no
316. Bore	mm inches	317. Stroke	mm inches
318. Distance from top of cyl. block to highest point of exhaust port :		38	mm inches
319. Distance from top of cyl. block to lowest point of inlet port :			mm inches
320. Distance from top of cyl. block to highest point of transfer port :		40	mm inches
321. <u>Drawing of cylinder ports.</u>			

330. Supercharging—state full details hereafter :

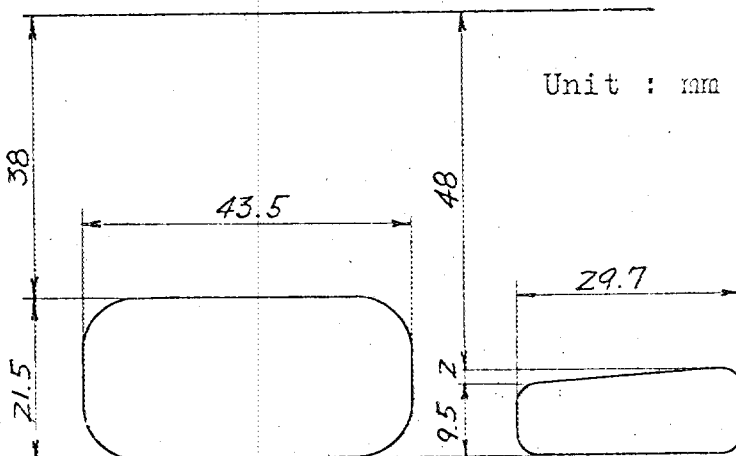

JAPAN AUTOMOBILE FEDERATION

難波靖治

Yasuharu Nanba

