

(Attention au
Corrigenda, dernière
page)

F.I.A. Recognition No. ⁵⁰¹⁶.....
Group..... 1... Tourisme de Série...

ROYAL AUTOMOBILE CLUB

31, Belgrave Square, London, S.W.1.

Form of recognition in accordance with
Appendix J to the International Sporting Code of the

FEDERATION INTERNATIONALE DE L'AUTOMOBILE

Rootes Group	Cylinder-capacity..875....cm ³ ..53.4...in ³
Manufacturer. Hillman Motor Car Co., Ltd.	Model.....Mark 2 Imp de luxe and Super. Imp
Serial No. of chassis. (B.41/2/000001... & B.44/2/000001	Manufacturer..Rootes.....
and engine.....	Manufacturer..Rootes.....
Recognition is valid from..1/1/1966	List.....

The manufacturing of the model described in this recognition form was started on 17th June.....1965 and the minimum production of..5,000.....identical cars, in accordance with the specifications of this form was reached on. 31st October 1965

Photograph A, $\frac{3}{4}$ view of car from front



F.I.A. Stamp

R.A.C. Stamp

Imp de luxe

FEDERATION INTERNATIONALE DE L'AUTOMOBILE

Page 1

Make

Hillman

Model

Imp

F.I.A. Rec.no. 5016

B



D

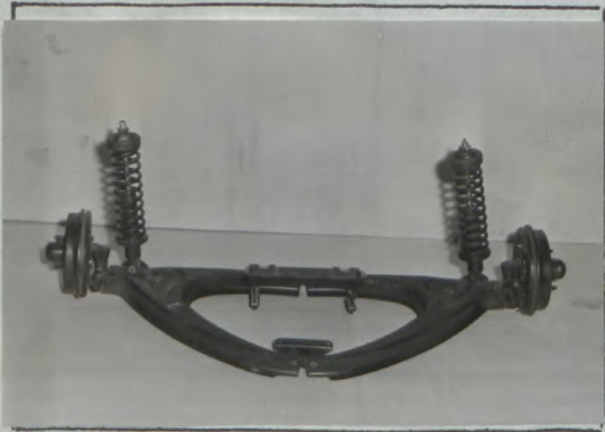

F

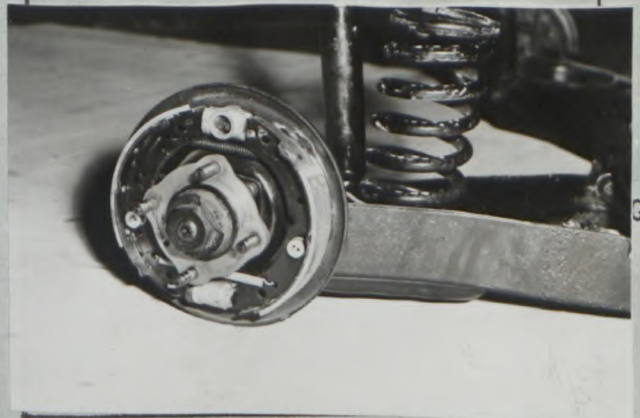
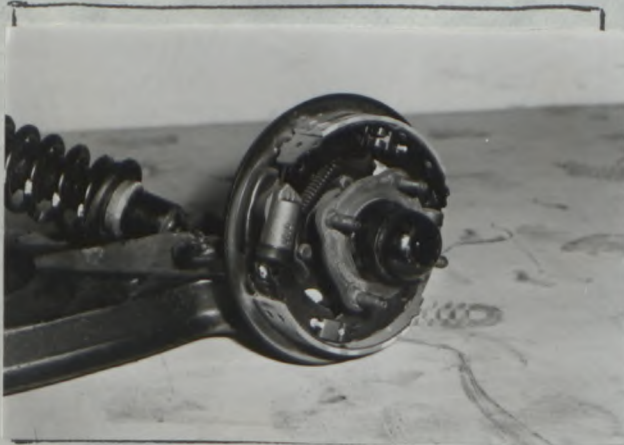

H

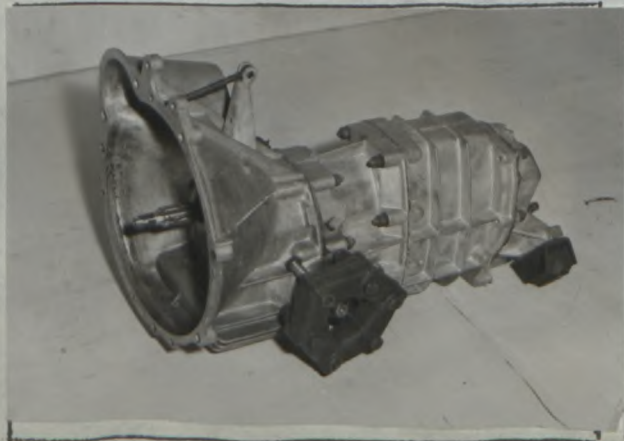

INTERNATIONAL
F.I.A. REC. NO. 5016

Make

Hillman

Model

Imp.

F.I.A. Rec.no. 5016

J

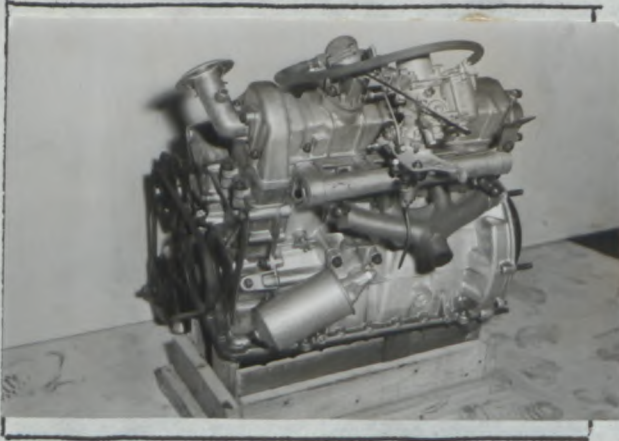

K

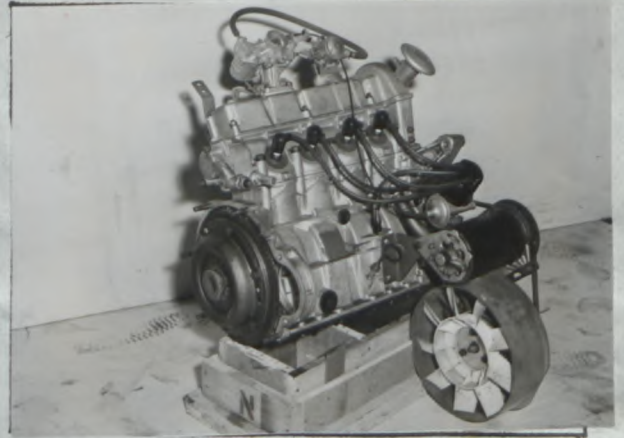

L

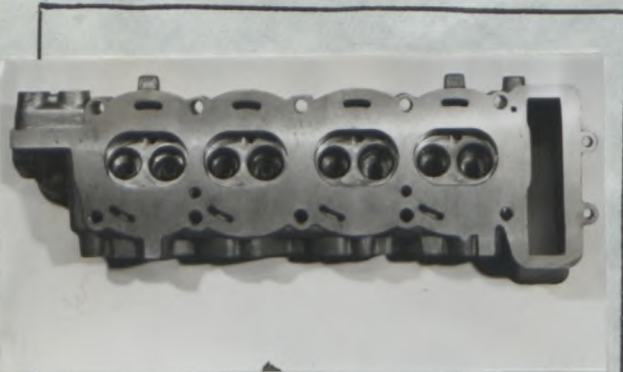

M



N



O

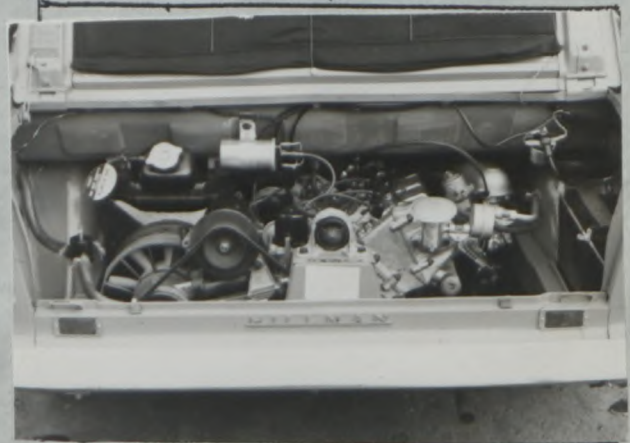

P

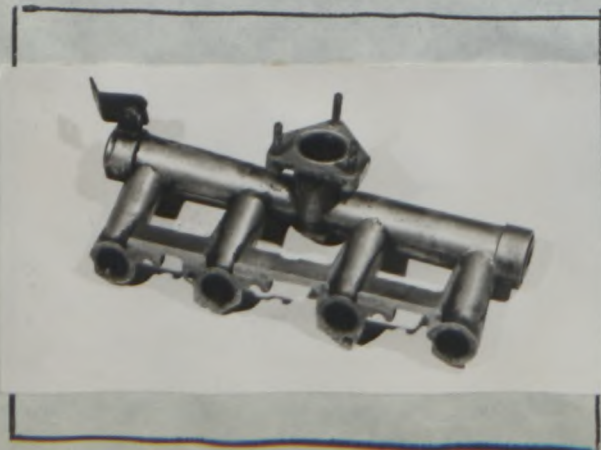

Q



Drawing inlet manifold ports, side of cylinder head. Indicate scale or dimensions and manufacturing tolerance.

Inlet manifold aluminium die casting Cast ports.

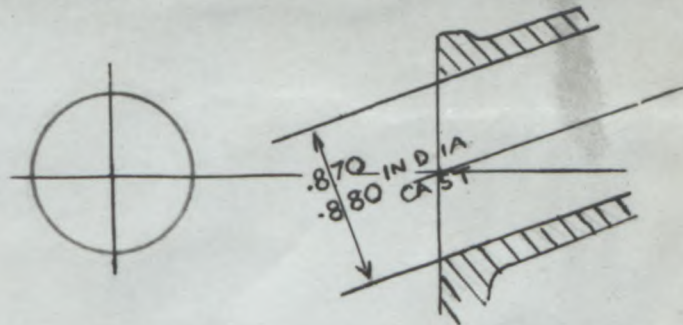

Drawing of entrance to inlet port of cylinder head. Indicate scale or dimensions and manufacturing tolerance.

Aluminium cylinder head, machined ports.

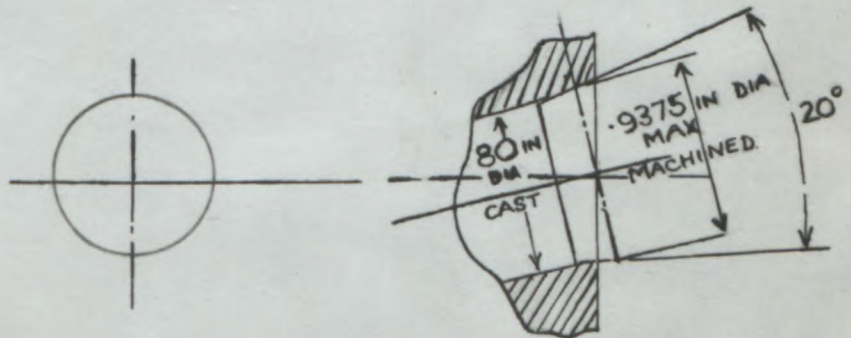

Drawing of exhaust manifold ports, side of cylinder head. Indicate scale or dimensions and manufacturing tolerance.

Exhaust manifold cast iron, cast ports.

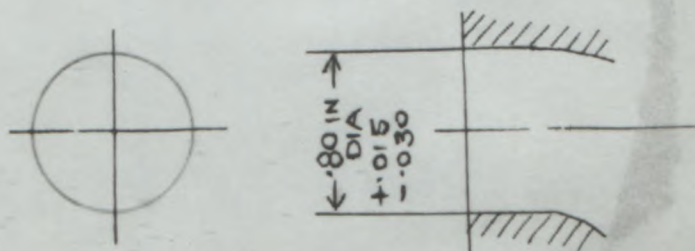

Drawing of exit to exhaust port of cylinder head. Indicate scale or dimensions and manufacturing tolerance.

Aluminium cylinder head machined.

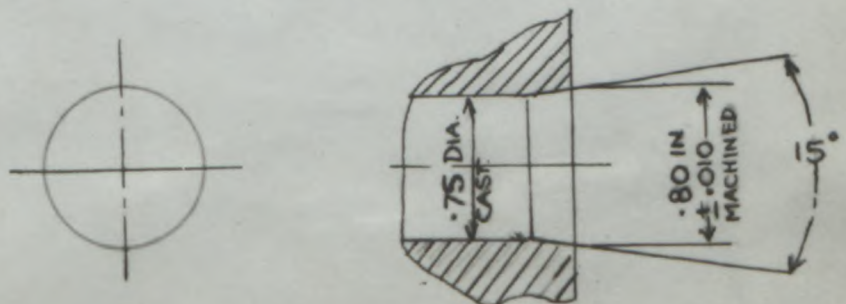

Make

Model

F.I.A. Rec.no. 5016

NOTE 1. All dimensions must be given in two measuring systems, see Note 3.

CAPACITIES AND DIMENSIONS.

- 1. Wheelbase 2032.8 mm. 82 ins.
- 2. Front track 1219.2 ± 12.7 mm. 48 ± 0.5 ins.
- 3. Rear track 1216.66 ± 12.7 mm. 47.9 ± 0.5 ins.

5a Front width = 59 1/2

5b. Rear width = 59

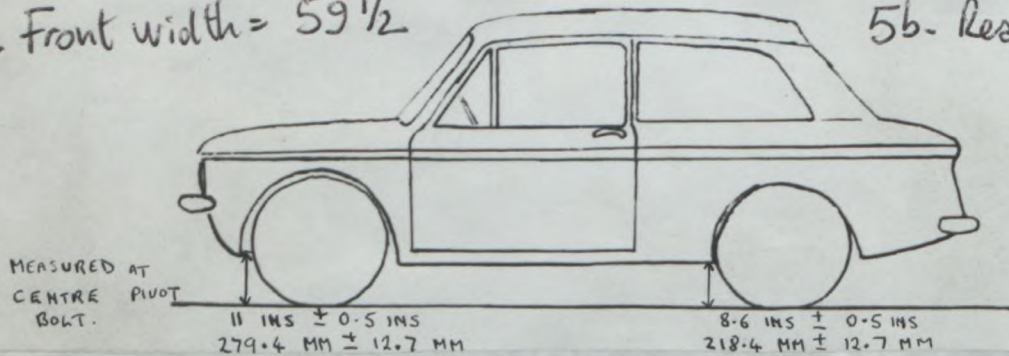

- 4. Overall length of the car 353.06 cm. 139 inches.
- 5. Overall width of the car 153.035 cm. 60.25 inches.
- 6. Overall height of the car 138.43 cm. 54.5 inches.
- 7. Capacity of fuel tank (reserve included)
27.276 ltrs. 7.2 Gall. US 6 Gall. Imp.
- 8. Seating Capacity. 4.
- 9. Weight, total weight of the car with normal equipment, water, oil, and spare wheel but without fuel or repair tools:
683.6 kg. 1507 lbs. 13.455 cwts.

NOTE 2. Differences in track caused by the use of other wheels with different rims widths must be stated when recognition is requested for the wheels concerned. Specify ground clearance in relation to the track and give drawing of two easily recognisable points at front and rear at which measurements are taken. These ground clearance dimensions are only for information when checking the track and can in no way affect the eligibility of the car.

No resulting increase in front or rear tracks caused by use of alternative magnesium alloy wheels.

NOTE 3. CONVERSION TABLE.

1 inch/pouce	- 2.54 cm.	1 quart US	- 0.9464 ltrs.
1 foot/pied	- 30.4794 cm.	1 pint (pt)	- 0.568 ltrs.
1 sq.inch/pouce carre	- 6.452 cm ² .	1 gallon Imp.	- 4.546 ltrs.
1 cubic inch/pouce cube	- 16.387 cm ³ .	1 gallon US	- 3.785 ltrs.
1 pound/livre (lb.)	- 453.593 gr.	1 hundred weight(cwt)	-50.802 kg.

SUSPENSION

- 70. Front suspension (photograph D), type Independent swing axle
- 71. Type of spring Coil
- 72. Stabiliser (if fitted) Nil
- 73. Number of shock absorbers 2 74. Type Telescopic
- 78. Rear suspension (photograph E), type Independent trailing arm.
- 79. Type of spring Coil
- 80. Stabiliser (if fitted) Nil
- 81. Number of shock absorbers 2 82. Type Telescopic

BRAKES (photographs F and G)

- 90. Method of operation Hydraulic
- 91. Servo-assistance (if fitted), type Nil
- 92. Number of hydraulic master cylinders 1

		FRONT	REAR
		2	1
93. Number of cylinders per wheel			
94. Bore of wheel cylinder(s)	17.78	mm. 0.7 inches	19.05 mm. 0.75 inches
Drum Brakes			
95. Inside diameter	203.2	mm. 8 inches	203.2 mm. 8 inches
96. Length of brake linings	159.5	mm. 6.28 inches	159.5 mm. 6.28 inches
97. Width of brake linings	38.1	mm. 1.5 inches	38.1 mm. 1.5 inches
98. Number of shoes per brake	2	mm. inches	2 mm. inches
99. Total area per brake	605.0	mm ² 218.8 sq.in.	605.0 mm ² 218.8 sq.in.
Disc Brakes Nil			
100. Outside diameter		mm. inches	mm. inches
101 Thickness of disc		mm. inches	mm. inches
102 Length of brake linings		mm. inches	mm. inches
103 Width of brake linings		mm. inches	mm. inches
104 Number of pads per brake			
105 Total area per brake		mm ² sq.in.	mm ² sq.in.



ENGINE (photographs J and K)

130. Cycles 4 131. Number of cylinders 4
132. Cylinder Arrangement In line. Inclined at 45°
133. Bore 68.0 mm. 2.677 in. 134. Stroke 60.375 mm. 2.377 in.
135. Capacity per cylinder 218.75 cm³ 13.35 cu.in.
136. Total cylinder capacity 875 cm³ 53.4 cu.in.
137. Material(s) of cylinder block Aluminium
138. Material(s) of sleeves (if fitted) Cast iron
139. Cylinder head, material(s) Aluminium Number fitted 1
140. Number of inlet ports 4 141. Number of exhaust ports 4
142. Compression ratio 10:1
143. Volume of one combustion chamber 20.33 cm³ 1.24 cu.in.
144. Piston, material Aluminium 145. Number of rings 3
146. Distance from gudgeon pin centre line to highest point of piston crown
 27.80) (1.055 in.
 27.67) mm. (1.050 in.
147. Crankshaft : ~~rounded~~ / Stamped 148. Type of crankshaft : integral/.....Yes.
149. Number of crankshaft main bearings 3
150. Material of bearing cap Aluminium
151. System of lubrication : ~~dry sump~~ / oil in sump
152. Capacity, lubricant 3.1 ltrs. 5.5 pts. 3.3 Quarts U.S.
153. Oil cooler : ~~yes~~ / no 154. Method of engine cooling Water
155. Capacity of cooling system 6.2 ltrs. 11 pts. 6.6 quarts U.S.
156. Cooling fan (if fitted) dia. 25.2 cm. 9.94 in.
157. Number of blades of cooling fan 9

Bearings

158. Crankshaft main, type Steel back lead Dia. 47.62 mm. 1.875 in.
 bronze
159. Connecting rod, big end lead indium over- Dia. 41.27 mm. 1.625 in.
 lay

Weights

160. Flywheel (clean) with starter ring 6.691 kg. 14.75 lbs.
161. Flywheel with clutch (all turning parts). 9.072 kg. 20 lbs.
162. Crankshaft 8.959 kg. 19.75 lbs. 163. Connecting rod kg. 1.07 lbs.
164. Piston with rings and pin 0.259 kg. 0.572 lbs.

FOUR STROKE ENGINES

170. Number of camshafts 1 171. Location Overhead
 172. Type of camshaft drive Roller Chain
 173. Type of valve operation Direct Tappet

INLET (see page 4)*

180. Material(s) of inlet manifold Aluminium
 181. Diameter of valves 30.582 mm. 1.204 ins.
 182. Max. valve lift 6.165 mm 0.2427 in. 183. Number of valve springs 1
 184. Type of spring Coil 185. Number of valves per cylinder 1
 186. Tappet clearance for checking timing (cold) .102 - .152 mm. 0.004 - .006 ins.
 187. Valves open at (with tolerance for tappet clearance indicated) 6° B.T.D.C.
 188. Valves close at (with tolerance for tappet clearance indicated) 46° A.B.D.C.
 189. Air filter, type Dry element

EXHAUST (see page 4)

195. Material(s) of exhaust manifold Cast iron
 196. Diameter of valves 27.036 mm. 1.066 ins.
 197. Max. valve lift 6.114 mm 0.2407 in. 198. Number of valve springs 1
 199. Type of spring Coil 200. Number of valves per cylinder 1
 201. Tappet clearance for checking timing (cold) 0.152 to 0.203 mm. 0.006 to 0.008 ins.
 202. Valves open at (with tolerance for tappet clearance indicated) 46° B.B.D.C.
 203. Valves close at (with tolerance for tappet clearance indicated) 6° A.B.D.C.

CARBURETION (photograph N)

210. Number of carburettors fitted 1 211. Type Semi - downdraught
 212. Make Solex 213. Model 30 P.I.H. 15
 214. Number of mixture passages per carburettor 4 circuits: Pilot, Pump, Main & Econostat
 215. Flange hole diameter of exit port(s) of carburettor 30 mm. 1.181 ins.
 216. Minimum diameter of venturi/~~minimum diameter of exit port(s) of carburettor~~ 22 mm. 0.866 ins.

INJECTION (if fitted) Nil

220. Make of pump 221. Number of plungers
 222. Model or type of pump 223. Total number of injectors
 224. Location of injectors
 225. Minimum diameter of inlet pipe mm. ins.

* For additional information concerning two-stroke engines and super-charged engines, see page 13.



ENGINE ACCESSORIES

- 230. Fuel pump : mechanical ~~and/or electric~~
- 231. No.fitted 1
- 232. Type of ignition system Coil
- 233. No.of distributors 1
- 234. No. of ignition coils 1
- 235. No. of spark plugs per cylinder 1
- 236. Generator, number fitted 1
- 237. Method of drive Belt
- 238. Voltage of generator 12 volts.
- 239. Battery, number 1
- 240. Location In engine compartment
- 241. Voltage of battery 12 volts

ENGINE AND CAR PERFORMANCES (as declared by manufacturer in catalogue)

- 250. Max. engine output 42 (type of horsepower: B.H.P.) at 5,000 rpm
- 251. Max. rpm 6,500 output at that figure not available for publication.
- 252. Max torque 55.6 at 2,800 rpm
- 253. Max speed of the car 128 km/hour 80 miles/hour

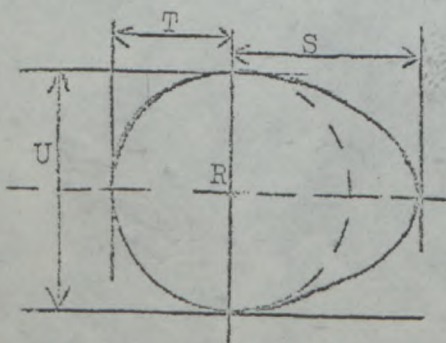

R = centre of camshaft.

Inlet cam

S =	17.950	mm.	0.7067	inches
T =	11.684	mm.	0.46	inches
U =	23.368	mm.	0.92	inches

Exhaust cam

S =	17.950	mm.	0.7067	inches
T =	11.684	mm.	0.46	inches
U =	23.368	mm.	0.92	inches



IMPORTANT - The conformity of the car with the following items of the present recognition form is to be disregarded during the scrutineering, when the vehicle has been entered in group 2 (Touring cars) or 3 (Grand Touring cars): 41, 72, 80, 91, 142, 143, 144, 145, 146, 153, 156, 157, 160, 161, 162, 163, 164, 182, 184, 186, 187, 188, 189, 199, 201, 202, 203, 212, 213, 215, 216, 222, 225, 230, 250, 251, 252, 253, and photographs I, M and N.

During the scrutineering of cars entered in group 4 (sportscars) only the following items of the present recognition form are to be taken into consideration: 1,2,3,9,20, 21, 22, 23, 24, 25, 26, 70, 71, 78, 79, 90, 130, 131, 132, 133, 134, 135, 136, 137, 138, 139, 140, 141, 147, 148, 149, 150, 158, 159, 170, 171, 172, 173, 185, 200, 270, 271, 274, 275, 290, 291, 292 and photographs A, B, D, E, F, G, H, J, K and O.

The vehicle described in this form has been subject to the following amendments:

on.....19.. rec.no.....List.....on.....19.. rec.no.....List.....
on.....19.. rec.no.....List.....on.....19.. rec.no.....List.....
on.....19.. rec.no.....List.....on.....19.. rec.no.....List.....
on.....19.. rec.no.....List.....on.....19.. rec.no.....List.....
on.....19.. rec.no.....List.....on.....19.. rec.no.....List.....

Optional equipment affecting preceding information. This to be stated together with reference number.

1. Wheels Part No. 7096101 → *Group 2 only* 
50. Type Magnesium Alloy ventilated
51. Weight (Per wheel, without tyre) 3.629 kgs. 8 lbs.
52. Method of Attachment 4 - Stud
53. Rim Diameter 305 mm. 12 in.
54. Rim width 127 mm. 5 in.

2. Title

The car in both "de-luxe" and "Super" forms is marketed under title "Sunbeam Imp" in U.S.A. and certain other export markets.

IMP11.

Federation Internationale de l'Automobile.
Supplement to Form of Recognition.

Manufacturer: Hillman Motor Car Co. Ltd. (Rootes Group).

Model: Hillman Imp Super Mark 11. (Variant of Imp de luxe Mark 11.)

Identical in every way with vehicle described in Imp de luxe Mark 11
Form of Recognition No. apart from minor differences in trim and
exterior mouldings.



Photograph A, 3/4 view of car from front.



Photograph B, 3/4 view of car from rear.



Photograph C, view of interior through drivers door.



FEDERATION INTERNATIONALE DE L'AUTOMOBILESupplement to Form of Recognition

Manufacturer: Rootes Group

Model: Hillman Mark 2 Imp de luxe and
Mark 2 Super Imp

Errata: The following information corrects and supercedes
that given in the Form of Recognition for this
Model:

42. Weight of front seat, complete with supports and rails out of the car
8.278 kg 18.25 lbs
44. Front bumper, weight 2.5 kg 5.5 lbs
45. Rear bumper, weight 2.324 kg 5.125 lbs.



tous Condition!
pas dépasser
carrosserie

5016 B/V
Valid: 1st May 1966

FEDERATION INTERNATIONALE DE L'AUTOMOBILE
SUPPLEMENT TO FORM OF RECOGNITION No.5016.

Manufacturer: Hillman Motor Car Co, Ltd. - Rootes Group.

Model: Imp Mk 2 de-luxe and Super Imp.

Schmid
Spencer
[Signature]

ERRATA.

The following information corrects and amends that contained in Form 5016

Brakes (Front and Rear)

99. Total area of brake: 12126 mm² 18.8 sq. ins.

OPTIONAL EQUIPMENT.

The following Optional Equipment is available for this car when used in Group 2 only.

1. Radiator Fan and Water Pump Wire Mesh Guard. Part No. 7103412
2. Alternator Pulley - Diameter 5 ins. Part No. 7100865.

[Signature]
FEDERATION INTERNATIONALE DE L'AUTOMOBILE
B. 2010120001



MOTOR SPORT DIVISION
The Royal Automobile Club,
31 Belgrave Square, London, S.W.1

Manufacturer Rootes Group
Hillman Mark 2 Imp de luxe
Modeland Super Imp
F.I.A. Recognition No. 5016 C/U
Amendment No. 5

Amendment to Form of Recognition

FEDERATION INTERNATIONALE DE L'AUTOMOBILE

No. Reference No.

OPTIONAL EQUIPMENT - GROUP 2

GEARBOX

270. Manual Type, make: Rootes. Method of operation: Manual
271. No. of gearbox ratios, forward: 4
272 Synchronised forward ratios: 4
273. Location of gear shift: Centre floor.
274 - Automatic, make and type: None
276

	Manual		Manual	
	Ratio	No. of teeth	Ratio	No. of teeth
1.	3.076	40 - 13	2.786	39 - 14
2.	1.831	33 - 18	1.631	31 - 19
3.	1.273	28 - 22	1.174	27 - 23
4.	0.923	24 - 26	0.923	24 - 26
Rev.	2.841	37 - 13	2.841	37 - 13

278 - Overdrive, etc. - None.
280

Date amendment is valid from

1st July 1967 list 16/4

*John Chown
Museum
Belgrave Square
London*



Stamp F.I.A. R.A.C.



MOTOR SPORT DIVISION
The Royal Automobile Club,
31 Belgrave Square, London, S.W.1

Manufacturer Rootes Group
Hillman Mark 2 Imp de Luxe
Model and Super Imp
F.I.A. Recognition No. 5016 CV
Amendment No. 6

Amendment to Form of Recognition

FEDERATION INTERNATIONALE DE L'AUTOMOBILE

No.

Reference No.

OPTIONAL EQUIPMENT - GROUP 2

Wheels

- | | |
|-----|---|
| 50. | Type: Magnesium Alloy Ventilated, Part No. 7103556 |
| 51. | Weight: (per wheel without tyre) 3.857 kgs. 8 lbs. 6 oz. |
| 52. | Method of attachment: 4 stud |
| 53. | Rim diameter: 305 mm. 12 ins. |
| 54. | Rim width: 141 mm. 5.5 ins. |
| | |
| 50. | Type: Magnesium Alloy Ventilated, Part No. 7103557 |
| 51. | Weight: (per wheel without tyre) 3.860 kgs. 8 lbs. 7 oz. |
| 52. | Method of attachment: 4 stud |
| 53. | Rim diameter: 305 mm. 12 ins. |
| 54. | Rim width: 152.5 mm. 6 ins. |
| | |
| 50. | Type: Magnesium Alloy Ventilated, Part No. 7103558 |
| 51. | Weight: (per wheel without tyre) 3.980 kgs. 8 lbs. 12 oz. |
| 52. | Method of attachment: 4 stud |
| 53. | Rim diameter: 330.2 mm. 13 ins. |
| 54. | Rim width: 114.3 mm. 4.5 ins. |

Date amendment is valid from

1st July 1967

Stamp of F.I.A./R.A.C.

John & Circa
Morgan
James
Steele





MOTOR SPORT DIVISION
 The Royal Automobile Club,
 31 Belgrave Square, London, S.W.1

Manufacturer Rootes Group
 Hillman Mark 2 Imp de Lux
 Model and Super Imp
 F.I.A. Recognition No. 5016
 Amendment No. 7

John B. Oliver
August
1967

Amendment to Form of Recognition

FEDERATION INTERNATIONALE DE L'AUTOMOBILE

No. | Reference No.

OPTIONAL EQUIPMENT - GROUP 2

- | | |
|-----|---|
| 50. | Type: Magnesium Alloy Ventilated, Part No. 7103415 |
| 51. | Weight: (per wheel without tyre) 4.08 kgs. 9 lbs. |
| 52. | Method of attachment: 4 stud |
| 53. | Rim diameter: 330.2 mm. 13 ins. |
| 54. | Rim width: 127 mm. 5 ins. |
| | |
| 50. | Type: Magnesium Alloy Ventilated, Part No. 7103416 |
| 51. | Weight: (per wheel without tyre) 4.660 kgs. 10 lbs. |
| 52. | Method of attachment: 4 stud |
| 53. | Rim diameter: 330.2 mm. 13 ins. |
| 54. | Rim width: 141 mm. 5.5 ins. |
| | |
| 50. | Type: Magnesium Alloy Ventilated, Part No. 7103417 |
| 51. | Weight: (per wheel without tyre) 4.730 kgs. 10 lbs. 6 oz. |
| 52. | Method of attachment: 4 stud |
| 53. | Rim diameter: 330.2 mm. 13 ins. |
| 54. | Rim width: 152.5 mm. 6 ins. |

Date amendment is valid from 1st July 1967



Stamp of F.I.A./R.A.C.



MOTOR SPORT DIVISION
 The Royal Automobile Club,
 31 Belgrave Square, London, S.W.1

Manufacturer Rootes Group
 Model Hillman Mark 2 Imp de luxe
and Super Imp
 F.I.A. Recognition No. 5016 *C/V*
 Amendment No. 8

Lead sheet - 2
ded!

Amendment to Form of Recognition

FEDERATION INTERNATIONALE DE L'AUTOMOBILE

No. Reference No. OPTIONAL EQUIPMENT - GROUP 2

- Radiator fan and water pump wire mesh stone guard, Part No. 7103412.



- Radiator protective wire mesh underguard fitted in certain export markets, Part No. 7102545.



155. Radiator of increased capacity, Part No. 710284 0/A
 7.67 litres 13.50 pints.
 Forward mounted radiator for tropical use, Part No. 7200678
 Increase in capacity of system: 0.99 litres 1.75 pints.

91. Girling Servo Assistance to brakes.

7. (i) Long range steel fuel tank, Part No. 7103359
 Capacity of fuel tank: 45 litres 12.009 gallons 10 gallons Imp
 (ii) Long range aluminium fuel tank, Part No. 7103359/ADE
 Capacity of fuel tank: 45 litres 12.009 gallons 10 gallons Imp

Date amendment is valid from 1st July, 1967

[Handwritten signature]

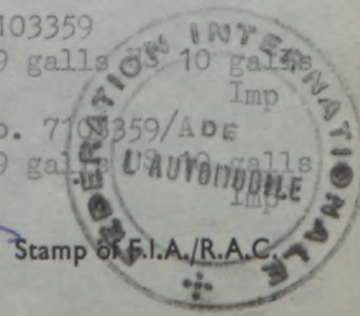



MOTOR SPORT DIVISION
 The Royal Automobile Club,
 31 Belgrave Square, London, S.W.1

Manufacturer Rootes Group
 Hillman Mark 2 Imp de luxe
 Model and Super Imp
 F.I.A. Recognition No. 5016 c/10
 Amendment No. 9

Amendment to Form of Recognition

FEDERATION INTERNATIONALE DE L'AUTOMOBILE

No. | Reference No.
 |
 | OPTIONAL EQUIPMENT - GROUP 2

[Handwritten signature]

Heavy duty sump guard, Part No. 7103420

Total length: 54.625 ins.
 138.7 cms.
 Length of tray: 21.25 ins.
 54 cms.
 Width of tray: 24.5 ins.
 62.4 cms.
 Depth: 3.6 ins.
 9 cms.
 Width, inner edge of bolt holes: 11.5 ins.
 29.2 cms.



Lightweight sump guard, Part No. 7103419

Length of tray: 21.125 ins.
 53.5 cms.
 Total length: 46 ins.
 116.8 cms.
 Max. width of tray: 18.125 ins.
 46.5 cms.
 Depth: 3.625 ins.
 9.1 cms.
 Width, inner edge of bolt holes: 12.125 ins.
 30.5 cms.

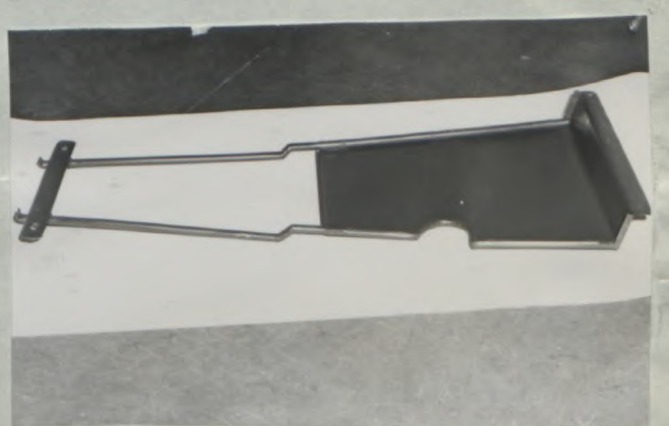

Date amendment is valid from 1st July 1967

[Handwritten signature]
 Stamp of F.I.A./R.A.C.
 INTERNATIONAL
 FEDERATION OF AUTOMOBILE CLUBS



MOTOR SPORT DIVISION
The Royal Automobile Club,
31 Belgrave Square, London, S.W.1

Manufacturer Rootes Group
Model Hillman Mark 2 Imp de luxe
and Super Imp
F.I.A. Recognition No. 5016
Amendment No. 16 1/ET

Amendment to Form of Recognition

FEDERATION INTERNATIONALE DE L'AUTOMOBILE

No. | Reference No.

EVOLUTIONARY CHANGE

Centre pivot point of the front suspension unit was lowered on cars from the following serial numbers of chassis:

Mark 2 Imp de luxe	B.41/2/018958
Super Imp	B.44/2/030361

resulting in an increase in the front track measurement as follows:

CAPACITIES AND DIMENSIONS

2. Front track: 1221.7 \pm 12.7 mm. 48.1 \pm 0.5 inches.

All other dimensions and specifications remain as listed in the Form of Recognition, 5016.

Date amendment is valid from 1st Nov 1967

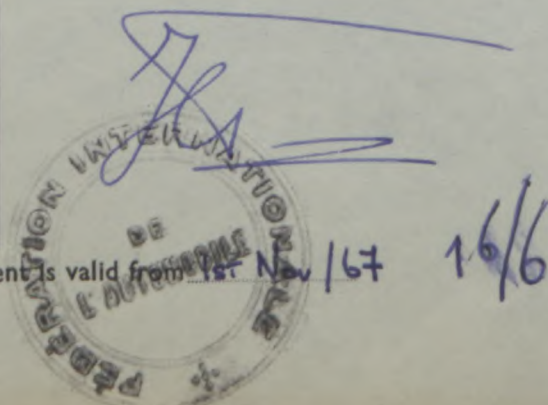

[Signature]
[Signature]
John F. Clwca
Stamp of F.I.A./R.A.C.



MOTOR SPORT DIVISION
The Royal Automobile Club,
31 Belgrave Square, London, S.W.1

Manufacturer Rootes Motors Ltd.

Model Imp de luxe.

F.I.A. Recognition No. 5016.

Amendment No. ~~40~~ 5/2E

(1)

Amendment to Form of Recognition

FEDERATION INTERNATIONALE DE L'AUTOMOBILE

No.

Reference No.

EVOLUTIONARY CHANGES

PHOTO A

$\frac{3}{4}$ front.



PHOTO B
 $\frac{3}{4}$ rear.

&

PHOTO C
interior.



Date amendment is valid from 1/1/70 - 70/4

[Handwritten signature]



Stamp of F.I.A./R.A.C.



MOTOR SPORT DIVISION
The Royal Automobile Club,
31 Belgrave Square, London, S.W.1

Manufacturer Rootes Motors Ltd.

Model Imp de luxe.

F.I.A. Recognition No. 5016.

Amendment No. 5/26

(2)

Amendment to Form of Recognition

FEDERATION INTERNATIONALE DE L'AUTOMOBILE

No.

Reference No.

EVOLUTIONARY CHANGES

2.	Front track :-	1245 ± 25 mm.	49 ± 1 in.
		The average for this figure is with the pivot bolts at a height of 10½ ins, 267 mm, above the ground.	
9.	Weight :-	674 kg.	1486 lbs. 13.25 cwts.
41.	Front seat type :-	Cushion frame.	
42.	Front seat weight :-	9.5 kg.	21 lbs.
43.	Rear seat type :-	Cushion frame.	
99.	Total area per brake :-	12.162 mm ² .	18.85 in ² .
187.	Inlet valve opens at :-	36° B.T.D.C.	
188.	Inlet valve closes at :-	76° A.B.D.C.	
201.	Tappet clearance :-	0.011 in.	0.280 mm.
202.	Exhaust valve opens at :-	43° B.B.D.C.	
203.	Exhaust valve closes at :-	3° A.T.D.C.	
277.	Number of teeth on 3rd gear :-	27 / 23.	

Date amendment is valid from 1/4/70 - 70/4





MOTOR SPORT DIVISION
The Royal Automobile Club,
31 Belgrave Square, London, S.W.1

Manufacturer Rootes Motors Ltd.

Model Imp Super.

F.I.A. Recognition No. 5016

Amendment No. 12.5/2

(3)

Amendment to Form of Recognition

FEDERATION INTERNATIONALE DE L'AUTOMOBILE

No.

Reference No.

EVOLUTIONARY CHANGES

PHOTO A
 $\frac{3}{4}$ front.



PHOTO B
 $\frac{3}{4}$ rear.



&

PHOTO C
interior.



9. Weight :- 689 kg. 1518 lbs. 13.55 cwts.

All other features of this car are identical to those of the
Imp de luxe, (69 model)

Date amendment is valid from 1/4/70 - 7/4

Stamp of F.I.A./R.A.C.
[Handwritten signature and circular stamp]



MOTOR SPORT DIVISION
The Royal Automobile Club,
31 Belgrave Square, London, S.W.1

Manufacturer Rootes Motors Ltd.

Model Imp Basic.

F.I.A. Recognition No. 5016.

Amendment No. B. 5/2E

(4)

Amendment to Form of Recognition

FEDERATION INTERNATIONALE DE L'AUTOMOBILE

No.

Reference No.

EVOLUTIONARY CHANGES

PHOTO A
 $\frac{3}{4}$ front.



PHOTO B
 $\frac{3}{4}$ rear.



&

PHOTO C
interior.



- 9. Weight :- 668 kg. 1478 lbs. 13.2 cwts.
- 38. No interior heating.
- 155. Capacity of cooling system :- 4.4 litres, 7.75 pints, 4.65 U.S. qu.

All other features of this car are identical to those of the Imp de luxe, (69 model).

Date amendment is valid from 4/1/70 - 30/4.

[Handwritten signature]

Stamp of F.I.A./R.A.C.



MOTOR SPORT DIVISION
The Royal Automobile Club,
31 Belgrave Square, London, S.W.1

Manufacturer Rootes Motors.

Model IMP

F.I.A. Recognition No. 5016

Amendment No. 1A 5/2E

(5)

Amendment to Form of Recognition

FEDERATION INTERNATIONALE DE L'AUTOMOBILE

No. Reference No. EVOLUTIONARY CHANGE

277. Alternative manual gear ratios, Group 1.

<u>Ratio.</u>	<u>Teeth.</u>	<u>Gear.</u>
3.076	40 / 13	1st.
1.831	33 / 18	2nd.
1.273	28 / 22	3rd.
0.923	24 / 26	4th.
2.841	37 / 13	Reverse.

This is the alternative gear ratio set for all cars from 1969 onwards.

Date amendment is valid from 1/4/70 - 20/4

[Handwritten signature]

Stamp of F.I.A./R.A.C.

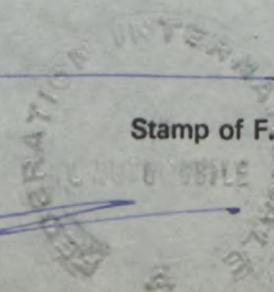



MOTOR SPORT DIVISION
The Royal Automobile Club,
31 Belgrave Square, London, S.W.1

Manufacturer Rootes Motors Ltd.

Model IMP

F.I.A. Recognition No. 5016

Amendment No. ~~1~~ 6/4V

GR II

Amendment to Form of Recognition

FEDERATION INTERNATIONALE DE L'AUTOMOBILE

No.

Reference No.

OPTIONAL EXTRAS (NOT VALID IN GROUP 1)

~~Modified Rear Bumper and Silencer Mountings. CTS 1057 - 2 off,
CTS 1053 - 2 off,~~

~~4. Overall length of car :- 359.5 cm, 141.6 in.~~



8 TUFTRIDED CRANKSHAFT, CTS 1005.

There is no change in dimensions or weight of this item.

* COMPETITION DRIVE SHAFT COUPLINGS, CTS 1104.

This is a stronger version of the original item, and it has 12 inserts instead of the normal 6 inserts.

Date amendment is valid from 14/70 - 70/4

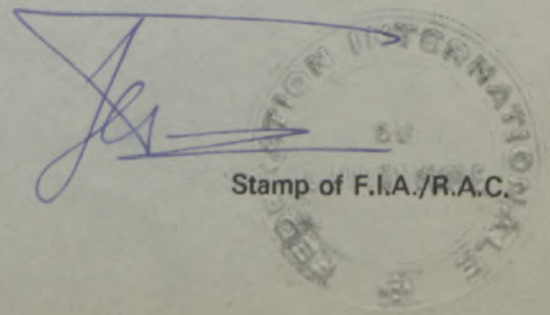

Stamp of F.I.A./R.A.C.



MOTOR SPORT DIVISION
The Royal Automobile Club,
31 Belgrave Square, London, S.W.1

Manufacturer Rootes Motors Ltd.

Model IMP

F.I.A. Recognition No. 5016

Amendment No. 7/5V

QR II

Amendment to Form of Recognition

FEDERATION INTERNATIONALE DE L'AUTOMOBILE

No.

Reference No.

OPTIONAL EXTRAS (Not valid in Group 1)

~~FIBREGLASS BONNET, GTS 1702.~~

~~FIBREGLASS BOOTLID, GTS 1701.~~

~~These parts do not change the appearance of the car in any way.~~

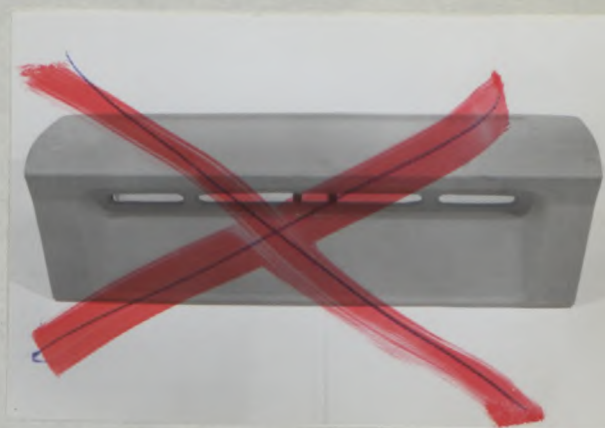
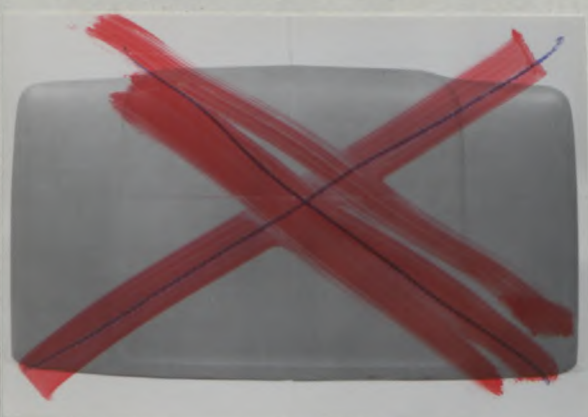

~~PLEXIGLASS WINDOWS, GTS 1703.~~

~~These are a direct replacement for the standard units.~~

Rallye DASHBOARD UNIT, GTS 1502/3/5/6/7.



[Handwritten signature]



Stamp of F.I.A./R.A.C.

Date amendment is valid from 1/4/70

70/4



MOTOR SPORT DIVISION
The Royal Automobile Club,
31 Belgrave Square, London, S.W.1

Manufacturer Rootes Motors Ltd.

Model JMP

F.I.A. Recognition No. 5016

Amendment No. 8/5V - 60 II

(1)

Amendment to Form of Recognition

FEDERATION INTERNATIONALE DE L'AUTOMOBILE

No.

Reference No.

OPTIONAL EXTRAS (Not valid in Group 1)

- SINTERED RACING CLUTCH, CTS 1063.
260. Diaphragm Clutch.
261. No of plates :- 1
262. Diameter of plate :- 18.4 cm. 7.25 in.
263. Lining diameter :- I.D. 13.3 cm. 5.25 in.
O.D. 18.4 cm. 7.25 in.
264. Hydraulic Operation.

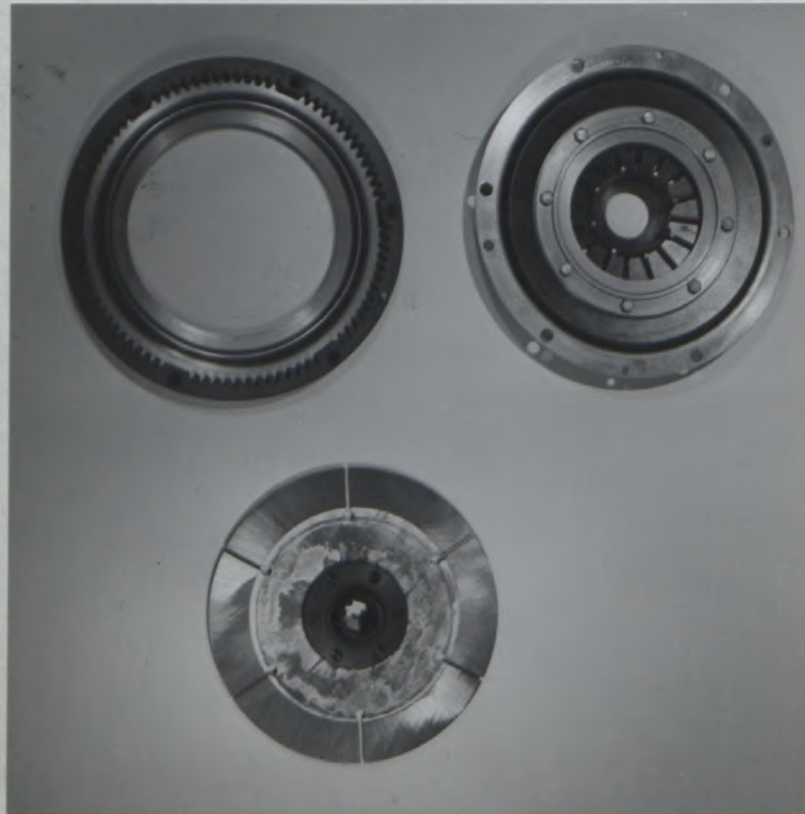

Date amendment is valid from 1/4/70 - 70/4

Stamp of F.I.A./R.A.C.





MOTOR SPORT DIVISION
The Royal Automobile Club,
31 Belgrave Square, London, S.W.1

Manufacturer Rootes Motors Ltd.

Model IMP

F.I.A. Recognition No. 5016

Amendment No. No 8/65

GRIF (1)

Amendment to Form of Recognition

FEDERATION INTERNATIONALE DE L'AUTOMOBILE

No. | Reference No. | OPTIONAL EXTRAS (Not valid for group 1)

FRONT WHEEL DISC BRAKE SET, CTS 1304.

94.	Bore of wheel cylinders :-	4.28 cm.	1.685 in.
100.	Outside diameter of disc :-	21.35 cm.	8.4 in.
101.	Thickness of disc :-	0.964 cm.	0.380 in.
102.	Length of pad lining :-	6.02 cm.	2.38 in.
103.	Width of pad lining :-	4.30 cm.	1.70 in.
104.	Number of pads per brake :-	2	
105.	Total area per brake :-	48 cm ² .	7.42 in ² .
2.	Front Track :- Increase of	3.5 cm.	1.4 in.



Date amendment is valid from 1/4/70

70/4



Stamp of F.I.A./R.A.C.



MOTOR SPORT DIVISION
The Royal Automobile Club,
31 Belgrave Square, London, S.W.1

Manufacturer Rootes Motors Ltd.

Model IMP

F.I.A. Recognition No. 5016

Amendment No. 19/7V-GR II

Amendment to Form of Recognition

FEDERATION INTERNATIONALE DE L'AUTOMOBILE

No.	Reference No.
	<u>OPTIONAL EXTRA (NOT VALID IN GROUP I.)</u>

WHEEL ARCH EXTENSIONS CTS/1704

These increase the width of the car by 5 cm. each side.

5. Overall width of the car 163.0 cm. 64.2"

WIRE MESH GRILLE CTS/1704

This replaces the rear panel of the engine cover.



Date amendment is valid from 1/4/70 - 70/4

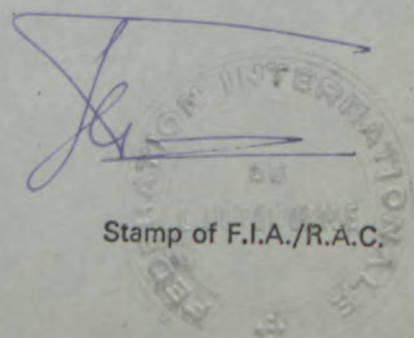

Stamp of F.I.A./R.A.C.