



JAPAN AUTOMOBILE FEDERATION

F. I. A. Recognition No.
Group 2

1496

FEDERATION INTERNATIONALE DE L'AUTOMOBILE

Form of recognition in accordance with
Appendix J to the International Sporting Code.



Manufacturer **SUZUKI MOTOR CO., LTD.**

Serial No of chassis **LC10-10001**

Serial No of engine **LC10-10001**

Recognition is valid from

The manufacturing of the model described in this recognition form was started on **MAR. 19 67** and the minimum production of **1.000** identical cars, in accordance with the specifications of this form was reached on **JUL. 19 67.**

Cylinder-capacity **356** cm³ **21.72** cu. in.

Model **SUZUKI FRONTEE 360 LC10(U)**

Manufacturer **SUZUKI**

Manufacturer **SUZUKI**

List

Photograph A, 3/4 view of car from front



The vehicle described in this form has been subject to the following amendments :

Variants

on	19	rec. No	List
on	19	rec. No	List
on	19	rec. No	List
on	19	rec. No	List
on	19	rec. No	List

Normal evolution of the type

on	19	rec. No.	List
on	19	rec. No	List
on	19	rec. No.	List
on	19	rec. No.	List
on	19	rec. No.	List

Stamp and signature of the
National Sporting Authority

Stamp and signature of the F. I. A.

11 11 1967



Make SUZUKI

Model LC10(U)

F.I.A. Rec. No.

IMPORTANT - the underlined items must be stated in two measuring systems, one of which must be the metric system. See conversion table hereafter.

CAPACITIES AND DIMENSIONS

1. <u>Wheelbase</u>	1,960	mm	77.2	inches
2. <u>Front track</u>	1,120	mm	44.1	inches *
3. <u>Rear track</u>	1,060	mm	41.7	inches *
4. Overall length of the car		299.5	cm	inches
5. Overall width of the car		129.5	cm	inches
6. Overall height of the car		133.0	cm	inches
7. <u>Capacity of fuel tank</u> (reserve included)				23 ltrs
	6.1	Gallon US		Gallon Imp.
8. Seating capacity	4			
9. <u>Weight</u> , total weight of the car with normal equipment, water, oil and spare wheel but without fuel nor repair tools:				
	405	kg	893	lbs cwt

* Differences in track caused by the use of other wheels with different rim widths must be stated when recognition is requested for the wheels concerned.

Specify ground clearance in relation to the track and give drawing of two fixed points of the vehicle's structure at which measurements are taken.

These ground clearance dimensions are only for information when checking the track and car in no way affect the eligibility of the car.

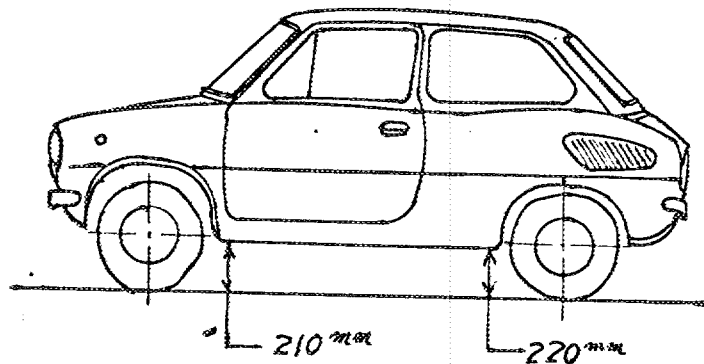

CONVERSION TABLE

1 inch/pouce	--	2.54 cm	1 quart US	--	0.9464 ltrs
1 foot/pied	--	30.4794 cm	1 pint (pt)	--	0.568 ltrs
1 square inch/pouce carré	--	6.452 cm ²	1 gallon Imp.	--	4.546 ltrs
1 cubic inch/pouce cube	--	16.387 cm ³	1 gallon US	--	3.785 ltrs
1 pound/livre (lb)	--	453.593 gr.	1 hundred weight (cwt)	--	50.802 kg

Make SUZUKI

Model LC10(U)

1496
F.I.A. Rec. No.

CHASSIS AND COACHWORK (Photographs A, B and C)

- 20. Chassis/body construction : ~~XXXX~~ / unitary construction
- 21. Unitary construction, material (s) **Steel**
Separate construction
- 22. Separate Constructions: Material(s) of chassis
- 23. Material (s) of coachwork
- 24. Number of doors **2** Material (s) **Steel**
- 25. Material (s) of bonnet **Steel**
- 26. Material (s) of boot lid **Steel**
- 27. Material (s) of rear-window **Glass**
- 28. Material (s) of windscreen **Glass**
- 29. Material (s) of front-door windows **Glass**
- 30. Material (s) of rear-door windows
- 31. Sliding system of door windows **Vertical, manual**
- 32. Material (s) of rear-quarter light **Glass**

ACCESSORIES AND UPHOLSTERY

- 38. Interior heating : yes - ~~XX~~
- 39. Air-conditioning : ~~XX~~ - no
- 40. Ventilation : yes - ~~XX~~
- 41. Front seats, type of seats and upholstery **Separate, vinyl**
- 42. Weight of front seat (s), complete with supports and rails, out of the car :
5.0 x 2 kg lbs
- 43. Rear seats, type of seats and upholstery **Bench, vinyl**
- 44. Front bumper, material (s) **Steel** Weight **1.4 kg** lbs
- 45. Rear bumper, material (s) **Steel** Weight **1.4 kg** lbs

WHEELS

- 50. Type **Pressed steel**
- 51. Weight (per wheel, without tyre) **2.4 kg** lbs
- 52. Method of attachment **Wheel nut** **(4 nuts)**
- 53. Rim diameter **254 mm** **10 inches**
- 54. Rim width **89 mm** **3.5 inches**

STEERING

- 60. Type **Rack-Pinion**
- 61. Servo-assistance : ~~XX~~ - no
- 62. Number of turns of steering wheel from lock to lock ***2.8**
- 63. In case of servo-assistance



Make SUZUKI

Model LC10(U)

1496

F. I. A. Rec. No

SUSPENSION

- 70. Front suspension (photogr. D), type Independent
- 71. Type of spring Coil
- 72. Stabiliser (if fitted) Torsion-bar
- 73. Number of shockabsorbers 2
- 74. Type Hydraulic, telescopic
- 78. Rear suspension (photogr. E), type Independent
- 79. Type of spring Coil
- 80. Stabiliser (if fitted)
- 81. Number of shockabsorbers 2
- 82. Type Hydraulic telescopic

BRAKES (photographs F and G)

- 90. System Hydraulic
- 91. Servo-assistance (if fitted), type
- 92. Number of hydraulic master cylinders 1

	FRONT		REAR	
93. Number of cylinders per wheel	2		1	
94. Bore of wheel cylinder (s)	22.2 mm	in.	22.2 mm	in.
Drum brakes				
95. Inside diameter	180 mm	in.	180 mm	in.
96. Length of brake linings	170 mm	in.	170 mm	in.
97. Width of brake linings	30 mm	in.	30 mm	in.
98. Number of shoes per brake	2		2	
99. Total area per brake	10,200 mm ²	sq. in.	10,200 mm ²	sq. in.
Disc brakes				
100. Outside diameter	mm	in.	mm	in.
101. Thickness of disc	mm	in.	mm	in.
102. Length of brake linings	mm	in.	mm	in.
103. Width of brake linings	mm	in.	mm	in.
104. Number of pads per brake				
105. Total area per brake	mm ²	sq. in.	mm ²	sq. in.

1496

Make SUZUKI

Model IC10(U)

F. I. A. Rec. No.

ENGINE (photographs J and K)

130. Cycle	2	131. Number of cylinders	3		
132. Cylinder arrangement	In line				
133. Bore	52 mm	2.04 in.	134. Stroke	56 mm	2.20 in.
135. Capacity per cylinder		118.9 cm ³		7.26 cu. in.	
136. Total cylinder-capacity		356 cm ³		21.72 cu. in.	
137. Material (s) of cylinder block	Cast iron				
138. Material (s) of sleeves (if fitted)					
139. Cylinder-head, material (s)	Al-alloy	Number fitted	3		
140. Number of inlet ports	3	141. Number of exhaust ports	3		
142. Compression ratio	6.8				
143. Volume of one combustion chamber		13.2 cm ³		cu. in.	
144. Piston, material	Al-alloy	145. Number of rings	2		
146. Distance from gudgeon pin centre line to highest point of piston crown	33 mm			inches	
147. Crankshaft	FRISCHG / stamped	148. Type of crankshaft	Integral / Assembled		
149. Number of crankshaft main bearings	7				
150. Material of bearing cap					
151. System of lubrication	dry sump / atmosphere				
152. Capacity, lubricant	4 ltrs			pts	quarts US
153. Oil cooler	YES / no	154. Method of engine cooling	Air		
155. Capacity of cooling system	ltrs			pints	quarts US
156. Cooling fan (if fitted), dia.	20 cm			inches	
157. Number of blades of cooling fan	30				
Bearings					
158. Crankshaft main, type	Ball	Dia.	25 mm		in.
159. Connecting rod big end,	Needle	Dia.	20 mm		in.
Weights					
160. Flywheel (clean)	1.55 kg			lbs	
161. Flywheel with clutch (all turning parts)			4.0 kg		lbs
162. Crankshaft	5.0 kg	lbs	163. Connecting rod	0.13 kg	lbs
164. Piston with rings and pin	0.14 kg			lbs	



Make SUZUKI

Model LC10 (U)

ENGINE ACCESSORIES

- | | | |
|---|--------------------------------------|---------------|
| 230. Fuel pump : mechanical and / electric | 231. No. fitted | 1 |
| 232. Type of ignition system Make and break ignition | 233. No. of distributors | 1 |
| 234. No. of ignition coils 1 | 235. No. of spark plugs per cylinder | 1 |
| 236. Generator, type: dynamo/ alternator number fitted | 237. Method of drive | Direct |
| 238. Voltage of generator | 12 | volts |
| 239. Battery, number | 1 | |
| 240. Location | Engine room | |
| 241. Voltage of battery | 12 | volts |

ENGINE AND CAR PERFORMANCES (as declared by manufacturer in catalogue)

- | | | | |
|-------------------------------|---|-----------------------|--------------|
| 250. Max. engine output | 25 PS (type of horsepower: JIS) at | 5,000 | rpm |
| 251. Maximum rpm | 7,000 | output at that figure | 19 PS |
| 252. Maximum torque | 3.7 kg-m | at 4,000 rpm | |
| 253. Maximum speed of the car | 110 | km/hour | miles / hour |

255.

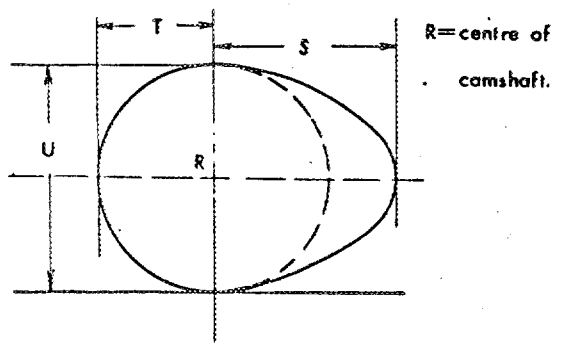

<u>Inlet cam</u>			
S =	mm		inches
T =	mm		inches
U =	mm		inches
<u>Exhaust cam</u>			
S =	mm		inches
T =	mm		inches
U =	mm		inches

Make **SUZUKI**

Model **IC10(U)**

1496
F. I. A. Rec. No.

Drawing inlet manifold ports, side of cylinder-head. Indicate scale or dimensions and manufacturing tolerance.

Unit. mm, ± 0.1

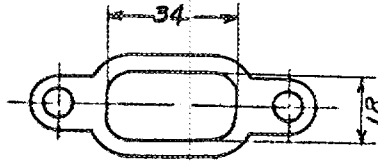

Drawing of entrance to inlet port of cylinder-head. Indicate scale or dimensions and manufacturing tolerance.

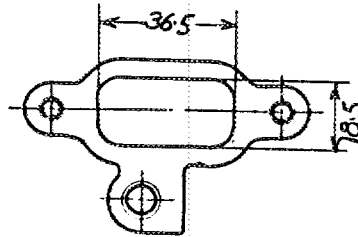

Drawing exhaust manifold ports, side of cylinder-head. Indicate scale or dimensions and manufacturing tolerance.

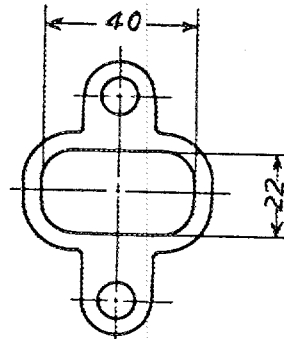

Drawing of exit to exhaust port of cylinderhead. Indicate scale or dimensions and manufacturing tolerance.

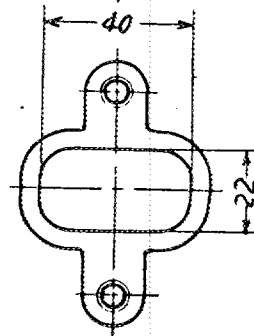

1
2
3
4
5
6
7
8
9
10
11
12
13
14
15
16
17
18
19
20
21
22
23
24
25
26
27
28
29
30
31
32
33
34
35
36
37
38
39
40
41
42
43
44
45
46
47
48
49
50
51
52
53
54
55
56
57
58
59
60
61
62
63
64
65
66
67
68
69
70
71
72
73
74
75
76
77
78
79
80
81
82
83
84
85
86
87
88
89
90
91
92
93
94
95
96
97
98
99
100

Make **SUZUKI**

Model **LC10(U)**

F. I. A. Rec. No.

DRIVE TRAIN

CLUTCH

260. Type of clutch **Dry single plate** 261. No. of plates **1**
262. Dia. of clutch plates **160** cm inches
263. Dia. of linings, inside **110** cm in. outside **160** cm in.
264. Method of operating clutch **Mechanical**

GEAR BOX (photograph H)

270. Manual type, make **SUZUKI** Method of operation **Mechanical**
271. No. of gear-box ratios forward **4** 272. Synchronized forward ratios **2, 3, 4.**
273. Location of gear-shift **Floor**
274. Automatic, make type
275. No. of forward ratios 276. location of gear-shift

277.	Manual			Automatic			Alternative manual/automatic					
	Ratio	No.	teeth	Ratio	No.	teeth	Ratio	No.	teeth	Ratio	No.	teeth
1	4.492	$\frac{48}{34}$	$\times \frac{35}{11}$									
2	2.647	$\frac{48}{34}$	$\times \frac{30}{16}$									
3	1.748	$\frac{48}{34}$	$\times \frac{26}{21}$									
4	1.242	$\frac{48}{34}$	$\times \frac{22}{25}$									
5												
6												
reverse	5.989	$\frac{48}{34}$	$\times \frac{20}{11} \times \frac{35}{15}$									

278. Overdrive, type
279. Forward gears on which overdrive can be selected
280. Overdrive ratio

FINAL DRIVE

290. Type of final drive **Bevel gear**
291. Type of differential **Bevel gear**
292. Type of limited slip differential (if fitted)
293. Final drive ratio **4.385**
- Number of teeth **57/13**

1496

Make SUZUKI

Model LC10(U)

F.I.A. Rec. No.

IMPORTANT: The conformity of the car with the following items of the present recognition form is to be disregarded during the scrutineering, when the vehicle has been entered in group 2 (Touring cars) or 3 (Grand Touring cars) : 41, 72, 80, 91, 142, 143, 144, 145, 146, 153, 156, 157, 160, 161, 162, 163, 164, 182, 184, 186, 187, 188, 189, 199, 201, 202, 203, 212, 213, 215, 216, 222, 225, 230, 250, 251, 252, 253, and photographs L, M and N.

During the scrutineering of cars entered in group 4 (Sportscars) only the following items of the present recognition form are to be taken into consideration : 1, 2, 3, 9, 20, 21, 22, 23, 24, 25, 26, 70, 71, 78, 79, 90, 130, 131, 132, 133, 134, 135, 136, 137, 138, 139, 140, 141, 147, 148, 149, 150, 158, 159, 170, 171, 172, 173, 185, 200, 270, 271, 274, 275, 290, 291, 292 and photographs A, B, D, E, F, G, H, J, K, and O.

Optional equipment affecting preceding information. This to be stated together with reference number.

* * *
* * *
* * *

Photograph

B. 3/4 view of car from rear

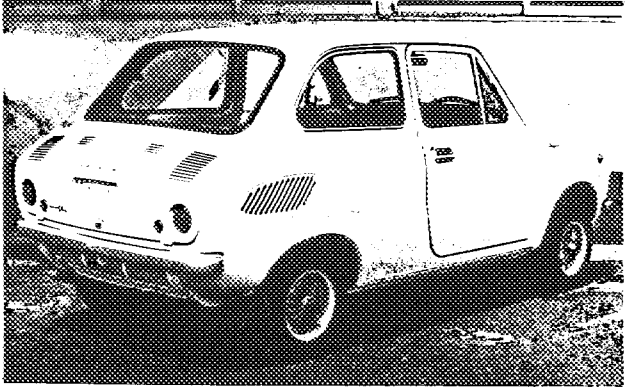

C. Interior view of car through driver's door window with door closed

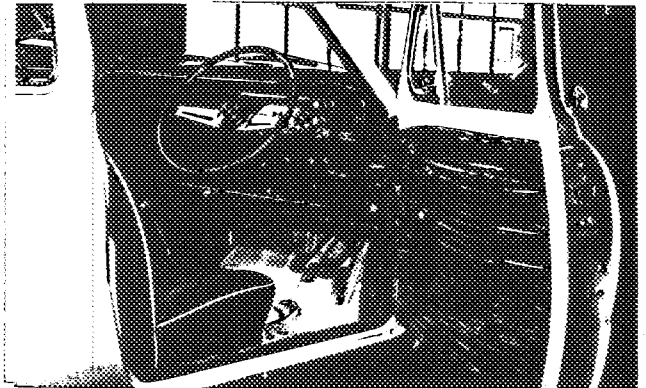

D. front axle complete, removed from car. Without wheels.

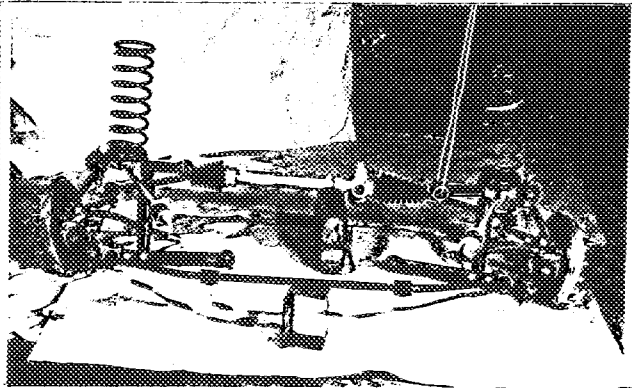

E. Rear axle complete without wheels, removed from car

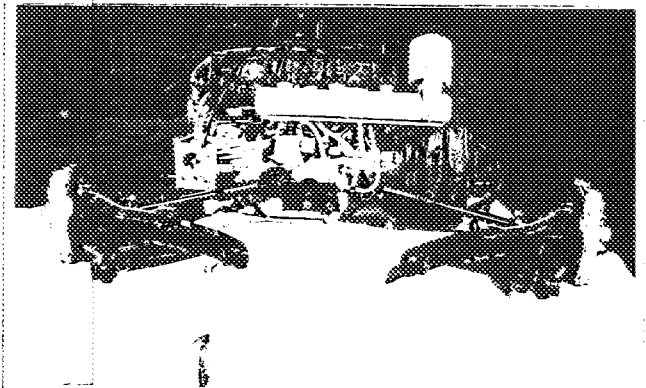

F. front brake, drum removed or disc with calipers

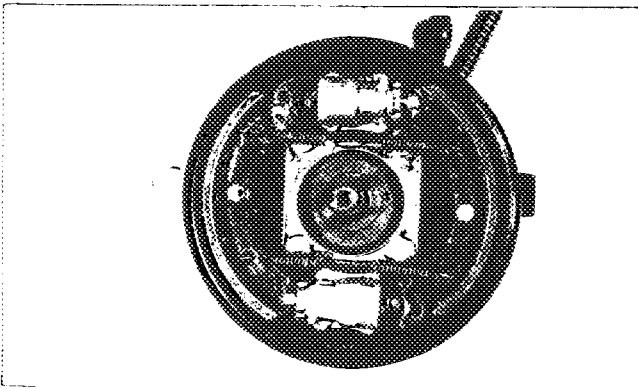

G. rear brake, drum removed or disc with calipers

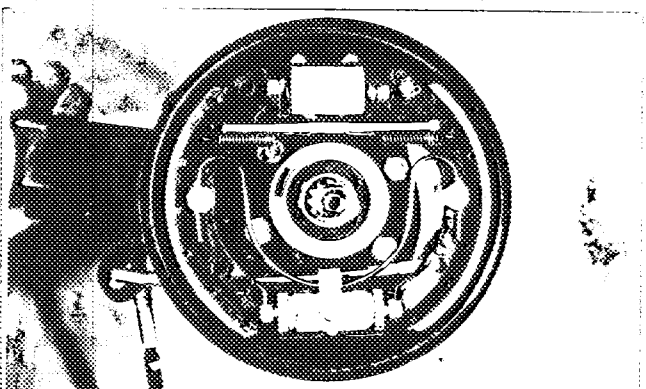

H. gear-box, view from side

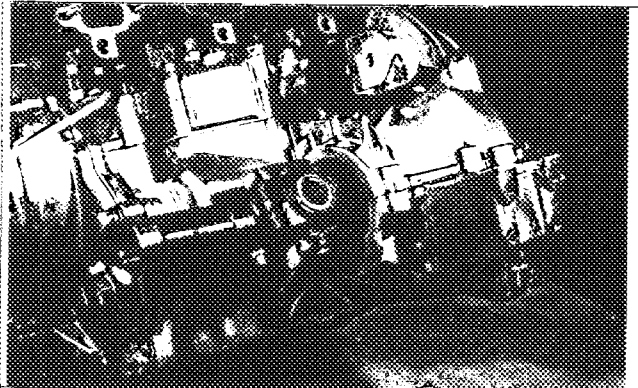

I. transfer & exhaust pipes after exhaust manifold

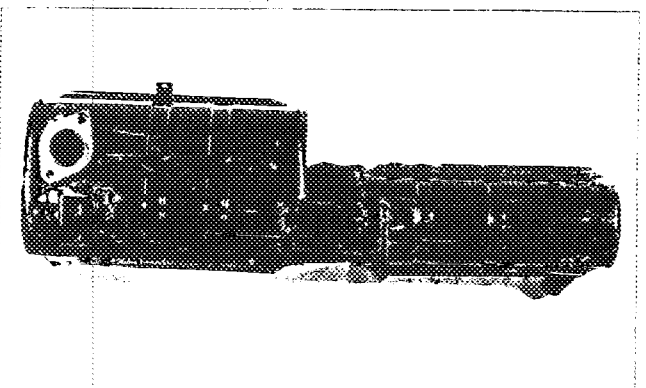

1496

Make SUZUKI

Photograph

Model 1000 (1)

F.I.A. Rec. 100

J, engine unit out of car, from right. With clutch and accessories but without air filter nor gear-box.

K, engine unit out of car, from left. With clutch and accessories but without gear-box nor air filter.

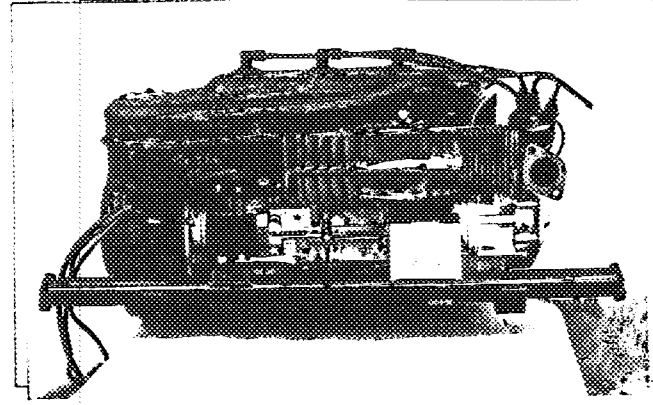
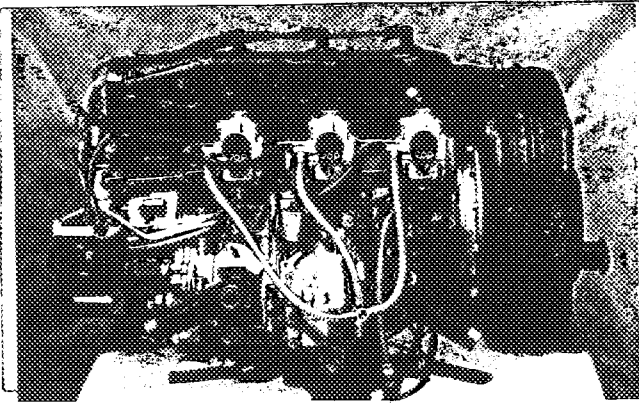

L, combustion chamber

M, piston crown

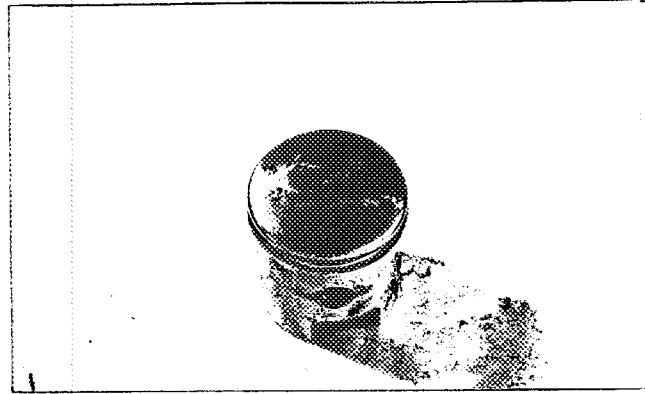
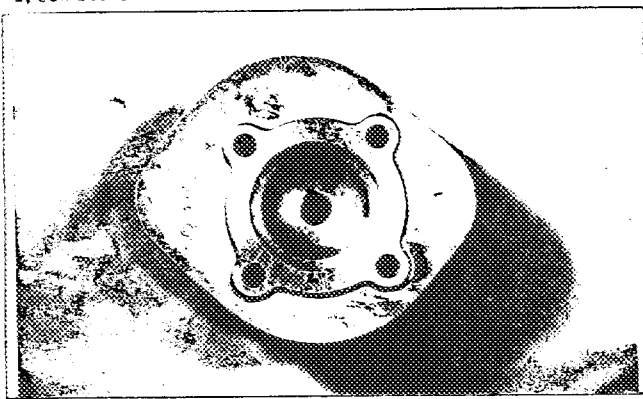

N, Carburettor (view from side of manifold)

O, engine in car with all accessories, bonnet open or removed

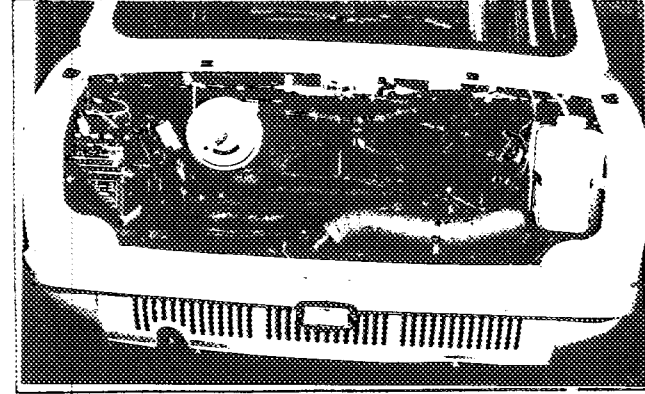
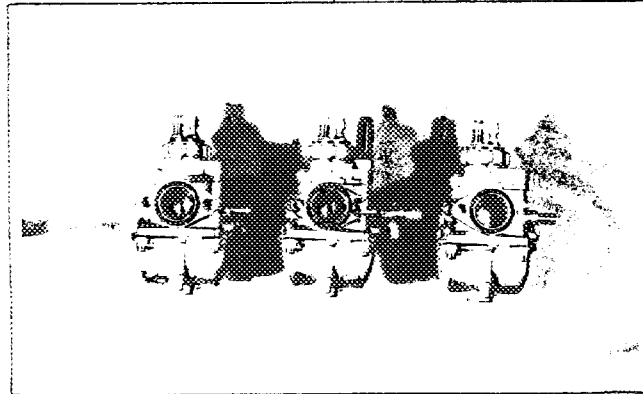

P, inlet manifold

Q, exhaust manifold

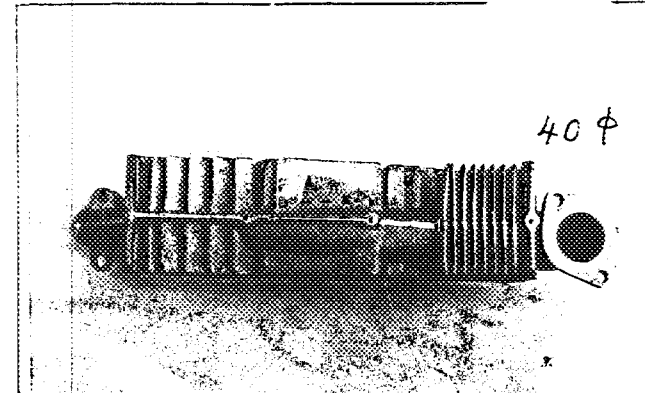
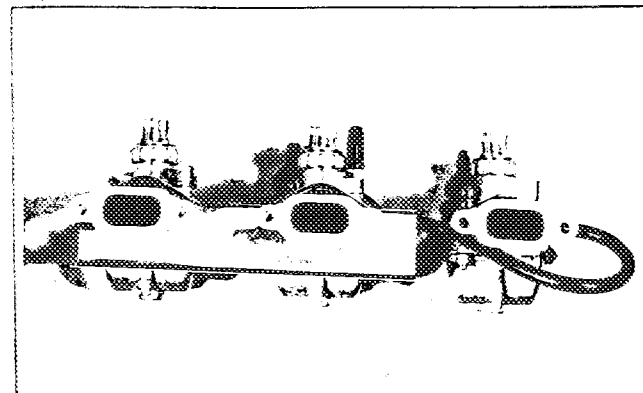

1496

Make SUZUKI

Model LC10(U)

F. I. A. Rec. No.

TWO STROKE ENGINES

300. System of cylinder scavenging	Crank case scavenging		
301. Type of lubrication	Forced		
302. Inlet ports, length measured around cylinder wall	35	mm	inches
303. Height inlet port	14.5	mm	in.
304. Area	422.4	mm ²	sq. in.
305. Exhaust ports, length measured around cylinder wall	30	mm	inches
306. Height exhaust port	17.5	mm	in.
307. Area	474.5	mm ²	sq. in.
308. Transfer port, length measured around cylinder wall	21	mm	inches
309. Height transfer port	11	mm	in.
310. Area	227.6	mm ²	sq. in.
311. Piston ports, length measured around piston		mm	inches
312. Height piston port		mm	in.
313. Area		mm ²	sq. in.
314. Method of precompression	315. Precompression cyl.: 3/8 /no		
316. Bore	mm	inches	317. Stroke
318. Distance from top of cyl. block to highest point of exhaust port :	38	mm	inches
319. Distance from top of cyl. block to lowest point of inlet port :	79	mm	inches
320. Distance from top of cyl. block to highest point of transfer port :	45.5	mm	inches
321. Drawing of cylinder ports.			

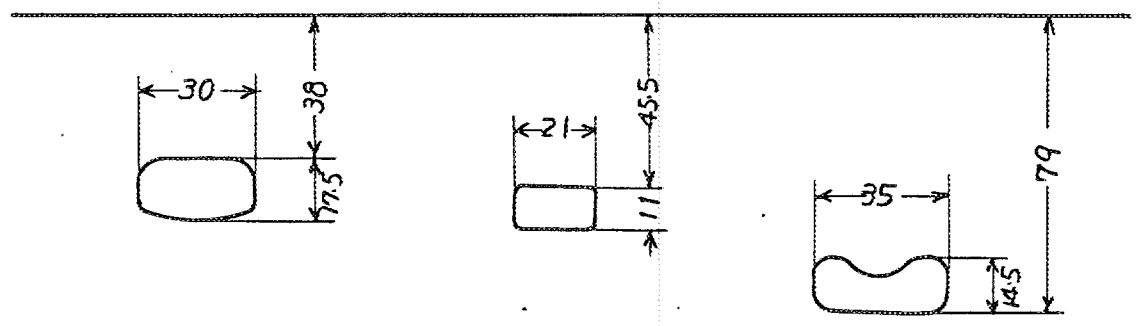

330. Supercharging—state full details hereafter :

JAPAN AUTOMOBILE FEDERATION

[Handwritten signature]

Kazunari Komotori

Make SUZUKI

Model LC10(U) 1496

DIMENSIONS OF INTERIOR
(Conform to Art. 253 b of Appendix J)

For four seaters :

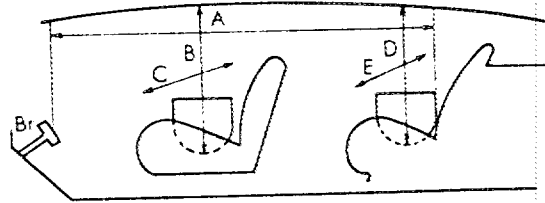

Minimum		Dimensions		
A	B	C	D	E
151 cm	93 cm	109 cm	91 cm	103 cm

For two seaters :

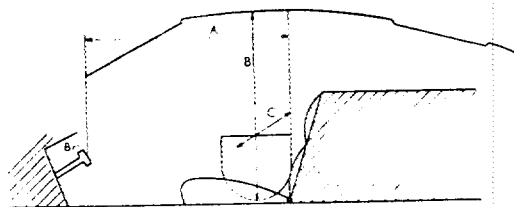

Minimum		Dimensions
A	B	C
cm	cm	cm