



JAPAN AUTOMOBILE FEDERATION

F. I. A. Recognition No 1429
Group 2i Touring

FEDERATION INTERNATIONALE DE L'AUTOMOBILE

Form of recognition in accordance with
Appendix J to the International Sporting Code.

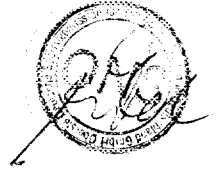

Manufacturer	NISSAN MOTOR CO., LTD.	Cylinder-capacity	1,595	cm ³	97.33	inches
Serial No of chassis	R411-000101	Model	R411			
Serial No of engine	R-000762	Manufacturer	NISSAN			
Recognition is valid from		Manufacturer	NISSAN			
		List				

The manufacturing of the model described in this recognition form was started on **June** 1965 and the minimum production of **1,000** identical cars, in accordance with the specifications of this form was reached on **Oct.** 1965

Photograph A, 3/4 view of car from front



The vehicle described in this form has been subject to the following amendments :

<u>Variants</u>				<u>Normal evolution of the type</u>			
on	19	rec. No	List	on	19	rec. No	List
on	19	rec. No	List	on	19	rec. No	List
on	19	rec. No	List	on	19	rec. No	List
on	19	rec. No	List	on	19	rec. No	List
on	19	rec. No	List	on	19	rec. No	List

Stamp and signature of the
National Sporting Authority

Stamp and signature of the F. I. A.

B 3/4 view of car from rear



C interior view of car through driver's door (open or removed)

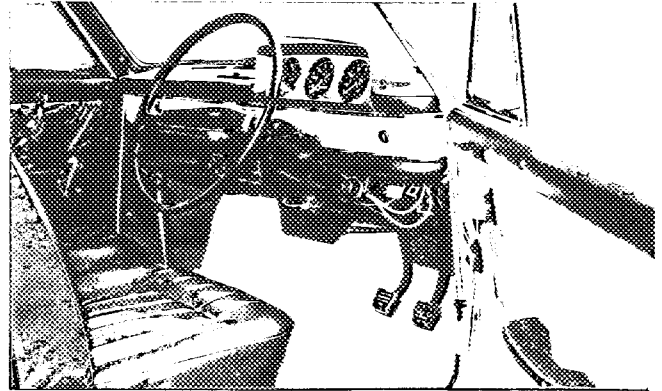

D front axle complete, removed from car. Without wheels.

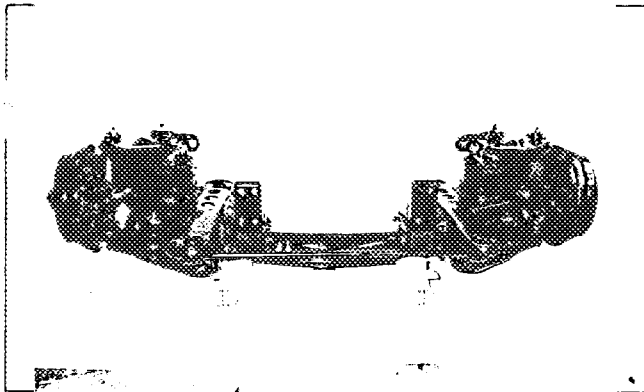

E Rear axle complete without wheels, removed from car.

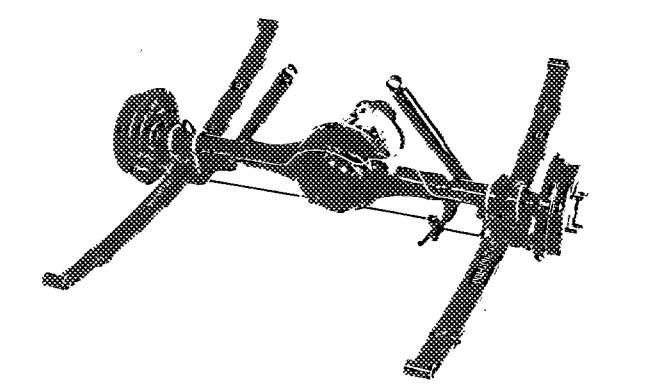

F front brake, drum removed

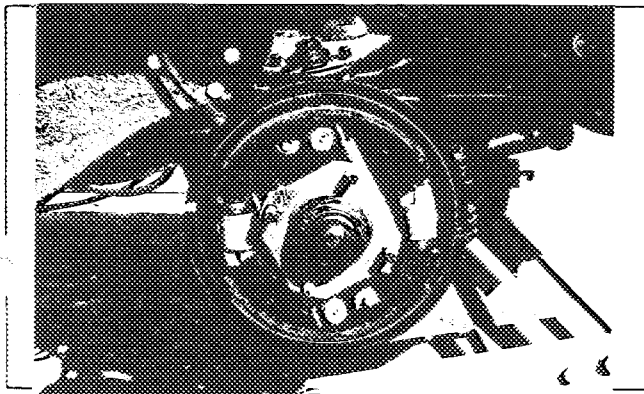

G rear brake, drum removed

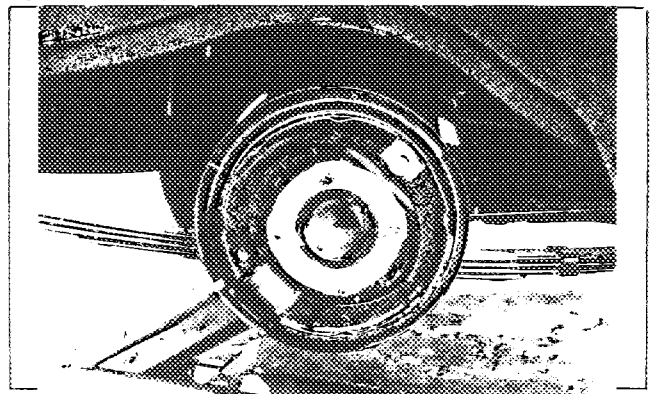

H gear-box, view from side

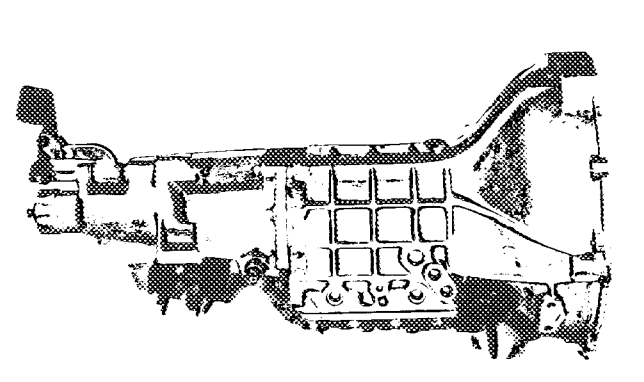

I silencer + exhaust pipes after exhaust manifold.

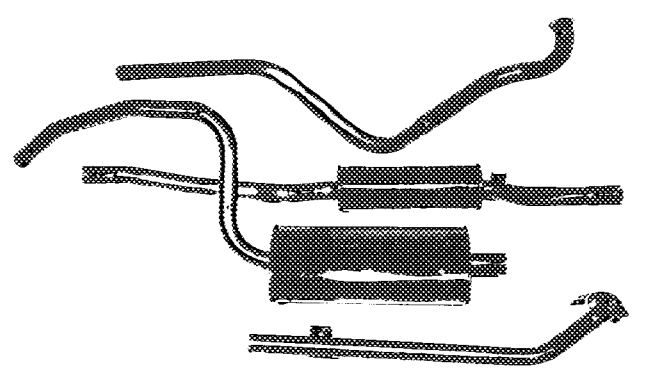

1429

Make NISSAN

Model R411

F. I. A. Rec. No

J engine unit out of car, from right. With clutch and accessories but without air filter nor gear-box.

K Engine unit out of car, from left. With clutch and accessories but without gear-box nor air filter.

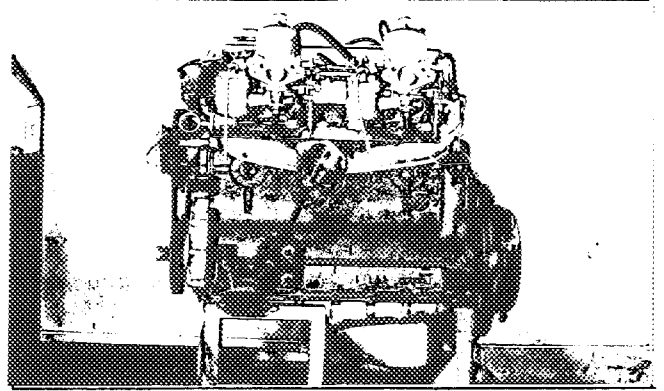
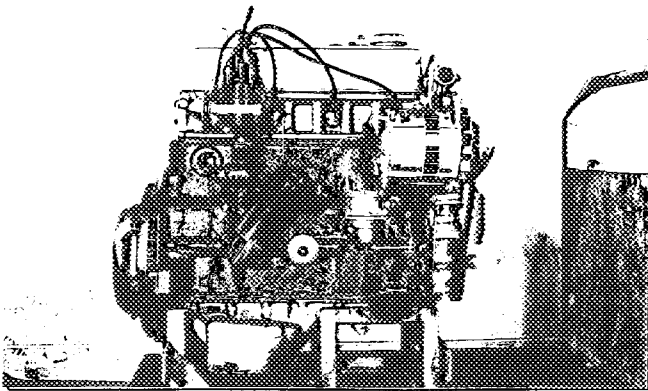

L combustion chamber

M piston crown

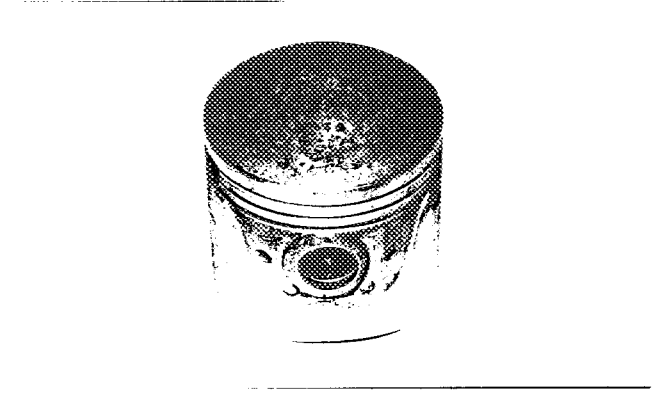
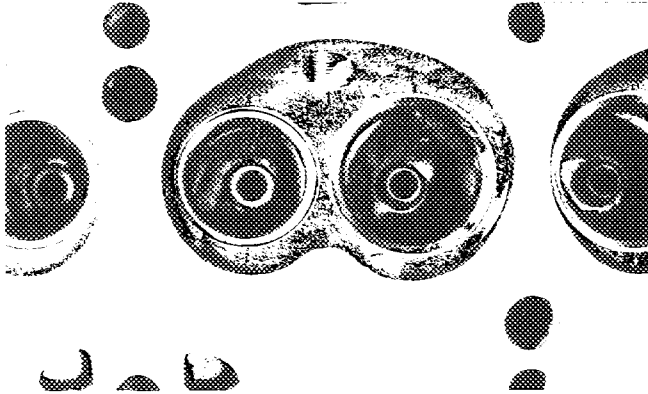

N Carburettor (view from side of manifold)

O engine in car with all accessories, bonnet open or removed

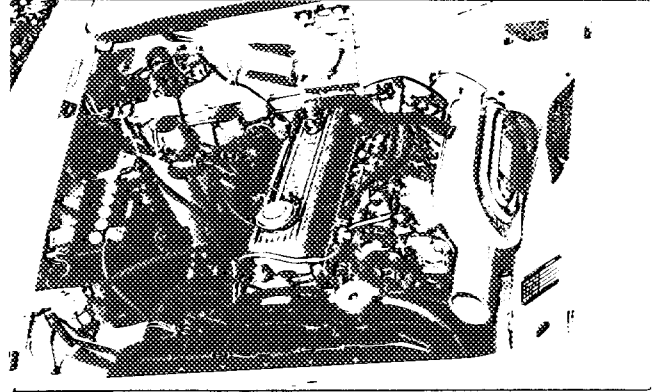
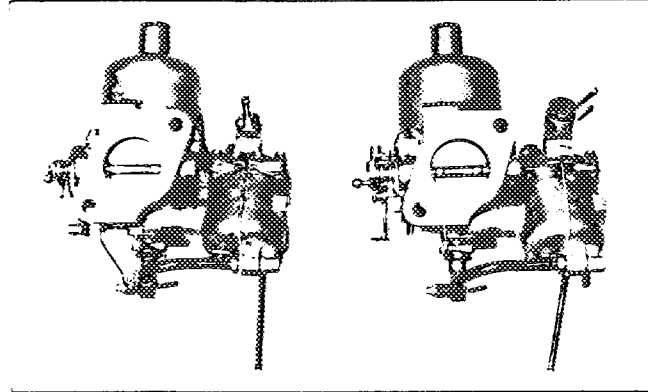

P inlet manifold

Q exhaust manifold

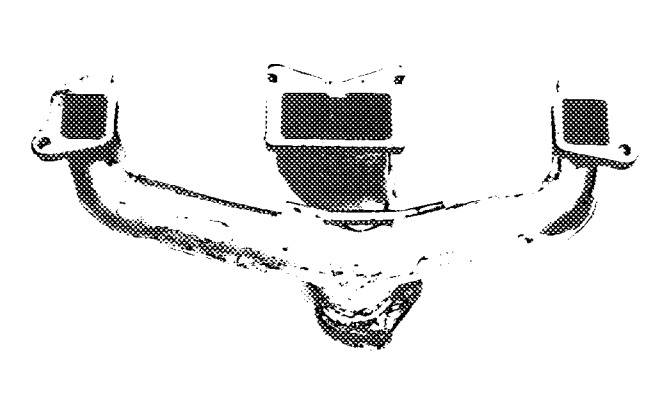
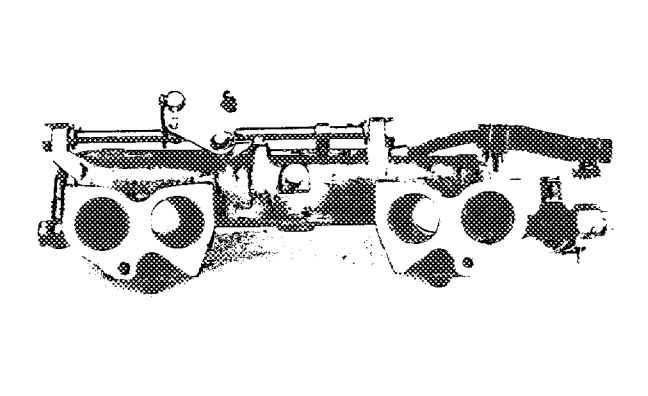

1429

Make **NISSAN**

Model **RA11**

F. I. A. Rec. No

Drawing inlet manifold ports, side of cylinder-head. Indicate scale or dimensions and manufacturing tolerance.

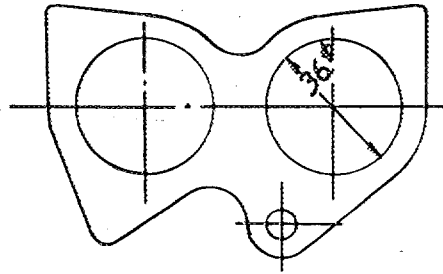

Dimension; mm
Tolerance; ± 1.5

Drawing of entrance to inlet port of cylinder-head. Indicate scale or dimensions and manufacturing tolerance.

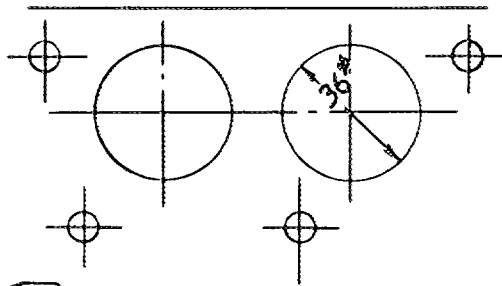

Drawing exhaust manifold ports, side of cylinder-head. Indicate scale or dimensions and manufacturing tolerance.

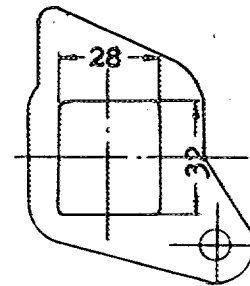
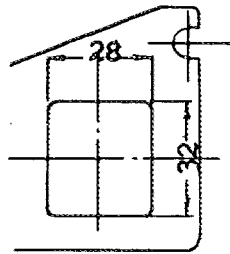

Drawing of exit to exhaust port of cylinderhead. Indicate scale or dimensions and manufacturing tolerance.

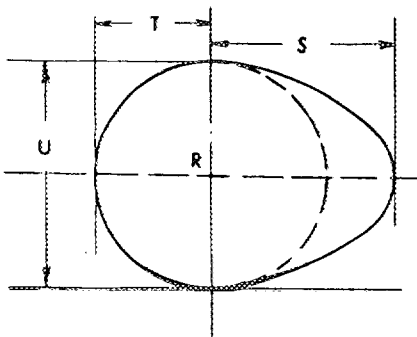
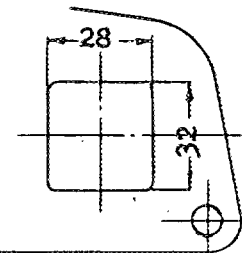
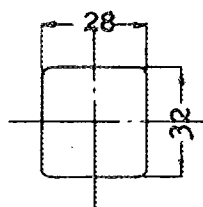

R=centre of camshaft.

Inlet cam

S =	21.5	mm	0.84	inches
T =	15.5	mm	0.61	inches
U =	31	mm	1.22	inches

Exhaust cam

S =	21.5	mm	0.84	inches
T =	15.5	mm	0.61	inches
U =	31	mm	1.22	inches

1429

Make **NISSAN**

Model **R411**

F. I. A. Rec. Rec. No

IMPORTANT the underlined items must be stated in two measuring systems, one of which must be the metric system, See coversion table here-after.

CAPACITIES AND DIMENSIONS

1. <u>Wheelbase</u>	2,380	mm	93.7	inches
2. <u>Front track</u>	1,206	mm	47.5	inches *
3. <u>Rear track</u>	1,198	mm	47.2	inches *
4. Overall length of the car		399.0	cm	inches
5. Overall width of the car		149.0	cm	inches
6. Overall height of the car		143.0	cm	inches
7. <u>Capacity of fuel tank</u> (reserve included)			4.1	ltrs
	10.8	Gallon US		Gallon Imp.
8. Seating capacity	5			
9. <u>Weight</u> , total weight of the car with normal equipment, water, oil and spare wheel but without fuel nor repair tools :				
	885	kg	1,949	lbs
				cwt

*) Differences in track caused by the use of other wheels with different rim widths must be stated when recognition is requested for the wheels concerned.

Specify ground clearance in relation to the track and give drawing of two easily recognizable points at front and rear at which measurements are taken.

These ground clearance dimensions are only for information when checking the track and can in no way affect the eligibility of the car.

CONVERSION TABLE

1 inch / pouce	— 2.54 cm	1 quart US	— 0.9464 ltrs
1 foot / pied	— 30.4794 cm	1 pint (pl)	— 0.568 ltrs
1 square inch / pouce carré	— 6.452 cm ²	1 gallon Imp.	— 4.546 ltrs
1 cubic inch / pouce cube	— 16.387 cm ³	1 gallon US	— 3.785 ltrs
1 pound / livre (lb)	— 453.593 gr.	1 hundred weight (cwt)	— 50.802 kg

Make NISSAN

Model

R411

F. I. A. Rec. No

CHASSIS AND COACHWORK (Photographs A, B and C)

- 20. Chassis/body construction : ~~XXXX~~ / unitary construction
- 21. Unitary construction, material (s) **Steel**
Separate construction
- 22. Material (s) of chassis
- 23. Material (s) of coachwork
- 24. Number of doors **2** Material (s) **Steel**
- 25. Material (s) of bonnet **Steel**
- 26. Material (s) of boot lid **Steel**
- 27. Material (s) of rear-window **Glass**
- 28. Material (s) of windscreen **Glass**
- 29. Material (s) of front-door windows **Glass**
- 30. Material (s) of rear-door windows
- 31. Sliding system of door windows **Vertical, manual**
- 32. Material (s) of rear-quarter light **Glass**

ACCESSORIES AND UPHOLSTERY

- 38. Interior heating : ~~XXXX~~ - no
- 39. Air-conditioning : ~~XXXX~~ - no
- 40. Ventilation : yes - ~~XX~~
- 41. Front seats, type of seat and upholstery **Separate, vinyl**
- 42. Weight of front seat (s), complete with supports and rails, out of the car :

13 x 2	kg	lbs
--------	----	-----
- 43. Rear seats, type of seat and upholstery **Bench, vinyl**
- 44. Front bumper, material (s) **Steel** Weight **7.5** kg inches
- 45. Rear bumper, material (s) **Steel** Weight **9.5** kg inches

WHEELS

- 50. Type **Pressed steel**
- 51. Weight (per wheel, without tyre) **6.0** kg lbs
- 52. Method of attachment **Wheel nut (4 nuts)**
- 53. Rim diameter **330** mm **13** inches
- 54. Rim width **102** mm **4** inches
- 114** mm **4.5** inches

STEERING

- 60. Type **Recirculating ball**
- 61. Servo-assistance : ~~XXXX~~ - no
- 62. Number of turns of steering wheel from lock to lock **3.0**
- 63. In case of servo-assistance

1429

Make NISSAN

Model Ball

F.I.A. Rec. No

SUSPENSION

- 70. Front suspension (photogr. D), type Independent by coil spring and wishbone
- 71. Type of spring Coil
- 72. Stabiliser (if fitted) Torsion bar
- 73. Number of shockabsorbers 2
- 74. Type Hydraulic telescopic
- 78. Rear suspension (photogr. E), type Rigid axle case and semi elliptical leaf spring
- 79. Type of spring Leaf
- 80. Stabiliser (if fitted)
- 81. Number of shockabsorbers 2
- 82. Type Hydraulic telescopic

BRAXES (photographs F and G)

- 90. Method of operation Hydraulic
- 91. Servo-assistance (if fitted), type
- 92. Number of hydraulic master cylinders 1

	FRONT			REAR		
93. Number of cylinders per wheel	2			1		
94. Bore of wheel cylinder (s)	25.4	mm	in.	23.8	mm	in.
Drum brakes						
95. Inside diameter	229	mm	in.	229	mm	in.
96. Length of brake linings	215	mm	in.	215	mm	in.
97. Width of brake linings	40	mm	in.	40	mm	in.
98. Number of shoes per brake	2			2		
99. Total area per brake	17,200	mm ²	sq. in.	17,200	mm ²	sq. in.
Disc brakes						
100. Outside diameter		mm	in.		mm	in.
101. Thickness of disc		mm	in.		mm	in.
102. Length of brake linings		mm	in.		mm	in.
103. Width of brake linings		mm	in.		mm	in.
104. Number of pads per brake						
105. Total area per brake		mm ²	sq. in.		mm ²	sq. in.

Make **NISSAN**

Model **R11**

ENGINE (photographs J and K)

- | | | | |
|---|-----------------------|-------------------------------|------------------------------------|
| 130. Cycle | 4 | 131. Number of cylinders | 4 |
| 132. Cylinder arrangement | In line | | |
| 133. Bore | 87.2 mm | 134. Stroke | 66.8 mm |
| | 3.43 in. | | 2.63 in. |
| 135. Capacity per cylinder | | | 24.34 cu. in. |
| | 398.9 cm ³ | | |
| 136. Total cylinder-capacity | | | 97.33 cu. in. |
| | 1,595 cm ³ | | |
| 137. Material (s) of cylinder block | Cast iron | | |
| 138. Material (s) of sleeves (if fitted) | | | |
| 139. Cylinder-head, material (s) | Al-cast | Number fitted | 1 |
| 140. Number of inlet ports | 4 | 141. Number of exhaust ports | 4 |
| 142. Compression ratio | 9.0 | | |
| 143. Volume of one combustion chamber | | 51.07 cm ³ | cu. in. |
| 144. Piston, material | Al-alloy | 145. Number of rings | 3 |
| 146. Distance from gudgeon pin centre line to highest point of piston crown | 45.1 mm | | |
| | | | inches |
| 147. Crankshaft : stamped / stamped | | 148. Type of crankshaft : | integral / XXXXXXXXXXXX |
| 149. Number of crankshaft main bearings | 3 | | |
| 150. Material of bearing cap | Cast iron | | |
| 151. System of lubrication : dry sump / oil in sump | | | |
| 152. Capacity, lubricant | 3.3 ltrs | | quarts US |
| | | | pls |
| 153. Oil cooler : yes / no | | 154. Method of engine cooling | Water |
| 155. Capacity of cooling system | 6.7 ltrs | | quarts US |
| | | | pints |
| 156. Cooling (if fitted), dia. | 32 cm | | inches |
| 157. Number of blades of cooling fan | 4 | | |

Bearings

- | | | | | |
|-----------------------------------|-------|------|-------|-----|
| 158. Crankshaft main, type | Plain | Dia. | 60 mm | in. |
| 159. Connecting rod big end, type | Plain | Dia. | 52 mm | in. |

Weights

- | | | | |
|---|---------|---------|-----|
| 160. Flywheel (clean) | 9.6 kg | lbs | |
| 161. Flywheel with clutch (all turning parts) | | 14.7 kg | lbs |
| 162. Crankshaft | 15.5 kg | lbs | |
| 163. Connecting rod | | 0.77 kg | lbs |
| 164. Piston with rings and pin | 0.49 kg | lbs | |

Make NISSAN

Model R411

F.I.A. Rec. No

FOUR STROKE ENGINES

- 170. Number of camshafts 1 171 Location Cylinder block
- 172. Type of camshaft drive Chain
- 173. Type of valve operation Push rod

INLET (see page 4) *

- 180. Material(s) of inlet manifold Al-cast
- 181. Diameter of valves 42 mm 1.65 inches
- 182. Max. valve lift 12 mm 0.47 in. 183. Number of valve springs 2
- 184. Type of spring Coil 185. Numbr of valves per cylinder 1
- 186. Tappet clearance for checking timing (cold) 0.43 mm inches
- 187. Valves open at (With tolerance for tappet clearance indicated) B, T, D, C 20° ±7°
- 188. Valves close at (with tolerance for tappet clearance indicated) A, B, D, C 56° ±7°
- 189. Air filter, type Dry

EXHAUST (see page 4)

- 195. Material (s) of exhaust manifold Cast iron
- 196. Diameter of valves 32 mm 1.26 inches
- 197. Max. valve lift 12 mm 0.47 in. 198. Number of valve springs 2
- 199. Type of spring Coil 200. Number of valves per cylinder 1
- 201. Tappet clearance for checking timing (cold) 0.43 mm inches
- 202. Valves open at (with tolerance for tappet clearance indicated) B, B, D, C. 58° ±7°
- 203. Valves close at (with tolerance for tappet clearance indicated) A, T, D, C 18° ±7°

CARBURETION (photograph N)

- 210. Number of carburetors fitted 2 211. Type Side draft
- 212. Make HITACHI 213. Model HJB-38W-3
- 214. Number of mixture passages per carburetor 1
- 215. Flange hold diameter of exit port(s) of carburetor 38 mm in.
- 216. ~~38 mm~~ / minimum diam. with piston at maximum height 38 mm inches

INJECTION (if fitted)

- 220. Make of pump 221. Number of plungers
- 222. Model or type of pump 223. Total number of injectors
- 224. Location of injectors
- 225. Minimum diameter of inlet pipe mm inches

*) for additional information concerning two-stroke engines and super-charged engines see page 13.

1429

Make NISSAN

Model

R411

F. i. A. Rec. No.

ENGINE ACCESSORIES

- 230. Fuel pump : mechanical and / ~~SCHEPAC~~
- 231. No fitted 1
- 232. Type of ignition system Make and break ignition
- 233. No of distributors 1
- 234. No of ignition coils 1
- 235. No of spark plugs per cylinder 1
- 236. Generator, type ~~SCHEPAC~~ / alternator-number fitted 1
- 237. Method of drive V-belt
- 238. Voltage of generator 12 volts
- 239. Battery, number 1
- 240. Location Engine room
- 241. Voltage of battery 12 volts

ENGINE AND CAR PERFORMANCES (as declared by manufacturer in catalogue)

- 250. Max. engine output 90 PS (type of horsepower: JIS) at 6,000 rpm
- 251. Maximum rpm 6,400 output at that figure 89 PS
- 252. Maximum torque 13.5 kg-m at 4,000 rpm
- 253. Maximum speed of the car 160 km/hour miles / hour

1429

Make

NISSAN

Model

RA11

F. I. A. Rec. No

DRIVE TRAIN

CLUTCH

260. Type of clutch **Dry single plate** 261. No. of plates **1**
262. Dia. of clutch plates **20.2** cm inches
263. Dia. of linings, inside **13.0** cm in. outside **20** cm in.
264. Method of operating clutch **Hydraulic**

GEAR BOX (photograph H)

270. ~~Method of operation~~ **NISSAN**
271. ~~No. of gear-box ratios forward~~ **Manual type, make** **4** 272. Synchronized forward ratios **1, 2, 3, 4**
273. Location of gear-shift **Floor**
274. Automatic, make type
275. No. of forward ratios 276. Location of gear-shift

277.	Manual		Automatic		Ratio	Alternative manual/ Automatic		Ratio	No. teeth
	Ratio	No. teeth	Ratio	No. teeth		No. teeth	No. teeth		
1	3.657	$\frac{32}{21} \times \frac{36}{15}$			3.382	$\frac{31}{22} \times \frac{36}{15}$			
2	2.177	$\frac{32}{21} \times \frac{30}{21}$			2.013	$\frac{31}{22} \times \frac{30}{21}$			
3	1.419	$\frac{32}{21} \times \frac{27}{29}$			1.312	$\frac{31}{22} \times \frac{27}{29}$			
4	1.000				1.000				
5									
6									
reverse	3.638	$\frac{32}{21} \times \frac{18}{21} \times \frac{39}{14}$			3.364	$\frac{31}{22} \times \frac{18}{21} \times \frac{39}{14}$			

278. Overdrive, type
279. Forward gears on which overdrive can be selected
280. Overdrive ratio

FINAL DRIVE

290. Type of final drive **Hypoid gear**
291. Type of differential **Bevel gear**
292. Type of limited slip differential (if fitted) **Mechanical**
293. Final drive ratio **3.889 4.111 4.375 4.625 4.875 5.125**
- Number of teeth **39/9 37/9 35/8 37/8 39/8 41/8**

1429

Make

NISSAN

Model

RA11

F. I. A. Rec. No

IMPORTANT- The conformity of the car with the following items of the present recognition form is to be disregarded during the scrutineering, when the vehicle has been entered in group 2 (Touring cars) or 3 (Grand Touring cars) : 41, 72, 80, 91, 142, 143, 144, 145, 146, 153, 156, 157, 160, 161, 162, 163, 164, 182, 186, 187, 188, 189, 201, 202, 203, 212, 213, 215, 216, 222, 225, 230, 236, 250, 251, 252, 253, 255 page 4. and photographs I, M and N,

During the scrutineering of entered in group 4 (Sportscars) only the following items of the present recognition form are to be taken into consideration : 1, 2, 3, 9, 20, 21, 22, 23, 24, 25, 26, 70, 71, 78, 79, 90, 130, 131, 132, 133, 134, 135, 136, 137, 138, 139, 140, 141, 147, 148, 149, 150, 158, 159, 170, 171, 172, 173, 185, 200, 270, 271, 274, 275, 290, 291, 292 and photographs A, B, D, E, F, G, H, J, K, and O.

Optional equipment affecting preceding information. This to be stated together with reference number.

Four door sedan



The model produced on the same line as two door sedan

NISSAN RA11

1429

Make NISSAN Model R411 F.I.A. Rec. No.

TWO STROKE ENGINES

- 300. System of cylinder scavenging
- 301. Type of lubrication
- 302. Inlet ports, length measured around cylinder wall mm inches
- 303. Height inlet port mm in. 304. Area mm² sq. in.
- 305. Exhaust ports, length measured around cylinder wall mm inches
- 306. Height exhaust port mm in. 307. Area mm² sq. in.
- 308. Transfer port, length measured around cylinder wall mm inches
- 309. Height transfer port mm in. 310. Area mm² sq. in.
- 311. Piston ports, length measured around piston mm inches
- 312. Height piston port mm in. 313. Area mm² sq. in.
- 314. Method of precompression 315. Precompression cyl.: yes /no
- 316. Bore mm inches 317. Stroke mm inches
- 318. Distance from top of cyl. block to highest point of exhaust port : mm inches
- 319. Distance from top of cyl. block to lowest point of inlet port : mm inches
- 320. Distance from top of cyl. block to highest point of transfer port : mm inches
- 321. Drawing of cylinder ports.

330. Supercharging—state full details hereafter :

JAPAN AUTOMOBILE FEDERATION

Chairman

of Technical Subcommission

Handwritten signature: Osamu Hirano

Osamu Hirano

